



City of Chicago



Or2023-58

Office of the City Clerk

Document Tracking Sheet

Meeting Date:	3/14/2023
Sponsor(s):	Cappleman (46)
Type:	Order
Title:	Issuance of permits for sign(s)/signboard(s) at 3501 N Halsted St - north elevation
Committee(s) Assignment:	Committee on Zoning, Landmarks and Building Standards

CITY COUNCIL
COMMITTEE ON ZONING, LANDMARKS AND BUILDING STANDARDS

COUNCIL ORDER

RE: Approval of sign over 100 square feet in area or over 24 feet above grade

ORDERED, that the City Council hereby approves the following sign application submitted by:

Applicant*: HOWARD BROWN HEALTH HALSTED
(* The Applicant is the owner of the real property or the business tenant of the real property. Do not list the sign contractor, sign erector, sign company or advertising entity in the above space.)

This Order approves the following sign in accordance with Municipal Code of Chicago Section 13-20-680:

Address of Sign: 3501 NORTH HALSTED STREET Chicago, IL 60657

Zoning District: C1-2

DOB Sign Permit Application #: 100999392

Sign Details:

1. On-premise OR Off-premise
2. Static sign OR Dynamic-image display sign
3. Number of sign faces 1
4. Projecting over the public way NO (Yes or No) If yes, Public Way Use #: _____
5. Dimensions: Length 14 feet 9 inches Height 3 feet 6 inches
Total square feet in area: 51 feet .63 inches
6. Height above grade: 53 feet 11 inches
7. Elevation (side of building or lot where the sign will be erected): NORTH ELEVATION
8. Name of Sign Contractor/Erector: POBLOCKI SIGN COMPANY

To be legal, such sign shall comply with all provisions of Title 17 of the Chicago Municipal Code ("Zoning Ordinance") and all other provisions of the Municipal Code governing the permitting, construction and maintenance and removal of signs and sign structures. Failure of the applicant and the applicant's successors to comply shall be grounds for invalidation or revocation of the sign permit.

James Capleman
Alderman

46th
Ward

SIGN SPECIFICATIONS

Lighting: LED - Blue
 LED Color: Cool White (Standard)
 Voltage: 120 V (TBD)

[A] - ILLUMINATED LOGO
 Description: Face-Lit (Acrylic);
 Face Color: Digital print to match artwork
 Return Color: Painted black
 Trimcap Color: Black
 Installation: Stud mounted flush

[B] - ILLUMINATED LETTERS
 Description: Face-Lit (Acrylic)
 Face Color: Red-orange PMS 1655 C with
 slight white outline
 Return Color: Painted black
 Trimcap Color: Black
 Installation: Stud mounted flush

[C] - ILLUMINATED LETTERS
 Description: Face-Lit (Acrylic)
 Face Color: Blue PMS 2607 C with slight
 white outline
 Return Color: Painted black
 Trimcap Color: Black
 Installation: Stud mounted flush

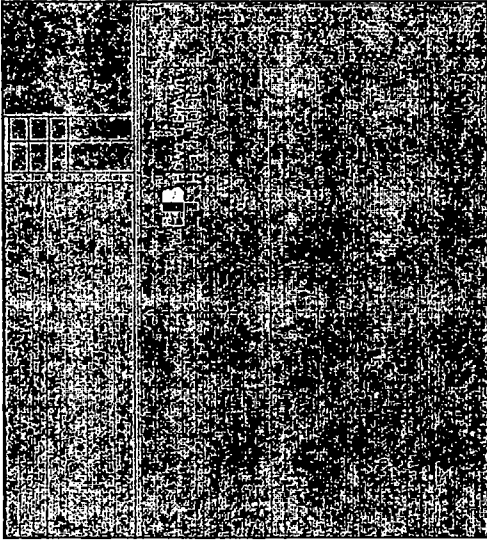

Proposed Night View - 3/32" = 1'



Proposed Day View - 3/32" = 1'

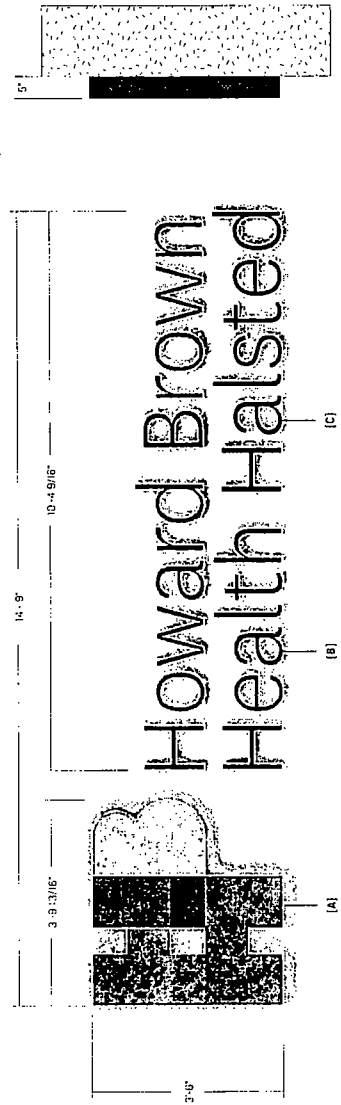

Side View

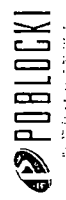

Publocki is a subsidiary of Publocki Sign Company, LLC. We provide professional sign and lighting solutions for businesses and organizations. Our services include design, fabrication, and installation of signs and lighting. We are committed to providing high-quality work and excellent customer service. For more information, please contact us at 312.461.1111 or visit our website at www.publocki.com.

Project: **Howard Brown Health Halsted**
 Chicago, IL

Scale: 1/2" = 1'
 Sheet No: 5.02 - II + 17
 Notes:

REVISION	DESCRIPTION	BY	DATE

Client: **North**
 Project: **North**

Sign Type: **LL-01**
 Sign Type: **LL Letters**

Project No: **92719**
 Project Name: **Health**

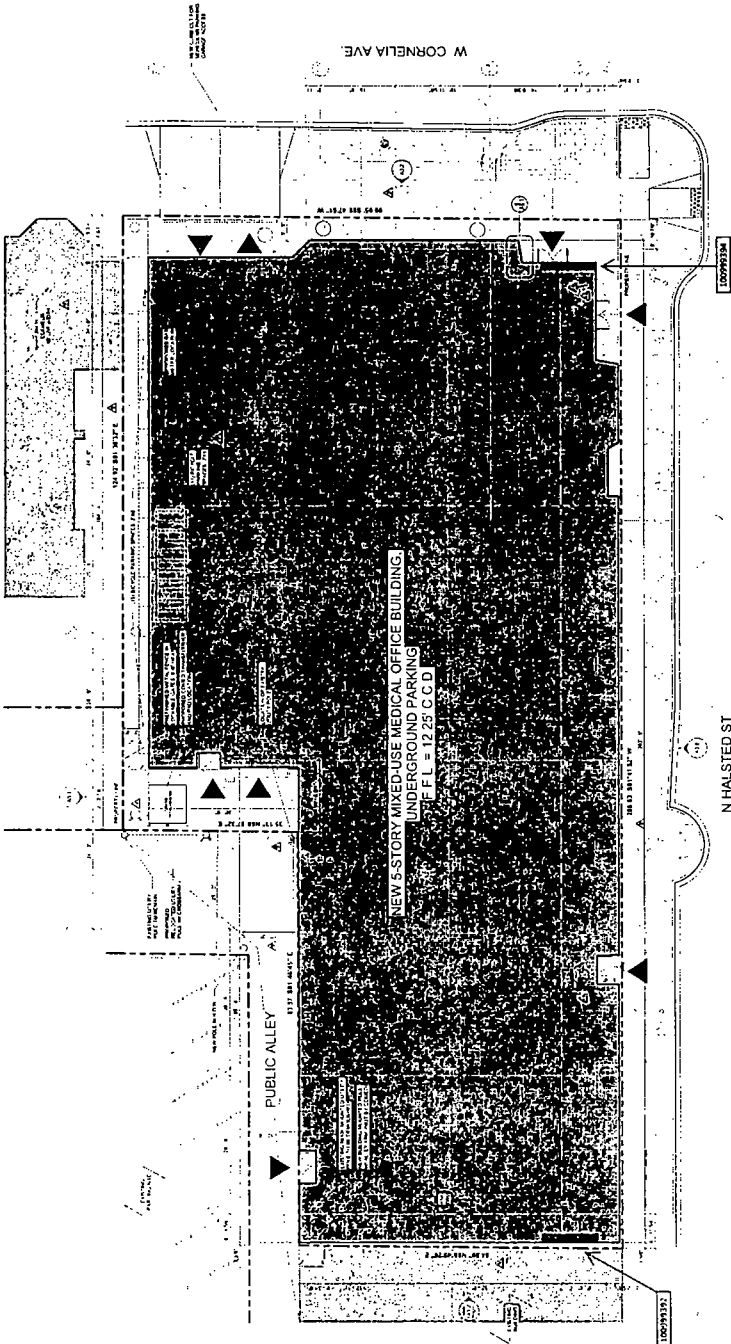

ARCHITECT:
 ECKENHOFF SAUNDERS SAUNDERS
 1000 EAST HARRISON AVENUE
 CHICAGO, ILLINOIS 60605
 CONTACT:
 GUY D. ECKENHOFF
 ARCHITECT
 630.988.9400
 www.eckens.com
 DATE: 10/18/2011

PROJECT:
 HOWARD BROWN HEALTH
 HALSTED CENTER
 ARCHITECTURAL SITE PLAN
 1000 EAST HARRISON AVENUE
 CHICAGO, ILLINOIS 60605
 DATE: 10/18/2011

**ECKENHOFF
 SAUNDERS**
 ARCHITECTS
 1000 EAST HARRISON AVENUE
 CHICAGO, ILLINOIS 60605
 TEL: 630.988.9400
 WWW.ECKENS.COM



PROJECT:
 HOWARD BROWN HEALTH
 HALSTED CENTER
 ARCHITECTURAL SITE PLAN
 1000 EAST HARRISON AVENUE
 CHICAGO, ILLINOIS 60605
 DATE: 10/18/2011

SHEET:
 4
 OF
 4
 AS1.0