



City of Chicago



O2017-5086

Office of the City Clerk

Document Tracking Sheet

Meeting Date:	6/28/2017
Sponsor(s):	Moore (49)
Type:	Ordinance
Title:	Sidewalk cafe(s) for 86th Ohio LLC, d.b.a. Empirical Brew Pub
Committee(s) Assignment:	Committee on Transportation and Public Way

ORDINANCE

86th Ohio LLC
Acct. No. 348586
Permit No. TBD

Be It Ordained by the City Council of the City of Chicago:

Permission and authority are hereby given and granted to 86th Ohio LLC, DBA Empirical Brew Pub upon the terms and subject to the conditions of this ordinance, to maintain and use a portion of the public right of way for a sidewalk cafe adjacent to its premises located at 1330 W. Morse Avenue. Said sidewalk cafe area #1 shall be forty-eight (48) feet in length and ten (10) feet in width for a total of four hundred eighty (480) square feet and shall allow six (6) feet of clear space from the face of the curb/building line along W. Morse Avenue. The compensation for said space and the days and hours of operation for the sidewalk cafe shall be as follows:

Tuesday through Wednesday 12:00 noon. to 10:00 pm
Thursday through Saturday 12:00 noon through 12:00 midnight
Sunday 12:00 noon. to 8:00 pm
Compensation: \$600.00
SEATING CAPACITY: 37

Sidewalk Cafe Permit and approved plan must be posted at all times.

This grant of privilege #TBD for a sidewalk cafe shall be subject to the provisions of Section 10-28-800 through 10-28-885 of the Municipal Code of Chicago and the directions of the Commissioner of Department of Business Affairs and Consumer Protection, the Commissioner of Streets and Sanitation, and the Commissioner of Transportation.

The permit holder agrees to hold the City of Chicago harmless for any damage, relocation or replacement costs associated with damage, relocation or removal of private property caused by the City performing work in the public way.

Authority for the above named privilege is herein given and granted from and after March 1, 2017 through and including December 1, 2017.

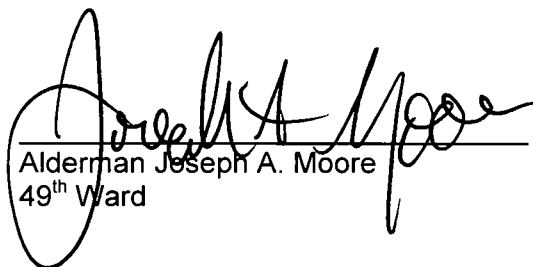
Alderman Joseph A. Moore
49th Ward

APPLICATION WORKSHEET

Please enclose a plan of the proposed Sidewalk Café and its relationship to the surrounding public way. Please show the associated dimensions, clearance measurements, boundaries and landscaping, street location, seating capacity, accessibility to patrons with disabilities and its relationship to the surrounding public way. Also include photograph(s) of proposed Sidewalk Café's location.

In addition, please fill in below the proposed Sidewalk Café's (1) business license information, (2) street location, dimensions, (3) seating capacity, and (4) days and hours of operation.

1. Business License Information

ACCOUNT #: 348586

CURRENT RETAIL FOOD LICENSE #: 2003847

BUSINESS LOCATION ADDRESS: 1330 W MORSE AVE

2. Proposed Sidewalk Café Location and Dimension Information

Note: The street name(s) and proposed length(s) and width(s) must match the proposed plan.

STREET NAME (City, State)	LENGTH	WIDTH
MORSE AVE	48'	10'

3. Proposed Sidewalk Café's Seating Capacity

Note: The proposed seating capacity must match the proposed plan.

CAPACITY: 30

4. Days and Hours of Operation

Note: Sidewalk Café's cannot operate earlier than 8:00 AM nor later than midnight.

DAY OF THE WEEK	PROPOSED HOURS OF OPERATION
Monday	CLOSED
Tuesday	12 PM - 10 PM
Wednesday	12 PM - 10 PM
Thursday	12 PM - 12 AM
Friday	12 PM - 12 AM
Saturday	12 PM - 12 AM
Sunday	12 PM - 8 PM

ACCEPTANCE OF SIDEWALK CAFE PERMIT TERMS

Please check **ALL** the boxes. *Failure to complete this section properly will prevent your application from being processed.*

ACKNOWLEDGEMENTS:

I hereby understand and accept the terms and conditions relative to the issuance of the Sidewalk Café permit, and by signing below, I acknowledge that I must adhere to the City of Chicago's Municipal Code 10-28-800 through 10-28-885 (Article XII. Sidewalk Cafés), the Rules and Regulations for Sidewalk Cafés, as well as all the additional requirements promulgated herein:

I understand it shall be my duty as the permit holder, and as a condition of the permit, to:

- comply with all the requirements defined within Chicago's Municipal Code, the Rules and Regulations, as well as the requirements promulgated herein;
- upon submission of the Sidewalk Café Application, furnish the Certificate of Insurance;
- upon the introduction of the permit ordinance at City Council, pay the non-refundable applicable Sidewalk Café annual permit fee (minimum \$600.00, varies with size and location);
- resolve all Account Holds since failure to do so will prevent the issuance of this permit application;
- install or maintain the Sidewalk Café after the issuance of the permit by the Commissioner of Business Affairs and Consumer Protection;
- install and/or maintain the Sidewalk Café in a manner that complies with all applicable accessibility requirements under local, state or Federal law, including but not limited to those set forth in the "Accessibility Requirements for Sidewalk Cafes in the City of Chicago" section of this Sidewalk Café Application Information Package

I understand that failure to adhere to all conditions imposed in the permit may result in revocation of the permit.

I hereby attest that all information that I have submitted is true and accurate.

MUST BE SIGNED BY AN AUTHORIZED OWNER/OFFICER OF THE LICENSED BUSINESS ENTITY

SIGNATURE: William Hurley

PRINT NAME: WILLIAM HURLEY

ACCOUNT #: 348586

LEGAL NAME OF ENTITY: 86th OHIO LLC

BUSINESS NAME (DBA): EMPIRICAL BREW PUB

BUSINESS LOCATION ADDRESS: 1330 W MORSE AVE

CITY: Chicago

STATE: Illinois

ZIP CODE: 60626

BUSINESS PHONE: 847-921-6932

E-MAIL: BILL.HURLEY@EMPIRICALBREWERY.COM PERMIT TYPE: Sidewalk Café





CERTIFICATE OF LIABILITY INSURANCE

DATE (MM/DD/YYYY)
5/4/2017

THIS CERTIFICATE IS ISSUED AS A MATTER OF INFORMATION ONLY AND CONFERS NO RIGHTS UPON THE CERTIFICATE HOLDER. THIS CERTIFICATE DOES NOT AFFIRMATIVELY OR NEGATIVELY AMEND, EXTEND OR ALTER THE COVERAGE AFFORDED BY THE POLICIES BELOW. THIS CERTIFICATE OF INSURANCE DOES NOT CONSTITUTE A CONTRACT BETWEEN THE ISSUING INSURER(S), AUTHORIZED REPRESENTATIVE OR PRODUCER, AND THE CERTIFICATE HOLDER.

IMPORTANT: If the certificate holder is an ADDITIONAL INSURED, the policy(ies) must be endorsed. If SUBROGATION IS WAIVED, subject to the terms and conditions of the policy, certain policies may require an endorsement. A statement on this certificate does not confer rights to the certificate holder in lieu of such endorsement(s).

PRODUCER Wine Sergi Insurance 1000 E. Warrenville Road Suite 101 Naperville IL 60563	CONTACT NAME: PHONE (A/C, No, Ext): 630-513-6600 FAX (A/C, No): 630-513-6399 E-MAIL ADDRESS: Debbiew@winesergi.com	
	INSURER(S) AFFORDING COVERAGE NAIC #	
INSURED 86th Ohio LLC 1330 W Morse Ave Chicago IL 60626	INSURER A: EMC INSURANCE COMPANIES	
	INSURER B:	
	INSURER C:	
	INSURER D:	
	INSURER E:	
	INSURER F:	

COVERAGES **CERTIFICATE NUMBER:** 1045061504 **REVISION NUMBER:**

THIS IS TO CERTIFY THAT THE POLICIES OF INSURANCE LISTED BELOW HAVE BEEN ISSUED TO THE INSURED NAMED ABOVE FOR THE POLICY PERIOD INDICATED. NOTWITHSTANDING ANY REQUIREMENT, TERM OR CONDITION OF ANY CONTRACT OR OTHER DOCUMENT WITH RESPECT TO WHICH THIS CERTIFICATE MAY BE ISSUED OR MAY PERTAIN, THE INSURANCE AFFORDED BY THE POLICIES DESCRIBED HEREIN IS SUBJECT TO ALL THE TERMS, EXCLUSIONS AND CONDITIONS OF SUCH POLICIES. LIMITS SHOWN MAY HAVE BEEN REDUCED BY PAID CLAIMS.

INSR LTR	TYPE OF INSURANCE	ADDL INSR	SUBR WVD	POLICY NUMBER	POLICY EFF (MM/DD/YYYY)	POLICY EXP (MM/DD/YYYY)	LIMITS
A	GENERAL LIABILITY <input checked="" type="checkbox"/> COMMERCIAL GENERAL LIABILITY <input type="checkbox"/> CLAIMS-MADE <input checked="" type="checkbox"/> OCCUR GEN'L AGGREGATE LIMIT APPLIES PER: <input type="checkbox"/> POLICY <input type="checkbox"/> PRO-JECT <input type="checkbox"/> LOC			5x67708	5/4/2017	5/4/2018	EACH OCCURRENCE \$1,000,000 DAMAGE TO RENTED PREMISES (Ea occurrence) \$500,000 MED EXP (Any one person) \$10,000 PERSONAL & ADV INJURY \$1,000,000 GENERAL AGGREGATE \$2,000,000 PRODUCTS - COMP/OP AGG \$2,000,000 \$
	AUTOMOBILE LIABILITY <input type="checkbox"/> ANY AUTO <input type="checkbox"/> ALL OWNED AUTOS <input type="checkbox"/> HIRED AUTOS <input type="checkbox"/> SCHEDULED AUTOS <input type="checkbox"/> NON-OWNED AUTOS						COMBINED SINGLE LIMIT (Ea accident) \$ BODILY INJURY (Per person) \$ BODILY INJURY (Per accident) \$ PROPERTY DAMAGE (Per accident) \$ \$
A	<input checked="" type="checkbox"/> UMBRELLA LIAB <input checked="" type="checkbox"/> OCCUR <input type="checkbox"/> EXCESS LIAB <input type="checkbox"/> CLAIMS-MADE DED RETENTION \$			5x67708	5/4/2017	5/4/2018	EACH OCCURRENCE \$1,000,000 AGGREGATE \$1,000,000 \$
	WORKERS COMPENSATION AND EMPLOYERS' LIABILITY ANY PROPRIETOR/PARTNER/EXECUTIVE OFFICER/MEMBER EXCLUDED? (Mandatory in NH) <input type="checkbox"/> Y/N If yes, describe under DESCRIPTION OF OPERATIONS below		N/A				WC STATU-TORY LIMITS OTH-ER E.L. EACH ACCIDENT \$ E.L. DISEASE - EA EMPLOYEE \$ E.L. DISEASE - POLICY LIMIT \$
A	Liquor Liability			5x67708	5/4/2017	5/4/2018	AGGREGATE \$1,000,000

DESCRIPTION OF OPERATIONS / LOCATIONS / VEHICLES (Attach ACORD 101, Additional Remarks Schedule, if more space is required)
BACP is included as additional insured with respects to general liability when required by written contract.
30 day advance notice of cancellation applies

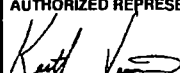
CERTIFICATE HOLDER City of Chicago Dept of Business Affairs & Consumer Protection 121 N LaSalle St, Rm 805 Chicago IL 60602	CANCELLATION SHOULD ANY OF THE ABOVE DESCRIBED POLICIES BE CANCELLED BEFORE THE EXPIRATION DATE THEREOF, NOTICE WILL BE DELIVERED IN ACCORDANCE WITH THE POLICY PROVISIONS. AUTHORIZED REPRESENTATIVE 
--	---

CITY OF CHICAGO

LICENSE CERTIFICATE NON-TRANSFERABLE

BY THE AUTHORITY OF THE CITY OF CHICAGO, THE FOLLOWING SPECIFIED LICENSE IS HEREBY GRANTED TO

NAME: 86TH OHIO LLC

PRINTED ON:
06/14/2017

DBA: EMPIRICAL BREW PUB
AT: 1330 W. MORSE AVE., Floor BSMT, 1ST, 2ND
CHICAGO, IL 60626
BSMT & 1ST FLR

LICENSE NO.: 2003847
LICENSE: Retail Food Establishment
17970 Sq. Ft.

CODE: 1006

FEE: \$**1,100.00

MANAGING MEMBER: KARI HURLEY

This license is a privilege granted and not a property right. This license is the property of the City of Chicago.

THIS LICENSE IS ISSUED AND ACCEPTED SUBJECT TO THE REPRESENTATIONS MADE ON THE APPLICATION THEREFOR, AND MAY BE SUSPENDED OR REVOKED FOR CAUSE AS PROVIDED BY LAW, LICENSEE SHALL OBSERVE AND COMPLY WITH ALL LAWS, ORDINANCES, RULES AND REGULATIONS OF THE UNITED STATES GOVERNMENT, STATE OF ILLINOIS, COUNTY OF COOK, CITY OF CHICAGO AND ALL AGENCIES THEREOF.

WITNESS THE HAND OF THE MAYOR OF SAID CITY AND THE CORPORATE SEAL THEREOF

THIS 16 DAY OF OCTOBER, 2016

EXPIRATION DATE: October 15, 2018

ATTEST:



Rahm Emanuel
MAYOR

ACCOUNT NO.
TRANS NO 348586 SITE: 1

Anna M. Valencia
CITY CLERK

DUPLICATE



THIS LICENSE MUST BE POSTED IN A CONSPICUOUS PLACE UPON THE LICENSED PREMISES.

CITY OF CHICAGO

LICENSE CERTIFICATE NON-TRANSFERABLE

BY THE AUTHORITY OF THE CITY OF CHICAGO, THE FOLLOWING SPECIFIED LICENSE IS HEREBY GRANTED TO

NAME: 86TH OHIO LLC

PRINTED ON:
06/14/2017

DBA: EMPIRICAL BREW PUB
AT: 1330 W. MORSE AVE., Floor BSMT, 1ST, 2ND
CHICAGO, IL 60626
1ST FL RESTAURANT

LICENSE NO: 2003849

CODE: 1475

FEE: \$**4,400.00

LICENSE: Consumption on Premises - Incidental Activity

Liquor Liability Insurance Must Be Kept On The Premises At All Times.

MANAGING MEMBER: KARI HURLEY

MANG: JOSEPH HENRY DESCHENE

This license is a privilege granted and not a property right. This license is the property of the City of Chicago.

ISSUED BY THE MAYOR AS THE LOCAL LIQUOR CONTROL COMMISSIONER

THIS LICENSE IS ISSUED AND ACCEPTED SUBJECT TO THE REPRESENTATIONS MADE ON THE APPLICATION THEREFOR, AND MAY BE SUSPENDED OR REVOKED FOR CAUSE AS PROVIDED BY LAW. LICENSEE SHALL OBSERVE AND COMPLY WITH ALL LAWS, ORDINANCES, RULES AND REGULATIONS OF THE UNITED STATES GOVERNMENT, STATE OF ILLINOIS, COUNTY OF COOK, CITY OF CHICAGO AND ALL AGENCIES THEREOF.

WITNESS THE HAND OF THE MAYOR OF SAID CITY AND THE CORPORATE SEAL THEREOF

THIS 16 DAY OF OCTOBER, 2016

ATTEST:

EXPIRATION DATE:

October 15, 2018



Rahn Emanuel
MAYOR

Anna M. Valencia
CITY CLERK

ACCOUNT NO. 348586
TRANS NO. SITE: 1

DUPLICATE



THIS LICENSE MUST BE POSTED IN A CONSPICUOUS PLACE UPON THE LICENSED PREMISES.

CITY OF CHICAGO
DEPARTMENT OF BUSINESS AFFAIRS AND CONSUMER PROTECTION
SIDEWALK CAFÉ PERMIT

DOING BUSINESS AS (DBA) NAME: Mayne Stage/Act One Pub
BUSINESS CONTACT NAME: c/o Joseph Deschene
BUSINESS MAILING ADDRESS: 1328-1330 W. MORSE AVE., FLOOR BSMT, 1ST,
2ND CHICAGO, IL 60626
BUSINESS CITY, STATE, ZIP CODE: CHICAGO, IL 60626
CITY WARD: 49
HOURS OF OPERATION: Sunday through Saturday 11:00am until 12:00am
SEATING CAPACITY: 30
VALID DATES: March 1, 2015 - December 1, 2015

PERMIT NUMBER: 1117133
PRINT DATE: 04/20/2015
ISSUE DATE: 04/20/2015
ACCOUNT NUMBER: 3485861-1
PERMIT FEE: \$600.00

THIS CITY OF CHICAGO SIDEWALK CAFÉ PERMIT, AND APPROVED SITE PLAN, MUST BE POSTED AT ALL TIMES.

Pursuant to the Ordinances passed by the City Council of the City of Chicago on 01/21/2015 (pending passage), permission and authority are hereby given and granted to Mayne Stage/Act One Pub upon the terms and subject to the conditions of this ordinance, to maintain and use a portion of the public right-of-way for a Sidewalk Café adjacent to its premises, located at 1328-1330 W. Morse Ave.. Said sidewalk café area shall be forty-eight (48) feet in length and ten (10) feet in width for a total of four hundred eighty (480) square feet and shall allow six (6) feet of clear space, unless otherwise noted on the approved plan, from the facade of the building line along Morse.

THIS PERMIT IS ISSUED AND ACCEPTED upon the condition that said Sidewalk Café shall be constructed and maintained in accordance with and subject to all conditions, stipulations and requirements of the ordinances of the City of Chicago, and all orders and ordinances, which may be passed by the City Council pertaining to, same, and all orders of the Commissioner of Transportation, and the Commissioner of Business Affairs and Consumer Protection.

The permit holder agrees to hold the City of Chicago harmless for any damage, relocation or replacement costs associated with damage, relocation or removal of private property caused by the City performing work in the public way.

THIS PERMIT IS REVOCABLE by the Commissioner of Business Affairs and Consumer Protection.



City of Chicago - Department of Business Affairs and Consumer Protection
Small Business Center - Public Way Use Unit - City Hall - 121 N. LaSalle Street, Room 800, Chicago, IL 60602
312-74-GOBIZ / 312-744-6249 • (312) 744-1944 (TTY) - <http://www.cityofchicago.org/bacp>

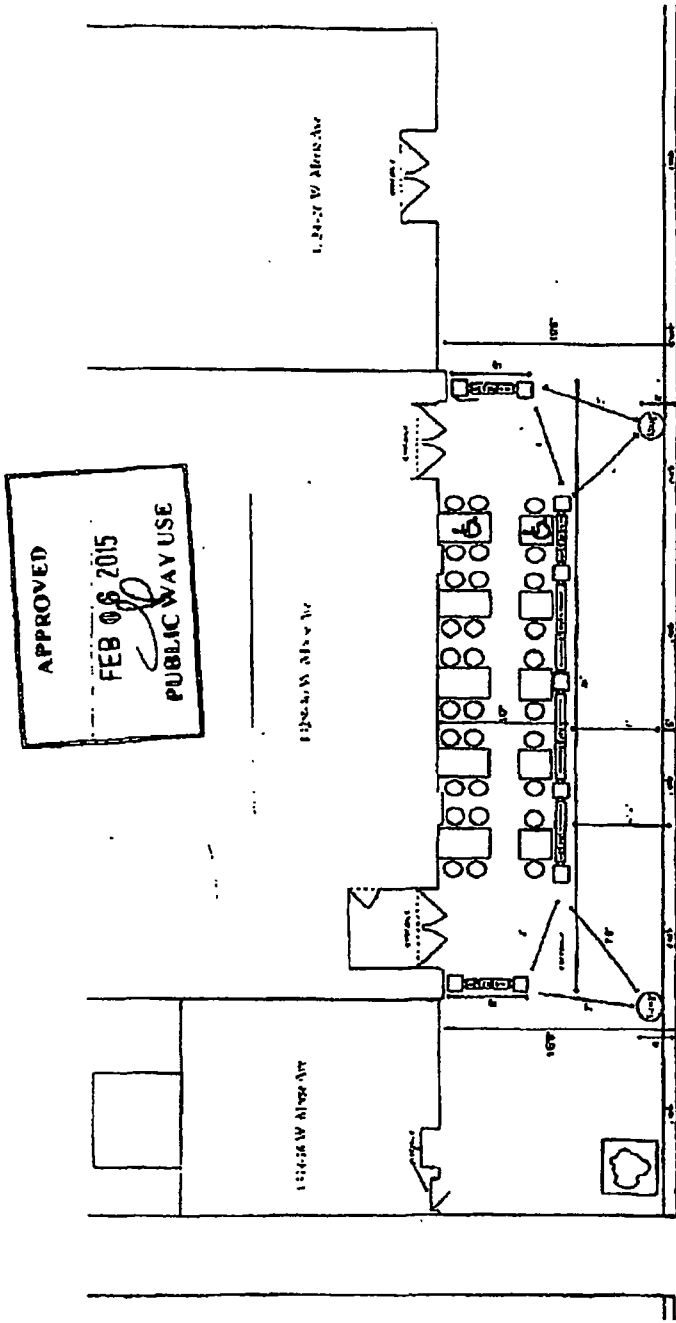

APPROVED
 FEB 06 2015
[Signature]
 PUBLIC WAY USE

86TH OHIO LLC.
 WEST MORSE AVENUE
 MAYNE STAGE / ACT ONE PUS
 1328-30 W. MORSE AVE.
 CHICAGO IL. 60626

