



Office of Chicago City Clerk



Or2011-573

Office of the City Clerk

City Council Document Tracking Sheet

Meeting Date:	6/8/2011
Sponsor(s):	Arena, John (45)
Type: -	Order
Title:	Issuance of Sign(s)/Signboard(s) permits at 5406 N Elston Ave
Committee(s) Assignment:	Committee on Zoning, Landmarks and Building Standards

Committee on Buildings

(signs)

ORDERED, That the Commissioner of Buildings is hereby directed to issue a sign permit to: (Contractor's name and address)

CHESTERFIELD AWNING CO.
16999 VAN DAM ROAD
SOUTH HOLLAND IL 60473

for the erection of a sign/signboard over 24 feet in height and/or over 100 square feet (in area of one face) at: (Business NAME & ADDRESS)

BESCO AIR
5406 N. ELSTON AVE.
CHICAGO, IL 60630

Dimensions: length 50'-0" height 3'-6"
height above grade/roof to top of sign 11'-6"
TOTAL SQUARE FOOT AREA 175

Such sign(s) shall comply with all applicable provisions of TITLE 17 of the Chicago Zoning Ordinance and all other applicable provisions of the Municipal Code of the City of Chicago governing the construction and maintenance of outdoor signs, signboards and structures.

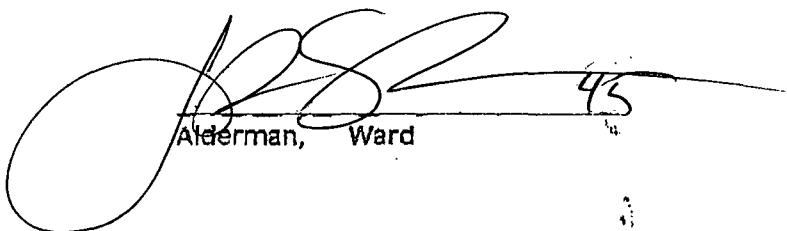
Alderman, Ward 45



CITY OF CHICAGO

DEPARTMENT OF BUILDINGS

Sign Permit Application

APPROVAL NUMBER	APPLICATION NUMBER 100388843	ANNUAL FEE	WORK CODE	DRAWINGS ATTACHED <input type="checkbox"/> YES <input type="checkbox"/> NO
DATE OF APPLICATION 04/07/2011	TYPE OF SIGN AWNING			
ADDRESS OF SIGN 5406 N ELSTON AVE, 60630	LENGTH	FT. 50	IN. 0	HEIGHT FT. 3
BUILDING	ORIGINAL PERMIT NUMBER	AREA	SQ. FT. 175	WEIGHT LBS. 150
TYPE OF PERMIT NEW CONSTRUCTION (SIGN)	SIGN HEIGHT ABOVE GRADE/ROOF			FT. 8
PAYER OF ANNUAL INSPECTION COX, JIM 5406 N. ELSON AVE. CHICAGO, IL 60630 (773)777-0200	SHAPE OF SIGN REGULAR			
SIGN MANUFACTURER CHESTERFIELD AWNING CO	SIGN WILL READ BESCO AIR LARGE ENOUGH TO SERVE SMALL ENOUGH TO CA			
ADDRESS WHERE SIGN CAN BE SEEN PRIOR TO ERECTION	NO. OF LAMPS	TOTAL WATTAGE		
TICKET NUMBER 0	REINSPECTION CONTROL NUMBER	TYPE OF LAMP		
TYPE OF SUPPORT FOR SIGN AWNINGS	NO. OF BALLAST/TRANSFORMERS	INPUT OF TRANSFORMERS		
SIGN BOARD SUPPORT MEMBERS OTHER	CONTRACTOR WILL INSTALL	<input checked="" type="checkbox"/> FEEDERS <input checked="" type="checkbox"/> CUSTOMER LEADS		
ANNUAL FEE	TYPE OF SWITCH			
CONSTRUCTION FEE 200.00	LOCATION OF SWITCH			
1017 B FEE	SIGN LOCATION CANVAS AWNING MADE AND INSTALLED FACING NORTH EAST (BESCO AIR)			
TOTAL FEE 200.00	Check # for Zoning			
AMOUNT PAID 200.00	Check # for DCAP			
BALANCE DUE				

The undersigned certify that the statements in this application are true and correct and that all work done under the proposed permit will conform to the requirements of the Chicago Municipal Code

REG. NO	BOND. NO.	REG NO	N91306
ELECT CONTR	SIGN ERECTOR CHESTERFIELD WINDOW	SIGNER	
ADDRESS	ADDRESS 16999 VAN DAM ROAD SOUTH HOLLAND IL, 60423-		
SUPERVISOR SIGNATURE	SIGNATURE		

The permit issued on this application will authorize only signs here applied for. If other signs are to be erected they must be covered by additional permits

City of Chicago
Richard M. Daley, Mayor



Department of Buildings
Richard Monocchio, Commissioner

TYPE OF BUSINESS <u>OTHER</u> Other: <u>HEATING & COOLNG</u> Name: <u>BESCO AIR</u> LIC #: _____ Renewal Date: _____	SIGN BOND REQUIRED? <input type="checkbox"/> YES COUNCIL ORDER REQUIRED <input checked="" type="checkbox"/> YES IS SPECIAL PERMISSION REQUIRED FROM CHIEF ELECTRICAL <input type="checkbox"/> YES IF YES, ATTACH LETTER OF REQUEST TIME STAMP
Projects Over: <input checked="" type="checkbox"/> Private Property <input checked="" type="checkbox"/> Public Way Grant Permit #: <u>1096080</u> <input type="checkbox"/> Planned Development/Manufacturing PMD/PD#: _____ Zoning District: <u>CI</u> Other: <u>CI-I</u>	TIME STAMP
TYPE OF SIGN: <input type="checkbox"/> ADVERTISING <input type="checkbox"/> ILLUMINATE <input type="checkbox"/> MOVEABLE <input checked="" type="checkbox"/> BUSINESS <input type="checkbox"/> FLASHING	
TOTAL STREET FRONTAGE OF LOT (IN FEET) _____ <u>50</u>	
TOTAL AREA OF NEW SIGN (SQ.FT.) _____ <u>175</u>	
TOTAL AREA OF ALL SIGNS ON LOT (SQ.FT.) _____ <u>1</u>	
HEIGHT OF SIGN ABOVE GRADE (TO TOP) _____ <u>11ft 6in</u>	SIGN CLERK _____ APPROVED FOR PERMIT _____
DISTANCE OF CURB LINE OUTER EDGE (ft) _____ <u>7</u>	
DISTANCE OF STRUCTURE INNER EDGE (ft) _____ <u>1</u>	
DISTANCE FROM (ft): A. PUBLIC PARK (OVER 10 ACRES) _____ B. EXPRESSWAY (IF LESS THAN 1,000 FT.) _____ C. RESIDENCE DISTRICT (ADVERTISING SIGNS ONLY) _____	REMARKS
IF REPLACEMENT SIGN OR CHANGE OF FACE, WHAT DOES THE EXISTING SIGN READ? Original Payee: _____	
Landmark Hold: <input type="checkbox"/> Status: _____	
ZONING (OFFICE USE ONLY)	

CITY OF CHICAGO
DEPARTMENT OF ZONING AND LAND USE PLANNING
SIGN SITE PLAN
(ALL INFORMATION MUST BE COMPLETED AND LEGIBLE)

Site Address: 5406 N. ELSTON AVE. 1 of 1 applications

Sign Company: CHESTERFIELD AWNING CO. Rep Name: DAVE OR MATT

Phone (708) 596 - 4434 EXT _____ (Below: Building, streets and location of sign on lot or structure)
 North

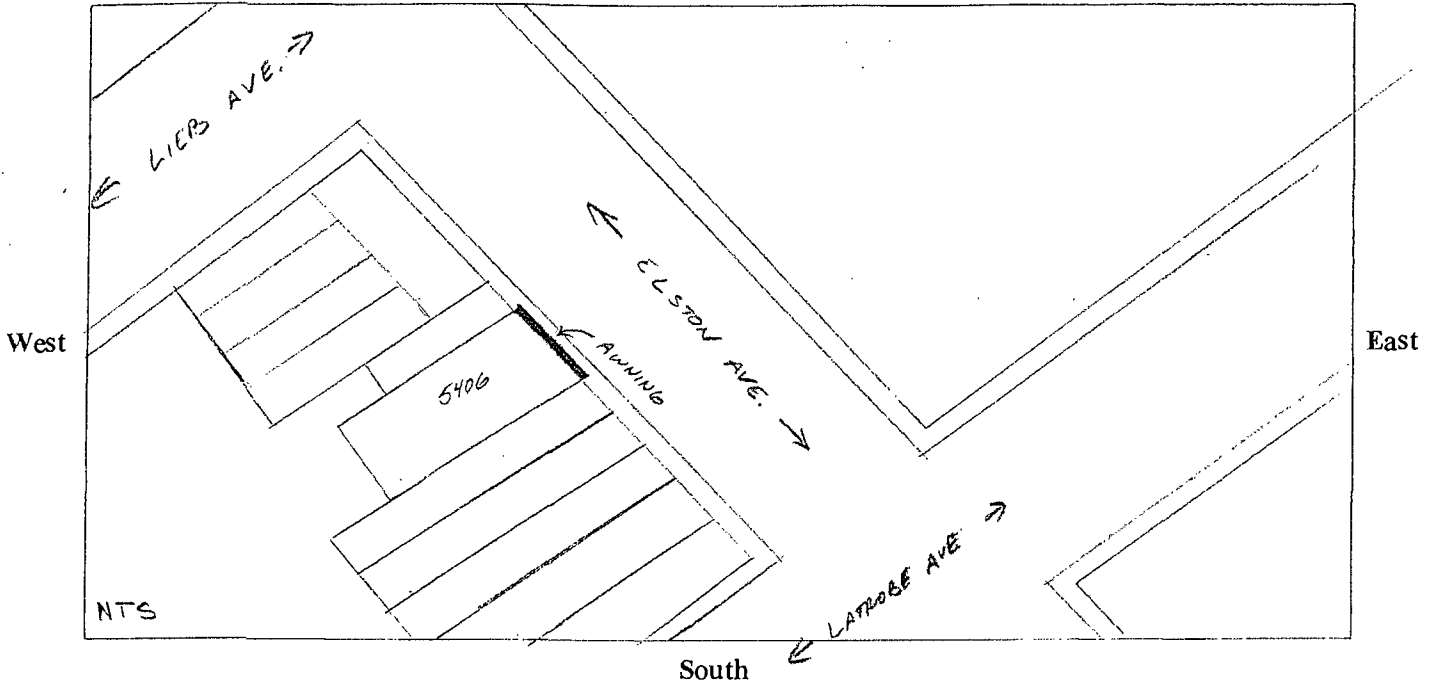

SIGN USE:

Bus. ID (On-premise) *Business Lice. #* _____

Advertising (Off-premise)

PERMIT TYPE:

New Construction

Change of Face

TOTAL SQUARE FOOTAGE:

Square footage of this proposed sign 175

Gross area of all proposed signs 175

Area of all existing signs
 (not including proposed) on Zoning Lot 1

TYPE OF SIGN:

Flat Wall

Freestanding

Awning

Marquee

High Rise Building

Projecting Private

Projecting Public Way

Public Way Use -Permit #

1096080

SIGN CHARACTERISTICS:

Non- Illuminated

Illuminated

Changing Image

Video Display

Flashing

DISTANCE FROM:

Curb Line: 7'-6"

Expressway, Toll Roads
 or Major Route

(n/a if over 1000 ft) n/a

Park (over 10 acres) n/a

Residential Zone n/a

Existing Off-premise on
 same side of street: n/a

Signature: _____

Date: _____

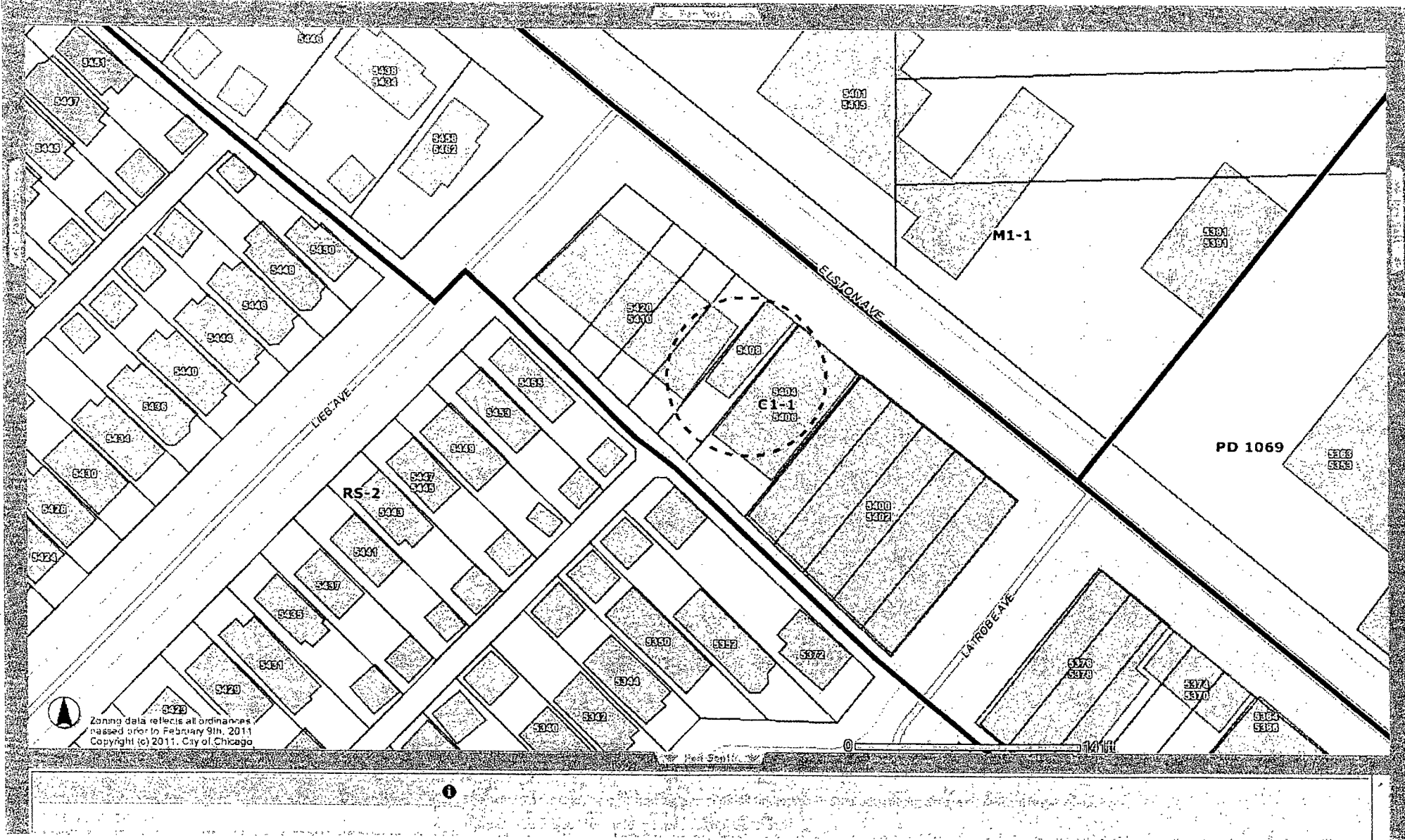

 5428
 Zoning data reflects all ordinances
 passed prior to February 9th, 2011.
 Copyright (c) 2011, City of Chicago

Chesterfield Awning Co.

Please note that upon signing this graphics sheet you are approving this design for production. Any changes made to the graphics and/or fabrication of the awning after your first signed approval will result in extra fees needed to cover the cost and time spent to make these changes. This can and will effect your installation date.

Chesterfield Awning Co., Inc

16999 Van Dam Rd.
South Holland, IL 60473
(708) 596-4434

RAFTER SPACING APPROX 24"-30" SPACING
AS NEEDED FOR STRUCTURAL INTEGRITY

FRAME LAYOUT

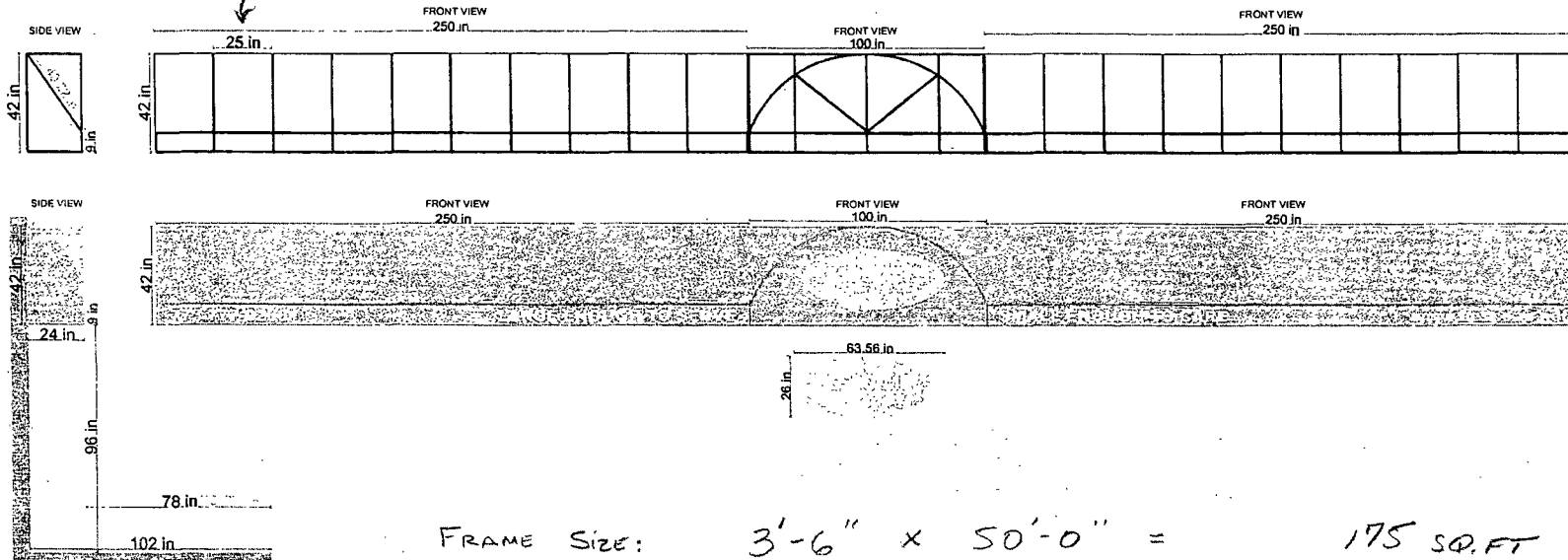

FRAME SIZE: $3'-6" \times 50'-0" = 175 \text{ SQ. FT}$

$3.5 \times 50 = 175$

$42" \times 600" = \frac{25200}{144} = 175$

File Name / Job Number:
Size/Style:
Color/Method:
Font Style:
Contact Person:
Misc. Notes:
Date:
Salesman:

This is an original drawing, created by Chesterfield Awning Company, Inc. It is being submitted for your personal use in connection with a project being planned for you by Chesterfield Awning Company, Inc. It is not to be used, reproduced, copied or exhibited in any fashion. In the event any of the above occurs, Chesterfield Awning company, Inc. expects to be reimbursed \$250.00 in compensation for the time and effort entailed in creating this drawing.

Customer Approval	Date
Sales Approval	Date



PHOTO RENDERING

Chesterfield Awning Co.

16999 Van Dam Road
South Holland, IL 60473
P: 708-596-4434
F: 708-596-9469

This is an original drawing, created by Chesterfield Awning Company, Inc. It is being submitted for your personal use in connection with a project being planned for you by Chesterfield Awning Company, Inc. It is not to be used, reproduced, copied or exhibited in any fashion. In the event any of the above occurs, Chesterfield Awning Company, Inc. expects to be reimbursed \$250.00 in compensation for the time and effort entailed in creating this drawing.

THIS DRAWING IS NOT TO SCALE

File Name: Besco Air
Date: 04-07-2011
Artist: M. C.
Address:
Salesman:
Job Number:
font Styles:

Misc Notes:

Fabric Color:

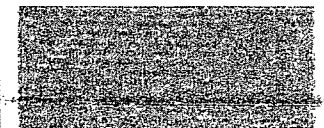

Customer Approval

Sales Approval

BESCO AIR
5406 N. ELSTON AVE

ANCHORING DETAIL: ALL METAL USED
1 X 1 SQ. ALUMINUM

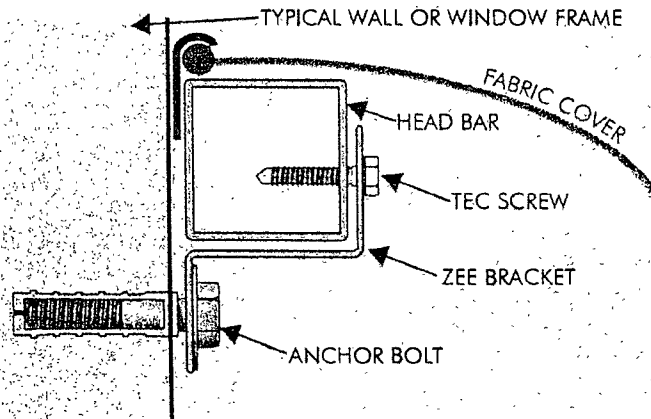

Mounting Detail • NTS