



Office of the Chicago City  
Clerk



Or2012-264

Office of the City Clerk

City Council Document Tracking Sheet

<b>Meeting Date:</b>	5/9/2012
<b>Sponsor(s):</b>	Silverstein, Debra L. (50)
<b>Type:</b>	Order
<b>Title:</b>	Issuance of permits for sign(s)/signboard(s) at 6148 N Lincoln Ave
<b>Committee(s) Assignment:</b>	Committee on Zoning, Landmarks and Building Standards

(signs)

Committee on Buildings

ORDERED, That the Commissioner of Buildings is hereby directed to issue a sign permit to: (Contractor's name and address)

FIRST AD-COMM  
3744 W. LAWRENCE AVE.  
CHICAGO IL 60625 (773) 267-6007

for the erection of a sign/signboard over 24 feet in height and/or over 100 square feet (in area of one face) at : (Business NAME & ADDRESS)

HOANH LONG RESTAURANT  
6148 N. Lincoln AVE.  
CHICAGO IL 60659

Dimensions: length 33'-0" height 4'-0"  
height above grade/roof to top of sign 16'-0"  
TOTAL SQUARE FOOT AREA 1324'

Such sign(s) shall comply with all applicable provisions of TITLE 17 of the Chicago Zoning Ordinance and all other applicable provisions of the Municipal Code of the City of Chicago governing the construction and maintenance of outdoor signs, signboards and structures.

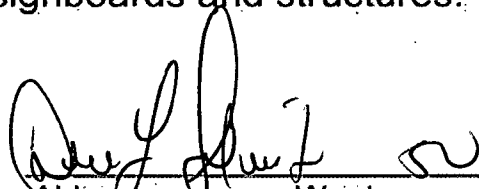
  
Alderman, Ward.



CITY OF CHICAGO

# DEPARTMENT OF BUILDINGS

## Sign Permit Application

APPROVAL NUMBER	APPLICATION NUMBER 100408758	ANNUAL FEE	WORK CODE	DRAWINGS ATTACHED <input checked="" type="checkbox"/> YES <input type="checkbox"/> NO
-----------------	---------------------------------	------------	-----------	--

DATE OF APPLICATION 08/29/2011	
ADDRESS OF SIGN 6148 N LINCOLN AVE, 60659-	
BUILDING	ORIGINAL PERMIT NUMBER
TYPE OF PERMIT NEW CONSTRUCTION (SIGN)	
PAYER OF ANNUAL INSPECTION LONG, HOANH 6148 N LINCOLN AVE CHICAGO, IL 60659 (773)583-7770	
SIGN MANUFACTURER FIRST AD-COMM	
ADDRESS WHERE SIGN CAN BE SEEN PRIOR TO ERECTION	
TICKET NUMBER 0	REINSPECTION CONTROL NUMBER
TYPE OF SUPPORT FOR SIGN AWNINGS	
SIGN BOARD SUPPORT MEMBERS STEEL	
ANNUAL FEE	_____
CONSTRUCTION FEE	400.00
1017 B FEE	_____
TOTAL FEE	400.00
AMOUNT PAID	200.00
BALANCE DUE	\$ 200.00

TYPE OF SIGN AWNING					
LENGTH	FT. 33	IN. 0	HEIGHT	FT. 4	IN. 0
AREA	SQ. FT. 132	WEIGHT		LBS 150	
SIGN HEIGHT ABOVE GRADE/ROOF					FT 12
SHAPE OF SIGN REGULAR					
SIGN WILL READ HAONH LONG VIETNAMESE & CHINESE CUISINE TEL:					
NO. OF LAMPS			TOTAL WATTAGE		
TYPE OF LAMP					
NO OF BALLAST/TRANSFORMERS			INPUT OF TRANSFORMERS		
CONTRACTOR WILL INSTALL			<input checked="" type="checkbox"/> FEEDERS <input checked="" type="checkbox"/> CUSTOMER LEADS		
TYPE OF SWITCH					
LOCATION OF SWITCH					
SIGN LOCATION AWNING ON FRONT OF STOREFRONT					

The undersigned certifies that the statements in this application are true and correct and that all work done under the proposed permit will conform to the requirements of the Chicago Municipal Code

REG. NO.	
ELECT CONTR	
ADDRESS	
SUPERVISOR SIGNATURE	

BOND NO.	B6136496	REG NO.	N93102
SIGN ERECTOR	FIRST AD-COMM INC	SIGNER	
ADDRESS	3744 W LAWRENCE CHICAGO IL, 60625-		
SIGNATURE			

The permit issued on this application will authorize only signs here applied for. If other signs are to be erected they must be covered by additional permits

City of Chicago  
Rahm Emanuel, Mayor



Department of Buildings  
Michael Merchant, Commissioner

TYPE OF BUSINESS OTHER _____ Other: RESTAURANT Name: _____ LIC #: _____ Renewal Date: _____	SIGN BOND REQUIRED? <input type="checkbox"/> YES COUNCIL ORDER REQUIRED <input type="checkbox"/> YES
---	---

Projects Over: <input checked="" type="checkbox"/> Private Property <input checked="" type="checkbox"/> Public Way Grant Permit #: 1097808 <input type="checkbox"/> Planned Development/Manufacturing PMD/PD#: _____ Zoning District: B1 Other: _____	IS SPECIAL PERMISSION REQUIRED FROM CHIEF ELECTRICAL <input type="checkbox"/> YES IF YES, ATTACH LETTER OF REQUEST
---	--

TYPE OF SIGN: <input type="checkbox"/> ADVERTISING <input type="checkbox"/> ILLUMINATE <input type="checkbox"/> MOVEABLE <input checked="" type="checkbox"/> BUSINESS <input type="checkbox"/> FLASHING	TIME STAMP
---	------------

TOTAL STREET FRONTAGE OF LOT (IN FEET) _____ 34 TOTAL AREA OF NEW SIGN (SQ.FT.) _____ 132 TOTAL AREA OF ALL SIGNS ON LOT (SQ.FT.) _____ 132 HEIGHT OF SIGN ABOVE GRADE (TO TOP) _____ 16ft 0in	
---	--

DISTANCE OF CURB LINE OUTER EDGE (ft) _____ 14 DISTANCE OF STRUCTURE INNER EDGE (ft) _____ 12	SIGN CLERK	APPROVED FOR PERMIT
--	------------	---------------------

DISTANCE FROM (ft): A. PUBLIC PARK (OVER 10 ACRES) _____ B. EXPRESSWAY (IF LESS THAN 1,000 FT.) _____ C. RESIDENCE DISTRICT (ADVERTISING SIGNS ONLY) _____ IF REPLACEMENT SIGN OR CHANGE OF FACE, WHAT DOES THE EXISTING SIGN READ? _____ Original Payee: _____	REMARKS <div style="text-align: center;">  </div>
---	---

Landmark Hold: <input type="checkbox"/> Status: _____	
---	--

ZONING (OFFICE USE ONLY)

**CONFORMS TO ZONING ORDINANCE**  
 This Approval of Application for signs shall not be held to permit or be an approval of any violation of the provisions.

APR 10 2012 

of the Chicago Zoning Ordinance, or any other requirements of the Municipal Code of the City of Chicago  
 ZONING ADMINISTRATOR

**CITY OF CHICAGO  
DEPARTMENT OF ZONING AND LAND USE PLANNING  
SIGN SITE PLAN**

*(ALL INFORMATION MUST BE COMPLETED AND LEGIBLE)*

Site Address: 6148 N. Lincoln Ave 1 of 1 applications

Sign Company: FIRST AD-COMM Rep Name: SEUNG PARK

Phone (773) 267-6007 EXT \_\_\_\_\_ (Below: Building, streets and location of sign on lot or structure)  
North

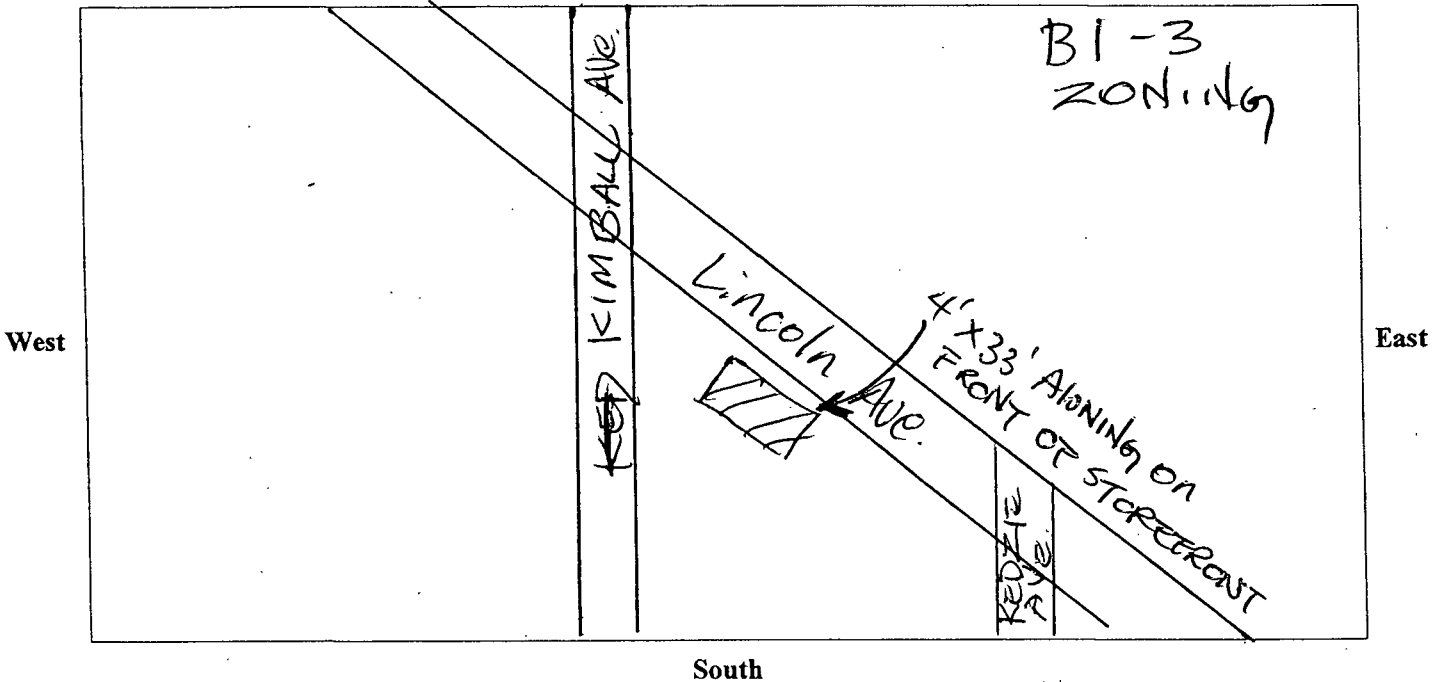

**SIGN USE:**

Bus. ID (On-premise)   
Business Lice. # \_\_\_\_\_

Advertising (Off-premise)

**PERMIT TYPE:**

New Construction   
Change of Face \_\_\_\_\_  
Previous Permit # \_\_\_\_\_

**TYPE OF SIGN:**

- Flat Wall
- Freestanding
- Awning
- Marquee
- High Rise Building
- Projecting Private
- Projecting Public Way

Public Way Use -Permit # \_\_\_\_\_

1097808

**SIGN CHARACTERISTICS:**

- Non-Illuminated
- Illuminated
- Changing Image
- Video Display
- Flashing

**DISTANCE FROM:**

Curb Line: 12'-0"  
Expressway, Toll Roads or Major Route \_\_\_\_\_  
(n/a if over 1000 ft) N/A  
Park (over 10 acres) N/A  
Residential Zone 100'  
Existing Off-premise on same side of street: N/A

**TOTAL SQUARE FOOTAGE:**

Square footage of this proposed sign 132 sq ft  
Gross area of all proposed signs 132 sq ft  
Area of all existing signs \_\_\_\_\_  
(not including proposed) on Zoning Lot 0

Signature: S. Park

Date: 8/29/11

# ■ AWNING ON FRONT OF WALL

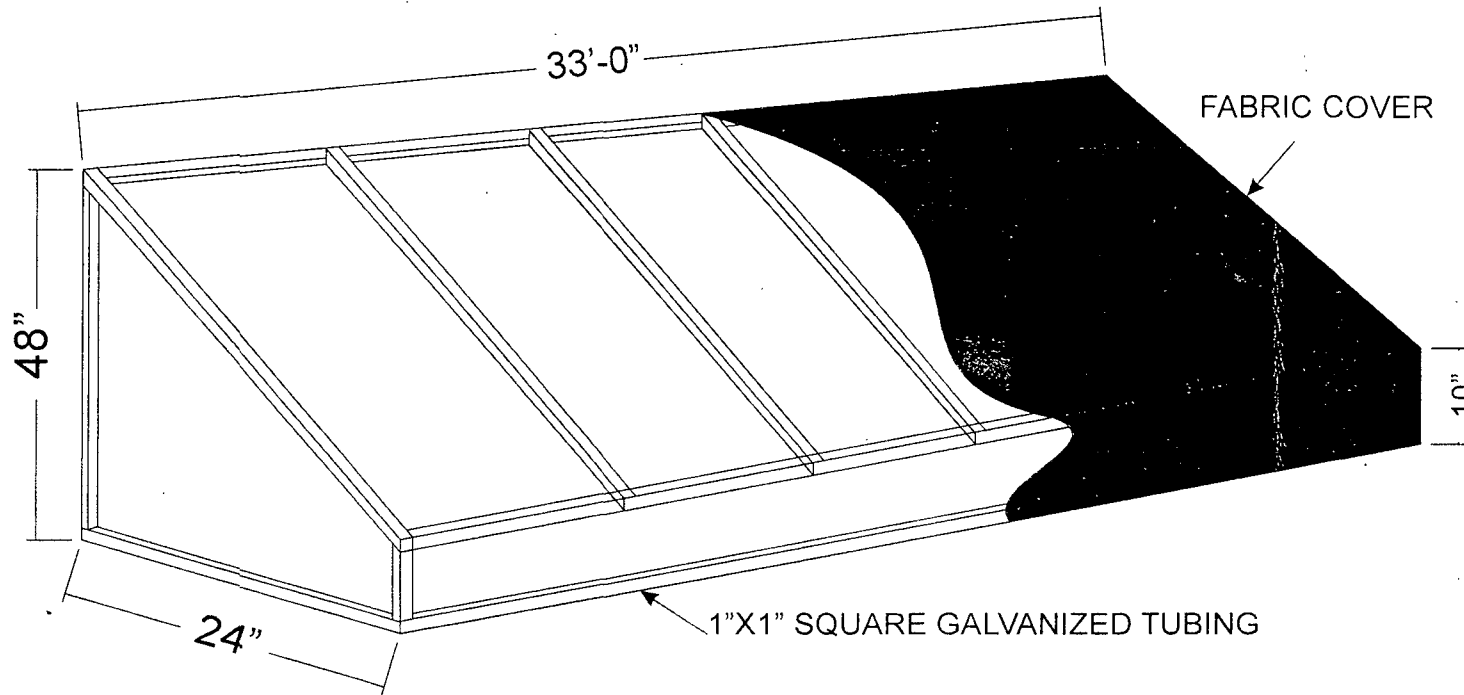
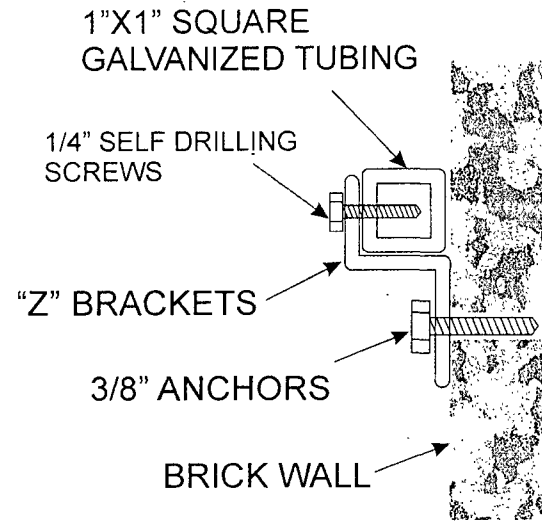

Created exclusively for:

Hoanh Long

Address:

6148 N. Lincoln Ave.

City:

CHICAGO

State:

IL 60659

Sign Location:

905 W. BELMONT

Account Rep:

SEUNG PARK

Client's Approved Date

Landlord's Approval Date

DesignNo.

011711

Sheet No.

1

Date:

01/17/11

Rev. Date:

Designer:

SEUNG PARK

Scale:

N/A

WORK DESCRIPTION

# ■ AWNING ON FRONT OF WALL

34' STOREFRONT



Created exclusively for:

Hoanh Long

Address:

6148 N. Lincoln Ave.

City:

CHICAGO

State:

IL 60659

Sign Location:

905 W. BELMONT

Account Rep:

SEUNG PARK

Client's Approved Date

Landlord's Approval Date

DesignNo.

Sheet No.

011711

1

Date:

Rev. Date.

01/17/11

Designer:

Scale:

SEUNG PARK

N/A

WORK DESCRIPTION

**PUBLIC WAY USE UNIT: PERMIT INFORMATION SHEET**

08/12/2011 - Stan Adams

DBA Name **HOANH LONG RESTAURANT**  
Location **6148 N. LINCOLN AVE.**  
Zip Code **60659**  
Account Number **308992**  
Site Number **2**  
Area **PERMIT**  
Permit Type **AWN**  
Permit Number **1097808**

Next steps: Department of Buildings – Permit process for signs

Your Public Way Use permit number is shown above. This number is to be used for each item on your DOB application and is needed for the Buildings (DOB) online sign application located @ [www.cityofchicago.org/buildings](http://www.cityofchicago.org/buildings). All signs, canopies, banners, marquees and awnings require a buildings permit. Only a licensed sign erector may apply for the Buildings permit online. The Buildings permit application will ask for the Public Way Use permit number supplied above. For additional information please contact the Buildings Department at (312) 744-3400.

Please return the completed Public Way Use application to City Hall - 121 N. LaSalle Street, Chicago, IL 60602 Room 800. The completed application package must include a copy of the completed DOB application and the Public Way Use application. The Public Way Use application must contain the Alderman's signature, site plans on 8 1/2 X 11 paper, photos of the item(s), the signed Acceptance letter and a copy of the insurance certificate. For additional information please contact BACP at (312)-74-GOBIZ (312-744-6249).