



# Office of the City Clerk



O2012-8136

Office of the City Clerk

## City Council Document Tracking Sheet

<b>Meeting Date:</b>	11/15/2012
<b>Sponsor(s):</b>	Cappleman, James (46)
<b>Type:</b>	Ordinance
<b>Title:</b>	Traffic sign(s)/signal(s) at 4720 N Clarendon Ave - Standing Zone-No Parking-Two Zone-Except with Flashing Lights
<b>Committee(s) Assignment:</b>	Committee on Pedestrian and Traffic Safety

**MEMORANDUM FOR TRAFFIC REGULATIONS**

**STANDING ZONE - NO PARKING - TOW ZONE - EXCEPT WITH FLASHING**

**LIGHTS:**

Street, etc: North Clarendon Avenue

Location, etc: No. 4720

Distance or extent: Install signs at the front entrance of the hospital, length of 67'7"

Time Limit: 15-MINUTES - Unattended vehicles must have flashing lights

Days: Sunday thru Saturday

Hours: At all times

**AURORA CHICAGO LAKESHORE HOSPITAL  
CHILDREN'S PAVILION  
4840 North Marine Drive  
Contact: C. Alan Eaks  
773.907.4600**

  
\_\_\_\_\_  
**JAMES CAPPLEMAN  
Alderman, 46th Ward**



**Alderman James Cappleman  
46th Ward – City of Chicago  
Standing/Loading Zone Application**

4544 N Broadway  
Chicago, IL 60640  
Tel: 773-878-4646  
Fax: 773-878-4920  
info@james46.org

**CHECKLIST**

**In order for your request to be reviewed, your application must be complete and include (please check off):**

- Letter on company letterhead requesting a standing zone or loading zone, specifically detailing the reasons for the zone. If there is not enough room on this application to answer all questions fully, please provide this information in your letter.
- Two photographs of the proposed location: one from across the street directed at your location and the second from the sidewalk at a property adjacent to your business.
- A diagram detailing the building, sidewalk, street, proposed location of the zone and all other parking restrictions on adjacent properties, including measurements. (Example provided)
- Completed Business Information Section.
- Completed Loading, Standing or Valet Zone Section.
- Signed Certification Section.

**BUSINESS INFORMATION**

Business Name: Aurora Chicago Lakeshore Hospital - Children's Pavilion

Business Address/Signs Location:

4720 N. Cleverdon

Zip: 60640

Billing Address (if different):

4840 N. Marine Dr.

Zip: 60640

Federal Identification Number: \_\_\_\_\_

Occupancy Limit: NA

Present parking regulations at \_\_\_\_\_

Open street parking

Business Hours:

Open all days 24/7/365

Monday:	Tuesday:	Wednesday:
Thursday:	Friday:	Saturday:
Sunday:		

4544 N Broadway  
Chicago, IL 60640  
Tel: 773-878-4646  
Fax: 773-878-4920  
info@james46.org

Length of Time at Location: new location - opening planned January 2013  
Number of Full-Time Equivalent Employees: 200

Scope of Business Activity:  
Psychiatric Hospital

Business Licenses Held:  
City of Chicago Hospital License # 2021834 State of IL # 000520

Contact Name: C. Alan Eaks  
Title: CEO

Contact Phone Number: (773) 907-4666  
Email: eaks@chicago.lakeshorehospital.com

Please fill out one of the following sections according to the type of zone you are requesting.

Check if Applicable **AMENDMENT TO EXISTING ZONE**

If you wish to amend an existing zone, please complete this section and fill out one of the following sections according to type of zone amendment you are requesting. Complete this section only if you currently have a standing/loading zone and you would like to make changes to it.

Type of Existing Parking Restriction:

Loading Zone  15-Minute Standing Zone  
 Valet Loading Zone  Other:

Restriction Times for Existing Zone:

Monday:	Tuesday:	Wednesday:
Thursday:	Friday:	Saturday:
Sunday:		

Length of Zone: \_\_\_\_\_ feet and approximately \_\_\_\_\_ vehicle spaces  
Last Invoice Number: \_\_\_\_\_ Permit Number: \_\_\_\_\_  
Permit Date: \_\_\_\_\_

4544 N Broadway  
Chicago, IL 60640  
Tel: 773-878-4646  
Fax: 773-878-4920  
info@james46.org

Please continue to one of the following sections according to the type of amendment you are requesting

Check if Applying

**15 MINUTE STANDING ZONE**

Please understand that:

- Vehicles parking in standing zones are limited to 15 minutes and must have their hazards flashing while the driver is away from the vehicle.
- Vehicles extending their stay over the 15 minute time limit are in violation of the Chicago Municipal Code and are liable to receive a citation.
- Even though the standing zone is placed adjacent to your business, vehicles standing in the zone for the allotted time are not obligated to patronize your business.
- It is illegal to post additional signage in the public way, including signage, which would cause one to assert that the loading zone is reserved solely for your business.

Restriction Times Requested: *All days 24/7/365*

Monday:	Tuesday:	Wednesday:
Thursday:	Friday:	Saturday:
Sunday:		

Length of Zone: 67'7" feet or approximately \_\_\_\_\_ vehicle space(s)

Reason for Zone / Business activity requiring standing zone:

*Front Entrance of Hospital. Utilized for drop-off and pick-up of patient arriving via own transportation*

Please describe the availability/restrictions of on-street parking:

*Open, non-metered street parking*

On the average day, how many sales/visits would utilize the zone? 25 out of a total of 100

Front view of 4720 N. Clarendon



*Side view of 4720 N. Clarendon*



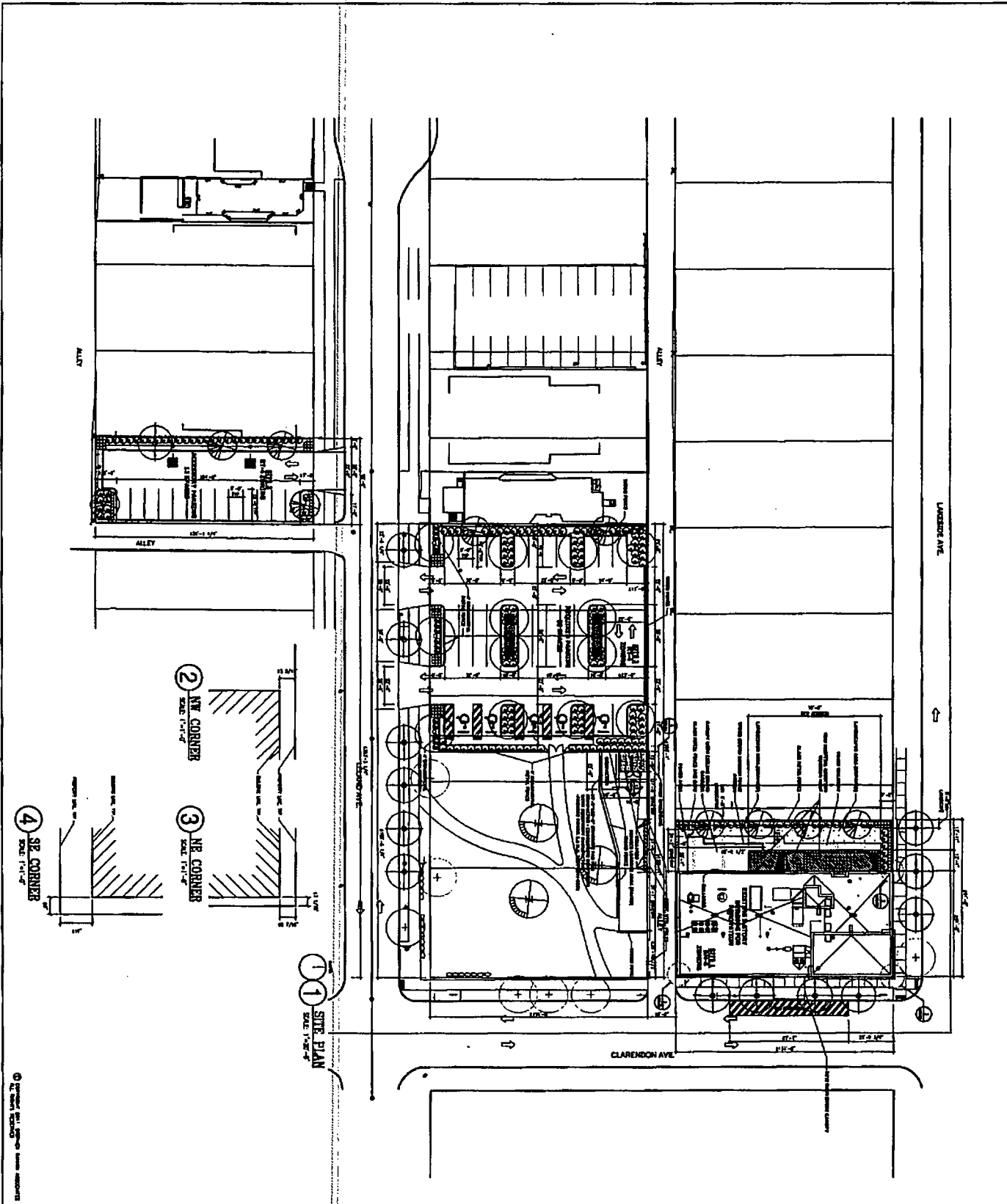

**STEPHEN RANKIN ASSOCIATES**  
**ARCHITECTS**  
 808 WEST WALKER DRIVE  
 SUITE 750  
 CERCADO, ILLINOIS 60606  
 TEL: 312.689.0008  
 FAX: 312.689.0965  
 WWW.SRAARCH.COM  
 EMAIL: SRA@SRAARCH.COM

**Site 11-1011**  
 S.L. LINDEN ARCHITECTS: 08/14/10  
 S.L. LINDEN: 11/02/2012

DATE:	08/14/10	SCALE:	AS SHOWN
PROJECT:	CHICAGO LANSBROKE HOSPITAL RENOVATION/ADDITION	DATE:	11/02/2012
CLIENT:	CHICAGO LANSBROKE HOSPITAL	SCALE:	1"=1'-0"
ARCHITECT:	STEPHEN RANKIN ASSOCIATES	DATE:	11/02/2012
PROJECT:	CHICAGO LANSBROKE HOSPITAL RENOVATION/ADDITION	SCALE:	1"=1'-0"
DATE:	11/02/2012	PROJECT:	CHICAGO LANSBROKE HOSPITAL RENOVATION/ADDITION

**CHICAGO LANSBROKE HOSPITAL RENOVATION/ADDITION**  
 CHICAGO, ILLINOIS

**1 SITE PLAN**  
 SCALE: 1"=1'-0"

**2 NW CORNER**  
 SCALE: 1"=1'-0"

**3 NE CORNER**  
 SCALE: 1"=1'-0"

**4 SE CORNER**  
 SCALE: 1"=1'-0"

**5 SITE PLAN**  
 SCALE: 1"=1'-0"

**6 SITE PLAN**  
 SCALE: 1"=1'-0"

**7 SITE PLAN**  
 SCALE: 1"=1'-0"

**8 SITE PLAN**  
 SCALE: 1"=1'-0"

**9 SITE PLAN**  
 SCALE: 1"=1'-0"

**10 SITE PLAN**  
 SCALE: 1"=1'-0"

**11 SITE PLAN**  
 SCALE: 1"=1'-0"

**12 SITE PLAN**  
 SCALE: 1"=1'-0"

**13 SITE PLAN**  
 SCALE: 1"=1'-0"

**14 SITE PLAN**  
 SCALE: 1"=1'-0"

**15 SITE PLAN**  
 SCALE: 1"=1'-0"

**16 SITE PLAN**  
 SCALE: 1"=1'-0"

**17 SITE PLAN**  
 SCALE: 1"=1'-0"

**18 SITE PLAN**  
 SCALE: 1"=1'-0"

**19 SITE PLAN**  
 SCALE: 1"=1'-0"

**20 SITE PLAN**  
 SCALE: 1"=1'-0"

**21 SITE PLAN**  
 SCALE: 1"=1'-0"

**22 SITE PLAN**  
 SCALE: 1"=1'-0"

**23 SITE PLAN**  
 SCALE: 1"=1'-0"

**24 SITE PLAN**  
 SCALE: 1"=1'-0"

**25 SITE PLAN**  
 SCALE: 1"=1'-0"

**26 SITE PLAN**  
 SCALE: 1"=1'-0"

**27 SITE PLAN**  
 SCALE: 1"=1'-0"

**28 SITE PLAN**  
 SCALE: 1"=1'-0"

**29 SITE PLAN**  
 SCALE: 1"=1'-0"

**30 SITE PLAN**  
 SCALE: 1"=1'-0"

**31 SITE PLAN**  
 SCALE: 1"=1'-0"

**32 SITE PLAN**  
 SCALE: 1"=1'-0"

**33 SITE PLAN**  
 SCALE: 1"=1'-0"

**34 SITE PLAN**  
 SCALE: 1"=1'-0"

**35 SITE PLAN**  
 SCALE: 1"=1'-0"

**36 SITE PLAN**  
 SCALE: 1"=1'-0"

**37 SITE PLAN**  
 SCALE: 1"=1'-0"

**38 SITE PLAN**  
 SCALE: 1"=1'-0"

**39 SITE PLAN**  
 SCALE: 1"=1'-0"

**40 SITE PLAN**  
 SCALE: 1"=1'-0"

**41 SITE PLAN**  
 SCALE: 1"=1'-0"

**42 SITE PLAN**  
 SCALE: 1"=1'-0"

**43 SITE PLAN**  
 SCALE: 1"=1'-0"

**44 SITE PLAN**  
 SCALE: 1"=1'-0"

**45 SITE PLAN**  
 SCALE: 1"=1'-0"

**46 SITE PLAN**  
 SCALE: 1"=1'-0"

**47 SITE PLAN**  
 SCALE: 1"=1'-0"

**48 SITE PLAN**  
 SCALE: 1"=1'-0"

**49 SITE PLAN**  
 SCALE: 1"=1'-0"

**50 SITE PLAN**  
 SCALE: 1"=1'-0"

**51 SITE PLAN**  
 SCALE: 1"=1'-0"

**52 SITE PLAN**  
 SCALE: 1"=1'-0"

**53 SITE PLAN**  
 SCALE: 1"=1'-0"

**54 SITE PLAN**  
 SCALE: 1"=1'-0"

**55 SITE PLAN**  
 SCALE: 1"=1'-0"

**56 SITE PLAN**  
 SCALE: 1"=1'-0"

**57 SITE PLAN**  
 SCALE: 1"=1'-0"

**58 SITE PLAN**  
 SCALE: 1"=1'-0"

**59 SITE PLAN**  
 SCALE: 1"=1'-0"

**60 SITE PLAN**  
 SCALE: 1"=1'-0"

**61 SITE PLAN**  
 SCALE: 1"=1'-0"

**62 SITE PLAN**  
 SCALE: 1"=1'-0"

**63 SITE PLAN**  
 SCALE: 1"=1'-0"

**64 SITE PLAN**  
 SCALE: 1"=1'-0"

**65 SITE PLAN**  
 SCALE: 1"=1'-0"

**66 SITE PLAN**  
 SCALE: 1"=1'-0"

**67 SITE PLAN**  
 SCALE: 1"=1'-0"

**68 SITE PLAN**  
 SCALE: 1"=1'-0"

**69 SITE PLAN**  
 SCALE: 1"=1'-0"

**70 SITE PLAN**  
 SCALE: 1"=1'-0"

**71 SITE PLAN**  
 SCALE: 1"=1'-0"

**72 SITE PLAN**  
 SCALE: 1"=1'-0"

**73 SITE PLAN**  
 SCALE: 1"=1'-0"

**74 SITE PLAN**  
 SCALE: 1"=1'-0"

**75 SITE PLAN**  
 SCALE: 1"=1'-0"

**76 SITE PLAN**  
 SCALE: 1"=1'-0"

**77 SITE PLAN**  
 SCALE: 1"=1'-0"

**78 SITE PLAN**  
 SCALE: 1"=1'-0"

**79 SITE PLAN**  
 SCALE: 1"=1'-0"

**80 SITE PLAN**  
 SCALE: 1"=1'-0"

**81 SITE PLAN**  
 SCALE: 1"=1'-0"

**82 SITE PLAN**  
 SCALE: 1"=1'-0"

**83 SITE PLAN**  
 SCALE: 1"=1'-0"

**84 SITE PLAN**  
 SCALE: 1"=1'-0"

**85 SITE PLAN**  
 SCALE: 1"=1'-0"

**86 SITE PLAN**  
 SCALE: 1"=1'-0"

**87 SITE PLAN**  
 SCALE: 1"=1'-0"

**88 SITE PLAN**  
 SCALE: 1"=1'-0"

**89 SITE PLAN**  
 SCALE: 1"=1'-0"

**90 SITE PLAN**  
 SCALE: 1"=1'-0"

**91 SITE PLAN**  
 SCALE: 1"=1'-0"

**92 SITE PLAN**  
 SCALE: 1"=1'-0"

**93 SITE PLAN**  
 SCALE: 1"=1'-0"

**94 SITE PLAN**  
 SCALE: 1"=1'-0"

**95 SITE PLAN**  
 SCALE: 1"=1'-0"

**96 SITE PLAN**  
 SCALE: 1"=1'-0"

**97 SITE PLAN**  
 SCALE: 1"=1'-0"

**98 SITE PLAN**  
 SCALE: 1"=1'-0"

**99 SITE PLAN**  
 SCALE: 1"=1'-0"

**100 SITE PLAN**  
 SCALE: 1"=1'-0"