



City of Chicago



O2015-2361

Office of the City Clerk

Document Tracking Sheet

| | |
|---------------------------------|---|
| Meeting Date: | 3/18/2015 |
| Sponsor(s): | Reilly (42) |
| Type: | Ordinance |
| Title: | Grant(s) of privilege in public way for 1221 N. LaSalle LLC |
| Committee(s) Assignment: | Committee on Transportation and Public Way |

ORDINANCE
1221 N. LASALLE LLC
Acct. No. 396149 - 1
Permit No. 1116856

Be It Ordained by the City Council of the City of Chicago:

SECTION 1. Permission and authority are hereby given and granted to 1221 N. LASALLE LLC, upon the terms and subject to the conditions of this ordinance to construct, install, maintain and use three (3) Planter(s) on the public right-of-way for beautification purposes adjacent to its premises known as 1221 N. La Salle Dr..

Said Planter(s) at N. La Salle Drive measure(s):

One (1) at five (5) feet in length, and five (5) feet in width for a total of twenty-five (25) square feet.

One (1) at five (5) feet in length, and seven (7) feet in width for a total of thirty-five (35) square feet.

One (1) at five (5) feet in length, and ten (10) feet in width for a total of fifty (50) square feet.

Grantee must allow the required clear and unobstructed space for pedestrian passage at all times per rules and regulations approved by the Department of Transportation.

The location of said privilege shall be as shown on prints kept on file with the Department of Business Affairs and Consumer Protection and the Office of the City Clerk.

Said privilege shall be constructed in accordance with plans and specifications approved by the Department of Planning and Development and Department of Transportation (Division of Project Development).

This grant of privilege in the public way shall be subject to the provisions of Section 10-28-015 and all other required provisions of the Municipal Code of Chicago.

The grantee shall pay to the City of Chicago as compensation for the privilege #1116856 herein granted the sum of zero (\$.00) per annum in advance.

A 25% penalty will be added for payments received after due date.

The permit holder agrees to hold the City of Chicago harmless for any damage, relocation or replacement costs associated with damage, relocation or removal of private property caused by the City performing work in the public way.

Authority herein given and granted for a period of five (5) years from and after Date of Passage.

Alderman _____

Brendan Reilly 42nd Ward

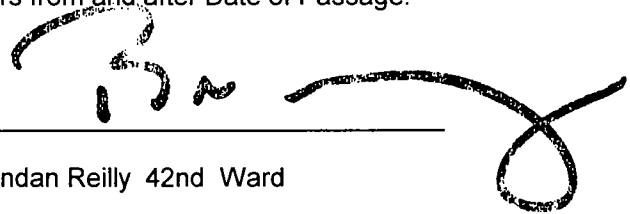

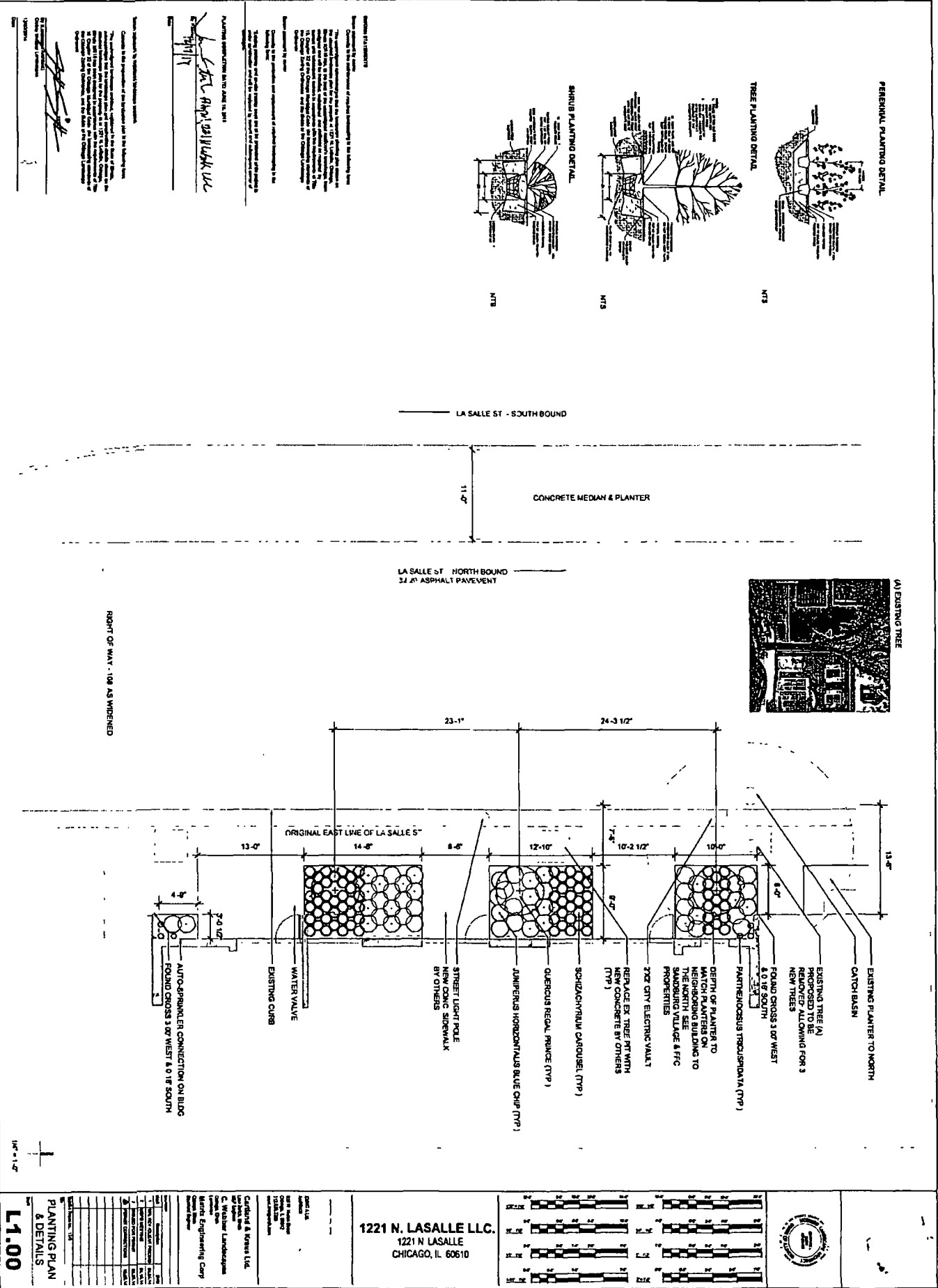

PLANTING SPECIFICATIONS

1. All trees to be planted in the ground and not in containers.

2. All trees to be planted in the ground and not in containers.

3. All trees to be planted in the ground and not in containers.

4. All trees to be planted in the ground and not in containers.

5. All trees to be planted in the ground and not in containers.

6. All trees to be planted in the ground and not in containers.

7. All trees to be planted in the ground and not in containers.

8. All trees to be planted in the ground and not in containers.

9. All trees to be planted in the ground and not in containers.

10. All trees to be planted in the ground and not in containers.

PLANTING SPECIFICATIONS (CONT.)

11. All trees to be planted in the ground and not in containers.

12. All trees to be planted in the ground and not in containers.

13. All trees to be planted in the ground and not in containers.

14. All trees to be planted in the ground and not in containers.

15. All trees to be planted in the ground and not in containers.

16. All trees to be planted in the ground and not in containers.

17. All trees to be planted in the ground and not in containers.

18. All trees to be planted in the ground and not in containers.

19. All trees to be planted in the ground and not in containers.

20. All trees to be planted in the ground and not in containers.

PLANTING SPECIFICATIONS (CONT.)

21. All trees to be planted in the ground and not in containers.

22. All trees to be planted in the ground and not in containers.

23. All trees to be planted in the ground and not in containers.

24. All trees to be planted in the ground and not in containers.

25. All trees to be planted in the ground and not in containers.

26. All trees to be planted in the ground and not in containers.

27. All trees to be planted in the ground and not in containers.

28. All trees to be planted in the ground and not in containers.

29. All trees to be planted in the ground and not in containers.

30. All trees to be planted in the ground and not in containers.

PLANTING SPECIFICATIONS (CONT.)

31. All trees to be planted in the ground and not in containers.

32. All trees to be planted in the ground and not in containers.

33. All trees to be planted in the ground and not in containers.

34. All trees to be planted in the ground and not in containers.

35. All trees to be planted in the ground and not in containers.

36. All trees to be planted in the ground and not in containers.

37. All trees to be planted in the ground and not in containers.

38. All trees to be planted in the ground and not in containers.

39. All trees to be planted in the ground and not in containers.

40. All trees to be planted in the ground and not in containers.

PLANTING SPECIFICATIONS (CONT.)

41. All trees to be planted in the ground and not in containers.

42. All trees to be planted in the ground and not in containers.

43. All trees to be planted in the ground and not in containers.

44. All trees to be planted in the ground and not in containers.

45. All trees to be planted in the ground and not in containers.

46. All trees to be planted in the ground and not in containers.

47. All trees to be planted in the ground and not in containers.

48. All trees to be planted in the ground and not in containers.

49. All trees to be planted in the ground and not in containers.

50. All trees to be planted in the ground and not in containers.

PLANTING SPECIFICATIONS (CONT.)

51. All trees to be planted in the ground and not in containers.

52. All trees to be planted in the ground and not in containers.

53. All trees to be planted in the ground and not in containers.

54. All trees to be planted in the ground and not in containers.

55. All trees to be planted in the ground and not in containers.

56. All trees to be planted in the ground and not in containers.

57. All trees to be planted in the ground and not in containers.

58. All trees to be planted in the ground and not in containers.

59. All trees to be planted in the ground and not in containers.

60. All trees to be planted in the ground and not in containers.

PLANTING SPECIFICATIONS (CONT.)

61. All trees to be planted in the ground and not in containers.

62. All trees to be planted in the ground and not in containers.

63. All trees to be planted in the ground and not in containers.

64. All trees to be planted in the ground and not in containers.

65. All trees to be planted in the ground and not in containers.

66. All trees to be planted in the ground and not in containers.

67. All trees to be planted in the ground and not in containers.

68. All trees to be planted in the ground and not in containers.

69. All trees to be planted in the ground and not in containers.

70. All trees to be planted in the ground and not in containers.

1221 N. LASALLE LLC.
1221 N LASALLE
CHICAGO, IL 60610

PLANTING PLAN & DETAILS

L1.00

1221 N. LASALLE LLC.
1221 N LASALLE
CHICAGO, IL 60610

1221 N. LASALLE LLC.
1221 N LASALLE
CHICAGO, IL 60610

1221 N. LASALLE LLC.
1221 N LASALLE
CHICAGO, IL 60610

1221 N. LASALLE LLC.
1221 N LASALLE
CHICAGO, IL 60610

1221 N. LASALLE LLC.
1221 N LASALLE
CHICAGO, IL 60610