



Office of the Chicago City  
Clerk



Or2011-679

Office of the City Clerk

City Council Document Tracking Sheet

<b>Meeting Date:</b>	7/6/2011
<b>Sponsor(s):</b>	Osterman, Harry (48)
<b>Type:</b>	Order
<b>Title:</b>	Issuance of Sign(s)/Signboard(s) at 4920 N Kenmore Ave
<b>Committee(s) Assignment:</b>	Committee on Zoning, Landmarks and Building Standards

Committee on Buildings

(Signs)

**ORDERED, That the Commissioner of Buildings is hereby directed to issue a sign permit to: (Contractor's name and address)**

North Shore Sign / attn: Skip Spanjer

1925 Industrial Drive

Libertyville, IL 60048

847-816-7020 (T) / 847-816-7145 (F)

**for the erection of a sign / signboard over 24 feet in height and / or over 100 square feet (in area of one face) at: (Business Address)**

Mid America HealthCare and Rehabilitation Centre

4920 N. Kenmore Ave.

(Zoning RT-4)

Dimensions: Length 12'-0" Height 12'-5"

Height above grade / roof to top of sign 36'

TOTAL SQUARE FOOT AREA 150

Such Sign (s) shall comply with all applicable provision of Chapter 194A of the Chicago Zoning Ordinance and all other Applicable provisions of the Municipal Code of the City of Chicago Governing the construction and maintenance of outdoor signs, Sign boards and structures.

  
Harry Osterman

Alderman,

48<sup>th</sup> Ward

## OWNERS LETTER OF APPROVAL

5-19-11

RE: Sign Permit Applications

TO: City of Chicago  
City Hall  
121 N. LaSalle St. / Room 905  
Chicago, IL 60602

Site: Mid America Healthcare and  
Rehabilitation Centre  
4920 N. Kenmore Ave.  
Chicago, IL 60640-3710

Attn: Department of Buildings

I approve North Shore Sign drawings # 09173 page 1, dated - rev. 5-5-11.

North Shore Sign will furnish install Sign A: One (1) new set of non-illuminated, cutout letters and logo 12'-5" x 12'-2" reading: Logo "Mid America HEALTHCARE AND REHABILITATION CENTRE". Sign located on the South elevation.

Owner-Landlord: Name Printed: MID-AMERICA CONVALESCENT CENTERS, INC.

Signature: 

Owners Address: 3553 W PETERSON AVE

SUITE 300

CHICAGO, IL 60659

Phone #: 773-463-1313

PIN # of site 14-08-410-020-0000  
4918 N. Kenmore Ave.



CITY OF CHICAGO

# DEPARTMENT OF BUILDINGS

## Aldermanic Acknowledgment Letter

TO: Department of Buildings  
121 North LaSalle Street, Room 900  
Chicago, IL 60602

DATE: 6/24, 20 11

I am aware of the application for a building permit at the following address. I have no objection to its issuance.

Address: 4920 N. KENMORE AVE

Date of Application: 6/24/11

Type of Permit: Sign Permit

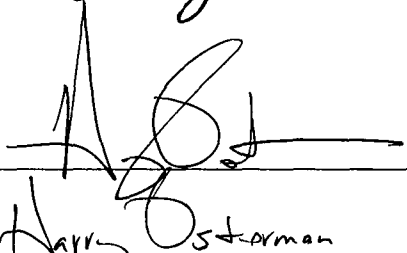
Signed:   
Harry Osterman  
(Alderman's full name, printed or typed)

Ward: 48  
Telephone: (773) 784-5277



"Quality Signage Since 1930"

### NORTH SHORE SIGN

**SKIP SPANJER**  
Sales Manager

1925 Industrial Drive  
Libertyville, Illinois 60048  
(847)816-7020  
fax (847)816-7145  
cell (262)620-8614  
skips@northshoresigns.com

Richard M. Daley, Mayor  
City of Chicago



ZONING SIGN PERMIT APPLICATION  
DEPARTMENT OF ZONING  
CITY OF CHICAGO  
OFFICE OF ZONING ADMINISTRATOR

APPLICATION FOR: North Shore Sign Co., Inc., Libertyville, IL 60048

Sign Location: Street Address 4920 N. Kenmore Ave.

Zoning District RT-4

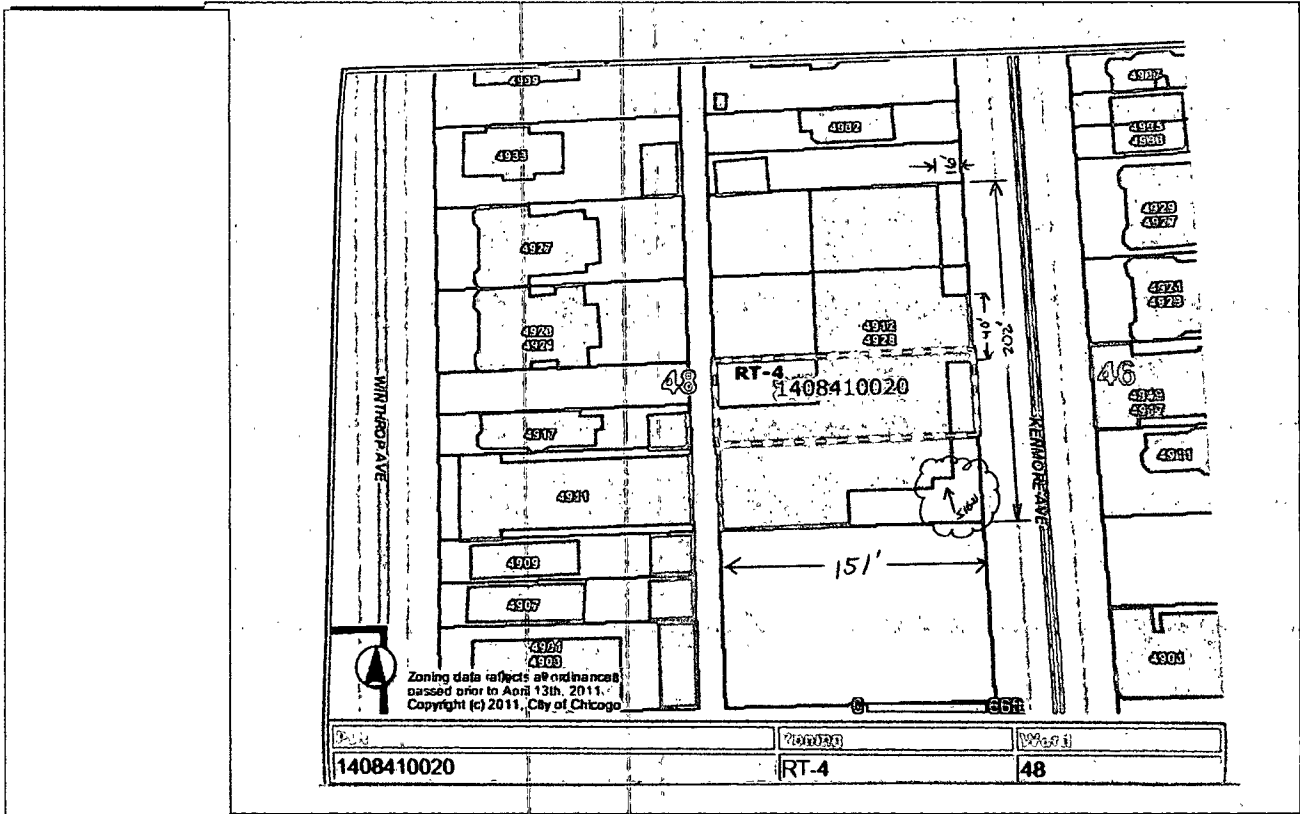

1. Height above Curb Level 36 ft. \_\_\_\_\_ in.
  2. Non-Illuminated X Illuminated \_\_\_\_\_ Flashing \_\_\_\_\_ Moving \_\_\_\_\_
  3. Gross Area of Sign 150 sq. ft.
  4. Total area of all signs on lot 195 sq. ft.
  5. Projection over public way 0 ft 0 in.
  6. Type of Sign: Business ID. X Advertising \_\_\_\_\_
  7. Distance from Expressway (within 1000 ft) N/A ft.
- Is the sign visible from expressway Yes or **(No)** (circle one)
8. Distance from Park N/A ft.
  9. Distance from residential zone 0 ft.

ALL OF THE ABOVE QUESTIONS MUST BE ANSWERED FULLY

SIGNATURE \_\_\_\_\_

NOTE: In B6-6 and B6-7 Districts, exact sign copy must be indicated.

For Roof Signs, Indicate height above grade \_\_\_\_\_ ft.



Southeast elevation



East elevation

SITE: 4920 N. Kenmore Ave.



Word # 48  
Zoning RT-4  
Sign

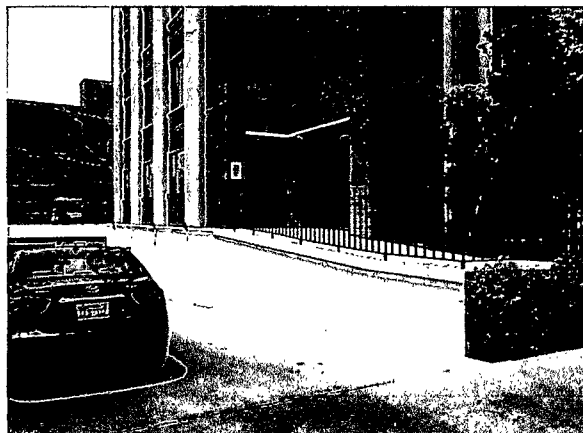

Survey by:  
North Shore  
Sign



APPROVAL NUMBER	PERMIT NUMBER	ANNUAL FEE	WORK CODE	DRAWINGS <input checked="" type="checkbox"/> YES
				ATTACHED <input type="checkbox"/> NO

**CONTRACTOR WILL FILL OUT BLANKS BELOW**

DATE OF APPLICATION 6/24/11

ADDRESS OF SIGN (NUMBER, DIRECTION AND STREET NAME) 60640 4920 N. KENMORE AVE

BUILDING \_\_\_\_\_ ORIGINAL PERMIT NUMBER \_\_\_\_\_

TYPE OF PERMIT:  NEW SIGN,  CHANGE OF FACE,  REPAIR,  ADDITIONAL SEGMENT,  REHANG,  REMODEL

PAYER OF ANNUAL INSPECTION FEE NATHAN DAVIS

ADDRESS 4920 N. KENMORE AVE

CITY CHICAGO STATE IL ZIP CODE 60640

SIGN MANUFACTURER NORTH SHORE SIGN

ADDRESS WHERE SIGN CAN BE SEEN PRIOR TO ERECTION \_\_\_\_\_

TICKET NUMBER 0 FORM# 1017B HEINSPECTION CONTROL NUMBER \_\_\_\_\_

TYPE OF SUPPORT FOR SIGN:  BEAM,  POLE,  GROUND STRUCTURE,  CANOPY,  BUILDING,  ROOF

SIGN BOARD SUPPORT MEMBERS:  WOOD,  STEEL

TYPE OF SIGN:  PROJECTING OVER PUBLIC WAY,  ROOF,  FLAT,  SIGNBOARD,  PROJECTING OVER PRIVATE PROPERTY

LENGTH	FT. <u>12</u>	IN. <u>0</u>	HEIGHT	FT. <u>12</u>	IN. <u>5</u>
AREA	SQ. FT. <u>150</u>		WEIGHT	LBS. <u>50</u>	
SIGN HEIGHT ABOVE GRADE/ <u>ROOF</u>				FT. <u>36</u>	

SHAPE OF SIGN:  REGULAR,  IRREGULAR

SIGN WILL READ: LOGO - MID AMERICA HEALTHCARE AND REHABILITATION CENTRE

NO. OF LAMPS \_\_\_\_\_ TOTAL WATTAGE \_\_\_\_\_

INCANDESCENT,  NEON,  FLUORESCENT,  OTHER

NO. OF BALLASTS/TRANSFORMERS \_\_\_\_\_

INPUT OF TRANSFORMERS \_\_\_\_\_

WILL FEEDERS BE INSTALLED BY YOU?  YES,  NO

WILL CONNECTIONS BE MADE TO CUSTOMER'S LEAD BY YOU?  YES,  NO

TYPE OF SWITCH:  KNIFE,  SPECIAL

LOCATION OF SWITCH:  OUTSIDE,  INSIDE HEALTHCARE AND

SIGN LOCATION COPY: "MID AMERICAN REHABILITATION CENTRE"  
CUTOUT INDIVIDUAL LETTERS  
42"-31 1/2"-12 1/2"-17" 10" x 1" deep  
SINTRA SPRAYED ACRYLIC POLYURETHANE  
WHITE. STEEL PIN MOUNT TO WALL.

ANNUAL FEE \_\_\_\_\_

CONSTRUCTION FEE \_\_\_\_\_

1017 B FEE \_\_\_\_\_

TOTAL FEE \_\_\_\_\_

The undersigned certify that the statements in this application are true and correct and that all work done under the proposed permit will conform to the Requirements of the Chicago Municipal Code.

REG. NO.	BOND NO.	REG. NO. <u>N9210</u>
ELEC. CONTR.	SIGN ERECTOR <u>NORTH SHORE SIGN CO</u>	
ADDRESS <u>N/A</u>	ADDRESS <u>1925 INDUSTRIAL DR., LIBERTYVILLE, IL</u>	
SUPERVISOR SIGNATURE:	SIGNATURE	

The permit issued on this application will authorize only signs here applied for. If other signs are to be erected they must be covered by additional permits.

City of Chicago  
Richard M. Daley, Mayor



Department of Construction and Permits  
John A. Roberson, Executive Director

**ZONING INFORMATION**

**ELECTRICAL INSPECTION INFORMATION**

TYPE OF BUSINESS <p style="text-align: center; font-size: 1.2em;"><i>RESIDENT GROUP LIVING</i></p>	SIGN BOND REQUIRED? <input type="checkbox"/> YES <input checked="" type="checkbox"/> NO
TYPE OF SIGN: <input type="checkbox"/> ADVERTISING <input type="checkbox"/> ILLUMINATED <input checked="" type="checkbox"/> BUSINESS <input type="checkbox"/> FLASHING	COUNCIL ORDER REQUIRED? <input checked="" type="checkbox"/> YES <input type="checkbox"/> NO
TOTAL STREET FRONTAGE OF LOT (IN FEET) <p style="text-align: center; font-size: 1.2em;"><i>202</i></p>	IS SPECIAL PERMISSION REQUIRED FROM CHIEF ELECTRICAL INSPECTOR? <input type="checkbox"/> YES <input checked="" type="checkbox"/> NO
TOTAL AREA OF NEW SIGN (SQ. FT.) <p style="text-align: center; font-size: 1.2em;"><i>150</i></p>	IF YES, ATTACH LETTER OF REQUEST.
TOTAL AREA OF ALL SIGNS ON LOT (SQ. FT.) <p style="text-align: center; font-size: 1.2em;"><i>195</i></p>	TIME STAMP
HEIGHT OF SIGN ABOVE GRADE (TO TOP) <p style="text-align: center; font-size: 1.2em;"><i>36</i></p>	SIGN CLERK _____ APPROVED FOR PERMIT _____
DISTANCE FROM CURB LINE OUTER EDGE DISTANCE FROM STRUCTURE INNER EDGE	REMARKS
DISTANCE FROM:  A. PUBLIC PARK (OVER 10 ACRES) <u>          <i>N/A</i>          </u> B. EXPRESSWAY (IF LESS THAN 1,000 FT.) <u>          <i>N/A</i>          </u> C. RESIDENCE DISTRICT (ADVERTISING SIGNS ONLY) _____	(REMARKS area continues)
IF REPLACEMENT SIGN OR CHANGE OF FACE, WHAT DOES EXISTING SIGN READ? <p style="text-align: center; font-size: 1.5em;"><i>N/A</i></p>	
ZONING (OFFICE USE ONLY)  <input type="checkbox"/> APPROVED <input type="checkbox"/> REJECTED	(REMARKS area continues)





(A) INDIVIDUAL FCO LETTERS  
 1/2" = 1'-0"  
 1" THICK FCO LETTERS / WHITE POLYURETHANE FINISH  
 STUD MOUNTED / 1" SPACERS

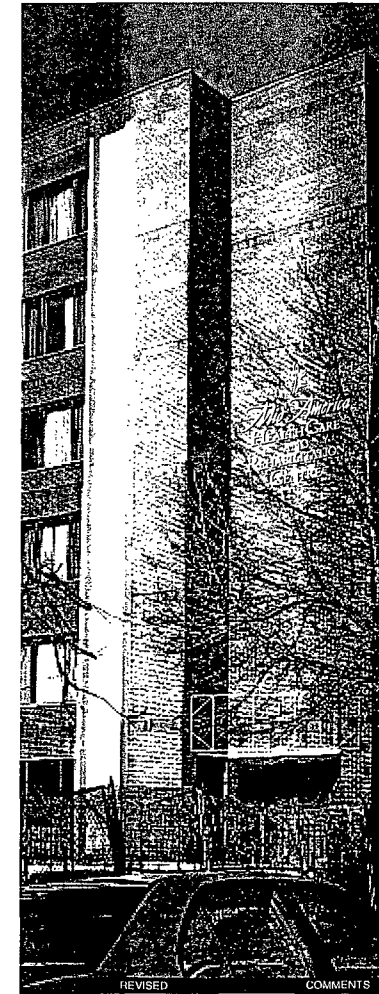
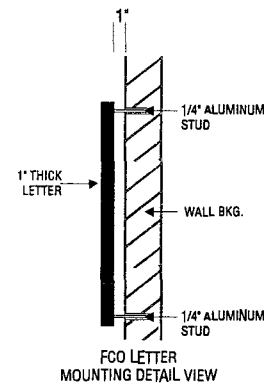

REVISED	COMMENTS
1	5/5/11 remove floods

**N**  
**NORTH SHORE SIGN**

1925 Industrial Drive Libertyville, Illinois 60048 847-816-7020

"Quality Signage Since 1930"



Colors depicted on this drawing are printed simulations to assist in visualizing the design. They do not accurately reflect the actual colors specified.

This design is the exclusive property of North Shore Sign Company Inc., and is the result of the original and creative work of its employees. This drawing is submitted to the respective customer for the sole purpose of consideration of whether or not to purchase this design, or a sign manufactured to this design from North Shore Sign Co. Distribution, use of, or exhibition of this drawing to anyone outside customer's organization, in order to secure quotation, design work, or purchase of a sign either to this design or similar to this design, is expressly forbidden. In the event that such distribution, use or exhibition occurs, North Shore Sign is to be compensated \$1500.00 for time, effort and creative services entailed in creating these plans, as well as any and all legal fees and expenses to enforce its rights. Copyright ©2010 North Shore Sign Company Inc.

MID-AMERICA CARE CENTER 4920 N. KENMORE AVE. CHICAGO	
SCALE	NOTED
DATE	1/17/11
SALESPERSON	SKIP
APPROVED BY:	



(A) INDIVIDUAL FCO LETTERS  
 1/2" = 1'-0"  
 1" THICK FCO LETTERS / WHITE POLYURETHANE FINISH  
 STUD MOUNTED / 1" SPACERS

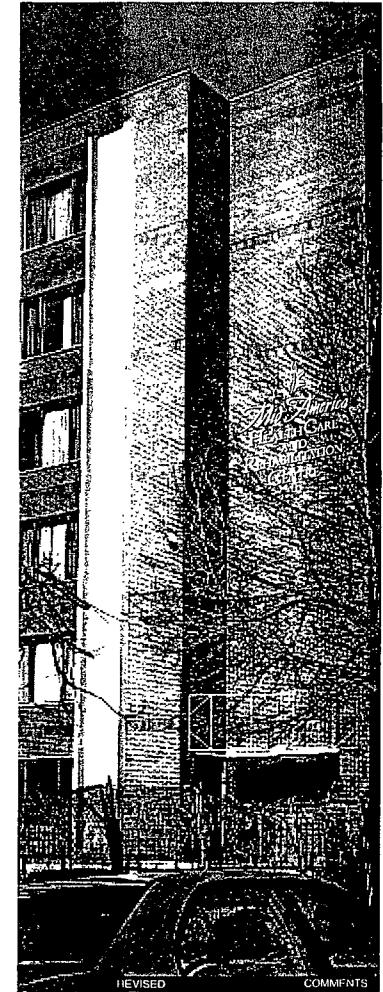
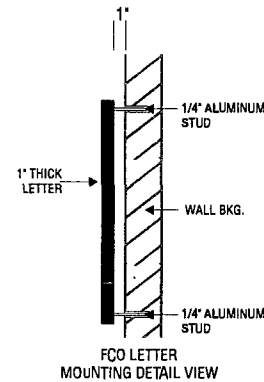

1	5/5/11	remove floods
REVISIONS		
COMMENTS		
MID-AMERICA CARE CENTER 4920 N. KENMORE AVE. CHICAGO		



**NORTH SHORE SIGN**

1925 Industrial Drive Libertyville, Illinois 80048 847-816-7020

"Quality Signage Since 1930"



Colors depicted on this drawing are printed simulations to assist in visualizing the design. They do not accurately reflect the actual colors specified.

This design is the exclusive property of North Shore Sign Company Inc., and is the result of the original and creative work of its employees. This drawing is submitted to the respective customer for the sole purpose of consideration of whether or not to purchase this design, or a sign manufactured to this design from North Shore Sign Co. Distribution, use of, or exhibition of this drawing to anyone outside customer organization, in order to secure quotation, design work, or purchase of a sign other to this design or similar to this design, is expressly forbidden. In the event that such distribution, use or exhibition occurs, North Shore Sign is to be compensated \$1500.00 for time, effort and creative service entailed in creating these plans, as well as any and all legal fees and expenses to enforce its rights. Copyright 2010 North Shore Sign Company Inc.

SCALE	NOTED
DATE	1/17/11
SALESPERSON	APPROVED BY:
SKIP	

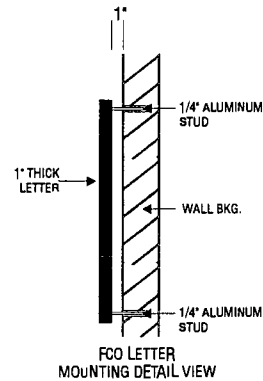

(A) INDIVIDUAL FCO LETTERS  
 1/2" = 1'-0"  
 1" THICK FCO LETTERS / WHITE POLYURETHANE FINISH  
 STUD MOUNTED / 1" SPACERS

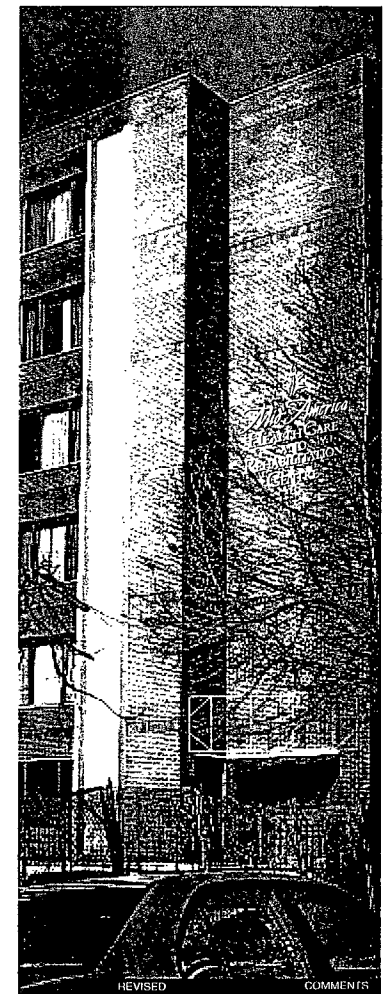

REVISED	COMMENTS
f 5/5/11	remove floods

**N**  
**NORTH SHORE SIGN**  
 1925 Industrial Drive Libertyville, Illinois 60048 847-816-7020  
*"Quality Signage Since 1930"*

Colors depicted on this drawing are printed simulations to assist in visualizing the design. They do not accurately reflect the actual colors specified.

This design is the exclusive property of North Shore Sign Company Inc., and is the result of the original and creative work of its employees. This drawing is submitted to the respective customer for the sole purpose of consideration of whether or not to purchase this design, or a sign manufactured to this design from North Shore Sign Co. Distribution, use of, or extension of this drawing to anyone outside customer organization, in order to secure quotation, design work, or purchase of a sign other to this design or similar to this design, is expressly forbidden. In the event that such distribution, use or extension occurs, North Shore Sign is to be compensated \$1500.00 for time, effort and creative service entailed in creating these plans, as well as any and all legal fees and expense to enforce its rights. Copyright 2010 North Shore Sign Company Inc.

MID-AMERICA CARE CENTER 4920 N. KENMORE AVE. CHICAGO	
SCALE	NOTED
DATE	1/17/11
SALESPERSON	APPROVED BY:
SKIP	