



Office of the Chicago City
Clerk



O2012-888

Office of the City Clerk

City Council Document Tracking Sheet

Meeting Date:	2/15/2012
Sponsor(s):	Reilly, Brendan (42)
Type:	Ordinance
Title:	Grant(s) of privilege in public way for Rosebud-Rush
Committee(s) Assignment:	Committee on Transportation and Public Way

ORDINANCE
ROSEBUD-RUSH
Acct. No. 85994 - 2
Permit No. 1099339

Be It Ordained by the City Council of the City of Chicago:

SECTION 1. Permission and authority are hereby given and granted to ROSEBUD-RUSH, upon the terms and subject to the conditions of this ordinance to maintain and use, as now constructed, ten (10) Light Fixture(s) projecting over the public right-of-way adjacent to its premises known as 55 E. Superior St..

Said Light Fixture(s) at E. Superior measure(s):

Ten (10) at one point eight (1.8) foot in length, point six (.6) feet in width and six point five (6.5) feet above grade level.

The location of said privilege shall be as shown on prints kept on file with the Department of Business Affairs and Consumer Protection and the Office of the City Clerk.

Said privilege shall be constructed in accordance with plans and specifications approved by the Department of Transportation (Division of Project Development).

This grant of privilege in the public way shall be subject to the provisions of Section 10-28-015 and all other required provisions of the Municipal Code of Chicago.

The grantee shall pay to the City of Chicago as compensation for the privilege #1099339 herein granted the sum of one hundred twenty (\$120.00) per annum in advance.

A 25% penalty will be added for payments received after due date.

The permit holder agrees to hold the City of Chicago harmless for any damage, relocation or replacement costs associated with damage, relocation or removal of private property caused by the City performing work in the public way.

Authority herein given and granted for a period of five (5) years from and after 02/07/2012.

Alderman 

Brendan Reilly 42nd Ward

S

Rosebud on Rush
720 N. Rush Street

44' 10"

W

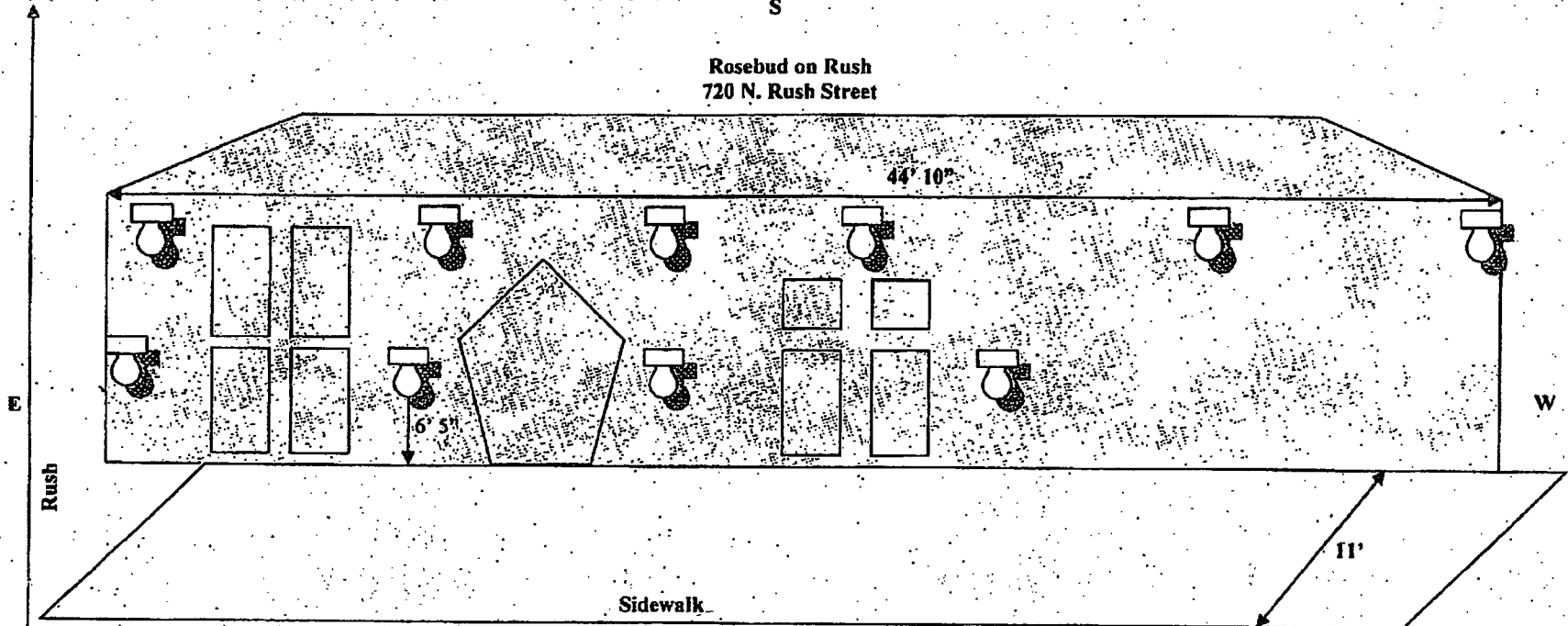

Rush

Sidewalk

11'

Curb

Superior

N



Light Fixtures = 22" x 8"