



# City of Chicago



Or2015-187

Office of the City Clerk

## Document Tracking Sheet

<b>Meeting Date:</b>	3/18/2015
<b>Sponsor(s):</b>	Thomas (17)
<b>Type:</b>	Order
<b>Title:</b>	Issuance of permits for sign(s)/signboard(s) at 7031 S Western Ave
<b>Committee(s) Assignment:</b>	Committee on Zoning, Landmarks and Building Standards

Committee on Zoning, Landmarks, and Building Standards

(Signs)

**ORDERED, That the Commissioner of Buildings is hereby directed to issue a sign permit to: (Contractor's name and address)**

OLYMPIC SIGNS INC.

1130 N. GARFIELD

LOMBARD, IL 60148

**for the erection of a sign/signboard over 24 feet in height and/or over 100 square feet (in area of one face) at: (Business Name & Address)**

WENDY'S - SITE #28

PERMIT #100570287

7031 S. WESTERN AVE.

CHICAGO, IL 60636

**Dimensions: Length** 12' **Height** 16'-6"  
**Height above grade/roof to top of sign** 30'-6"  
**TOTAL SQUARE FOOT AREA:** 198

**Such sign(s) shall comply with all applicable provisions of TITLE 17 of the Chicago Zoning Ordinance and all other applicable provisions of the Municipal Code of the City of Chicago governing the construction and maintenance of outdoor signs, signboards and structures.**



ALDERMAN LATASHA R. THOMAS - WARD 17

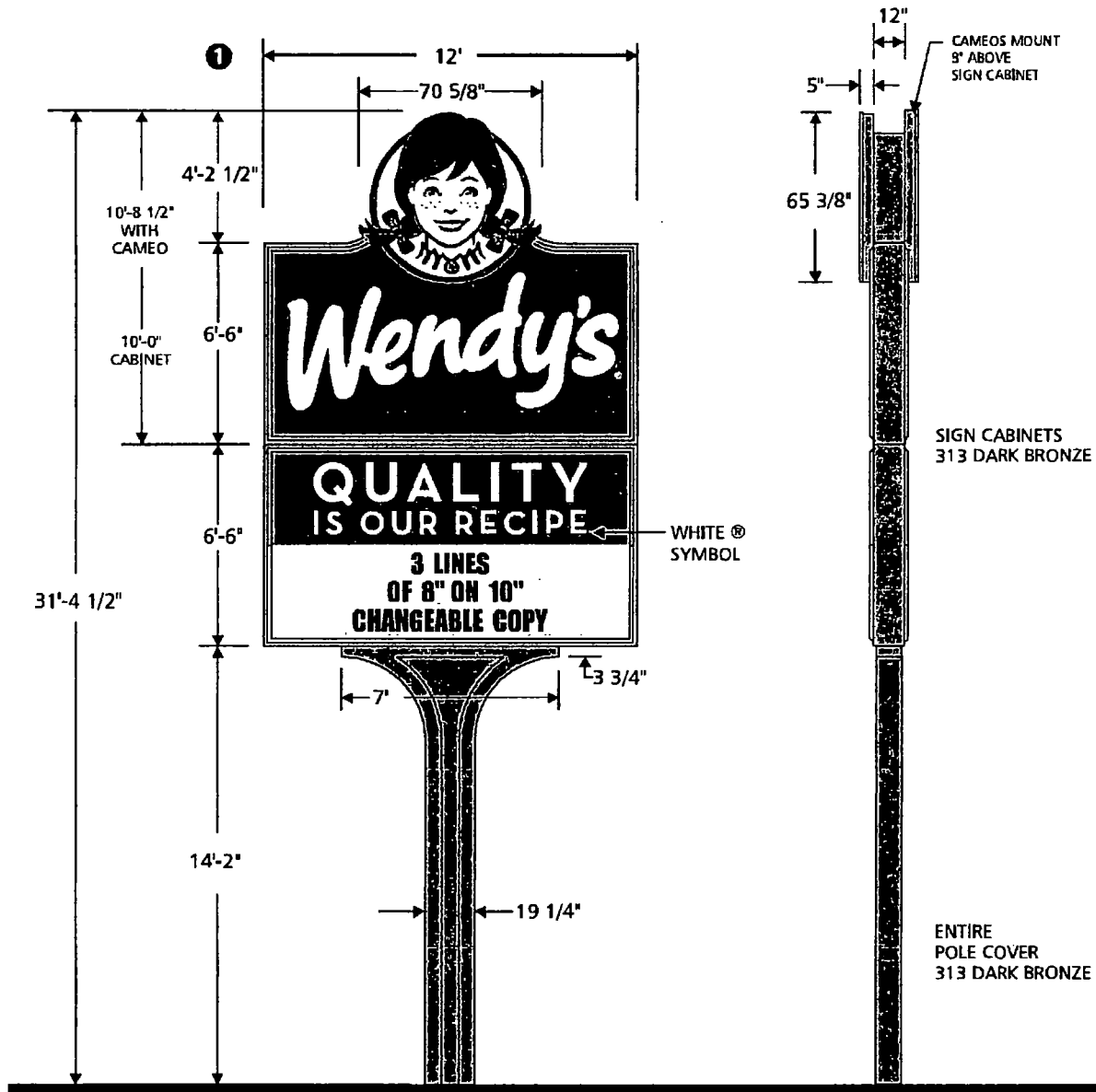

ALL WIRING MEETS NEC 2008 SPECIFICATIONS.  
SIGN TO BE WIRED TO A STANDARD 120 VOLT / 20 AMP CIRCUIT.

THIS SIGN IS INTENDED TO BE INSTALLED IN ACCORDANCE WITH THE REQUIREMENTS OF ARTICLE 610 OF THE NATIONAL ELECTRICAL CODE AND/OR OTHER APPLICABLE LOCAL CODES.  
THIS INCLUDES PROPER GROUNDING AND BONDING OF THE SIGN.

SIGN TYPE	SPECIFICATIONS	COLORS	SIGN SURVEY	ARTWORK
<input checked="" type="checkbox"/> DOUBLE FACE <input checked="" type="checkbox"/> ILLUMINATED <input checked="" type="checkbox"/> GROUND	- 12" 5A ALUMINUM CABINET PAINTED 313 DARK BRONZE. - .150 PAN FORMED EMBOSSED SOLAR GRADE POLYCARBONATE FACES. - FORMED A.B.S. POLE COVER PAINTED 313 DARK BRONZE. - FLUORESCENT ILLUMINATION. CAMEOS - FORMED POLYCARBONATE WITH PRINTED GRAPHICS SECOND SURFACE WITH LED ILLUMINATION. - ALUMINUM RETURNS AND BACKS PAINTED 313 DARK BRONZE.	<input checked="" type="checkbox"/> 313 DARK BRONZE <input checked="" type="checkbox"/> PMS 186 RED <input type="checkbox"/> WHITE <input checked="" type="checkbox"/> PMS 186 RED HAIR <input checked="" type="checkbox"/> PMS 299 BLUE HAIR <input type="checkbox"/> PMS 698 PINK <input checked="" type="checkbox"/> PMS 439 BROWN	<input type="checkbox"/> FACE TRIMS <input type="checkbox"/> FASCIA COLOR <input type="checkbox"/> RADIUS DIM. <input type="checkbox"/> BUILDING DIM. <input type="checkbox"/> FACADE ANGLE <input type="checkbox"/> OTHER	<input checked="" type="checkbox"/> PROVIDED <input type="checkbox"/> REQUIRED If required, customer to provide Custom Sign Center, Inc. with camera ready or appropriate digital file. Please contact your salesperson or Design Staff for appropriate file types.

E122574

custom SIGN Center, Inc. Full Service Sign Company

3200 Valleyview Drive Columbus, OH 43204  
PH 614-279-6700 FX: 614-279-7525

Approval Signatures Required to insure that all spelling, colors, and specifications for sign rendered meets customer & landlord approval's.

FILENAME: U0601-1A-WP171 REV# SCALE: 3/16" = 1' DATE: \_\_\_\_\_  
 DATE: 3/20/14 REV. DATE: DGNR: RTK SALES: T. SHEEHY CUSTOMER: \_\_\_\_\_ DATE: \_\_\_\_\_  
 LANDLORD: \_\_\_\_\_ DATE: \_\_\_\_\_

This original design and all information herein are the property of Custom Sign Center, Inc. Artwork is subject to return if not purchased. Any unauthorized use is forbidden.

Council Order Req.

**STANDARD INSTALLATION DETAIL**

**DESIGN CRITERIA**

90 M.P.H. WIND LOAD / EXPOSURE B / 2011 OBC  
 SOIL COMPACTNESS=2,000 PSF  
 CONCRETE FOUNDATION=3,000 PSI-5 BAG, 28 DAY MIN.  
 (IF LOCAL CONDITIONS REQUIRE ADJUSTMENTS TO THE  
 ABOVE CRITERIA IT IS THE RESPONSIBILITY OF THE SIGN  
 INSTALLER TO OBTAIN ADEQUATE ENGINEERING SPECIFICATIONS)

**ELECTRICAL DETAIL**

2 CIRCUITS  
 TOP CABINET - 10AMPS  
 BOTTOM CABINET - 8.4 AMPS  
 TOTAL 18.4 AMPS

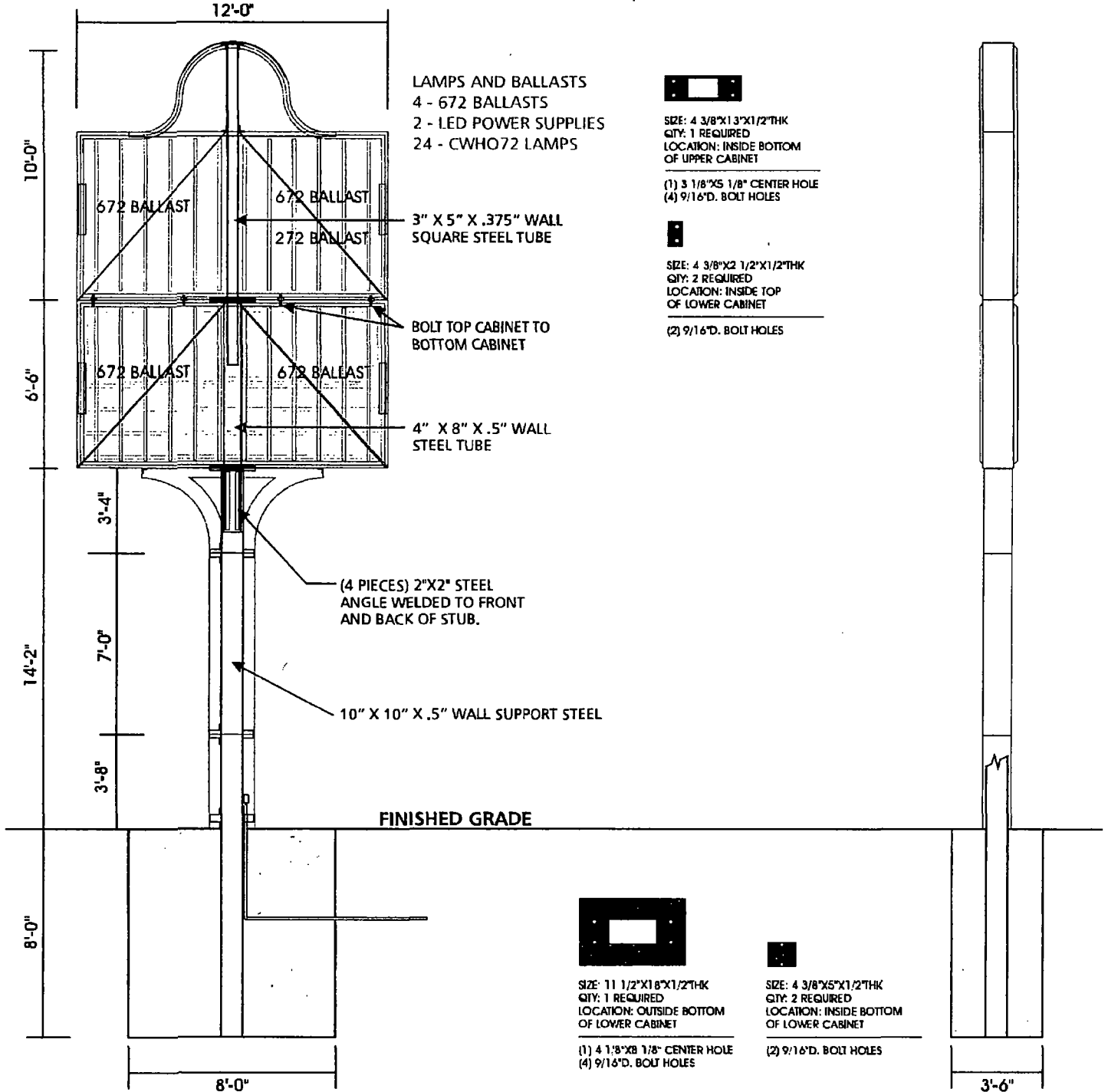

**NOTE: ENGINEER STAMP NEW PYLON CABINETS & CONNECTION ONLY**

**CUSTOM SIGN CENTER, INC. 3200 VALLEYVIEW DRIVE COLUMBUS, OHIO 43204 800-522-2934**

**Wendy's Site #00000**  
 7031 S. WESTERN AVE.  
 CHICAGO, IL 60636

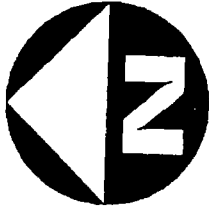

SCALE: 1" = 50'

**SIGN KEY**

- ① Pylon Sign
- ② Channel Letters
- ③ Channel Letters
- ④ Channel Letters
- ⑤ 9" QIOR
- ⑥ QIOR-PVC62
- ⑦ Thank You Sign
- ⑧ Exit Directional
- ⑨ Exit Directional
- ⑩ Enter Directional
- ⑪ Enter Directional
- ⑫ Pre-Sell
- ⑬ Menu Board
- ⑭ Menu Board

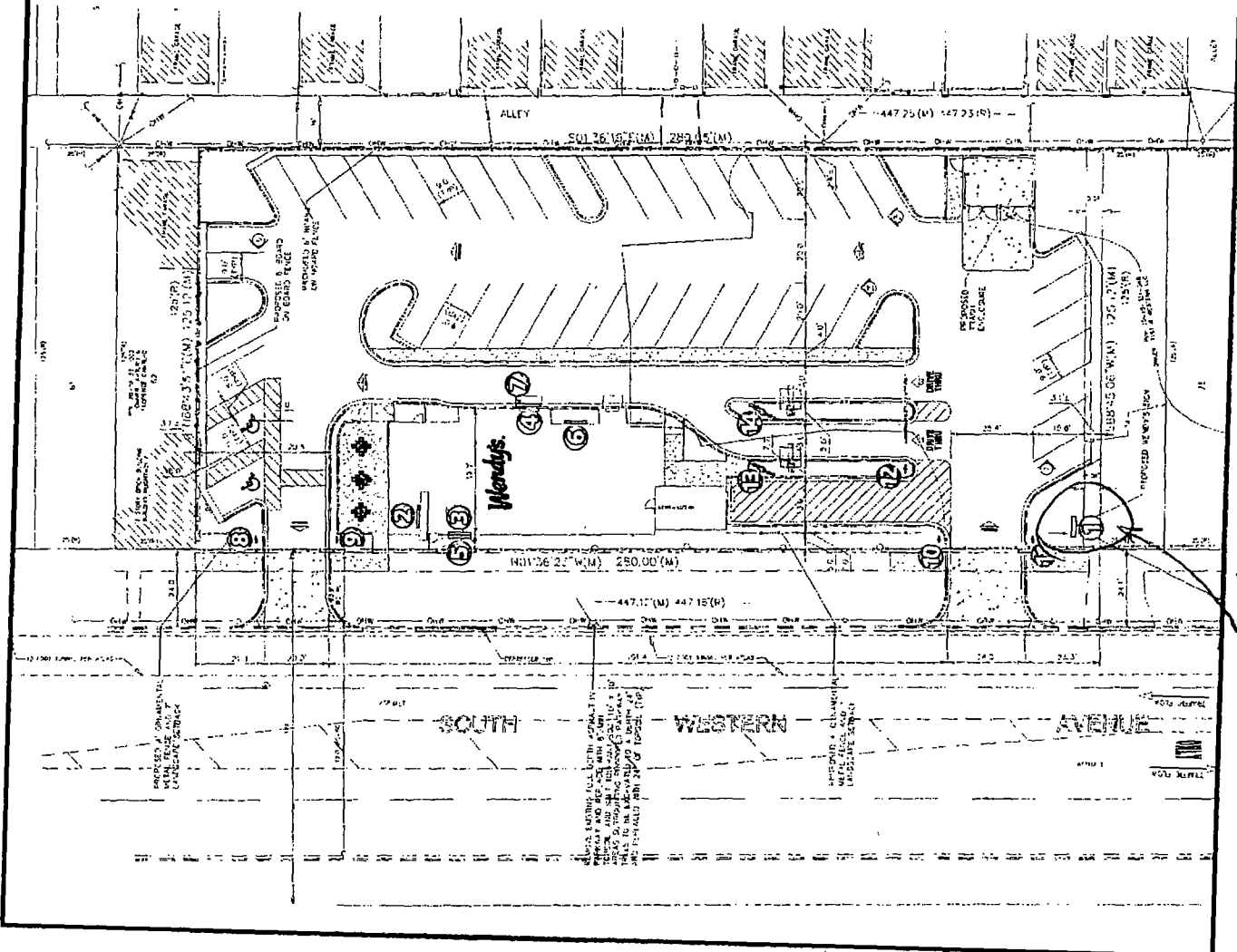

*Sign location*

File Copy



CITY OF CHICAGO

DEPARTMENT OF BUILDINGS

Sign Permit Application

APPROVAL NUMBER	APPLICATION NUMBER 100570287	ANNUAL FEE	WORK CODE	DRAWINGS ATTACHED <input type="checkbox"/> YES <input type="checkbox"/> NO
DATE OF APPLICATION 11/13/2014		TYPE OF SIGN FLAT OR BOX		
ADDRESS OF SIGN 7031 S WESTERN AVE, 60636-		LENGTH	FT 12	IN. 0
BUILDING	ORIGINAL PERMIT NUMBER	HEIGHT	FT 16	IN. 6
TYPE OF PERMIT NEW CONSTRUCTION (SIGN)		AREA	SQ FT. 198	WEIGHT LBS 800
PAYER OF ANNUAL INSPECTION WENDY'S, J.GYLLING 40 SHUMAN BLVD. , STE. 130 NAPERVILLE, IL 60563 (630)305-5574		SIGN HEIGHT ABOVE GRADE/ROOF		FT. 14
SIGN MANUFACTURER CUSTOM SIGN CENTER, INC.		SHAPE OF SIGN IRREGULAR		
ADDRESS WHERE SIGN CAN BE SEEN PRIOR TO ERECTION		SIGN WILL READ WENDY'S QUALITY IS OUR RECIPE		
TICKET NUMBER 0	REINSPECTION CONTROL NUMBER	NO. OF LAMPS 24	TOTAL WATTAGE 352	
TYPE OF SUPPORT FOR SIGN POLE		TYPE OF LAMP FLUORESCENT		
SIGN BOARD SUPPORT MEMBERS OTHER		NO. OF BALLAST/TRANSFORMERS 6	INPUT OF TRANSFORMERS 120	
ANNUAL FEE		CONTRACTOR WILL INSTALL <input checked="" type="checkbox"/> N FEEDERS <input type="checkbox"/> Y CUSTOMER LEADS		
CONSTRUCTION FEE 200.00		TYPE OF SWITCH SPECIAL		
1017 B FEE		LOCATION OF SWITCH OUTSIDE SIGN		
TOTAL FEE 200.00		SIGN LOCATION SOUTHWEST CORNER OF PROPERTY: ILLUMINATED POLE SIGN "WENDY'S QUALITY IS OUR RECIPE" WITH MANUAL CHANGEABLE COPY BOARD.		
AMOUNT PAID 200.00				
BALANCE DUE				

The undersigned certify that the statements in this application are true and correct and that all work done under the proposed permit will conform to the requirements of the Chicago Municipal Code.

ELECT CONTR OLYMPIC SIGNS, INC.	RLG. NO. E69270	BOND NO.	RLG. NO. N91822
ADDRESS 1130 N. GARFIELD LOMBARD, IL 60148	ELECTR	SIGN ERECTOR OLYMPIC SIGNS INC.	SIGNER
SUPERVISOR SIGNATURE		ADDRESS 1130 N. GARFIELD LOMBARD IL, 60148	SIGNATURE

The permit issued on this application will authorize only signs here applied for. If other signs are to be erected they must be covered by additional permits.

City of Chicago  
Rahm Emanuel, Mayor



Department of Buildings  
Felicia Davis, Commissioner