



# City of Chicago



O2016-6828

Office of the City Clerk

## Document Tracking Sheet

<b>Meeting Date:</b>	9/14/2016
<b>Sponsor(s):</b>	Reilly (42)
<b>Type:</b>	Ordinance
<b>Title:</b>	Grant(s) of privilege in public way for Spertus Institute of Jewish Studies - catch basin
<b>Committee(s) Assignment:</b>	Committee on Transportation and Public Way

ORDINANCE  
SPERTUS INSTITUTE OF JEWISH STUDIES  
Acct. No. 266772 - 3  
Permit No. 1124089

*Be It Ordained by the City Council of the City of Chicago:*

SECTION 1. Permission and authority are hereby given and granted to SPERTUS INSTITUTE OF JEWISH STUDIES, upon the terms and subject to the conditions of this ordinance to maintain and use, as now constructed, one (1) Catch Basin(s) under the public right-of-way adjacent to its premises known as 610 S. Michigan Ave..

Said Catch Basin(s) at S. MICHIGAN measure(s):

One (1) at five (5) feet in length, and five (5) feet in width for a total of twenty-five (25) square feet.

The location of said privilege shall be as shown on prints kept on file with the Department of Business Affairs and Consumer Protection and the Office of the City Clerk.

Said privilege shall be constructed in accordance with plans and specifications approved by the Department of Transportation (Office of Underground Coordination) and Department of Water Management.

This grant of privilege in the public way shall be subject to the provisions of Section 10-28-015 and all other required provisions of the Municipal Code of Chicago.

The grantee shall pay to the City of Chicago as compensation for the privilege #1124089 herein granted the sum of four hundred (\$400.00) per annum in advance.

A 25% penalty will be added for payments received after due date.

The permit holder agrees to hold the City of Chicago harmless for any damage, relocation or replacement costs associated with damage, relocation or removal of private property caused by the City performing work in the public way.

Authority herein given and granted for a period of five (5) years from and after 07/26/2016.

Alderman \_\_\_\_\_

  
Brendan Reilly 42nd Ward

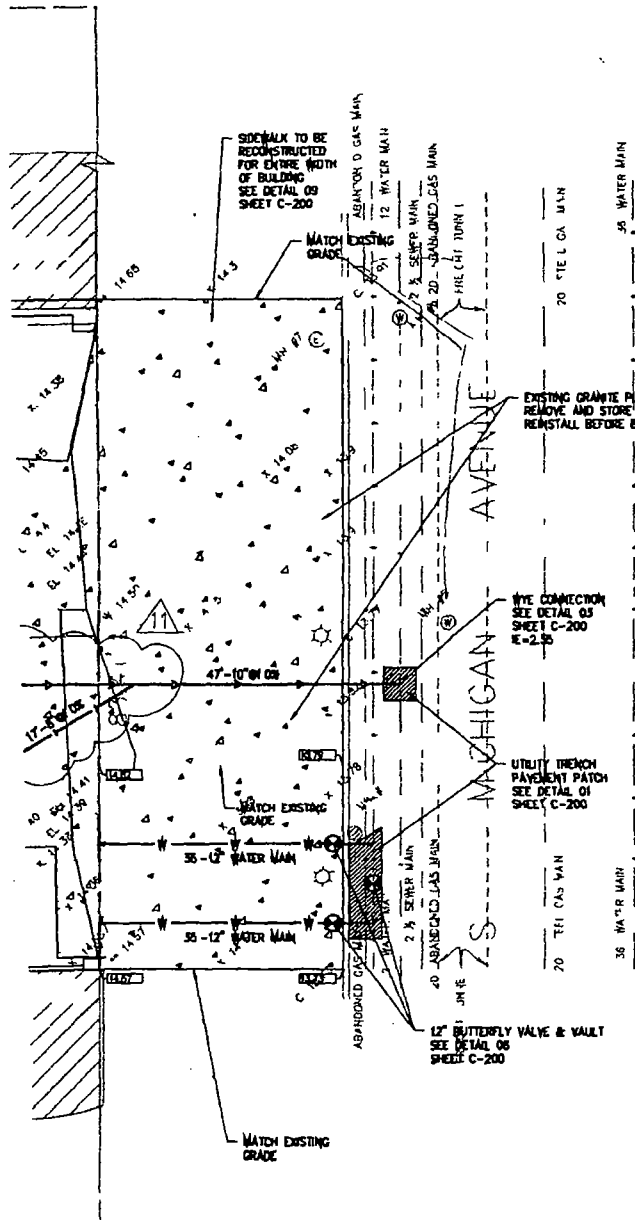
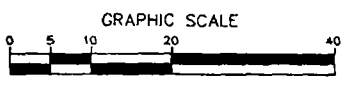

EXISTING CONDITIONS SHOWN ARE IN ACCORDANCE WITH THE TOPOGRAPHIC SURVEY SUPPLIED BY GREMLEY & BIEDERMANN INC AN ILLINOIS CORPORATION. EXISTING CONDITIONS ARE SHOWN IN PARTIAL TONE PRINTING.

EXISTING GRANITE PLANTERS REMOVE AND STORE DURING CONSTRUCTION. REINSTALL BEFORE BUILDING OPENING.

WYE CONNECTION SEE DETAIL OF SHEET C-200 E-2.35

UTILITY TRENCH PAVEMENT PATCH SEE DETAIL OF SHEET C-200

12" BUTTERFLY VALVE & VAULT SEE DETAIL OF SHEET C-200

**LEGEND**

DESCRIPTION	EXISTING	PROPOSED
FLARED END SECTION	—	—
FIRE HYDRANT	—	—
SECT	—	—
CATCH BASIN	—	—
MANHOLE	—	—
POST INDICATOR VALVE	—	—
BOLLARD (GUARDPOST)	—	—
WALL	—	—
VALVE	—	—
UTILITY POLE	—	—
LIGHT	—	—
ELECTRICAL HANDHOLE	—	—
CHAIN LINK FENCE	—	—
BARBURY SEWER	—	—
STORM SEWER	—	—
SEWER	—	—
TELEPHONE	—	—
ELECTRIC	—	—
GAS	—	—
CONTOUR LINE	—	—
FLYING OR PROP LINE	—	—
EDGE OF PAVEMENT	—	—
CONCRETE BARRIER CURB	—	—
CONCRETE CURB & GUTTER	—	—
GROUND GRADE	—	—
PAVEMENT GRADE	—	—
FLOW ARROW	—	—
STRUCTURE NUMBER	—	—
COORDINATE LOCATION	—	—
COLUMN LINE DESIGNATION	—	—
SILT FENCE	—	—
STRAP BALE	—	—
SEWAGE BASIN RISER	—	—

**OWNER/PROJECT ADDRESS:**  
**SPERTUS INSTITUTE OF JEWISH STUDIES**  
 615 South Michigan Avenue, Chicago IL 60605

**PROJECT MANAGEMENT:**  
**INST PROJECT MANAGEMENT**  
 1 East Jackson Boulevard, Chicago IL 60604  
 Tel 312 362 6800 Fax 312 362 5807

**U S EQUITIES DEVELOPMENT**  
 20 North Michigan Avenue, Chicago IL 60602  
 Tel 312 491 7300 Fax 312 491 8254

**ARCHITECT OF RECORD:**  
**KRUECK + SEXTON**  
 221 West Erie, Chicago IL 60610  
 TEL 312 767 0000 FAX 312 767 8116

**ASSOCIATED ARCHITECT:**  
**VOA**  
 224 North Michigan Avenue, Chicago IL 60604  
 TEL 312 534 1400 FAX 312 534 5412

**GENERAL CONTRACTOR:**  
**WE O'NEIL**  
 2751 North Diversey Avenue, Chicago IL 60640  
 Tel 773 755 1811 Fax 773 527 4784

**CONSULTANTS:**

**A. EPSTEIN AND SONS INTERNATIONAL**

**EPSTEIN**

810 N. FLATION ST  
 CHICAGO  
 ILLINOIS  
 60611 189

CHICAGO  
 NEW YORK  
 LOS ANGELES  
 BOSTON  
 TEL AVIV  
 TOKYO

TEL 312 54 9100  
 FAX 312 538 1211  
 website .com

NO	DATE	DESCRIPTION
1	08 AUG 2006	BULLETIN #11
2	23 JUNE 2006	BULLETIN #9
3	02 MAY 2006	ISSUED FOR SEWER PERMIT
4	30 JAN 2006	100% CD (FOR GMP-2)
5	23 DEC 2005	FOUNDATION CONSTRUCTION
6	15 DEC 2005	BUILDING PERMIT
7	18 OCT 2005	FOUNDATION PERMIT REVISION
8	01 AUG 2005	50% CD
9	24 JUNE 2005	25% CD (FOR COORDINATION)
10	21 APR 2005	FOUNDATION PERMIT

**REVISIONS**

**KEY SECTION**

**SHEET TITLE**

**SITE PLAN**

<b>DRAWN BY:</b> B MARCHAL	<b>SHEET NO</b>  <b>C-100</b>
<b>PROJECT NO</b> 0303	
<b>CHECKED BY:</b> D HILTY	
<b>SCALE</b> AS STATED	
<b>DATE:</b> 1.14.05	