



City of Chicago



Or2015-515

Office of the City Clerk

Document Tracking Sheet

Meeting Date:	9/24/2015
Sponsor(s):	Ervin (28)
Type:	Order
Title:	Issuance of permits for sign(s)/signboard(s) at 1939 W 13th St
Committee(s) Assignment:	Committee on Zoning, Landmarks and Building Standards

Committee on Zoning, Landmarks, and Building Standards

(Signs)

ORDERED, That the Commissioner of Buildings is hereby directed to issue a sign permit to: (Contractor's name and address)

ASA Signage Innovations
2630 West Bradley Place, Suite C
Chicago, Illinois 60618

for the erection of a sign/signboard over 24 feet in height and/or over 100 square feet (in area of one face) at: (Business Name & Address)

Easter Seals Metropolitan Chicago
1939 West 13th Street
Chicago, Illinois 60608

Dimensions: Length 180" Height 300"
Height above grade/roof to top of sign 149 5/16" and 47 23/32"
TOTAL SQUARE FOOT AREA: 375 square feet

Such sign(s) shall comply with all applicable provisions of TITLE 17 of the Chicago Zoning Ordinance and all other applicable provisions of the Municipal Code of the City of Chicago governing the construction and maintenance of outdoor signs, signboards and structures.

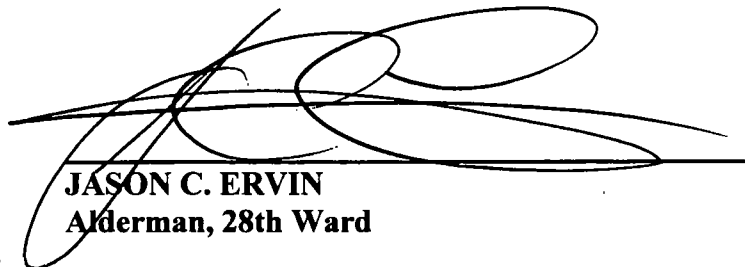
JASON C. ERVIN
Alderman, 28th Ward

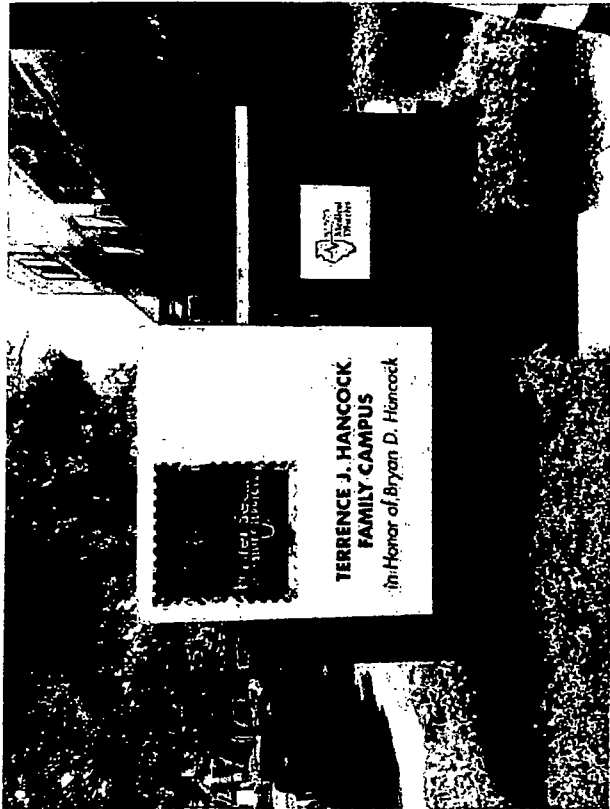
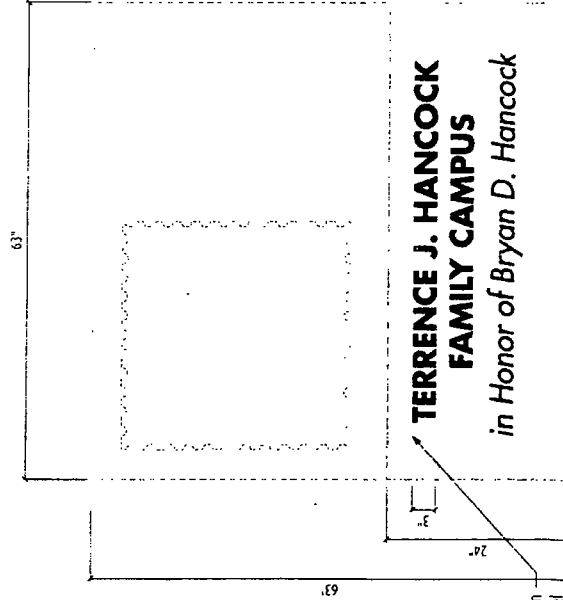

PHOTO RENDERING



fabricated aluminum "bump-out" panel

TYPICAL VIEW
scale: 3/4" = 1'-0"
From: 013 01 2013 013 (2 1/2 sheets)

END VIEW
scale: 3/4" = 1'-0"



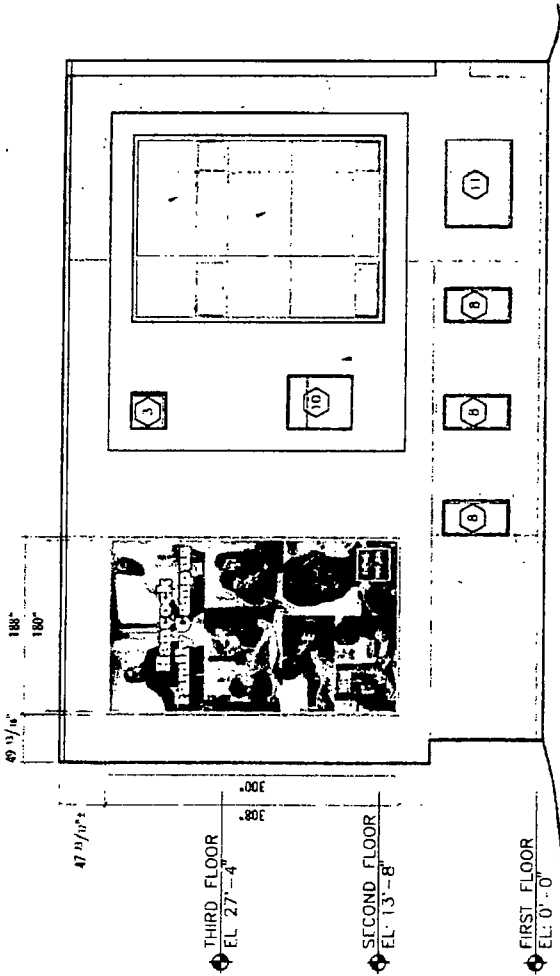

WEST ELEVATION VIEW
SCALE: 1/32" = 1'-0"

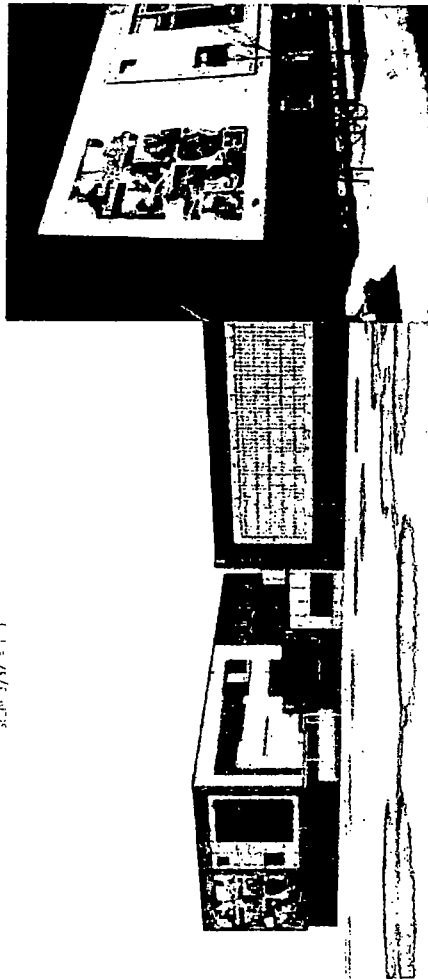

25'-8" 308"

25'-0" 300"

PHOTO: JAMES L. COOPER

TYPICAL VIEW
SCALE: 1/32" = 1'-0"



36"
(9'-0")



PLAQUE PHOTO RENDERING (Placeholder artwork shown)
Scale: 1/4" = 1'-0"

(0-2)
24"



> asi | Design Build Services

Kelly Anne Ohde



Metropolitan Chicago

1939 West 13th Street, Suite 300
Chicago, IL 60608
kellyanne.ohde@eastersealschicago.org

O: 312.491.4124
C: 708.670.8992