



City of Chicago



Or2023-7

Office of the City Clerk

Document Tracking Sheet

Meeting Date:	1/18/2023
Sponsor(s):	Waguespack (32)
Type:	Order
Title:	Issuance of permits for sign(s)/signboard(s) at 2131 N Elston Ave - Permit No. 100997460
Committee(s) Assignment:	Committee on Zoning, Landmarks and Building Standards

CITY COUNCIL
COMMITTEE ON ZONING, LANDMARKS AND BUILDING STANDARDS

COUNCIL ORDER

RE: Approval of sign over 100 square feet in area or over 24 feet above grade

ORDERED, that the City Council hereby approves the following sign application submitted by:

Applicant*: The Green

(* The Applicant is the owner of the real property or the business tenant of the real property. Do not list the sign contractor, sign erector, sign company or advertising entity in the above space.)

This Order approves the following sign in accordance with Municipal Code of Chicago Section 13-20-680:

Address of Sign: 2131 N. Elston Ave. Chicago, IL 606 14

Zoning District: PD1420

DOB Sign Permit Application #: 100997460

Sign Details:

1. On-premise OR Off-premise
2. Static sign OR Dynamic-image display sign
3. Number of sign faces 1
4. Projecting over the public way No (Yes or No) If yes, Public Way Use #: _____
5. Dimensions: Length 15 feet 4 inches Height 9 feet 4 inches
Total square feet in area: 143 feet _____ inches
6. Height above grade: 1 feet _____ inches
7. Elevation (side of building or lot where the sign will be erected): West
8. Name of Sign Contractor/Erector: Olympik Signs

To be legal, such sign shall comply with all provisions of Title 17 of the Chicago Municipal Code ("Zoning Ordinance") and all other provisions of the Municipal Code governing the permitting, construction and maintenance and removal of signs and sign structures. Failure of the applicant and the applicant's successors to comply shall be grounds for invalidation or revocation of the sign permit.

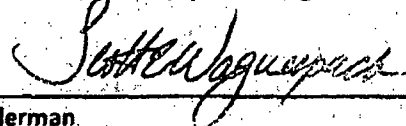
Alderman

37
Ward



CITY OF CHICAGO

DEPARTMENT OF BUILDINGS

Sign Permit Application

APPROVAL NUMBER	APPLICATION NUMBER 100997460	ANNUAL FEE	WORK CODE	DRAWINGS ATTACHED <input type="checkbox"/> YES <input type="checkbox"/> NO
DATE OF APPLICATION 11/23/2022		TYPE OF SIGN FLAT OR BOX		
ADDRESS OF SIGN 2131 N ELSTON AVE, 60614-		LENGTH	FT. 15	IN. 4
BUILDING	ORIGINAL PERMIT NUMBER	HEIGHT	FT. 9	IN. 4
TYPE OF PERMIT NEW CONSTRUCTION (SIGN)		AREA	SQ. FT. 143	WEIGHT
PAYER OF ANNUAL INSPECTION FEE PTACIN, CONNOR 3742 W DIVERSEY AVE, APT 2 CHICAGO, IL 60647 (847)826-6456		SIGN HEIGHT ABOVE GRADE/ROOF		LBS 10
SIGN MANUFACTURER OLYMPIK SIGNS		SHAPE OF SIGN REGULAR		
ADDRESS WHERE SIGN CAN BE SEEN PRIOR TO ERECTION		SIGN WILL READ PLAY YOUR BUCKET LIST COURSES		
TICKET NUMBER 0	REINSPECTION CONTROL NUMBER	NO. OF LAMPS	TOTAL WATTAGE	
TYPE OF SUPPORT FOR SIGN BUILDING		TYPE OF LAMP		
SIGN BOARD SUPPORT MEMBERS OTHER		NO. OF BALLAST/TRANSFORMERS	INPUT OF TRANSFORMERS	
ANNUAL FEE		CONTRACTOR WILL INSTALL <input checked="" type="checkbox"/> FEEDERS <input checked="" type="checkbox"/> CUSTOMER LEADS		
CONSTRUCTION FEE	400.00	TYPE OF SWITCH		
1017 B FEE		LOCATION OF SWITCH		
TOTAL FEE	400.00	SIGN LOCATION INSTALL VINYL ON WEST ELEVATION WINDOW.		
AMOUNT PAID	200.00			
BALANCE DUE	\$ 200.00			
		Check # for Zoning		
		Check # for DCAP		

The undersigned certify that the statements in this application are true and correct and that all work done under the proposed permit will conform to the requirements of the Chicago Municipal Code.

LICENSE #	TGC101361
ELECT CONTR*	CONTRACTOR* OLYMPIK SIGNS INC
ADDRESS	GENCON ADDRESS 1130 NORTH GARFIELD STREET LOMBARD IL, 60148
SUPERVISOR SIGNATURE	SIGNATURE

*IF APPLICABLE

The permit issued on this application will authorize only signs here applied for. If other signs are to be erected they must be covered by additional permits

City of Chicago
Lori E Lightfoot, Mayor



Department of Buildings
Matthew Beudet, Commissioner

TYPE OF BUSINESS COM-ENTERTAIN Other: <u>GOLF SIMULATOR</u> Name: _____ LIC #: _____ Renewal Date: _____	SIGN BOND REQUIRED? <input type="checkbox"/> YES COUNCIL ORDER REQUIRED <input checked="" type="checkbox"/> YES IS SPECIAL PERMISSION REQUIRED FROM CHIEF ELECTRICAL INSPECTOR <input type="checkbox"/> YES IF YES, ATTACH LETTER OF REQUEST
Projects Over: <input checked="" type="checkbox"/> Private Property <input checked="" type="checkbox"/> Public Way Grant Permit <input checked="" type="checkbox"/> Planned Development/Manufactur. PMD/PD# <u>PD1420</u> Zoning District: <u>OTHER</u> Other: <u>PD</u>	TIME STAMP
TYPE OF SIGN: <input type="checkbox"/> ADVERTISING <input type="checkbox"/> ILLUMINATED <input type="checkbox"/> MOVEABLE <input checked="" type="checkbox"/> BUSINESS <input type="checkbox"/> FLASHING	
TOTAL STREET FRONTAGE OF LOT (IN FEET) <u>1,550</u>	
TOTAL AREA OF NEW SIGN (SQ. FT.) <u>143</u>	
TOTAL AREA OF ALL SIGNS ON LOT (SQ. FT.) <u>1,814</u>	
HEIGHT OF SIGN ABOVE GRADE (TO TOP) <u>10ft 4in</u>	
DISTANCE OF CURB LINE OUTER EDGE (ft) <u>10</u> DISTANCE OF STRUCTURE INNER EDGE (ft) <u>10</u>	SIGN CLERK: _____ APPROVED FOR PERMIT: _____
DISTANCE FROM (ft): A. PUBLIC PARK (OVER 10 ACRES) <u>1,000</u> B. EXPRESSWAY (IF LESS THAN 1,000 FT.) <u>1,000</u> C. RESIDENCE DISTRICT (ADVERTISING SIGNS ONLY) <u>580</u>	REMARKS:
IF REPLACEMENT SIGN OR CHANGE OF FACE, WHAT DOES THE EXISTING SIGN READ? Original Payee: _____ Landmark Hold: <input type="checkbox"/> Status: _____	
ZONING (OFFICE USE ONLY)	

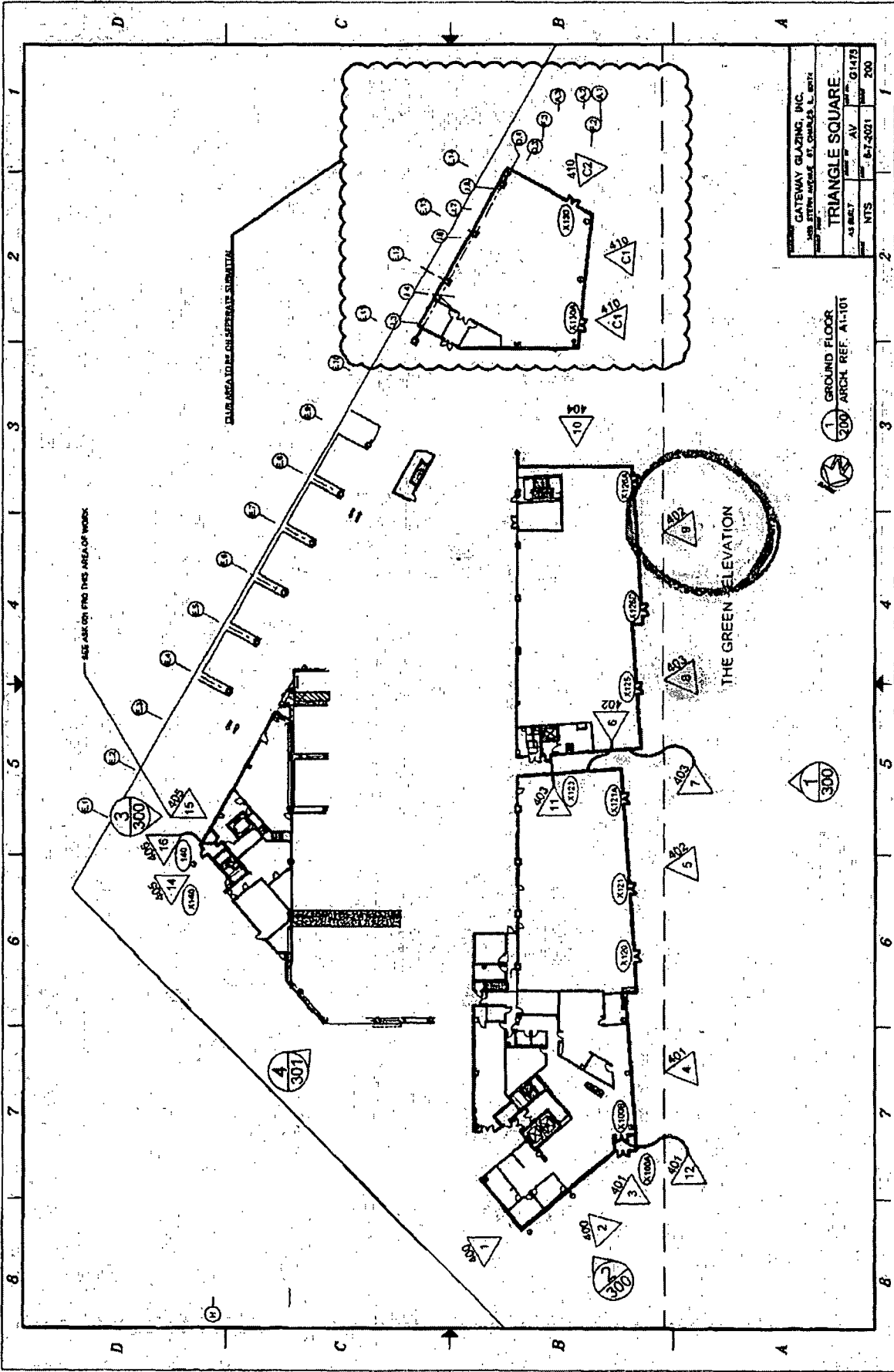

GATEWAY GLAZING, INC.	
100 STEIN AVENUE, ST. CHARLES, L. 04174	
PROJECT: TRIANGLE SQUARE	
DATE: AV	SCALE: 1/4" = 1'-0"
NO: 13-00017	DATE: 11-17-73
NTS	8-7-2021
	200

1 GROUND FLOOR
200 ARCH. REF. A1-101

C

B

A

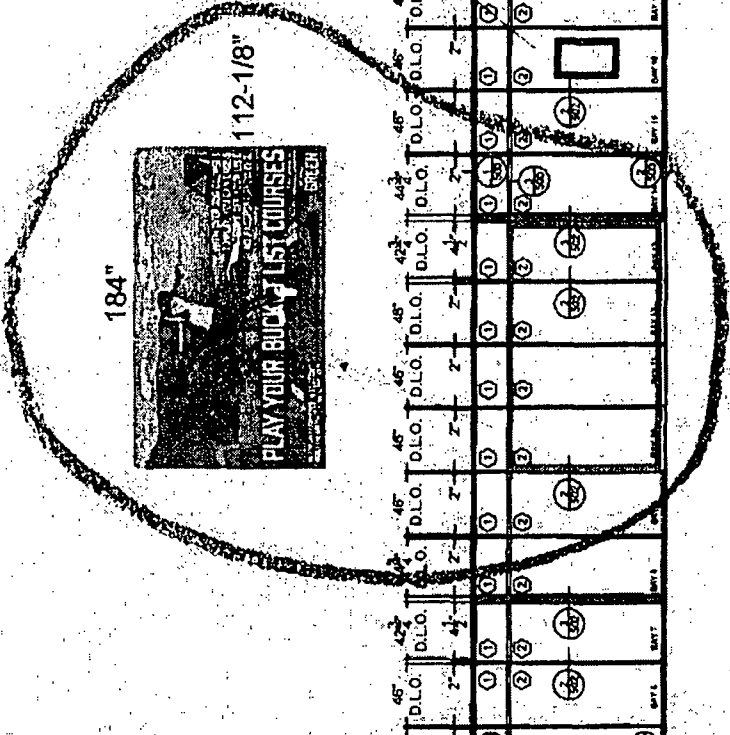
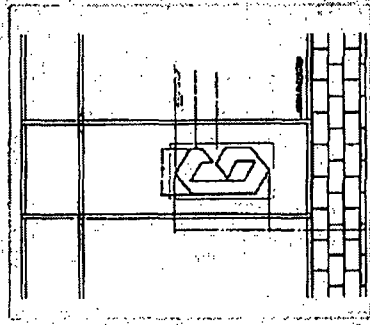
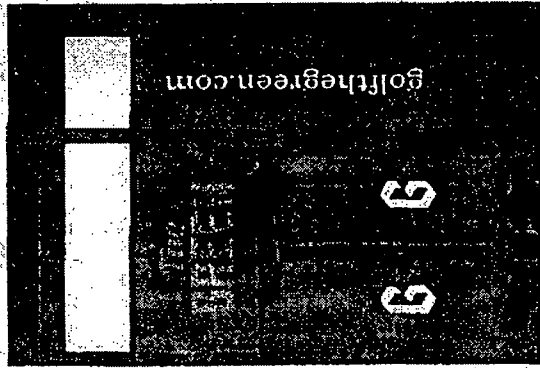

GATEWAY GLAZING, INC. 3455 STERN AVENUE ST CHARLES, IL 60174			
PROJECT NAME: TRIANGLE SQUARE			
AS BUILT	DATE: 3/16	BY: AV	REV: G-1475
QUANTITY: 1	DATE: 6-7-2021	BY: 402	

1

2

3

4

5

ELEVATION MARK
KAWNEER 451T
QTY: 1

