



City of Chicago



O2016-1866

Office of the City Clerk

Document Tracking Sheet

Meeting Date:	3/16/2016
Sponsor(s):	Hopkins (2)
Type:	Ordinance
Title:	Grant(s) of privilege in public way for Clark 800 LLC
Committee(s) Assignment:	Committee on Transportation and Public Way

ORDINANCE
Clark 800 LLC
Acct. No. 401326 - 1
Permit No. 1121821

Be It Ordained by the City Council of the City of Chicago:

SECTION 1. Permission and authority are hereby given and granted to Clark 800 LLC, upon the terms and subject to the conditions of this ordinance to maintain and use, as now constructed, seven (7) Vault(s) under the public right-of-way adjacent to its premises known as 800 N. Clark St..

Said Vault(s) at N. Clark Street measure(s):

One (1) at ninety-three (93) feet in length, and three (3) feet in width for a total of two hundred seventy-nine (279) square feet.

One (1) at ten point two five (10.25) feet in length, and nine (9) feet in width for a total of ninety-two point two five (92.25) square feet.

Said Vault(s) at W. Chicago Avenue measure(s):

One (1) at one hundred fifty-one (151) feet in length, and two point five (2.5) feet in width for a total of three hundred seventy-seven point five (377.5) square feet.

One (1) at twelve point eight three (12.83) feet in length, and eleven point two five (11.25) feet in width for a total of one hundred forty-four point three four (144.34) square feet.

One (1) at six (6) feet in length, and three (3) feet in width for a total of eighteen (18) square feet.

One (1) at twelve point eight three (12.83) feet in length, and seven point three three (7.33) feet in width for a total of ninety-four point zero four (94.04) square feet.

One (1) at four point two five (4.25) feet in length, and eleven point six seven (11.67) feet in width for a total of forty-nine point six (49.6) square feet.

The location of said privilege shall be as shown on prints kept on file with the Department of Business Affairs and Consumer Protection and the Office of the City Clerk.

Said privilege shall be constructed in accordance with plans and specifications approved by the Department of Transportation (Office of Underground Coordination).

This grant of privilege in the public way shall be subject to the provisions of Section 10-28-015 and all other required provisions of the Municipal Code of Chicago.

The grantee shall pay to the City of Chicago as compensation for the privilege #1121821 herein granted the sum of seventeen thousand seven hundred nineteen (\$17,719.00) per annum in advance.

A 25% penalty will be added for payments received after due date.

The permit holder agrees to hold the City of Chicago harmless for any damage, relocation or replacement costs associated with damage, relocation or removal of private property caused by the City performing work in the public way.

Authority herein given and granted for a period of five (5) years from and after Date of Passage.

Alderman

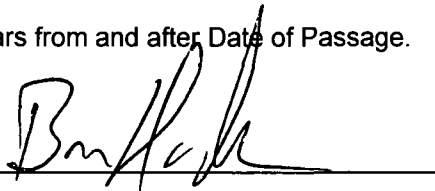

Brian Hopkins 2nd Ward

Vault B: Section 1 = 151'-0" x 2'-6"

Section 2 = 12'-10" x 11'-3"

Section 3 = 6'-0" x 3'-0"

Section 4 = 12'-10" x 7'-4"

Section 5 = 4'-3" x 11'-8"

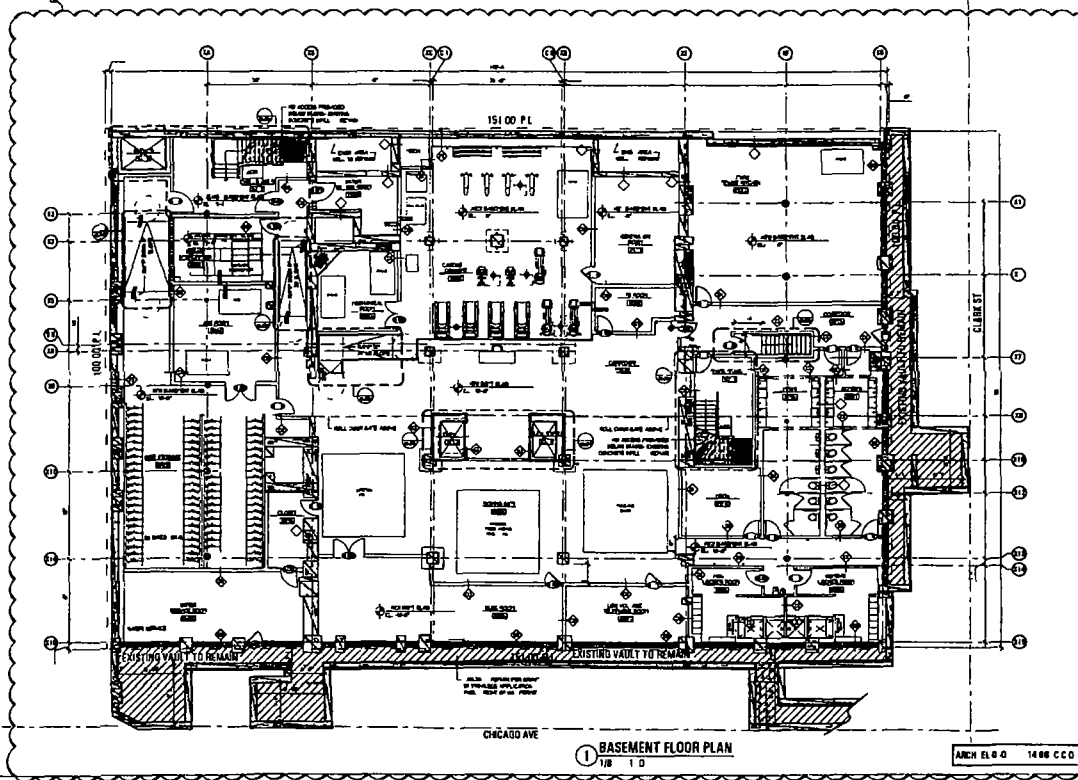

AREA FOR CITY APPROVAL STAMP
 EXISTING AREA NOTES

PLAN MATERIAL KEY

PLAN NOTES

FLATS
 11 C

NO. 8 CLASH #7
 CHICAGO 6

DATE	DESCRIPTION
10/10/11	SCHEMATIC
10/21/11	SCHEMATIC
10/27/11	SCHEMATIC
11/02/11	SCHEMATIC
11/09/11	SCHEMATIC
11/16/11	SCHEMATIC
11/23/11	SCHEMATIC
11/30/11	SCHEMATIC
12/07/11	SCHEMATIC
12/14/11	SCHEMATIC
12/21/11	SCHEMATIC
12/28/11	SCHEMATIC
01/04/12	SCHEMATIC
01/11/12	SCHEMATIC
01/18/12	SCHEMATIC
01/25/12	SCHEMATIC
02/01/12	SCHEMATIC
02/08/12	SCHEMATIC
02/15/12	SCHEMATIC
02/22/12	SCHEMATIC
02/29/12	SCHEMATIC
03/06/12	SCHEMATIC
03/13/12	SCHEMATIC
03/20/12	SCHEMATIC
03/27/12	SCHEMATIC
04/03/12	SCHEMATIC
04/10/12	SCHEMATIC
04/17/12	SCHEMATIC
04/24/12	SCHEMATIC
05/01/12	SCHEMATIC
05/08/12	SCHEMATIC
05/15/12	SCHEMATIC
05/22/12	SCHEMATIC
05/29/12	SCHEMATIC
06/05/12	SCHEMATIC
06/12/12	SCHEMATIC
06/19/12	SCHEMATIC
06/26/12	SCHEMATIC
07/03/12	SCHEMATIC
07/10/12	SCHEMATIC
07/17/12	SCHEMATIC
07/24/12	SCHEMATIC
07/31/12	SCHEMATIC
08/07/12	SCHEMATIC
08/14/12	SCHEMATIC
08/21/12	SCHEMATIC
08/28/12	SCHEMATIC
09/04/12	SCHEMATIC
09/11/12	SCHEMATIC
09/18/12	SCHEMATIC
09/25/12	SCHEMATIC
10/02/12	SCHEMATIC
10/09/12	SCHEMATIC
10/16/12	SCHEMATIC
10/23/12	SCHEMATIC
10/30/12	SCHEMATIC
11/06/12	SCHEMATIC
11/13/12	SCHEMATIC
11/20/12	SCHEMATIC
11/27/12	SCHEMATIC
12/04/12	SCHEMATIC
12/11/12	SCHEMATIC
12/18/12	SCHEMATIC
12/25/12	SCHEMATIC
01/01/13	SCHEMATIC
01/08/13	SCHEMATIC
01/15/13	SCHEMATIC
01/22/13	SCHEMATIC
01/29/13	SCHEMATIC
02/05/13	SCHEMATIC
02/12/13	SCHEMATIC
02/19/13	SCHEMATIC
02/26/13	SCHEMATIC
03/05/13	SCHEMATIC
03/12/13	SCHEMATIC
03/19/13	SCHEMATIC
03/26/13	SCHEMATIC
04/02/13	SCHEMATIC
04/09/13	SCHEMATIC
04/16/13	SCHEMATIC
04/23/13	SCHEMATIC
04/30/13	SCHEMATIC
05/07/13	SCHEMATIC
05/14/13	SCHEMATIC
05/21/13	SCHEMATIC
05/28/13	SCHEMATIC
06/04/13	SCHEMATIC
06/11/13	SCHEMATIC
06/18/13	SCHEMATIC
06/25/13	SCHEMATIC
07/02/13	SCHEMATIC
07/09/13	SCHEMATIC
07/16/13	SCHEMATIC
07/23/13	SCHEMATIC
07/30/13	SCHEMATIC
08/06/13	SCHEMATIC
08/13/13	SCHEMATIC
08/20/13	SCHEMATIC
08/27/13	SCHEMATIC
09/03/13	SCHEMATIC
09/10/13	SCHEMATIC
09/17/13	SCHEMATIC
09/24/13	SCHEMATIC
10/01/13	SCHEMATIC
10/08/13	SCHEMATIC
10/15/13	SCHEMATIC
10/22/13	SCHEMATIC
10/29/13	SCHEMATIC
11/05/13	SCHEMATIC
11/12/13	SCHEMATIC
11/19/13	SCHEMATIC
11/26/13	SCHEMATIC
12/03/13	SCHEMATIC
12/10/13	SCHEMATIC
12/17/13	SCHEMATIC
12/24/13	SCHEMATIC
12/31/13	SCHEMATIC
01/07/14	SCHEMATIC
01/14/14	SCHEMATIC
01/21/14	SCHEMATIC
01/28/14	SCHEMATIC
02/04/14	SCHEMATIC
02/11/14	SCHEMATIC
02/18/14	SCHEMATIC
02/25/14	SCHEMATIC
03/04/14	SCHEMATIC
03/11/14	SCHEMATIC
03/18/14	SCHEMATIC
03/25/14	SCHEMATIC
04/01/14	SCHEMATIC
04/08/14	SCHEMATIC
04/15/14	SCHEMATIC
04/22/14	SCHEMATIC
04/29/14	SCHEMATIC
05/06/14	SCHEMATIC
05/13/14	SCHEMATIC
05/20/14	SCHEMATIC
05/27/14	SCHEMATIC
06/03/14	SCHEMATIC
06/10/14	SCHEMATIC
06/17/14	SCHEMATIC
06/24/14	SCHEMATIC
07/01/14	SCHEMATIC
07/08/14	SCHEMATIC
07/15/14	SCHEMATIC
07/22/14	SCHEMATIC
07/29/14	SCHEMATIC
08/05/14	SCHEMATIC
08/12/14	SCHEMATIC
08/19/14	SCHEMATIC
08/26/14	SCHEMATIC
09/02/14	SCHEMATIC
09/09/14	SCHEMATIC
09/16/14	SCHEMATIC
09/23/14	SCHEMATIC
09/30/14	SCHEMATIC
10/07/14	SCHEMATIC
10/14/14	SCHEMATIC
10/21/14	SCHEMATIC
10/28/14	SCHEMATIC
11/04/14	SCHEMATIC
11/11/14	SCHEMATIC
11/18/14	SCHEMATIC
11/25/14	SCHEMATIC
12/02/14	SCHEMATIC
12/09/14	SCHEMATIC
12/16/14	SCHEMATIC
12/23/14	SCHEMATIC
12/30/14	SCHEMATIC
01/06/15	SCHEMATIC
01/13/15	SCHEMATIC
01/20/15	SCHEMATIC
01/27/15	SCHEMATIC
02/03/15	SCHEMATIC
02/10/15	SCHEMATIC
02/17/15	SCHEMATIC
02/24/15	SCHEMATIC
03/02/15	SCHEMATIC
03/09/15	SCHEMATIC
03/16/15	SCHEMATIC
03/23/15	SCHEMATIC
03/30/15	SCHEMATIC
04/06/15	SCHEMATIC
04/13/15	SCHEMATIC
04/20/15	SCHEMATIC
04/27/15	SCHEMATIC
05/04/15	SCHEMATIC
05/11/15	SCHEMATIC
05/18/15	SCHEMATIC
05/25/15	SCHEMATIC
06/01/15	SCHEMATIC
06/08/15	SCHEMATIC
06/15/15	SCHEMATIC
06/22/15	SCHEMATIC
06/29/15	SCHEMATIC
07/06/15	SCHEMATIC
07/13/15	SCHEMATIC
07/20/15	SCHEMATIC
07/27/15	SCHEMATIC
08/03/15	SCHEMATIC
08/10/15	SCHEMATIC
08/17/15	SCHEMATIC
08/24/15	SCHEMATIC
08/31/15	SCHEMATIC
09/07/15	SCHEMATIC
09/14/15	SCHEMATIC
09/21/15	SCHEMATIC
09/28/15	SCHEMATIC
10/05/15	SCHEMATIC
10/12/15	SCHEMATIC
10/19/15	SCHEMATIC
10/26/15	SCHEMATIC
11/02/15	SCHEMATIC
11/09/15	SCHEMATIC
11/16/15	SCHEMATIC
11/23/15	SCHEMATIC
11/30/15	SCHEMATIC
12/07/15	SCHEMATIC
12/14/15	SCHEMATIC
12/21/15	SCHEMATIC
12/28/15	SCHEMATIC
01/04/16	SCHEMATIC
01/11/16	SCHEMATIC
01/18/16	SCHEMATIC
01/25/16	SCHEMATIC
02/01/16	SCHEMATIC
02/08/16	SCHEMATIC
02/15/16	SCHEMATIC
02/22/16	SCHEMATIC
02/29/16	SCHEMATIC
03/06/16	SCHEMATIC
03/13/16	SCHEMATIC
03/20/16	SCHEMATIC
03/27/16	SCHEMATIC
04/03/16	SCHEMATIC
04/10/16	SCHEMATIC
04/17/16	SCHEMATIC
04/24/16	SCHEMATIC
05/01/16	SCHEMATIC
05/08/16	SCHEMATIC
05/15/16	SCHEMATIC
05/22/16	SCHEMATIC
05/29/16	SCHEMATIC
06/05/16	SCHEMATIC
06/12/16	SCHEMATIC
06/19/16	SCHEMATIC
06/26/16	SCHEMATIC
07/03/16	SCHEMATIC
07/10/16	SCHEMATIC
07/17/16	SCHEMATIC
07/24/16	SCHEMATIC
07/31/16	SCHEMATIC
08/07/16	SCHEMATIC
08/14/16	SCHEMATIC
08/21/16	SCHEMATIC
08/28/16	SCHEMATIC
09/04/16	SCHEMATIC
09/11/16	SCHEMATIC
09/18/16	SCHEMATIC
09/25/16	SCHEMATIC
10/02/16	SCHEMATIC
10/09/16	SCHEMATIC
10/16/16	SCHEMATIC
10/23/16	SCHEMATIC
10/30/16	SCHEMATIC
11/06/16	SCHEMATIC
11/13/16	SCHEMATIC
11/20/16	SCHEMATIC
11/27/16	SCHEMATIC
12/04/16	SCHEMATIC
12/11/16	SCHEMATIC
12/18/16	SCHEMATIC
12/25/16	SCHEMATIC
12/31/16	SCHEMATIC

BASEMENT PLAN

A10



Department of Business Affairs and Consumer Protection
Small Business Center- Public Way Use Unit
City Hall- 121 N LaSalle Street Room 800 • Chicago, IL 60602
312-74-GOBIZ / 312-744-6249 • (312) 744-1944 (TTY)
<http://www.cityofchicago.org/bacp>

03/16/2016

Alderman Brian Hopkins
Ward # 02
City of Chicago
City Hall, Room 200
121 North LaSalle Street
Chicago, Illinois 60602

Re: An ordinance to use and maintain a portion of the public right-of-way for **seven (7) vault(s)** for **Clark 800 LLC**, adjacent to the premises known as **800 N. Clark St.**

Dear Alderman **Brian Hopkins**:

The applicant referenced above has requested the use of the public right-of-way for **vault(s)**. An ordinance has been prepared by the Department of Business Affairs and Consumer Protection– Small Business Center- Public Way Use Unit for presentation to the City Council. Because this request was made for properties located in your ward, as approved by you as per the attached, I respectfully request that you introduce the attached ordinance at the next City Council meeting.

If you have any questions regarding this ordinance, please contact Anthony Bertuca at (312) 744-5506.

Department of Business Affairs and Consumer Protection