



Office of the Chicago City
Clerk



Or2012-314

Office of the City Clerk

City Council Document Tracking Sheet

Meeting Date:	6/6/2012
Sponsor(s):	Arena, John (45)
Type:	Order
Title:	Issuance of permits for sign(s)/signboard(s) at 4401 N Milwaukee Ave
Committee(s) Assignment:	Committee on Zoning, Landmarks and Building Standards

City Council, meeting date: **June 6th, 2012**
Committee on Zoning, Landmarks, & Building Standards

ORDERED, That the Commissioner of the Building Department is hereby directed to issue a sign permit to **M-K Signs, Inc., 4900 N. Elston Avenue, Chicago, IL 60630**, for the erection of a sign / signboard over twenty-four (24) feet in height and / or over one hundred (100) square feet (in area of one face) for the business of **A List Startenders Bartending School, 4401 N. Milwaukee Ave, Chicago, IL 60630** with the dimensions, height and square foot area:

Dimensions: length: 50'0" height: 4'0"

Height above grade to top of sign: 15'0"

Total Square Foot Area: 200 square feet

Such signs shall comply with all provisions of Title 17 of the Chicago Zoning Ordinance and all other applicable provisions of the Municipal Code of the City of Chicago governing the construction and maintenance of outdoor signs, sign boards, and structures.

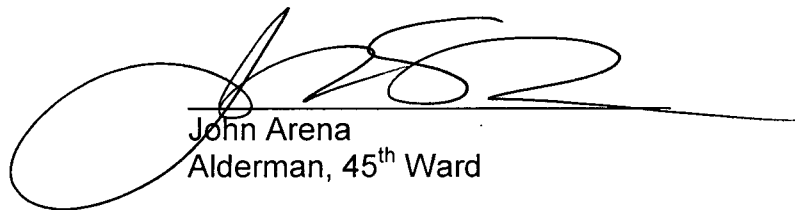

John Arena
Alderman, 45th Ward



CITY OF CHICAGO

DEPARTMENT OF BUILDINGS

Sign Permit Application

APPROVAL NUMBER	APPLICATION NUMBER 100422702	ANNUAL FEE	WORK CODE	DRAWINGS ATTACHED <input type="checkbox"/> YES <input type="checkbox"/> NO
DATE OF APPLICATION 12/20/2011	ADDRESS OF SIGN 4401 N MILWAUKEE AVE, 60630-		TYPE OF SIGN FLAT OR BOX	
BUILDING	ORIGINAL PERMIT NUMBER	LENGTH 50	FT. 0	IN. 0
TYPE OF PERMIT NEW CONSTRUCTION (SIGN)		HEIGHT 4	FT. 11	IN. 0
PAYER OF ANNUAL INSPECTION PISANO, ANTHONY 4401 N MILWAUKEE AVENUE CHICAGO, IL 60630 (773)545-4444		AREA 200	SQ FT. 200	WEIGHT 350
SIGN MANUFACTURER M-K SIGNS, INC		SIGN HEIGHT ABOVE GRADE/ROOF		FT. 11
ADDRESS WHERE SIGN CAN BE SEEN PRIOR TO ERECTION		SHAPE OF SIGN REGULAR		
TICKET NUMBER 0		SIGN WILL READ BARTENDING SCHOOL		
REINSPECTION CONTROL NUMBER		NO OF LAMPS		
TYPE OF SUPPORT FOR SIGN BUILDING		TOTAL WATTAGE		
SIGN BOARD SUPPORT MEMBERS STEEL		TYPE OF LAMP		
ANNUAL FEE		NO. OF BALLAST/TRANSFORMERS		
CONSTRUCTION FEE 200.00		INPUT OF TRANSFORMERS		
1017 B FEE		CONTRACTOR WILL INSTALL <input checked="" type="checkbox"/> FEEDERS <input type="checkbox"/>		
TOTAL FEE 200.00		CUSTOMER LEADS <input type="checkbox"/>		
AMOUNT PAID 200.00		TYPE OF SWITCH		
BALANCE DUE		LOCATION OF SWITCH		
Check # for Zoning		SIGN LOCATION A LIST STARTENDERS WALL DISPLAY		
Check # for DCAP				

The undersigned certify that the statements in this application are true and correct and that all work done under the proposed permit will conform to the requirements of the Chicago Municipal Code

REG NO	BOND. NO.	REG. NO	E05834
ELECT CONTR	SIGN ERECTOR M-K SIGNS, INC.	SIGNER	
ADDRESS	ADDRESS 4900 N. ELSTON AVE. CHICAGO IL, 60630		
SUPERVISOR SIGNATURE	SIGNATURE		

The permit issued on this application will authorize only signs here applied for. If other signs are to be erected they must be covered by additional permits

City of Chicago
Rahm Emanuel, Mayor



Department of Buildings
Michael Merchant, Commissioner



FASCIA BAND (4'-0" X 50'-0") - Sq.Ft. 200.0

APPROVED: _____ DATE: _____

M-K SIGNS
CHICAGO

4900 N. ELSTON AVE
CHICAGO, IL 60630

773/545-4444
FAX 773/545-0042
E-MAIL: artdept@mksigns.net

A LIST STARTENDERS 4401 N. Milwaukee Chicago, IL <small>Colors represented in this drawing are for presentation purposes only. They will not match your finished product exactly. Actual color samples can be obtained from your sales representative.</small> <small>This design is the original and unpublished work of MK SIGNS and may not be reproduced, copied or exhibited in any fashion without the expressed written consent of MK SIGNS. The rights to this design may be purchased.</small>	DATE	REVISION	SCALE	DATE
			N.T.S.	01/02/12
			DESIGNER	SALES
			JTF	
			FILE	DRAWING NUMBER
		WINDOW DISPLAY	6011	

CITY OF CHICAGO
DEPARTMENT OF ZONING AND LAND USE PLANNING
SIGN SITE PLAN
 (ALL INFORMATION MUST BE COMPLETED AND LEGIBLE)

Site Address: 4401 N Milwaukee Ave 1 of 1 applications

Sign Company: M-K SIGNS INC Rep Name: Anthony Cilia

Phone (773) 545-4444 EXT _____ (Below: Building, streets and location of sign on lot or structure)
 North

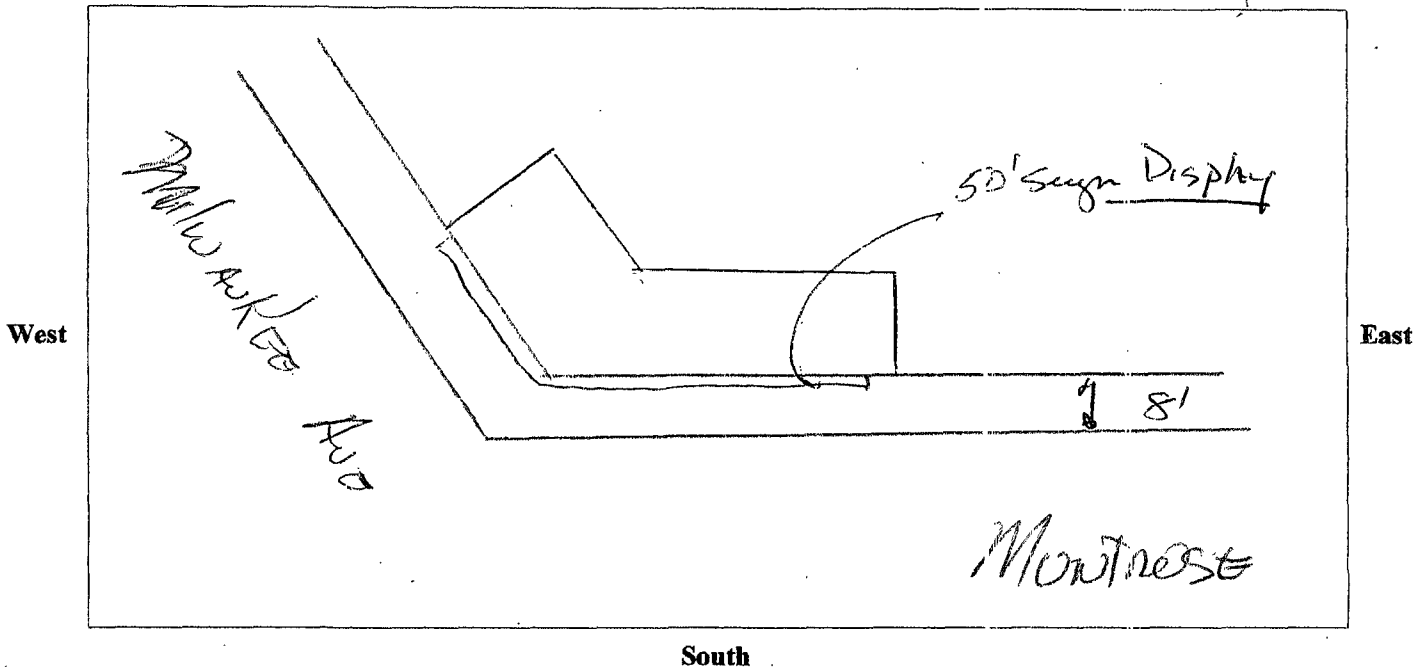

SIGN USE:

Bus. ID (On-premise)

Business Lice. #

Advertising (Off-premise)

PERMIT TYPE:

New Construction

Change of Face

Previous Permit #

TYPE OF SIGN:

Flat Wall

Freestanding

Awning

Marquee

High Rise Building

Projecting Private

Projecting Public Way

Public Way Use -Permit #

1088542

SIGN CHARACTERISTICS:

Non-Illuminated

Illuminated

Changing Image

Video Display

Flashing

DISTANCE FROM:

Curb Line: 8

Expressway, Toll Roads

or Major Route

(n/a if over 1000 ft) —

Park (over 10 acres) —

Residential Zone —

Existing Off-premise on

same side of street: —

TOTAL SQUARE FOOTAGE:

Square footage of this proposed sign 200

Gross area of all proposed signs —

Area of all existing signs

(not including proposed) on Zoning Lot —

Signature: Anthony Cilia

Date: 12-20-11

