



# City of Chicago



Or2015-765

Office of the City Clerk

## Document Tracking Sheet

<b>Meeting Date:</b>	12/9/2015
<b>Sponsor(s):</b>	Mell (33)
<b>Type:</b>	Order
<b>Title:</b>	Issuance of permits for sign(s)/signboard(s) at 2939 W Addison St -156 sq. ft.
<b>Committee(s) Assignment:</b>	Committee on Zoning, Landmarks and Building Standards

**Committee on Zoning, Landmarks, and Building Standards**

**(Signs)**

**ORDERED, That the Commissioner of Buildings is hereby directed to issue a sign permit to: (Contractor's name and address)**

**Modern Signs Inc.**

**1727 Armitage Court**

**Addison, Illinois 60101**

**for the erection of a sign/signboard over 24 feet in height and/or over 100 square feet (in area of one face) at: (Business Name & Address)**

**Target**

**2939 West Addison Street**

**Chicago, Illinois 60618**

**Dimensions: Length 24 feet Height 6 feet 6 inches  
Height above grade/roof to top of sign 16 feet 6 inches  
TOTAL SQUARE FOOT AREA: 156 feet**

**Such sign(s) shall comply with all applicable provisions of TITLE 17 of the Chicago Zoning Ordinance and all other applicable provisions of the Municipal Code of the City of Chicago governing the construction and maintenance of outdoor signs, signboards and structures.**

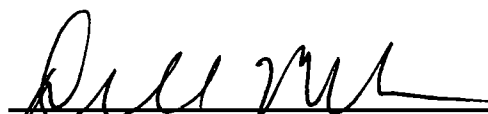
  
**DEBORAH L. MELL**  
**Alderman, 33rd Ward**



CITY OF CHICAGO

# DEPARTMENT OF BUILDINGS

## Aldermanic Acknowledgment Letter

TO: Department of Buildings  
121 North LaSalle Street, Room 900  
Chicago, IL 60602

DATE: \_\_\_\_\_, 20\_\_\_\_

PERMIT # 100624311

I am aware of the application for a building permit at the following address. I have no objection to its issuance.

TARGET

Address: 2939 W ADDISON 60618

Date of Application: 11/18/2015

Type of Permit: SIGN

Signed: \_\_\_\_\_

Ward: \_\_\_\_\_

\_\_\_\_\_  
(Alderman's full name, printed or typed)

Telephone: (\_\_\_\_) \_\_\_\_\_





CITY OF CHICAGO

# DEPARTMENT OF BUILDINGS

## Sign Permit Application

APPROVAL NUMBER	APPLICATION NUMBER 100624311	ANNUAL FEE	WORK CODE	DRAWINGS ATTACHED <input type="checkbox"/> YES <input type="checkbox"/> NO
-----------------	---------------------------------	------------	-----------	--

DATE OF APPLICATION 11/18/2015	
ADDRESS OF SIGN 2939 W ADDISON ST, 60618-	
BUILDING	ORIGINAL PERMIT NUMBER
TYPE OF PERMIT NEW CONSTRUCTION (SIGN)	
PAYER OF ANNUAL INSPECTION BRANDELL, MARLYS 1000 NICOLET MALL TPN-12H MINNEAPOLIS, MN 55403 (612)761-1547	
SIGN MANUFACTURER PHILADELPHIA SIGNS	
ADDRESS WHERE SIGN CAN BE SEEN PRIOR TO ERECTION	
TICKET NUMBER 0	REINSPECTION CONTROL NUMBER
TYPE OF SUPPORT FOR SIGN BUILDING	
SIGN BOARD SUPPORT MEMBERS STEEL	
ANNUAL FEE	_____
CONSTRUCTION FEE	400.00
1017 B FEE	_____
TOTAL FEE	400.00
AMOUNT PAID	200.00
BALANCE DUE	\$ 200.00
<input type="checkbox"/> Check # for Zoning <input type="checkbox"/> Check # for DCAP	

TYPE OF SIGN FLAT OR BOX					
LENGTH	FT. 24	IN.	HEIGHT	FT. 6	IN. 6
AREA	SQ. FT. 156	WEIGHT		LBS. 80	
SIGN HEIGHT ABOVE GRADE/ROOF					FT. 10
SHAPE OF SIGN REGULAR					
SIGN WILL READ LOGO ONLY					
NO. OF LAMPS 1			TOTAL WATTAGE 60		
TYPE OF LAMP OTHER					
NO. OF BALLAST/TRANSFORMERS 1			INPUT OF TRANSFORMERS 120		
CONTRACTOR WILL INSTALL			<input checked="" type="checkbox"/> N FEEDERS <input type="checkbox"/> Y CUSTOMER LEADS		
TYPE OF SWITCH SPECIAL					
LOCATION OF SWITCH LISTED FLUSH TOGGLE					
SIGN LOCATION INSTALL ILLUMINATED WALL SIGN FACING WEST OVER PRIVATE PROPERTY. SWITCH IS PART OF UL SIGN. EXISTING SIGN TO BE REMOVED.					

The undersigned certify that the statements in this application are true and correct and that all work done under the proposed permit will conform to the requirements of the Chicago Municipal Code

REG. NO.	E94792
ELECT CONTR MODERN SIGNS, INC.	ELECTR
ADDRESS 1727 ARMITAGE COURT ADDISON, IL 60101	
SUPERVISOR SIGNATURE <i>William F. Healy</i>	

BOND. NO.	REG. NO.	N93883
SIGN ERECTOR MODERN SIGNS INC	SIGNER	
ADDRESS 1727 ARMITAGE CT ADDISON IL, 60101-		
SIGNATURE <i>[Signature]</i>		

The permit issued on this application will authorize only signs here applied for. If other signs are to be erected they must be covered by additional permits

City of Chicago  
Rahm Emanuel, Mayor



Department of Buildings  
Judith Frydland, Commissioner

TYPE OF BUSINESS  
**COMMERCIAL** Other: **RETAIL**  
 Name: **TARGET**  
 LIC #:  
 Renewal Date: **02/15/2016**

SIGN BOND REQUIRED?  YES  
 COUNCIL ORDER REQUIRED  YES  
 IS SPECIAL PERMISSION REQUIRED FROM CHIEF ELECTRICAL  
 YES  
 IF YES, ATTACH LETTER OF REQUEST

Projects Over:  
 Private Property  
 Public Way Grant Permit #:  
 Planned Development/Manufacturing PMD/PD#: **PD 353**  
 Zoning District: **OTHER** Other: **PD 35**

TIME STAMP

TYPE OF SIGN:  
 ADVERTISING  ILLUMINATE  MOVEABLE  
 BUSINESS  FLASHING

TOTAL STREET FRONTAGE OF LOT (IN FEET) **1,350**  
 TOTAL AREA OF NEW SIGN (SQ.FT.) **156**  
 TOTAL AREA OF ALL SIGNS ON LOT (SQ.FT.) **794**  
 HEIGHT OF SIGN ABOVE GRADE (TO TOP) **16ft 6in**

DISTANCE OF CURB LINE OUTER EDGE (ft) **627**  
 DISTANCE OF STRUCTURE INNER EDGE (ft) **651**

SIGN CLERK  
 APPROVED FOR PERMIT

DISTANCE FROM (ft):  
 A. PUBLIC PARK (OVER 10 ACRES) **500**  
 B. EXPRESSWAY (IF LESS THAN 1,000 FT.) **1,000**  
 C. RESIDENCE DISTRICT (ADVERTISING SIGNS ONLY) **50**

REMARKS

IF REPLACEMENT SIGN OR CHANGE OF FACE, WHAT DOES THE EXISTING SIGN READ?  
 Original Payee:

Landmark Hold:  Status:

ZONING (OFFICE USE ONLY)

# CITY OF CHICAGO SIGN PERMIT APPLICATION CONTINUED

Expediter: \_\_\_\_\_  
Address: \_\_\_\_\_ License #: \_\_\_\_\_  
Phone #: \_\_\_\_\_ Mobile #: \_\_\_\_\_ Email: \_\_\_\_\_  
Website: \_\_\_\_\_

## Section 3 - Sign and Structure Details

(Please check all that apply)

### Sign Category:

On-Premise (Business ID):  Dynamic  Static

Business License # of Tenant Business: \_\_\_\_\_

Off-Premise (Advertising):  Dynamic  Static

Temporary:  Special Event:

Sign will read (Please provide a description, picture and shop drawing): LOGO ONLY

### Type of sign (Mark all that apply):

Awning  Canopy  Freestanding  Marquee  Projecting  Dynamic Image Display

Wall  Painted  Cabinet/Frame  Vinyl  Projected image  Flashing

High Rise Building  Hotel/Hospitals  Other buildings: \_\_\_\_\_

What is the dimension of the wall on which the sign will be installed? 8' x 70'

Where is sign or sign structure mounted?  Inside the building  Outside the building

Is the sign or sign structure attached to a building or wall?  Yes  No If yes, which wall of building? N E S W

Is this a freestanding sign?  Yes  No Location of sign on lot: N E S W

In which direction does sign copy face? N E S W

Does any portion of the sign, sign structure or attachments cover, obscure or obstruct an existing window in a residential unit whether occupied or not?  Yes  No

Does any portion of the sign, sign structure, or attachments extend on or over the public way?  Yes  No

If yes, what is the public way use permit number? \_\_\_\_\_

Are panels: Back to back within 30 degrees of parallel  Yes  No

Number of Faces: 1

Support Structure:  Pole  Roof  Ground  Building  Windows  Other: \_\_\_\_\_

Does any portion of the sign or sign structure extend 24 inches above the roof line as defined in 17-17-02149 of the Municipal Code of Chicago?  Yes  No

Picture or rendering must be attached depicting sign placement with before and after view.

Section 3 continues on next page

# CITY OF CHICAGO SIGN PERMIT APPLICATION CONTINUED

Section 3 continued

## Dimensions of Sign Structure (i.e. cabinet, frame, awning, canopy)

Length: 24 Feet \_\_\_\_\_ Inches    Height: 6 Feet 6 Inches    Depth: \_\_\_\_\_ Feet 7 Inches

Area: 156 Sq Ft    Weight: 80 lbs.

Shape of Sign: REGULAR

## Sign Height above Grade:

From Grade to Bottom of sign or sign structure, whichever is lowest: 10 Ft.

From Grade to Top of sign or sign structure, whichever is highest: 17 Ft.

Is City Council Order required?\*  Yes  No

\*All signs in excess of 100 Square Feet in area OR in excess of 24 feet above grade require a City Council Order pursuant to Section 13-20-680 of the Municipal Code of Chicago

## Dimension of Sign Elements pursuant to Section 17-12-0601 of the Chicago Zoning Ordinance:

Length: 5 Feet \_\_\_\_\_ Inches    Height: 5 Feet \_\_\_\_\_ inches    Area: 25 Sq Ft.

Electrical Contractor will install: Feeders:  Yes  No    Customer Leads:  Yes  No

Number of Lamps: 1    Total Wattage: 60    Type of Lamp: LED

Number of Ballast/Transformers: 1    Input of Transformers: 120

Type of Switch: SPECIAL    Location of Switch: LISTED FLUSH Toggle

Painted:  Yes  No

Illuminated:  Yes  No

If yes - External \_\_\_\_\_ Internal X

Dynamic Image Display:  Yes  No

An affidavit of compliance is required for all dynamic image display signs pursuant to Section 13-20-675(d)(2) of the Municipal Code of Chicago.)

Max Nits \_\_\_\_\_ Max Foot Candles \_\_\_\_\_ Message Time (Screen Hold): \_\_\_\_\_ seconds

Self Dimming Capability:  Yes  No

What is the total of the sign face area devoted to dynamic image display? \_\_\_\_\_ Sq Ft.

## Section 4 - Zoning Information

Zoning District or Planned Development #: PD 353

Sign located in a special sign district?  Yes  No

If yes:  Michigan Avenue Corridor  Oak Street Corridor  State Street/Wabash Avenue Corridor

Frontal Street frontage of Zoning Lot: 1350 (Ft.)

Net Area of new sign: 156 (Sq Ft.) Gross Area of all proposed signs: 501 (Sq Ft.)

Net Area of all existing signs on Zoning Lot: 794 (Sq Ft.)

Picture or rendering must be attached depicting sign placement with before and after view.

Section 4 continues on next page

# CITY OF CHICAGO SIGN PERMIT APPLICATION CONTINUED

## Section 4 continued

Distance from outer edge of sign or structure to curb line: 627 (Ft.)

Distance from inner edge of sign or sign structure to curb line: 651 (Ft.)

Distance from:

Public Park 10 acres or more: +500 (Ft.)

Public Park 2 acres or more: +500 (Ft.)

Expressway or Toll Road: +1000 (Ft.)

Lake Shore Drive: \_\_\_\_\_ (Ft.)

Michigan Avenue (Oak St. to Roosevelt Rd.): \_\_\_\_\_ (Ft.)

Residential District: \_\_\_\_\_ (Ft.)

Residential building in a D district: \_\_\_\_\_ (Ft.)

Existing off-premise/advertising signs on same side of street?  Yes  No

In a B or C District: \_\_\_\_\_ (Ft.)

In a D or M District: \_\_\_\_\_ (Ft.)

Waterways: \_\_\_\_\_ (Ft.)

## Section 5 - Sign Permit History

Does the proposed sign, change, alter or replace an existing sign?  Yes  No

If yes, were permits issued for the sign being replaced, changed or altered?  Yes  No

If yes, please list each permit number and date each permit was issued:

Permit Number: 166516 Date issued: 7/15/2003

Permit Number: \_\_\_\_\_ Date issued: \_\_\_\_\_

Permit Number: \_\_\_\_\_ Date issued: \_\_\_\_\_

Permit Number: \_\_\_\_\_ Date issued: \_\_\_\_\_

Does the proposed sign change a static sign to a dynamic image display sign?  Yes  No

Does the proposed sign change or alter the square footage or the height of the sign or sign structure?  Yes  No

Does the proposed sign change an on-premise sign to an off-premise/advertising sign?  Yes  No

## Section 6 - Attestation and Signatures

I, the undersigned, under penalty of perjury, do hereby affirm and attest that the above information is true, complete, and correct and to the best of my knowledge that incorrect information is grounds to revoke or rescind a permit.

Owner of Real Property: MARLYS BEANDELL Date 11/18/15

Lessee of Real Property: MARLYS BEANDELL Date 11/18/15

Inspector: \_\_\_\_\_ Date \_\_\_\_\_

Permitting Electrician: William + Leahy Date 11/18/15

Sign Erector: [Signature] Date 11/15/15

Picture or rendering must be attached depicting sign placement with before and after view.



For Office Use

ZONING	PUBLIC WAY

**Sign Review Fee:**

Zoning Review Fee: \$ \_\_\_\_\_ Total Fee: \$ \_\_\_\_\_

Amount Paid: \$ \_\_\_\_\_ Balance Due: \$ \_\_\_\_\_

**PERMIT IS VALID FOR A PERIOD OF FIVE YEARS AFTER ISSUANCE. IT IS SOLELY THE RESPONSIBILITY OF THE OWNER OR LESSEE TO FILE FOR RENEWAL**

\* Once zoning fee is paid, this application is valid for a period of up to six months from payment date.

Applies to sign permits applied for on or after April 2, 2014.

City of Chicago  
Mayor Rahm Emanuel



Department of Buildings  
Felicia Davis, Commissioner

**SIGN INVENTORY**

**SITE:** T1437 Chicago Mid North

**SIGN PAGE:** PROPOSED SIGNS

- A3a 3 New Projecting sign to replace existing
- V1a 4 New Directional Sign
- A2a 5 New Wall Directional sign to replace ext.
- A2b 6 New Wall Directional sign to replace ext.

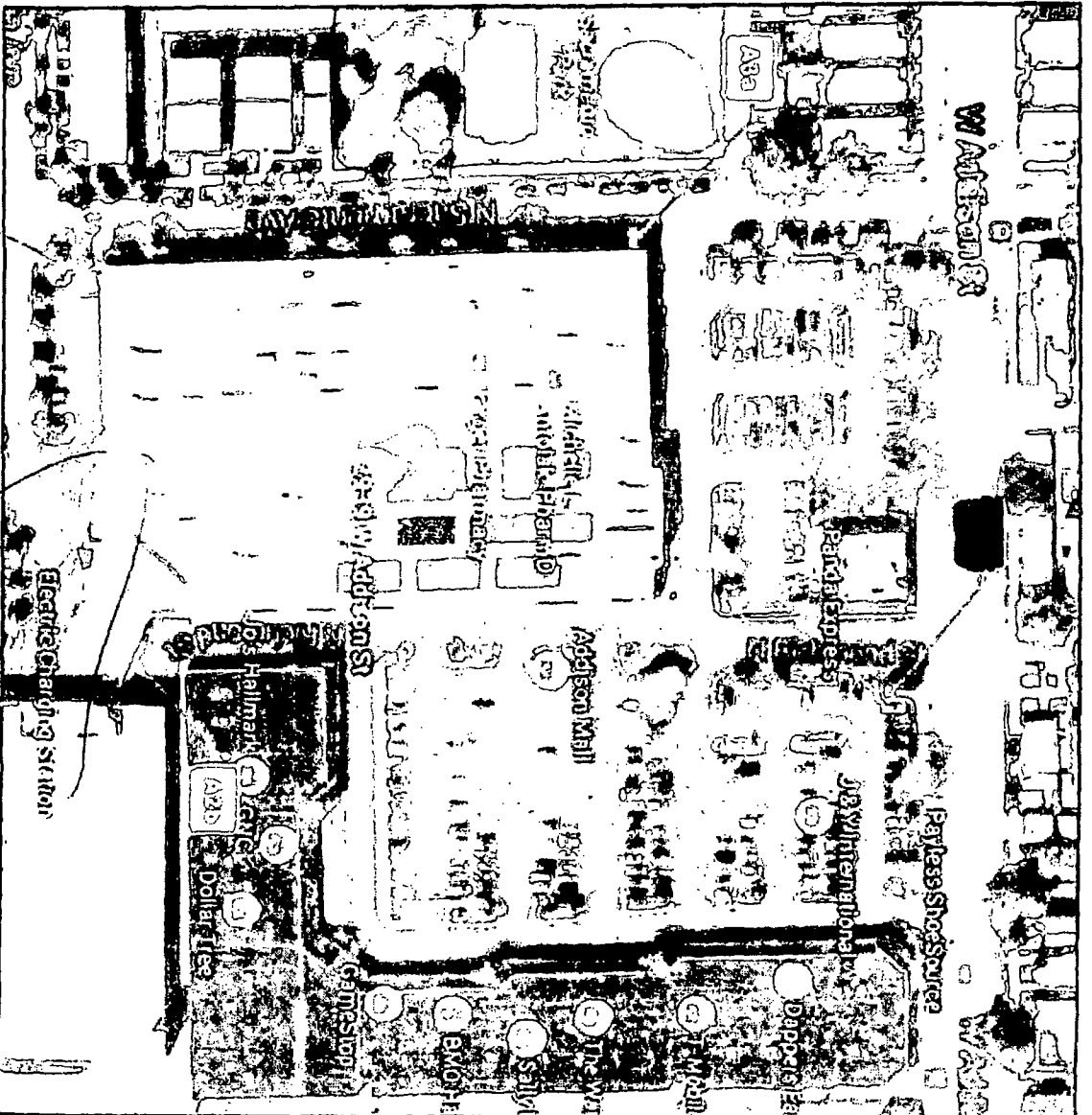
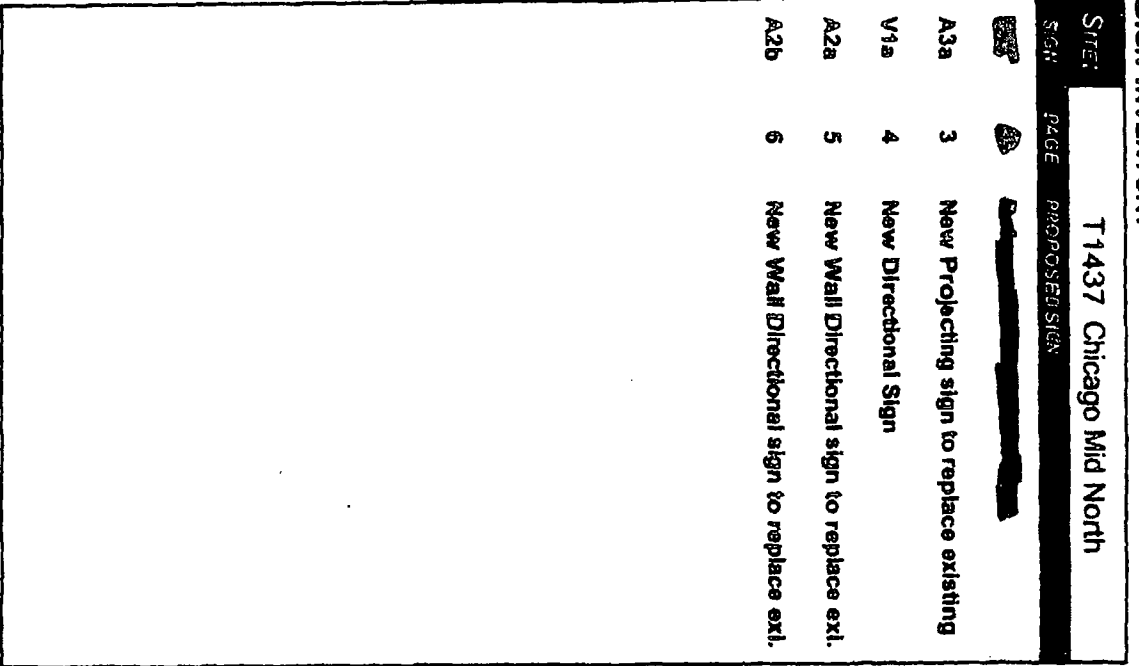

**TITLE**

Target

**DWG BY:** RJW

**DATE:** 10/08/115

**DATE:** REVISION

**BY:**

**ADDRESS**

T1437 Chicago Mid North  
2939 W Addison Street  
Chicago, IL 60618

**DWG NUM:** AZ5389

**SHEET:** 1



**PHILADELPHIA SIGN**

A2b 6'6h x 24' 0w Illuminated Horizontal Store and Parking Ramp Entry

Proposed

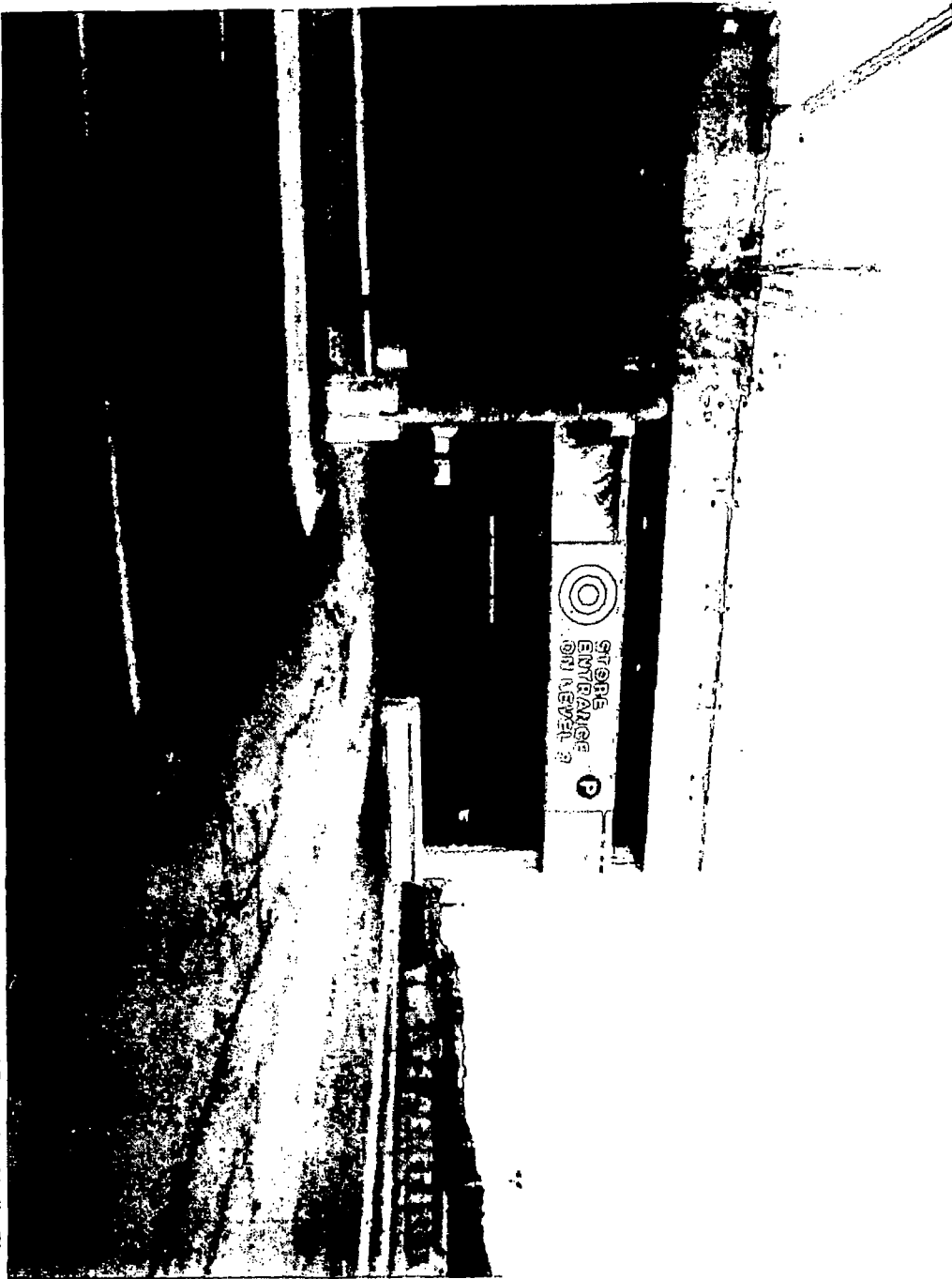

Existing



Signs Rendered Proportional to the Photo

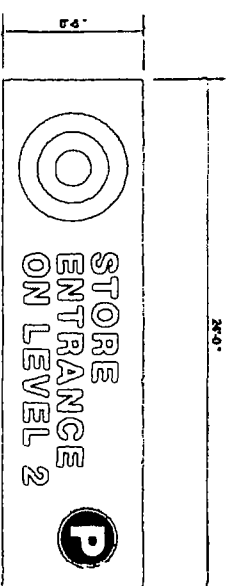

PHILADELPHIASIGN

TITLE	Target	DMG BY	RLW	DATE	10/08/115	DATE	11.17.15	REVISION	Revised V1a, A2a, A3a, and A2b	BY	AFR
ADDRESS	11437 Chicago Mid North 2939 W. Addison Street Chicago, IL 60618		DMG NUM	A25389	SHEET	6					
<p>THIS IS AN ORIGINAL UNPUBLISHED DRAWING CREATED BY P.S.C. O. R. IS SUBMITTED FOR YOUR PERSONAL USE IN CONNECTION WITH A PROJECT BEING PLANNED FOR YOU BY P.S.C. O. IT IS NOT TO BE SHOWN TO ANYONE OUTSIDE YOUR ORGANIZATION NOR IS IT TO BE USED, COPIED, REPRODUCED OR EXHIBITED IN ANY MANNER.</p>											



SQUARE FOOTAGE: 163.9



PLAN VIEW  
SCALE: 1/4" = 1' 0"

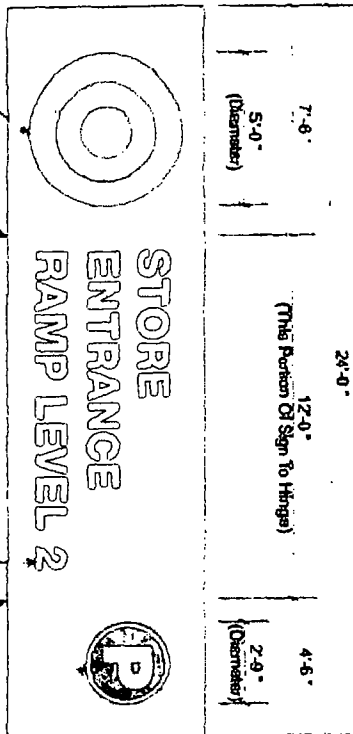

ELEVATION VIEW  
SIGN A2b - PRIMARY STORE AND PARKING ENTRY  
Illuminated Horizontal Sign And Parking Ramp Entry  
SCALE: 1/4" = 1' 0"

Electrical Load  
(0.0) Amps @ 120 Volts  
Electrical Req. mts  
(1) 20 Amp/120 Volt Circuits

- STANDARD WALL SIGN NOTES:
1. Sufficient Primary Circuit in Vicinity of Sign By Others.
  2. Fast Primary Hook-up By Sign Installer. Where Aligned By Local Codes.
  3. Sign Shall Be U.L. Listed.
  4. Mounting Hardware By Sign Installer.

Note: This sign is intended to be installed in accordance with the requirements of Article 600 of the National Electrical Code unless other applicable local codes. This includes proper grounding and bonding of the sign.

PERMITS  
ONLY

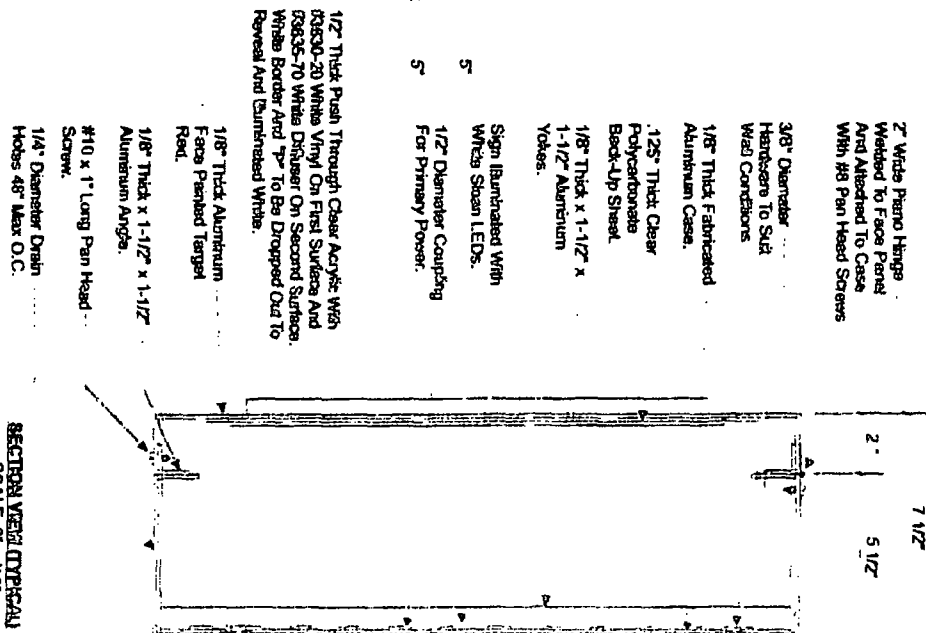

SECTION VIEW (TYPICAL)  
SCALE: 3" = 1' 0"



PHILADELPHIA SIGN  
INCORPORATED  
100 South Parkway Georgia Street  
Pittsburgh, PA 15203  
Phone: (412) 261-1100  
Fax: (412) 261-0200  
www.philadelphiasign.com

CUSTOMER:  
TARGET

JOB NUMBER:  
T1437

SIGN TYPE:  
Vertical

LOCATION:  
3033 N. Addison Road  
Chicago, IL 60631

DATE:  
08/19/2015

DRAWN BY:  
JTR

REVISION:  
Number Date By

PROJECT:  
2 OF 6

DRAWING NUMBER:  
B5712-1

ENGINEER SEAL:

DATE: 08/20/2015 09:25:00 AM  
DRAWN BY: JTR

PHILADELPHIA SIGN  
INCORPORATED  
100 South Parkway Georgia Street  
Pittsburgh, PA 15203  
Phone: (412) 261-1100  
Fax: (412) 261-0200  
www.philadelphiasign.com

# Zoning Map

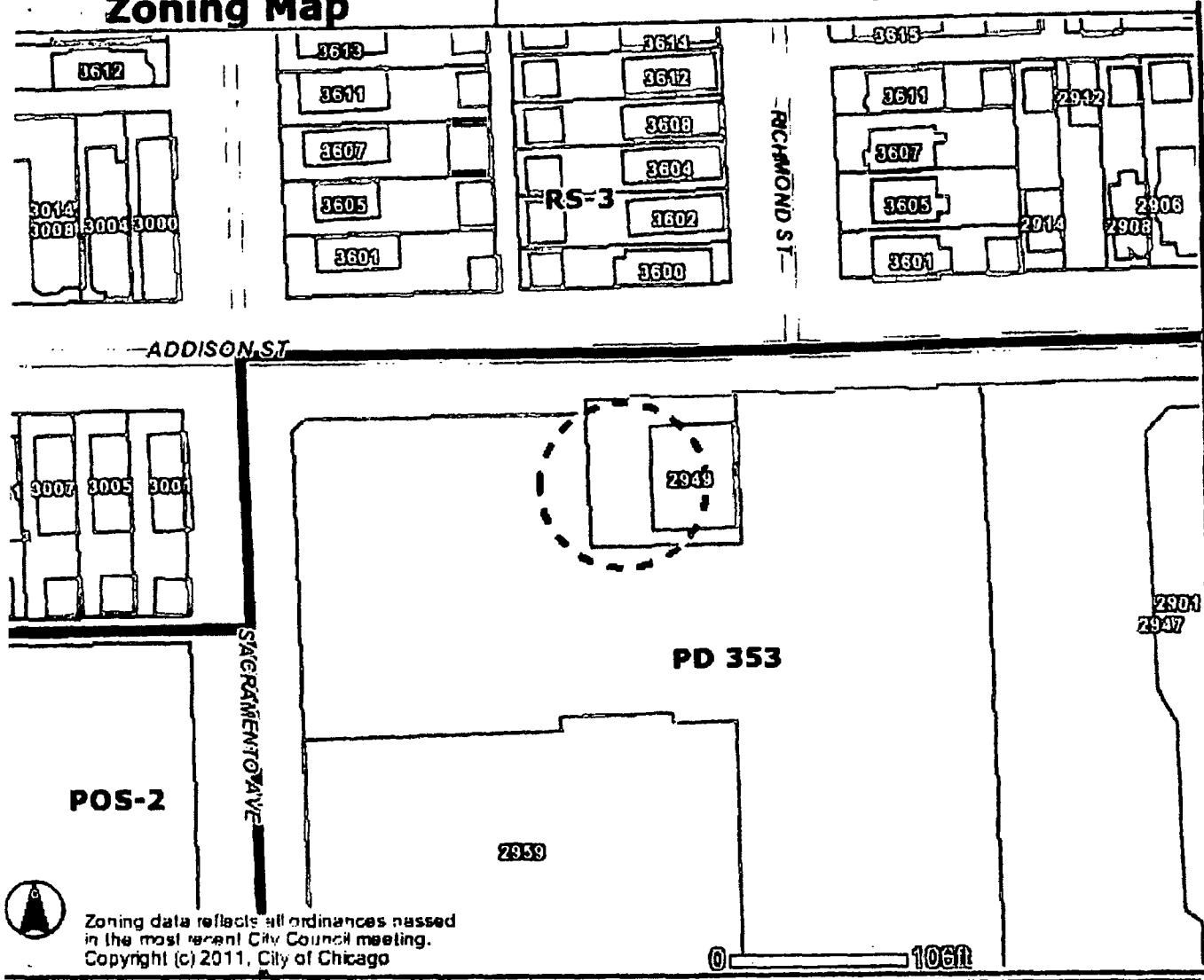

Zoning data reflects all ordinances passed in the most recent City Council meeting. Copyright (c) 2011, City of Chicago

Address  
**339 W ADDISON ST**

<p><b>Zoning</b></p> <ul style="list-style-type: none"> <li> Business</li> <li> Commercial</li> <li> Manufacturing</li> <li> Residential</li> <li> Planned Development</li> <li> Planned Manufacturing</li> <li> Downtown Core</li> <li> Downtown Service</li> <li> Downtown Mixed</li> <li> Downtown Residential</li> <li> Transportation</li> <li> Parks &amp; Open Space</li> <li> Zoning Boundaries</li> </ul>	<p><b>Historic Preservation</b></p> <p><b>CHICAGO LANDMARKS</b></p> <ul style="list-style-type: none"> <li> Chicago Landmarks</li> <li> Landmark Districts</li> </ul> <p><b>Chicago Historic Resources Survey - Buildings subject to Demolition-Delay Ordinance</b></p> <ul style="list-style-type: none"> <li> Red</li> <li> Orange</li> </ul> <p> Water</p> <p><b>Cemetery</b></p> <p><b>Municipalities</b></p>	<ul style="list-style-type: none"> <li> Lakefront</li> <li> Pedestrian Streets</li> <li> Buildings</li> <li> Parcels</li> <li> Streets</li> <li> Curbs</li> <li> Forest Preserve</li> <li> City Boundary</li> </ul>	
--	---	---	--

Information provided on the City of Chicago web site should not be used as a substitute for legal, accounting, real estate, business, tax, or other professional advice. The City of Chicago assumes no liability for any damages or loss of any kind that might arise from the use of, misuse of, or the inability to use the City web site and/or the materials contained on the web site. The City of Chicago also assumes no liability for improper or incorrect use of materials or information contained on its web site. All materials that appear on the City of Chicago web site are distributed and transmitted as is, without warranties of any kind, either express or implied, and subject to the terms and conditions stated in this disclaimer.