



City of Chicago



O2016-6439

Office of the City Clerk

Document Tracking Sheet

Meeting Date:	9/14/2016
Sponsor(s):	Mell (33)
Type:	Ordinance
Title:	Issuance of permits for sign(s)/signboard(s) at 3515 -- 3517 W Lawrence Ave
Committee(s) Assignment:	Committee on Zoning, Landmarks and Building Standards

ORDINANCE

Be it ordained by the City of Chicago:

Section 1. That the Commissioner of Buildings is hereby authorized and directed to issue a sign permit to M-K Signs, Inc., 4900 N. Elston Avenue, Chicago, IL 60630, for the election of a sign/signboard over 24 feet in height and / or 100 square feet (in area of one face) at Clothes Pin Laundromats & Dry Cleaners, 3515-17 W. Lawrence Avenue, Chicago, IL 60625 with the dimensions, height and square foot area:

AWNING

Dimensions: length: 47'10" height: 4'6"

Height above grade to top of sign: 16'0"

Total Square foot area: 216 square feet

Not with standing any provisions of Title 17 of the Municipal Code, of the City of Chicago (the Chicago Zoning Ordinance) to the contrary, the Commissioner of Buildings is hereby directed and authorized to issue a sign permit to the address referenced within this ordinance.

Section 2. This ordinance shall be in force and effect from and after its passage and due publication.



Deborah Mell
Alderman, 33rd Ward

47'-10"



4'-6"

11'-0"

APPROVED: _____ DATE: _____

M-K SIGNS
 4900 N. ELSTON AVE
 CHICAGO, IL 60630
 EMAIL: Anthony.Clid70@yahoo.com
 RC@mksigns.net

CLOTHES PIN
 3253 W. LAWRENCE CHICAGO, IL

Colors represented in this drawing are for presentation purposes only. They will not match your finished product exactly. Actual color samples can be obtained from your sales representative. This design is the original and unpublished work of M-K SIGNS and may not be reproduced, copied or exhibited in any fashion without the expressed written consent of M-K SIGNS. The rights to this design may be purchased.

DATE	REVISION

SCALE	N.T.S.	DATE	8-16-16
DESIGNER	LP	SALES	TC
FILE	Clothes Pin - Lawrence Ave.	DRAWING NUMBER	2510-2



CITY OF CHICAGO

DEPARTMENT OF BUILDINGS

Sign Permit Application

APPROVAL NUMBER	APPLICATION NUMBER 100665246	ANNUAL FEE	WORK CODE	DRAWINGS ATTACHED <input type="checkbox"/> YES <input type="checkbox"/> NO
-----------------	---------------------------------	------------	-----------	--

DATE OF APPLICATION 08/17/2016	
ADDRESS OF SIGN 3515 W LAWRENCE AVE, 60625-	
BUILDING	ORIGINAL PERMIT NUMBER
TYPE OF PERMIT NEW CONSTRUCTION (SIGN)	
PAYER OF ANNUAL INSPECTION WIESER, RICHARD 3515 W LAWRENCE AVE CHICAGO, IL 60625 (773)545-4444	
SIGN MANUFACTURER M-K SIGNS, INC.	
ADDRESS WHERE SIGN CAN BE SEEN PRIOR TO ERECTION	
TICKET NUMBER 0	REINSPECTION CONTROL NUMBER
TYPE OF SUPPORT FOR SIGN AWNINGS	
SIGN BOARD SUPPORT MEMBERS STEEL	
ANNUAL FEE	
CONSTRUCTION FEE	700.00
1017 B FEE	
TOTAL FEE	700.00
AMOUNT PAID	200.00
BALANCE DUE	\$ 500.00

TYPE OF SIGN AWNING					
LENGTH	FT. 47	IN. 10	HEIGHT	FT. 4	IN. 6
AREA	SQ. FT. 215	WEIGHT		LBS. 400	
SIGN HEIGHT ABOVE GRADE/ROOF					FT. 11
SHAPE OF SIGN REGULAR					
SIGN WILL READ LAUNDROMAT CLOTHES PIN DRY CLEANERS					
NO. OF LAMPS			TOTAL WATTAGE		
TYPE OF LAMP					
NO. OF BALLAST/TRANSFORMERS			INPUT OF TRANSFORMERS		
CONTRACTOR WILL INSTALL			<input checked="" type="checkbox"/> FEEDERS <input checked="" type="checkbox"/> CUSTOMER LEADS		
TYPE OF SWITCH					
LOCATION OF SWITCH					
SIGN LOCATION CLOTHES PIN LAUNDROMAT AWNING					

The undersigned certify that the statements in this application are true and correct and that all work done under the proposed permit will conform to the requirements of the Chicago Municipal Code

REG. NO.
ELECT CONTR.
ADDRESS
SUPERVISOR SIGNATURE

BOND. NO.	REG. NO.	E05834
SIGN ERECTOR M-K SIGNS, INC.		SIGNER
ADDRESS 4900 N. ELSTON AVE. CHICAGO IL, 60630		
SIGNATURE		

The permit issued on this application will authorize only signs here applied for. If other signs are to be erected they must be covered by additional permits

City of Chicago
Rahm Emanuel, Mayor



Department of Buildings
Judith Frydland, Commissioner

TYPE OF BUSINESS COMMERCIAL Other: _____ Name: CLOTHES PIN LAUNDROMAT & DRY C LIC #: _____ Renewal Date: _____	SIGN BOND REQUIRED? <input type="checkbox"/> YES COUNCIL ORDER REQUIRED <input type="checkbox"/> YES IS SPECIAL PERMISSION REQUIRED FROM CHIEF ELECTRICAL <input type="checkbox"/> YES IF YES, ATTACH LETTER OF REQUEST
Projects Over: <input checked="" type="checkbox"/> Private Property <input checked="" type="checkbox"/> Public Way Grant Permit #: _____ <input type="checkbox"/> Planned Development/Manufacturing PMD/PD#: _____ Zoning District: B3 Other: _____	TIME STAMP
TYPE OF SIGN: <input type="checkbox"/> ADVERTISING <input type="checkbox"/> ILLUMINATE <input type="checkbox"/> MOVEABLE <input checked="" type="checkbox"/> BUSINESS <input type="checkbox"/> FLASHING	
TOTAL STREET FRONTAGE OF LOT (IN FEET) <u>50</u> TOTAL AREA OF NEW SIGN (SQ.FT.) <u>215</u> TOTAL AREA OF ALL SIGNS ON LOT (SQ.FT.) <u>1</u> HEIGHT OF SIGN ABOVE GRADE (TO TOP) <u>15ft 6in</u>	
DISTANCE OF CURB LINE OUTER EDGE (ft) <u>8</u> DISTANCE OF STRUCTURE INNER EDGE (ft) <u>10</u>	SIGN CLERK APPROVED FOR PERMIT
DISTANCE FROM (ft): A. PUBLIC PARK (OVER 10 ACRES) _____ B. EXPRESSWAY (IF LESS THAN 1,000 FT.) _____ C. RESIDENCE DISTRICT (ADVERTISING SIGNS ONLY) _____ IF REPLACEMENT SIGN OR CHANGE OF FACE, WHAT DOES THE EXISTING SIGN READ? Original Payee: _____ Landmark Hold: <input type="checkbox"/> Status: _____	REMARKS
ZONING (OFFICE USE ONLY)	

Zoning Map

Created on: 8/16/2016 12:05 P.M.

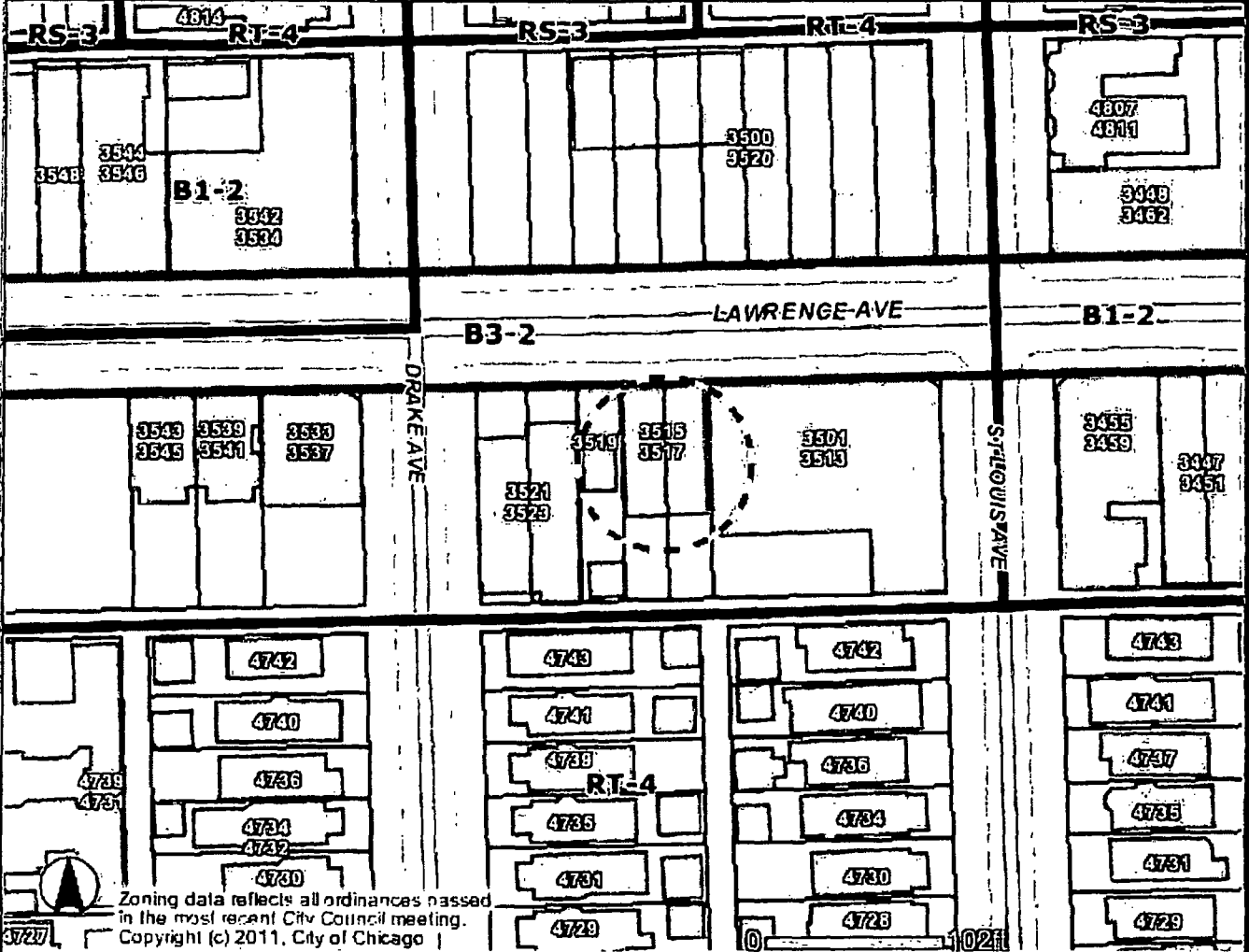

Zoning data reflects all ordinances passed in the most recent City Council meeting. Copyright (c) 2011, City of Chicago

Address
3515 W LAWRENCE AVE

<p>Zoning</p> <ul style="list-style-type: none"> <input type="checkbox"/> Business <input type="checkbox"/> Commercial <input type="checkbox"/> Manufacturing <input type="checkbox"/> Residential <input type="checkbox"/> Planned Development <input type="checkbox"/> Planned Manufacturing <input checked="" type="checkbox"/> Downtown Core <input type="checkbox"/> Downtown Service <input type="checkbox"/> Downtown Mixed <input type="checkbox"/> Downtown Residential <input checked="" type="checkbox"/> Transportation <input type="checkbox"/> Parks & Open Space <input checked="" type="checkbox"/> Zoning Boundaries 	<p>Historic Preservation</p> <p>CHICAGO LANDMARKS</p> <ul style="list-style-type: none"> <input checked="" type="checkbox"/> Chicago Landmarks <input checked="" type="checkbox"/> Landmark Districts <p>Chicago Historic Resources Survey - Buildings subject to Demolition-Delay Ordinance</p> <ul style="list-style-type: none"> <input type="checkbox"/> Red <input type="checkbox"/> Orange <input type="checkbox"/> Water <input type="checkbox"/> Cemetery <p>Municipalities</p>	<ul style="list-style-type: none"> <input checked="" type="checkbox"/> Lakefront <input checked="" type="checkbox"/> Pedestrian Streets <input type="checkbox"/> Buildings <input type="checkbox"/> Parcels <input checked="" type="checkbox"/> Streets <input type="checkbox"/> Curbs <input checked="" type="checkbox"/> Forest Preserve <input type="checkbox"/> City Boundary 	
---	---	---	--

Information provided on the City of Chicago web site should not be used as a substitute for legal, accounting, real estate, business, tax, or other professional advice. The City of Chicago assumes no liability for any damages or loss of any kind that might arise from the use of, misuse of, or the inability to use the City web site and-or the materials contained on the web site. The City of Chicago also assumes no liability for improper or incorrect use of materials or information contained on its web site. All materials that appear on the City of Chicago web site are distributed and transmitted as is, without warranties of any kind, either express or implied, and subject to the terms and

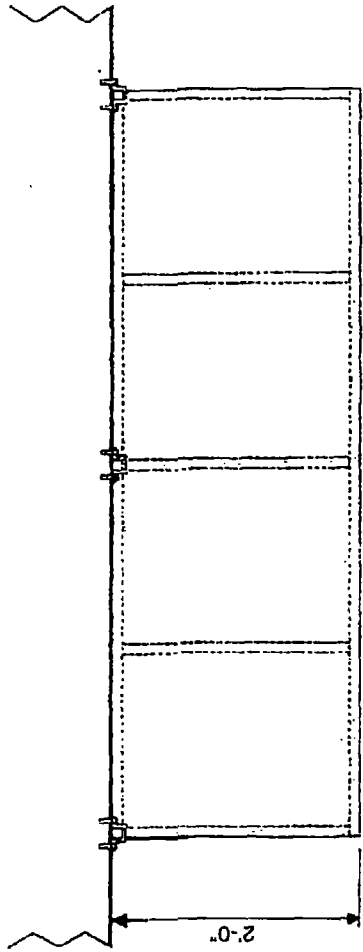
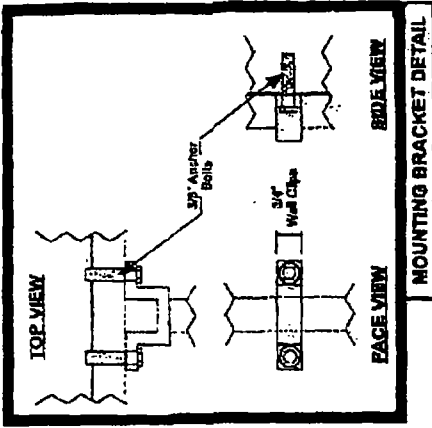

TOP VIEW

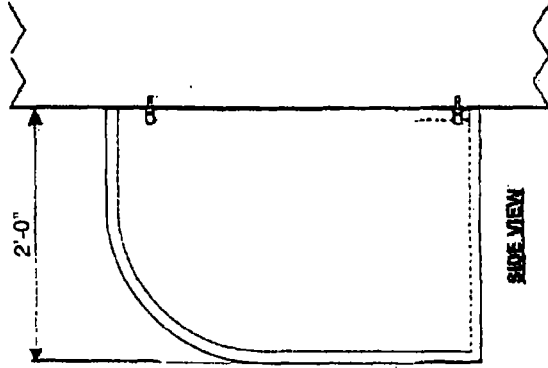

SIDE VIEW

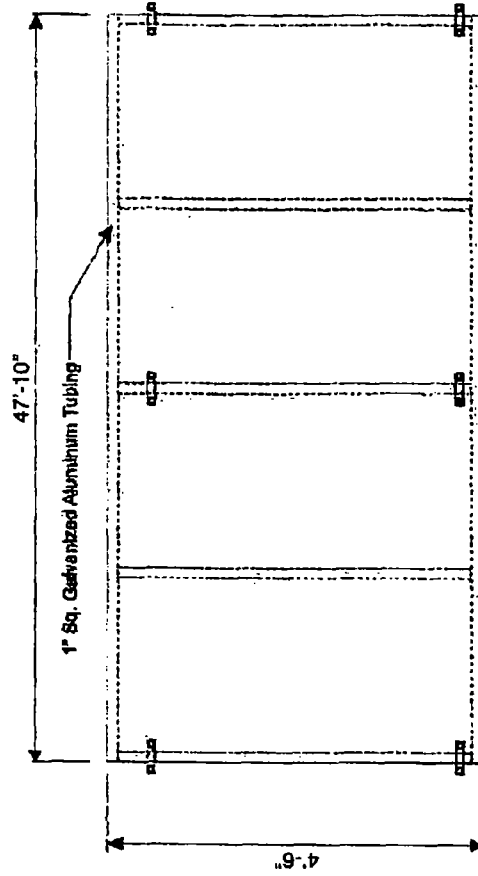

FACE VIEW

APPROVED: _____ DATE: _____

M-K SIGNS
CHICAGO

773-515-4444 / FAX: 773-545-9275
EMAIL: Anthony.Gilra70@yahoo.com
RE@mksigns.net

CLOTHES PIN
3253 W. LAWRENCE CHICAGO, IL

Colors represented in this drawing are for presentation purposes only. They will not match your finished product exactly. Actual color samples can be obtained from your sales representative. This design is the original and unpublished work of M-K SIGNS and may not be reproduced, copied or exhibited in any fashion without the expressed written consent of M-K SIGNS. The rights to this design may be purchased.

DATE	REVISION	SCALE	DATE
		N.T.S.	8-16-16
		DESIGNER	SALES
		LP	TC
		FILE	DRAWING NUMBER
		Clothes Pin - Lawrence Ave.	2510-1