



City of Chicago



O2022-1879

Office of the City Clerk

Document Tracking Sheet

Meeting Date: 6/22/2022

Sponsor(s): Sawyer (6)

Type: Ordinance

Title: Exemption from physical barrier requirement for commercial driveway alley access for Benjamin E. Mays Elementary School (Chicago Public Schools/Board of Education of City of Chicago)

Committee(s) Assignment: Committee on Transportation and Public Way

BE IT ORDAINED BY THE CITY COUNCIL OF CHICAGO:

SECTION 1. Pursuant to Section 10-20-430 of the Municipal Code of Chicago, the Commissioner of Transportation is hereby authorized and directed to exempt Benjamin E. Mays Elementary Academy (Chicago Public Schools/Board of Education of the City of Chicago), **6656 South Normal Blvd.** from the provisions requiring barriers as a prerequisite to prohibit alley ingress and egress to parking facilities for premise address.

SECTION 2. This ordinance shall take effect and be in force from and after its passage and publication.



Roderick T. Sawyer
Alderman, 6th Ward



BENJAMIN E. MAYS
ELEMENTARY ACADEMY
8854 S. NORWAY BLVD
CHICAGO, ILLINOIS 60617
PROJECT NO. 1000-1921-40P

NO.	DATE	DESCRIPTION

DESIGNED BY: [blank]
CHECKED BY: M. CH
DATE: 06/20/08-01
SCALE: 1" = 40'
11. 2008-01-11-11.01-11.01-11.01-11.01-11.01-11.01

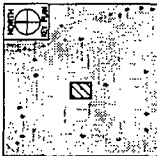

SHEET TITLE
WEST PARKING LOT

DRAWING NO
EX1.0

APRIL 18, 2008

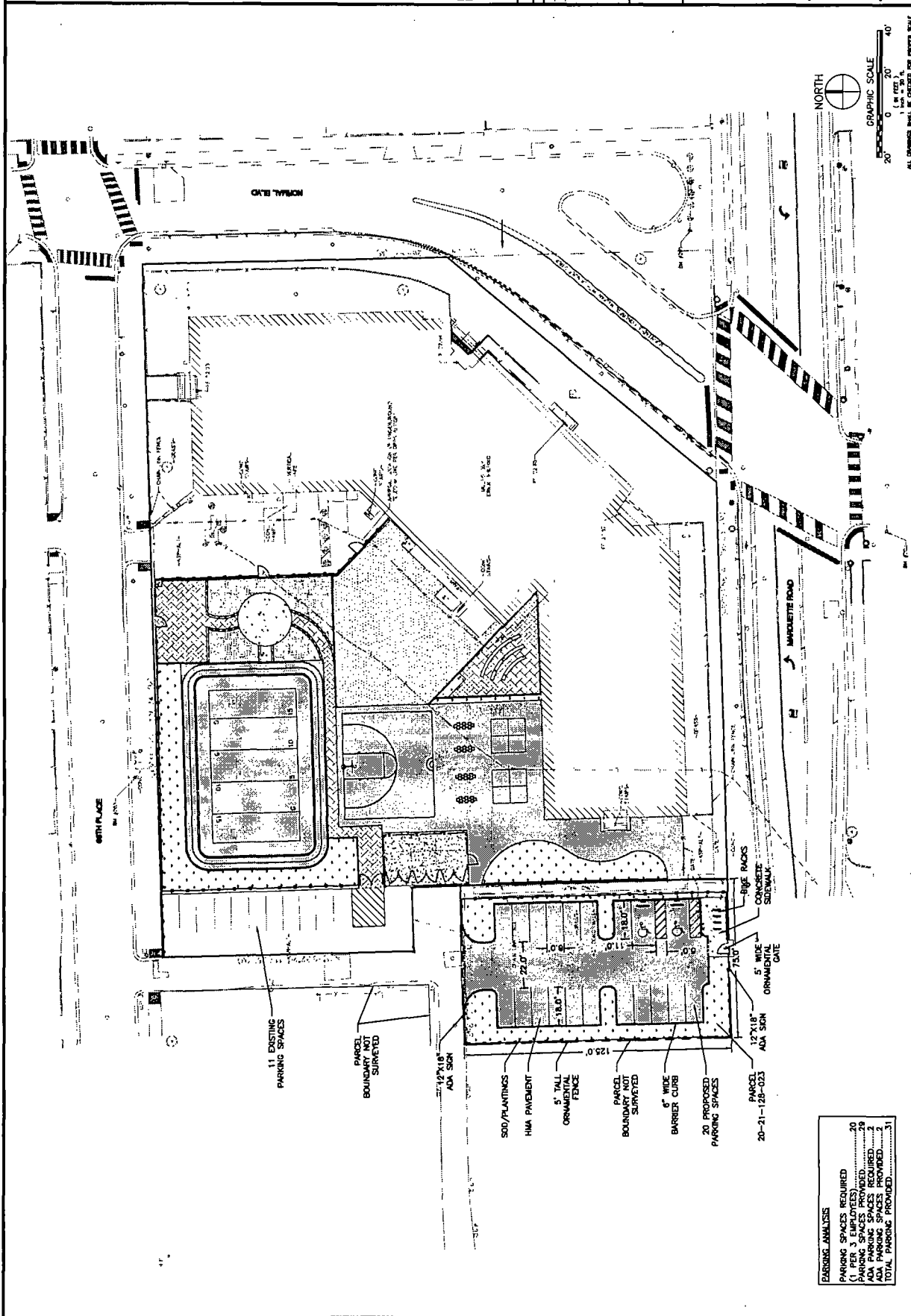

11 EXISTING PARKING SPACES

PARCEL BOUNDARY SURVEYED

12' X 18" ADA SIGN

SOO/PLANTINGS

HMA PAVEMENT

5' TALL ORNAMENTAL FENCE

PARCEL BOUNDARY NOT SURVEYED

8" WIDE BARRIER CURB

20 PROPOSED PARKING SPACES

12' X 18" ADA SIGN

5' WIDE ORNAMENTAL GATE

RISE RACKS CONCRETE SIDEWALK

PARCEL 20-21-128-023

4th PLACE

NORWAY BLVD

5th PLACE

W. FULLER ROAD

W. FULLER ROAD

W. FULLER ROAD

W. FULLER ROAD

W. FULLER ROAD

W. FULLER ROAD

W. FULLER ROAD

W. FULLER ROAD

W. FULLER ROAD

W. FULLER ROAD

W. FULLER ROAD

W. FULLER ROAD

W. FULLER ROAD

W. FULLER ROAD

W. FULLER ROAD

PARKING ANALYSIS	
PARKING SPACES REQUIRED (1 PER 3 EMPLOYEES)	20
PARKING SPACES PROVIDED	29
ADA PARKING SPACES REQUIRED	2
ADA PARKING SPACES PROVIDED	2
TOTAL PARKING PROVIDED	31

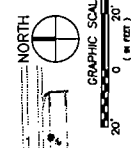

ALL DIMENSIONS SHOWN ARE CHECKED FOR PROPER SCALE.
THIS DRAWING IS THE PROPERTY OF FULLER OPENWORKS, INC. NO PART OF THIS DRAWING IS TO BE REPRODUCED OR TRANSMITTED IN ANY FORM OR BY ANY MEANS, ELECTRONIC OR MECHANICAL, WITHOUT THE WRITTEN PERMISSION OF FULLER OPENWORKS, INC.
THIS DRAWING IS THE PROPERTY OF FULLER OPENWORKS, INC. NO PART OF THIS DRAWING IS TO BE REPRODUCED OR TRANSMITTED IN ANY FORM OR BY ANY MEANS, ELECTRONIC OR MECHANICAL, WITHOUT THE WRITTEN PERMISSION OF FULLER OPENWORKS, INC.
THIS DRAWING IS THE PROPERTY OF FULLER OPENWORKS, INC. NO PART OF THIS DRAWING IS TO BE REPRODUCED OR TRANSMITTED IN ANY FORM OR BY ANY MEANS, ELECTRONIC OR MECHANICAL, WITHOUT THE WRITTEN PERMISSION OF FULLER OPENWORKS, INC.
THIS DRAWING IS THE PROPERTY OF FULLER OPENWORKS, INC. NO PART OF THIS DRAWING IS TO BE REPRODUCED OR TRANSMITTED IN ANY FORM OR BY ANY MEANS, ELECTRONIC OR MECHANICAL, WITHOUT THE WRITTEN PERMISSION OF FULLER OPENWORKS, INC.