



City of Chicago



Or2020-71

Office of the City Clerk

Document Tracking Sheet

Meeting Date:	2/19/2020
Sponsor(s):	Reilly (42)
Type:	Order
Title:	Issuance of permits for sign(s)/signboard(s) at 159 E Ohio St
Committee(s) Assignment:	Committee on Zoning, Landmarks and Building Standards

CITY COUNCIL
COMMITTEE ON ZONING, LANDMARKS AND BUILDING STANDARDS

COUNCIL ORDER

RE: Approval of sign over 100 square feet in area or over 24 feet above grade

ORDERED, that the City Council hereby approves the following sign application submitted by:

Applicant*: Ed Debevic's Restaurant

(* The Applicant is the owner of the real property or the business tenant of the real property. Do not list the sign contractor, sign erector, sign company or advertising entity in the above space.)

This Order approves the following sign in accordance with Municipal Code of Chicago Section 13-20-680:

Address of Sign: 159 E. Ohio Street Chicago, IL 60611

Zoning District: DX-12

DOB Sign Permit Application #: 100858195

Sign Details:

1. On-premise OR Off-premise
2. Static sign OR Dynamic-image display sign
3. Number of sign faces 2
4. Projecting over the public way (Yes or No) If yes, Public Way Use #: 1143559
5. Dimensions: Length 1 feet 8 inches Height 14 feet 0 inches
Total square feet in area: 23 feet 0 inches
6. Height above grade: 31 feet 0 inches
7. Elevation (side of building or lot where the sign will be erected): Ohio Street side
8. Name of Sign Contractor/Erector: Best Neon Sign Co

To be legal, such sign shall comply with all provisions of Title 17 of the Chicago Municipal Code ("Zoning Ordinance") and all other provisions of the Municipal Code governing the permitting, construction and maintenance and removal of signs and sign structures. Failure of the applicant and the applicant's successors to comply shall be grounds for invalidation or revocation of the sign permit.

Alderman

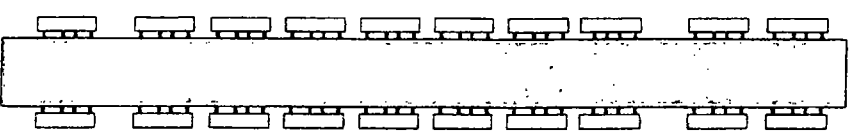
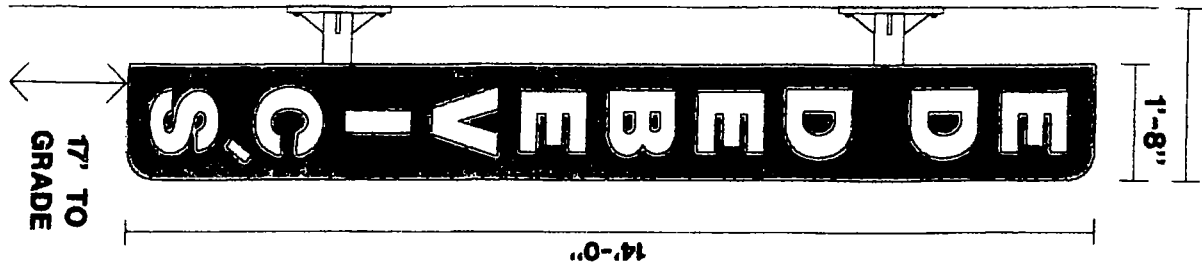

Ward

3' FROM WALL

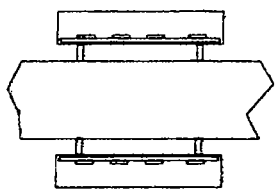

STREET SIDE
OF SIGN
SATIN ALUMINIUM
FINISH

WHITE LED
ILLUMINATION WASHES
ON SIGN FACE
LED MODULES MOUNTED
ON FLEXIGLAS BACKING
INSIDE LETTER
LETTER MOUNTED TO
BACKING WITH ALUMINIUM
STAND-OFFS



HALO LIT LETTERS
CROSS-SECTION

DETAIL OF BEAM MOUNT
4" STEEL TUBE/GUSSETS WELDED
TO .5" STEEL PLATE/BOLTED TO
BACKING PLATE WITH .5" GALV. BOLTS

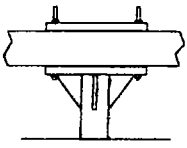

14'x1'-8" DOUBLE FACE BLADE SIGN
WITH 11.5" REVERSE LIT CHANNEL LETTERS
WHITE LETTERS/WHITE HALO ILLUMINATION
MOUNTED ON RED FACE OF SIGN

BEFORE

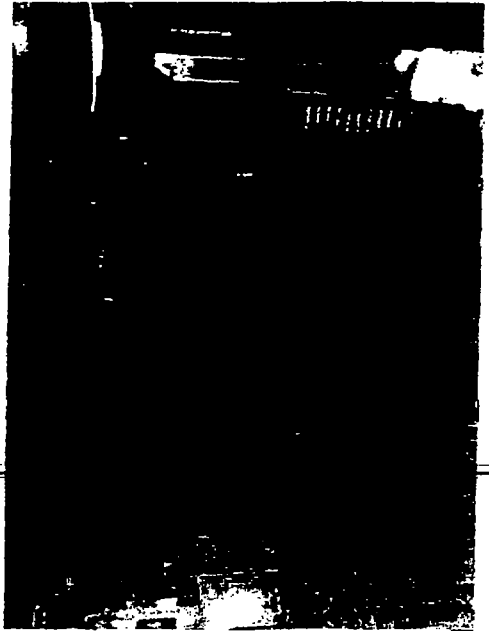

AFTER

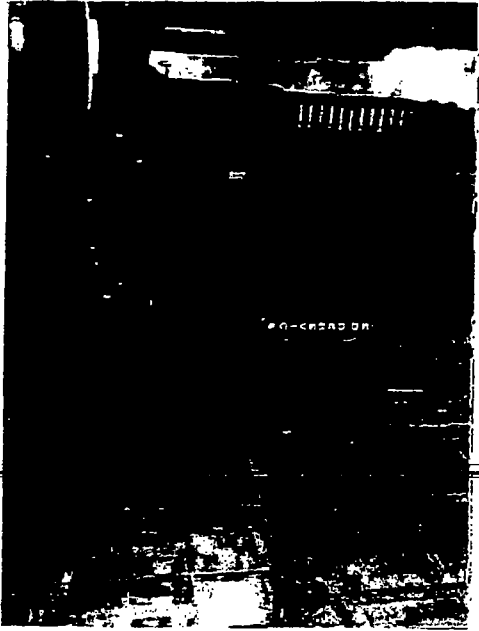

SHOWN INSTALLED ON NORTH ELEVATION

**Best Neon
Sign**

SCALE	NO. SCALE	DATE	BY
CUSTOMER	ED DEBEVICS		
ADDRESS	150 E. OHIO ST.		
CITY	CHICAGO	STATE	IL
ARTIST	lg	DATE	1/21/20
APPROVED		DATE	
CUSTOMER APPROVAL:			

By signing the approval box on this sketch, I understand that I am accepting all aspects of this drawing. This includes artwork, specifications, dimensions, spelling and any other representations herein. I also understand that color reproductions on this sketch are approximate, and may not match manufactured product exactly.