



City of Chicago



O2013-9698

Office of the City Clerk

Document Tracking Sheet

Meeting Date:	12/11/2013
Sponsor(s):	Reilly (42)
Type:	Ordinance
Title:	Grant(s) of privilege in public way for Wildfire
Committee(s) Assignment:	Committee on Transportation and Public Way

ORDINANCE
WILDFIRE
Acct. No. 8677 - 2
Permit No. 1109703

Be It Ordained by the City Council of the City of Chicago:

SECTION 1. Permission and authority are hereby given and granted to WILDFIRE, upon the terms and subject to the conditions of this ordinance to maintain and use, as now constructed, a portion of the public right-of-way for an existing Permanent Café Enclosure adjacent to its premises known as 159 W. Erie Street. Existing area is approximately one hundred four (104) feet in length and seven (7) feet in width for a total square footage of seven hundred twenty-eight (728).

The location of said privilege shall be as shown on prints kept on file with the Department of Business Affairs and Consumer Protection and the Office of the City Clerk.

Said privilege shall be constructed in accordance with plans and specifications approved by the Department of Planning and Development and Department of Transportation (Division of Project Development).

This grant of privilege in the public way shall be subject to the provisions of Section 10-28-015 and all other required provisions of the Municipal Code of Chicago.

The grantee shall pay to the City of Chicago as compensation for the privilege #1109703 herein granted the sum of five thousand seven hundred ninety-two (\$5,792.00) per annum in advance.

A 25% penalty will be added for payments received after due date.

The permit holder agrees to hold the City of Chicago harmless for any damage, relocation or replacement costs associated with damage, relocation or removal of private property caused by the City performing work in the public way.

Authority herein given and granted for a period of five (5) years from and after 12/14/2013.

Alderman _____

Brendan Reilly 42nd Ward

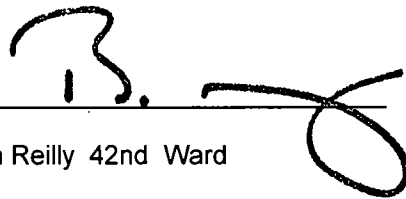
A handwritten signature in black ink, appearing to be 'B. Reilly', written over a horizontal line. The signature is stylized and includes a large loop at the end.

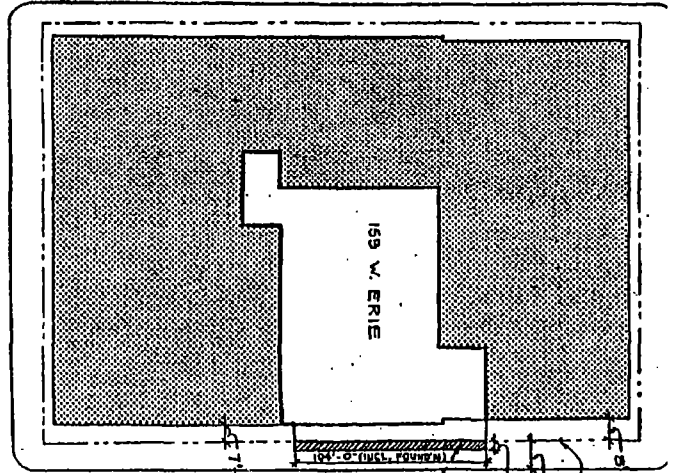

LASALLE STREET

169 W. ERIE
SITE PLAN

SCALE: 1" = 60'-0"



PROPERTY LINE
10'-0 1/2"
8'-0 1/2" ON PUBLIC WAY
(INCLUDES 1'-0" FOR
FOUNDATION SPREAD)
PERMANENT CAPE
ENCLOSURE ON
PUBLIC WAY
ERIE STREET

11' 5 1/2"