



# City of Chicago



O2014-367

Office of the City Clerk

## Document Tracking Sheet

<b>Meeting Date:</b>	1/15/2014
<b>Sponsor(s):</b>	Reilly (42)
<b>Type:</b>	Ordinance
<b>Title:</b>	Grant(s) of privilege in public way for JHTC Holdings LLC
<b>Committee(s) Assignment:</b>	Committee on Transportation and Public Way

ORDINANCE  
JHTC Holdings LLC  
Acct. No. 385570 - 1  
Permit No. 1108991

*Be It Ordained by the City Council of the City of Chicago:*

SECTION 1. Permission and authority are hereby given and granted to JHTC Holdings LLC, upon the terms and subject to the conditions of this ordinance to maintain and use, as now constructed, twelve (12) Vault(s) under the public right-of-way adjacent to its premises known as 875 N. Michigan Ave..

Vault #1 at N. Miles Van Der Rohe measure(s):

One (1) at one hundred fifteen point five eight (115.58) feet in length, and fifteen (15) feet in width for a total of one thousand seven hundred thirty-three point seven (1733.7) square feet. Existing vault is used for Regional Commonwealth Edison equipment.

Vault #2 at E. Chestnut measure(s):

Commencing at a point on north line of East Chestnut Street, twenty (20) feet four (4) inches west of the west line North Seneca Avenue, then proceeding in a westerly direction a distance of seventy (70) feet one (1) inch. Existing vault being twenty (20) feet four (4) inches in width and is used for mechanical space, housing electrical switchboard and water pump.

Vault #3 at E. Chestnut measure(s):

Commencing at a point on the north line of East chestnut Street, ninety (90) feet five (5) inches west of west line North Seneca Avenue; the proceeding in a westerly direction a distance of forty-five (45) feet six (6) inches. The width of existing vault is twenty (20) feet four (4) inches and is used as a building services area containing lockers, toilet and supplies.

Vault #4 at E. chestnut measure(s):

Commencing at a point on the north line of East chestnut Street, one hundred thirty-five (135) feet eleven (11) inches west of the west line of North Seneca Avenue; then proceeding in a westerly direction along the north line of East Chestnut Street, a distance of sixty-three (63) feet five (5) inches. Existing vault is twenty (20) feet four (4) inches in width and contains a loading dock.

Vault #5 at E. Chestnut measure(s):

Commericing at a point one hundred ninety-nine (199) feet west of the west line of North Seneca Avenue; thence in a westerly direction along the north line of East Chestnut Street, a distance of one hundred sixty (160) feet one (1) inch. Existing vault is twenty (20) feet four (4) inches in width and contains commercial storage and kitchen equipment for restaurant.

Vault #6 at E. Chestnut measure(s):

Commencing at a point on the north line of East Chestnut Street, three hundred fifty-nine (359) feet west of the west line of North Seneca Avenue, then proceeding in a westerly direction a distance of one hundred ninety (190) feet eleven (11) inches to the east line of North Michigan Avenue. Existing vault is twenty (20) feet four (4) inches in width and is used for restaurant and dining facilities..

Vault #7 at E. Delaware measure(s):

Commencing at a point on the north line of East Delaware Place, approximately one hundred twenty-five (125) feet west of the west line of North Seneca Avenue, then proceeding in a westerly direction along the south line of East Delaware Place, a distance of sixty-three (63) feet four (4) inches. Existing vault is twenty-one (21) feet ten (10) inches in width and is used for a loading dock.

Vault # 8 at E. Delaware measure(s):

Commencing at a point on the south line of East Delaware Place one hundred eighty-eight (188) feet four (4) inches west of the west line of North Seneca Avenue, then proceeding westerly along the south line of East Delaware Place, a distance of one hundred seventy-seven (177) feet. Existing vault space is twenty-one (21) feet ten (10) inches in width at this point and is used for mechanical equipment and partially occupied by a retail tenant.

Vault #9 at E. Delaware measure(s):

Commencing at a point line of East Delaware Place on one hundred thirty (130) feet six (6) inches east of the east line of North Michigan Avenue, then proceeding west along the south line of East Delaware Place, a distance of twenty-one (21) feet ten (10) inches in width and sixty-four (64) feet in length, outside dimensions housing heating, cooling and air handling equipment.

Vault #10 at E. Delaware measure(s):

Commencing at a point on the south line of East Delaware Place, east of the east line of North Michigan Avenue, then proceeding in a westerly direction a distance of seventy-two (72) feet six (6) inches. Existing vault begin twenty-one (21) feet ten (10) inches in width, outside dimensions occupied by commercial restaurant tenant.

Vault #11 at E. Delaware measure(s):

Commencing at a point on the south line of East Delaware Place, nineteen (19) feet six (6) inches east of the east line of North Michigan Avenue, then proceeding in a westerly direction a distance of nine (9) feet eight (8) inches by twenty-one (21) feet ten (10) inches occupied by commercial tenant.

Vault #12 at E. Delaware measure(s):

Commencing at a point on the south line of East Delaware Place, nine (9) feet eight (8) inches east of the east line of North Michigan Avenue, then proceeding in a westerly direction a distance of nineteen (19) feet eight (8) inches to the east line of North Michigan Avenue by twenty-one (21) feet ten (10) inches. Occupied by commercial restaurant tenant.

The location of said privilege shall be as shown on prints kept on file with the Department of Business Affairs and Consumer Protection and the Office of the City Clerk.

Said privilege shall be constructed in accordance with plans and specifications approved by the Department of Transportation (Office of Underground Coordination).

This grant of privilege in the public way shall be subject to the provisions of Section 10-28-015 and all other required provisions of the Municipal Code of Chicago.

The grantee shall pay to the City of Chicago as compensation for the privilege #1108991 herein granted the sum of one hundred thirteen thousand five hundred twenty-eight (\$113,528.00) per annum in advance.

A 25% penalty will be added for payments received after due date.

The permit holder agrees to hold the City of Chicago harmless for any damage, relocation or replacement costs associated with damage, relocation or removal of private property caused by the City performing work in the public way.

Authority herein given and granted for a period of five (5) years from and after Date of Passage.

Alderman 

Brendan Reilly 42nd Ward

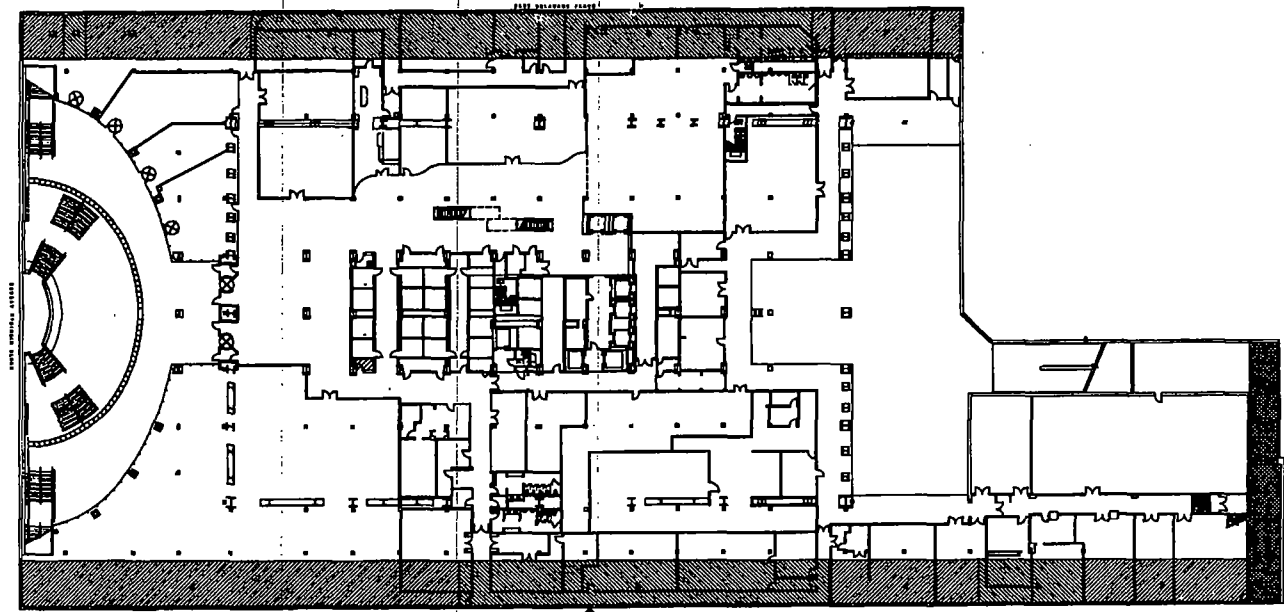

- |                                  |                                 |                      |                                 |
|----------------------------------|---------------------------------|----------------------|---------------------------------|
| 1. COM ED                        | 15'-0" X 115'-7" = 1,782 SQ/FT  | 7. COMMERICAL SPACE  | 63'-4" X 21'-10" = 1,396 SQ/FT  |
| 2. BUILDING MECHANICAL SPACE     | 70'-1" X 20'-4" = 1,420 SQ/FT   | 8. COMMERICAL SPACE  | 177'-0" X 21'-10" = 3,769 SQ/FT |
| 3. BUILDING SERVICE AREA         | 45'-6" X 20'-4" = 920 SQ/FT     | 9. COMMERICAL SPACE  | 64'-0" X 21'-10" = 1,329 SQ/FT  |
| 4. BUILDING LOADING DOCK/STORAGE | 63'-5" X 20'-4" = 1,280 SQ/FT   | 10. COMMERICAL SPACE | 72'-6" X 21'-10" = 1,482 SQ/FT  |
| 5. COMMERICAL STORAGE/EQUIPMENT  | 160'-1" X 20'-4" = 3,220 SQ/FT  | 11. COMMERICAL SPACE | 9'-8" X 21'-10" = 196 SQ/FT     |
| 6. COMMERICAL USE                | 190'-11" X 20'-4" = 3,998 SQ/FT | 12. COMMERICAL SPACE | 19'-8" X 21'-10" = 390 SQ/FT    |

# TECHNO<sub>LD.</sub>

ARCHITECTURE • INTERIOR DESIGN • FACILITY MANAGEMENT  
67 EAST MADISON STREET, SUITE 1405  
CHICAGO, ILLINOIS 60603  
TELEPHONE 312.920.0060 FAX 312.920.0061

## JOHN HANCOCK CENTER VAULTS

SHEET TITLE:

JOB NO.:

DATE:

SCALE:

9.9.13

NTS

DRAWN BY: