



# City of Chicago



O2016-47

Office of the City Clerk

## Document Tracking Sheet

<b>Meeting Date:</b>	1/13/2016
<b>Sponsor(s):</b>	Misc. Transmittal
<b>Type:</b>	Ordinance
<b>Title:</b>	Zoning Reclassification Map No. 4-H at 1830-1858 W 19th St - App No. 18614
<b>Committee(s) Assignment:</b>	Committee on Zoning, Landmarks and Building Standards

#18614  
INTRO DATE  
JAN 13, 2016

**ORDINANCE**

***BE IT ORDAINED BY THE CITY COUNCIL OF THE CITY OF CHICAGO:***

***SECTION 1.*** Title 17 of the Municipal Code of Chicago, the Chicago Zoning Ordinance, is hereby amended by changing all the Institutional Planned Development No. 639 symbols and indications as shown on Map No. 4-H in the area bounded by:

South Wolcott Avenue or the line thereof if extended where no street exists; a line 150.20 feet north of West 19<sup>th</sup> Street; a line 356 feet east of South Wolcott Avenue or the line thereof if extended where no street exists; West 19<sup>th</sup> Street and South Wolcott Avenue or the line thereof if extended where no street exists.

to those of Institutional Planned Development No. 639, as amended and a corresponding use district is hereby established in the area above described.

***SECTION 2.*** This ordinance shall be in force and effect from and after its passage and due publication

Address of Property: 1830-58 West 19<sup>th</sup> Street

## STANDARD PLANNED DEVELOPMENT STATEMENTS

The Planned Development Statements describe the legal regulations and conditions that will control the development of the proposed project. The following statements shall be included in the ordinance; any proposed changes to these statements must be discussed and reviewed with the Chicago Department of Planning and Development. Based on the scope of the project, additional statements (listed at the end of this document) may be required. The following statements must be included in the ordinance:

1. The area delineated herein as Institutional Planned Development Number #639, as amended (“Planned Development”) consists of approximately 61,565 square feet (approximately 1.41 acres) which is depicted on the attached Boundary Line Map (“Property”) and is controlled by the Applicant, The National Museum of Mexican Art.
2. The requirements, obligations and conditions contained within this Planned Development shall be binding upon the Applicant, its successors and assigns and, if different than the Applicant, the legal title holders and any ground lessors. All rights granted hereunder to the Applicant shall inure to the benefit of the Applicant’s successors and assigns and, if different than the Applicant, the legal title holder and any ground lessors. Furthermore, pursuant to the requirements of Section 17-8-0400 of the Chicago Zoning Ordinance, the Property, at the time of application for amendments, modifications or changes (administrative, legislative or otherwise) to this Planned Development are made, shall be under single ownership or designated control. Single designated control is defined in Section 17-8-0400 of the Zoning Ordinance.
3. All applicable official reviews, approvals or permits are required to be obtained by the Applicant or its successors, assignees or grantees. Any dedication or vacation of streets or alleys or grants of easements or any adjustment of the right-of-way shall require a separate submittal to the Department of Transportation on behalf of the Applicant or its successors, assign or grantees.

Any requests for grants of privilege, or any items encroaching on the public way, shall be in compliance with the Plans.

Ingress or egress shall be pursuant to the Plans and may be subject to the review and approval of the Departments of Planning and Development and Transportation. Closure of all or any public street or alley during demolition or construction shall be subject to the review and approval of the Department of Transportation.

All work proposed in the public way must be designed and constructed in accordance with the Department of Transportation Construction Standards for Work in the Public Way and in compliance with the Municipal Code of the City of Chicago. Prior to the issuance of any Part II approval, the submitted plans must be approved by the Department of Transportation.

Applicant: The National Museum of Mexican Art  
Address: 1830-1858 West 19<sup>th</sup> Street  
Introduced: January 13, 2016  
Plan Commission:

4. This Plan of Development consists of fifteen (15) Statements: a Bulk Regulations & Data Table; Zoning Map; Boundary Line Map; Land Use Map; Site Plan; Landscape Plan; Aerial Site Plan; and Building Elevations (North, South, East and West) and Rendering submitted herein. Full-sized copies of the Site Plan are on file with the Department of Planning and Development. In any instance where a provision of this Planned Development conflicts with the Chicago Building Code, the Building Code shall control. This Planned Development conforms to the intent and purpose of the Zoning Ordinance, and all requirements thereto, and satisfies the established criteria for approval as a Planned Development. In case of a conflict between the terms of this Planned Development Ordinance and the Zoning Ordinance, this Planned Development Ordinance shall control.
5. The following uses shall be allowed in the area delineated herein as an Institutional Planned Development #639, as amended:

Museum and Accessory Uses, including accessory education and research facilities, libraries, bookstores, restaurants, auditoriums and theatres; Community Center, Accessory Parking.
6. On-Premise signs and temporary signs, such as construction and marketing signs, shall be permitted within the Planned Development, subject to the review and approval of the Department of Planning and Development. Off-Premise signs are prohibited within the boundary of the Planned Development.
7. For purposes of height measurement, the definitions in the Zoning Ordinance shall apply. The height of any building shall also be subject to height limitations, if any, established by the Federal Aviation Administration.
8. The maximum permitted Floor Area Ratio ("FAR") for the site shall be in accordance with the attached Bulk Regulations Table. For the purposes of FAR calculations and measurements, the definitions in the Zoning Ordinance shall apply. The permitted FAR identified in the Bulk Regulations Table has been determined using a Net Site Area of 53,570 square feet (approximately 1.23 acres)
9. Upon review and determination, "Part II Review", pursuant to Section 17-13-0610 of the Zoning Ordinance, a Part II Review Fee shall be assessed by the Department of Planning and Development. The fee, as determined by staff at the time, is final and binding on the Applicant and must be paid to the Department of Revenue prior to the issuance of any Part II approval.
10. The Site and Landscape Plans shall be in substantial conformance with the Landscape Ordinance and any other corresponding regulations and guidelines. Final landscape plan review and approval will be by the Department of Planning and Development. Any interim reviews associated with site plan review or Part II reviews are conditional until final Part II approval.

Applicant: The National Museum of Mexican Art  
Address: 1830-1858 West 19<sup>th</sup> Street  
Introduced: January 13, 2016  
Plan Commission:

11. The Applicant shall comply with Rules and Regulations for the Maintenance of Stockpiles promulgated by the Commissioners of the Departments of Streets and Sanitation, Environment and Buildings, under Section 13-32-125 of the Municipal Code, or any other provision of that Code.
12. The terms and conditions of development under this Planned Development ordinance may be modified administratively, pursuant to section 17-13-0611-A of the Zoning Ordinance by the Zoning Administrator upon the application for such a modification by the Applicant, its successors and assigns and, if different than the Applicant, the legal title holders and any ground lessors.
13. The Applicant acknowledges that it is in the public interest to design, construct and maintain the project in a manner which promotes, enables and maximizes universal access throughout the Property. Plans for all buildings and improvements on the Property shall be reviewed and approved by the Mayor's Office for People with Disabilities to ensure compliance with all applicable laws and regulations related to access for persons with disabilities and to promote the highest standard of accessibility.
14. The Applicant acknowledges that it is in the public interest to design, construct, renovate and maintain all buildings in a manner that provides healthier indoor environments, reduces operating costs and conserves energy and natural resources. Building certification will be LEED, Energy Star or Chicago Green Homes.
15. This Planned Development shall be governed by Section 17-13-0612 of the Zoning Ordinance. Should this Planned Development ordinance lapse, the Commissioner of the Department of Planning and Development shall initiate a Zoning Map Amendment to rezone the property to a RT4 Residential, Two-Flat, Townhome and Multi-Unit District.

Applicant: The National Museum of Mexican Art  
Address: 1830-1858 West 19<sup>th</sup> Street  
Introduced: January 13, 2016  
Plan Commission:

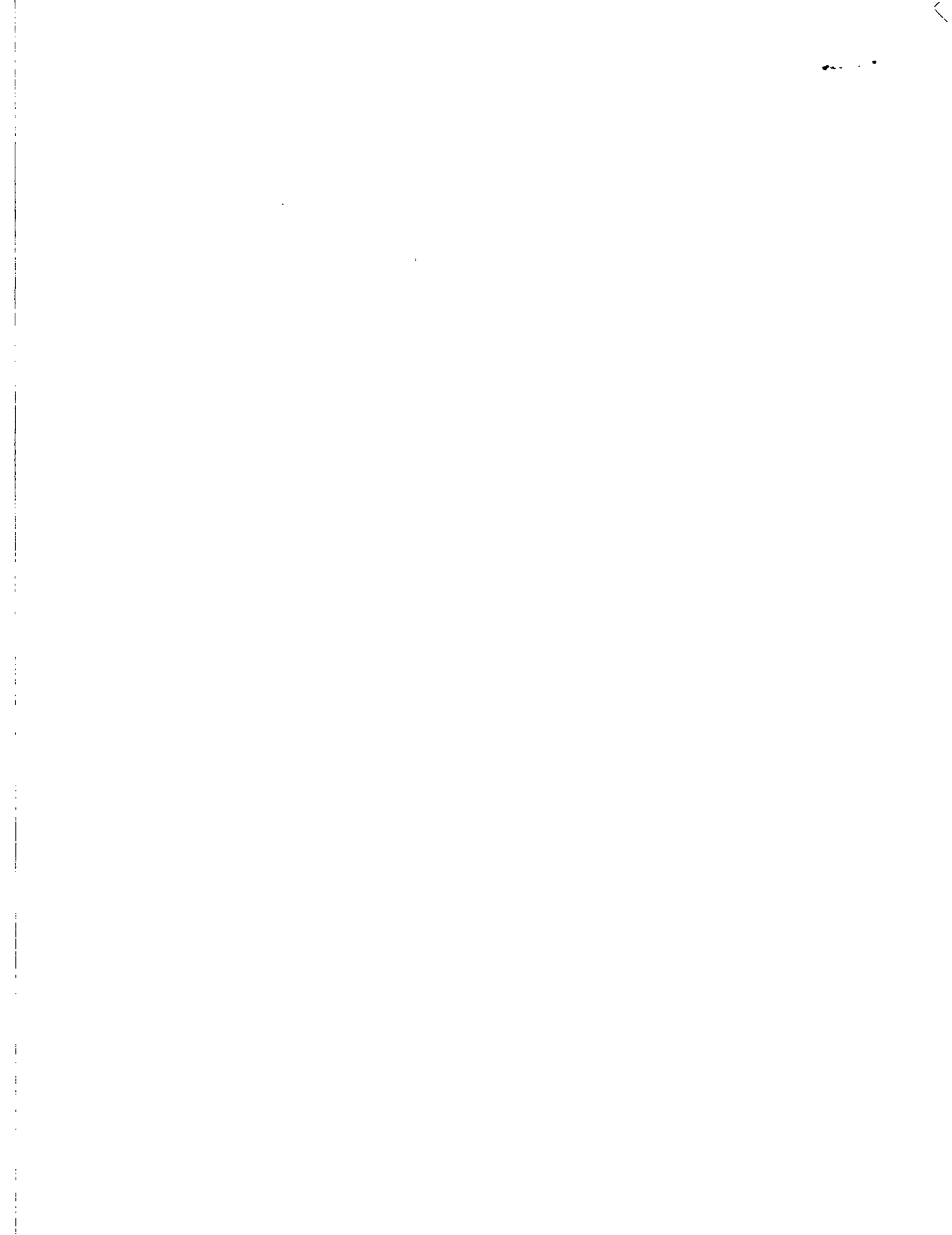

Institutional Planned Development Number 639, as Amended

Plan of Development

Bulk Regulations and Data Table

Net Site Area:	53,470 square feet (1.23 acres)
Area in Public Right of Way:	8,095 square feet (0.18 acres)
Gross Site Area:	61,565 square feet (1.41 acres)
Maximum Permitted Floor Area Ratio:	1.2 (as approved under Institutional Planned Development #639)
Setbacks from Property Line:	Substantial conformance with the Site/Landscape Plan
Maximum Percentage of Site Coverage:	Substantial conformance with the Site/Landscape Plan
Maximum Building Height:	Substantial conformance with the Building Elevations
Minimum Number of Off-Street Parking Spaces:	50
Minimum Number of Off-Street Loading Spaces:	0

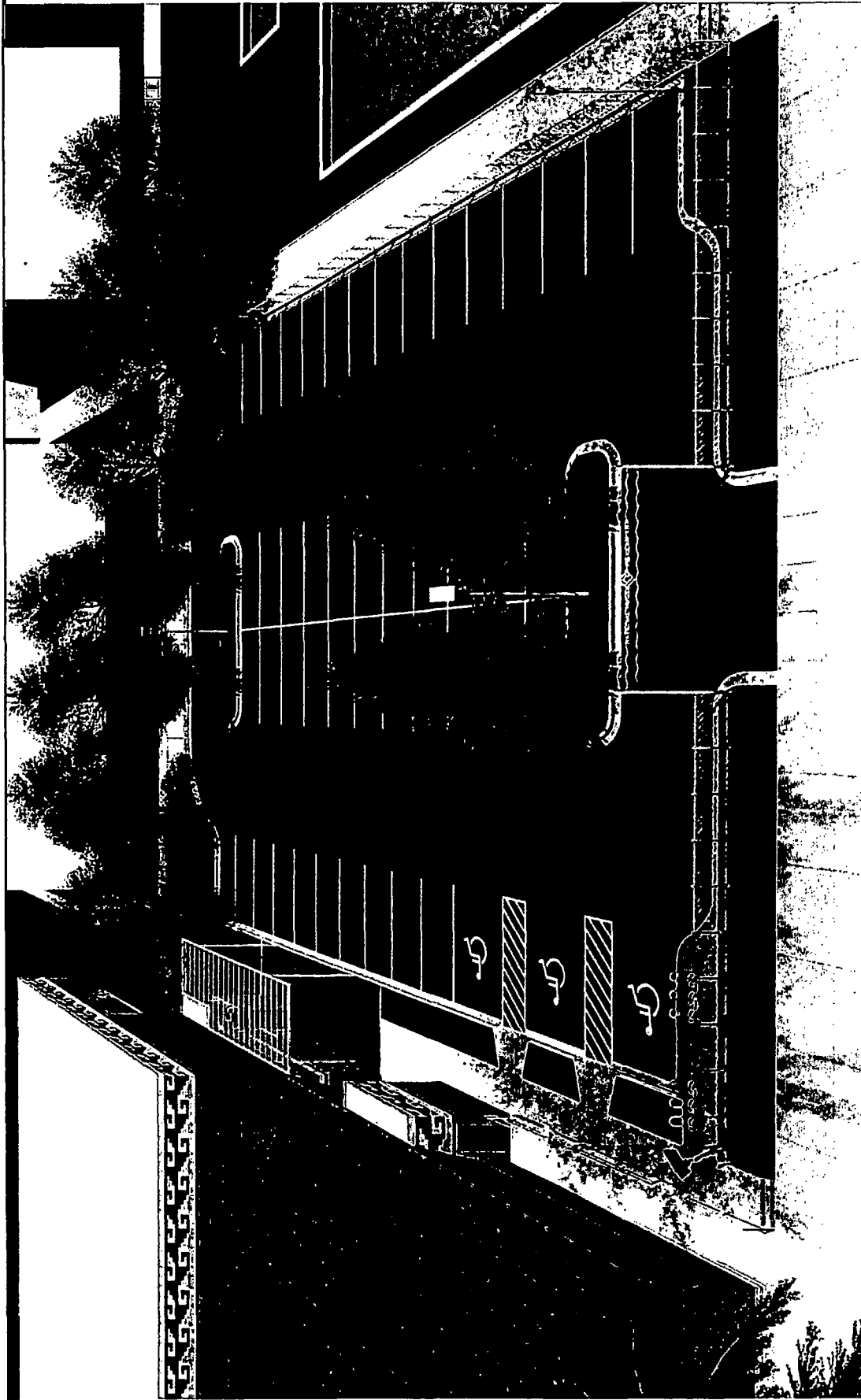

APPLICANT: THE NATIONAL MUSEUM OF MEXICAN ART  
PROPERTY: 1852 W. WEST 19TH STREET,  
COMMONLY KNOWN AS 1852 WEST 19TH STREET)  
INTRODUCED: JANUARY 13, 2016  
PLAN COMMISSION:

**Wallin + Gomez**  
**ARCHITECTS LTD**  
711 South Dearborn Street, Suite 606  
Chicago, Illinois 60605-1927  
P 312-427-4702 • F 312-427-8611

NMMA PARKING LOT DESIGN RENDERING  
HALF SIZE

1852 W 19TH ST  
CHICAGO, IL 60608

SCALE: 1/8" = 1'-0"

Z-00







**Wallin + Gomez**  
**ARCHITECTS LTD**  
 711 South Dearborn Street, Suite 606  
 Chicago, Illinois 60605-1827  
 P. 312-427-4702 • F. 312-427-4811

APPLICANT: THE NATIONAL MUSEUM OF MEXICAN ART  
 PROPERTY: 1850-58 WEST 19TH STREET  
 (COMMONLY KNOWN AS 1852 WEST 19TH STREET)  
 INTRODUCED: JANUARY 13, 2018  
 PLAN COMMISSION:

**01** AERIAL SITE PLAN

NMMA PARKING LOT DESIGN  
 AERIAL SITE PLAN  
 HALF SIZE  
 1852 W 19TH ST  
 CHICAGO, IL 60608  
 Z-0



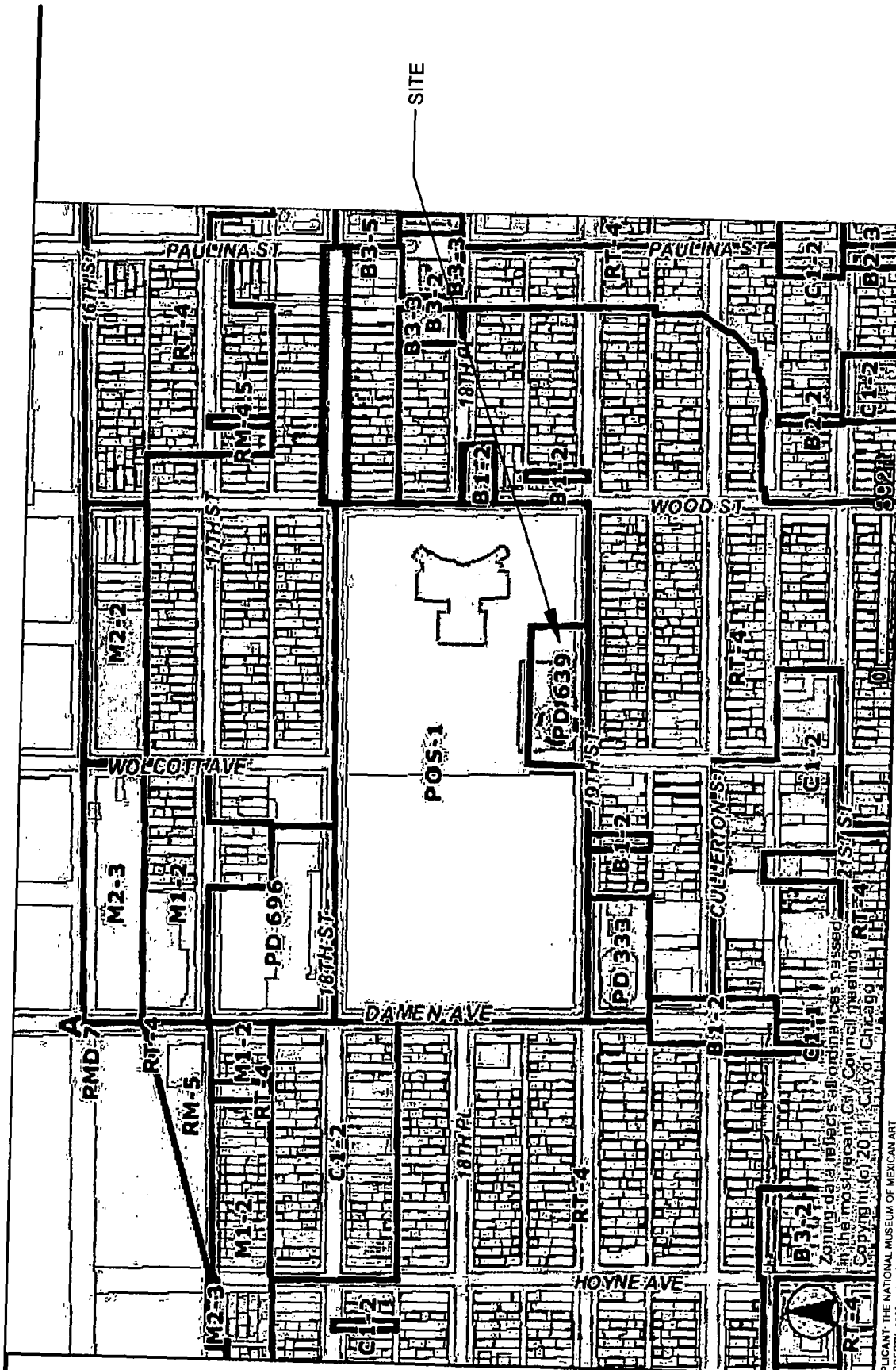

NIMMA PARKING LOT DESIGN ZONING MAP  
 HALF SIZE

1852 W 19TH ST  
 CHICAGO, IL 60608  
 Z-1



APPLICANT: THE NATIONAL MUSEUM OF MEXICAN ART  
 PROPERTY: 1830-58 WEST 18TH STREET  
 COMMONLY KNOWN AS 1852 WEST 19TH STREET  
 INTRODUCED: JANUARY 13, 2016  
 PLAN COMMISSION:

Wallin - Gomez  
 ARCHITECTS LTD  
 711 South Dearborn Street, Suite 606  
 Chicago, Illinois 60605-1827  
 P. 312-427-4702 • F. 312-427-4611



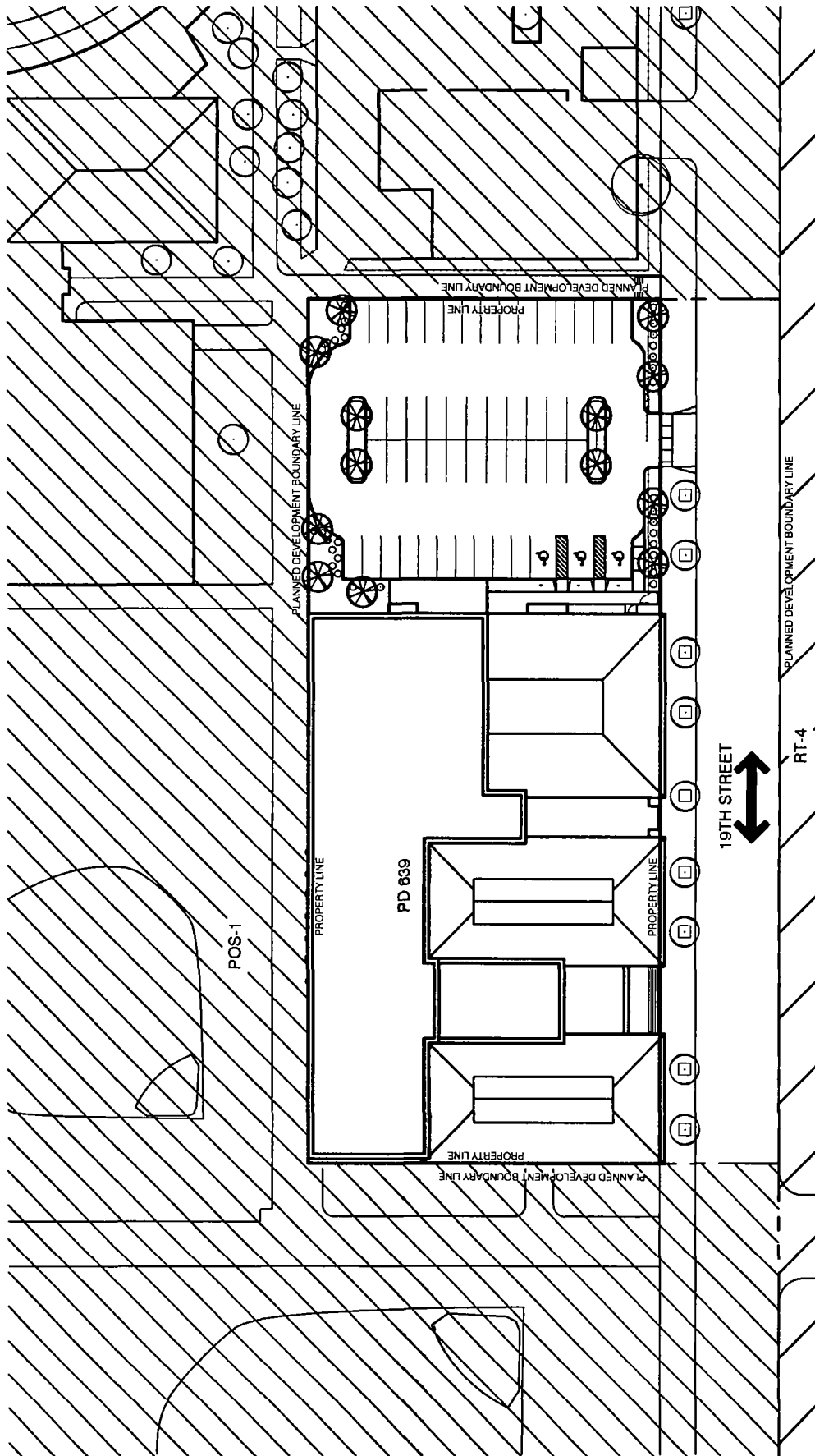

**Wallin + Gomez**  
**ARCHITECTS LTD**  
 711 South Dearborn Street, Suite 606  
 Chicago, Illinois 60605-1827  
 P: 312-427-4702 • F: 312-427-4611

APPLICANT: THE NATIONAL MUSEUM OF MEXICAN ART  
 PROPERTY: 1852 WEST 19TH STREET  
 (COMMONLY KNOWN AS 1852 WEST 19TH STREET)  
 INTRODUCED: JANUARY 13, 2016  
 PLAN COMMISSION:



**BOUNDARY LINE SITE PLAN**

SCALE: 1" = 40'

NMMA PARKING LOT DESIGN  
 BOUNDARY  
 LINE MAP  
 HALF SIZE

1852 W 19TH ST  
 CHICAGO, IL 60608  
**Z-2**

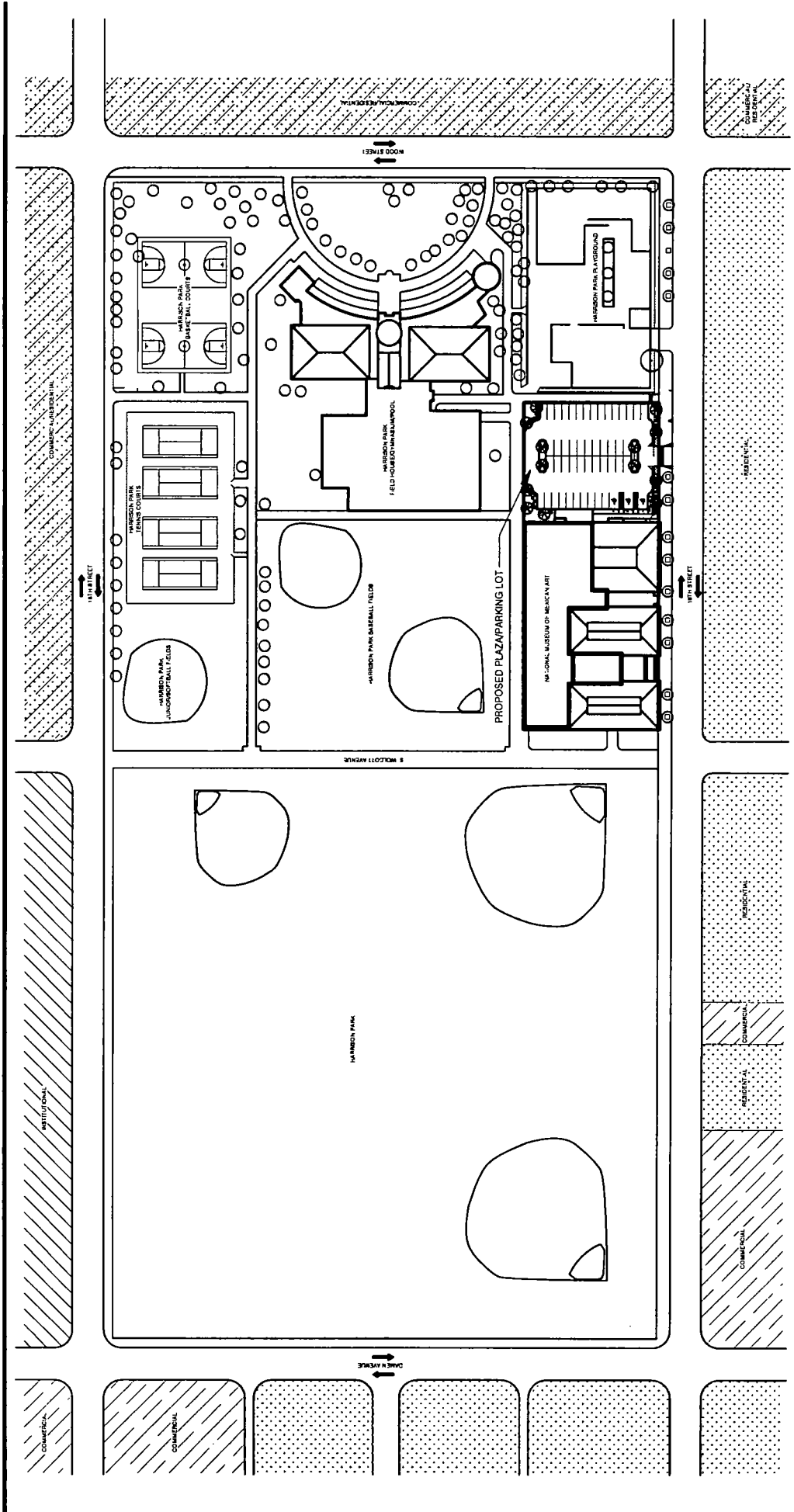

**Wallin = Gomez**  
**ARCHITECTS LTD**  
 711 South Dearborn Street, Suite 606  
 Chicago, Illinois 60605-1827  
 P 312-427-4702 • F 312-427-4811

APPLICANT: THE NATIONAL MUSEUM OF MEXICAN ART  
 PROPERTY: 1852 WEST 19TH STREET  
 (COMMONLY KNOWN AS 1852 WEST 19TH STREET)  
 INTRODUCED: JANUARY 13, 2016  
 PLAN COMMISSION:

**01** LAND USE MAP

SCALE: 1" = 100'

**NMMA PARKING LOT DESIGN**  
**LAND USE**  
**MAP**  
**HALF SIZE**  
 1852 W 19TH ST  
 CHICAGO, IL 60608  
**Z-3**





January 5, 2016

Chairman, Committee on Zoning  
Room 304 – City Hall  
Chicago, Illinois 60602

Committee Members:

I, Eimy Rosales, as Business Director of The National Museum of Mexican Art, understand that Sylvia C. Michas of Chico & Nunes, PC has filed a sworn affidavit identifying The National Museum of Mexican Art as the Applicant/Lessee of the property located at 1830-58 West 19<sup>th</sup> Street Chicago, IL who is seeking an amendment of the zoning for the property located at 1830-58 West 19<sup>th</sup> Street from the existing Institutional Planned Development #639 to Institutional Planned Development #639, as amended.

I authorize Sylvia C. Michas and the law firm of Chico & Nunes, PC to file the Institutional Planned Development application.

I, Eimy Rosales, as Business Director of The National Museum of Mexican Art, being first duly sworn on oath, depose and say that The National Museum of Mexican Art holds interest in 1830-58 West 19<sup>th</sup> Street Chicago, IL on behalf itself and no other person, association, or member.



Eimy Rosales  
Business Director  
National Museum of Mexican Art

SUBSCRIBED AND SWORN to before me this  
5 day of Jan, 2016

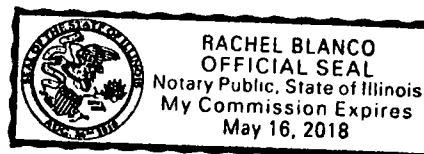
  
NOTARY PUBLIC

10/10/12

10/10/12

10/10/12

**NOTICE**

Via USPS First Class Mail

January 6, 2016

Dear Sir or Madam:

In accordance with Amendment to the Zoning Code enacted by the City Council, Section 17-13-0107-A, please be informed that on or about **January 6, 2016**, I, the undersigned, filed an application for a change in zoning from **Institutional Planned Development #639 to Institutional Planned Development #639, as amended** on behalf of the **Applicant/Lessee, The National Museum of Mexican Art and Owner, Chicago Park District**, for the property located at **1830-58 West 19<sup>th</sup> Street Chicago, IL**.

The one-story brick building, which currently operates as the National Museum of Mexican Art, will remain. The zoning amendment is required in order to permit an on-site surface parking lot, containing fifty (50) parking spaces, within the Property. The proposed exterior on-site surface parking lot will be accessory to the museum's operation and serve the museum's patrons.

The National Museum of Mexican Art is located at 1852 West 19<sup>th</sup> Street Chicago, IL

Chicago Park District is located at 541 North Fairbanks Chicago, IL

I am the duly authorized attorney for the Applicant. My address is 333 West Wacker Drive, Suite 1420, Chicago, IL 60606. My telephone number is (312) 884-5067.

**PLEASE NOTE THAT THE APPLICATION IS NOT SEEKING TO PURCHASE OR REZONE YOUR PROPERTY. THE APPLICANT IS REQUIRED BY LAW TO SEND YOU THIS NOTICE BECAUSE YOU OWN PROPERTY LOCATED WITHIN 250 FEET OF THE SUBJECT PROPERTY.**

Very truly yours,

CHICO AND NUNES P.C.

  
\_\_\_\_\_  
Sylvia C. Michas



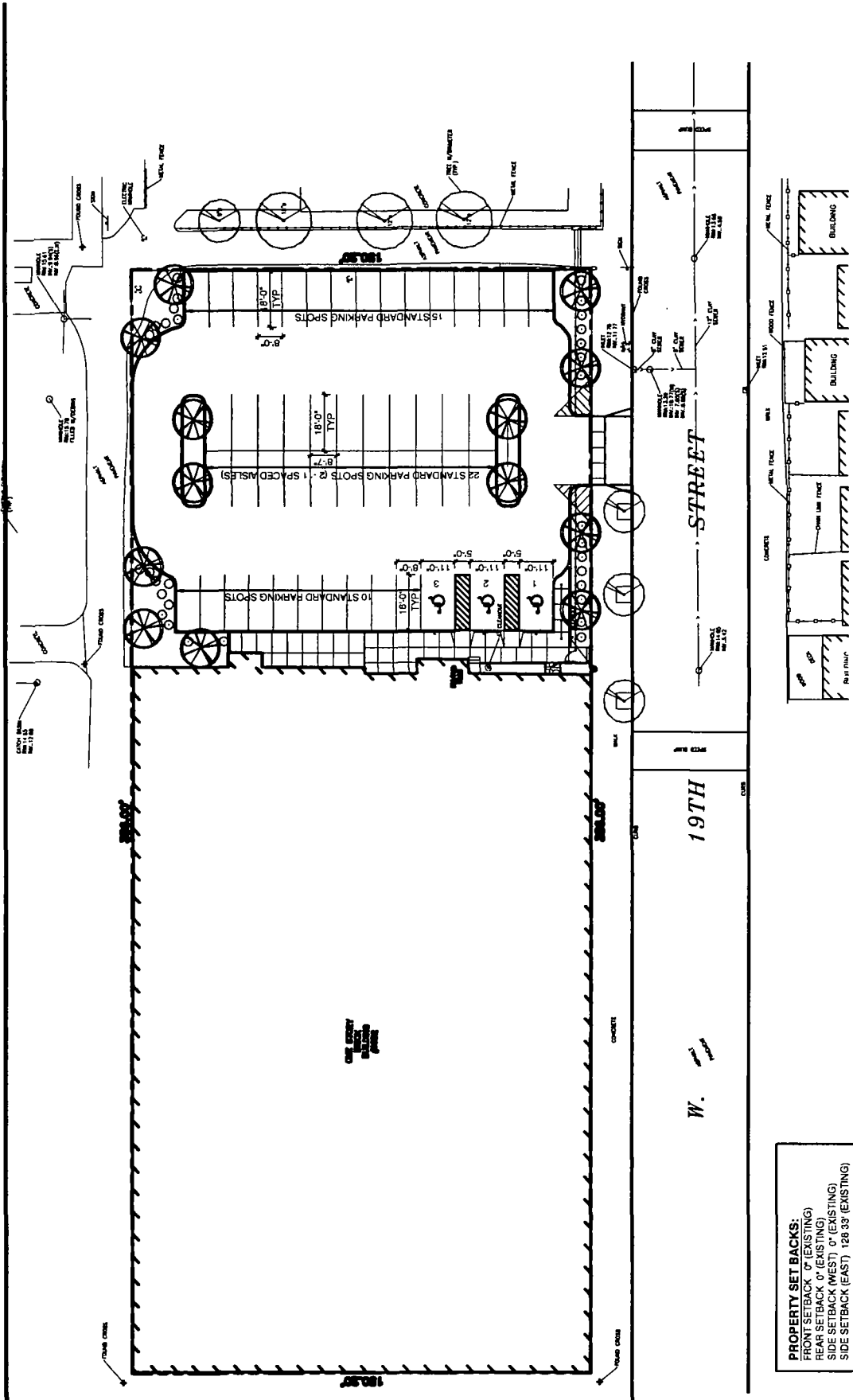

**PROPERTY SET BACKS:**  
 FRONT SETBACK 0' (EXISTING)  
 REAR SETBACK 0' (EXISTING)  
 SIDE SETBACK (WEST) 0' (EXISTING)  
 SIDE SETBACK (EAST) 128 33' (EXISTING)

APPLICANT: THE NATIONAL MUSEUM OF MEXICAN ART  
 PROPERTY: 1820-68 WEST 19TH STREET,  
 CHICAGO, ILLINOIS AS 1822 WEST 19TH STREET  
 (CROSSING OF CHICAGO RIVER) JANUARY 13, 2010  
 PLAN COMMISSION:

**Wallin - Gomez**  
 ARCHITECTS LTD  
 711 South Dearborn Street, Suite 605  
 Chicago, Illinois 60605-1827  
 P 312-427-4702 • F 312-427-8811



**SITE PLAN**

**NMMA PARKING LOT DESIGN**  
**HALF SIZE**  
**SITE PLAN**

1852 W 19TH ST  
 CHICAGO, IL 60608

SCALE 1" = 30'

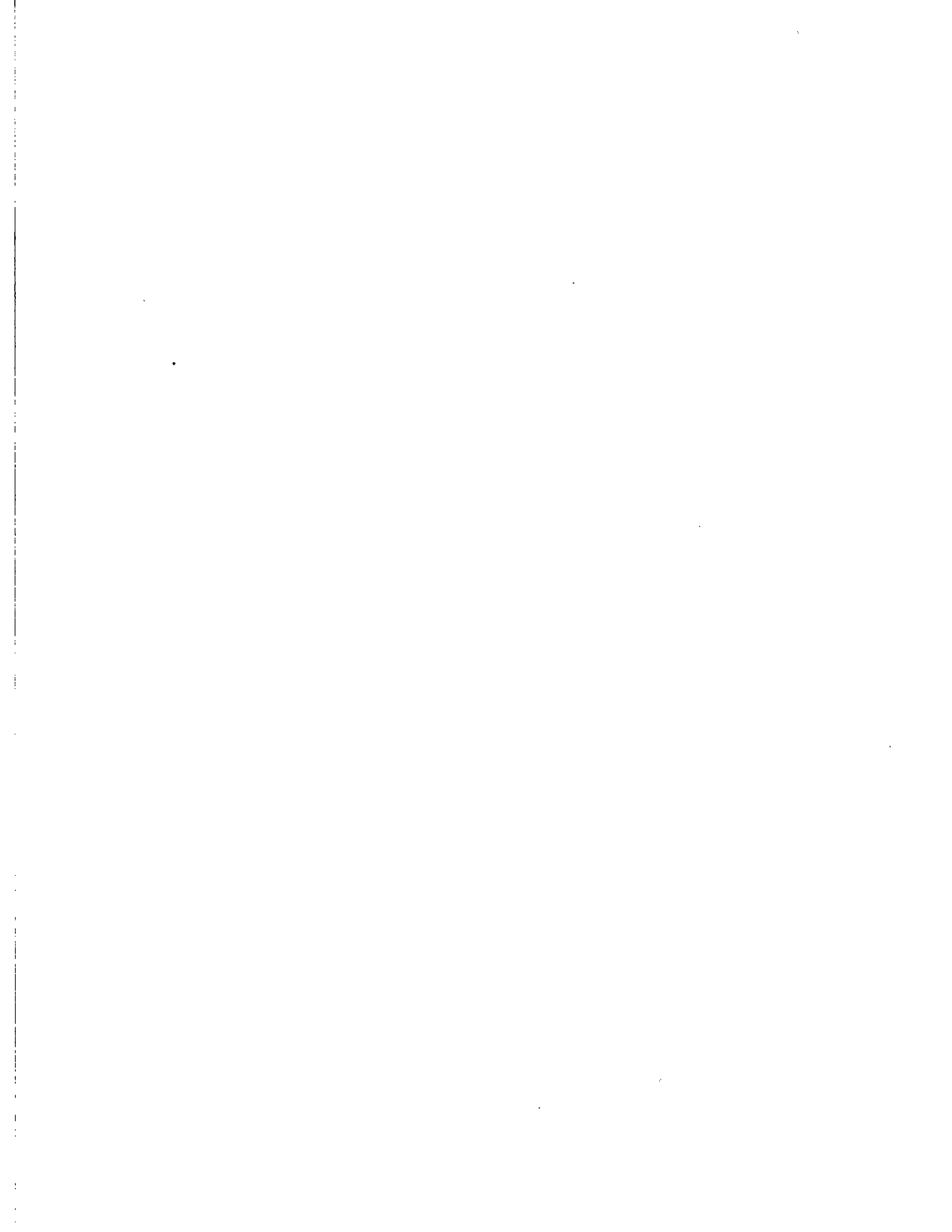

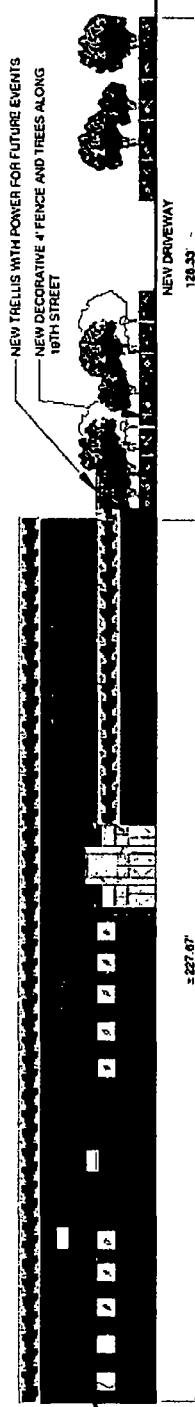

01 SOUTH ELEVATION

SCALE 1"=3'

APPLICANT: THE NATIONAL MUSEUM OF MEXICAN ART  
 PROJECT: WEST 19TH STREET  
 PROPERTY ADDRESS: 1852 WEST 19TH STREET  
 INTRODUCED: JANUARY 13, 2018  
 PLAN COMMISSION:

**Wallin + Gomez**  
 ARCHITECTS LTD  
 711 South Dearborn Street, Suite 600  
 Chicago, Illinois 60605-1827  
 P: 312-427-4702 • F: 312-427-6811

NIMMA PARKING LOT DESIGN SOUTH ELEVATION  
 HALF SIZE  
 1852 W 19TH ST  
 CHICAGO, IL 60608  
**Z-5**

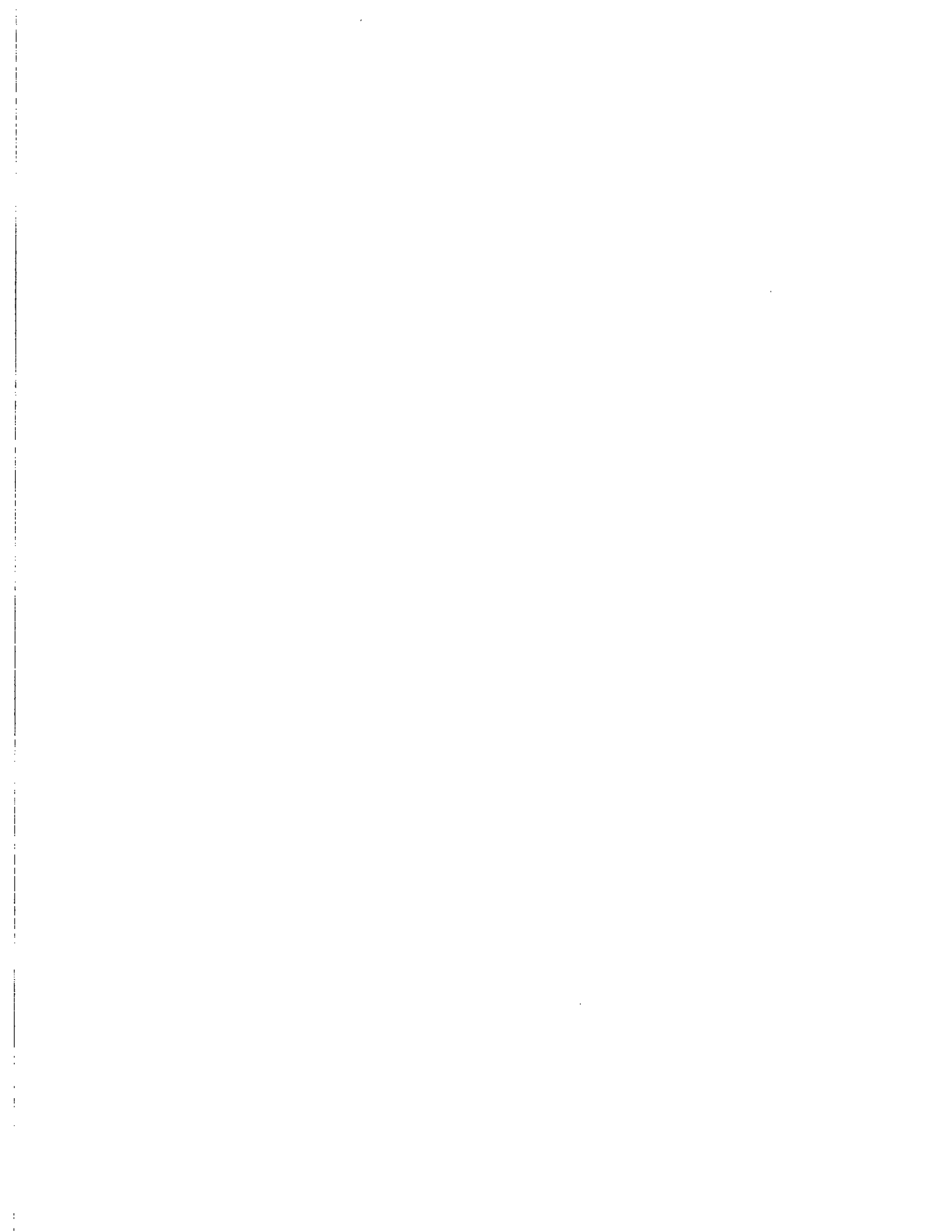





±227.67

SCALE 1" = 30'

01 NORTH ELEVATION

128.33'  
SCOPE OF WORK

**Wallin + Gomez**  
ARCHITECTS LTD  
711 South Dearborn Street, Suite 606  
Chicago, Illinois 60605-1077  
P: 312-427-4702 • F: 312-427-9511

APPLICANT: THE NATIONAL MUSEUM OF MEXICAN ART  
PROPERTY: 1832-68 WEST 19TH STREET  
(COMMONLY KNOWN AS 1832 WEST 19TH STREET)  
INTRODUCED: JANUARY 13, 2016  
PLAN COMMISSION:

NMMA PARKING LOT DESIGN NORTH  
ELEVATION  
HALF SIZE  
1852 W 19TH ST  
CHICAGO, IL 60608  
Z-6



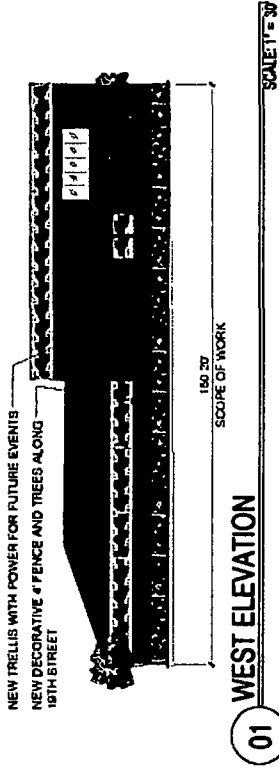

01 WEST ELEVATION

SCALE 1" = 3'

**Wallin - Gomez**  
 ARCHITECTS - LTD  
 711 South Dearborn Street, Suite 606  
 Chicago, Illinois 60605-1827  
 P: 312-467-4702 • F: 312-467-6811

APPLICANT: THE NATIONAL MUSEUM OF MEXICAN ART  
 PROPERTY: 1832-58 WEST 19TH STREET  
 (COMMONLY KNOWN AS 1852 WEST 19TH STREET)  
 INTRODUCED: JANUARY 13, 2018  
 PLAN COMMISSION:

NMMA PARKING LOT DESIGN WEST  
 HALF SIZE ELEVATION  
 1852 W 19TH ST  
 CHICAGO, IL 60608

Z-7

1" = 1/8" = 1/4" = 1/2" = 3/4" = 1" = 1 1/4" = 1 1/2" = 1 3/4" = 2" = 2 1/4" = 2 1/2" = 2 3/4" = 3" = 3 1/4" = 3 1/2" = 3 3/4" = 4" = 4 1/4" = 4 1/2" = 4 3/4" = 5" = 5 1/4" = 5 1/2" = 5 3/4" = 6" = 6 1/4" = 6 1/2" = 6 3/4" = 7" = 7 1/4" = 7 1/2" = 7 3/4" = 8" = 8 1/4" = 8 1/2" = 8 3/4" = 9" = 9 1/4" = 9 1/2" = 9 3/4" = 10" = 10 1/4" = 10 1/2" = 10 3/4" = 11" = 11 1/4" = 11 1/2" = 11 3/4" = 12" = 12 1/4" = 12 1/2" = 12 3/4" = 13" = 13 1/4" = 13 1/2" = 13 3/4" = 14" = 14 1/4" = 14 1/2" = 14 3/4" = 15" = 15 1/4" = 15 1/2" = 15 3/4" = 16" = 16 1/4" = 16 1/2" = 16 3/4" = 17" = 17 1/4" = 17 1/2" = 17 3/4" = 18" = 18 1/4" = 18 1/2" = 18 3/4" = 19" = 19 1/4" = 19 1/2" = 19 3/4" = 20"

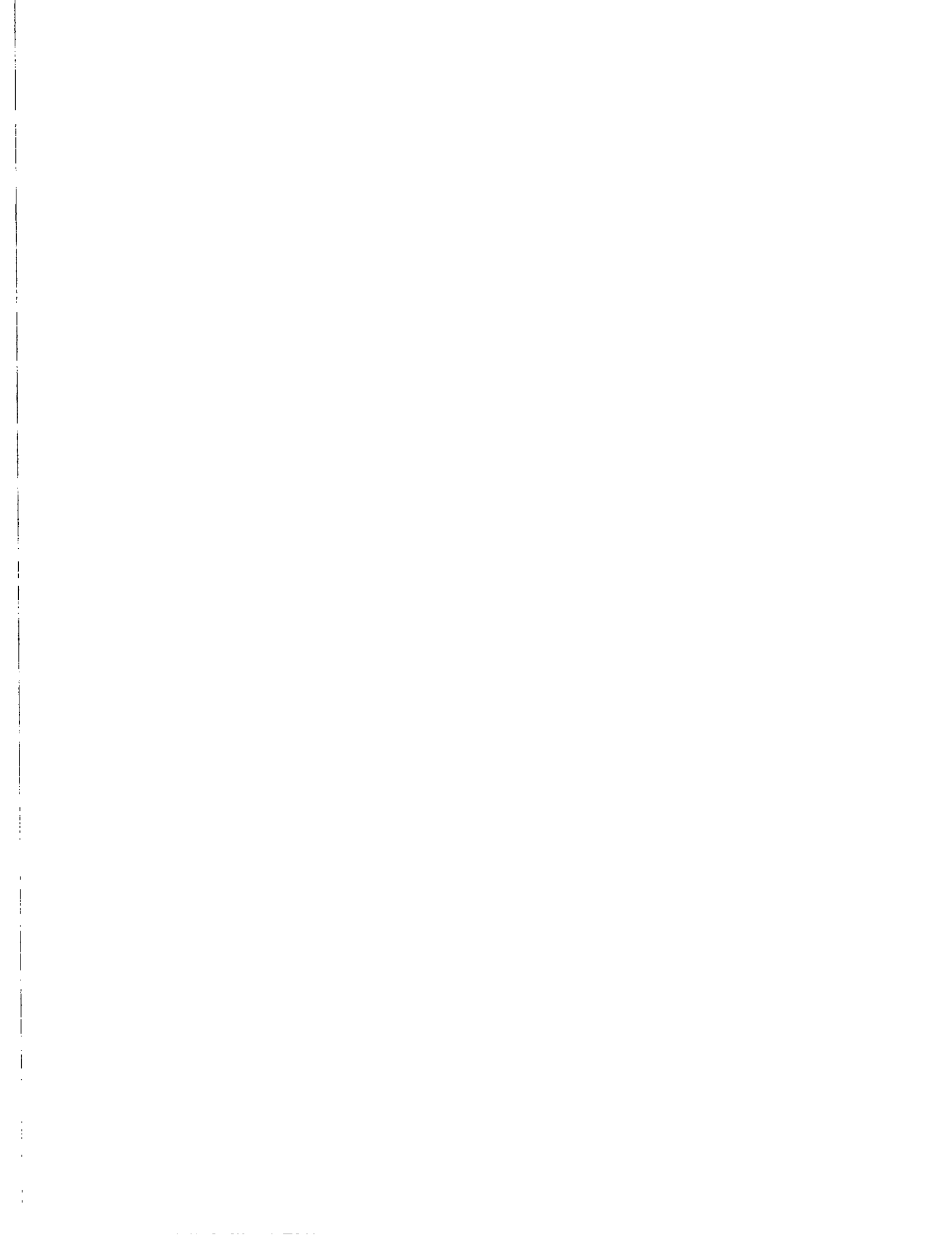

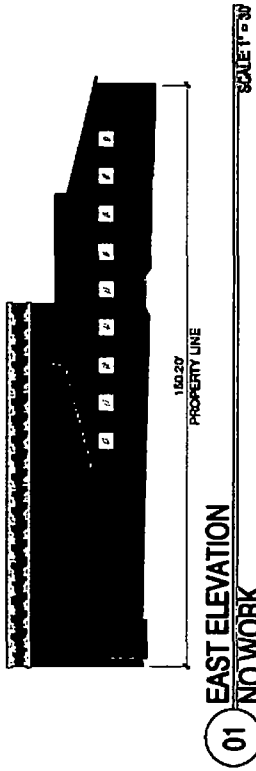

**Wallin - Gomez**  
 ARCHITECTS LTD  
 711 South Dearborn Street, Suite 605  
 Chicago, Illinois 60605-1927  
 P: 312-427-4102 • F: 312-427-6811

APPLICANT: THE NATIONAL MUSEUM OF MEXICAN ART  
 PROPERTY: 1833-58 WEST 19TH STREET  
 (COMMONLY KNOWN AS 1833 WEST 19TH STREET)  
 INTRODUCED: JANUARY 13, 2018  
 PLAN COMMISSION:

NMMA PARKING LOT DESIGN EAST  
 ELEVATION  
 HALF SIZE  
 1832 W 19TH ST  
 CHICAGO, IL 60608  
**Z-8**





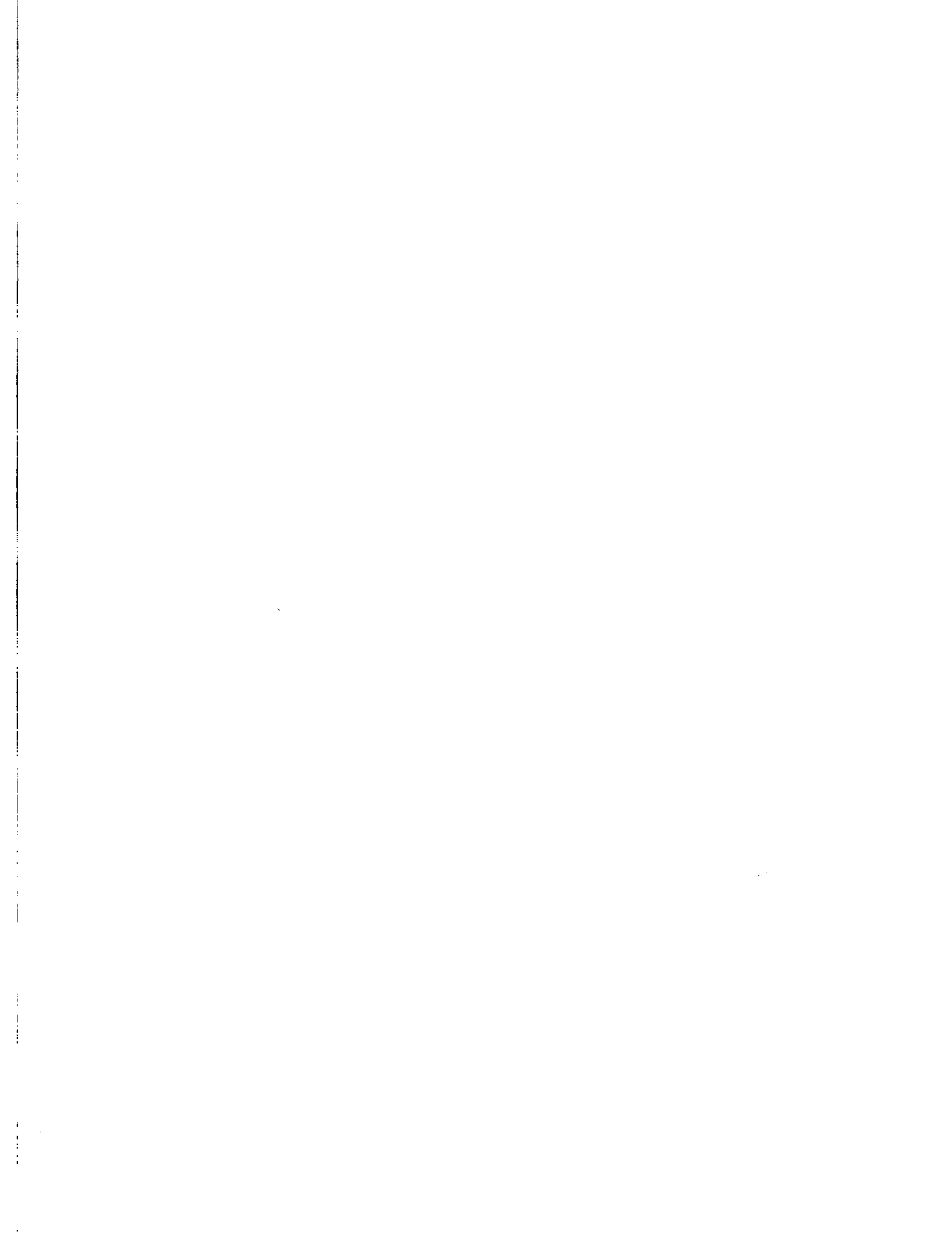







# National Museum of Mexican Art

## Board of Trustees

Jill Arnold  
Vice President  
North Region Sales Leader  
Private Risk Management  
Wells Fargo Insurance Services  
330 Madison Avenue, 7<sup>th</sup> Fl.  
55 Broadway, 24<sup>th</sup> Fl.  
New York, NY 10017  
[Jill.ArnoldBull@wellsfargo.com](mailto:Jill.ArnoldBull@wellsfargo.com)

Carlos R. Cardenas, Chair (2012-1<sup>st</sup>)  
SVP-Managing Director  
Wintrust Commercial Banking  
190 S. LaSalle St., 22<sup>nd</sup> Fl.  
Chicago, IL 60603  
312.447.7353 – W  
312.580.8203 - cell  
[ccardenas@wintrust.com](mailto:ccardenas@wintrust.com)

Edward R. Casas  
Managing Partner  
SOLIC Capital  
1603 Orrington Ave., Suite 1600  
Evanston, IL 60201  
847.583.1619 – W  
847.583.1426 – F  
[ecasas@soliccapi.com](mailto:ecasas@soliccapi.com)

Martin R. Castro  
(2012- 3rd )  
President & CEO  
Castro Synergies, LLC  
161 N. Clark St., Suite 4700  
Chicago, IL 60606  
312.523.2073 – W  
312.523.2001 - Fax  
312.399.3987 –Cell  
[mcastro@castrosynergies.com](mailto:mcastro@castrosynergies.com)

Ramon Cepeda (2011-1<sup>st</sup>)  
Sr. Vice President-Managing Dir.,  
Investor Real Estate Group  
Northern Trust  
50 S. LaSalle Street  
Chicago, IL 60603  
312.557.3270  
312.557.3092 – F  
312.730.6309 (cell)  
[rc110@ntrs.com](mailto:rc110@ntrs.com)

Julie Chavez, (2012-1<sup>st</sup>)  
Senior Vice President  
Bank of America  
135 S. LaSalle Street, Suite 362  
Chicago, IL 60603  
312.992.5073 – W  
312.974.8284 – F  
[julie.chavez@bankofamerica.com](mailto:julie.chavez@bankofamerica.com)

Gery Chico  
Partner  
Chico & Nunes, P.C.  
333 W. Wacker Dr., Suite 1420  
Chicago, IL 60606  
312.884-5666– W  
312.884.5066 - F  
[gchico@chiconunes.com](mailto:gchico@chiconunes.com)

Douglas A. Doetsch (2013-2nd)  
Mayer, Brown LLP  
71 South Wacker Drive  
Chicago, IL 60606-4637  
312.701.7973 - W  
312.706.8125  
[ddoetsch@mayerbrown.com](mailto:ddoetsch@mayerbrown.com)

Benjamin Fernandez  
333 E. Benton Pl., #100  
Chicago, IL 60601  
312.731.9052  
[bfernandez@blackcoffeegallery.com.mx](mailto:bfernandez@blackcoffeegallery.com.mx)

Phillip Fuentes (2013-3rd)  
Proprietor  
McDonald's  
2827 S. Cicero  
Cicero, IL 60650  
708.863.6227 – W  
708.222.9595 – (cell)  
708.863.3296 - Fax  
[PMAMCD@aol.com](mailto:PMAMCD@aol.com)

Rudy Gonzalez

Associate Managing Director  
The PrivateBank  
120 S.LaSalle, Suite 5Fl.  
Chicago, IL 60603  
312.564.2709 - W  
312.282-8109 - C  
[RGonzalez1@theprivatebank.com](mailto:RGonzalez1@theprivatebank.com)

Rita L. Knox (2012-2nd)  
2215 N. Cleveland Ave.  
Chicago, IL 60614  
773.935.0425  
[jeknoxie@aol.com](mailto:jeknoxie@aol.com)

Joseph Luna, Treasurer (2014-1<sup>st</sup>)  
Senior Vice President  
Commercial Bank  
JPMorgan Chase Bank, N.A.  
1201 S. Milwaukee Ave.  
Libertyville, IL 60048  
847.816.4241 – W  
847.816.4210 – Fax  
[joseph.a.luna@chase.com](mailto:joseph.a.luna@chase.com)

Fidel Marquez, Jr.  
(2013-2nd)  
Senior Vice President  
Governmental & External Affairs  
Chief Government & Community  
Relations Officer  
Commonwealth Edison Company  
440 S. LaSalle St., Suite 3300  
Chicago, IL 60605  
312.394.4951 - W  
312.513.7834 – (cell)  
312.394.5433  
[fidel.marquez@comed.com](mailto:fidel.marquez@comed.com)

Juan Gabriel Moreno, AIA  
President  
JGMA  
218 S. Wabash, Suite 200  
Chicago, IL 60604  
773.294.1056 – W  
[juan@jgma.co](mailto:juan@jgma.co)

Raymond Mota (2012-2nd)  
Retired General Contractor  
7218 N. Kedvale Ave.

100

100

100

100

Lincolnwood, IL 60712  
312.520.6682  
[Raymond.mota@gmail.com](mailto:Raymond.mota@gmail.com)

Blanca Murillo DDS  
1504 N. Western  
Chicago IL 60633  
773.544.1664  
[drblancamurillo@yahoo.com](mailto:drblancamurillo@yahoo.com)

Sally Nieto, Secretary, Vice Chair  
(2012-2nd)  
841 Clinton Place  
River Forest, IL 60305  
708.771.2164  
[lands.nieto@comcast.net](mailto:lands.nieto@comcast.net)

Miguel Noyola (2012-3rd )  
Baker & McKenzie  
Partner  
300 E. Randolph Dr., Suite 5000  
Chicago, IL 60601  
312.861.7589 – W  
312.861.8088 - Fax  
[f-miguel.noyola@bakernet.com](mailto:f-miguel.noyola@bakernet.com)

Diana Palomar  
(2014-2nd)  
VP Community Affairs  
ABC 7 Chicago (WLS-TV)  
190 North State St.  
Chicago, IL 60601  
312.750.7515  
[Diana.Palomar@abc.com](mailto:Diana.Palomar@abc.com)

Jose Luis Prado, Treasurer  
401 N. Wabash Ave.,  
Unit 74B  
Chicago, IL 60606  
312.608.9370  
[joseluis@pradob.com](mailto:joseluis@pradob.com)

Jessica Priego (2013-1<sup>st</sup>)  
3331 Wood Terrace  
Los Angeles, CA 90027  
[jessica@jpriego.com](mailto:jessica@jpriego.com)

Glen Ellyn, IL 60137  
630.790.2687  
[vdrassociates@sbcglobal.net](mailto:vdrassociates@sbcglobal.net)

Alejandro Silva, Jr.  
Silva Capital Management  
625 N. Michigan Ave.  
Chicago, IL 60611  
312.397.0400  
[asilva@silvacapitalmanagement.com](mailto:asilva@silvacapitalmanagement.com)

Rod Slemmons  
1536 West Adams St. #2  
Chicago, IL 60607  
312.942.1505  
312.286.2422 - cell  
[Kiffandrod@earthlink.net](mailto:Kiffandrod@earthlink.net)

Carlos Tortolero  
President  
National Museum of Mexican Art  
1852 W. 19<sup>th</sup> Street  
Chicago, IL 60608  
312.433.3902 – direct line  
312.738.9740 - Fax  
[carlos@nationalmuseumofmexicanart.org](mailto:carlos@nationalmuseumofmexicanart.org)

Yolanda (Dusty) Stemer (2012-1<sup>st</sup>)  
46 East Road  
Chesterton, IN 46304  
219.730.6500 - Cell  
[ystemer@aol.com](mailto:ystemer@aol.com)

Roberto Valencia  
VP Corporate Operations  
Walgreen Co.  
200 Wilmot Rd., MS#2273  
Deerfield, IL 60015  
847.315.4367 – W  
[roberto.valencia@walgreens.com](mailto:roberto.valencia@walgreens.com)

Vonita Reescer (2012-1<sup>st</sup>)  
VDR & Associate  
2S532 Danbury Dr.



#18614  
INTRO DATE  
JAN 13, 2016

CITY OF CHICAGO

APPLICATION FOR AN AMENDMENT TO  
THE CHICAGO ZONING ORDINANCE

1. ADDRESS of the property Applicant is seeking to rezone:

1830-58 West 19th Street

2. Ward Number that property is located in: 25

3. APPLICANT The National Museum of Mexican Art

ADDRESS 1852 West 19th Street CITY Chicago

STATE IL ZIP CODE 60608 PHONE 312-884-5067

EMAIL smichas@chiconunes.com CONTACT PERSON Sylvia C. Michas, Attorney for Applicant

4. Is the applicant the owner of the property? YES \_\_\_\_\_ NO X

If the applicant is not the owner of the property, please provide the following information regarding the owner and attach written authorization from the owner allowing the application to proceed.

OWNER Chicago Park District

ADDRESS 541 North Fairbanks CITY Chicago

STATE IL ZIP CODE 60611 PHONE 312-742-7529

EMAIL \_\_\_\_\_ CONTACT PERSON Michael P. Kelly

5. If the Applicant/Owner of the property has obtained a lawyer as their representative for the rezoning, please provide the following information:

ATTORNEY Sylvia C. Michas c/o Chico & Nunes PC

ADDRESS 333 West Wacker Drive #1420

CITY Chicago STATE IL ZIP CODE 60606

PHONE 312-884-5067 FAX 312-463-1001 EMAIL smichas@chiconunes.com

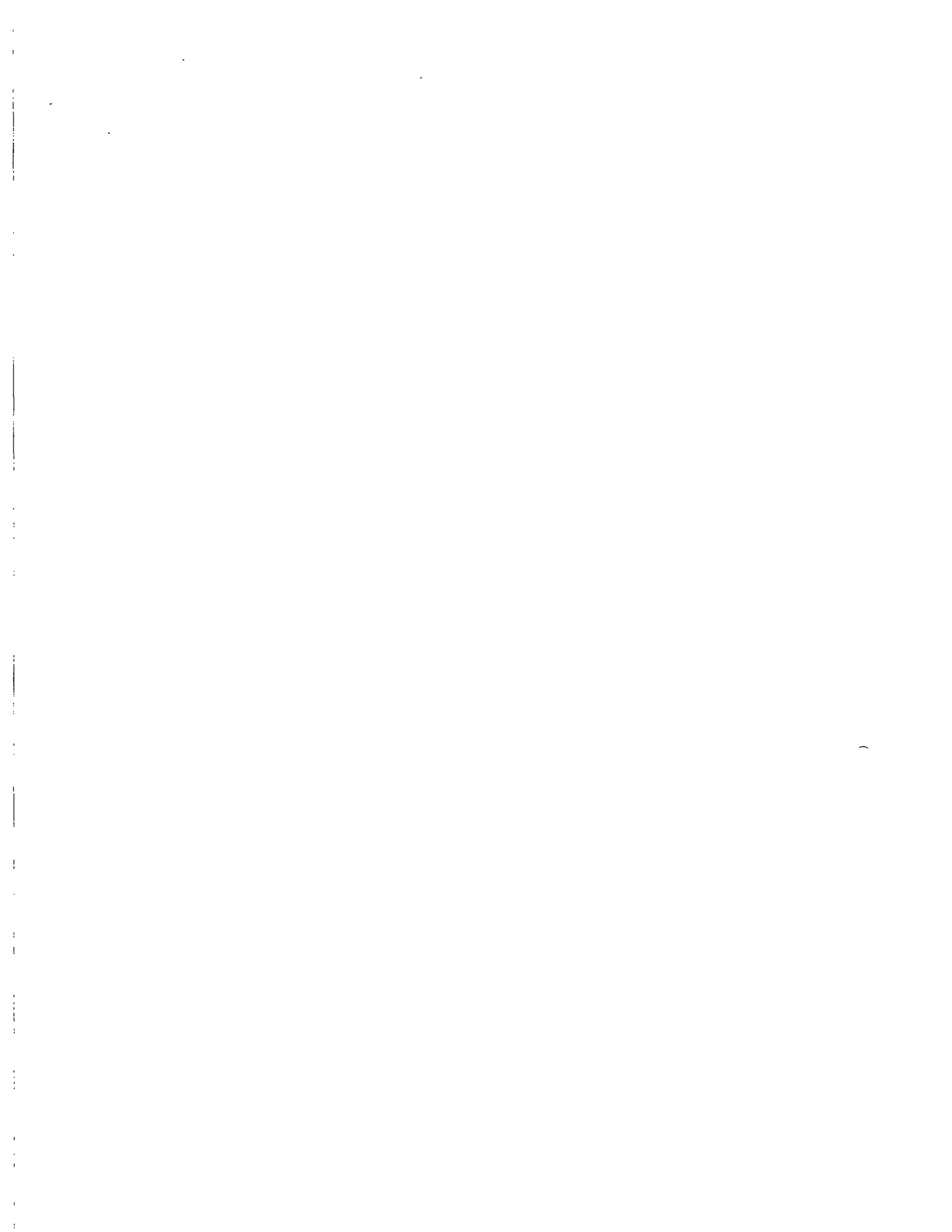



6. If the applicant is a legal entity (Corporation, LLC, Partnership, etc.) please provide the names of all owners as disclosed on the Economic Disclosure Statements.

\_\_\_\_\_  
NA  
\_\_\_\_\_  
\_\_\_\_\_  
\_\_\_\_\_

7. On what date did the owner acquire legal title to the subject property? 1912

8. Has the present owner previously rezoned this property? If yes, when?

No  
\_\_\_\_\_

9. Present Zoning District Institutional Planned Development #639 Proposed Zoning District Institutional Planned Development #639, as amended

10. Lot size in square feet (or dimensions) 53,470 sq. ft.

11. Current Use of the property The subject property is currently partially improved with a one-story brick building and the remainder is vacant and unimproved.

12. Reason for rezoning the property The reason for the rezoning is to develop the vacant and unimproved portion of the property with an exterior parking lot.

13. Describe the proposed use of the property after the rezoning. Indicate the number of dwelling units; number of parking spaces; approximate square footage of any commercial space; and height of the proposed building. (BE SPECIFIC)

The one-story brick building, which currently operates as the National Museum of Mexican Art, will remain. The zoning amendment is required in order to permit a surface parking lot, containing fifty (50) parking spaces, within the Property. The proposed surface parking lot will be accessory to the museum's operation and serve the museum's patrons.

14. The Affordable Requirements Ordinance (ARO) requires on-site affordable housing units and/or a financial contribution for residential housing projects with ten or more units that receive a zoning change which, among other triggers, increases the allowable floor area, or, for existing Planned Developments, increases the number of units (see attached fact sheet or visit [www.cityofchicago.org/ARO](http://www.cityofchicago.org/ARO) for more information). Is this project subject to the ARO?

YES \_\_\_\_\_ NO X \_\_\_\_\_

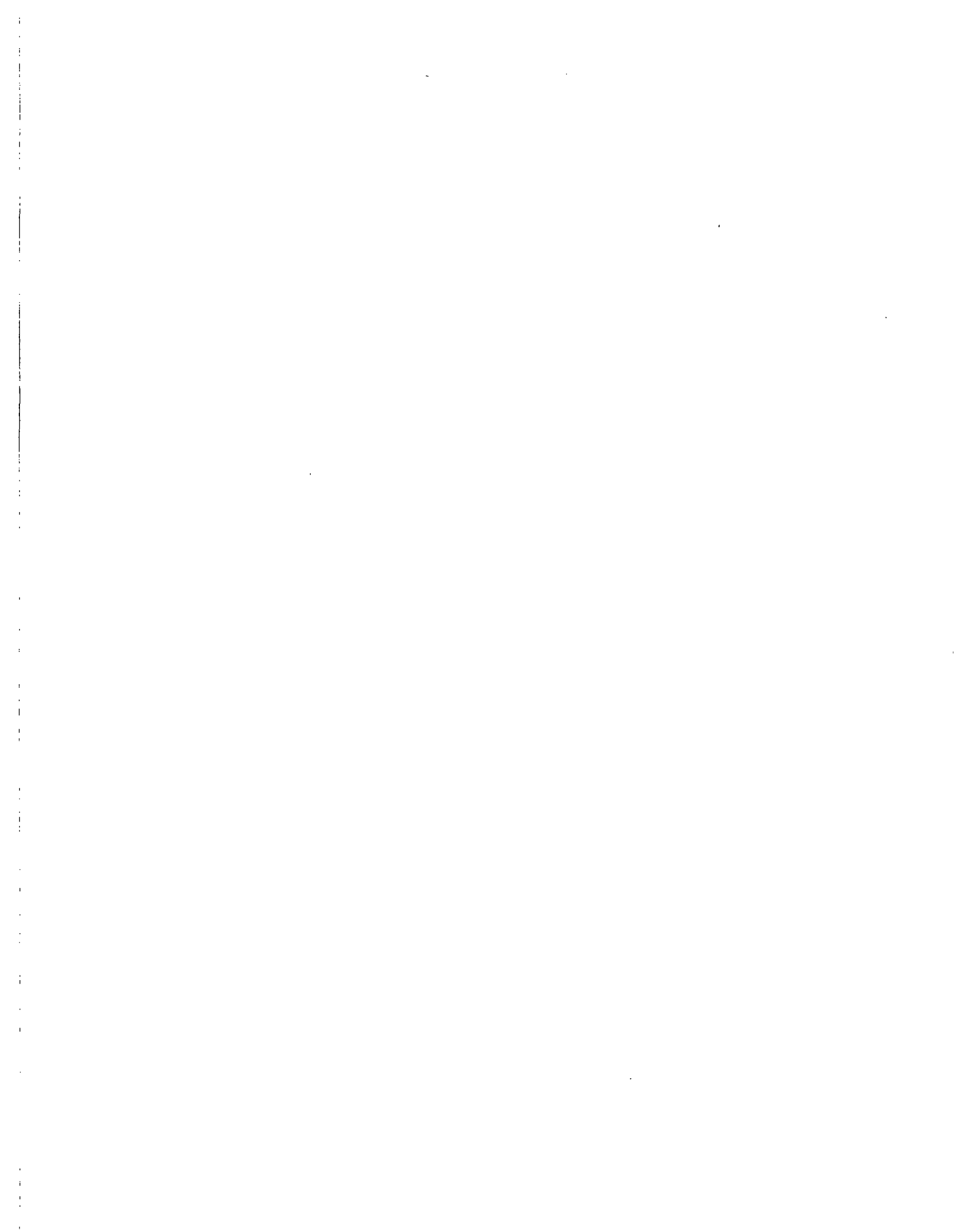

=====

COUNTY OF COOK  
STATE OF ILLINOIS

I, Eimy Rosales, Business Director of The National Museum of Mexican Art, being first duly sworn on oath, states that all of the above statements and the statements contained in the documents submitted herewith are true and correct.

  
\_\_\_\_\_  
Eimy Rosales

Subscribed and Sworn to before me this  
5 day of January, 2016.



  
\_\_\_\_\_  
Notary Public

=====

For Office Use Only

Date of Introduction: \_\_\_\_\_

File Number: \_\_\_\_\_

Ward: \_\_\_\_\_

100

100

100



**chicago park district**

Administration Office  
541 North Fairbanks  
Chicago, Illinois 60611  
(312) 742-PLAY (7529)  
(312) 747-2001 TTY  
www.chicagoparkdistrict.com

**Board of Commissioners**  
Bryan Traubert  
*President*

Avis LaVelle  
*Vice-President*

Erika R. Allen  
Donald J. Edwards  
Tim King  
M. Laird Koldyke  
Juan Salgado

**General Superintendent  
& CEO**  
Michael P. Kelly

City of Chicago  
Rahm Emanuel  
*Mayer*

September 4, 2014

To: The Illinois Department of Commerce and Economic  
Development

The National Museum of Mexican Art has a perpetual lease for the space it occupies in Harrison Park in Chicago. The Chicago Park District gives permission to pursue funding to do the construction and renovations required to build a parking lot for the Museum in space already assigned to the Museum as outlined in its lease and contingent upon approval by the Park District.

Sincerely,

A handwritten signature in black ink, appearing to read "Michael P. Kelly".

Michael P. Kelly  
General Superintendent and CEO  
Chicago Park District



# National Museum of Mexican Art

## Board of Trustees

Jill Arnold  
Vice President  
North Region Sales Leader  
Private Risk Management  
Wells Fargo Insurance Services  
330 Madison Avenue, 7<sup>th</sup> Fl.  
55 Broadway, 24<sup>th</sup> Fl.  
New York, NY 10017  
Jill.ArnoldBull@wellsfargo.com

Carlos R. Cardenas, Chair (2012-1<sup>st</sup>)  
SVP-Managing Director  
Wintrust Commercial Banking  
190 S. LaSalle St., 22<sup>nd</sup> Fl.  
Chicago, IL 60603  
312.447.7353 – W  
312.580.8203 - cell  
ccardenas@wintrust.com

Edward R. Casas  
Managing Partner  
SOLIC Capital  
1603 Orrington Ave., Suite 1600  
Evanston, IL 60201  
847.583.1619 – W  
847.583.1426 – F  
ecasas@soliccapital.com

Martin R. Castro  
(2012- 3rd )  
President & CEO  
Castro Synergies, LLC  
161 N. Clark St., Suite 4700  
Chicago, IL 60606  
312.523.2073 – W  
312.523.2001 - Fax  
312.399.3987 –Cell  
mcastro@castrosynergies.com

Ramon Cepeda (2011-1<sup>st</sup>)  
Sr. Vice President-Managing Dir.,  
Investor Real Estate Group  
Northern Trust  
50 S. LaSalle Street  
Chicago, IL 60603  
312.557.3270  
312.557.3092 – F  
312.730.6309 (cell)  
rc110@ntrs.com

Julie Chavez, (2012-1<sup>st</sup>)  
Senior Vice President  
Bank of America  
135 S. LaSalle Street, Suite 362  
Chicago, IL 60603  
312.992.5073 – W  
312.974.8284 – F  
julie.chavez@bankofamerica.com

Gery Chico  
Partner  
Chico & Nunes, P.C.  
333 W. Wacker Dr., Suite 1420  
Chicago, IL 60606  
312.884-5666– W  
312.884.5066 - F  
gchico@chiconunes.com

Douglas A. Doetsch (2013-2nd)  
Mayer, Brown LLP  
71 South Wacker Drive  
Chicago, IL 60606-4637  
312.701.7973 - W  
312.706.8125  
ddoetsch@mayerbrown.com

Benjamin Fernandez  
333 E. Benton Pl., #100  
Chicago, IL 60601  
312.731.9052  
bfernandez@blackcoffeegallery.  
com.mx

Phillip Fuentes (2013-3rd)  
Proprietor  
McDonald's  
2827 S. Cicero  
Cicero, IL 60650  
708.863.6227 – W  
708.222.9595 – (cell)  
708.863.3296 - Fax  
PMAMCD@aol.com

Rudy Gonzalez

Associate Managing Director  
The PrivateBank  
120 S.LaSalle, Suite 5Fl.  
Chicago, IL 60603  
312.564.2709 - W  
312.282-8109 - C  
RGonzalez1@theprivatebank.com

Rita L. Knox (2012-2nd)  
2215 N. Cleveland Ave.  
Chicago, IL 60614  
773.935.0425  
jeknoxie@aol.com

Joseph Luna, Treasurer (2014-1<sup>st</sup>)  
Senior Vice President  
Commercial Bank  
JPMorgan Chase Bank, N.A.  
1201 S. Milwaukee Ave.  
Libertyville, IL 60048  
847.816.4241 – W  
847.816.4210 – Fax  
joseph.a.luna@chase.com

Fidel Marquez, Jr.  
(2013-2nd)  
Senior Vice President  
Governmental & External Affairs  
Chief Government & Community  
Relations Officer  
Commonwealth Edison Company  
440 S. LaSalle St., Suite 3300  
Chicago, IL 60605  
312.394.4951 - W  
312.513.7834 – (cell)  
312.394.5433  
fidel.marquez@comed.com

Juan Gabriel Moreno, AIA  
President  
JGMA  
218 S. Wabash, Suite 200  
Chicago, IL 60604  
773.294.1056 – W  
juan@jgma.co

Raymond Mota (2012-2nd)  
Retired General Contractor  
7218 N. Kedvale Ave.





Lincolnwood, IL 60712  
312.520.6682  
[Raymond.mota@gmail.com](mailto:Raymond.mota@gmail.com)

Blanca Murillo DDS  
1504 N. Western  
Chicago IL 60633  
773.544.1664  
[drblancamurillo@yahoo.com](mailto:drblancamurillo@yahoo.com)

Sally Nieto, Secretary, Vice Chair  
(2012-2nd)  
841 Clinton Place  
River Forest, IL 60305  
708.771.2164  
[lands.nieto@comcast.net](mailto:lands.nieto@comcast.net)

Miguel Noyola (2012-3rd )  
Baker & McKenzie  
Partner  
300 E. Randolph Dr., Suite 5000  
Chicago, IL 60601  
312.861.7589 – W  
312.861.8088 - Fax  
[f-miguel.noyola@bakernet.com](mailto:f-miguel.noyola@bakernet.com)

Diana Palomar  
(2014-2nd)  
VP Community Affairs  
ABC 7 Chicago (WLS-TV)  
190 North State St.  
Chicago, IL 60601  
312.750.7515  
[Diana.Palomar@abc.com](mailto:Diana.Palomar@abc.com)

Jose Luis Prado, Treasurer  
401 N. Wabash Ave.,  
Unit 74B  
Chicago, IL 60606  
312.608.9370  
[joseluis@pradob.com](mailto:joseluis@pradob.com)

Jessica Priego (2013-1<sup>st</sup>)  
3331 Wood Terrace  
Los Angeles, CA 90027  
[jessica@jpriego.com](mailto:jessica@jpriego.com)

Glen Ellyn, IL 60137  
630.790.2687  
[vdrassociates@sbcglobal.net](mailto:vdrassociates@sbcglobal.net)

Alejandro Silva, Jr.  
Silva Capital Management  
625 N. Michigan Ave.  
Chicago, IL 60611  
312.397.0400  
[asilva@silvacapitalmanagement.com](mailto:asilva@silvacapitalmanagement.com)

Rod Slemmons  
1536 West Adams St. #2  
Chicago, IL 60607  
312.942.1505  
312.286.2422 - cell  
[Kiffandrod@earthlink.net](mailto:Kiffandrod@earthlink.net)

Carlos Tortolero  
President  
National Museum of Mexican Art  
1852 W. 19<sup>th</sup> Street  
Chicago, IL 60608  
312.433.3902 – direct line  
312.738.9740 - Fax  
[carlos@nationalmuseumofmexicanart.org](mailto:carlos@nationalmuseumofmexicanart.org)

Yolanda (Dusty) Stemer (2012-1<sup>st</sup>)  
46 East Road  
Chesterton, IN 46304  
219.730.6500 - Cell  
[ystemer@aol.com](mailto:ystemer@aol.com)

Roberto Valencia  
VP Corporate Operations  
Walgreen Co.  
200 Wilmot Rd., MS#2273  
Deerfield, IL 60015  
847.315.4367 – W  
[roberto.valencia@walgreens.com](mailto:roberto.valencia@walgreens.com)

Vonita Reescer (2012-1<sup>st</sup>)  
VDR & Associate  
2S532 Danbury Dr.



**CITY OF CHICAGO  
ECONOMIC DISCLOSURE STATEMENT  
AND AFFIDAVIT**

**SECTION I -- GENERAL INFORMATION**

A. Legal name of the Disclosing Party submitting this EDS. Include d/b/a/ if applicable:

The National Museum of Mexican Art

**Check ONE of the following three boxes:**

Indicate whether the Disclosing Party submitting this EDS is:

1.  the Applicant

OR

2.  a legal entity holding a direct or indirect interest in the Applicant. State the legal name of the Applicant in which the Disclosing Party holds an interest: \_\_\_\_\_

OR

3.  a legal entity with a right of control (see Section II.B.1.) State the legal name of the entity in which the Disclosing Party holds a right of control: \_\_\_\_\_

B. Business address of the Disclosing Party: 1852 West 19th Street  
Chicago, IL 60

C. Telephone: 312-884-5067 Fax: 312-463-1000 Email: smichas@chiconunes.com

D. Name of contact person: Sylvia C. Michas, Attorney for Applicant

E. Federal Employer Identification No. (if you have one): \_\_\_\_\_

F. Brief description of contract, transaction or other undertaking (referred to below as the "Matter") to which this EDS pertains. (Include project number and location of property, if applicable):

Amendment to Institutional Planned Development #639 for the property located at 1830-1858 West 19th Street

G. Which City agency or department is requesting this EDS? Department of Planning & Development;  
Department of Law

If the Matter is a contract being handled by the City's Department of Procurement Services, please complete the following:

Specification # \_\_\_\_\_ and Contract # \_\_\_\_\_



**SECTION II -- DISCLOSURE OF OWNERSHIP INTERESTS**

**A. NATURE OF THE DISCLOSING PARTY**

1. Indicate the nature of the Disclosing Party:

- Person
  - Publicly registered business corporation
  - Privately held business corporation
  - Sole proprietorship
  - General partnership
  - Limited partnership
  - Trust
  - Limited liability company
  - Limited liability partnership
  - Joint venture
  - Not-for-profit corporation
- (Is the not-for-profit corporation also a 501(c)(3))?
- Yes                       No
- Other (please specify) \_\_\_\_\_

2. For legal entities, the state (or foreign country) of incorporation or organization, if applicable:

Illinois

3. For legal entities not organized in the State of Illinois: Has the organization registered to do business in the State of Illinois as a foreign entity?

- Yes
- No
- N/A

**B. IF THE DISCLOSING PARTY IS A LEGAL ENTITY:**

1. List below the full names and titles of all executive officers and all directors of the entity.

**NOTE:** For not-for-profit corporations, also list below all members, if any, which are legal entities. If there are no such members, write "no members." For trusts, estates or other similar entities, list below the legal titleholder(s).

If the entity is a general partnership, limited partnership, limited liability company, limited liability partnership or joint venture, list below the name and title of each general partner, managing member, manager or any other person or entity that controls the day-to-day management of the Disclosing Party.

**NOTE:** Each legal entity listed below must submit an EDS on its own behalf.

Name	Title
<u>See attached list of officers and Board of Trustees</u>	

2. Please provide the following information concerning each person or entity having a direct or indirect beneficial interest (including ownership) in excess of 7.5% of the Disclosing Party. Examples of such an interest include shares in a corporation, partnership interest in a partnership or joint venture,



interest of a member or manager in a limited liability company, or interest of a beneficiary of a trust, estate or other similar entity. If none, state "None." **NOTE:** Pursuant to Section 2-154-030 of the Municipal Code of Chicago ("Municipal Code"), the City may require any such additional information from any applicant which is reasonably intended to achieve full disclosure.

Name	Business Address	Percentage Interest in the Disclosing Party
None		

**SECTION III -- BUSINESS RELATIONSHIPS WITH CITY ELECTED OFFICIALS**

Has the Disclosing Party had a "business relationship," as defined in Chapter 2-156 of the Municipal Code, with any City elected official in the 12 months before the date this EDS is signed?

Yes                       No

If yes, please identify below the name(s) of such City elected official(s) and describe such relationship(s):

---

---

**SECTION IV -- DISCLOSURE OF SUBCONTRACTORS AND OTHER RETAINED PARTIES**

The Disclosing Party must disclose the name and business address of each subcontractor, attorney, lobbyist, accountant, consultant and any other person or entity whom the Disclosing Party has retained or expects to retain in connection with the Matter, as well as the nature of the relationship, and the total amount of the fees paid or estimated to be paid. The Disclosing Party is not required to disclose employees who are paid solely through the Disclosing Party's regular payroll.

"Lobbyist" means any person or entity who undertakes to influence any legislative or administrative action on behalf of any person or entity other than: (1) a not-for-profit entity, on an unpaid basis, or (2) himself. "Lobbyist" also means any person or entity any part of whose duties as an employee of another includes undertaking to influence any legislative or administrative action.

If the Disclosing Party is uncertain whether a disclosure is required under this Section, the Disclosing Party must either ask the City whether disclosure is required or make the disclosure.





Name (indicate whether retained or anticipated to be retained)	Business Address	Relationship to Disclosing Party (subcontractor, attorney, lobbyist, etc.)	Fees (indicate whether paid or estimated.) <b>NOTE:</b> "hourly rate" or "t.b.d." is not an acceptable response.
Chico & Nunes P.C.	333 West Wacker Drive #1420 Chicago, IL 60606	Attorney	\$0 (pro-bono)

(Add sheets if necessary)

Check here if the Disclosing Party has not retained, nor expects to retain, any such persons or entities.

**SECTION V -- CERTIFICATIONS**

**A. COURT-ORDERED CHILD SUPPORT COMPLIANCE**

Under Municipal Code Section 2-92-415, substantial owners of business entities that contract with the City must remain in compliance with their child support obligations throughout the contract's term.

Has any person who directly or indirectly owns 10% or more of the Disclosing Party been declared in arrearage on any child support obligations by any Illinois court of competent jurisdiction?

Yes       No       No person directly or indirectly owns 10% or more of the Disclosing Party.

If "Yes," has the person entered into a court-approved agreement for payment of all support owed and is the person in compliance with that agreement?

Yes       No

**B. FURTHER CERTIFICATIONS**

1. Pursuant to Municipal Code Chapter 1-23, Article I ("Article I")(which the Applicant should consult for defined terms (e.g., "doing business") and legal requirements), if the Disclosing Party submitting this EDS is the Applicant and is doing business with the City, then the Disclosing Party certifies as follows: (i) neither the Applicant nor any controlling person is currently indicted or charged with, or has admitted guilt of, or has ever been convicted of, or placed under supervision for, any criminal offense involving actual, attempted, or conspiracy to commit bribery, theft, fraud, forgery, perjury, dishonesty or deceit against an officer or employee of the City or any sister agency; and (ii) the Applicant understands and acknowledges that compliance with Article I is a continuing requirement for doing business with the City. **NOTE:** If Article I applies to the Applicant, the permanent compliance timeframe in Article I supersedes some five-year compliance timeframes in certifications 2 and 3 below.



2. The Disclosing Party and, if the Disclosing Party is a legal entity, all of those persons or entities identified in Section II.B.1. of this EDS:

- a. are not presently debarred, suspended, proposed for debarment, declared ineligible or voluntarily excluded from any transactions by any federal, state or local unit of government;
- b. have not, within a five-year period preceding the date of this EDS, been convicted of a criminal offense, adjudged guilty, or had a civil judgment rendered against them in connection with: obtaining, attempting to obtain, or performing a public (federal, state or local) transaction or contract under a public transaction; a violation of federal or state antitrust statutes; fraud; embezzlement; theft; forgery; bribery; falsification or destruction of records; making false statements; or receiving stolen property;
- c. are not presently indicted for, or criminally or civilly charged by, a governmental entity (federal, state or local) with committing any of the offenses set forth in clause B.2.b. of this Section V;
- d. have not, within a five-year period preceding the date of this EDS, had one or more public transactions (federal, state or local) terminated for cause or default; and
- e. have not, within a five-year period preceding the date of this EDS, been convicted, adjudged guilty, or found liable in a civil proceeding, or in any criminal or civil action, including actions concerning environmental violations, instituted by the City or by the federal government, any state, or any other unit of local government.

3. The certifications in subparts 3, 4 and 5 concern:

- the Disclosing Party;
- any "Contractor" (meaning any contractor or subcontractor used by the Disclosing Party in connection with the Matter, including but not limited to all persons or legal entities disclosed under Section IV, "Disclosure of Subcontractors and Other Retained Parties");
- any "Affiliated Entity" (meaning a person or entity that, directly or indirectly: controls the Disclosing Party, is controlled by the Disclosing Party, or is, with the Disclosing Party, under common control of another person or entity. Indicia of control include, without limitation: interlocking management or ownership; identity of interests among family members, shared facilities and equipment; common use of employees; or organization of a business entity following the ineligibility of a business entity to do business with federal or state or local government, including the City, using substantially the same management, ownership, or principals as the ineligible entity); with respect to Contractors, the term Affiliated Entity means a person or entity that directly or indirectly controls the Contractor, is controlled by it, or, with the Contractor, is under common control of another person or entity;
- any responsible official of the Disclosing Party, any Contractor or any Affiliated Entity or any other official, agent or employee of the Disclosing Party, any Contractor or any Affiliated Entity, acting pursuant to the direction or authorization of a responsible official of the Disclosing Party, any Contractor or any Affiliated Entity (collectively "Agents").

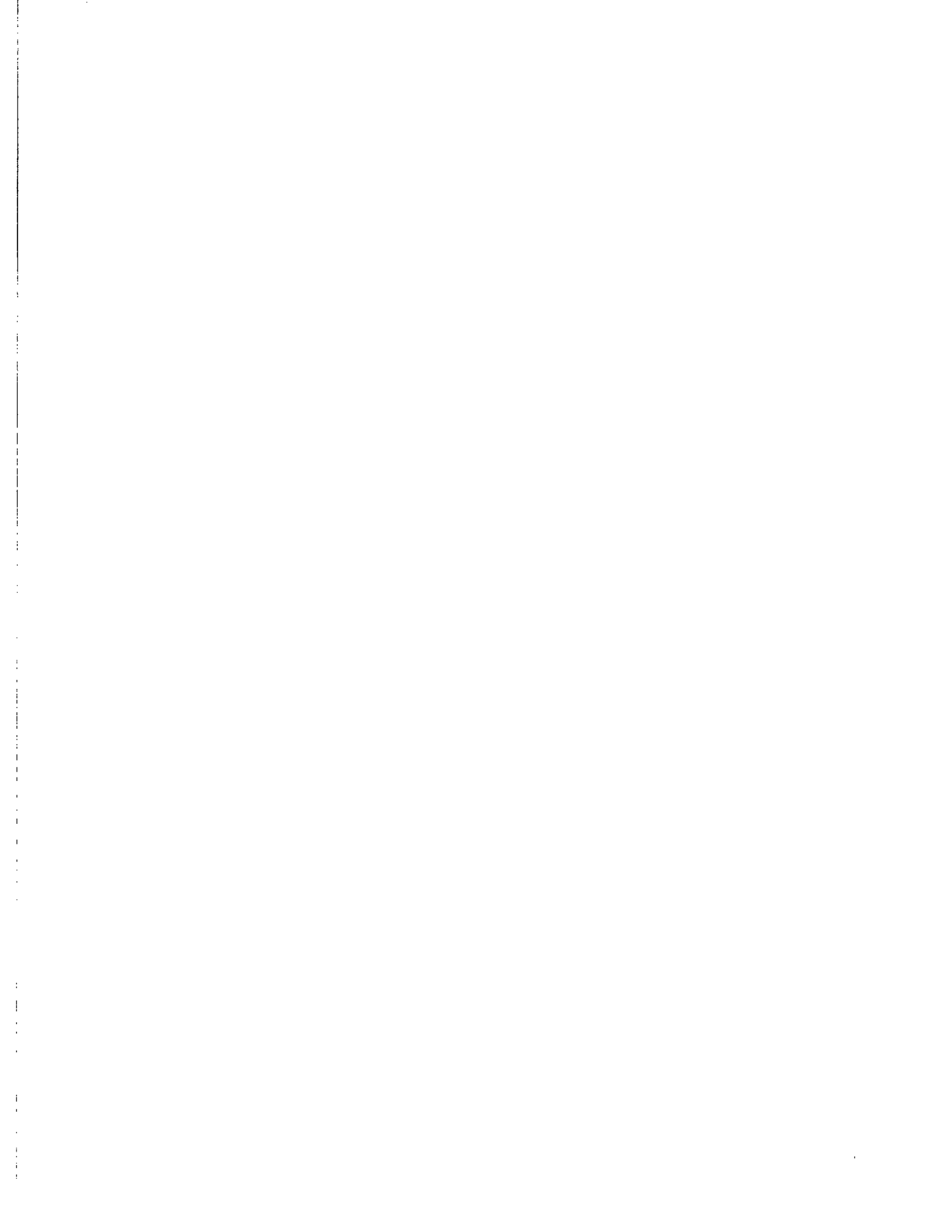

Neither the Disclosing Party, nor any Contractor, nor any Affiliated Entity of either the Disclosing Party or any Contractor nor any Agents have, during the five years before the date this EDS is signed, or, with respect to a Contractor, an Affiliated Entity, or an Affiliated Entity of a Contractor during the five years before the date of such Contractor's or Affiliated Entity's contract or engagement in connection with the Matter:

- a. bribed or attempted to bribe, or been convicted or adjudged guilty of bribery or attempting to bribe, a public officer or employee of the City, the State of Illinois, or any agency of the federal government or of any state or local government in the United States of America, in that officer's or employee's official capacity;
- b. agreed or colluded with other bidders or prospective bidders, or been a party to any such agreement, or been convicted or adjudged guilty of agreement or collusion among bidders or prospective bidders, in restraint of freedom of competition by agreement to bid a fixed price or otherwise; or
- c. made an admission of such conduct described in a. or b. above that is a matter of record, but have not been prosecuted for such conduct; or
- d. violated the provisions of Municipal Code Section 2-92-610 (Living Wage Ordinance).

4. Neither the Disclosing Party, Affiliated Entity or Contractor, or any of their employees, officials, agents or partners, is barred from contracting with any unit of state or local government as a result of engaging in or being convicted of (1) bid-rigging in violation of 720 ILCS 5/33E-3; (2) bid-rotating in violation of 720 ILCS 5/33E-4; or (3) any similar offense of any state or of the United States of America that contains the same elements as the offense of bid-rigging or bid-rotating.

5. Neither the Disclosing Party nor any Affiliated Entity is listed on any of the following lists maintained by the Office of Foreign Assets Control of the U.S. Department of the Treasury or the Bureau of Industry and Security of the U.S. Department of Commerce or their successors: the Specially Designated Nationals List, the Denied Persons List, the Unverified List, the Entity List and the Debarred List.

6. The Disclosing Party understands and shall comply with the applicable requirements of Chapters 2-55 (Legislative Inspector General), 2-56 (Inspector General) and 2-156 (Governmental Ethics) of the Municipal Code.

7. If the Disclosing Party is unable to certify to any of the above statements in this Part B (Further Certifications), the Disclosing Party must explain below:

---

NA

---

---



If the letters "NA," the word "None," or no response appears on the lines above, it will be conclusively presumed that the Disclosing Party certified to the above statements.

8. To the best of the Disclosing Party's knowledge after reasonable inquiry, the following is a complete list of all current employees of the Disclosing Party who were, at any time during the 12-month period preceding the execution date of this EDS, an employee, or elected or appointed official, of the City of Chicago (if none, indicate with "N/A" or "none").

---

NA

---

9. To the best of the Disclosing Party's knowledge after reasonable inquiry, the following is a complete list of all gifts that the Disclosing Party has given or caused to be given, at any time during the 12-month period preceding the execution date of this EDS, to an employee, or elected or appointed official, of the City of Chicago. For purposes of this statement, a "gift" does not include: (i) anything made generally available to City employees or to the general public, or (ii) food or drink provided in the course of official City business and having a retail value of less than \$20 per recipient (if none, indicate with "N/A" or "none"). As to any gift listed below, please also list the name of the City recipient.

---

NA

---

**C. CERTIFICATION OF STATUS AS FINANCIAL INSTITUTION**

1. The Disclosing Party certifies that the Disclosing Party (check one)

is  is not

a "financial institution" as defined in Section 2-32-455(b) of the Municipal Code.

2. If the Disclosing Party IS a financial institution, then the Disclosing Party pledges:

"We are not and will not become a predatory lender as defined in Chapter 2-32 of the Municipal Code. We further pledge that none of our affiliates is, and none of them will become, a predatory lender as defined in Chapter 2-32 of the Municipal Code. We understand that becoming a predatory lender or becoming an affiliate of a predatory lender may result in the loss of the privilege of doing business with the City."

If the Disclosing Party is unable to make this pledge because it or any of its affiliates (as defined in Section 2-32-455(b) of the Municipal Code) is a predatory lender within the meaning of Chapter 2-32 of the Municipal Code, explain here (attach additional pages if necessary):

---

---





---

If the letters "NA," the word "None," or no response appears on the lines above, it will be conclusively presumed that the Disclosing Party certified to the above statements.

**D. CERTIFICATION REGARDING INTEREST IN CITY BUSINESS**

Any words or terms that are defined in Chapter 2-156 of the Municipal Code have the same meanings when used in this Part D.

1. In accordance with Section 2-156-110 of the Municipal Code: Does any official or employee of the City have a financial interest in his or her own name or in the name of any other person or entity in the Matter?

Yes                       No

NOTE: If you checked "Yes" to Item D.1., proceed to Items D.2. and D.3. If you checked "No" to Item D.1., proceed to Part E.

2. Unless sold pursuant to a process of competitive bidding, or otherwise permitted, no City elected official or employee shall have a financial interest in his or her own name or in the name of any other person or entity in the purchase of any property that (i) belongs to the City, or (ii) is sold for taxes or assessments, or (iii) is sold by virtue of legal process at the suit of the City (collectively, "City Property Sale"). Compensation for property taken pursuant to the City's eminent domain power does not constitute a financial interest within the meaning of this Part D.

Does the Matter involve a City Property Sale?

Yes                       No

3. If you checked "Yes" to Item D.1., provide the names and business addresses of the City officials or employees having such interest and identify the nature of such interest:

Name	Business Address	Nature of Interest

4. The Disclosing Party further certifies that no prohibited financial interest in the Matter will be acquired by any City official or employee.

**E. CERTIFICATION REGARDING SLAVERY ERA BUSINESS**

Please check either 1. or 2. below. If the Disclosing Party checks 2., the Disclosing Party must disclose below or in an attachment to this EDS all information required by paragraph 2. Failure to

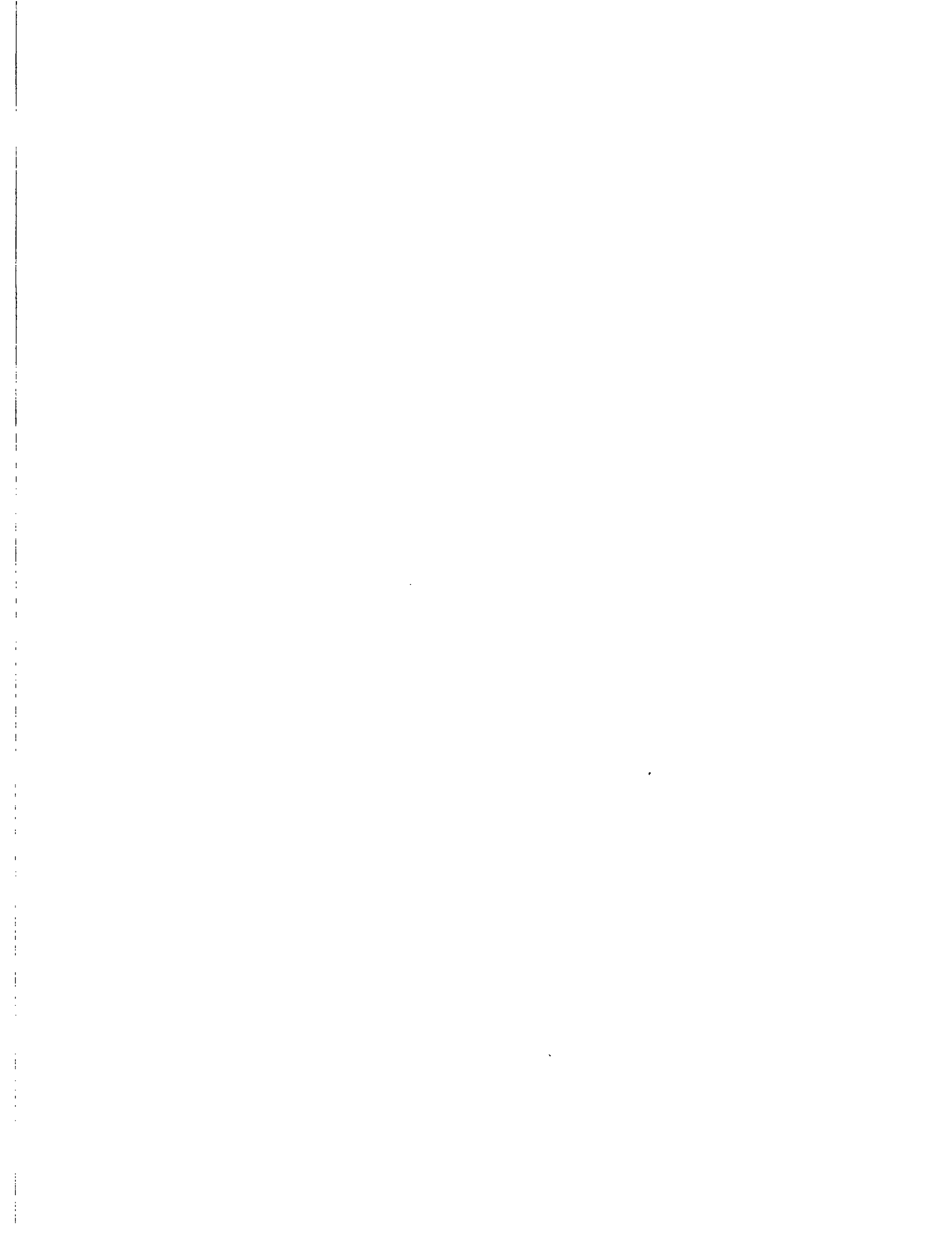

comply with these disclosure requirements may make any contract entered into with the City in connection with the Matter voidable by the City.

X 1. The Disclosing Party verifies that the Disclosing Party has searched any and all records of the Disclosing Party and any and all predecessor entities regarding records of investments or profits from slavery or slaveholder insurance policies during the slavery era (including insurance policies issued to slaveholders that provided coverage for damage to or injury or death of their slaves), and the Disclosing Party has found no such records.

2. The Disclosing Party verifies that, as a result of conducting the search in step 1 above, the Disclosing Party has found records of investments or profits from slavery or slaveholder insurance policies. The Disclosing Party verifies that the following constitutes full disclosure of all such records, including the names of any and all slaves or slaveholders described in those records:

---

---

---

---

## SECTION VI -- CERTIFICATIONS FOR FEDERALLY FUNDED MATTERS

**NOTE: If the Matter is federally funded, complete this Section VI. If the Matter is not federally funded, proceed to Section VII.** For purposes of this Section VI, tax credits allocated by the City and proceeds of debt obligations of the City are not federal funding.

### A. CERTIFICATION REGARDING LOBBYING

1. List below the names of all persons or entities registered under the federal Lobbying Disclosure Act of 1995 who have made lobbying contacts on behalf of the Disclosing Party with respect to the Matter: (Add sheets if necessary):

---

---

---

(If no explanation appears or begins on the lines above, or if the letters "NA" or if the word "None" appear, it will be conclusively presumed that the Disclosing Party means that NO persons or entities registered under the Lobbying Disclosure Act of 1995 have made lobbying contacts on behalf of the Disclosing Party with respect to the Matter.)

2. The Disclosing Party has not spent and will not expend any federally appropriated funds to pay any person or entity listed in Paragraph A.1. above for his or her lobbying activities or to pay any person or entity to influence or attempt to influence an officer or employee of any agency, as defined by applicable federal law, a member of Congress, an officer or employee of Congress, or an employee of a member of Congress, in connection with the award of any federally funded contract, making any federally funded grant or loan, entering into any cooperative agreement, or to extend, continue, renew, amend, or modify any federally funded contract, grant, loan, or cooperative agreement.

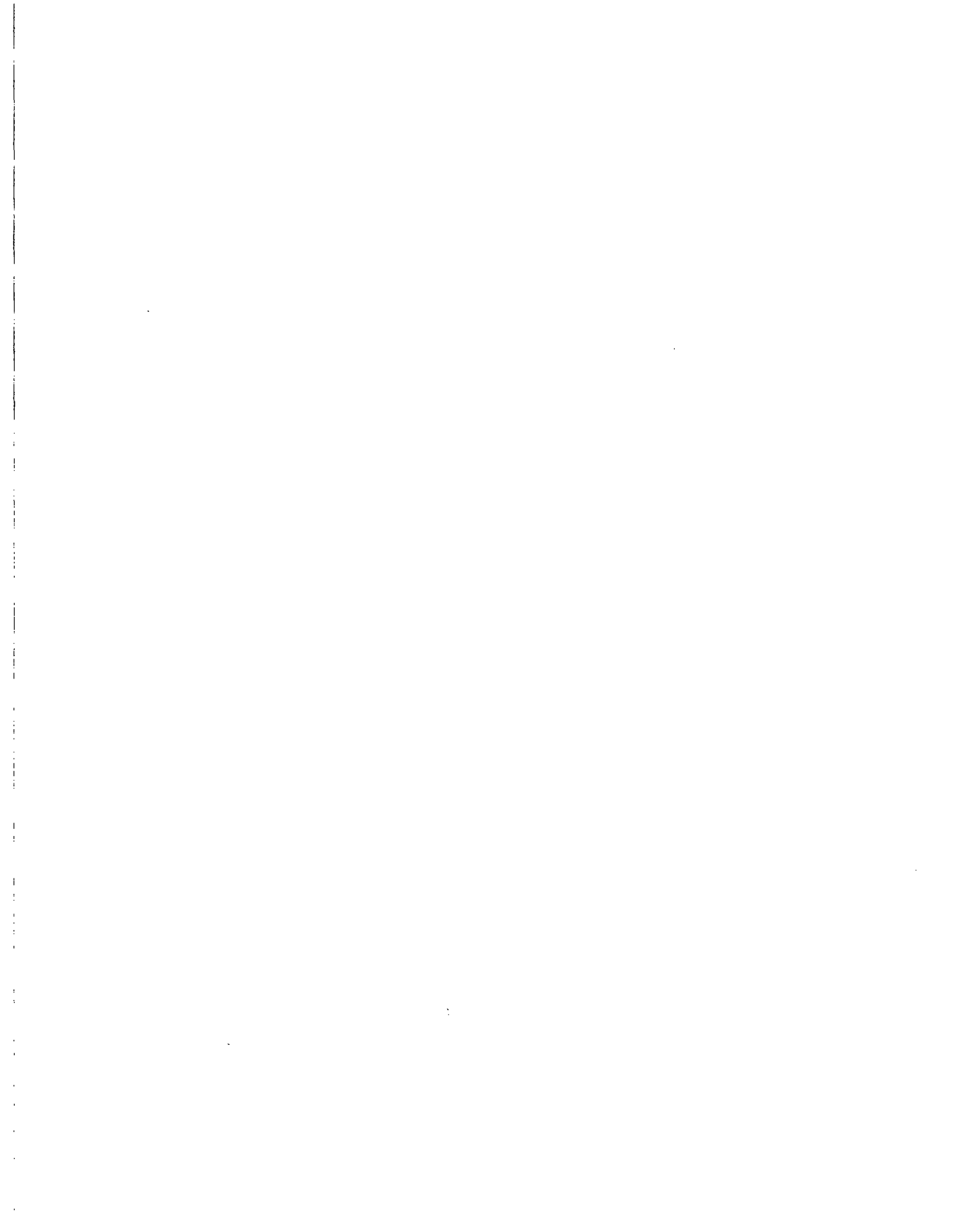

3. The Disclosing Party will submit an updated certification at the end of each calendar quarter in which there occurs any event that materially affects the accuracy of the statements and information set forth in paragraphs A.1. and A.2. above.

4. The Disclosing Party certifies that either: (i) it is not an organization described in section 501(c)(4) of the Internal Revenue Code of 1986; or (ii) it is an organization described in section 501(c)(4) of the Internal Revenue Code of 1986 but has not engaged and will not engage in "Lobbying Activities".

5. If the Disclosing Party is the Applicant, the Disclosing Party must obtain certifications equal in form and substance to paragraphs A.1. through A.4. above from all subcontractors before it awards any subcontract and the Disclosing Party must maintain all such subcontractors' certifications for the duration of the Matter and must make such certifications promptly available to the City upon request.

#### B. CERTIFICATION REGARDING EQUAL EMPLOYMENT OPPORTUNITY

If the Matter is federally funded, federal regulations require the Applicant and all proposed subcontractors to submit the following information with their bids or in writing at the outset of negotiations.

Is the Disclosing Party the Applicant?

Yes                       No

If "Yes," answer the three questions below:

1. Have you developed and do you have on file affirmative action programs pursuant to applicable federal regulations? (See 41 CFR Part 60-2.)

Yes                       No

2. Have you filed with the Joint Reporting Committee, the Director of the Office of Federal Contract Compliance Programs, or the Equal Employment Opportunity Commission all reports due under the applicable filing requirements?

Yes                       No

3. Have you participated in any previous contracts or subcontracts subject to the equal opportunity clause?

Yes                       No

If you checked "No" to question 1. or 2. above, please provide an explanation:

---

---



## **SECTION VII -- ACKNOWLEDGMENTS, CONTRACT INCORPORATION, COMPLIANCE, PENALTIES, DISCLOSURE**

The Disclosing Party understands and agrees that:

A. The certifications, disclosures, and acknowledgments contained in this EDS will become part of any contract or other agreement between the Applicant and the City in connection with the Matter, whether procurement, City assistance, or other City action, and are material inducements to the City's execution of any contract or taking other action with respect to the Matter. The Disclosing Party understands that it must comply with all statutes, ordinances, and regulations on which this EDS is based.

B. The City's Governmental Ethics and Campaign Financing Ordinances, Chapters 2-156 and 2-164 of the Municipal Code, impose certain duties and obligations on persons or entities seeking City contracts, work, business, or transactions. The full text of these ordinances and a training program is available on line at [www.cityofchicago.org/Ethics](http://www.cityofchicago.org/Ethics), and may also be obtained from the City's Board of Ethics, 740 N.

Sedgwick St., Suite 500, Chicago, IL 60610, (312) 744-9660. The Disclosing Party must comply fully with the applicable ordinances.

C. If the City determines that any information provided in this EDS is false, incomplete or inaccurate, any contract or other agreement in connection with which it is submitted may be rescinded or be void or voidable, and the City may pursue any remedies under the contract or agreement (if not rescinded or void), at law, or in equity, including terminating the Disclosing Party's participation in the Matter and/or declining to allow the Disclosing Party to participate in other transactions with the City. Remedies at law for a false statement of material fact may include incarceration and an award to the City of treble damages.

D. It is the City's policy to make this document available to the public on its Internet site and/or upon request. Some or all of the information provided on this EDS and any attachments to this EDS may be made available to the public on the Internet, in response to a Freedom of Information Act request, or otherwise. By completing and signing this EDS, the Disclosing Party waives and releases any possible rights or claims which it may have against the City in connection with the public release of information contained in this EDS and also authorizes the City to verify the accuracy of any information submitted in this EDS.

E. The information provided in this EDS must be kept current. In the event of changes, the Disclosing Party must supplement this EDS up to the time the City takes action on the Matter. If the Matter is a contract being handled by the City's Department of Procurement Services, the Disclosing Party must update this EDS as the contract requires. **NOTE:** With respect to Matters subject to Article I of Chapter 1-23 of the Municipal Code (imposing **PERMANENT INELIGIBILITY** for certain specified offenses), the information provided herein regarding eligibility must be kept current for a longer period, as required by Chapter 1-23 and Section 2-154-020 of the Municipal Code.

The Disclosing Party represents and warrants that:

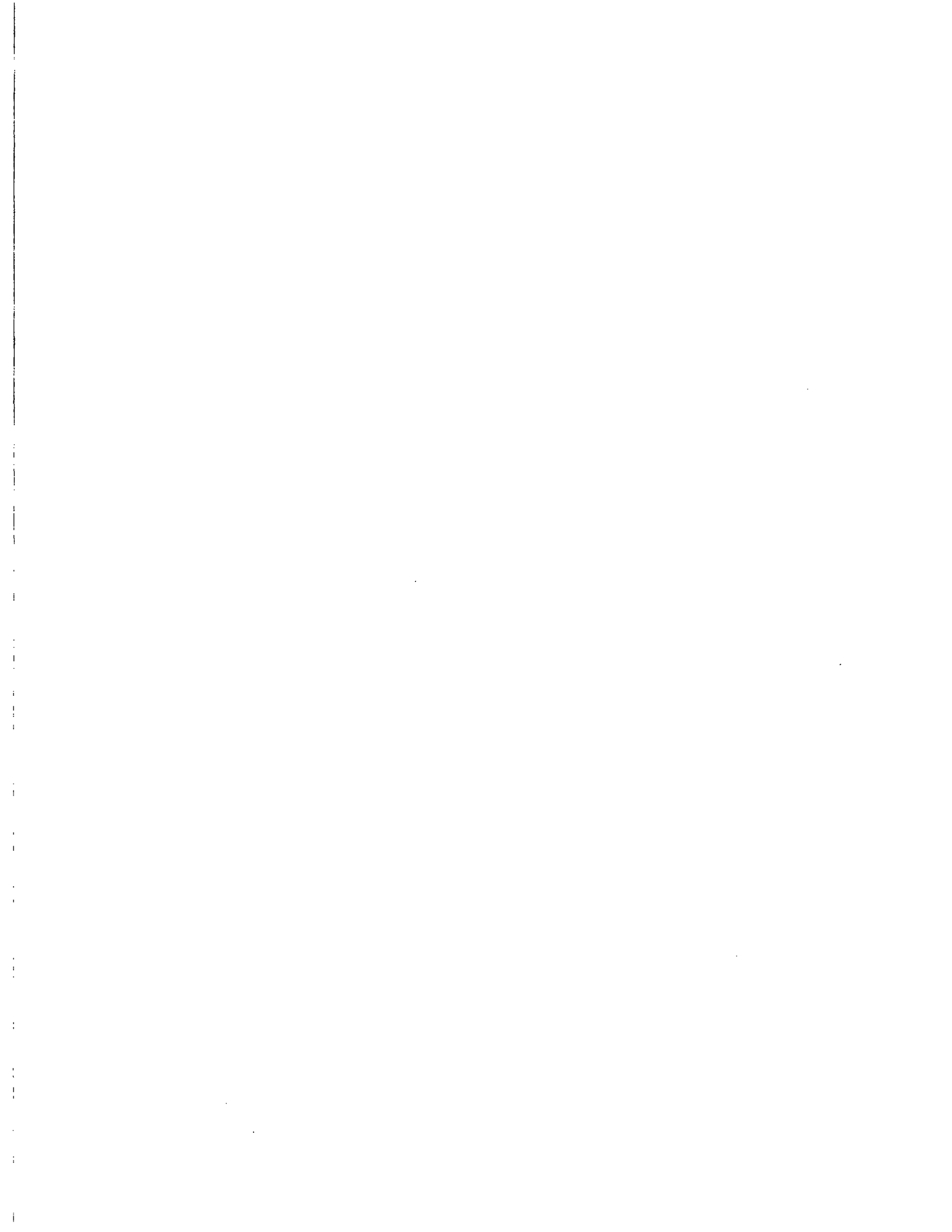



F.1. The Disclosing Party is not delinquent in the payment of any tax administered by the Illinois Department of Revenue, nor are the Disclosing Party or its Affiliated Entities delinquent in paying any fine, fee, tax or other charge owed to the City. This includes, but is not limited to, all water charges, sewer charges, license fees, parking tickets, property taxes or sales taxes.

F.2 If the Disclosing Party is the Applicant, the Disclosing Party and its Affiliated Entities will not use, nor permit their subcontractors to use, any facility listed by the U.S. E.P.A. on the federal Excluded Parties List System ("EPLS") maintained by the U. S. General Services Administration.

F.3 If the Disclosing Party is the Applicant, the Disclosing Party will obtain from any contractors/subcontractors hired or to be hired in connection with the Matter certifications equal in form and substance to those in F.1. and F.2. above and will not, without the prior written consent of the City, use any such contractor/subcontractor that does not provide such certifications or that the Disclosing Party has reason to believe has not provided or cannot provide truthful certifications.

NOTE: If the Disclosing Party cannot certify as to any of the items in F.1., F.2. or F.3. above, an explanatory statement must be attached to this EDS.

**CERTIFICATION**

Under penalty of perjury, the person signing below: (1) warrants that he/she is authorized to execute this EDS and Appendix A (if applicable) on behalf of the Disclosing Party, and (2) warrants that all certifications and statements contained in this EDS and Appendix A (if applicable) are true, accurate and complete as of the date furnished to the City.

The National Museum of Mexican Art  
(Print or type name of Disclosing Party)

By: *Eimy Rosales*  
(Sign here)

Eimy Rosales  
(Print or type name of person signing)

Business Director  
(Print or type title of person signing)

Signed and sworn to before me on (date) January 5, 2016,  
at Cook County, Illinois (state).

Rachel Blanco Notary Public.

Commission expires: May 16, 2018.

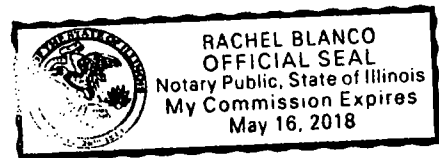



**CITY OF CHICAGO  
ECONOMIC DISCLOSURE STATEMENT AND AFFIDAVIT  
APPENDIX A**

**FAMILIAL RELATIONSHIPS WITH ELECTED CITY OFFICIALS AND DEPARTMENT HEADS**

**This Appendix is to be completed only by (a) the Applicant, and (b) any legal entity which has a direct ownership interest in the Applicant exceeding 7.5 percent. It is not to be completed by any legal entity which has only an indirect ownership interest in the Applicant.**

Under Municipal Code Section 2-154-015, the Disclosing Party must disclose whether such Disclosing Party or any “Applicable Party” or any Spouse or Domestic Partner thereof currently has a “familial relationship” with any elected city official or department head. A “familial relationship” exists if, as of the date this EDS is signed, the Disclosing Party or any “Applicable Party” or any Spouse or Domestic Partner thereof is related to the mayor, any alderman, the city clerk, the city treasurer or any city department head as spouse or domestic partner or as any of the following, whether by blood or adoption: parent, child, brother or sister, aunt or uncle, niece or nephew, grandparent, grandchild, father-in-law, mother-in-law, son-in-law, daughter-in-law, stepfather or stepmother, stepson or stepdaughter, stepbrother or stepsister or half-brother or half-sister.

“Applicable Party” means (1) all executive officers of the Disclosing Party listed in Section II.B.1.a., if the Disclosing Party is a corporation; all partners of the Disclosing Party, if the Disclosing Party is a general partnership; all general partners and limited partners of the Disclosing Party, if the Disclosing Party is a limited partnership; all managers, managing members and members of the Disclosing Party, if the Disclosing Party is a limited liability company; (2) all principal officers of the Disclosing Party; and (3) any person having more than a 7.5 percent ownership interest in the Disclosing Party. “Principal officers” means the president, chief operating officer, executive director, chief financial officer, treasurer or secretary of a legal entity or any person exercising similar authority.

Does the Disclosing Party or any “Applicable Party” or any Spouse or Domestic Partner thereof currently have a “familial relationship” with an elected city official or department head?

Yes

No

If yes, please identify below (1) the name and title of such person, (2) the name of the legal entity to which such person is connected; (3) the name and title of the elected city official or department head to whom such person has a familial relationship, and (4) the precise nature of such familial relationship.

---

---

---



**CITY OF CHICAGO  
ECONOMIC DISCLOSURE STATEMENT AND AFFIDAVIT  
APPENDIX B**

**BUILDING CODE SCOFFLAW/PROBLEM LANDLORD CERTIFICATION**

**This Appendix is to be completed only by (a) the Applicant, and (b) any legal entity which has a direct ownership interest in the Applicant exceeding 7.5 percent (an "Owner"). It is not to be completed by any legal entity which has only an indirect ownership interest in the Applicant.**

1. Pursuant to Municipal Code Section 2-154-010, is the Applicant or any Owner identified as a building code scofflaw or problem landlord pursuant to Section 2-92-416 of the Municipal Code?

Yes  No

2. If the Applicant is a legal entity publicly traded on any exchange, is any officer or director of the Applicant identified as a building code scofflaw or problem landlord pursuant to Section 2-92-416 of the Municipal Code?

Yes  No  Not Applicable

3. If yes to (1) or (2) above, please identify below the name of the person or legal entity identified as a building code scofflaw or problem landlord and the address of the building or buildings to which the pertinent code violations apply.

---

---

---

**FILLING OUT THIS APPENDIX B CONSTITUTES ACKNOWLEDGMENT AND AGREEMENT THAT THIS APPENDIX B IS INCORPORATED BY REFERENCE INTO, AND MADE A PART OF, THE ASSOCIATED EDS, AND THAT THE REPRESENTATIONS MADE IN THIS APPENDIX B ARE SUBJECT TO THE CERTIFICATION MADE UNDER PENALTY OF PERJURY ON PAGE 12 OF THE ASSOCIATED EDS.**

