



# City of Chicago



O2015-7107

Office of the City Clerk

## Document Tracking Sheet

<b>Meeting Date:</b>	9/24/2015
<b>Sponsor(s):</b>	Reilly (42)
<b>Type:</b>	Ordinance
<b>Title:</b>	Grant(s) of privilege in public way for Grand Kingsbury LLC
<b>Committee(s) Assignment:</b>	Committee on Transportation and Public Way

ORDINANCE  
GRAND KINGSBURY LLC  
Acct. No. 1824 - 18  
Permit No. 1119792

*Be It Ordained by the City Council of the City of Chicago:*

SECTION 1. Permission and authority are hereby given and granted to GRAND KINGSBURY LLC, upon the terms and subject to the conditions of this ordinance to maintain and use, as now constructed, two (2) Planter(s) on the public right-of-way for beautification purposes adjacent to its premises known as 520 N. Kingsbury St..

Said Planter(s) at N. KINGSBURY measure(s):

One (1) at thirteen point four (13.4) feet in length, and six point six (6.6) feet in width for a total of eighty-eight point four four (88.44) square feet.

One (1) at sixty-five point one (65.1) feet in length, and six point six (6.6) feet in width for a total of four hundred twenty-nine point six six (429.66) square feet.

Grantee must allow the required clear and unobstructed space for pedestrian passage at all times per rules and regulations approved by the Department of Transportation.

The location of said privilege shall be as shown on prints kept on file with the Department of Business Affairs and Consumer Protection and the Office of the City Clerk.

Said privilege shall be constructed in accordance with plans and specifications approved by the Department of Planning and Development and Department of Transportation (Division of Project Development).

This grant of privilege in the public way shall be subject to the provisions of Section 10-28-015 and all other required provisions of the Municipal Code of Chicago.

The grantee shall pay to the City of Chicago as compensation for the privilege #1119792 herein granted the sum of zero (\$.00) per annum in advance.

A 25% penalty will be added for payments received after due date.

The permit holder agrees to hold the City of Chicago harmless for any damage, relocation or replacement costs associated with damage, relocation or removal of private property caused by the City performing work in the public way.

Authority herein given and granted for a period of five (5) years from and after 07/27/2015.

Alderman \_\_\_\_\_

Brendan Reilly 42nd Ward

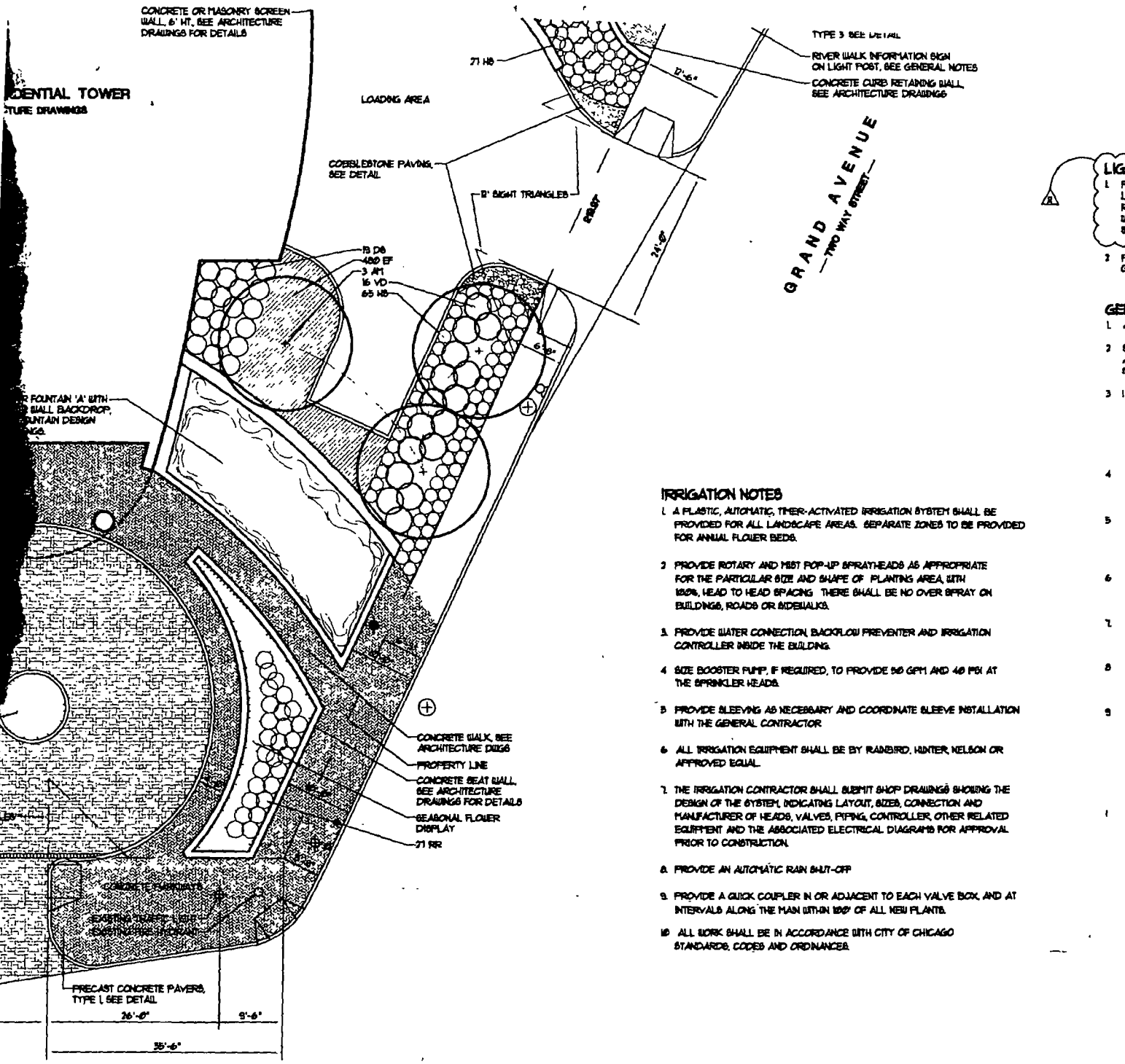

**IRRIGATION NOTES**

1. A PLASTIC, AUTOMATIC, THER-ACTIVATED IRRIGATION SYSTEM SHALL BE PROVIDED FOR ALL LANDSCAPE AREAS. SEPARATE ZONES TO BE PROVIDED FOR ANNUAL FLOWER BEDS.
2. PROVIDE ROTARY AND HSBT POP-UP SPRAYHEADS AS APPROPRIATE FOR THE PARTICULAR SIZE AND SHAPE OF PLANTING AREA, WITH 100% LEAD TO HEAD SPACING. THERE SHALL BE NO OVER SPRAY ON BUILDINGS, ROADS OR SIDEWALKS.
3. PROVIDE WATER CONNECTION, BACKFLOW PREVENTER AND IRRIGATION CONTROLLER INSIDE THE BUILDING.
4. SIZE BOOSTER PUMP, IF REQUIRED, TO PROVIDE 50 GPM AND 40 PSI AT THE SPRINKLER HEADS.
5. PROVIDE SLEEVING AS NECESSARY AND COORDINATE SLEEVE INSTALLATION WITH THE GENERAL CONTRACTOR.
6. ALL IRRIGATION EQUIPMENT SHALL BE BY RAMBIRD, HUNTER NELSON OR APPROVED EQUAL.
7. THE IRRIGATION CONTRACTOR SHALL SUBMIT SHOP DRAWINGS SHOWING THE DESIGN OF THE SYSTEM, INDICATING LAYOUT, SIZES, CONNECTION AND MANUFACTURER OF HEADS, VALVES, PIPING, CONTROLLER, OTHER RELATED EQUIPMENT AND THE ASSOCIATED ELECTRICAL DIAGRAMS FOR APPROVAL PRIOR TO CONSTRUCTION.
8. PROVIDE AN AUTOMATIC RAIN SHUT-OFF.
9. PROVIDE A QUICK COUPLER IN OR ADJACENT TO EACH VALVE BOX AND AT INTERVALS ALONG THE MAIN WITHIN 100' OF ALL NEW PLANTS.
10. ALL WORK SHALL BE IN ACCORDANCE WITH CITY OF CHICAGO STANDARDS, CODES AND ORDINANCES.

**PLANT LIST**

CODE	BOTANICAL NAME	COMMON NAME
<b>DECIDUOUS TREES</b>		
AT	ACER NYABEI 'MORTON'	STATE STREET NYABEE PALM
PC	PYRUS CALLERYANA 'ARISTOCRAT'	ARISTOCRAT PEAR
PO	POPULUS TREMULOIDES	QUAKING ASPEN
TA	TILIA AMERICANA 'REDMOND'	REDMOND LINDEN
<b>DECIDUOUS AND EVERGREEN SHRUBS</b>		
AI	ARONIA MELANOCARPA 'TROGLODITE BEAUTY'	TROGLODITE BEAUTY CHERRY
BM	BUDRA MICROPHYLLA 'GREEN MOUND'	GREEN MOUND BOXWOOD
DB	DIERVILLA SPLENIDENS	SOUTHERN BURN HONEYBUSH
FG	FOTHERGILLA GARDENII	DWARF FOTHERGILLA
HA	HYDRANGEA ARBOR 'WHITE DOME'	WHITE DOME HYDRANGEA
HB	HYDRANGEA MACROPHYLLA 'BALMER'	ENDLESS SUMMER HYDRANGEA
RA	RHUS AROMATICA 'GRO-LOW'	GRO-LOW SUMAC
RR	ROSA 'RADRAZ'	KNOCKOUT ROSE
TH	TAXUS MEDIA 'RUYAN'	RUYAN DENSE YEW
VD	VIORNIUM DENTATUM 'CHURSTON'	BLUE MUFFIN VIORNIUM
VL	VIORNIUM LANTANA 'MONICAN'	MONICAN VIORNIUM
<b>PERENNIALS, ORNAMENTAL GRASSES AND GROUNDCOVERS</b>		
CK	CALAMAGROSTIS A. 'KARL FOERSTER'	FEATHER REED GRASS
EP	EUCHROMIS FORTUNEI 'COLORATUS'	PURPLELEAF WINTERCRE
GB	GERANIUM x 'JOLLY BEE'	JOLLY BEE GERANIUM
HG	HOSTA 'GREAT EXPECTATIONS'	GREAT EXPECTATIONS H
HB	HEBERCALLIS 'STRAWBERRY CANDY'	STRAWBERRY CANDY D.
IO	IRIDIUM BRICATA 'KOBOLD'	DWARF GATFEATHER

COBBLES TO BE SET IN A BED OF LIMESTONE SCREENINGS, OVER A COMPACTED GRAVEL BASE. SET COBBLES SO THAT THERE IS A LEVEL AND FLAT TOP SURFACE. ALL SIDES TO HAVE EDGING, EXCEPT ALONG BACK OF CURB. WRAP FILTER FABRIC UNDER EDGING.

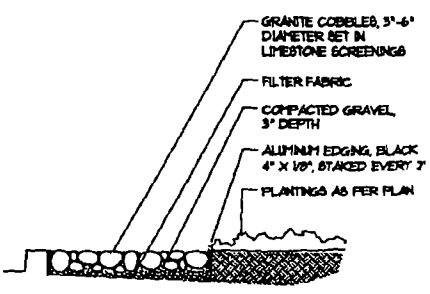

FOR TO DIGGING. EXCAVATE ENTIRE BACKFILL WITH PLANTING MIX AS SPECIFIED GRADE AND WELL DRAINED MULCH LIMITS TO 28 TO EXTEND TO ALL EDGES OF THE SEE PLANT LIST FOR PLANT SPACING.

PACING, AS SPECIFIED IN THE PLANT LIST SHALL BE PLACED WITH THEIR CENTERS 1" THAN 2" FROM EDGE OF BED. MULCH SHALL BE PLACED WITH THEIR 2" CLOSER THAN 6" FROM EDGE OF BED.

LEAF MULCH, 2" DEPTH AROUND PERENNIALS AND 1" DEPTH AROUND GROUNDCOVERS.

LIGHT  
1 PC  
LK  
RE  
#1  
#2  
#3  
#4  
#5  
#6  
#7  
#8  
#9  
#10

GE  
L  
2  
3  
4  
5  
6  
7  
8  
9  
10