



Office of the City Clerk



O2012-5404

Office of the City Clerk

City Council Document Tracking Sheet

Meeting Date:	7/25/2012
Sponsor(s):	Tunney, Thomas (44)
Type:	Ordinance
Title:	Grant(s) of privilege in public way for 3830 N. Sheffield Manor Condominium
Committee(s) Assignment:	Committee on Transportation and Public Way

ORDINANCE

3830 N. Sheffield Manor Condominium

Acct. No. 220062 - 1

Permit No. 1101695

Be It Ordained by the City Council of the City of Chicago:

SECTION 1. Permission and authority are hereby given and granted to 3830 N. Sheffield Manor Condominium, upon the terms and subject to the conditions of this ordinance to maintain and use, as now constructed, one (1) Flood Control(s) under the public right-of-way adjacent to its premises known as 3830 N. Sheffield Ave..

Said Flood Control(s) at N. Sheffield Ave. measure(s):

Existing flood control system consist of an automatic backflow valve and a sewer ejector pump under the sidewalk area three (3) feet from front foundation with thirty-six (36) inch diameter basin under grade and a heavy duty four (4) inch steel manhole frame with a solid lid at grade of sidewalk. Existing flood control system is attached to the building's private drain for purpose of preventing sewer backups from flooding the basement of the building. Existing area measure thirty-six (36) feet in length and four (4) feet in width for a total of one hundred forty-four (144) square feet.

The location of said privilege shall be as shown on prints kept on file with the Department of Business Affairs and Consumer Protection and the Office of the City Clerk.

Said privilege shall be constructed in accordance with plans and specifications approved by the Department of Transportation (Office of Underground Coordination) and Department of Water Management.

This grant of privilege in the public way shall be subject to the provisions of Section 10-28-015 and all other required provisions of the Municipal Code of Chicago.

The grantee shall pay to the City of Chicago as compensation for the privilege #1101695 herein granted the sum of four hundred (\$400.00) per annum in advance.

A 25% penalty will be added for payments received after due date.

The permit holder agrees to hold the City of Chicago harmless for any damage, relocation or replacement costs associated with damage, relocation or removal of private property caused by the City performing work in the public way.

Authority herein given and granted for a period of five (5) years from and after 11/28/2011.

Alderman

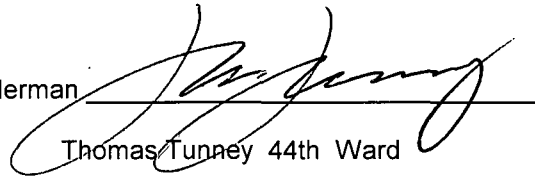

Thomas Tunney 44th Ward

Use of Public Way Renewal Application
 3830 N Sheffield Manor Condominium
 Flood Control System Diagram
 October 27, 2006

Scale - 1/20 : 1

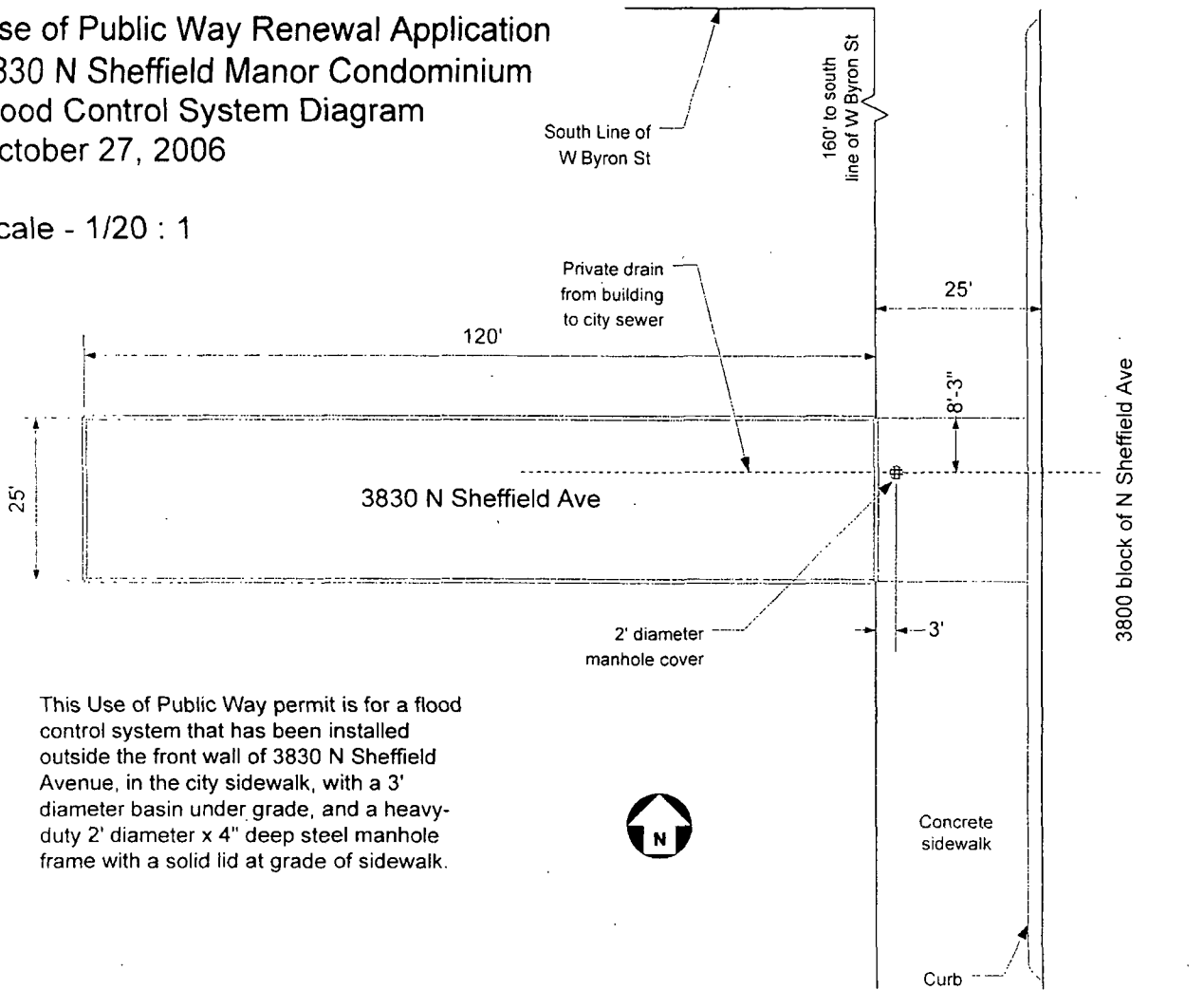

This Use of Public Way permit is for a flood control system that has been installed outside the front wall of 3830 N Sheffield Avenue, in the city sidewalk, with a 3' diameter basin under grade, and a heavy-duty 2' diameter x 4" deep steel manhole frame with a solid lid at grade of sidewalk.



07/25/2012

Alderman **Thomas Tunney**
Ward # 44
City of Chicago
City Hall, Room 203
121 North LaSalle Street
Chicago, Illinois 60602

Re: An ordinance to use and maintain a portion of the public right-of-way for **one (1) flood control(s)** for **3830 N. Sheffield Manor Condominium**, adjacent to the premises known as **3830 N. Sheffield Ave.**

Dear Alderman **Thomas Tunney**:

The applicant referenced above has requested the use of the public right-of-way for a **flood control(s)**. An ordinance has been prepared by the Department of Business Affairs and Consumer Protection – Business Assistance Center - Public Way Use Unit for presentation to the City Council. Because this request was made for properties located in your ward, as approved by you as per the attached, I respectfully request that you introduce the attached ordinance at the next City Council meeting.

If you have any questions regarding this ordinance, please contact Anthony Bertuca at (312) 744-5506.

Department of Business Affairs and Consumer Protection