



# Office of the City Clerk



Or2013-174

Office of the City Clerk

## City Council Document Tracking Sheet

<b>Meeting Date:</b>	4/10/2013
<b>Sponsor(s):</b>	Solis, Daniel (25)
<b>Type:</b>	Order
<b>Title:</b>	Issuance of permits for sign(s)/signboard(s) at 329 W 18th St - west elevation
<b>Committee(s) Assignment:</b>	Committee on Zoning, Landmarks and Building Standards

ORDERED, That the Commissioner of the Building Department is hereby directed to issue a sign permit to: *(Contractor's name and address)*

**M-K Signs Inc  
4900 N Elston Ave  
Chicago IL 60630**

For the erection of a sign / signboard over twenty-four (24) feet in height and / or over one hundred (100) square feet (in area of one face) at:

**329 W 18<sup>th</sup> Street  
Chicago IL 60613**

With the following Dimensions, height, and square foot area:

West Elevation

**Dimensions: Length: 90 feet Height 4 feet  
Height Above Grade / Roof to top of Sign: 116 feet  
Total Square Foot Area: 360 Square Feet**

Such signs shall comply with all provisions of Title 17 of the Chicago Zoning Ordinance and all other applicable provisions of the Municipal Code of the City of Chicago governing the construction and maintenance of outdoor signs, sign boards, and structures.



---

Daniel Solis  
Alderman, 25<sup>th</sup> Ward



CITY OF CHICAGO

# DEPARTMENT OF BUILDINGS

## Sign Permit Application

APPROVAL NUMBER	APPLICATION NUMBER 100479853	ANNUAL FEE	WORK CODE	DRAWINGS ATTACHED <input type="checkbox"/> YES <input type="checkbox"/> NO
-----------------	---------------------------------	------------	-----------	-------------------------------------------------------------------------------

DATE OF APPLICATION 03/01/2013	
ADDRESS OF SIGN 329 W 18TH ST, 60616-	
BUILDING	ORIGINAL PERMIT NUMBER
TYPE OF PERMIT NEW CONSTRUCTION (SIGN)	
PAYER OF ANNUAL INSPECTION KATZ, NATASHA 329 W. 18TH STREET CHICAGO, IL 60616 (773)545-4444	
SIGN MANUFACTURER M-K SIGNS, INC.	
ADDRESS WHERE SIGN CAN BE SEEN PRIOR TO ERECTION	
TICKET NUMBER 0	REINSPECTION CONTROL NUMBER
TYPE OF SUPPORT FOR SIGN BUILDING	
SIGN BOARD SUPPORT MEMBERS STEEL	
ANNUAL FEE	_____
CONSTRUCTION FEE	200.00
1017 B FEE	_____
TOTAL FEE	200.00
AMOUNT PAID	200.00
BALANCE DUE	_____

TYPE OF SIGN FLAT OR BOX					
LENGTH	FT. 90	IN 0	HEIGHT	FT. 4	IN 0
AREA	SQ FT 360	WEIGHT		LBS 200	
SIGN HEIGHT ABOVE GRADE/ROOF				FT 116	
SHAPE OF SIGN REGULAR					
SIGN WILL READ BLUE STAR COMMERCIAL LOFT SPACE					
NO OF LAMPS			TOTAL WATTAGE		
TYPE OF LAMP					
NO OF BALLAST/TRANSFORMERS			INPUT OF TRANSFORMERS		
CONTRACTOR WILL INSTALL			<input checked="" type="checkbox"/> FEEDERS <input checked="" type="checkbox"/> CUSTOMER LEADS		
TYPE OF SWITCH					
LOCATION OF SWITCH					
SIGN LOCATION BLUE STAR BANNER SIGN, WEST ELEVATION					

The undersigned certfy that the statements in this application are true and correct and that all work done under the proposed permit will conform to the requirements of the Chicago Municipal Code

REG NO	
ELECT CONTR	
ADDRESS	
SUPERVISOR SIGNATURE	

BOND NO	REG. NO E05834
SIGN ERECTOR M-K SIGNS, INC.	SIGNER
ADDRESS 4900 N. ELSTON AVE. CHICAGO, IL, 60630	
SIGNATURE	

The permit issued on this application will authorize only signs here applied for. If other signs are to be erected they must be covered by additional permits.

City of Chicago  
Rahm Emanuel, Mayor



Department of Buildings  
Michael Merchant, Commissioner

TYPE OF BUSINESS <u>COMMERCIAL</u> Other: _____ Name <u>BLUE STAR</u> LIC #: _____ Renewal Date: _____	SIGN BOND REQUIRED? <input type="checkbox"/> YES COUNCIL ORDER REQUIRED <input checked="" type="checkbox"/> YES IS SPECIAL PERMISSION REQUIRED FROM CHIEF ELECTRICAL <input type="checkbox"/> YES IF YES, ATTACH LETTER OF REQUEST
Projects Over: <input checked="" type="checkbox"/> Private Property <input checked="" type="checkbox"/> Public Way Grant Permit # _____ <input checked="" type="checkbox"/> Planned Development/Manufacturing PMD/PI#: <u>PMD 11</u> Zoning District <u>M1</u> Other: _____	TIME STAMP
TYPE OF SIGN: <input type="checkbox"/> ADVERTISING <input type="checkbox"/> ILLUMINATE <input type="checkbox"/> MOVEABLE <input checked="" type="checkbox"/> BUSINESS <input type="checkbox"/> FLASHING	
TOTAL STREET FRONTAGE OF LOT (IN FEET) <u>450</u>	
TOTAL AREA OF NEW SIGN (SQ FT.) <u>360</u>	
TOTAL AREA OF ALL SIGNS ON LOT (SQ FT.) <u>360</u>	
HEIGHT OF SIGN ABOVE GRADE (TO TOP) <u>120ft 0in</u>	
DISTANCE OF CURB LINE OUTER EDGE (ft) <u>12</u> DISTANCE OF STRUCTURE INNER EDGE (ft) <u>13</u>	SIGN CLERK _____ APPROVED FOR PERMIT _____
DISTANCE FROM (ft): A. PUBLIC PARK (OVER 10 ACRES) _____ B. EXPRESSWAY (IF LESS THAN 1,000 FT.) _____ C. RESIDENCE DISTRICT (ADVERTISING SIGNS ONLY) _____	REMARKS
IF REPLACEMENT SIGN OR CHANGE OF FACE, WHAT DOES THE EXISTING SIGN READ?  Original Payee: _____	
Landmark Hold: <input type="checkbox"/> Status: _____	
ZONING (OFFICE USE ONLY)	

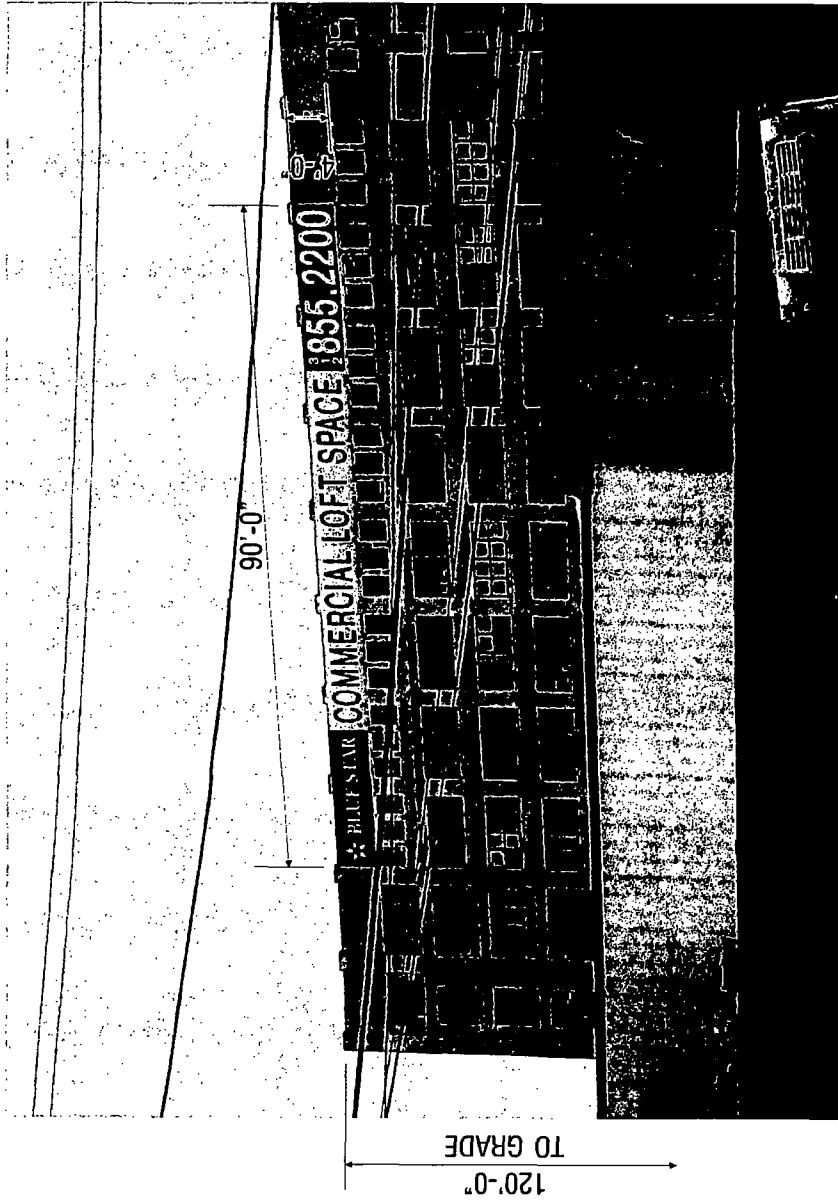

WEST ELEVATION

S/F BANNER DISPLAY  
 4'-0" X 90'-0" DISPLAY  
 FLEX FACE W/ VINYL COPY  
 MOUNTED W/ STAINLESS STEEL ANCHORS ON 18" CENTERS

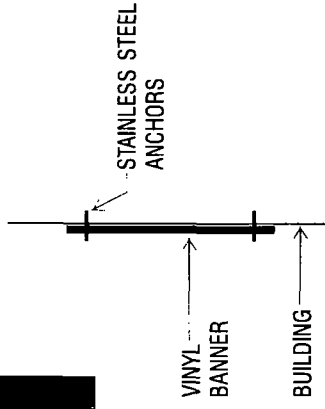

SIDE VIEW

APPROVED: \_\_\_\_\_ DATE: \_\_\_\_\_

**M-K SIGNS**  
 CHICAGO  
 4900 N. ELSTON AVE  
 CHICAGO, IL 60630  
 773/305-0200  
 FAX 773/543-0042  
 E-MAIL: [artdept@mksigns.net](mailto:artdept@mksigns.net)

**BLUE STAR**  
 CHICAGO, IL

Colors represented in this drawing are for presentation purposes only. They will not match your finished product exactly. Actual color samples can be obtained from your sales representative. This design is the original and unpublished work of MK SIGNS and may not be reproduced, copied or exhibited in any fashion without the expressed written consent of MK SIGNS. The rights to this design may be purchased.

DATE	REVISION	SCALE	DATE
		N.T.S.	3-1-13
		DESIGNER	SALES
		LM	RC
		FILE	DRAWING NUMBER
		Blue Star	2177-2

**CITY OF CHICAGO**  
**DEPARTMENT OF ZONING AND LAND USE PLANNING**  
**SIGN SITE PLAN**  
*( ALL INFORMATION MUST BE COMPLETED AND LEGIBLE )*

Site Address: 329 W. 18TH STREET 1 of 2 applications

Sign Company: M-K SIGNS, INC Rep Name: ANTHONY CILIA

Phone (773) 545-4444 EXT          (Below: Building, streets and location of sign on lot or structure)  
 North

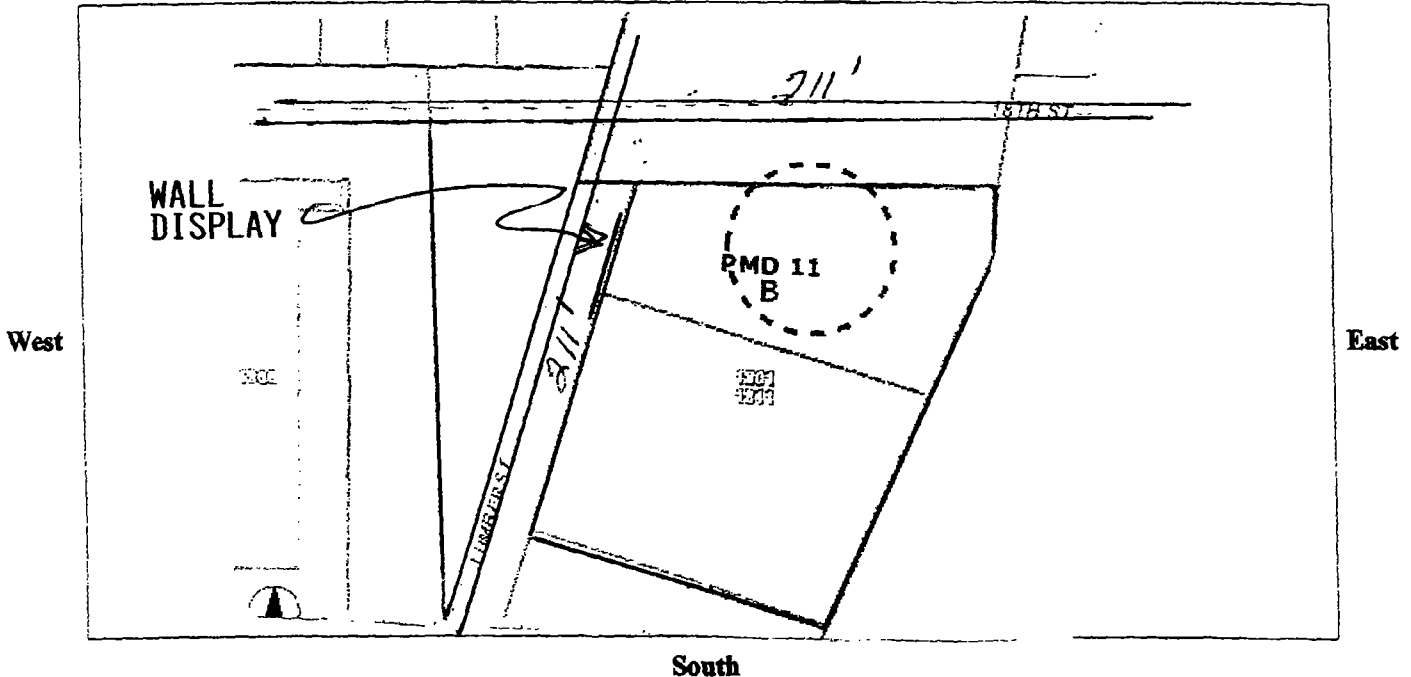

**SIGN USE:**  
 Bus. ID (On-premise)  **XX**  
 Business Lice. # \_\_\_\_\_  
 Advertising (Off-premise)

**TYPE OF SIGN:**  
 Flat Wall  **XX**  
 Freestanding   
 Awning   
 Marquee   
 High Rise Building   
 Projecting Private  **XX**  
 Projecting Public Way   
 Public Way Use -Permit # \_\_\_\_\_

**SIGN CHARACTERISTICS:**  
 Non- Illuminated  **XX**  
 Illuminated   
 Changing Image   
 Video Display   
 Flashing

**PERMIT TYPE:**  
 New Construction  **XX**  
 Change of Face \_\_\_\_\_  
 Previous Permit #

**DISTANCE FROM:**  
 Curb Line: 13FT  
 Expressway, Toll Roads  
 or Major Route XX  
 (n/a if over 1000 ft)  
 Park (over 10 acres) XX  
 Residential Zone XX  
 Existing Off-premise on  
 same side of street: XX

**TOTAL SQUARE FOOTAGE:**  
 Square footage of this proposed sign 360  
 Gross area of all proposed signs 720  
 Area of all existing signs  
 (not including proposed) on Zoning Lot 0

Signature: Anthony Cilia

Date: 3-15-13

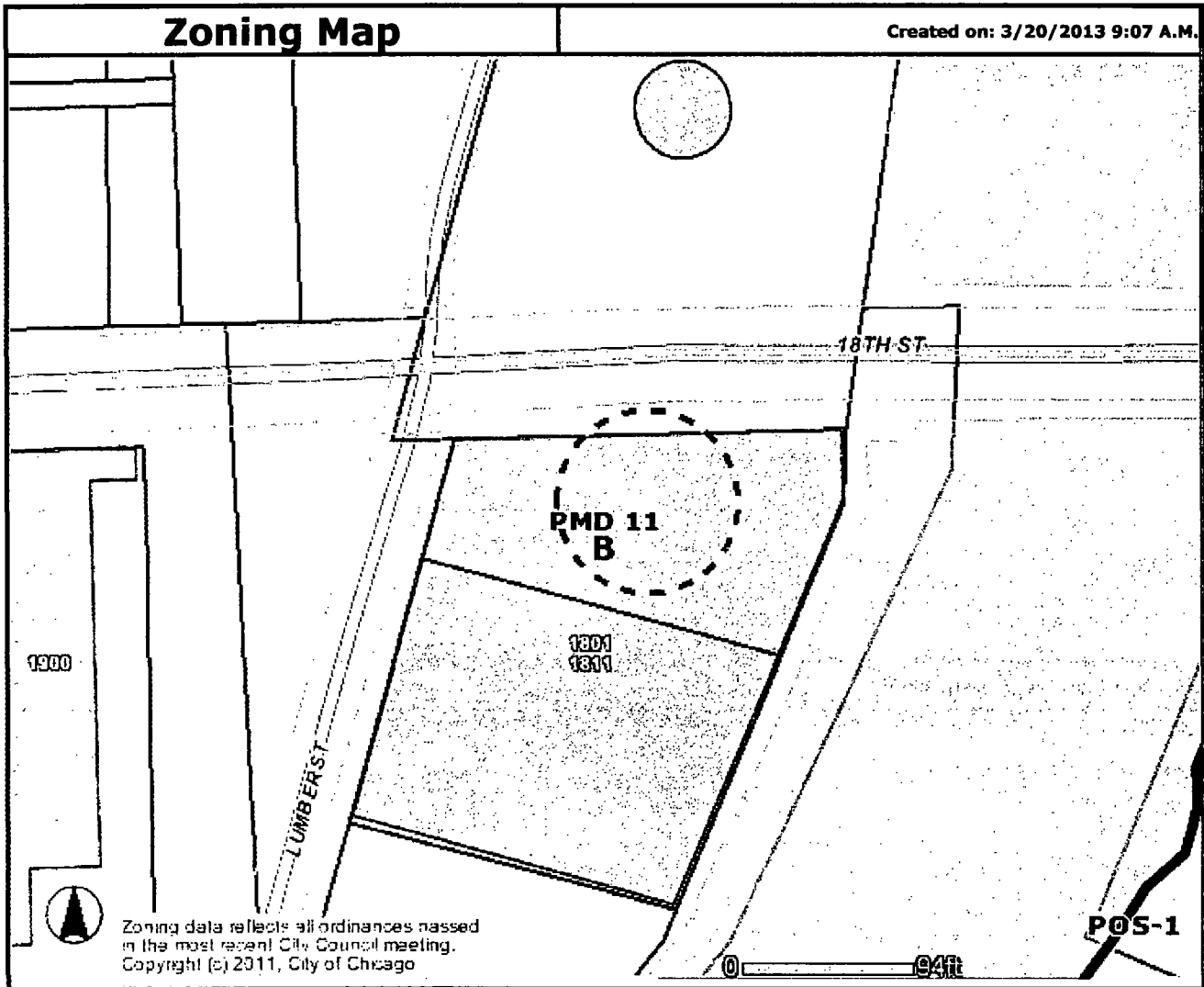

**Address**

329 W 18TH ST

**Zoning**

- Business
- Commercial
- Manufacturing
- Residential
- Planned Development
- Planned Manufacturing
- Downtown Core
- Downtown Service
- Downtown Mixed
- Downtown Residential
- Transportation
- Parks & Open Space
- Zoning Boundaries

**Historic Preservation**

- CHICAGO LANDMARKS**
- Chicago Landmarks
  - Landmark Districts
- Chicago Historic Resources Survey - Buildings subject to Demolition-Delay Ordinance**
- Red
  - Orange
  - Water
  - Cemetery
  - Municipalities

**Lakefront**

- Pedestrian Streets
- Buildings
- Parcels
- Streets
- Curbs
- Forest Preserve
- City Boundary

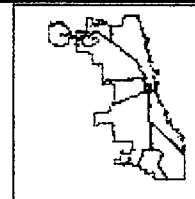

Information provided on the City of Chicago web site should not be used as a substitute for legal, accounting, real estate, business, tax, or other professional advice. The City of Chicago assumes no liability for any damages or loss of any kind that might arise from the use of, misuse of, or the inability to use the City web site and-or the materials contained on the web site. The City of Chicago also assumes no liability for improper or incorrect use of materials or information contained on its web site. All materials that appear on the City of Chicago web site are distributed and transmitted as is, without warranties of any kind, either express or implied, and subject to the terms and conditions stated in this disclaimer.