



City of Chicago



O2015-6971

Office of the City Clerk

Document Tracking Sheet

Meeting Date:	9/24/2015
Sponsor(s):	O'Connor (40)
Type:	Ordinance
Title:	Grant(s) of privilege in public way for Napleton's Northwestern Chrysler Jeep Dodge
Committee(s) Assignment:	Committee on Transportation and Public Way

ORDINANCE
NAPLETON'S NORTHWESTERN CHRYSLER JEEP DODGE
Acct. No. 63963 - 5
Permit No. 1118295

Be It Ordained by the City Council of the City of Chicago:

SECTION 1. Permission and authority are hereby given and granted to NAPLETON'S NORTHWESTERN CHRYSLER JEEP DODGE, upon the terms and subject to the conditions of this ordinance to maintain and use eight (8) sign(s) projecting over the public right-of-way attached to its premises known as 5950 N. Western Ave..

Said sign structure(s) measures as follows; along N. Western Avenue:

One (1) at two point six seven (2.67) feet in length, fifteen (15) feet in height and twenty (20) feet above grade level.

One (1) at seven point five (7.5) feet in length, one point five (1.5) feet in height and twenty (20) feet above grade level.

One (1) at twelve (12) feet in length, three (3) feet in height and twelve (12) feet above grade level.

One (1) at twelve (12) feet in length, three point one seven (3.17) feet in height and twelve (12) feet above grade level.

One (1) at seven point five (7.5) feet in length, three (3) feet in height and twelve (12) feet above grade level.

One (1) at twelve (12) feet in length, one point two five (1.25) feet in height and twelve (12) feet above grade level.

One (1) at twelve (12) feet in length, two point three three (2.33) feet in height and twelve (12) feet above grade level.

One (1) at nine (9) feet in length, two (2) feet in height and fifteen (15) feet above grade level.

The location of said privilege shall be as shown on prints kept on file with the Department of Business Affairs and Consumer Protection and the Office of the City Clerk.

Said privilege shall be constructed in accordance with plans and specifications approved by the Department of Transportation (Division of Project Development) and Zoning Department - Signs.

This grant of privilege in the public way shall be subject to the provisions of Section 10-28-015 and all other required provisions of the Municipal Code of Chicago.

The grantee shall pay to the City of Chicago as compensation for the privilege #1118295 herein granted the sum of one thousand three hundred seventy-five (\$1,375.00) per annum in advance.

A 25% penalty will be added for payments received after due date.

The permit holder agrees to hold the City of Chicago harmless for any damage, relocation or replacement costs associated with damage, relocation or removal of private property caused by the City performing work in the public way.

Authority herein given and granted for a period of five (5) years from and after Date of Passage.

Alderman

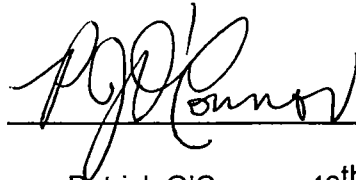
A handwritten signature in black ink, appearing to read "Patrick O'Connor". The signature is written in a cursive style and is positioned above a horizontal line.

Patrick O'Connor 40th Ward

Chicago Sign and Light Company

CHICAGO SIGN[®]

25W 325 St Charles Road Unit A
 Carol Stream, IL 60198
 630-407-0852 Fax 630-407-0855
 ChicagoSign@aol.com

03.12.2015

Napleton's Northwestern Chrysler
 5950 N. Western Ave, Chicago, IL 60659

USE OF THE PUBLIC WAY DRAWING



East Elevation

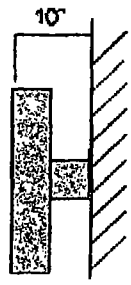
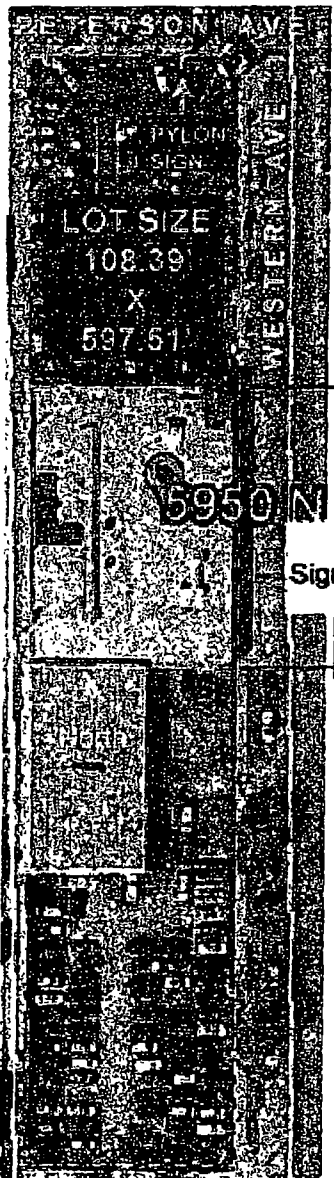

Storefront Sign Side View

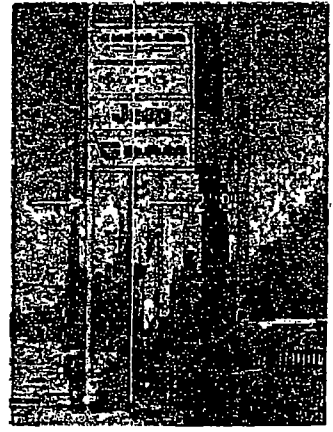

Pylon sign use of the public way
 29' Pylon Sign

	Area:	Public Way Use:
Pylon Sign:	10' x 15' = 150 sq ft	29' x 32' = 6.4 sq ft
Enterprise	18' x 90' = 11 sq ft	10' x 90' = 6.3 sq ft
EXPRESS LANE	35' x 144' = 38 sq ft	10' x 144' = 10 sq ft
RAM	35' x 144' = 38 sq ft	10' x 144' = 10 sq ft
Jeep	38' x 90' = 22.5 sq ft	10' x 90' = 6.3 sq ft
DODGE	15' x 144' = 15 sq ft	10' x 144' = 10 sq ft
CHRYSLER	28' x 144' = 28 sq ft	10' x 144' = 10 sq ft
Napleton	24' x 108' = 18 sq ft	10' x 108' = 7.5 sq ft
	320.5 Sq Ft	PW Use: 66.5 SQ FT



09/24/2015

Alderman **Patrick O'Connor**
Ward # **40**
City of Chicago
City Hall, Room **300**
121 North LaSalle Street
Chicago, Illinois 60602

Re: An ordinance to use and maintain a portion of the public right-of-way for **eight (8) sign(s)** for **NAPLETON'S NORTHWESTERN CHRYSLER JEEP DODGE**, adjacent to the premises known as **5950 N. Western Ave.**.

Dear Alderman **Patrick O'Connor**:

The applicant referenced above has requested the use of the public right-of-way for a **sign(s)**. An ordinance has been prepared by the Department of Business Affairs and Consumer Protection – Small Business Center - Public Way Use Unit for presentation to the City Council. Because this request was made for properties located in your ward, as approved by you as per the attached, I respectfully request that you introduce the attached ordinance at the next City Council meeting.

If you have any questions regarding this ordinance, please contact Anthony Bertuca at (312) 744-5506.

Department of Business Affairs and Consumer Protection