



Office of Chicago City Clerk



Or2011-345

Office of the City Clerk

City Council Document Tracking Sheet

Meeting Date:	4/13/2011
Sponsor(s):	Fioretti, Bob (2)
Type:	Order
Title:	Issuance of Permit(s) for Sign(s)/Signboard(s) at 1154 S Clark St
Committee(s) Assignment:	Committee on Buildings

(signs)

ORDERED, That the Commissioner of Buildings is hereby directed to
issue a sign permit to: (Contractor's name and address)

Neon Prism

1213 Paramount Parkway

Batavia, IL 60510

for the erection of a sign / signboard over 24 feet in height and / or over 100
square feet (in area of one face) at: (Business NAME & ADDRESS)

Target Corporation

Premises Address: 1154 South Clark Street

Dimensions: Length 3'10" +/- Height 25' 1" +/-

Height above grade / roof to top of sign 43' 1"

TOTAL SQUARE FOOT AREA 100 +/-

Such sign(s) shall comply with all applicable provisions of TITLE 17 of the
Chicago Zoning Ordinance and all other applicable provisions of the Municipal
Code of the City of Chicago governing the construction and maintenance of
outdoor signs, signboards and structures.

Alderman, 2nd Ward



BLAIR COMPANIES
ARCHITECTURAL IMAGING
SIGNS • FIXTURES • LOGISTICS

address: 5107 Kissell Avenue
Altoona FA 16601
telephone: 814.949.8287
fax: 814.949.8293
web: blaircompanies.com

project information

client: TARGET
address: 1154 South Clark Street
Chicago, I.L.
store #:
m number: 92006
date: 03/04/11
rendered: Jov. R.
file name: TGT 92006_10A

revisions

- a. 03-04-11, Jov. revise package as per .pdf attachment.
- b. 03-16-11, ng chgs per customer
- c. 03-21-11, ng chgs per customer
- d. 03-25-11, Jov, chgs per customer
- e. 03-29-11, ng, chgs per customer

These drawings are not for construction. The information contained herein is intended to express design intent only.

This original design is the sole property of the Blair Companies, it cannot be reproduced, copied or exhibited, in whole or part, without first obtaining written consent from the Blair Companies.

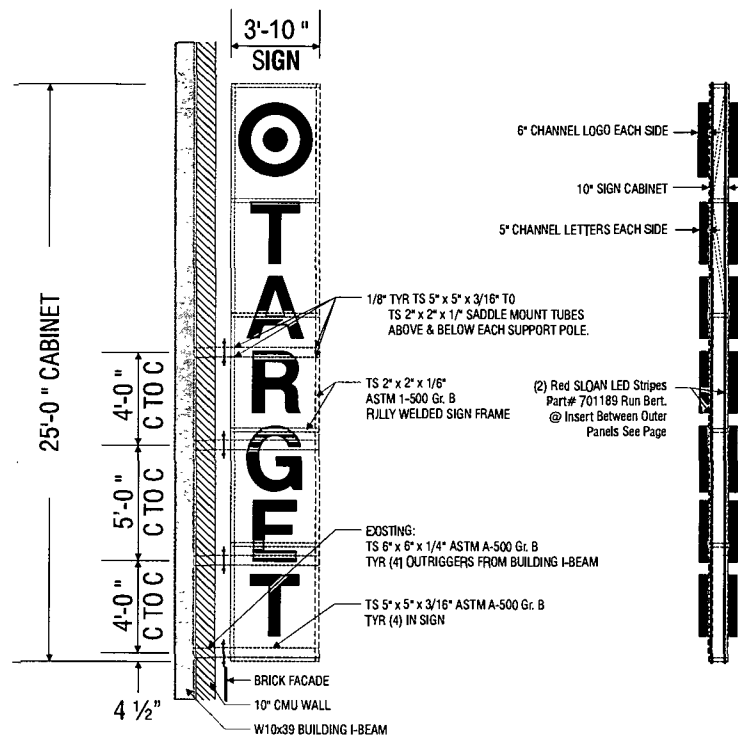

SIDE ELEVATION VIEW

SCALE: 1/8" = 1'-0"

STANDARD WALL SIGN NOTES:

1. Sufficient Primary Circuit In Vicinity Of Sign By Others.
2. Letter To Letter Wiring & Final Primary Hook-up By Others.
3. Sign Shall Be U.L. Listed.
4. Mounting Hardware By Sign Installer.

SIDE VIEW

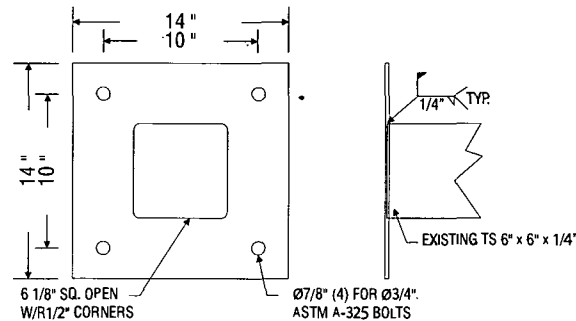

MATCH PLATE DETAIL
3/4" ASTM A-36 STEEL

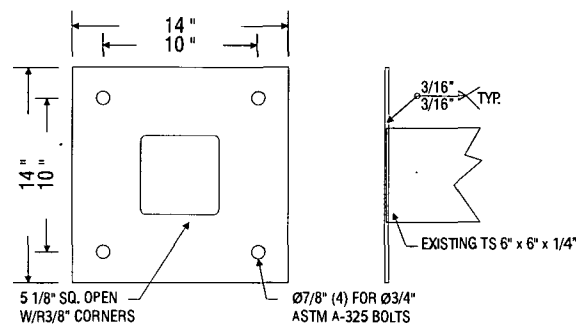

MOUNTING PLATE DETAIL
3/4" ASTM A-325 BOLTS

ELECTRICAL LOAD
(11) Amps @ 120 Volts
ELECTRICAL REQ'MTS
(1) 20 Amp/120 Volt Circuits

• 25'-1" X 3'-10" BLADE SIGN MOUNTED TO EXISTING OUTRIGGERS FROM BUILDING WALL

QTY = 1





CITY OF CHICAGO

DEPARTMENT OF BUILDINGS

Sign Permit Application

APPROVAL NUMBER	APPLICATION NUMBER 100387977	ANNUAL FEE	WORK CODE	DRAWINGS ATTACHED <input type="checkbox"/> YES <input type="checkbox"/> NO
DATE OF APPLICATION 04/02/2011		TYPE OF SIGN FLAT OR BOX		
ADDRESS OF SIGN 1154 S CLARK ST, 60605-		LENGTH	FT. 3 IN. 10	HEIGHT
BUILDING	ORIOINAL PERMIT NUMBER	AREA	SQ FT. 96	WEIGHT
TYPE OF PERMIT NEW CONSTRUCTION (SIGN)		SIGN HEIGHT ABOVE GRADE/ROOF		FT. 18
PAYER OF ANNUAL INSPECTION NAGEL, SUE 1154 S CLARK ST CHICAGO, IL 60605 (312) 918-0287		SHAPE OF SIGN REGULAR		
Target Corporation Attn: Judy Bezanson 1000 Nicollet Mall, TPN 0910 Minneapolis, MN 55403		SIGN WILL READ TARGET		
SIGN MANUFACTURER BLAIR COMPANIES		NO. OF LAMPS	TOTAL WATTAGE	
ADDRESS WHERE SIGN CAN BE SEEN PRIOR TO ERECTION		400	1920	
TICKET NUMBER 0	REINSPECTION CONTROL NUMBER	TYPE OF LAMP OTHER		
TYPE OF SUPPORT FOR SIGN BUILDING		NO OF BALLAST/TRANSFORMERS	INPUT OF TRANSFORMERS	
SIGN BOARD SUPPORT MEMBERS STEEL		8	120V	
ANNUAL FEE		CONTRACTOR WILL INSTALL <input checked="" type="checkbox"/> FEEDERS <input checked="" type="checkbox"/> CUSTOMER LEADS		
CONSTRUCTION FEE 200.00		TYPE OF SWITCH SPECIAL		
1017 B FEE		LOCATION OF SWITCH LISTED FLUSH TOGGLE		
TOTAL FEE 200.00		SIGN LOCATION INSTALL ONE INTERNALLY ILLUMINATED BLADE SIGN ON SOUTH ELEVATION		
AMOUNT PAID 200.00		Check # for Zoning		
BALANCE DUE		Check # for DCAP		

The undersigned certify that the statements in this application are true and correct and that all work done under the proposed permit will conform to the requirements of the Chicago Municipal Code

REG. NO. E92427	BOND NO	REG. NO. N93036
ELECT CONTR NEON PRISM	SIGN ERECTOR NEON PRISM	SIGNER
ADDRESS 1213 PARAMOUNT PARKWAY BATAVIA, IL 60510-	ADDRESS 1213 PARAMOUNT PKWY BATAVIA IL, 60510-	
SUPERVISOR SIGNATURE	SIGNATURE	

The permit issued on this application will authorize only signs here applied for. If other signs are to be erected they must be covered by additional permits

City of Chicago
Richard M. Daley, Mayor



Department of Buildings
Richard Monocchio, Commissioner

TYPE OF BUSINESS
COMMERCIAL , Other: _____
 Name: _____
 LIC #: _____
 Renewal Date: _____

SIGN BOND REQUIRED? YES
 COUNCIL ORDER REQUIRED YES
 IS SPECIAL PERMISSION REQUIRED FROM CHIEF ELECTRICAL
 YES

Projects Over:
 Private Property
 Public Way Grant Permit #: _____
 Planned Development/Manufacturing PMD/PD#: 523
 Zoning District: OTHER Other: PUD

IF YES, ATTACH LETTER OF REQUEST
 TIME STAMP

TYPE OF SIGN:
 ADVERTISING ILLUMINATE MOVEABLE
 BUSINESS FLASHING

TOTAL STREET FRONTAGE OF LOT (IN FEET) 1,400
 TOTAL AREA OF NEW SIGN (SQ.FT.) 96
 TOTAL AREA OF ALL SIGNS ON LOT (SQ.FT.) 514
 HEIGHT OF SIGN ABOVE GRADE (TO TOP) 43ft 1in
 DISTANCE OF CURB LINE OUTER EDGE (ft) 10
 DISTANCE OF STRUCTURE INNER EDGE (ft) 10

SIGN CLERK _____ APPROVED FOR PERMIT _____

DISTANCE FROM (ft):
 A. PUBLIC PARK (OVER 10 ACRES) _____
 B. EXPRESSWAY (IF LESS THAN 1,000 FT.) _____
 C. RESIDENCE DISTRICT (ADVERTISING SIGNS ONLY) _____

REMARKS

IF REPLACEMENT SIGN OR CHANGE OF FACE, WHAT DOES THE EXISTING SIGN READ?
 Original Payee: _____
 Landmark Hold: Status: _____

ZONING (OFFICE USE ONLY)