

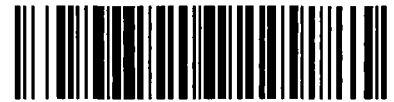

City of Chicago



Or2018-58

Office of the City Clerk

Document Tracking Sheet

Meeting Date:	2/28/2018
Sponsor(s):	Hopkins (2)
Type:	Order
Title:	Issuance of permits for sign(s)/signboard(s) at 1111 N Clark St
Committee(s) Assignment:	Committee on Zoning, Landmarks and Building Standards

CITY COUNCIL
COMMITTEE ON ZONING, LANDMARKS AND BUILDING STANDARDS

COUNCIL ORDER

RE: Approval of sign over 100 square feet in area or over 24 feet above grade

ORDERED, that the City Council hereby approves the following sign application submitted by:

Applicant*: Honda of Downtown Chicago

(* The Applicant is the owner of the real property or the business tenant of the real property. Do not list the sign contractor, sign erector, sign company or advertising entity in the above space.)

This Order approves the following sign in accordance with Municipal Code of Chicago Section 13-20-680:

Address of Sign: 1111 N Clark Street Chicago, IL 60610

Zoning District: C2-5

DOB Sign Permit Application #: 100748045

Sign Details:

1. On-premise X OR Off-premise _____

2. Static sign X OR Dynamic-image display sign _____

3. Number of sign faces 1

4. Projecting over the public way Yes (Yes or No) If yes, Public Way Use #: 1131900

5. Dimensions: Length 44 feet 4 inches Height 3 feet _____ inches

Total square feet in area: 133 feet _____ inches

6. Height above grade: 18 feet _____ inches

7. Elevation (side of building or lot where the sign will be erected): West

8. Name of Sign Contractor/Erector: Bright Light Sign Co.

To be legal, such sign shall comply with all provisions of Title 17 of the Chicago Municipal Code ("Zoning Ordinance") and all other provisions of the Municipal Code governing the permitting, construction and maintenance and removal of signs and sign structures. Failure of the applicant and the applicant's successors to comply shall be grounds for invalidation or revocation of the sign permit.

B. M. H.
Alderman

2
Ward

Gen III Building Signage

3'-0" 44'-4 3/4" Downtown Chicago

DNL-36 Dealer Name Letters

Supply & install (1) one set of fabricated aluminum channel letters
Returns prefinished satin anodized aluminum
Trimcap 1" brushed chrome (Jewelite)
Acrysteel #6701 blue faces
Illuminated with LED
Remote power supply

2'-6" 26'-2 25/32" Service Center

SCL-30 Service Center Letters

Supply & install (1) one set of fabricated aluminum channel letters
Returns prefinished satin anodized aluminum
Trimcap 1" brushed chrome (Jewelite)
Acrysteel #6701 blue faces
Illuminated with LED
Remote power supply



410 N. Cedar Bluff Rd, Suite 101, Knoxville, TN 37923
(Toll Free) 1 866 635 1110 (Fax) 1 899 694 1106
www.pattisonsign.com



The sign to be installed in accordance with the requirements of Article 600 of the
National Electrical Code (NEC) and the requirements of the local, provincial, state or federal laws.
The sign includes proper grounding and bonding of the sign.



Fluorescent, Neon and HID lamps contain Mercury (Hg).
Dispose of the lamps according to local, provincial, state or federal laws.

208747

Honda of Downtown Chicago
1111 N Clark Street
Chicago, IL

Sign Item
SG1

Project ID
AII-13501

Date: 06JAN2016
Scale: 1/8"=1'-0"
Sales: Alarsson
Designer: Eviolante

Rev. R: NS
Date: 13DEC17

Revision Note
R1 - Remove H-Logo
R4 - HLS is now only
REMOVE & REPLACE
R5 - Changed to
Downtown of Chicago

Information Required:
✓ Conceptual

Master
Electrical

☒ 120V ☐ 347V
☐ Other _____

Customer Approval

Signature _____
MM/DD/YYYY

It is the Customer's responsibility to ensure that the product of the sign is installed in accordance with the requirements of the local, provincial, state or federal laws being ordered. Please ask PSG to provide further details if required.

All rights reserved. The artwork and design of the sign are the exclusive property of Pattison Sign Group and as such cannot be reproduced in whole or in part without written permission by Pattison Sign Group.

Clark Street Elevation

Maple Street Elevation

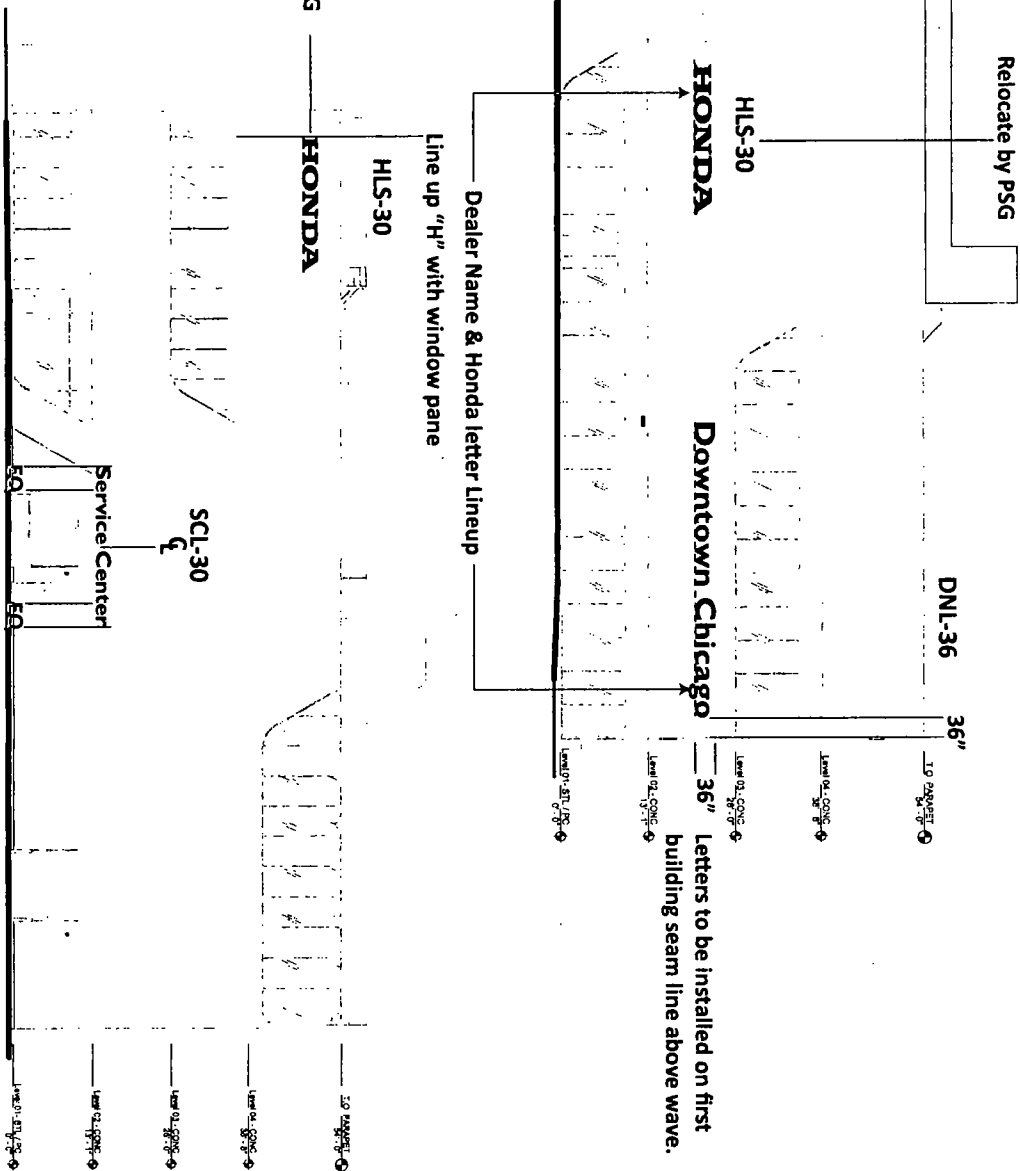

410 N. Cedar Bluff Rd. Suite 101 Knoxville TN 37933
(Toll Free) 1.866.635.1110 (Fax) 1.899.694.1106
www.pattisonsgn.com

THIS SIGN TO BE INSTALLED IN ACCORDANCE WITH THE REQUIREMENTS OF A LOCAL EDITION OF THE
NATIONAL ELECTRICAL CODE AND/OR OTHER APPLICABLE LOCAL CODES
THIS INCLUDES PROPER GROUNDING AND BONDING OF THE SIGN

REMARKS: NEW'S AND OLD UNIONS CONTAIN MERCURY (Pb)
DISPOSE OF THE SIGN ACCORDING TO LOCAL, NATIONAL, STATE OR FEDERAL LAWS

208747
Honda of Downtown Chicago
1111 N Clark Street
Chicago, IL
Sign Item
SGI

Project ID	AIJ-13501
Date	06JAN2016
Scale	N.T.S
Sales	A Jackson
Designer	E Violante
Rev. #	R5
Date	13DEC17
Revision Note	R1 - Remove H-Logo R4 - HLS is now only REMOVE & REPLACE R5 - Changed to Downtown of Chicago
Information Required	<input checked="" type="checkbox"/> Conceptual
Master	<input type="checkbox"/>
Electrical	<input checked="" type="checkbox"/> 120V <input type="checkbox"/> 347V <input type="checkbox"/> Other
Customer Approval	Signature _____ MM/DD/YYYY

It is the Customer's responsibility to ensure that the building is designed and constructed to accept the installation of the sign being ordered. Please ask PSG to provide further details if required.

All rights reserved. The artwork, captioned herein, is copyright of Pattison Sign Group and as such cannot be reproduced in whole or in part without written permission by Pattison Sign Group.

Site Plan

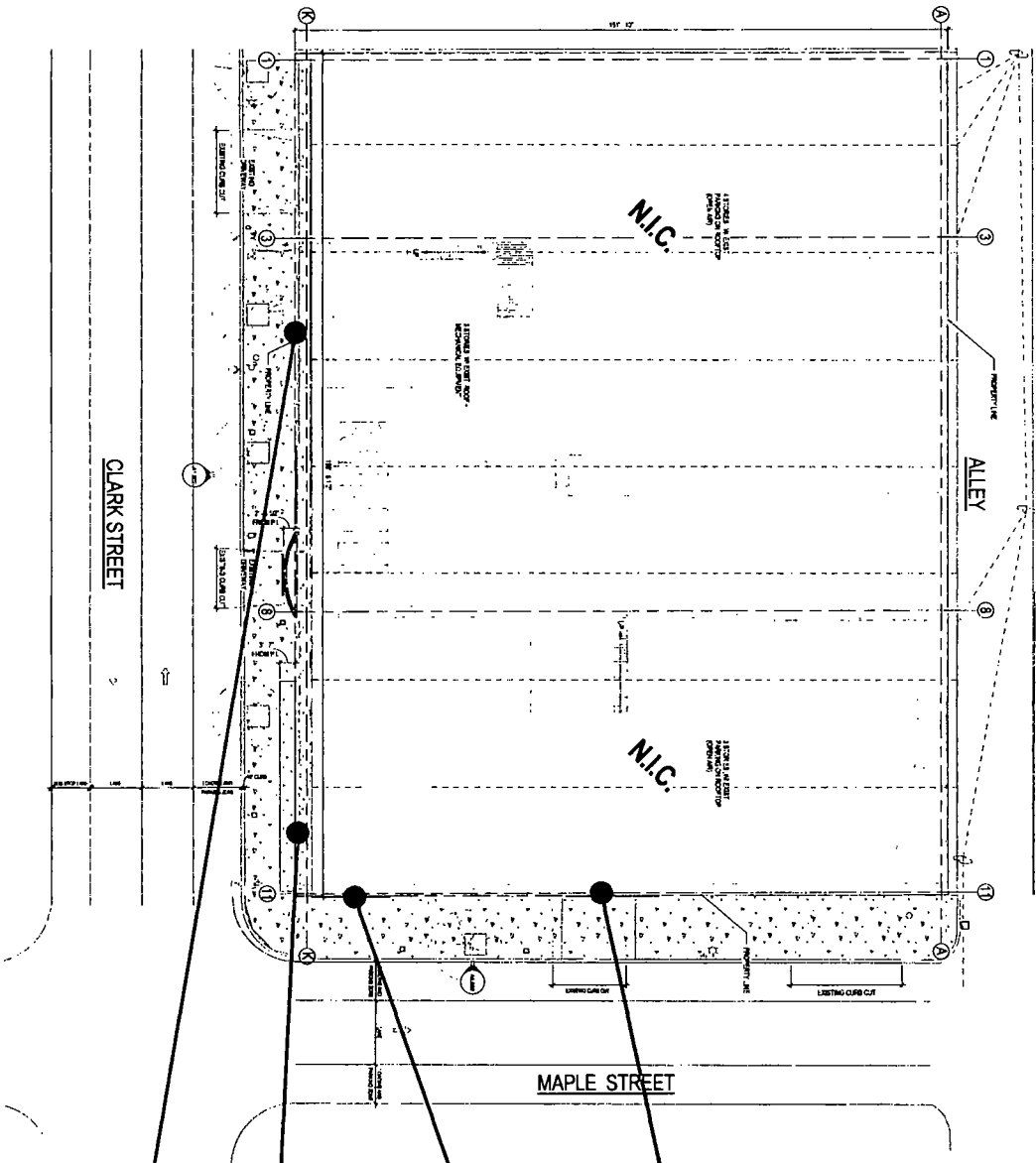

- SCL-30
Service Center
- Relocate by PSG
HLS-30
HONDA
- DNL-36
Downtown Chicago
- Relocate by PSG
HLS-30
HONDA



410 N. Cedar Bluff Rd. Suite 101 Knoxville TN 37923
(Toll Free) 1.866.635.1110 (Fax) 1.899.694.1106
www.pattisonsign.com

This sign to be installed in accordance with the requirements of Article 600 of the
National Electrical Code and/or other applicable local codes
This includes proper grounding and bonding of the sign.

Representative, Neos and HIO signs contain Mercury (Hg)
Disposal of the signs according to local, provincial, state or federal laws

208747

Honda of Downtown Chicago
1111 N Clark Street
Chicago, IL

Sign Item
SGI

It is the Customer's responsibility to ensure that the building is designed and constructed to accept the installation of the signs being ordered. Please call PSG to provide further details if required.

All rights reserved. The signs depicted herein are copyright of Pattison Sign Group and as such cannot be reproduced in whole or in part without written permission by Pattison Sign Group.

Customer Approval

Signature _____

DATE: 06/07/2016

Information Required

☒ Master

☒ 120V ☐ 347V

☐ Other _____

Revision Note

R1 - Remove H-Logo

R4 - HLS is now only REMOVE & REPLACE

R5 - Changed to Downtown of Chicago

Project ID
AII-13501

Date
06JAN2016

Scale
N.T.S

Sales
A Jackson

Designer
E Violante

Rev. #: R5

Date: 13DEC17

Clark Street Elevation



Project ID
AI1-13501

Date 14SEP17
Scale N.T.S.
Sales A. Jackson
Designer E. Violante
Rev. # 15
Date 13DEC17

Revision Note
R1 - Remove H Logo
R4 - HLS is now only
REMOVE & REPLACE
R5 - Changed to
Downtown of Chicago

Information Required:
☒ Conceptual

☐ Master
☒ 120V ☐ 347V
☐ Other _____
Electrical

Customer Approval
Signature _____
MM/DD/YYYY

It is the Customer's responsibility to ensure that the building is properly wired and grounded to accept the installation of the signs being ordered. Please call P&G to provide further details if required.
All rights reserved. The product design and layout is a property of Pattison Sign Group and as such cannot be reproduced in whole or in part without written permission by Pattison Sign Group.



410 N. Cedar Bluff Rd., Suite 101, Knoxville TN 37923
(Toll Free) 1.866.635.1110 (Fax) 1.899.694.1106
www.pattisonsign.com

 The sign is to be installed in accordance with the requirements of Article 600 of the National Electrical Code and/or other applicable local codes. This includes proper grounding and bonding of the sign.

 Signage, Mark and HUD items contain Mercury (Hg). Dispose of the signs according to local, provincial, state or federal laws.

208747
Hards of Downtown Chicago
1111 N Clark Street
Chicago, IL
Sign Item
SG1