



Office of the City Clerk



O2012-6771

Office of the City Clerk

City Council Document Tracking Sheet

Meeting Date:	10/3/2012
Sponsor(s):	Reilly, Brendan (42)
Type:	Ordinance
Title:	Awning(s) for Forty East Delaware Condo Assn.
Committee(s) Assignment:	Committee on Transportation and Public Way

ORDINANCE
FORTY EAST DELAWARE CONDOMINIUM ASSOCIATION
Acct. No. 375735 - 1
Permit No. 1103013

Be It Ordained by the City Council of the City of Chicago:

SECTION 1. Permission and authority are hereby given and granted to FORTY EAST DELAWARE CONDOMINIUM ASSOCIATION, upon the terms and subject to the conditions of this ordinance to maintain and use, as now constructed, one (1) Awning(s) projecting over the public right-of-way adjacent to its premises known as 40 E. Delaware Pl..

Said Awning(s) at measure(s):

One (1) at twenty-one (21) feet in length, and thirteen (13) feet in width for a total of two hundred seventy-three (273) square feet.

The location of said privilege shall be as shown on prints kept on file with the Department of Business Affairs and Consumer Protection and the Office of the City Clerk.

Said privilege shall be constructed in accordance with plans and specifications approved by the Zoning Department - Signs.

This grant of privilege in the public way shall be subject to the provisions of Section 10-28-015 and all other required provisions of the Municipal Code of Chicago.

The grantee shall pay to the City of Chicago as compensation for the privilege #1103013 herein granted the sum of fifty (\$50.00) per annum in advance.

A 25% penalty will be added for payments received after due date.

The permit holder agrees to hold the City of Chicago harmless for any damage, relocation or replacement costs associated with damage, relocation or removal of private property caused by the City performing work in the public way.

Authority herein given and granted for a period of five (5) years from and after Date of Passage.

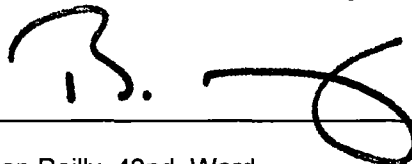
Alderman 
Brendan Reilly 42nd Ward

Certified Survey Co.

Phone 775-7755 5740 N. Elston Ave. Chicago, Illinois 60646 Fax 775-2855

Plat of Survey

LOTS 4 AND 5 IN NAPIER'S RESUBDIVISION OF LOTS 2, 3, 4, AND 5 IN THE SUPERIOR COURT PARTITION, BEING A SUBDIVISION OF THE EAST 2/3 OF BLOCK 15 IN CANAL TRUSTEES' SUBDIVISION OF THE SOUTH FRACTIONAL 1/4 OF SECTION 3, TOWNSHIP 36 NORTH, RANGE 14, EAST OF THE THIRD PRINCIPAL MERIDIAN, TOGETHER WITH LOT 1 IN SUPERIOR COURT PARTITION OF THE EAST 2/3 OF BLOCK 12 IN THE SUBDIVISION BY THE COMMISSIONERS OF ILLINOIS AND MICHIGAN CANAL OF THE SOUTH FRACTIONAL 1/4 OF SECTION 3, TOWNSHIP 36 NORTH, RANGE 14, EAST OF THE THIRD PRINCIPAL MERIDIAN, TAKEN AS A SINGLE TRACT OF LAND, EXCEPT THAT PART LYING ABOVE A HORIZONTAL PLANE HAVING A LOWER ELEVATION OF +14.81 FEET AND LYING BELOW A HORIZONTAL PLANE HAVING AN UPPER ELEVATION OF +34.61 FEET CHICAGO CITY DATUM DESCRIBED AS FOLLOWS:
 BEGINNING AT A POINT 2.45 FEET NORTH OF THE SOUTH LINE AND 2.51 FEET WEST OF THE EAST LINE OF SAID LOT 1; (THE FOLLOWING COURSES AND DISTANCES ARE ALONG THE INTERIOR FACE OF EXISTING WALLS) THENCE WEST 4.73 FEET; THENCE SOUTH 1.36 FEET; THENCE WEST 8.89 FEET; THENCE NORTH 1.40 FEET; THENCE WEST 2.84 FEET; THENCE NORTH 0.31 FEET; THENCE WEST 20.29 FEET; THENCE NORTH 7.44 FEET; THENCE EAST 1.20 FEET; THENCE NORTH 8.85 FEET; THENCE EAST 7.93 FEET; THENCE NORTH 18.74 FEET; THENCE WEST 6.83 FEET; THENCE NORTH 14.70 FEET; THENCE EAST 1.80 FEET; THENCE NORTH 15.48 FEET; THENCE WEST 20.24 FEET; THENCE SOUTH 0.23 FEET; THENCE WEST 6.04 FEET; THENCE NORTH 21.74 FEET; THENCE EAST 8.34 FEET; THENCE NORTH 2.45 FEET; THENCE EAST 4.45 FEET; THENCE SOUTH 1.32 FEET; THENCE EAST 4.62 FEET; THENCE NORTH 1.03 FEET; THENCE EAST 11.34 FEET; THENCE SOUTH 1.83 FEET; THENCE EAST 3.07 FEET; THENCE NORTH 11.83 FEET; THENCE EAST 18.07 FEET; THENCE SOUTH 1.53 FEET; THENCE EAST 2.85 FEET; THENCE SOUTH 1.73 FEET; THENCE EAST 15.24 FEET; THENCE SOUTH 0.33 FEET; THENCE EAST 1.40 FEET; THENCE SOUTH 11.59 FEET; THENCE WEST 1.40 FEET; THENCE SOUTH 7.90 FEET; THENCE EAST 1.40 FEET; THENCE SOUTH 11.57 FEET; THENCE WEST 1.40 FEET; THENCE SOUTH 7.94 FEET; THENCE EAST 1.30 FEET; THENCE SOUTH 11.42 FEET; THENCE WEST 1.39 FEET; THENCE SOUTH 7.94 FEET; THENCE EAST 1.40 FEET; THENCE SOUTH 8.89 FEET; THENCE WEST 1.40 FEET; THENCE SOUTH 4.89 FEET TO THE PLACE OF BEGINNING, ALL IN COOK COUNTY, ILLINOIS.

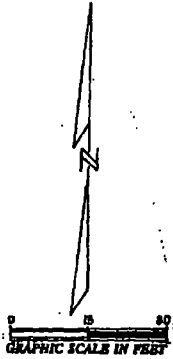

DOCUMENT WITH THIS PLAT

95905942

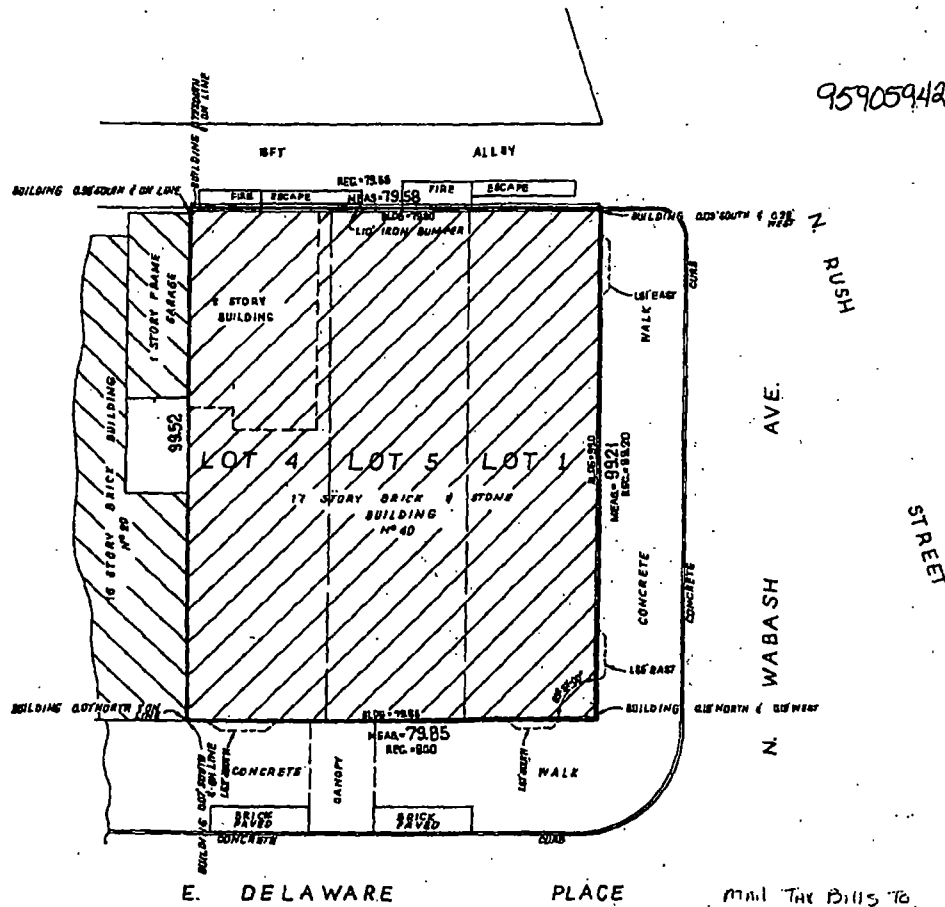

Prepared by: MR. DAVID BERTRIF
 ARNSTEIN & LEHR
 1806 Riverside Plaza
 Chicago, IL 60606
 MR. DAVID BERTRIF

Address: 40 EAST DELAWARE
 17-03-309-013
 17-03-209-014
 17-03-209-015

Grand Company
 645 N. Michigan
 Chicago, IL 60611
 MR. JOHN HARRIS

95905942

ORDER NO. 9539
 EXHIBIT A
 PAGE 1 OF 20

STATE OF ILLINOIS
 COUNTY OF COOK

I, DAVID A. KERRICH, A REGISTERED ILLINOIS LAND SURVEYOR DO HEREBY CERTIFY THAT I HAVE SURVEYED THE ABOVE DESCRIBED LAND, PROPERTY AND SPACE AND THAT IT CORRECTLY SHOWS THE RELATION OF THE BUILDING TO THE PROPERTY LINES OF THE LAND INDICATED HEREON, THAT THE WALLS OF SAID BUILDING ARE PLUMB AND THAT THERE ARE NO ENCROACHMENTS OF SAID ADJOINING BUILDINGS OR STRUCTURES ONTO SAID LAND NOR OVERLAP OF BUILDINGS OR STRUCTURES FROM SAID LAND, EXCEPT AS SHOWN. DIMENSIONS ARE SHOWN IN FEET AND DECIMAL PARTS THEREOF.
 DATED 2008 07 17 DAY OF JULY A.D. 1935

David A. Kerrich
 REGISTERED ILLINOIS LAND SURVEYOR 6177