



# City of Chicago



O2013-8310

Office of the City Clerk

## Document Tracking Sheet

<b>Meeting Date:</b>	10/16/2013
<b>Sponsor(s):</b>	Munoz (22)
<b>Type:</b>	Ordinance
<b>Title:</b>	Grant(s) of privilege in public way for PAWS Chicago
<b>Committee(s) Assignment:</b>	Committee on Transportation and Public Way

ORDINANCE  
PAWS CHICAGO  
Acct. No. 206852 - 1  
Permit No. 1108811

*Be It Ordained by the City Council of the City of Chicago:*

SECTION 1. Permission and authority are hereby given and granted to PAWS CHICAGO, upon the terms and subject to the conditions of this ordinance to maintain and use, as now constructed, six (6) Light Fixture(s) projecting over the public right-of-way adjacent to its premises known as 3516 W. 26th St..

Said Light Fixture(s) at W. 26th St measure(s):

Six (6) at one (1) foot in length, two (2) feet in width and sixteen point four (16.4) feet above grade level.

The location of said privilege shall be as shown on prints kept on file with the Department of Business Affairs and Consumer Protection and the Office of the City Clerk.

Said privilege shall be constructed in accordance with plans and specifications approved by the Department of Transportation (Division of Project Development).

This grant of privilege in the public way shall be subject to the provisions of Section 10-28-015 and all other required provisions of the Municipal Code of Chicago.

The grantee shall pay to the City of Chicago as compensation for the privilege #1108811 herein granted the sum of seventy-five (\$75.00) per annum in advance.

A 25% penalty will be added for payments received after due date.

The permit holder agrees to hold the City of Chicago harmless for any damage, relocation or replacement costs associated with damage, relocation or removal of private property caused by the City performing work in the public way.

Authority herein given and granted for a period of five (5) years from and after 06/11/2013.

Alderman  \_\_\_\_\_

Ricardo Munoz 22nd Ward

Pous Chicago  
3516 W. 26<sup>th</sup> Street

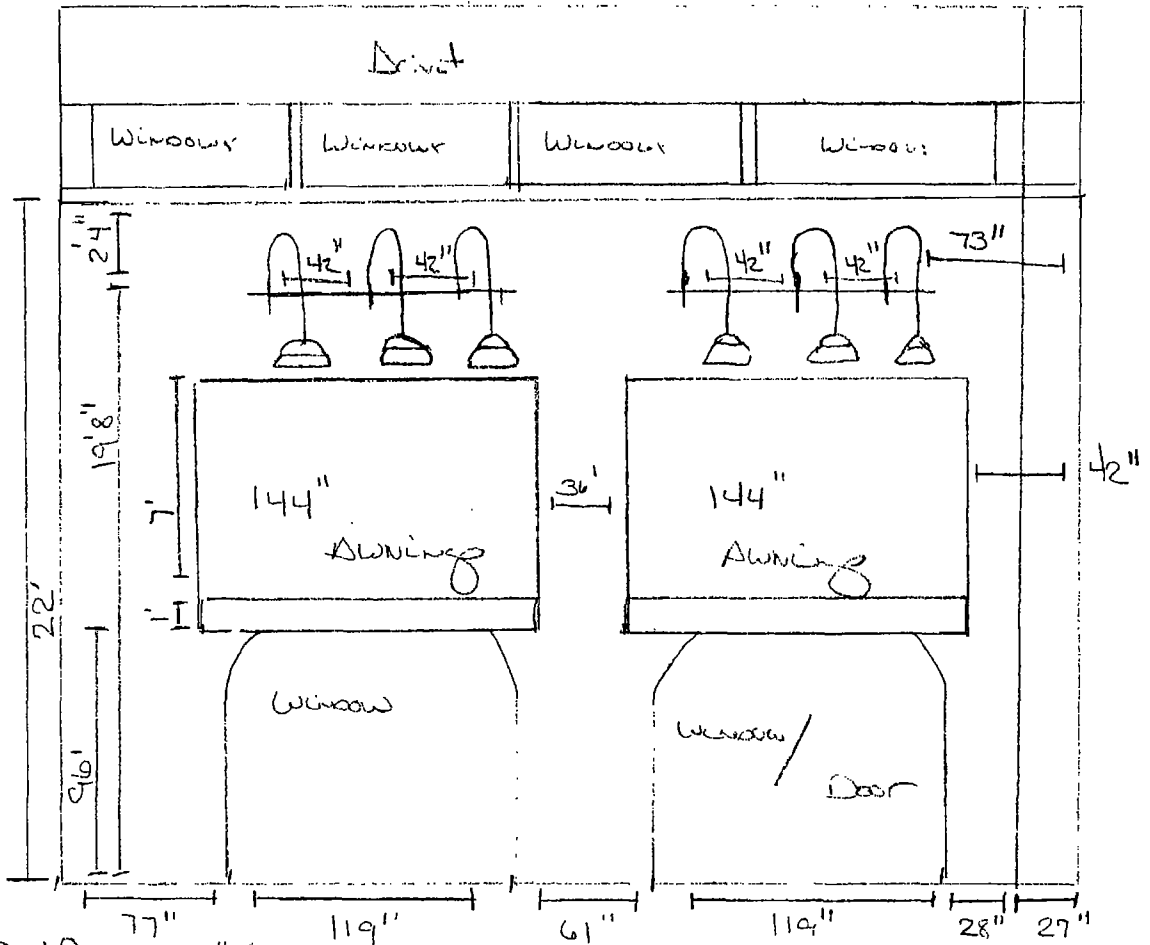

Drake Street  
 17' 9" from End of Building to Street  
 (Metro Station Building is at 3522 W 26<sup>th</sup> St)

26<sup>th</sup> Street  
 12' 8" from Building to 26<sup>th</sup> Str