



# Office of the City Clerk



Or2012-462

Office of the City Clerk

## City Council Document Tracking Sheet

---

<b>Meeting Date:</b>	9/12/2012
<b>Sponsor(s):</b>	Cappleman, James (46)
<b>Type:</b>	Order
<b>Title:</b>	Issuance of permits for sign(s)/signboard(s) at 3929 N Clarendon Ave
<b>Committee(s) Assignment:</b>	Committee on Zoning, Landmarks and Building Standards

City Council  
Meeting Date: \_\_\_\_\_  
Committee on Buildings

(signs)

ORDERED, That the Commissioner of Buildings is hereby directed to

issue a sign permit to: (Contractor's name and address)

LAMAR ADVERTISING  
1770 W. 41<sup>ST</sup> AVE  
GARY IN 46408

for the erection of a sign / signboard over 24 feet in height and / or over 100 square feet (in area of one face) at: (Business NAME & ADDRESS)

3929 N. <sup>CLARENDON</sup>~~BROADWAY~~  
SOUTH WALL

Dimensions: Length 9'-8" Height 9'-8"

Height above grade / roof to top of sign 28'-0"

TOTAL SQUARE FOOT AREA 947

Such sign(s) shall comply with all applicable provisions of TITLE 17 of the Chicago Zoning Ordinance and all other applicable provisions of the Municipal Code of the City of Chicago governing the construction and maintenance of outdoor signs, signboards and structures.

*James Cappelman*  
Alderman, 4<sup>th</sup> Ward



CITY OF CHICAGO

# DEPARTMENT OF BUILDINGS

## Sign Permit Application

APPROVAL NUMBER	APPLICATION NUMBER 100441038	ANNUAL FEE	WORK CODE	DRAWINGS ATTACHED <input type="checkbox"/> YES <input type="checkbox"/> NO
DATE OF APPLICATION 05/16/2012		TYPE OF SIGN FLAT OR BOX		
ADDRESS OF SIGN 3929 N CLARENDON AVE, 60613-		LENGTH	FT. 9	IN. 8
BUILDING	ORIGINAL PERMIT NUMBER	HEIGHT	FT. 9	IN. 8
TYPE OF PERMIT NEW CONSTRUCTION (SIGN)		AREA	SQ. FT. 93	WEIGHT LBS. 750
PAYER OF ANNUAL INSPECTION TERPSTRA, JON 1770 W. 41ST AVE GARY, IN 46408 (219)980-1147		SIGN HEIGHT ABOVE GRADE/ROOF		FF. 28
SIGN MANUFACTURER YESCO		SHAPE OF SIGN REGULAR		
ADDRESS WHERE SIGN CAN BE SEEN PRIOR TO ERECTION		SIGN WILL READ VARIOUS ADVERTISERS		
TICKET NUMBER 0	REINSPECTION CONTROL NUMBER	NO. OF LAMPS 1	TOTAL WATTAGE 2700	
TYPE OF SUPPORT FOR SIGN BUILDING		TYPE OF LAMP OTHER		
SIGN BOARD SUPPORT MEMBERS STEEL		NO. OF BALLAST/TRANSFORMERS 1	INPUT OF TRANSFORMERS 110	
ANNUAL FEE		CONTRACTOR WILL INSTALL <input checked="" type="checkbox"/> FEEDERS <input checked="" type="checkbox"/> CUSTOMER LEADS		
CONSTRUCTION FEE 600.00		TYPE OF SWITCH KNIFE		
1017 B FEE		LOCATION OF SWITCH OUTSIDE SIGN		
TOTAL FEE 600.00		SIGN LOCATION REPALCE EXISTING STATIC 10 X 10 ADVERTISING SIGN WITH LED CHANGING IMAGE SIGN		
AMOUNT PAID 500.00				
BALANCE DUE \$ 100.00				

The undersigned certify that the statements in this application are true and correct and that all work done under the proposed permit will conform to the requirements of the Chicago Municipal Code

REG. NO.	E74732
ELECT CONTR DUNNING ELECTRICAL SERVICES IN	ELECTR
ADDRESS 6809 W. IRVING PARK RD. CHICAGO, IL 60634	
SUPERVISOR SIGNATURE	

BOND NO.	REG. NO.	N90950
SIGN ERECTOR LAMAR WHITECO OUTDOOR	SIGNER	
ADDRESS 1770 W. 41ST AVE. GARY IN, 46408-		
SIGNATURE		

The permit issued on this application will authorize only signs here applied for. If other signs are to be erected they must be covered by additional permits

City of Chicago  
Rahm Emanuel, Mayor



Department of Buildings  
Michael Merchant, Commissioner

TYPE OF BUSINESS <u>COMMERCIAL</u> Other: _____ Name: _____ LIC #: _____ Renewal Date: _____	SIGN BOND REQUIRED? <input type="checkbox"/> YES COUNCIL ORDER REQUIRED <input type="checkbox"/> YES IS SPECIAL PERMISSION REQUIRED FROM CHIEF ELECTRICAL <input type="checkbox"/> YES IF YES, ATTACH LETTER OF REQUEST
Projects Over: <input checked="" type="checkbox"/> Private Property <input checked="" type="checkbox"/> Public Way Grant Permit #: _____ <input type="checkbox"/> Planned Development/Manufacturing PMD/PD#: _____ Zoning District: <u>B3</u> Other: _____	TIME STAMP
TYPE OF SIGN: <input checked="" type="checkbox"/> ADVERTISING <input checked="" type="checkbox"/> ILLUMINATE <input type="checkbox"/> MOVEABLE <input type="checkbox"/> BUSINESS <input type="checkbox"/> FLASHING	
TOTAL STREET FRONTAGE OF LOT (IN FEET) _____ 260 TOTAL AREA OF NEW SIGN (SQ.FT.) _____ 93 TOTAL AREA OF ALL SIGNS ON LOT (SQ.FT.) _____ 212 HEIGHT OF SIGN ABOVE GRADE (TO TOP) _____ 37ft 8in	
DISTANCE OF CURB LINE OUTER EDGE (ft) _____ 15 DISTANCE OF STRUCTURE INNER EDGE (ft) _____ 14	SIGN CLERK _____ APPROVED FOR PERMIT _____
DISTANCE FROM (ft): A. PUBLIC PARK (OVER 10 ACRES) _____ 333 B. EXPRESSWAY (IF LESS THAN 1,000 FT.) _____ C. RESIDENCE DISTRICT (ADVERTISING SIGNS ONLY) _____ 200	REMARKS
IF REPLACEMENT SIGN OR CHANGE OF FACE, WHAT DOES THE EXISTING SIGN READ?  Original Payee: _____	
Landmark Hold: <input type="checkbox"/> Status: _____	
ZONING (OFFICE USE ONLY)	

CITY OF CHICAGO  
 DEPARTMENT OF ZONING AND LAND USE PLANNING  
 SIGN SITE PLAN  
 (ALL INFORMATION MUST BE COMPLETED AND LEGIBLE)

Site Address: 3929 N. CLARENDON of      applications

Sign Company: LAMAR ADVERTISING Rep Name: TOM WICHLINSKI

Phone (773) 242-1054 EXT 321 (Below: Building, streets and location of sign on lot or structure)  
 North

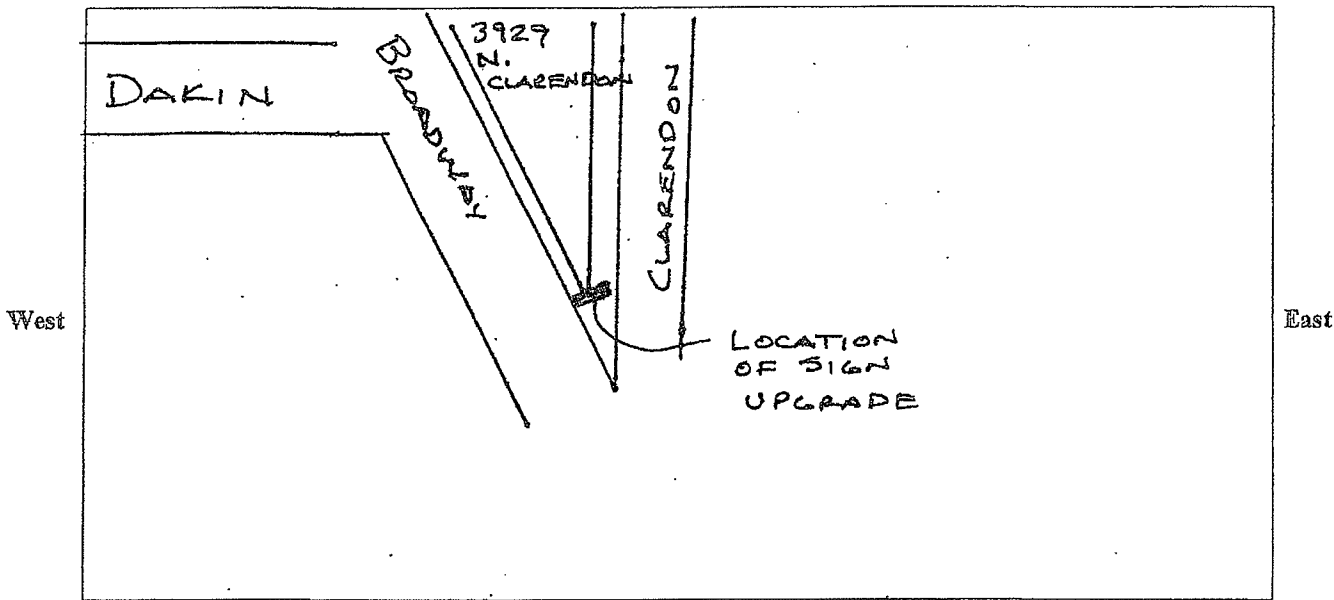

South

**SIGN USE:**

Bus. ID (On-premise)

*Business Lice. #*

Advertising (Off-premise)

**PERMIT TYPE:**

New Construction

Change of Face

Previous Permit #

**TYPE OF SIGN:**

Flat Wall

Freestanding

Awning

Marquee

High Rise Building

Projecting Private

Projecting Public Way

Public Way Use -Permit #

1094472

**SIGN CHARACTERISTICS:**

Non- Illuminated

Illuminated

Changing Image

Video Display

Flashing

**DISTANCE FROM:**

Curb Line: 15

Expressway, Toll Roads or Major Route

(n/a if over 1000 ft) N/A

Park (over 10 acres) N/A

Residential Zone 200 +

Existing Off-premise on same side of street: 300 +

**TOTAL SQUARE FOOTAGE:**

Square footage of this proposed sign 94 #

Gross area of all proposed signs 94 #

Area of all existing signs

(not including proposed) on Zoning Lot 118

Signature: A E Wall

(Revised 4/10)

Date: 7-10-12

REVISED W/

CORRECTED ADDRESS:

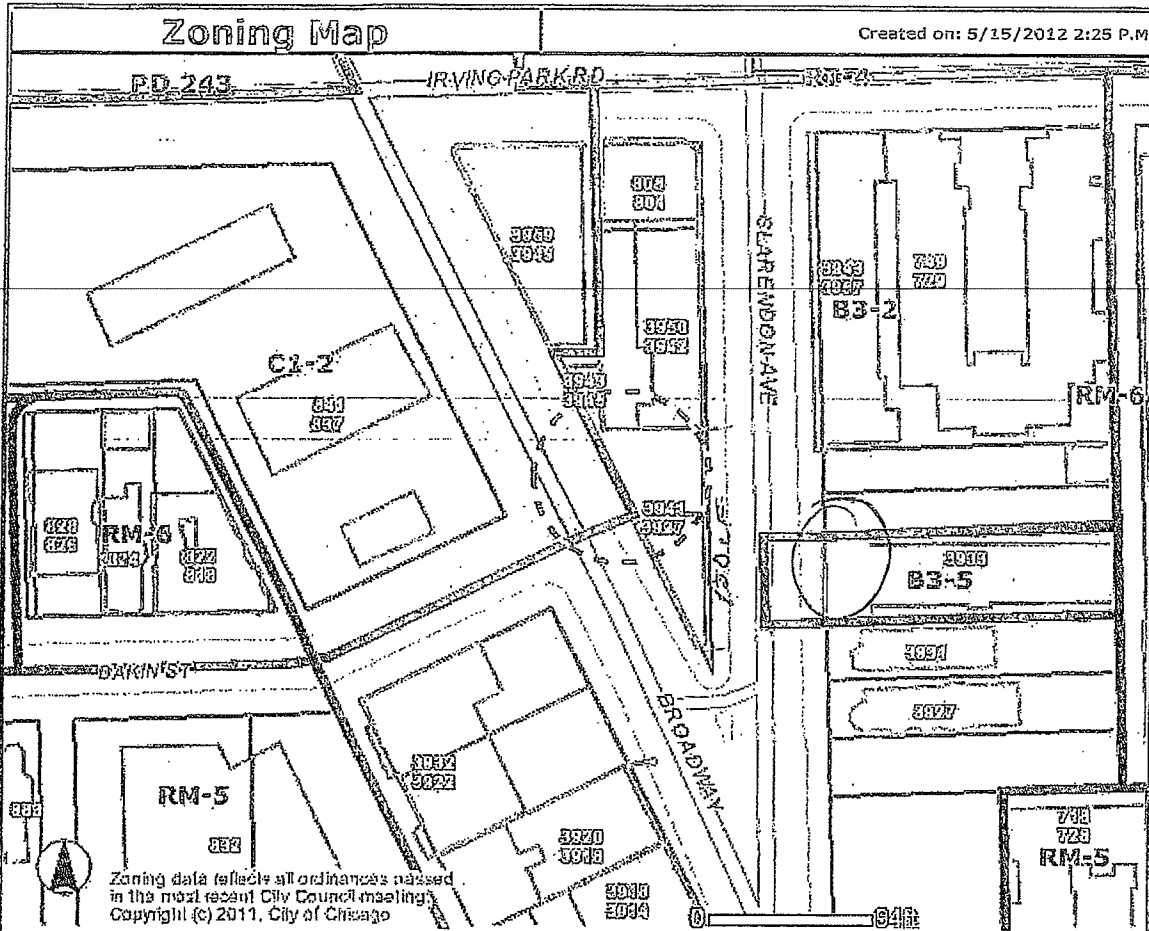

Address	Measure Tool Total
3936 N CLARENDON AVE	14.73 Feet

**Zoning**

- Business
- Commercial
- Manufacturing
- Residential
- Planned Development
- Planned Manufacturing
- Downtown Core
- Downtown Service
- Downtown Mixed
- Downtown Residential
- Transportation
- Parks & Open Space
- Zoning Boundaries

**Historic Preservation**

CHICAGO LANDMARKS

- Chicago Landmarks
- Landmark Districts

Chicago Historic Resources Survey - Buildings subject to Demolition-Delay Ordinance

- Red
- Orange
- Water
- Cemetery

Municipalities

- Lakefront
- Pedestrian Streets
- Buildings
- Parcels
- Streets
- Curbs
- Forest Preserve
- City Boundary

Information provided on the City of Chicago web site should not be used as a substitute for legal, accounting, real estate, business, tax, or other professional advice. The City of Chicago assumes no liability for any damages or loss of any kind that might arise from the use of, misuse of, or the inability to use the City web site and/or the materials contained on the web site. The City of Chicago also assumes no liability for improper or incorrect use of materials or information contained on its web site. All materials that appear on the City of Chicago web site are distributed and transmitted as is, without warranties of any kind, either express or implied, and subject to the terms and conditions stated in this disclaimer.