



City of Chicago



O2015-4476

Office of the City Clerk

Document Tracking Sheet

Meeting Date:	5/20/2015
Sponsor(s):	Reilly (42)
Type:	Ordinance
Title:	Grant(s) of privilege in public way for LaSalle Partners Management Ltd.
Committee(s) Assignment:	Committee on Transportation and Public Way

ORDINANCE
LASALLE PARTNERS MGMT., LTD.
Acct. No. 82047 - 1
Permit No. 1118913

Be It Ordained by the City Council of the City of Chicago:

SECTION 1. Permission and authority are hereby given and granted to LASALLE PARTNERS MGMT., LTD., upon the terms and subject to the conditions of this ordinance to maintain and use, as now constructed, one (1) Bay Window(s) projecting over the public right-of-way adjacent to its premises known as 633 N. St Clair St..

Said Bay Window(s) at N. ST CLAIR STREET measure(s):

One (1) at ten (10) feet in length, and twelve (12) feet in width for a total of one hundred twenty (120) square feet.

The location of said privilege shall be as shown on prints kept on file with the Department of Business Affairs and Consumer Protection and the Office of the City Clerk.

Said privilege shall be constructed in accordance with plans and specifications approved by the Department of Transportation (Division of Project Development).

This grant of privilege in the public way shall be subject to the provisions of Section 10-28-015 and all other required provisions of the Municipal Code of Chicago.

The grantee shall pay to the City of Chicago as compensation for the privilege #1118913 herein granted the sum of seventy-five (\$75.00) per annum in advance.

A 25% penalty will be added for payments received after due date.

The permit holder agrees to hold the City of Chicago harmless for any damage, relocation or replacement costs associated with damage, relocation or removal of private property caused by the City performing work in the public way.

Authority herein given and granted for a period of five (5) years from and after 05/16/2015.

Alderman _____

Brendan Reilly 42nd Ward

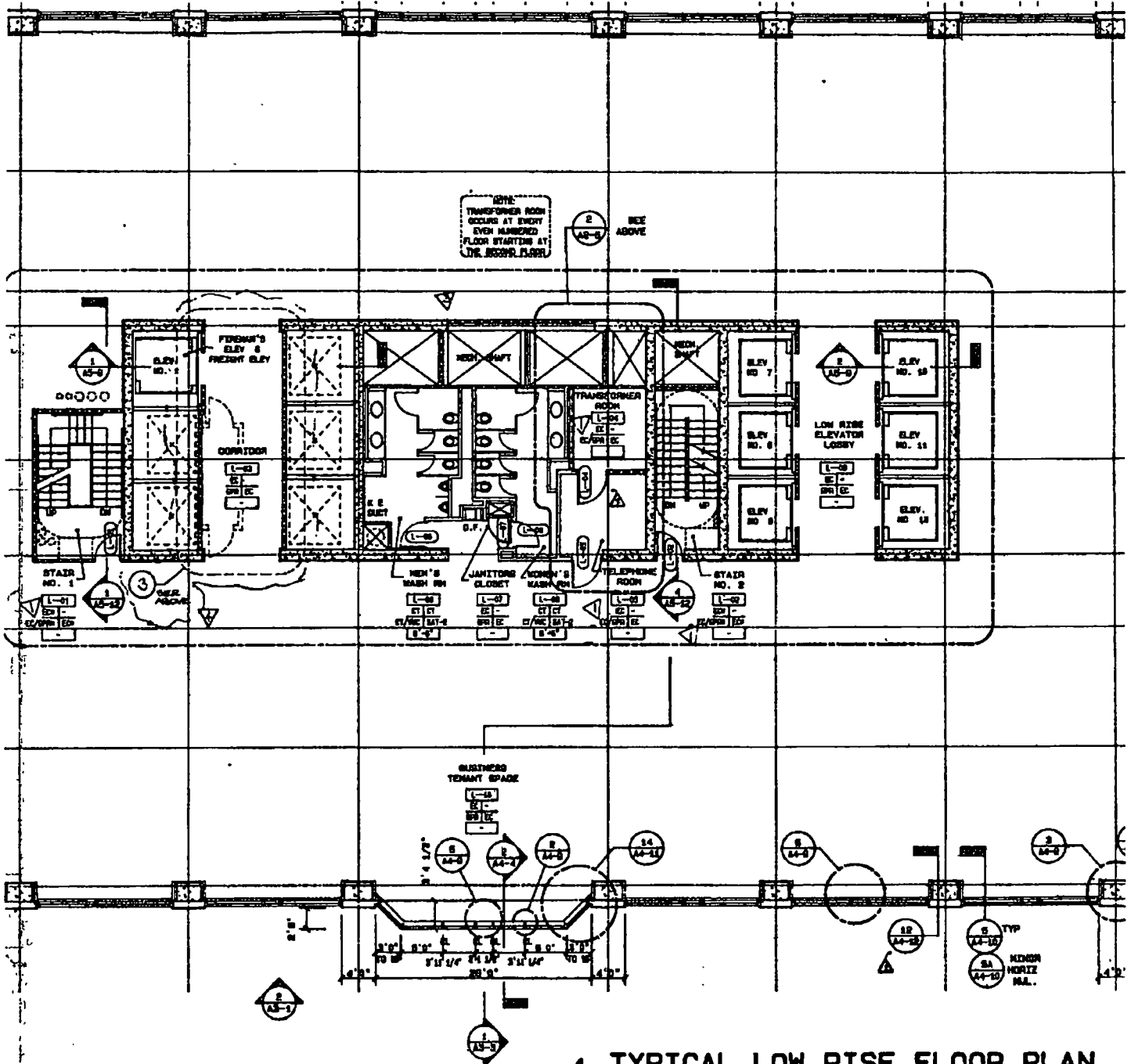

1 TYPICAL LOW RISE FLOOR PLAN

SCALE: 1/8" = 1'-0"

VIEW 1

LEGEND

BASE	EXPOSED CONSTRUCTION
CE	CERAMIC TILE BASE
CS	RESILIENT STRAIGHT BASE
CC	RESILIENT COVERED BASE
CB	BRICK TILE BASE
CF	MEN'S WASH ROOM FLOORING TURNED UP ON CURB
CG	CONCRETE HANDICAP PAINTED
CEILING	
EC	EXPOSED CONSTRUCTION
EP	EXPOSED CONSTRUCTION FINISHED ONLY
EA	CENGLAID SPLINE ACOUSTICAL TILE CEILING
EB	RECESSED LAY-IN ACOUSTICAL PANELS
ED	SUSPENDED GYPSON BOARD CEILING PAINTED
EE	SUSPENDED GYPSON BOARD EPoxy PAINTED
EF	CONCRETE PLASTER
EL	LATH AND PLASTER
EM	FURNISH PAINT METAL STAIR TREADS, RISERS & HANDRAILS (SEE - NOT IN CONTRACT)

RATED WALL CONSTRUCTION KEY

---	1/2 HR RATED CONSTRUCTION
----	1 HR RATED CONSTRUCTION
-----	2 HR RATED CONSTRUCTION

GENERAL NOTES

11/24/85

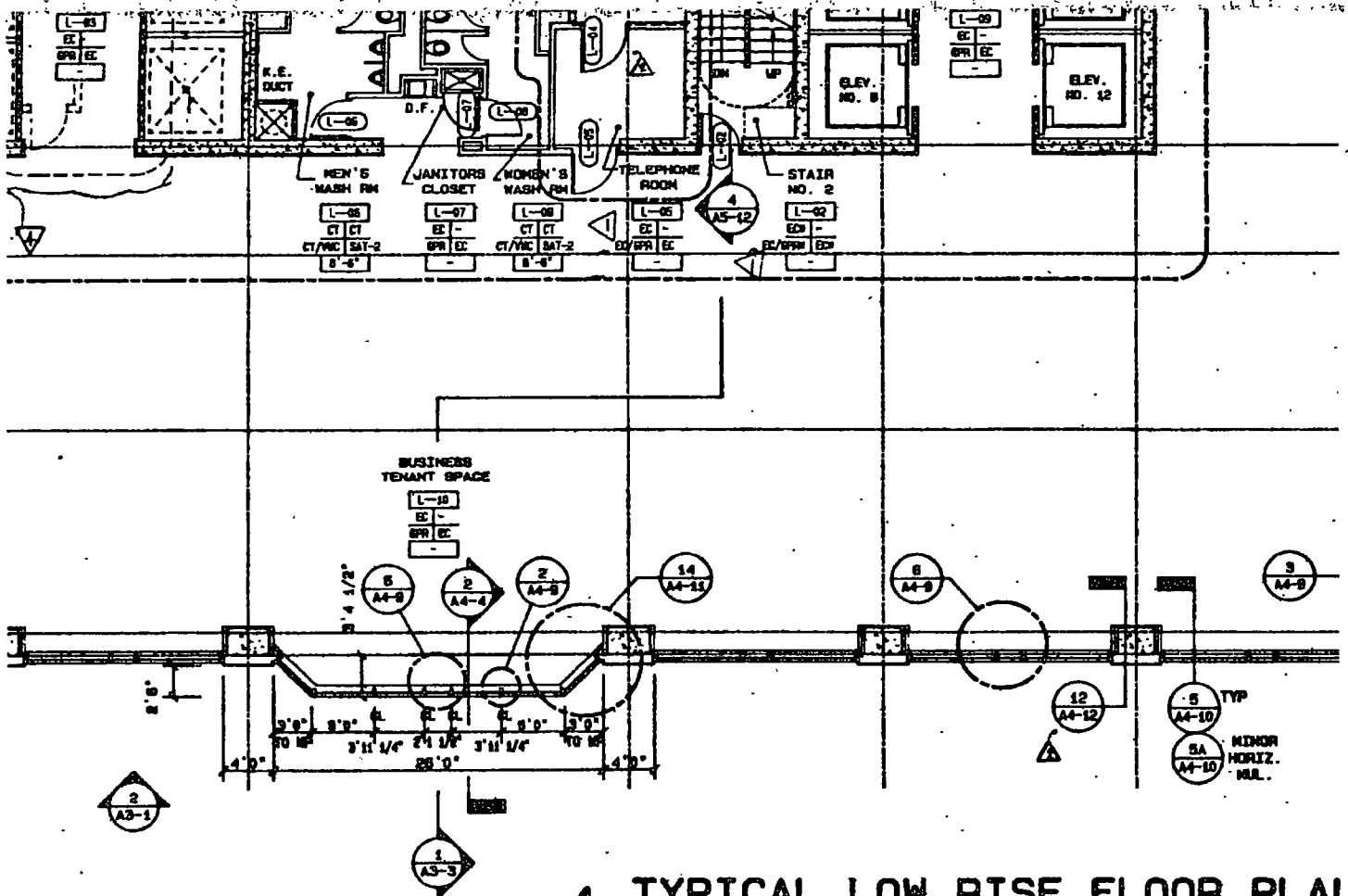

1 TYPICAL LOW RISE FLOOR PLAN

SCALE: 1/8" = 1'-0"
Close up view.