



City of Chicago



Or2010-1079

Office of the City Clerk

Document Tracking Sheet

Meeting Date:	10/6/2010
Sponsor(s):	Allen (38)
Type:	Order
Title:	Issuance of permits for sign(s)/signboard(s) at 3632 N Cicero Ave - 150 sq. ft.
Committee(s) Assignment:	Committee on Buildings

City Council

Meeting Date: 10/6/10

Committee on Buildings

(signs)

ORDERED, That the Commissioner of Buildings is hereby directed to
issue a sign permit to: (Contractor's name and address)

AD DELUXE SIGN COMPANY, INC.

5540 W. Harrison St.

Chicago, IL 60644

for the erection of a sign / signboard over 24 feet in height and / or over 100
square feet (in area of one face) at: (Business NAME & ADDRESS)

carrosenpagos.com

3632 North Cicero Avenue

Chicago, IL 60641

Dimensions: Length 5'-0" Height 30'-0"

Height above grade / roof to top of sign 15'-0"

TOTAL SQUARE FOOT AREA 150 sq. ft.

Such sign(s) shall comply with all applicable provisions of TITLE 17 of the
Chicago Zoning Ordinance and all other applicable provisions of the Municipal
Code of the City of Chicago governing the construction and maintenance of
outdoor signs, signboards and structures.

Thomas R. Allen

Alderman, 38th Ward



Document No. PO2010-989

REFERRED TO COMMITTEE ON BUILDINGS
OCT - 6 2010
<i>Jeffrey A. Delle</i> City of Chicago



CITY OF CHICAGO

DEPARTMENT OF BUILDINGS

Sign Permit Application

APPROVAL NUMBER 19032	APPLICATION NUMBER 100345640	ANNUAL FEE	WORK CODE	DRAWINGS ATTACHED <input type="checkbox"/> YES <input type="checkbox"/> NO			
DATE OF APPLICATION 05/24/2010		TYPE OF SIGN FLAT OR BOX					
ADDRESS OF SIGN 3632 N CICERO AVE, 60641-		LENGTH	FT. 30	IN 0	HEIGHT	FT. 5	IN 0
BUILDING	ORIGINAL PERMIT NUMBER	AREA	SQ. FT. 150	WEIGHT		LBS 300	
TYPE OF PERMIT NEW CONSTRUCTION (SIGN)		SIGN HEIGHT ABOVE GRADE/ROOF					FT. 10
PAYER OF ANNUAL INSPECTION FEE HORWITZ, AVE 3632 N CICERO AVE CHICAGO, IL 60641 (773)931-8000		SHAPE OF SIGN REGULAR					
SIGN MANUFACTURER AD DELUXE SIGN CO		SIGN WILL READ CARROSENPAOS.COM					
ADDRESS WHERE SIGN CAN BE SEEN PRIOR TO ERECTION		NO. OF LAMPS 3		TOTAL WATTAGE 1200			
TICKET NUMBER 0		REINSPECTION CONTROL NUMBER		TYPE OF LAMP HIGH DENSITY DISCHARGE			
TYPE OF SUPPORT FOR SIGN BUILDING		NO. OF BALLAST/TRANSFORMERS 3		INPUT OF TRANSFORMERS 110			
SIGN BOARD SUPPORT MEMBERS STEEL		CONTRACTOR WILL INSTALL		<input checked="" type="checkbox"/> FEEDERS <input checked="" type="checkbox"/> CUSTOMER LEADS			
ANNUAL FEE		TYPE OF SWITCH KNIFE					
CONSTRUCTION FEE 200.00		LOCATION OF SWITCH OUTSIDE SIGN					
1017 B FEE		SIGN LOCATION FURNISH AND INSTALL 5' X 30' SINGLE FACE BANNER ON CICERO AVE. ILLUMINATED WITH 400 WATT HALIDE PARKING LOT FIXTURES					
TOTAL FEE 200.00							
AMOUNT PAID 200.00							
BALANCE DUE							

The undersigned certify that the statements in this application are true and correct and that all work done under the proposed permit will conform to the requirements of the Chicago Municipal Code

REG NO	E68756
ELECT CONTR FULLER-BURRELL ELECTRIC CONTRA	ELECTR
ADDRESS 1424 N. LUNA AVE. CHICAGO, IL 60651-	
SUPERVISOR SIGNATURE 	

BOND NO	REG. NO	N92559
SIGN ERECTOR AD DELUXE SIGN CO INC.	SIGNER 	
ADDRESS 5540 WEST HARRISON CHICAGO IL, 60644		
SIGNATURE 		

The permit issued on this application will authorize only signs here applied for. If other signs are to be erected they must be covered by additional permits.

City of Chicago
Richard M. Daley, MayorDepartment of Buildings
Richard Monocchio, Commissioner

TYPE OF BUSINESS <u>COMMERCIAL</u> Other: <u>CAR DEALER</u> Name: <u>LEONS AUTO SALES</u> LIC #: <u>72166</u> Renewal Date: _____	SIGN BOND REQUIRED? <input type="checkbox"/> YES COUNCIL ORDER REQUIRED <input checked="" type="checkbox"/> YES IS SPECIAL PERMISSION REQUIRED FROM CHIEF ELECTRICAL INSPECTOR? <input checked="" type="checkbox"/> YES IF YES, ATTACH LETTER OF REQUEST TIME STAMP
Projects Over: <input type="checkbox"/> Private Property <input checked="" type="checkbox"/> Public Way Grant Permit #: <u>1091864</u> <input type="checkbox"/> Planned Development/Manufacturing PMD/PD#: _____ Zoning District: <u>C1</u> Other: <u>C1-1</u>	REMARKS
TYPE OF SIGN: <input type="checkbox"/> ADVERTISING <input checked="" type="checkbox"/> ILLUMINATED <input type="checkbox"/> MOVEABLE <input checked="" type="checkbox"/> BUSINESS <input type="checkbox"/> FLASHING	
TOTAL STREET FRONTAGE OF LOT (IN FEET) <u>350</u> TOTAL AREA OF NEW SIGN (SQ.FT.) <u>150</u> TOTAL AREA OF ALL SIGNS ON LOT (SQ.FT.) <u>414</u> HEIGHT OF SIGN ABOVE GRADE (TO TOP) <u>15ft 0in</u>	
DISTANCE OF CURB LINE OUTER EDGE (ft) <u>11</u> DISTANCE OF STRUCTURE INNER EDGE (ft) <u>12</u>	
DISTANCE FROM (ft): A. PUBLIC PARK (OVER 10 ACRES) <u>1,000</u> B. EXPRESSWAY (IF LESS THAN 1,000 FT.) <u>1,000</u> C. RESIDENCE DISTRICT (ADVERTISING SIGNS ONLY) <u>150</u>	
IF REPLACEMENT SIGN OR CHANGE OF FACE, WHAT DOES THE EXISTING SIGN READ? _____ Original Payee: _____ _____ Landmark Hold: <input type="checkbox"/> Status: _____	
ZONING (OFFICE USE ONLY) <div style="text-align: center;"> <p>CONFORMS TO ZONING ORDINANCE This Approval of Application for signs shall not be held to permit or be an approval of any violation of the provisions.</p> <p>AUG 03 2010</p> <p>of the Chicago Zoning Ordinance, or any other requirements of the Municipality Code of the City of Chicago ZONING ADMINISTRATOR</p> </div>	

App# 100345640

CITY OF CHICAGO
DEPARTMENT OF ZONING AND LAND USE PLANNING
SIGN SITE PLAN
 (ALL INFORMATION MUST BE COMPLETED AND LEGIBLE)

 Site Address: 3632-36 N. CICERO AVE 1 of 3 applications

 Sign Company: AD DELUXE SIGN CO Rep Name: John Miller

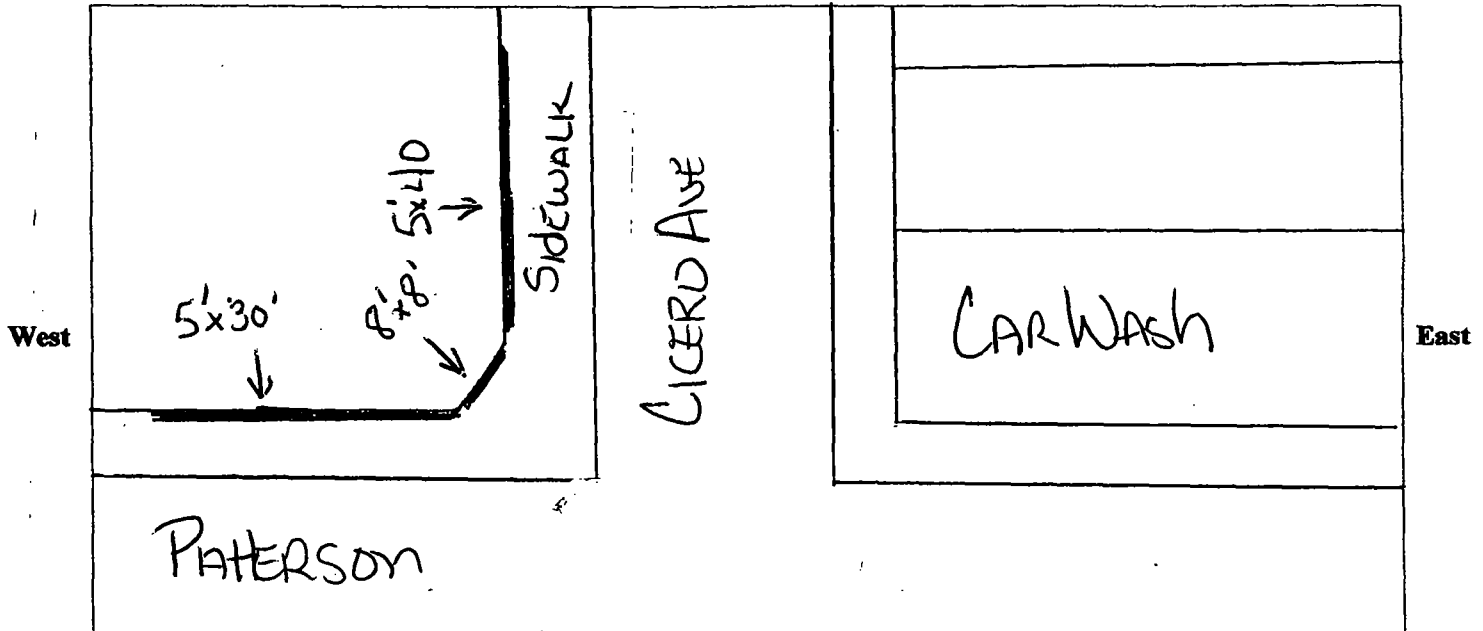
 Phone (773) 378 4548 EXT (Below: Building, streets and location of sign on lot or structure)
 North

South

SIGN USE:Bus. ID (On-premise) ☒*Business Lice. #*781606Advertising (Off-premise) ☐**PERMIT TYPE:**New Construction ☒

Change of Face

Previous Permit # ☐**TYPE OF SIGN:**Flat Wall ☒Freestanding ☐Awning ☐Marquee ☐High Rise Building ☐Projecting Private ☐Projecting Public Way ☒*Public Way Use -Permit #*1091864**SIGN CHARACTERISTICS:**Non- Illuminated ☐Illuminated ☒Changing Image ☐Video Display ☐Flashing ☐**DISTANCE FROM:**Curb Line: 12

Expressway, Toll Roads

or Major Route 1000(n/a if over 1000 ft) 1000Park (over 10 acres) 1000Residential Zone 150Existing Off-premise on
same side of street: **TOTAL SQUARE FOOTAGE:**Square footage of this proposed sign 150Gross area of all proposed signs 414

Area of all existing signs

(not including proposed) on Zoning Lot C-1
 Signature: Allen [Signature]

 Date: May 21, 2010



carrosenpagos.com

Ad Deluxe Sign Co.
5540 West Harrison
Chicago, IL 60644
ADDELUXESIGN@comcast.net
phone : 773-378-4548
fax: 773-378-4552

CICERO ELEVATION

THE AUTO WAREHOUSE
36³⁷~~23~~ NORTH CICERO AVE
CHICAGO, IL 60639

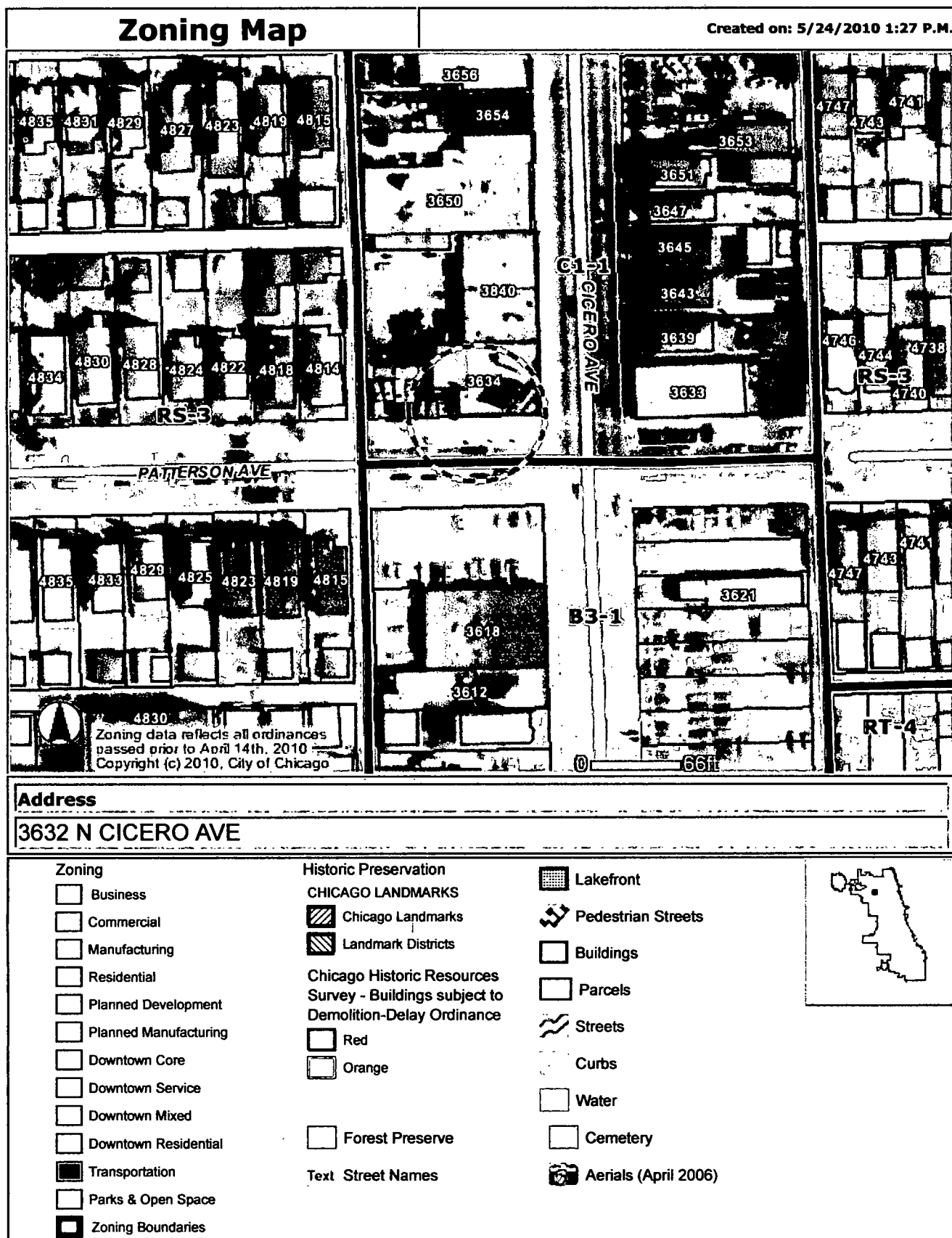

ZONE Classification		Ordinance Number				Ordinance Date				
C1-1										
TIF										
Belmont/Cicero										
Building Id	From Add	To Add	Dir	Street	Type	Stories	Units Built	Sq.Ft.	Condition	Vacancy
847820	3634	3634	N	CICERO AVE	1		1925		SOUND	
Map Index				Page Number						
9-L				52B						
PIN				From Address		To Address		Dir Street Type Suffix		
Cook County Assessor Cook County Recorder of Deeds CNT 13212270320000				3634		3634		N CICERO AVE		
Ward	Alderman		Phone		Address					
38	THOMAS R. ALLEN		773-545-3838		5817 W IRVING PARK RD					

[Close Window](#)



City of Chicago

Buildings

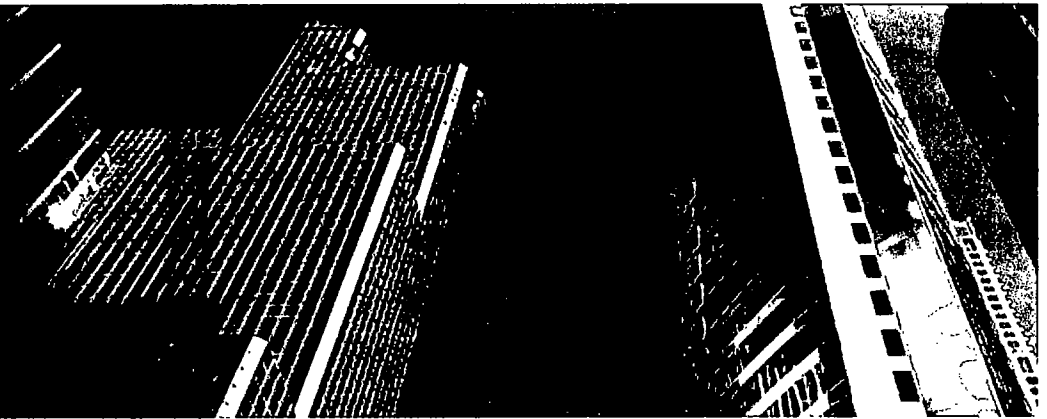
Online Permits &
Trade License Renewals

Plumbing Services

Online Permits

Application Forms

Permitting Information

Contact Us

1. Type

2. Location Info

3. Description

4. Details

5. Contractors

6.

Payment Confirmation

Thank you for using the City of Chicago Online Permitting.
Please keep this information as verification of payment.

App #	Date	Type	Description	Fee
+ 100345640	5/24/2010	Sign	3632 N CICERO AVE 60641-	\$200.00
+ 100345656	5/24/2010	Sign	3632 N CICERO AVE 60641-	\$200.00
+ 100345662	5/24/2010	Sign	3632 N CICERO AVE 60641-	\$200.00

Total:

PAYMENTCONFIRMATION

Payment Transaction #: 50289

Your Credit Card has been charged \$600.00

Authorization # 024845

Reference # 2699351

If you are having trouble with the website, please contact the City of Chicago by calling 311 to report a technician will respond within one business day. If you are located outside of the city limits, please call

PUBLIC WAY USE UNIT: PERMIT INFORMATION SHEET

05/24/2010 - Lisa Pusateri

DBA Name	<u>THE AUTO WAREHOUSE</u>
Location	<u>3632-36 N. CICERO AVE.</u>
Zip Code	<u>60641</u>
Account Number	<u>21789</u>
Site Number	<u>1</u>
Area	<u>PERMIT</u>
Permit Type	<u>BANNER</u>
Permit Number	<u>1091864</u>

Next steps: Department of Buildings – Permit process for signs

Your Public Way Use permit number is shown above. This number is to be used for each item on your DOB application and is needed for the Buildings (DOB) online sign application located @ www.cityofchicago.org/buildings. All signs, canopies, banners, marquees and awnings require a buildings permit. Only a licensed sign erector may apply for the Buildings permit online. The Buildings permit application will ask for the Public Way Use permit number supplied above. For additional information please contact the Buildings Department at (312) 744-3400.

Please return the completed Public Way Use application to City Hall - 121 N. LaSalle Street, Chicago, IL 60602 Room 800. The completed application package must include a copy of the completed DOB application and the Public Way Use application. The Public Way Use application must contain the Alderman's signature, site plans on 8 1/2 X 11 paper, photos of the item(s), the signed Acceptance letter and a copy of the insurance certificate. For additional information please contact BACP at (312)-74-GOBIZ (312-744-6249).

CITY OF CHICAGO

LICENSE CERTIFICATE

NON-TRANSFERABLE

BY THE AUTHORITY OF THE CITY OF CHICAGO, THE FOLLOWING SPECIFIED LICENSE IS HEREBY GRANTED TO

NAME: **LEON'S AUTO SALES INC**

DBA: **THE AUTO WAREHOUSE**
AT: **3632-3636 N. CICERO AVE.**
CHICAGO, IL 60641
1ST

LICENSE NO.: **72166** CODE: **1010**

FEE: **\$****250.00**

LICENSE: **Limited Business License**

PRESIDENT: **AVE D. HORWITZ**

SECRETARY: **RONIT HOROWITZ**

PRINTED ON : **07/27/2009**

\$**250.00**

THIS LICENSE IS ISSUED AND ACCEPTED SUBJECT TO THE REPRESENTATIONS MADE ON THE APPLICATION THEREFOR, AND MAY BE SUSPENDED OR REVOKED FOR CAUSE AS PROVIDED BY LAW. LICENSEE SHALL OBSERVE AND COMPLY WITH ALL LAWS, ORDINANCES, RULES AND REGULATIONS OF THE UNITED STATES GOVERNMENT, STATE OF ILLINOIS, COUNTY OF COOK, CITY OF CHICAGO AND ALL AGENCIES THEREOF.

WITNESS THE HAND OF THE MAYOR OF SAID CITY AND THE CORPORATE SEAL THEREOF

THIS **15** DAY OF **AUGUST**, **2009**

EXPIRATION DATE:

August 15, 2011

ATTEST:



Rick M Daley
MAYOR

Miguel del Valle
CITY CLERK

DREV NO. **21789** SITE: **1**
TRANS NO.



THIS LICENSE MUST BE POSTED IN A CONSPICUOUS PLACE UPON THE LICENSED PREMISES.

THE FACE OF THIS DOCUMENT HAS A MULTI-COLORED DOCUMENT FROM WHITE PAPER



This map is a public resource of general information. The City of Chicago makes no warranty, representation or guaranty as to the content, sequence, accuracy, timeliness or completeness of any of the database information provided herein. The reader should not rely on the data provided herein for any reason. The City of Chicago explicitly disclaims any representations and warranties, including; without limitation, the implied warranties of merchantability and fitness for a particular purpose. the City of Chicago shall assume no liability for: 1. any errors, omissions, or inaccuracies in the information provided regardless of how caused; or 2. any decision made or action taken or not taken by the reader in reliance upon any information or data furnished hereunder. Map Copyright (c) 2007-2017 City of Chicago



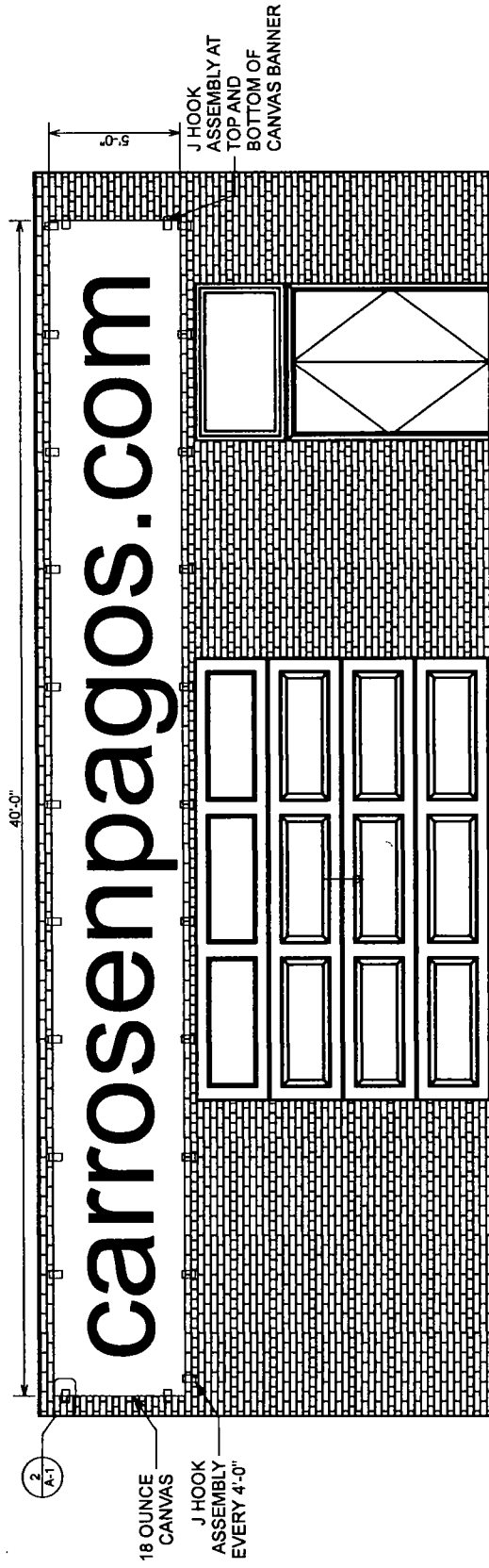
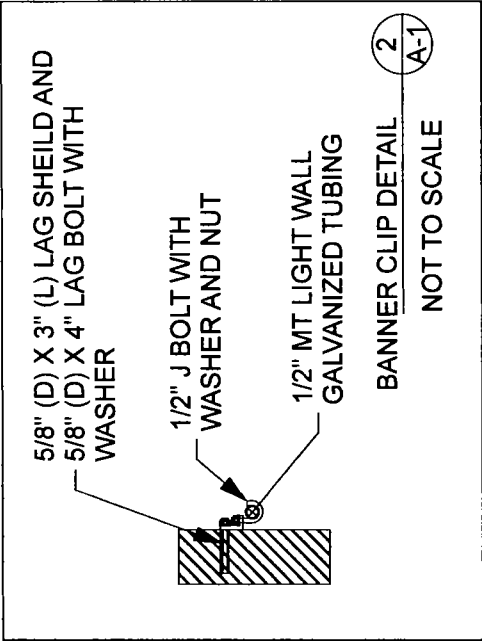

WEST PATTERSON ELEVATION 1
A-1

NOT TO SCALE

AD DELUXE SIGN COMPANY, INC 5540 WEST HARRISON STREET CHICAGO, ILLINOIS 60644 PHONE: 773-378-3538 FAX: 773-378-4552 Email: ADDELUXESIGN@comcast.net	CLIENT DATA: LEON AUTO SALE HORWITZ, AVE 3632 NORTH CICERO AVE CHICAGO, ILLINOIS 60641 PHONE: (773) 931-8000	SCOPE OF WORK: INSTALL 5'-0" x 40'-0" ILLUMINATED CANVAS SIGN	PERMIT APP. NUMBER: 100345656 APPROVAL NUMBER: 19032 TOTAL AREA: 200 SQ. FT. STREET FRONTAGE: 300'-0" SIGN TO READ: CARROSENPAPOS.COM SHEET A-1
---	--	--	--

