



Office of the City Clerk



Or2013-138

Office of the City Clerk

City Council Document Tracking Sheet

Meeting Date:	3/13/2013
Sponsor(s):	Thompson, Joann (16)
Type:	Order
Title:	Issuance of permits for sign(s)/signboard(s) at 6032 S Halsted St
Committee(s) Assignment:	Committee on Zoning, Landmarks and Building Standards

CITY COUNCIL MEETING
Introduced March 13, 2013

Ordered, that the Commissioner of Buildings is hereby authorized and directed to issue a sign permit to:

**Magic Sign
2839 W. Montrose Avenue
Chicago, IL 60618**

For the erection of a sign/signboard over 24 feet in height and/or 100 square feet in the area of one facet at:

**Reymar Clinic
6032 S. Halsted
Chicago, IL 60621**

Dimensions: Length: 24 Ft Height: 10 Ft

Height above grade/roof to top of sign: 5 Ft

Total Square Foot Area: 240 Sq Ft

Such sign(s) shall comply with the applicable provisions of Title 17 of the Chicago Zoning Ordinance of the Municipal Code of the City of Chicago governing the construction and maintenance of outdoor signs, signboards and structures.

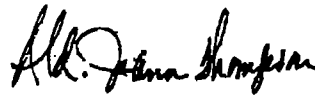

**JoAnn Thompson
Alderman, 16th Ward**



CITY OF CHICAGO

DEPARTMENT OF BUILDINGS

Sign Permit Application

APPROVAL NUMBER	APPLICATION NUMBER 100479543	ANNUAL FEE	WORK CODE	DRAWINGS ATTACHED <input type="checkbox"/> YES <input type="checkbox"/> NO
-----------------	---------------------------------	------------	-----------	--

DATE OF APPLICATION	02/28/2013		
ADDRESS OF SIGN	6032 S HALSTED ST, 60621-		
BUILDING	ORIGINAL PERMIT NUMBER		
TYPE OF PERMIT	NEW CONSTRUCTION (SIGN)		
PAYER OF ANNUAL INSPECTION	SIDDIQUE, ZAHID 6032 S. HALSTED ST CHICAGO, IL 60621 (773)208-6683		
SIGN MANUFACTURER	MAGIC SIGN		
ADDRESS WHERE SIGN CAN BE SEEN PRIOR TO ERECTION			
TICKET NUMBER	0	REINSPECTION CONTROL NUMBER	
TYPE OF SUPPORT FOR SIGN	BUILDING		
SIGN BOARD SUPPORT MEMBERS	STEEL		
ANNUAL FEE			
CONSTRUCTION FEE	700.00	Check # for Zoning	
1017 B FEE			
TOTAL FEE	700.00		
AMOUNT PAID	200.00	Check # for DCAP	
BALANCE DUE	\$ 500.00		

TYPE OF SIGN	FLAT OR BOX				
LENGTH	FT. 24	IN.	HEIGHT	FT. 10	IN.
AREA	SQ. FT. 240	WEIGHT	LBS. 60		
SIGN HEIGHT ABOVE GRADE/ROOF				FT. 5	
SHAPE OF SIGN	REGULAR				
SIGN WILL READ REYMAR CLINIC					
NO. OF LAMPS			TOTAL WATTAOB		
TYPE OF LAMP					
NO. OF BALLAST/TRANSFORMERS			INPUT OF TRANSFORMERS		
CONTRACTOR WILL INSTALL			<input checked="" type="checkbox"/> FEEDERS	<input checked="" type="checkbox"/> CUSTOMER LEADS	
TYPE OF SWITCH					
LOCATION OF SWITCH					
SIGN LOCATION ALUMINUM SIGN					

The undersigned certifies that the statements in this application are true and correct and that all work done under the removed permit will conform to the requirements of the Chicago Municipal Code

	REG. NO.
ELECT CONTR	
ADDRESS	
SUPERVISOR SIGNATURE	

BOND. NO.	REG. NO. N93127
SIGN DIRECTOR MAGIC SIGN	SIGNER
ADDRESS 2839 W. MONTROSE AVE CHICAGO X IL, 60618	
SIGNATURE <i>[Signature]</i> 02/20/13	

The permit issued on this application will authorize only signs here applied for. If other signs are to be created they must be covered by additional permits

City of Chicago
Rahm Emanuel, Mayor



Department of Buildings
Michael Merchant, Commissioner

Aluminum sign (0.40)

6032 S. Halsted
South view

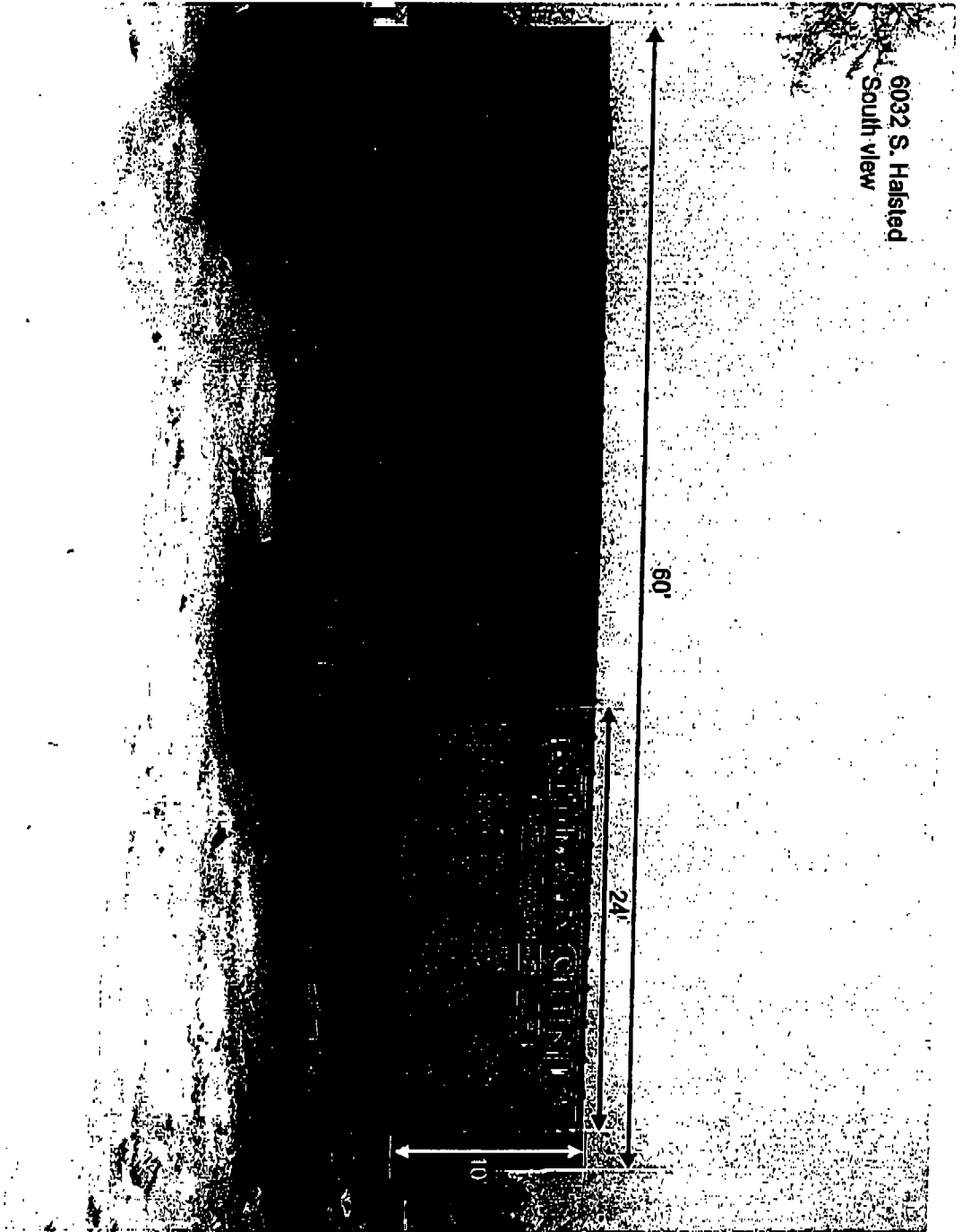

Customer Approval: _____

Date: _____

Client: Reymar Clinic

Drawing #: 1

Address: 6032 S. Halsted St, Chicago

Date: 02/28/13

Scale:

Drawn By:

Rev Date:

All sign and concepts shown here are confidential and are the property of Magie Sign Co. They are not to be distributed, copied or otherwise used without our written permission.

COMPUTER GENERATED COLORS ARE NOT A TRUE MATCH TO ANY PMS, VINYL OR PAINT.

FRAME TO WALL ANCHOR DETAIL

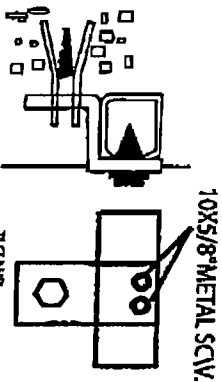

Magic Sign
The Sign That Shines

Zoning Map

Created on: 2/28/2013 10:59 A.M.

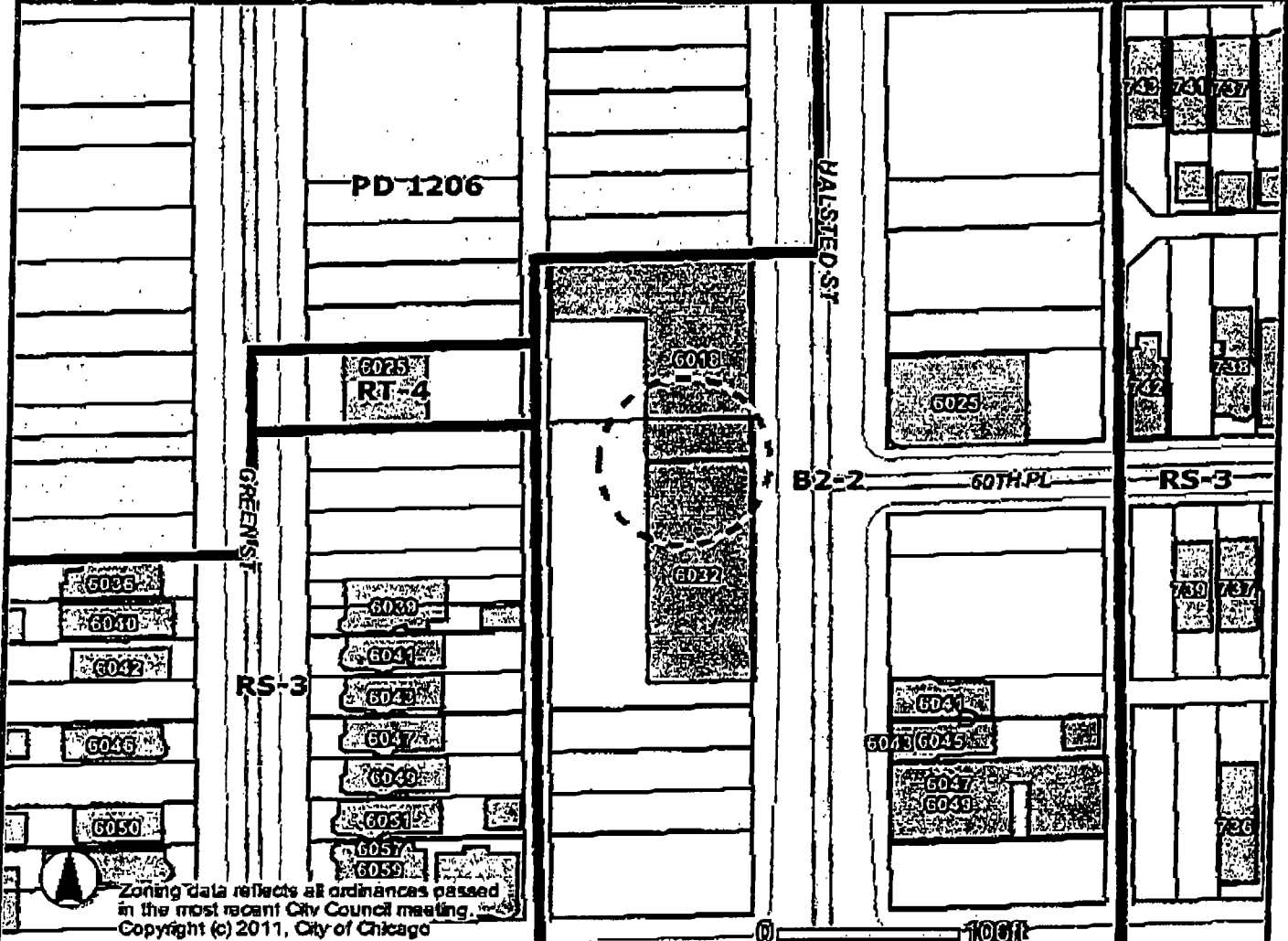

Zoning data reflects all ordinances passed in the most recent City Council meeting.
 Copyright (c) 2011, City of Chicago

Address

6032 S HALSTED ST

Zoning

- Business
- Commercial
- Manufacturing
- Residential
- Planned Development
- Planned Manufacturing
- Downtown Core
- Downtown Service
- Downtown Mixed
- Downtown Residential
- Transportation
- Parks & Open Space
- Zoning Boundaries

Historic Preservation

- CHICAGO LANDMARKS**
- Chicago Landmarks
 - Landmark Districts
- Chicago Historic Resources Survey - Buildings subject to Demolition-Delay Ordinance**
- Red
 - Orange
 - Water
 - Cemetery
 - Municipalities

Lakefront

- Pedestrian Streets
- Buildings
- Parcels
- Streets
- Curbs
- Forest Preserve
- City Boundary



Information provided on the City of Chicago web site should not be used as a substitute for legal, accounting, real estate, business, tax, or other professional advice. The City of Chicago assumes no liability for any damages or loss of any kind that might arise from the use of, misuse of, or the inability to use the City web site and/or the materials contained on the web site. The City of Chicago also assumes no liability for improper or incorrect use of materials or information contained on its web site. All materials that appear on the City of Chicago web site are distributed and transmitted as is, without warranties of any kind, either express or implied, and subject to the terms and

Aluminum Sign (0.40)

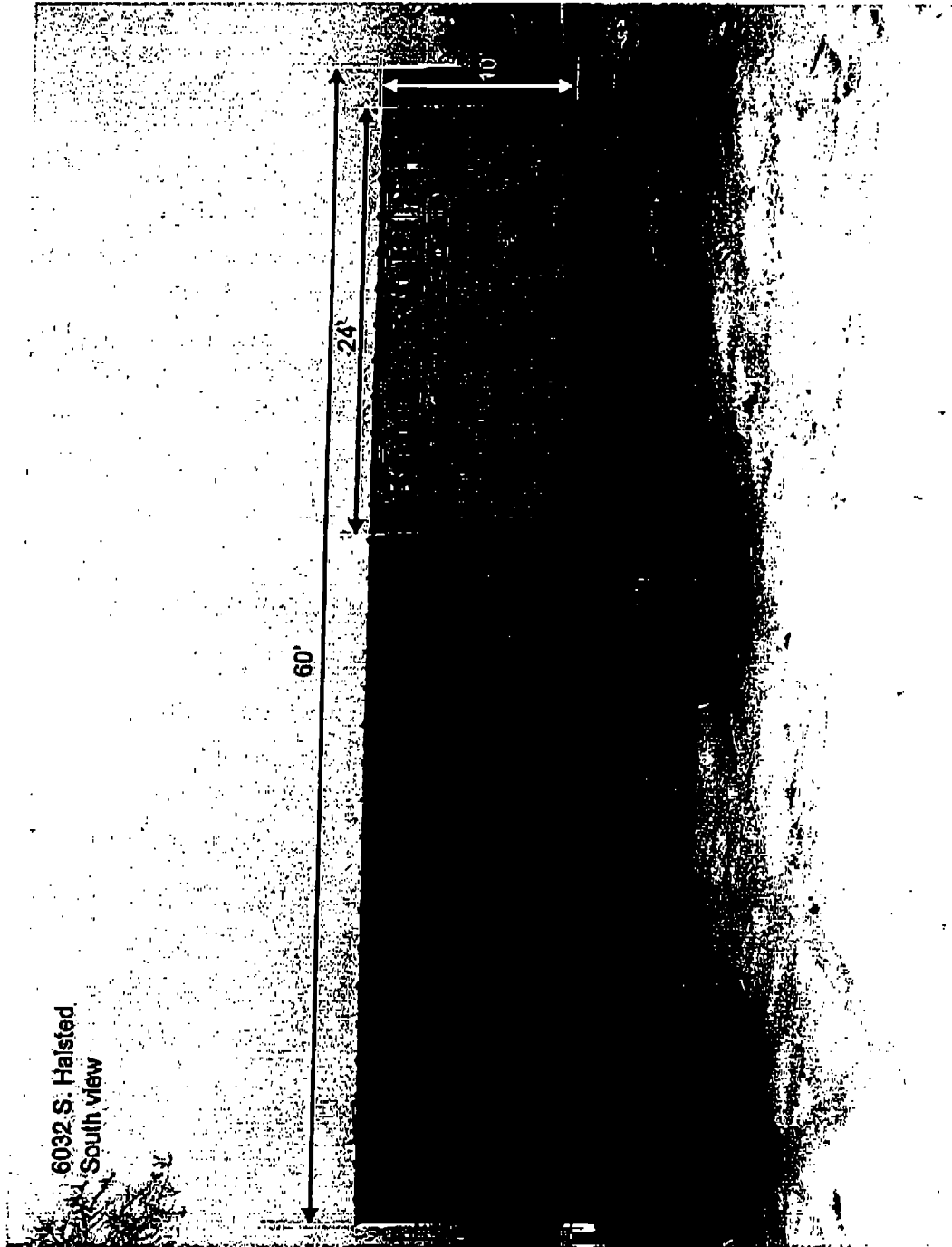

6032 S. Halsted
South view

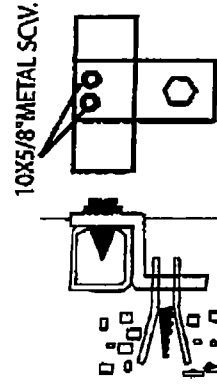

FRAME TO WALL ANCHOR DETAIL

Customer Approval: _____

Date: _____

Client: Reymar Clinic		Drawing #: 1
Address: 6032 S. Halsted St, Chicago		Date: 02/28/13
Scale:	Drawn By:	Rev Date:

All sign and concepts shown here are confidential and are the property of Magic Sign Co. They are not to be distributed, copied or otherwise used without our written permission.

COMPUTER GENERATED COLORS ARE NOT A TRUE MATCH TO ANY PMS, VINYL OR PAINT.

