



City of Chicago



O2014-7675

Office of the City Clerk

Document Tracking Sheet

Meeting Date:	9/10/2014
Sponsor(s):	Burnett (27)
Type:	Ordinance
Title:	Grant(s) of privilege in public way for 1K Fulton LLC
Committee(s) Assignment:	Committee on Transportation and Public Way

ORDINANCE
1K Fulton, LLC
Acct. No. 383089 - 1
Permit No. 1114396

Be It Ordained by the City Council of the City of Chicago:

SECTION 1. Permission and authority are hereby given and granted to 1K Fulton, LLC, upon the terms and subject to the conditions of this ordinance to construct, install, maintain and use four (4) Irrigation System(s) under the public right-of-way adjacent to its premises known as 1000 W. Fulton Market .

Said Irrigation System(s) at N. Carpenter Street measure(s):

One (1) at two hundred eighty (280) feet in length, and point five (.5) feet in width for a total of one hundred forty (140) square feet.

Said Irrigation System(s) at W. Carroll Avenue measure(s):

One (1) at two hundred forty (240) feet in length, and point five (.5) feet in width for a total of one hundred twenty (120) square feet.

Said Irrigation System(s) at N. Morgan Street measure(s):

One (1) at two hundred eighty (280) feet in length, and point five (.5) feet in width for a total of one hundred forty (140) square feet.

Said Irrigation System(s) at W. Fulton Street measure(s):

One (1) at two hundred five (205) feet in length, and point five (.5) feet in width for a total of one hundred two point five (102.5) square feet.

The location of said privilege shall be as shown on prints kept on file with the Department of Business Affairs and Consumer Protection and the Office of the City Clerk.

Said privilege shall be constructed in accordance with plans and specifications approved by the Department of Transportation (Office of Underground Coordination) and Department of Water Management.

This grant of privilege in the public way shall be subject to the provisions of Section 10-28-015 and all other required provisions of the Municipal Code of Chicago.

The grantee shall pay to the City of Chicago as compensation for the privilege #1114396 herein granted the sum of one thousand six hundred (\$1,600.00) per annum in advance.

A 25% penalty will be added for payments received after due date.

The permit holder agrees to hold the City of Chicago harmless for any damage, relocation or replacement costs associated with damage, relocation or removal of private property caused by the City performing work in the public way.

Authority herein given and granted for a period of five (5) years from and after Date of Passage.

Alderman 
Walter Burnett Jr. 27th Ward

ANDREW MCCOY
Zone Sprinkling Systems
1813 W 17TH STREET
EAST HAZEL CREST, IL 60030
PHONE (708) 788-6731

PLUMBING CONSULTANTS
OF ILLINOIS

ANDREW MCCOY		1813 W 17TH STREET	2014
Zone Sprinkling Systems		EAST HAZEL CREST, IL 60030	
DATE	PROJECT	CLIENT	
10-1-14	10-1-14	10-1-14	
10-1-14		10-1-14	

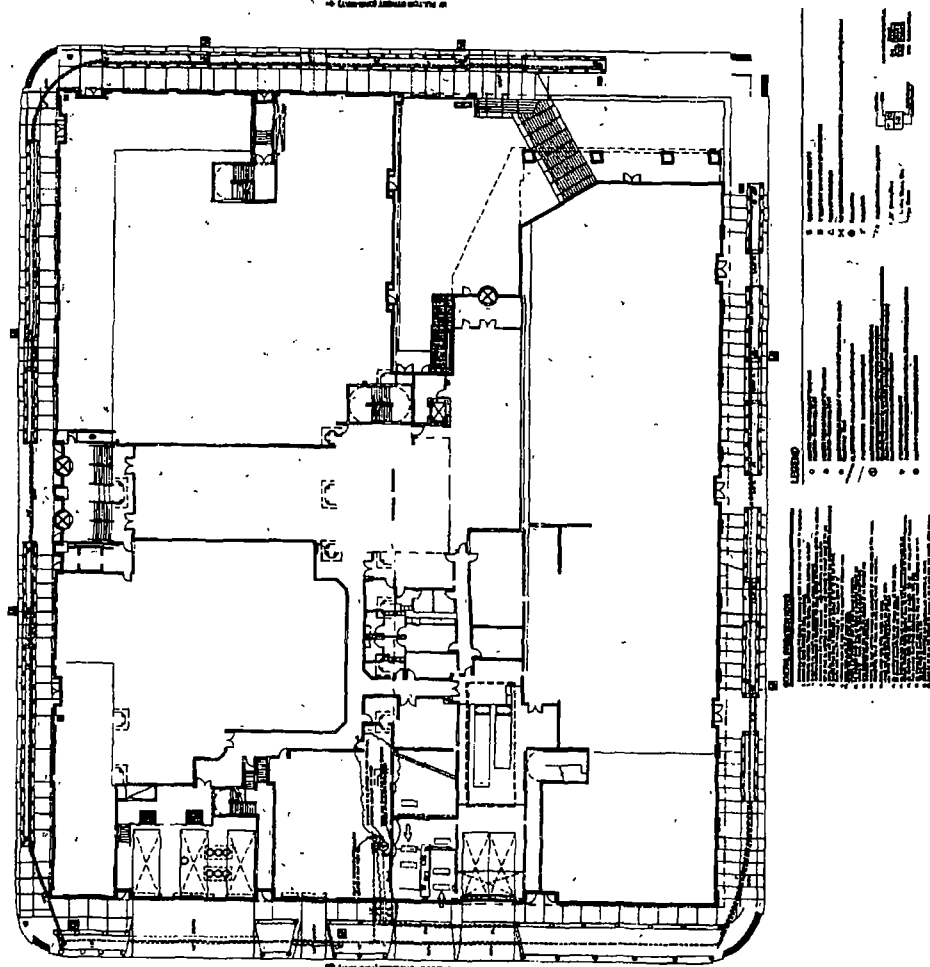

LEGEND	
1	10' x 10' TILE
2	12' x 12' TILE
3	18' x 18' TILE
4	24' x 24' TILE
5	30' x 30' TILE
6	36' x 36' TILE
7	42' x 42' TILE
8	48' x 48' TILE
9	54' x 54' TILE
10	60' x 60' TILE
11	66' x 66' TILE
12	72' x 72' TILE
13	78' x 78' TILE
14	84' x 84' TILE
15	90' x 90' TILE
16	96' x 96' TILE
17	102' x 102' TILE
18	108' x 108' TILE
19	114' x 114' TILE
20	120' x 120' TILE
21	126' x 126' TILE
22	132' x 132' TILE
23	138' x 138' TILE
24	144' x 144' TILE
25	150' x 150' TILE
26	156' x 156' TILE
27	162' x 162' TILE
28	168' x 168' TILE
29	174' x 174' TILE
30	180' x 180' TILE
31	186' x 186' TILE
32	192' x 192' TILE
33	198' x 198' TILE
34	204' x 204' TILE
35	210' x 210' TILE
36	216' x 216' TILE
37	222' x 222' TILE
38	228' x 228' TILE
39	234' x 234' TILE
40	240' x 240' TILE
41	246' x 246' TILE
42	252' x 252' TILE
43	258' x 258' TILE
44	264' x 264' TILE
45	270' x 270' TILE
46	276' x 276' TILE
47	282' x 282' TILE
48	288' x 288' TILE
49	294' x 294' TILE
50	300' x 300' TILE
51	306' x 306' TILE
52	312' x 312' TILE
53	318' x 318' TILE
54	324' x 324' TILE
55	330' x 330' TILE
56	336' x 336' TILE
57	342' x 342' TILE
58	348' x 348' TILE
59	354' x 354' TILE
60	360' x 360' TILE
61	366' x 366' TILE
62	372' x 372' TILE
63	378' x 378' TILE
64	384' x 384' TILE
65	390' x 390' TILE
66	396' x 396' TILE
67	402' x 402' TILE
68	408' x 408' TILE
69	414' x 414' TILE
70	420' x 420' TILE
71	426' x 426' TILE
72	432' x 432' TILE
73	438' x 438' TILE
74	444' x 444' TILE
75	450' x 450' TILE
76	456' x 456' TILE
77	462' x 462' TILE
78	468' x 468' TILE
79	474' x 474' TILE
80	480' x 480' TILE
81	486' x 486' TILE
82	492' x 492' TILE
83	498' x 498' TILE
84	504' x 504' TILE
85	510' x 510' TILE
86	516' x 516' TILE
87	522' x 522' TILE
88	528' x 528' TILE
89	534' x 534' TILE
90	540' x 540' TILE
91	546' x 546' TILE
92	552' x 552' TILE
93	558' x 558' TILE
94	564' x 564' TILE
95	570' x 570' TILE
96	576' x 576' TILE
97	582' x 582' TILE
98	588' x 588' TILE
99	594' x 594' TILE
100	600' x 600' TILE