



City of Chicago



SO2021-2448

Office of the City Clerk

Document Tracking Sheet

Meeting Date:	6/25/2021
Sponsor(s):	Misc. Transmittal
Type:	Ordinance
Title:	Zoning Reclassification Map No. 3-J at 3518-3556 W Division St - App No. 20749T1
Committee(s) Assignment:	Committee on Zoning, Landmarks and Building Standards

FINAL FOR PUBLICATION

ORDINANCE

BE IT ORDAINED BY THE CITY COUNCIL OF THE CITY OF CHICAGO:

SECTION 1. Title 17 of the Municipal Code of Chicago, the Chicago Zoning Ordinance, is hereby amended by changing all of the M2-1, Light Industry District symbols and indications as shown on Map No 3-1 in the area bounded by:

West Potomac Avenue, Chicago Milwaukee and St. Paul Rail Road Right-of-Way; West Division Street; and North Central Park Avenue

to those of a C2-1 Motor Vehicle-Related District.

SECTION 2 This ordinance shall be in force and effect from and after its passage and due publication.

Common Address of Property: 3518-3556 W. Division Street, Chicago, IL 60651

FINAL FOR PUBLICATION

Substitute Narrative and Plans for Zoning Map Amendment
Type 1 at 3518-3556 W. Division Street
From M2-1 to C2-1

- A) Analysis describing proposed development: Building will be remodeled to auto parts supply and accessory sales store. There will be no dwelling units. Existing commercial space – 29,028 sf; Parking spaces – 119; Building height – 19'-0". No changes to the existing bulk size of the building.
- a. Floor area ratio: 0.24
Lot area: 120,196.89 square feet – 2.75 acres
 - b. Density (lot area per dwelling unit): None – no residential
 - c. Off-street Parking: 119 on-site parking spaces
 - d. Setbacks:
 - Front: 229.81 feet
 - Rear: 160.88 feet
 - East: 4.04 feet
 - West: 0 feet
 - e. Building height: 19.0 feet

Plans have been provided for reference.

FINAL FOR PUBLICATION

FINAL FOR PUBLICATION

- GENERAL NOTES**
- SEE VERTICAL CURVE FOR ADDITIONAL INFORMATION.
 - ALL DIMENSIONS ARE TO FACE UNLESS OTHERWISE SPECIFIED. DIMENSIONS TO FACE OF CURVES ARE TO THE CENTERLINE OF THE ROAD UNLESS OTHERWISE SPECIFIED.
 - SEE SPECIFICATIONS TO FACE OF BUILDING. EXTERIOR CURVE CENTERLINE DIMENSIONS TO FACE OF BUILDING ARE TO THE CENTERLINE OF THE ROAD UNLESS OTHERWISE SPECIFIED.
 - SEE SPECIFICATIONS TO FACE OF BUILDING. EXTERIOR CURVE CENTERLINE DIMENSIONS TO FACE OF BUILDING ARE TO THE CENTERLINE OF THE ROAD UNLESS OTHERWISE SPECIFIED.
 - SEE SPECIFICATIONS TO FACE OF BUILDING. EXTERIOR CURVE CENTERLINE DIMENSIONS TO FACE OF BUILDING ARE TO THE CENTERLINE OF THE ROAD UNLESS OTHERWISE SPECIFIED.
 - SEE SPECIFICATIONS TO FACE OF BUILDING. EXTERIOR CURVE CENTERLINE DIMENSIONS TO FACE OF BUILDING ARE TO THE CENTERLINE OF THE ROAD UNLESS OTHERWISE SPECIFIED.
 - SEE SPECIFICATIONS TO FACE OF BUILDING. EXTERIOR CURVE CENTERLINE DIMENSIONS TO FACE OF BUILDING ARE TO THE CENTERLINE OF THE ROAD UNLESS OTHERWISE SPECIFIED.
 - SEE SPECIFICATIONS TO FACE OF BUILDING. EXTERIOR CURVE CENTERLINE DIMENSIONS TO FACE OF BUILDING ARE TO THE CENTERLINE OF THE ROAD UNLESS OTHERWISE SPECIFIED.
 - SEE SPECIFICATIONS TO FACE OF BUILDING. EXTERIOR CURVE CENTERLINE DIMENSIONS TO FACE OF BUILDING ARE TO THE CENTERLINE OF THE ROAD UNLESS OTHERWISE SPECIFIED.
 - SEE SPECIFICATIONS TO FACE OF BUILDING. EXTERIOR CURVE CENTERLINE DIMENSIONS TO FACE OF BUILDING ARE TO THE CENTERLINE OF THE ROAD UNLESS OTHERWISE SPECIFIED.

TABLE 1

GENERAL NOTES

1. SEE SPECIFICATIONS TO FACE OF BUILDING. EXTERIOR CURVE CENTERLINE DIMENSIONS TO FACE OF BUILDING ARE TO THE CENTERLINE OF THE ROAD UNLESS OTHERWISE SPECIFIED.

2. SEE SPECIFICATIONS TO FACE OF BUILDING. EXTERIOR CURVE CENTERLINE DIMENSIONS TO FACE OF BUILDING ARE TO THE CENTERLINE OF THE ROAD UNLESS OTHERWISE SPECIFIED.

3. SEE SPECIFICATIONS TO FACE OF BUILDING. EXTERIOR CURVE CENTERLINE DIMENSIONS TO FACE OF BUILDING ARE TO THE CENTERLINE OF THE ROAD UNLESS OTHERWISE SPECIFIED.

4. SEE SPECIFICATIONS TO FACE OF BUILDING. EXTERIOR CURVE CENTERLINE DIMENSIONS TO FACE OF BUILDING ARE TO THE CENTERLINE OF THE ROAD UNLESS OTHERWISE SPECIFIED.

5. SEE SPECIFICATIONS TO FACE OF BUILDING. EXTERIOR CURVE CENTERLINE DIMENSIONS TO FACE OF BUILDING ARE TO THE CENTERLINE OF THE ROAD UNLESS OTHERWISE SPECIFIED.

6. SEE SPECIFICATIONS TO FACE OF BUILDING. EXTERIOR CURVE CENTERLINE DIMENSIONS TO FACE OF BUILDING ARE TO THE CENTERLINE OF THE ROAD UNLESS OTHERWISE SPECIFIED.

7. SEE SPECIFICATIONS TO FACE OF BUILDING. EXTERIOR CURVE CENTERLINE DIMENSIONS TO FACE OF BUILDING ARE TO THE CENTERLINE OF THE ROAD UNLESS OTHERWISE SPECIFIED.

8. SEE SPECIFICATIONS TO FACE OF BUILDING. EXTERIOR CURVE CENTERLINE DIMENSIONS TO FACE OF BUILDING ARE TO THE CENTERLINE OF THE ROAD UNLESS OTHERWISE SPECIFIED.

9. SEE SPECIFICATIONS TO FACE OF BUILDING. EXTERIOR CURVE CENTERLINE DIMENSIONS TO FACE OF BUILDING ARE TO THE CENTERLINE OF THE ROAD UNLESS OTHERWISE SPECIFIED.

10. SEE SPECIFICATIONS TO FACE OF BUILDING. EXTERIOR CURVE CENTERLINE DIMENSIONS TO FACE OF BUILDING ARE TO THE CENTERLINE OF THE ROAD UNLESS OTHERWISE SPECIFIED.

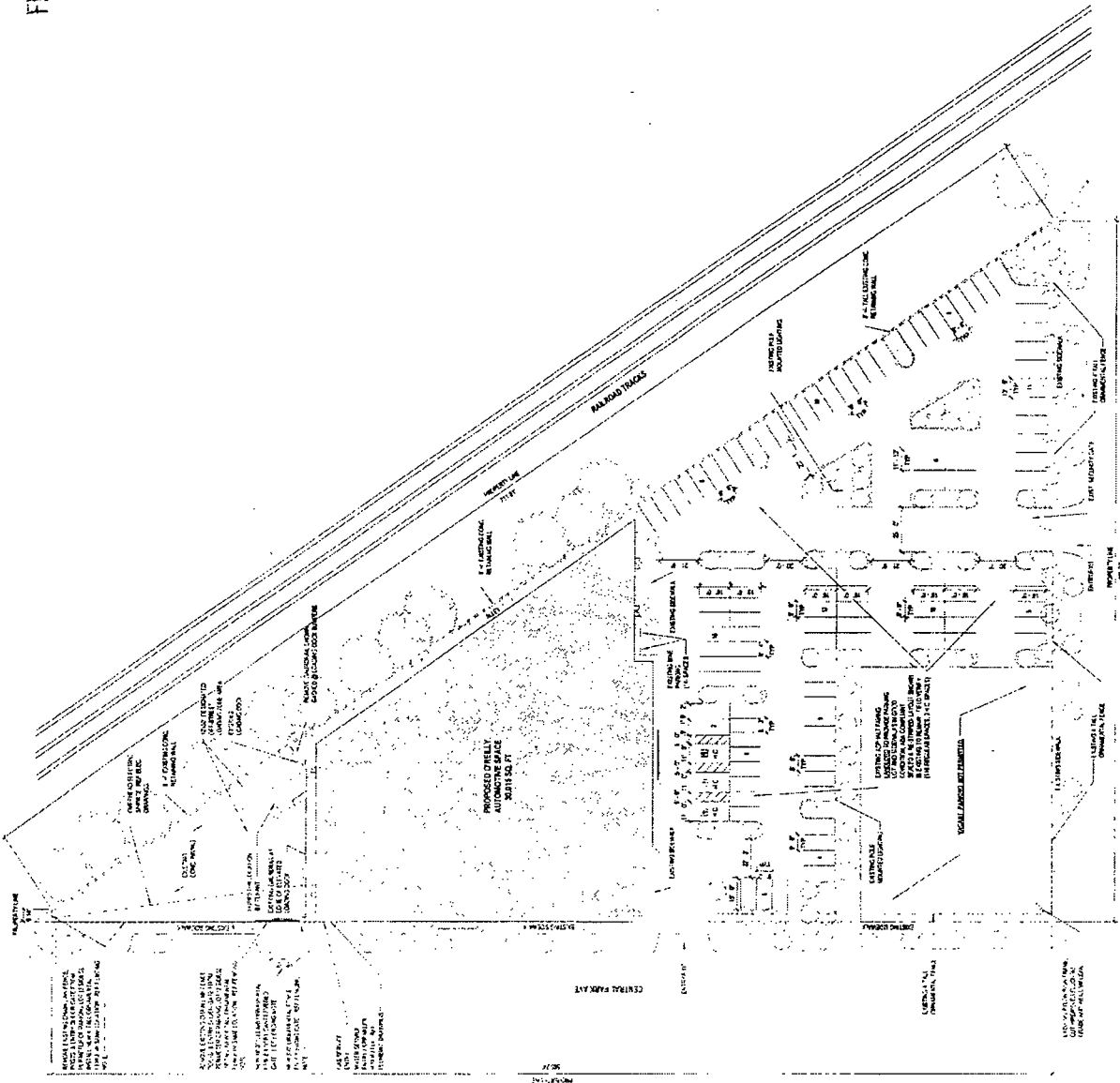

1A SITE LOCATOR MAP

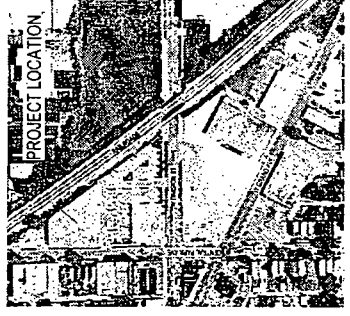

1 ARCHITECTURAL SITE PLAN

PROJECT

ARCHITECT: JAMES H. HAN

DATE: 11/11/08

SCALE: 1/8" = 1'-0"

PROJECT: GREATLY AUTO PARTS STORE

REilly

ARCHITECTURE

1170 SOUTH PATTERSON

SAN FRANCISCO, CALIFORNIA 94116

TEL: (415) 398-2574

FAX: (415) 398-2575

WWW.REILLYARCHITECTURE.COM

ASP1.1

DATE: 11/11/08

BY: JH



3 NORTH COLOR EXTERIOR ELEVATION



2 WEST COLOR EXTERIOR ELEVATION



1 SOUTH COLOR EXTERIOR ELEVATION

EXTERIOR COLOR ELEVATIONS
 REMODEL O'REILLY AUTO PARTS STORE
 CHICAGO, IL



REPRESENTING: NOT FOR CONSTRUCTION PURPOSES
 ALL INFORMATION IS SUBJECT TO CHANGE WITHOUT NOTICE
 © 2014 O'REILLY AUTO PARTS STORE, CHICAGO, IL

pb2
 architecture + engineering
 100 N. LAKE ST. SUITE 1000
 CHICAGO, IL 60601-1000
 TEL: 312.467.1000
 WWW.PB2ARCHITECTURE.COM