



# City of Chicago



Or2013-759

Office of the City Clerk

## Document Tracking Sheet

<b>Meeting Date:</b>	12/11/2013
<b>Sponsor(s):</b>	Reilly (42)
<b>Type:</b>	Order
<b>Title:</b>	Issuance of permits for sign(s)/signboard(s) at 233 N Michigan Ave
<b>Committee(s) Assignment:</b>	Committee on Zoning, Landmarks and Building Standards





# APPLICATION TO USE THE PUBLIC RIGHT OF WAY

OFFICE USE ONLY		
DOB PERMIT #:		
AMNESTY ELIGIBLE?	<input type="checkbox"/> YES	<input type="checkbox"/> NO

## APPLICANT INFORMATION

LEGAL NAME OF ENTITY: \_\_\_\_\_

PERMIT MAILING ADDRESS: \_\_\_\_\_

CITY: \_\_\_\_\_ STATE: \_\_\_\_\_ ZIP CODE: \_\_\_\_\_

CONTACT PERSON: \_\_\_\_\_ TITLE: \_\_\_\_\_

PHONE: \_\_\_\_\_ FAX: \_\_\_\_\_ E-MAIL: \_\_\_\_\_

## BUILDING OWNER INFORMATION

NAME: \_\_\_\_\_

ADDRESS: \_\_\_\_\_

CITY: \_\_\_\_\_ STATE: \_\_\_\_\_ ZIP CODE: \_\_\_\_\_

PHONE: \_\_\_\_\_ FAX: \_\_\_\_\_ E-MAIL: \_\_\_\_\_

## USE OF THE PUBLIC WAY

- List the proposed or existing use below and complete the worksheet on page 3. Use only one application for all public way use type.

TYPE	HOW MANY?	BUILDING ADDRESS
SIGN	1	233 N MICHIGAN AVENUE

- Please enclose one sketch of each proposed use of the public way, which maps to scale the proposed use(s) and its relationship to surrounding right-of-way. All measurements must be indicated.

The prints should also accurately depict the location of the property line and public facilities (meters, light poles, sidewalks).

## APPLICANT CERTIFICATION

I hereby certify that all statements made as part of the application, and the attachments herein, are true to the best of my knowledge and belief.

BY: \_\_\_\_\_ TITLE: \_\_\_\_\_

F.E.I.N. or SOCIAL SECURITY NUMBER: \_\_\_\_\_

## ALDERMAN'S APPROVAL

As part of this application process, you are required to notify/obtain approval from the Alderman in whose ward your proposed use of the public way is located.

ALDERMAN'S SIGNATURE: \_\_\_\_\_

DATE: \_\_\_\_\_ WARD: \_\_\_\_\_





# APPLICATION TO USE THE PUBLIC RIGHT OF WAY

## APPLICATION WORKSHEET

- For use by NEW APPLICANTS ONLY.
- For renewals obtain form from City Hall, 121 N. LaSalle St., Rm. 800 or call (312) 74 - GOBIZ (744-6249)

Complete the worksheet for each use of the public way and indicate all applicable measurements.

	Exact Street (i.e. S. State St.)	Quantity	Length of structure along public way	Height of structure	Depth of structure	Height above grade	Total depth over public way	Is this sign(s) illuminated? (Y/N)	Is this an Existing Public Way Use (Y/N)
SIGNS	233 N MICHIGAN AVE	1	25'	3'11"	2"	30'	2"	Y	N
CANOPIES / AWNINGS									
LIGHTS									

See example of required plans beginning on page 5.

NOTE: Pursuant to section 2-154-030 of the Municipal Code of the City of Chicago the Corporation Counsel of the City of Chicago may require any such additional information from any applicant to achieve full disclosure relevant to the request for action by the City Council or other city agency. Pursuant to section 2-154-020 of the Municipal code of the City of Chicago any material change in the information required above must be provided by supplementing this statement at any time up to the time the City Council or any city agency takes action on the application.



TIME BLOCK UPDATE

**NORDQUIST**  
SIGN COMPANY  
www.nordquist.com  
945 Plaza North Shore, St. Paul, MN 55114  
612.823.7291 800.598.8901

**CATTALYON**  
12100 North 44th Ave  
Chaska, MN 55318  
Phone: 612.435.8455  
www.cattalyon.com  
© 2011 Cattalyon, Inc. All rights reserved.

CLIENT:  
111-233  
NORTH MICHIGAN  
233 NORTH MICHIGAN AVE  
CHICAGO, IL 60601

SIGN TYPE:  
SIGN E3  
EXTERIOR ILLUM. LETTERS

CUSTOMER APPROVAL

NAME:  
DATE:

REV 1: 11-20-13 TRW  
REV 2:  
REV 3:  
REV 4:  
REV 5:

SALES: SH CK'D  
DESIGN: JF  
DATE: 11.05.13  
DWG: 4017-02

Note: Check for the existence property, as well as the zoning and other regulations of the original work or its replacement. They are submitted to your company for the purpose of your company's approval. The sign is a sign, fabricated according to these plans, installation or other instructions, and is not a representation of your company or its products. It is intended to be used as a guide only. All other rights reserved. Copyright 2013 NDC, Inc.

NOTE:  
SEE PG. 23 FOR  
SPECIFIC DETAILS

SCALE: NTS

1 SOUTH WATER STREET OVERPASS ELEVATION SIGN TYPE E3-01

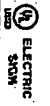
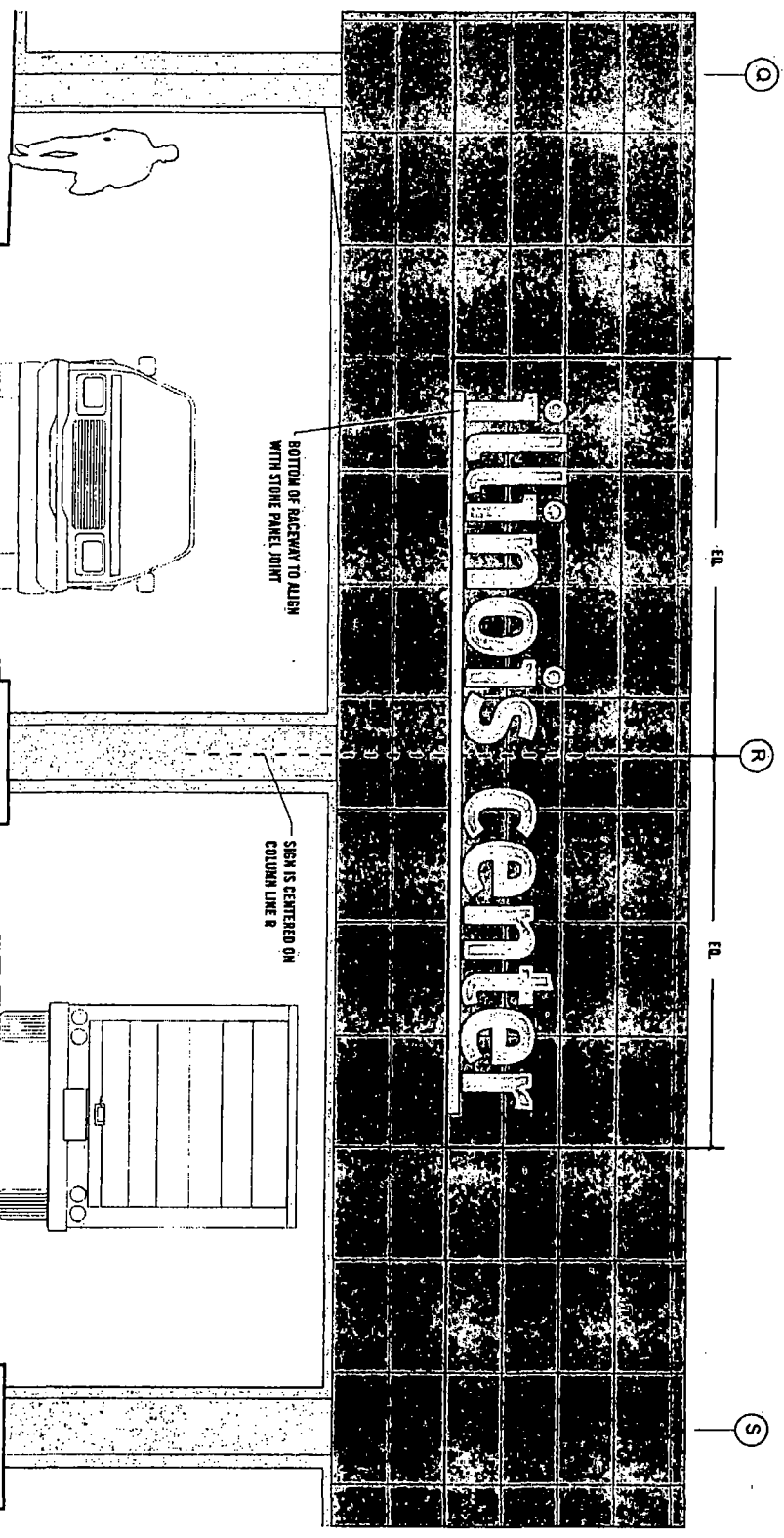

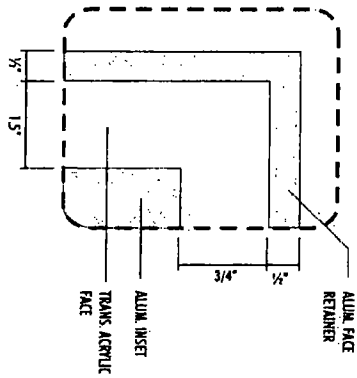

3 DETAIL  
SCALE: FULL

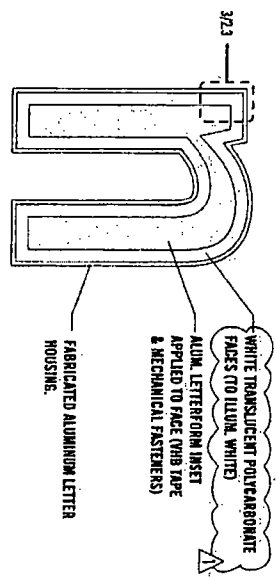

2 DETAIL  
SCALE: NTS

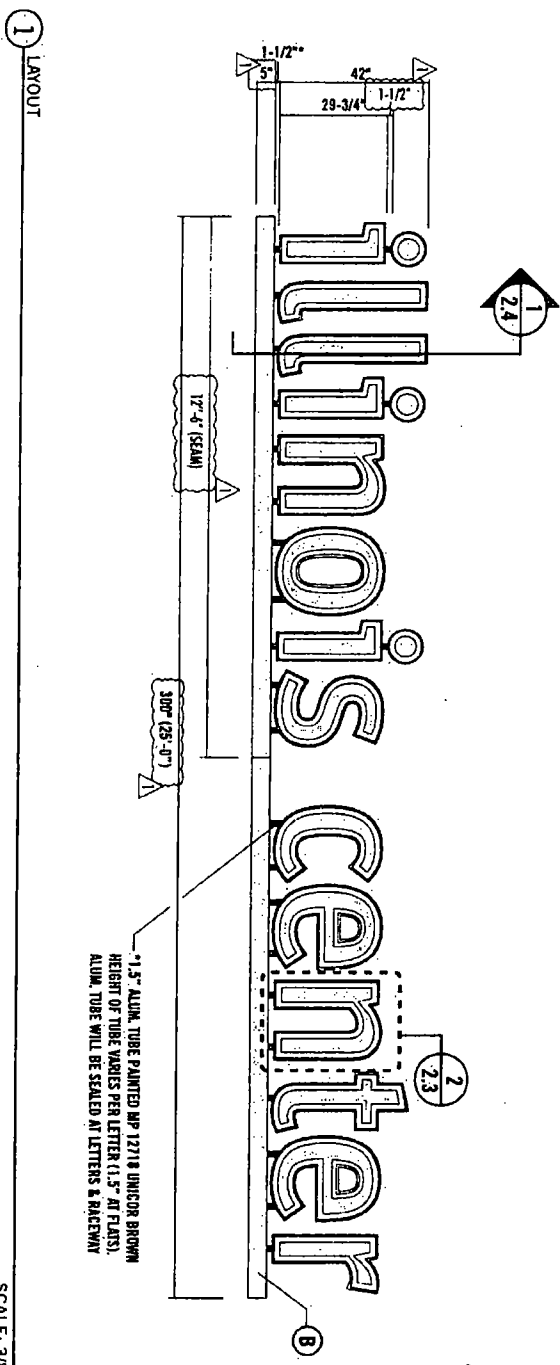

1 LAYOUT  
SCALE: 3/8" = 1'-0"

**EXTERIOR ILLUMINATED LETTERS**

- A - LETTERS**
    - 4" DEEP RETURN PAINTED TO MATCH MP 41-342 BRUSHED ALUMINUM
    - INSIDE LETTERS PAINTED MP SATIN WHITE
    - 1/17" THK. WHITE TRANSLUCENT POLYCARBONATE FACES
    - 1/8" ALUM. LETTERFORM INSERTS PAINTED TO MATCH MP 41-342 BRUSHED ALUMINUM
  - B - FACEWAY**
    - FABRICATED ALUM. PAINTED MP 41-342 BRUSHED ALUM.
- ELECTRICAL REQUIREMENTS:**
- (APPROX.) 115 FT/3 SDRAM LONG WHITE LED UNITS
  - (4) MODSD LED DRIVER
  - (1) TOGGLE SWITCH WEATHER PROOF
  - APPROX 4 AMP @ 120 VOLT
- ELECTRICAL SERVICE AND CONNECTION BY OTHERS**
- INSTALL:**  
ANCHOR MOUNTED TO WALL. DEPTH NOT TO EXCEED 1".

**TIME BLOCK UPDATE**

<p><b>NORDQUIST SIGN COMPANY</b> www.nordquist.com 3401 Pershing Avenue, St. Paul, MN 55116 612.623.7281 800.698.8901</p>	<p><b>CLIENT:</b> 111-233 NORTH MICHIGAN 233 NORTH MICHIGAN AVE. CHICAGO, IL 60601</p>
	<p><b>SIGN TYPE:</b> SIGN E3 EXTERIOR ILLUM. LETTERS</p>
<p><b>CUSTOMER APPROVAL</b></p> <p>NAME: _____ DATE: _____</p>	<p>REV 1: 11-20-13 TRW REV 2: _____ REV 3: _____ REV 4: _____ REV 5: _____</p>
<p><b>SALES: SH</b>    <b>CR/D:</b> _____ <b>DESIGN: YP</b> <b>DATE: 11.05.13</b> <b>DWG: 4017-02</b></p>	<p>These plans are the exclusive property of Nordquist Sign Company. They are not to be reproduced or used in any way without the written consent of Nordquist Sign Company. The use of these plans for any other project is strictly prohibited. Nordquist Sign Company reserves the right to modify these plans at any time without notice. Copyright © 2013 by Nordquist Sign Company. All rights reserved.</p>



**NORDQUIST**  
SIGN COMPANY  
www.nordquist.com  
340 North La Grange, St. Paul, MN 55109  
612.823.7291 800.598.8901

**C.A.T. LAYON**  
SIGN & LETTERING  
13 Wabasha Ave. 2nd Fl.  
Chicago, IL 60604  
Phone: 312-467-4141  
www.cathyandjays.com  
© 2013 Northlight Sign & Lettering

**CLIENT:**  
111-233  
**NORTH MICHIGAN**  
233 NORTH MICHIGAN AVE.  
CHICAGO, IL 60601

**SIGN TYPE:**  
SIGN E3  
EXTERIOR ILLUM. LETTERS

**CUSTOMER APPROVAL**  
NAME: \_\_\_\_\_  
DATE: \_\_\_\_\_

REV. 1: 11-20-13 TRW  
REV. 2: \_\_\_\_\_  
REV. 3: \_\_\_\_\_  
REV. 4: \_\_\_\_\_  
REV. 5: \_\_\_\_\_

**SALES:** SH CK'D  
**DESIGN:** VF  
**DATE:** 11.05.13  
**DWG:** 4017-02

These plans are the exclusive property of Nordquist Sign Company. They are to be used only for the project and site specified. Any other use without the written consent of Nordquist Sign Company is prohibited. The client agrees to indemnify and hold Nordquist Sign Company harmless from all claims, damages, and expenses, including reasonable attorney's fees, arising from any use of these plans other than that intended. The client also agrees to hold Nordquist Sign Company harmless from all claims, damages, and expenses, including reasonable attorney's fees, arising from any use of these plans other than that intended. The client also agrees to hold Nordquist Sign Company harmless from all claims, damages, and expenses, including reasonable attorney's fees, arising from any use of these plans other than that intended.



SCALE: 3" = 1'-0"

1 SECTION DETAIL

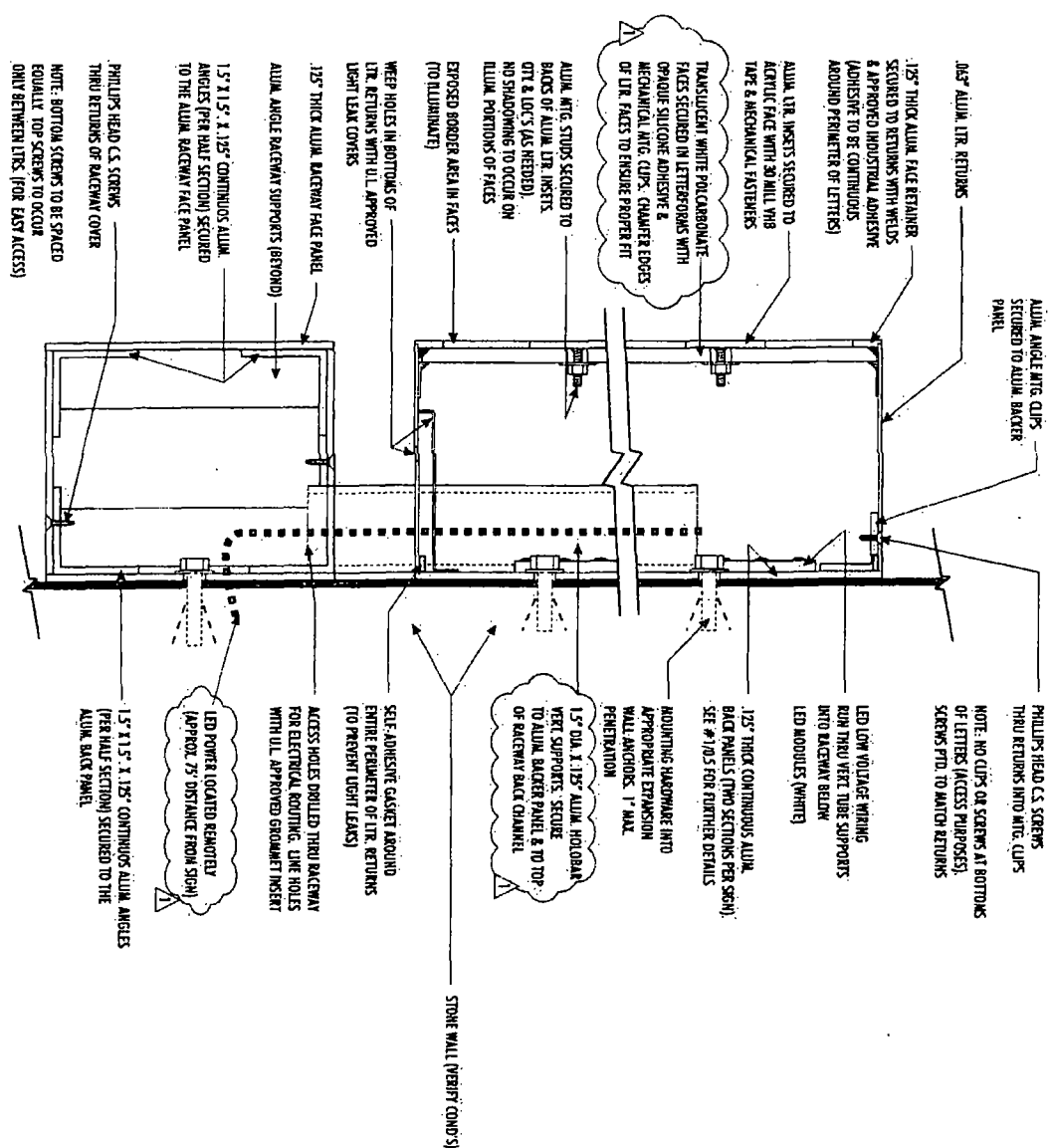





CHICAGO GUARANTEE SURVEY COMPANY  
PLAT OF SURVEY



SIGN  
LOCATION

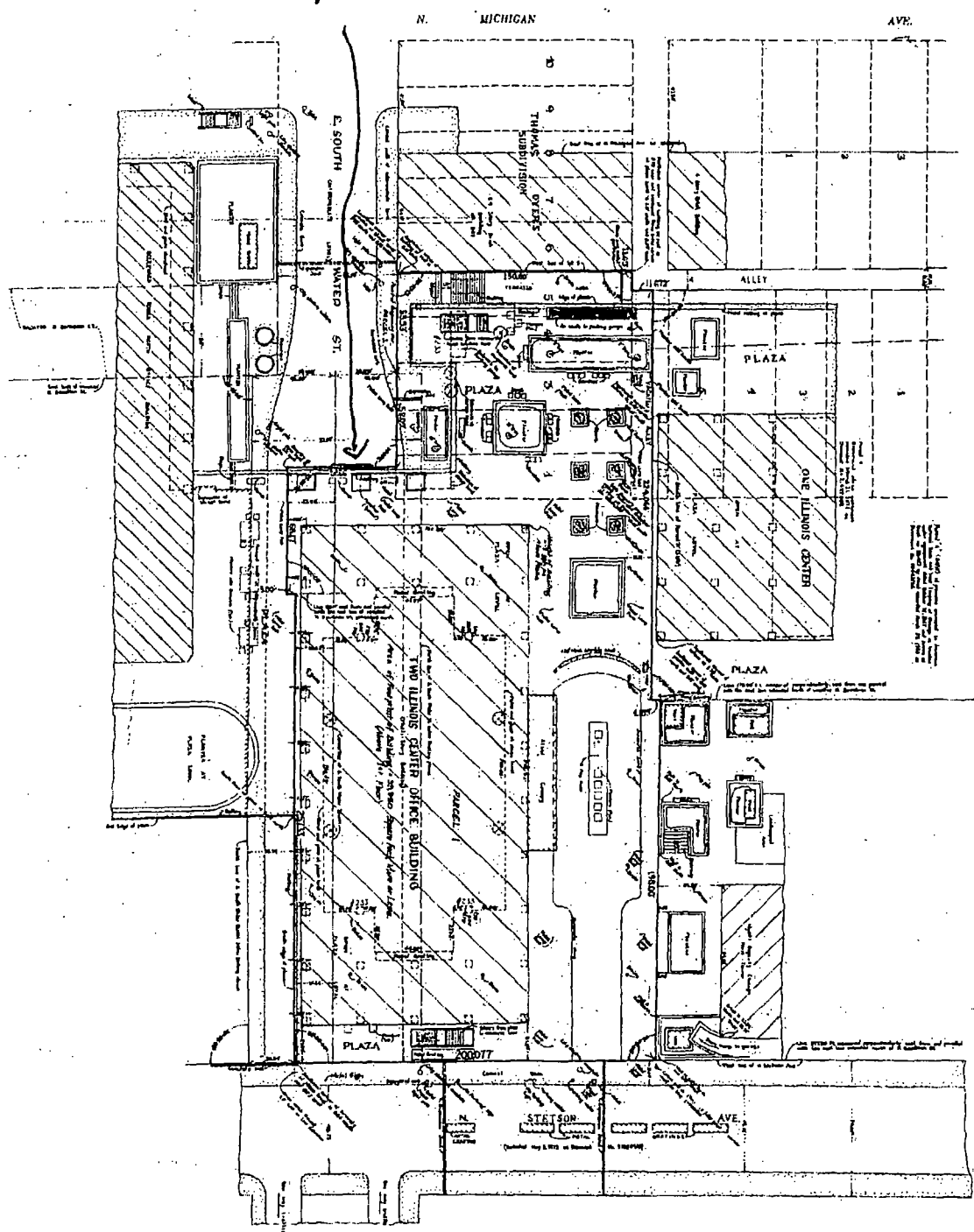

0121201  
SHEET 2 OF 6

By  
CHICAGO GUARANTEE SURVEY COMPANY

**CITY OF CHICAGO  
DEPARTMENT OF ZONING AND LAND USE PLANNING  
SIGN SITE PLAN**

*(ALL INFORMATION MUST BE COMPLETED AND LEGIBLE)*

Site Address: 233 N MICHIGAN AVENUE 1 of 1 applications

Sign Company: PARVIN-CLASS SIGN CO Rep Name: MARY CLASS

Phone (630) 510-2020 EXT          (Below: Building, streets and location of sign on lot or structure)

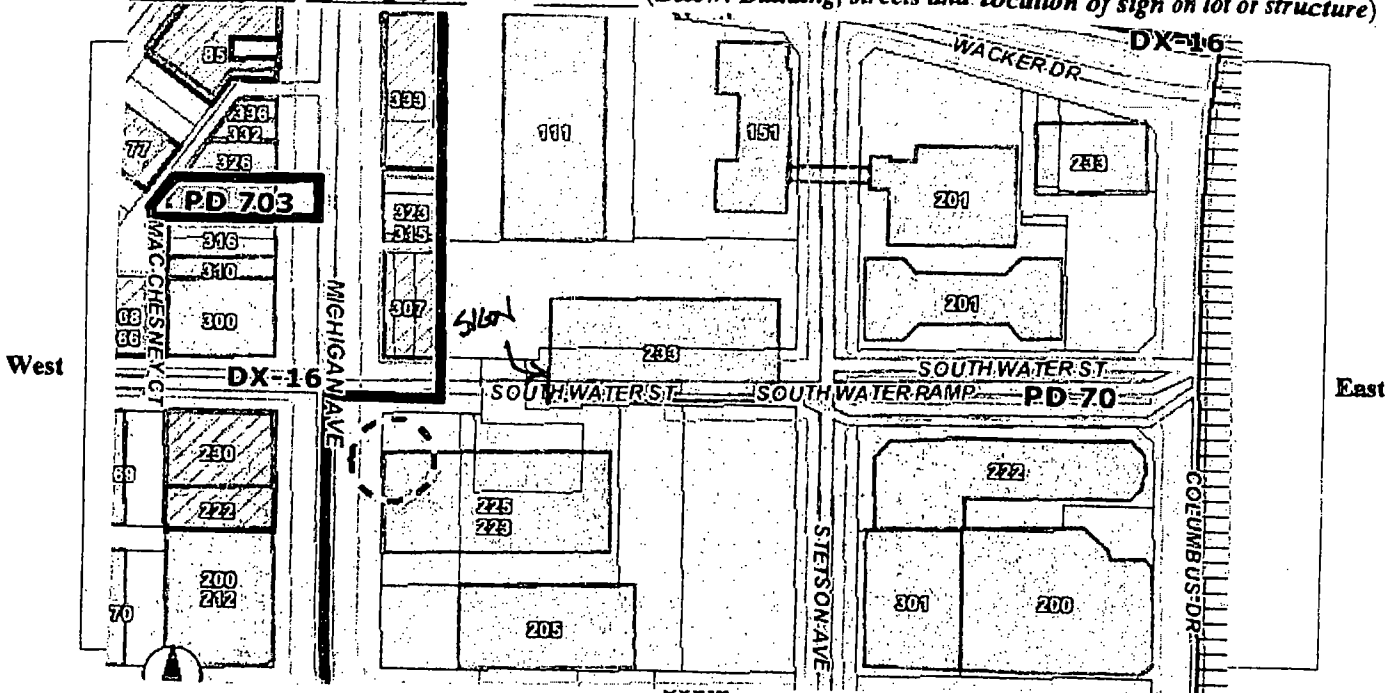

**SIGN USE:**

Bus. ID (On-premise)    
 Business Lice. #

Advertising (Off-premise)

**PERMIT TYPE:**

New Construction    
 Change of Face    
 Previous Permit #

**TYPE OF SIGN:**

- Flat Wall
- Freestanding
- Awning
- Marquee
- High Rise Building
- Projecting Private
- Projecting Public Way
- Public Way Use - Permit #

**SIGN CHARACTERISTICS:**

- Non-Illuminated
- Illuminated
- Changing Image
- Video Display
- Flashing

**DISTANCE FROM:**

- Curb Line: 7'
- Expressway, Toll Roads or Major Route (n/a if over 1000 ft) 1000
- Park (over 10 acres) 1000
- Residential Zone 1000
- Existing Off-premise on same side of street: No

**TOTAL SQUARE FOOTAGE:**

Square footage of this proposed sign 97   
 Gross area of all proposed signs 97   
 Area of all existing signs            
 (not including proposed) on Zoning Lot 0

Signature: Mary Class

Date: 11/25/13