



Office of the Chicago City
Clerk



O2011-10028

Office of the City Clerk

City Council Document Tracking Sheet

Meeting Date:	12/14/2011
Sponsor(s):	Fioretti, Bob (2)
Type:	Ordinance
Title:	Grant(s) of Privilege in Public Way for Panda Express
Committee(s) Assignment:	Committee on Transportation and Public Way

ORDINANCE
PANDA EXPRESS
Acct. No. 298924 - 19
Permit No. 1098594

Be It Ordained by the City Council of the City of Chicago:

SECTION 1. Permission and authority are hereby given and granted to PANDA EXPRESS, upon the terms and subject to the conditions of this ordinance to maintain and use one (1) sign(s) projecting over the public right-of-way attached to its premises known as 515 S. State St..

Said sign structure(s) measures as follows; along S. State:

One (1) at twelve point eight three (12.83) feet in length, three point five (3.5) feet in height and sixteen point five (16.5) feet above grade level.

The location of said privilege shall be as shown on prints kept on file with the Department of Business Affairs and Consumer Protection and the Office of the City Clerk.

Said privilege shall be constructed in accordance with plans and specifications approved by the Department of Transportation (Division of Project Development) and Zoning Department - Signs.

This grant of privilege in the public way shall be subject to the provisions of Section 10-28-015 and all other required provisions of the Municipal Code of Chicago.

The grantee shall pay to the City of Chicago as compensation for the privilege #1098594 herein granted the sum of three hundred (\$300.00) per annum in advance.

A 25% penalty will be added for payments received after due date.

The permit holder agrees to hold the City of Chicago harmless for any damage, relocation or replacement costs associated with damage, relocation or removal of private property caused by the City performing work in the public way.

Authority herein given and granted for a period of five (5) years from and after Date of Passage.

Alderman 
Bob Fioretti 2nd Ward

Sign A		Front Elevation		
Proposed	Height	Width	Area	
Wall Sign	42"	12'-9 3/4"	44.84 sq. ft.	
Allowable This Elevation	50 square feet			
Stop To Grade	20'-4"	Bottom to Grade	16'-10"	

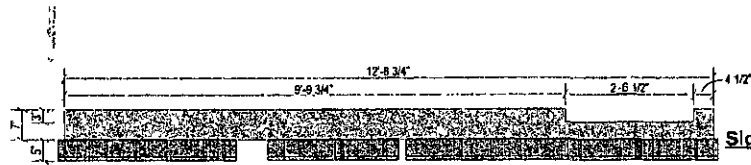

Sign Layout - Top
Scale 1/2" = 1'-0"

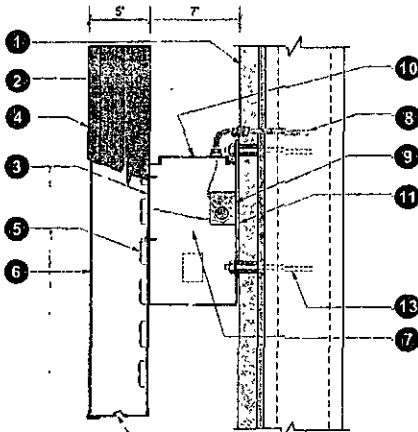

1/2" Drain holes at bottom of letter cans (2) per letter

Section @ LED Logo Raceway
Scale: N.T.S.

Electrical Detail: Channel Letters
JTLED (JT-SLS016R) Red LEDs (2) 60w 12V Transformers Total Amps 0.55

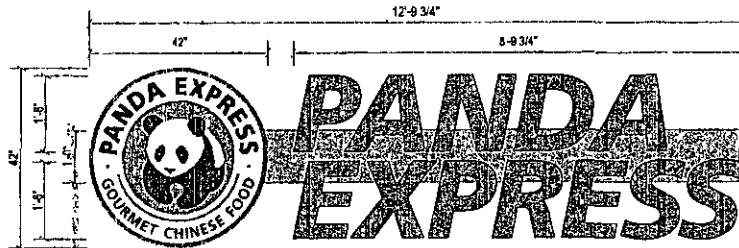



Sign Layout Detail
Scale 1/2" = 1'-0"

Specifications:
1. Existing Facade To be determined
2. 0.040" Aluminum letter returns painted to match Hunter Red
3. 3mm Signabond Lite composite backs (Interior of sign can painted ultra white for maximum illumination)
4. 0.125" x 1" trim cap to match True Red
5. Channel Letters: JT Red LEDs / Logo JT White LEDs
6. Channel Letters: 3/16" Rohm & Haas 2283 Red Acrylic Logo: 3/16" Signifax WDR52 White Acrylic faces with first surface applied vinyl ■ 3M 7725-22 Matte Black ■ 3M 3632-83 Regal Red
7. Waterproof disconnect switch per NEC 600-6
8. Primary electrical feed
9. Transformers
10. 0.060" Aluminum raceway painted to match the facade
11. 15" x 2" x 0.1875" Aluminum mounting tabs welded to raceway - Maximum 6" from each end and every 48" o.c.
12. #12 x 1" TEC screws with 1 1/4" fender washers
13. Mounting hardware to suit

Electrical Detail: Logo
JTLED (JT-SLS016R) Red LEDs (2) 60w 12V Transformers Total Amps 0.55

General Notes:
This sign is to be installed in accordance with the requirements of Article 600 of the National Electrical Code
1) Grounded and bonded per NEC 800.7/NEC 250
2) Existing branch circuit in compliance with NEC 600.5, not to exceed 20 amps
3) Sign is to be UL listed per NEC 600.3
4) UL disconnect switch per NEC 600.5- required per sign component before leaving manufacturer *For multiple signs, a disconnect is permitted but not required for each section

	Client: Panda Express	05042011	Original Rendering	CL	<small>This rendering is the property of Anchor Sign, Inc. It is for the exclusive use of Anchor Sign, Inc. and the party which requested the rendering. It is an unlicensed original drawing and is not to be duplicated, reproduced or exhibited without the consent of Anchor Sign, Inc. Please contact your account manager for questions regarding this statement.</small>
	Site #: PE-2012	07182011	Add Top View Detail	CL	
	Address: 300 South State	07292011	Increase Letter Size, Revise Placement	CL	
	Chicago, IL 60604				
State & Congress					



12/14/2011

Alderman **Bob Fioretti**
Ward # 02
City of Chicago
City Hall, Room 300
121 North LaSalle Street
Chicago, Illinois 60602

Re: An ordinance to use and maintain a portion of the public right-of-way for **one (1) sign(s)** for **PANDA EXPRESS**, adjacent to the premises known as **515 S. State St.**

Dear Alderman **Bob Fioretti**:

The applicant referenced above has requested the use of the public right-of-way for a **sign(s)**. An ordinance has been prepared by the Department of Business Affairs and Consumer Protection – Business Assistance Center - Public Way Use Unit for presentation to the City Council. Because this request was made for properties located in your ward, as approved by you as per the attached, I respectfully request that you introduce the attached ordinance at the next City Council meeting.

If you have any questions regarding this ordinance, please contact Anthony Bertuca at (312) 744-5506.

Department of Business Affairs and Consumer Protection