



# City of Chicago



O2014-6250

Office of the City Clerk

## Document Tracking Sheet

**Meeting Date:** 7/30/2014  
**Sponsor(s):** Reilly (42)  
**Type:** Ordinance  
**Title:** Grant(s) of privilege in public way for Equity Office  
Properties Management Corp. - siamese connections  
**Committee(s) Assignment:** Committee on Transportation and Public Way

ORDINANCE  
EQUITY OFFICE PROPERTIES MANAGEMENT CORP.  
Acct. No. 4856 - 2  
Permit No. 1113768

*Be It Ordained by the City Council of the City of Chicago:*

SECTION 1. Permission and authority are hereby given and granted to EQUITY OFFICE PROPERTIES MANAGEMENT CORP., upon the terms and subject to the conditions of this ordinance to maintain and use, as now constructed, six (6) Siamese Connection(s) projecting over the public right-of-way adjacent to its premises known as 2 N. Riverside Plz..

Said Siamese Connection(s) at N. Canal measure(s):

Two (2) at point three three (.33) feet in length, and one (1) foot in width for a total of point six six (.66) square feet.

Said Siamese Connection(s) at W. Washington measure(s):

Two (2) at point three three (.33) feet in length, and one (1) foot in width for a total of point six six (.66) square feet.

Said Siamese Connection(s) at W. Madison measure(s):

Two (2) at point three three (.33) feet in length, and one (1) foot in width for a total of point six six (.66) square feet.

The location of said privilege shall be as shown on prints kept on file with the Department of Business Affairs and Consumer Protection and the Office of the City Clerk.

Said privilege shall be constructed in accordance with plans and specifications approved by the Department of Transportation (Division of Project Development).

This grant of privilege in the public way shall be subject to the provisions of Section 10-28-015 and all other required provisions of the Municipal Code of Chicago.

The grantee shall pay to the City of Chicago as compensation for the privilege #1113768 herein granted the sum of two thousand four hundred (\$2,400.00) per annum in advance.

A 25% penalty will be added for payments received after due date.

The permit holder agrees to hold the City of Chicago harmless for any damage, relocation or replacement costs associated with damage, relocation or removal of private property caused by the City performing work in the public way.

Authority herein given and granted for a period of five (5) years from and after 07/29/2014.

Alderman \_\_\_\_\_

Brendan Reilly 42nd Ward

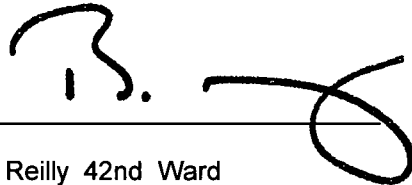

# SOUTH BRANCH OF CHICAGO RIVER

WABJFNDJUN

MADISON

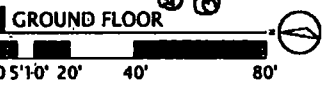
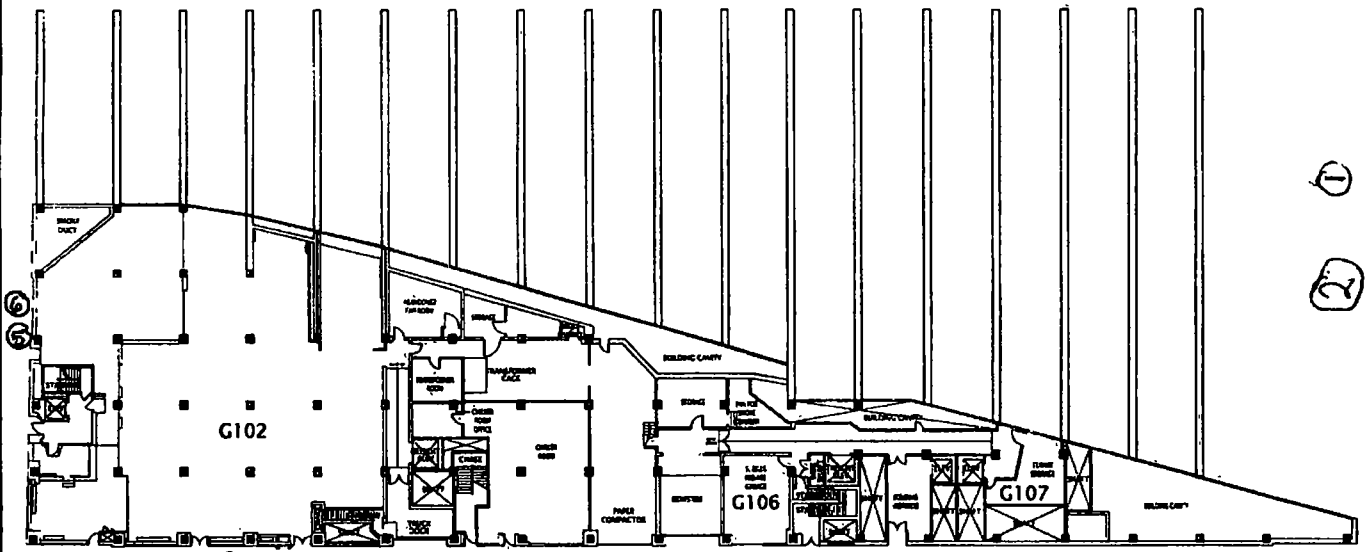

## CANAL



Fitzgerald Earles Architects and Associates  
 1820 W. Hubbard, Suite:320 | Chicago, Illinois 60622  
 312.491.9840 | (F)312.491.9844 | www.feachicago.com

CLIENT: 2. N. RIVERSIDE - GROUND FLOOR RSF: N/A  
 SKETCH NO: LEED PROJECT NO: 10015.04  
 FILE NAME: GD-BASE.DWG DRAWN BY: AIF DATE: 10.26.2011