



Office of the Chicago City
Clerk



O2011-7896

Office of the City Clerk

Tracking Sheet

Meeting Date:	9/8/2011
Sponsor(s):	Fioretti, Bob (2)
Type:	Ordinance
Title:	Issuance of permit(s) for sign(s)/signboard(s) at 1101 W Jackson
Committee(s) Assignment:	Committee on Zoning, Landmarks and Building Standards

Introduced: Sept. 8, 2011

Referred to: Committee on Zoning, Landmarks and Buildings Standards

BE IT ORDAINED BY THE CITY COUNCIL OF THE CITY OF CHICAGO:

SECTION 1. That the Commissioner of Buildings is hereby authorized and directed to issue a sign permit to Western Remac Inc. 1740 Internationale Pkwy Woodridge IL. 60517 for the erection of (2) temporary V sign/signboard over 100 SQF at the new Target site 1101 W. Jackson in the West Loop with the dimensions, height and sq.ft. area:

Dimensions: length 14 feet; height 8 feet

Height Above Grade 7' from bottom of sign

Total Square Foot Area: 112 SQF per face 224 total per sign

Such a sign will comply with all applicable provisions of TITLE 17 of the Chicago Zoning Ordinance and all other applicable provisions of the Municipal Code of the City of Chicago governing the construction and maintenance of outdoor signs, signboards and structures

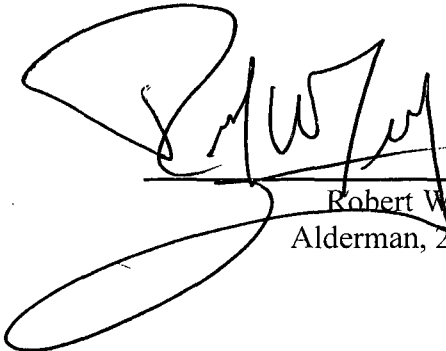

Robert W. Fioretti
Alderman, 2nd Ward



Your Complete Sign Solution Provider™

1740 Internationale Pkwy. (630) 972-7770
Woodridge, IL 60517 fax(630) 972 9680

PROJECT: Target Coming Soon Chicago West Loop

DATE: 8/22/2011

CUSTOMER: Taylor Bros

CONTACT:

SALESPERSON: Mike Burrafato

PHONE:

FAX:

PROD. FILE NAME: target Coming soon Taylor11.FS

DESIGNER: Donna Sassano

CUSTOMER APPROVAL SIGNATURE:

SCALE: 0.021

PROCESS/MATERIALS

- CUT VINYL
- EXTRUDED PANEL
- ROUTED
- DIGITAL
- SILKSCREEN
- WRI DURAGRAPHICS
- OTHER

color names:
Benjamin Moore

Neon Red

CUT VINYL:

- n/r e/g e/c
- egp t/l hip
- d/g3 d/g vip

1st or 2nd surf: 1st
substrate: 1/2" MDO

ROUTED:

substrate:

de-mount:

finish:

mounting:

DIGITAL PRINT:

media:

overlam:

substrate:

1st or 2nd surf

R1, R2, R3

SILKSCREEN

media:

ink:

substrate:

ADA SIGNAGE:

wri-duragraphic:

photopolymer:

other

fonts:

radius:

margin:

border:

mounting

instructions:

Ground Mount (5)
4" x 6" x 20' Post
include stringers

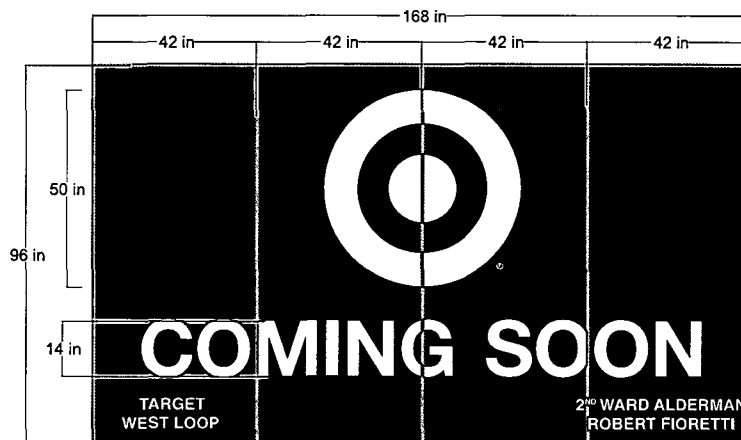
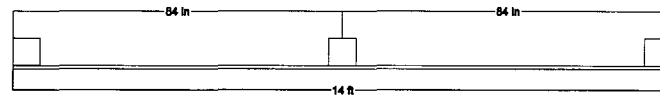
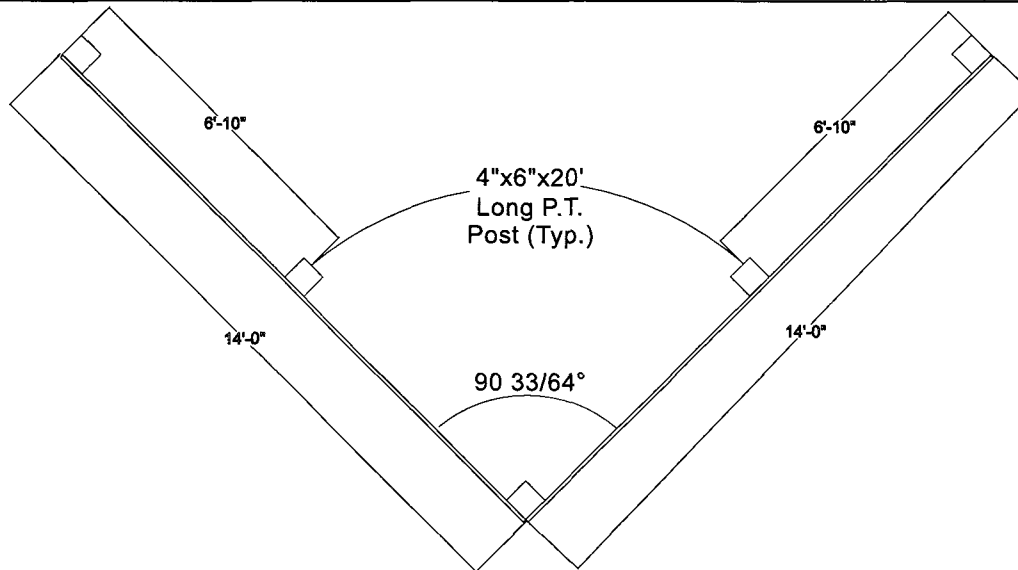

7725-10 White Logo & Text
Background Painted Benjamin Moore Neon Red
Backs & Stringers and
Post Painted Red

2 face

NOTE: INSTALL 7' FROM
BOTTOM OF SIGN TO GROUND

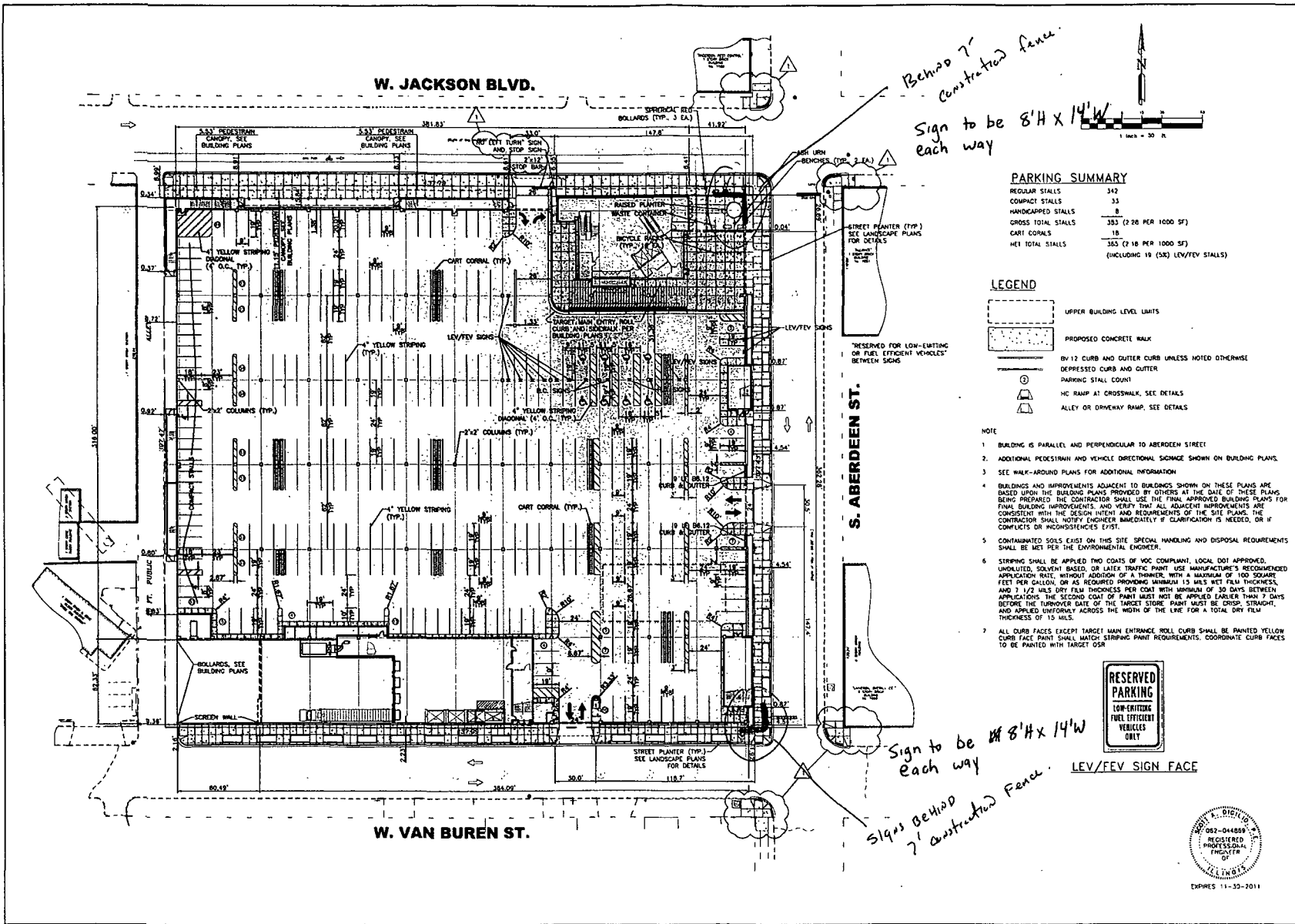

Behind 7' constructed fence.
Sign to be 8'H x 14'W
Each way

PARKING SUMMARY

REGULAR STALLS	342
COMPACT STALLS	33
HANDICAPPED STALLS	8
GROSS TOTAL STALLS	383 (2.28 PER 1000 SF)
CART CORALS	18
NET TOTAL STALLS	365 (2.18 PER 1000 SF)
	(INCLUDING 18 (53) LEV/FEV STALLS)

LEGEND

- UPPER BUILDING LEVEL LIMITS
- PROPOSED CONCRETE WALK
- BY 12 CURB AND OUTER CURB UNLESS NOTED OTHERWISE
- DEPRESSED CURB AND OUTER
- PARKING STALL COUNT
- RAMP AT CROSSWALK, SEE DETAILS
- ALLEY OR DRIVEWAY RAMP, SEE DETAILS

- NOTE**
- BUILDING IS PARALLEL AND PERPENDICULAR TO ABERDEEN STREET
 - ADDITIONAL PEDESTRIAN AND VEHICLE DIRECTIONAL SIGNAGE SHOWN ON BUILDING PLANS
 - SEE WALK-AROUND PLANS FOR ADDITIONAL INFORMATION
 - BUILDINGS AND IMPROVEMENTS ADJACENT TO BUILDINGS SHOWN ON THESE PLANS ARE BASED UPON THE BUILDING PLANS PROVIDED BY OTHERS AT THE DATE OF THESE PLANS. BEING PREPARED THE CONTRACTOR SHALL USE THE FINAL APPROVED BUILDING PLANS FOR FINAL BUILDING IMPROVEMENTS, AND VERIFY THAT ALL ADJACENT IMPROVEMENTS ARE CONSISTENT WITH THE DESIGN INTENT AND REQUIREMENTS OF THE SITE PLANS. THE CONTRACTOR SHALL NOTIFY ENGINEER IMMEDIATELY IF CLARIFICATION IS NEEDED, OR IF CONFLICTS OR INCONSISTENCIES EXIST.
 - CONTAMINATED SOILS EXIST ON THIS SITE. SPECIAL HANDLING AND DISPOSAL REQUIREMENTS SHALL BE MET PER THE ENVIRONMENTAL ENGINEER.
 - STRIPING SHALL BE APPLIED TWO COATS OF VOC COMPLIANT, LOCAL DOT APPROVED, UNDILUTED, SOLVENT BASED, OR LATEX TRAFFIC PAINT USE MANUFACTURER'S RECOMMENDED APPLICATION RATE, WITHOUT ADDITION OF A THINNER, WITH A MAXIMUM OF 100 SQUARE FEET PER GALLON, OR AS REQUIRED PROVIDING MINIMUM 1.5 MILS NET FILM THICKNESS, AND 1 1/2 MILS DRY FILM THICKNESS PER COAT WITH MINIMUM OF 30 DAYS BETWEEN APPLICATIONS. THE SECOND COAT OF PAINT MUST NOT BE APPLIED EARLIER THAN 7 DAYS BEFORE THE TURNOVER DATE OF THE TARGET STORE. PAINT MUST BE CRISP, STRAIGHT, AND APPLIED UNIFORMLY ACROSS THE WIDTH OF THE LINE FOR A TYPICAL DRY FILM THICKNESS OF 1.5 MILS.
 - ALL CURB FACES EXCEPT TARGET MAIN ENTRANCE ROLL CURB SHALL BE PAINTED YELLOW CURB FACE PAINT SHALL MATCH STRIPING PAINT REQUIREMENTS. COORDINATE CURB FACES TO BE PAINTED WITH TARGET OSR



Sign to be 8'H x 14'W
Signs behind 7' constructed fence.

LEV/FEV SIGN FACE



APPLIED
 715 ROOSEVELT UNIVERSITY CENTER
 1810 N. JACKSON BLDG.
 CHICAGO, ILLINOIS 60614
 (312) 514-2000 (PHONE)
 (312) 578-0702 (FAX)
 (312) 514-2001 (FAX)

SITE LAYOUT PLAN

PROJECT NAME: CHICAGO WEST LOOP TARGET STORE
 PROJECT No: 1860
 SHEET No: C4
 EXPIRES 11-30-2011

PERMIT SET