



City of Chicago



Or2016-410

Office of the City Clerk

Document Tracking Sheet

Meeting Date:	7/20/2016
Sponsor(s):	Waguespack (32)
Type:	Order
Title:	Issuance of permits for sign(s)/signboard(s) at 3128 N Ashland Ave - 98 square feet
Committee(s) Assignment:	Committee on Zoning, Landmarks and Building Standards

City Council
Meeting Date: 7/20/16
Committee on Buildings

(signs)

ORDERED, That the Commissioner of Buildings is hereby directed to
issue a sign permit to: (Contractor's name and address)

MODERN SIGNS INC.
1727 ARMITAGE CT
ADDISON IL 60101

for the erection of a sign / signboard over 24 feet in height and / or over 100
square feet (in area of one face) at: (Business NAME & ADDRESS)

XFINITY
3128 N. ASHLAND AVE
CHICAGO IL 60657

Dimensions: Length 17'4" Height 5'8"

Height above grade / roof to top of sign 32'

TOTAL SQUARE FOOT AREA 98

Such sign(s) shall comply with all applicable provisions of TITLE 17 of the
Chicago Zoning Ordinance and all other applicable provisions of the Municipal
Code of the City of Chicago governing the construction and maintenance of
outdoor signs, signboards and structures.

Alderman, 32 Ward



CITY OF CHICAGO

DEPARTMENT OF BUILDINGS

Aldermanic Acknowledgment Letter

TO: Department of Buildings
121 North LaSalle Street, Room 900
Chicago, IL 60602

DATE: _____, 20____

I am aware of the application for a building permit at the following address. I have no objection to its issuance.

Address: 3128 N. ASHLAND AVE 60657

Date of Application: 6/23/16

Type of Permit: SIGN

Signed: 

Ward: 32

Telephone: (773) 248-1230

(Alderman's full name, printed or typed)





Sign Permit Application

APPROVAL NUMBER	APPLICATION NUMBER 100656766	ANNUAL FEE	WORK CODE	DRAWINGS ATTACHED <input type="checkbox"/> YES <input type="checkbox"/> NO
DATE OF APPLICATION 06/23/2016		TYPE OF SIGN FLAT OR BOX		
ADDRESS OF SIGN 3128 N ASHLAND AVE, 60657-		LENGTH 17 FT	IN. 4	HEIGHT 5 FT
BUILDING	ORIGINAL PERMIT NUMBER	AREA 98 SQ FT	WEIGHT 100 LBS	IN. 8
TYPE OF PERMIT NEW CONSTRUCTION (SIGN)		SIGN HEIGHT ABOVE GRADE/ROOF 26 FT		
PAYER OF ANNUAL INSPECTION SCHAFFELD, FRANK 1500 MCCONNER PKWY SCHAUMBURG, IL 60173 (847)789-1343		SHAPE OF SIGN IRREGULAR		
SIGN MANUFACTURER ADVANCED SIGN GROUP		SIGN WILL READ XFINITY		
ADDRESS WHERE SIGN CAN BE SEEN PRIOR TO ERECTION		NO. OF LAMPS 1	TOTAL WATTAGE 100	
TICKET NUMBER 0		TYPE OF LAMP OTHER		
REINSPECTION CONTROL NUMBER		NO. OF BALLAST/TRANSFORMERS 1	INPUT OF TRANSFORMERS 120	
TYPE OF SUPPORT FOR SIGN BUILDING		CONTRACTOR WILL INSTALL <input checked="" type="checkbox"/> FEEDERS <input checked="" type="checkbox"/> CUSTOMER LEADS		
SIGN BOARD SUPPORT MEMBERS STEEL		TYPE OF SWITCH SPECIAL		
ANNUAL FEE		LOCATION OF SWITCH LISTED FLUSH TOGGLE		
CONSTRUCTION FEE 300.00		SIGN LOCATION INSTALL ILLUMINATED CHANNEL LETTER WALL SIGN FACING EAST OVER PRIVATE PROPERTY. SWITCH IS PART OF UL SIGN.		
1017 B FEE				
TOTAL FEE 300.00				
AMOUNT PAID 200.00				
BALANCE DUE \$ 100.00				

The undersigned certifies that the statements in this application are true and correct and that all work done under the proposed permit will conform to the requirements of the Chicago Municipal Code.

REG. NO. E94792	BOND NO.	REG. NO. N93883
ELECT CONTR MODERN SIGNS, INC.	SIGN TECTOR MODERN SIGNS INC	SIGNER
ADDRESS 1727 ARMITAGE COURT ADDISON, IL 60101	ADDRESS 1727 ARMITAGE CT ADDISON IL, 60101-	
SUPERVISOR SIGNATURE <i>William T. Leahy</i>	SIGNATURE <i>[Signature]</i>	

The permit issued on this application will authorize only signs here applied for. If other signs are to be erected they must be covered by additional permits.

City of Chicago
Rahm Emanuel, Mayor



Department of Buildings
Judith Frydland, Commissioner

TYPE OF BUSINESS
COMMERCIAL Other: **RETAIL**
 Name: **XFINITY**
 LIC #:
 Renewal Date:

SIGN BOND REQUIRED? YES
 COUNCIL ORDER REQUIRED YES
 IS SPECIAL PERMISSION REQUIRED FROM CHIEF ELECTRICAL
 YES

Projects Over:
 Private Property
 Public Way Grant Permit #:
 Planned Development/Manufacturing PMD/PD#:
 Zoning District: **B3** Other: **B3-3**

IF YES, ATTACH LETTER OF REQUEST
 TIME STAMP

TYPE OF SIGN:
 ADVERTISING ILLUMINATE MOVEABLE
 BUSINESS FLASHING

TOTAL STREET FRONTAGE OF LOT (IN FEET) 150
 TOTAL AREA OF NEW SIGN (SQ.FT.) 98
 TOTAL AREA OF ALL SIGNS ON LOT (SQ.FT.) 284
 HEIGHT OF SIGN ABOVE GRADE (TO TOP) 31ft 8in

DISTANCE OF CURB LINE OUTER EDGE (ft) 13
 DISTANCE OF STRUCTURE INNER EDGE (ft) 14

SIGN CLERK APPROVED FOR PERMIT

DISTANCE FROM (ft):
 A. PUBLIC PARK (OVER 10 ACRES) 500
 B. EXPRESSWAY (IF LESS THAN 1,000 FT.) 1,000
 C. RESIDENCE DISTRICT (ADVERTISING SIGNS ONLY) 50

REMARKS

IF REPLACEMENT SIGN OR CHANGE OF FACE, WHAT DOES THE EXISTING SIGN READ?
 Original Payee:

Landmark Hold: Status:

ZONING (OFFICE USE ONLY)

Expediter: _____
 Address: _____ License #: _____
 Phone #: _____ Mobile #: _____ Email: _____
 Website: _____

Section 3 - Sign and Structure Details

(Please check all that apply)

Sign Category:

On-Premise (Business ID): Dynamic Static

Business License # of Tenant Business: _____

Off-Premise (Advertising): Dynamic Static

Temporary: Special Event:

Sign will read (Please provide a description, picture and shop drawing): XFINITY

Type of sign (Mark all that apply):

- Awning Canopy Freestanding Marquee Projecting Dynamic Image Display
 Wall Painted Cabinet/Frame Vinyl Projected image Flashing
 High Rise Building Hotel/Hospitals Other buildings: _____

What is the dimension of the wall on which the sign will be installed? 34' ↑ x 85' →

Where is sign or sign structure mounted? Inside the building Outside the building

Is the sign or sign structure attached to a building or wall? Yes No If yes, which wall of building? N E S W

Is this a freestanding sign? Yes No Location of sign on lot: N E S W

Which direction does sign copy face? N E S W

Does any portion of the sign, sign structure or attachments cover, obscure or obstruct an existing window in a residential unit whether occupied or not? Yes No

Does any portion of the sign, sign structure, or attachments extend on or over the public way? Yes No

If yes, what is the public way use permit number? _____

Sign Panels: Back to back within 30 degrees of parallel Yes No

Number of Faces: 1

Sign Support Structure: Pole Roof Ground Building Windows Other: _____

Does any portion of the sign or sign structure extend 24 inches above the roof line as defined in 17-17-02149 of the Municipal Code of Chicago? Yes No

Picture or rendering must be attached depicting sign placement with before and after view.

Section 3 continues on next page

Section 3 continued

Dimensions of Sign Structure (i.e. cabinet, frame, awning, canopy)

Length: 17 Feet 4 Inches Height: 5 Feet 8 Inches Depth: _____ Feet 6 1/2 Inches
 Area: 98 Sq Ft. Weight: 100 lbs.
 Shape of Sign: IRREGULAR

Sign Height above Grade:

From Grade to Bottom of sign or sign structure, whichever is lowest: 26 Ft.
 From Grade to Top of sign or sign structure, whichever is highest: 32 Ft.

Is City Council Order required?* Yes No

*All signs in excess of 100 Square Feet in area OR in excess of 24 feet above grade require a City Council Order pursuant to Section 13-20-680 of the Municipal Code of Chicago

Dimension of Sign Elements pursuant to Section 17-12-0601 of the Chicago Zoning Ordinance:

Length: _____ Feet _____ Inches Height: _____ Feet _____ inches Area: _____ Sq Ft.

Electrical Contractor will install: Feeders: Yes No Customer Leads: Yes No

Number of Lamps: 1 Total Wattage: 100 Type of Lamp: LED

Number of Ballast/Transformers: 1 Input of Transformers: 120

Type of Switch: SPECIAL Location of Switch: LISTED FLUSH TOGGLE

Static: Yes No

Illuminated: Yes No

If yes - External _____ Internal

Dynamic Image Display: Yes No

An affidavit of compliance is required for all dynamic image display signs pursuant to Section 13-20-675(d)(2) of the Municipal Code of Chicago.

Max Nits _____ Max Foot Candles _____ Message Time (Screen Hold): _____ seconds

Self Dimming Capability: Yes No

What is the total of the sign face area devoted to dynamic image display? _____ Sq Ft.

Section 4 - Zoning Information

Zoning District or Planned Development #: B3-3

Is sign located in a special sign district? Yes No

If yes: Michigan Avenue Corridor Oak Street Corridor State Street/Wabash Avenue Corridor

Frontal Street frontage of Zoning Lot: 150 (FL)

Frontal Area of new sign: 98 (Sq Ft.) Gross Area of all proposed signs: 284 (Sq Ft.)

Frontal Area of all existing signs on Zoning Lot: 0 (Sq Ft.) ANY PREVIOUS SIGNAGE BEING REMOVED

Picture or rendering must be attached depicting sign placement with before and after view.

Section 4 continues on next page

Section 4 continued

Distance from outer edge of sign or structure to curb line: 13 (Ft.)
 Distance from inner edge of sign or sign structure to curb line: 14 (Ft.)
 Distance from:
 Public Park 10 acres or more: + 500 (Ft.)
 Public Park 2 acres or more: _____ (Ft.)
 Expressway or Toll Road: + 1000 (Ft.)
 Lake Shore Drive: _____ (Ft.)
 Michigan Avenue (Oak St. to Roosevelt Rd.): _____ (Ft.)
 Residential District: + 50 (Ft.)
 Residential building in a D district: _____ (Ft.)
 Existing off-premise/advertising signs on same side of street? Yes No
 In a B or C District: _____ (Ft.)
 In a D or M District: _____ (Ft.)
 Waterways: _____ (Ft.)

Section 5 - Sign Permit History

Does the proposed sign, change, alter or replace an existing sign? Yes No
 If yes, were permits issued for the sign being replaced, changed or altered? Yes No
 If yes, please list each permit number and date each permit was issued:

Permit Number: _____ Date issued: _____
 Permit Number: _____ Date issued: _____
 Permit Number: _____ Date issued: _____
 Permit Number: _____ Date issued: _____

Does the proposed sign change a static sign to a dynamic image display sign? Yes No
 Does the proposed sign change or alter the square footage or the height of the sign or sign structure? Yes No
 Does the proposed sign change an on-premise sign to an off-premise/advertising sign? Yes No

Section 6 - Attestation and Signatures

I, the undersigned, under penalty of perjury, do hereby affirm and attest that the above information is true, complete, and correct and I acknowledge that incorrect information is grounds to revoke or rescind a permit.

Owner of Real Property: Charles Monahan Date 6/23/16
 Addressee of Real Property: Frank Sheffield Date 6/23/16

Inspector: _____ Date _____
 Supervising Electrician: William J. Leahy Date 6/23/16
 Sign Erector: [Signature] Date 6/23/16

Picture or rendering must be attached depicting sign placement with before and after view.

For Office Use

ZONING	PUBLIC WAY

Sign Review Fee:

Zoning Review Fee: \$ _____ Total Fee: \$ _____

Amount Paid: \$ _____ Balance Due: \$ _____

PERMIT IS VALID FOR A PERIOD OF FIVE YEARS AFTER ISSUANCE. IT IS SOLELY THE RESPONSIBILITY OF THE OWNER OR LESSEE TO FILE FOR RENEWAL

* Once zoning fee is paid, this application is valid for a period of up to six months from payment date.

Applies to sign permits applied for on or after April 2, 2014.

City of Chicago
Mayor Rahm Emanuel



Department of Buildings
Felicia Davis, Commissioner

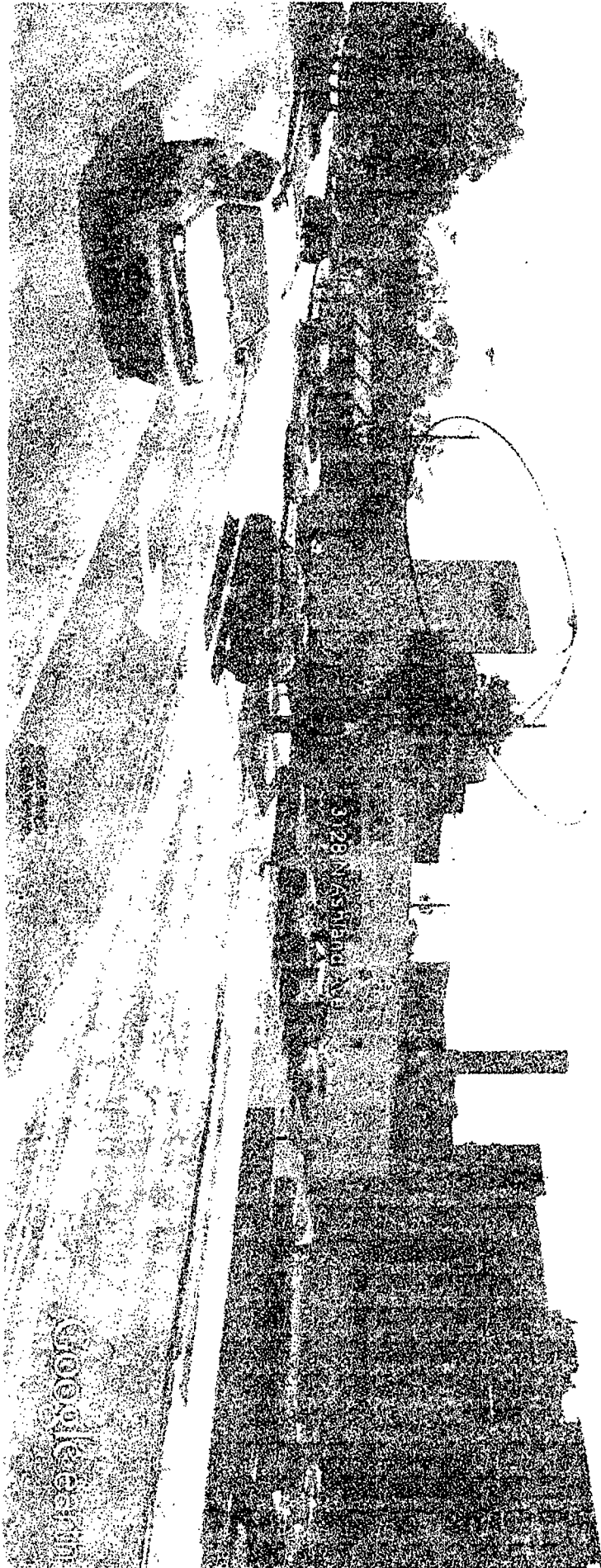

31281 Ashland Ave

Google Earth

Google Earth

feet
meters

20

7



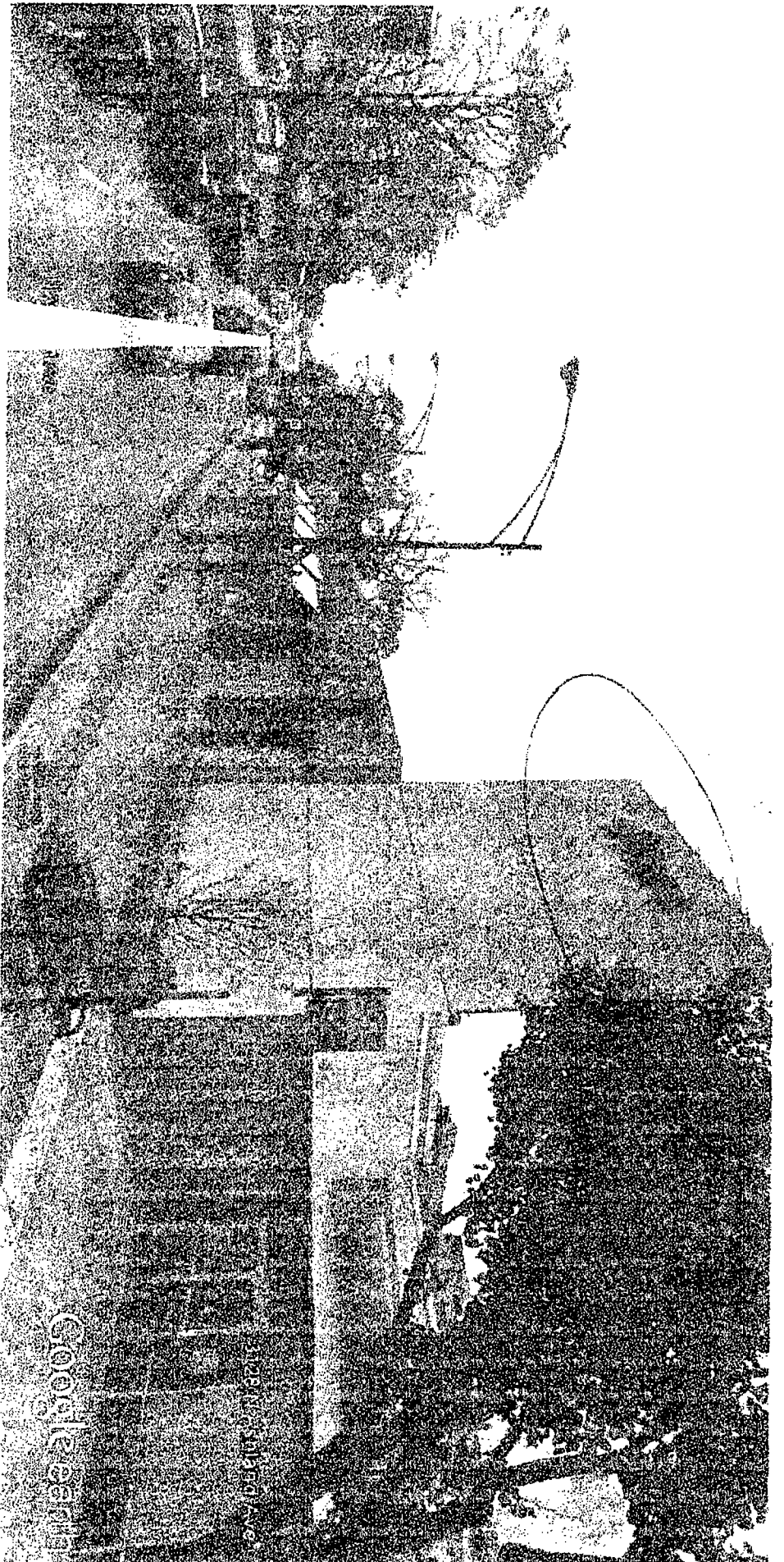

Google earth

feet
meters



Google earth



Zoning Map

Created on: 6/23/2016 11:34 A.M.

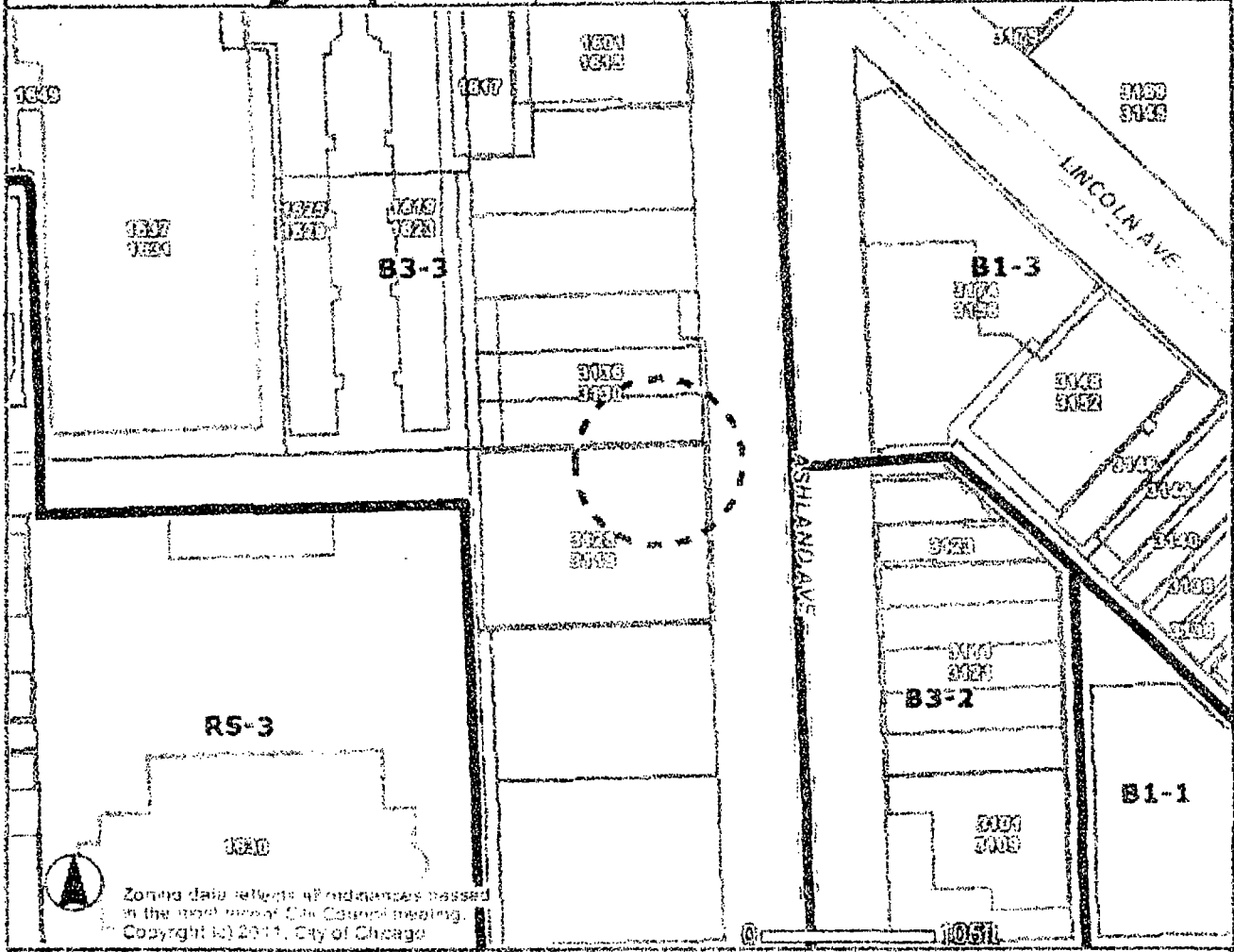

Zoning data reflects all ordinances passed in the last year of City Council meeting.
Copyright (c) 2011, City of Chicago

Addresses

3128 N ASHLAND AVE

Zoning

- Business
- Commercial
- Manufacturing
- Residential
- Planned Development
- Planned Manufacturing
- Downtown Core
- Downtown Service
- Downtown Mixed
- Downtown Residential
- Transportation
- Parks & Open Space
- Zoning Boundaries

Historic Preservation

- CHICAGO LANDMARKS**
- Chicago Landmarks
 - Landmark Districts
- Chicago Historic Resources Survey - Buildings subject to Demolition-Delay Ordinance**
- Red
 - Orange
- Water
- Cemetery
- Municipalities

Lakelfront

- Pedestrian Streets
- Buildings
- Parcels
- Streets
- Curbs
- Forest Preserve
- City Boundary

Information provided on the City of Chicago web site should not be used as a substitute for legal, accounting, real estate, business, tax, or other professional advice. The City of Chicago assumes no liability for any damages or loss of any kind that might arise from the use of, misuse of, or the inability to use the City web site and/or the materials contained on the web site. The City of Chicago also assumes no liability for improper or incorrect use of materials or information contained on its web site. All materials that appear on the City of Chicago web site are distributed and transmitted as is, without warranties of any kind, either express or implied, and subject to the terms and conditions stated in this disclaimer.

