



# Office of the City Clerk



Or2012-419

Office of the City Clerk

## City Council Document Tracking Sheet

<b>Meeting Date:</b>	7/25/2012
<b>Sponsor(s):</b>	Waguespack, Scott (32)
<b>Type:</b>	Order
<b>Title:</b>	Issuance of permits for sign(s)/signboard(s) at 1415 N Kingsbury St
<b>Committee(s) Assignment:</b>	Committee on Zoning, Landmarks and Building Standards

(signs)

ORDERED, That the Commissioner on Buildings is hereby directed to issue a sign permit to—

Doyle Signs, Inc.  
232 W Interstate Rd.  
Addison, IL 60101

For the erection of a sign/signboard over 24 feet in height and/or over 100 square feet (in area of one face) at

Buy Buy Baby  
1415 N. Kingsbury St.  
Chicago, IL 60640

Dimensions: Length: 22' Height: 11'

Height above grade/roof to top of sign: 22'

TOTAL SQUARE FOOT AREA: 242

Such sign shall comply with all applicable provisions of Title 17 of the Chicago Zoning Ordinance and all other applicable provisions of the Municipal Code of the City of Chicago governing the construction and maintenance of outdoor signs, signboards and structures.

  
\_\_\_\_\_  
Scott Waguespack  
Alderman, 32nd Ward

**CITY OF CHICAGO**  
**DEPARTMENT OF BUILDINGS**  
**Sign Permit Application**

APPROVAL NUMBER	APPLICATION NUMBER 100432010	ANNUAL FEE	WORK CODE	DRAWINGS ATTACHED <input type="checkbox"/> YES <input checked="" type="checkbox"/> NO
DATE OF APPLICATION 03/16/2012		TYPE OF SIGN FLAT OR BOX		
ADDRESS OF SIGN 1415 N KINGSBURY ST, 60642-		LENGTH 22	IN 0	HEIGHT 11
BUILDING	ORIGINAL PERMIT NUMBER	AREA 242	WIDTH	LBX 500
TYPE OF PERMIT NEW CONSTRUCTION (SIGN)		SIGN HEIGHT ABOVE GRADE/ROOF FT. 22		
PAYER OF ANNUAL INSPECTION BUY BUY BABY, BUY BUY BABY 1415 N KINGSBURY ST CHICAGO, IL 60642 (630)543-9490		SHAPE OF SIGN REGULAR		
SIGN MANUFACTURER DOYLE SIGNS, INC		SIGN WILL BE ILLUMINATED BUY BUY BABY		
ADDRESS WHERE SIGN CAN BE SEEN PRIOR TO ERECTION		NO OF LAMPS 20	TOTAL WATTAGE 940	
TICKET NUMBER 0		TYPE OF LAMP OTHER		
REINSPECTION CONTROL NUMBER <i>031106</i>		NO OF BALLAST/TRANSFORMERS 3	INPUT OF TRANSFORMERS 120	
TYPE OF SUPPORT FOR SIGN BUILDING		CONTRACTOR WILL INSTALL <input checked="" type="checkbox"/> YES <input type="checkbox"/> NO CUSTOMER LEADS		
SIGN BOARD SUPPORT MEMBER NONE		TYPE OF SWITCH SPECIAL		
ANNUAL FEE		LOCATION OF SWITCH LISTED FLUSH TOGGLE		
CONSTRUCTION FEE 700.00		SIGN LOCATION INSTALLATION OF (1) SET OF INTERNALLY ILLUMINATED CHANNEL LETTERS TO BE MOUNTED TO THE WEST ELEVATION TO READ "BUY BUY BABY"		
1017 B FEE		Check # for Zoning		
TOTAL FEE 700.00		Check # for DCAP		
AMOUNT PAID 200.00				
BALANCE DUE \$ 500.00				

The undersigned certify that the statements in this application are true and correct and that all work done under the proposed permit will conform to the requirements of the Chicago Municipal Code

ISSUE NO	E92684	BOND NO <i>031106906</i>	REF NO	E92684
ISSUE CONTR	DOYLE SIGNS INC	SIGN ERECTOR	DOYLE SIGNS INC	
ADDRESS	232 INTERSTATE RD - P.O. BOX 1068 ADDISON, IL 60101-		SIGNER	
SUPERVISOR SIGNATURE			SIGNATURE	

The permit issued on this application will authorize only signs here applied for. If other signs are to be erected they must be covered by additional permits

City of Chicago  
 Rahm Emanuel, Mayor



Department of Buildings  
 Michael Merchant, Commissioner

TYPE OF BUSINESS <b>COMMERCIAL</b> Other: _____ Name: _____ LIC #: _____ Renewal Date: _____	SIGN BOND REQUIRED? <input type="checkbox"/> YES COUNCIL ORDER REQUIRED <input checked="" type="checkbox"/> YES IS SPECIAL PERMISSION REQUIRED FROM CHIEF ELECTRICAL <input type="checkbox"/> YES IF YES, ATTACH LETTER OF REQUEST
Projects Over: <input checked="" type="checkbox"/> Private Property <input checked="" type="checkbox"/> Public Way Grant Permit #: _____ <input type="checkbox"/> Planned Development/Manufacturing PMD/PD#: _____ Zoning District: <b>C3</b> Other: <b>C3-5</b>	TIME STAMP
TYPE OF SIGN: <input type="checkbox"/> ADVERTISING <input checked="" type="checkbox"/> ILLUMINATE <input type="checkbox"/> MOVEABLE <input checked="" type="checkbox"/> BUSINESS <input type="checkbox"/> FLASHING	
TOTAL STREET FRONTAGE OF LOT (IN FEET) _____ 240 TOTAL AREA OF NEW SIGN (SQ.FT.) _____ 242 TOTAL AREA OF ALL SIGNS ON LOT (SQ.FT.) _____ 315 HEIGHT OF SIGN ABOVE GRADE (TO TOP) _____ 33ft 0in	
DISTANCE OF CURB LINE OUTER EDGE (ft) _____ 35 DISTANCE OF STRUCTURE INNER EDGE (ft) _____ 35	SIGN CLERK _____ APPROVED FOR PERMIT _____
DISTANCE FROM (ft): A. PUBLIC PARK (OVER 10 ACRES) _____ 910 B. EXPRESSWAY (IF LESS THAN 1,000 FT.) _____ 490 C. RESIDENCE DISTRICT (ADVERTISING SIGNS ONLY) _____ 948	REMARKS
IF REPLACEMENT SIGN OR CHANGE OF FACE, WHAT DOES THE EXISTING SIGN READ?  Original Payee: _____	
Landmark Hold: <input type="checkbox"/> Status: _____	
ZONING (OFFICE USE ONLY)	

CITY OF CHICAGO  
DEPARTMENT OF ZONING AND LAND USE PLANNING  
SIGN SITE PLAN  
(ALL INFORMATION MUST BE COMPLETED AND LEGIBLE)

Site Address: 1415 N. Kingsbury St of 4 application:

Sign Company: Doyle Signs Inc. Rep Name: Lisa Neal

Phone (630) 543-9490 EXT 28 (Below: Building, streets and location of sign on lot or structure)

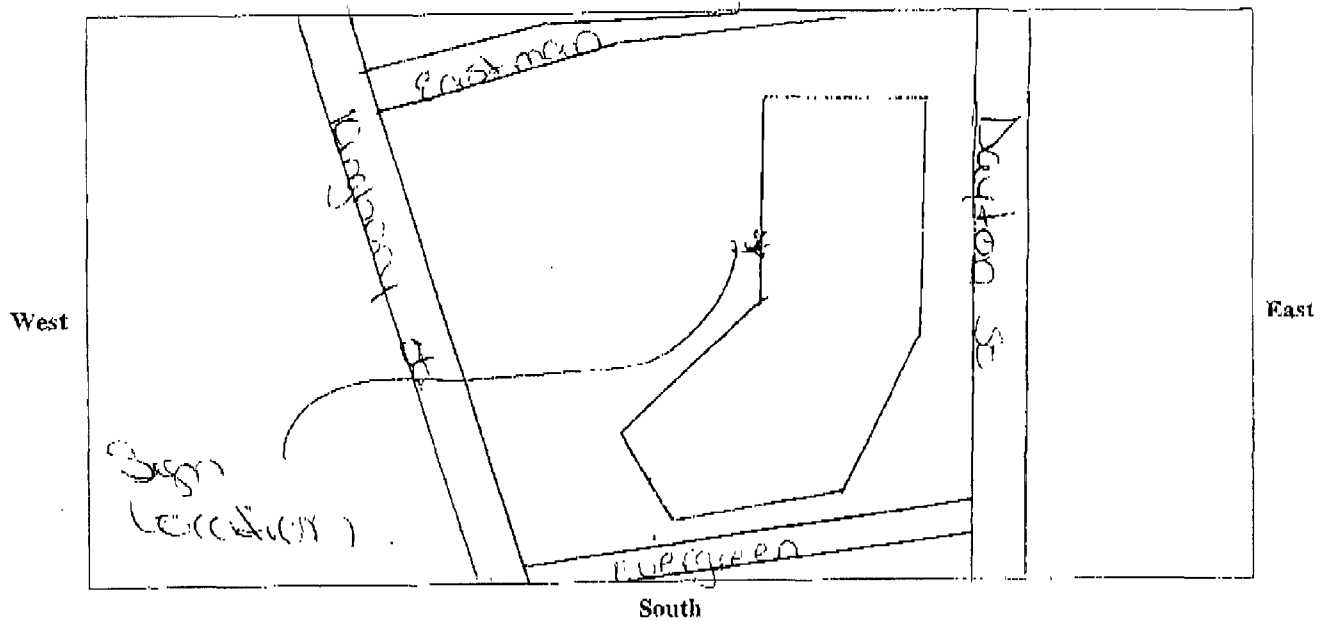

**SIGN USE:**  
Bus. ID (On-premise)   
**Business Lice. #**  
Advertising (Off-premise)

**TYPE OF SIGN:**  
Flat Wall   
Freestanding   
Awning   
Marquee   
High Rise Building   
Projecting Private   
Projecting Public Way   
**Public Way Use -Permit #**

**SIGN CHARACTERISTICS:**  
Non-Illuminated   
Illuminated   
Changing Image   
Video Display   
Flashing

**PERMIT TYPE:**  
New Construction   
Change of Face   
**Previous Permit #**

**DISTANCE FROM:**  
Curb Line: 35  
Expressway, Toll Roads  
or Major Route  
(n/a if over 1000 ft) 490  
Park (over 10 acres) 710  
Residential Zone 948  
Existing Off-premise on  
same side of street: 171A

**TOTAL SQUARE FOOTAGE:**  
Square footage of this proposed sign 242  
Gross area of all proposed signs 315  
Area of all existing signs  
(not including proposed) on Zoning Lot 0

Signature: Lisa Neal

Date: 3/2/12

(Revised 4/10)

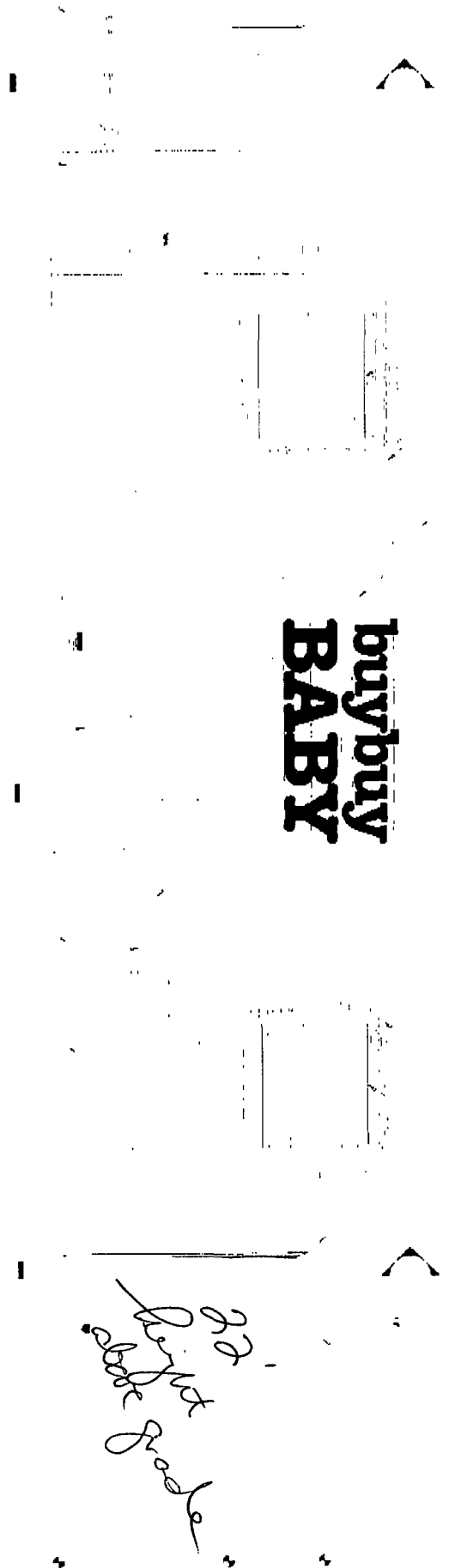



**buybuy**  
**BABY**

*Pl. height above grade*