



Office of the Chicago City  
Clerk



O2011-5687

Office of the City Clerk

City Council Document Tracking Sheet

<b>Meeting Date:</b>	7/6/2011
<b>Sponsor(s):</b>	Burns, William D. (4)
<b>Type:</b>	Ordinance
<b>Title:</b>	Zoning Reclassification Map No. 12-D
<b>Committee(s) Assignment:</b>	Committee on Zoning, Landmarks and Building Standards

**ORDINANCE**

***BE IT ORDAINED BY THE CITY COUNCIL OF THE CITY OF CHICAGO:***

**SECTION 1.** Title 17 of the Municipal Code of Chicago, the Chicago Zoning Ordinance, is hereby amended by changing all the POS-1 Regional or Community Park District symbols and indications as shown on Map No. 12-D in the area bounded by

East 49<sup>th</sup> Street; South Kenwood Avenue or the center line thereof if extended where no street exists; East 50<sup>th</sup> Street; and a line 129.38' east of and parallel to South Kimbark Avenue

to those of a RS-1 Residential Single-Unit (Detached House) District and a corresponding uses district is hereby established in the area above described.

**SECTION 2.** This ordinance shall be in force and effect from and after its passage and due publication.

Common address of property:            1330 East 50<sup>th</sup> Street (1314-30 East 50<sup>th</sup> Street; 4900-58 South Kenwood Avenue; and 1315-29 East 49<sup>th</sup> Street)

Shoesmith Elementary School

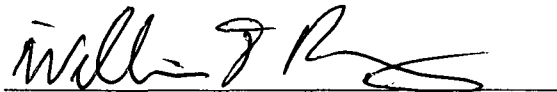

William Bums  
Alderman, 4<sup>th</sup> Ward

# Bing Maps

1330 E 50th St, Chicago, IL 60615-2992

My Notes

Shoesmith

FREE! Use Bing 411 to find movies, businesses & more: 800-BING-411

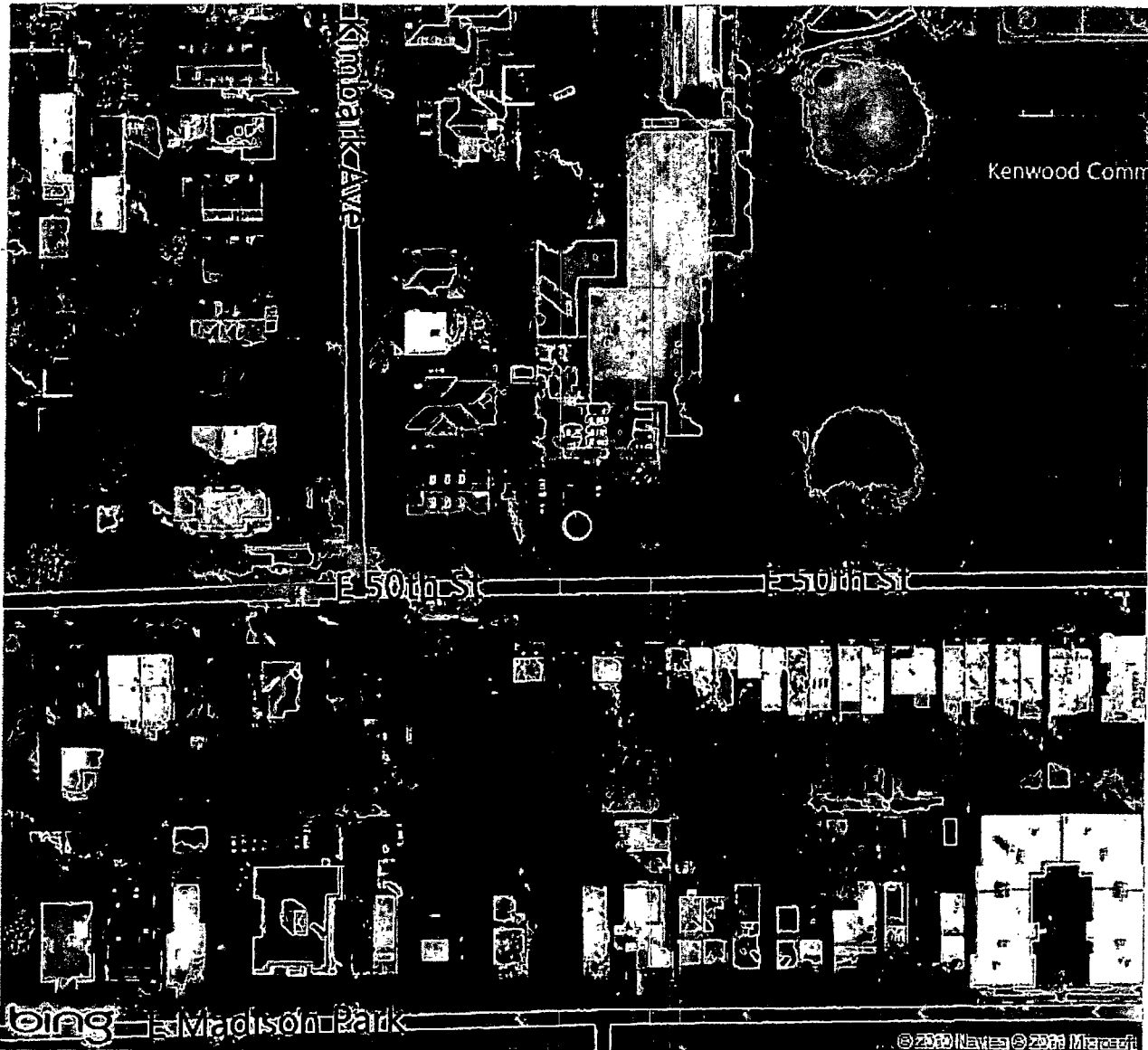

 Bird's eye view maps can't be printed, so another map view has been substituted.

# Zoning Map

Created on: 6/8/2011 4:41 P.M.

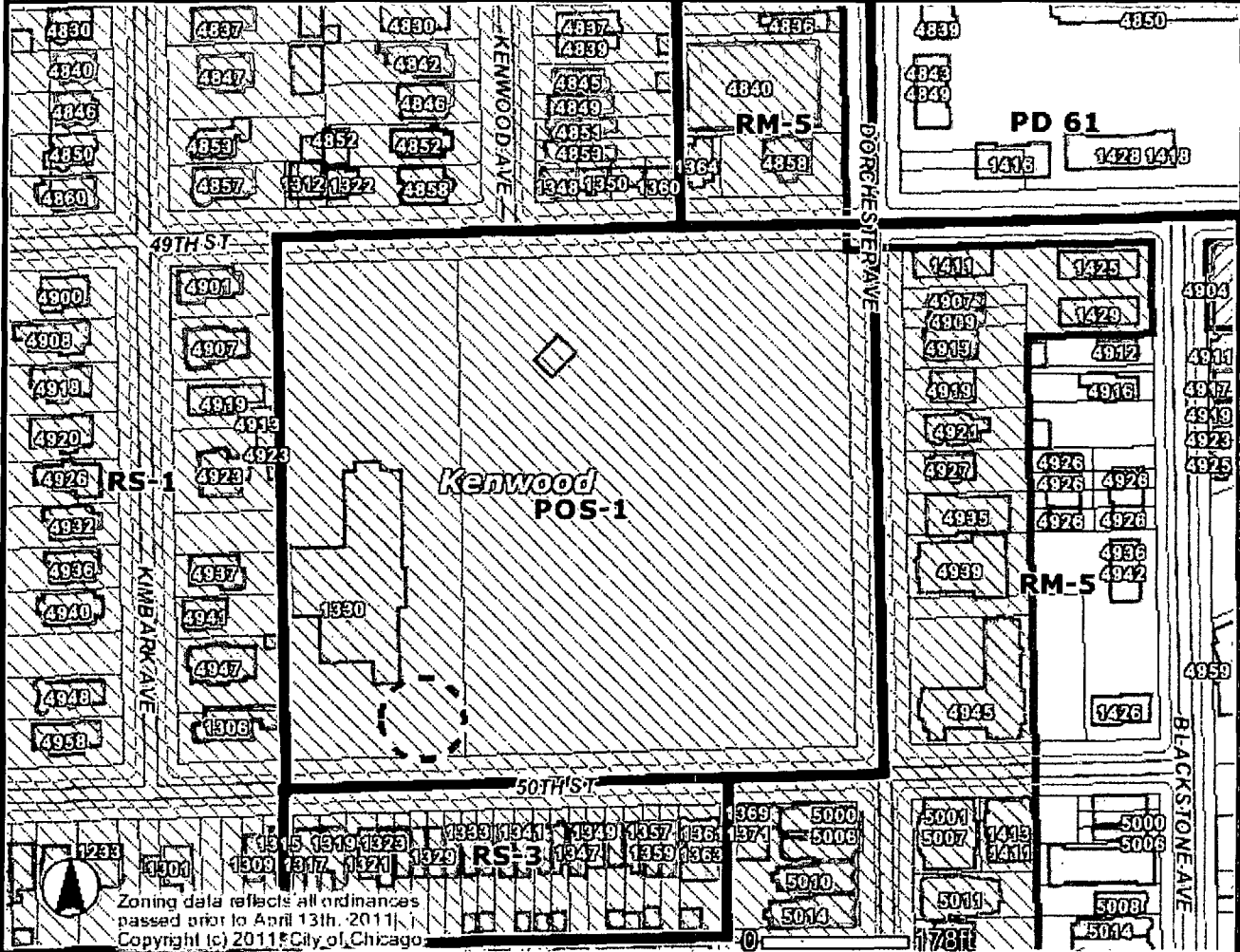

Zoning data reflects all ordinances passed prior to April 13th, 2011.  
Copyright (c) 2011 City of Chicago

## Address

1330 E 50TH ST

### Zoning

- Business
- Commercial
- Manufacturing
- Residential
- Planned Development
- Planned Manufacturing
- Downtown Core
- Downtown Service
- Downtown Mixed
- Downtown Residential
- Transportation
- Parks & Open Space
- Zoning Boundaries

### Historic Preservation

- CHICAGO LANDMARKS
- Chicago Landmarks
  - Landmark Districts
- Chicago Historic Resources Survey - Buildings subject to Demolition-Delay Ordinance
- Red
  - Orange
  - Forest Preserve
  - City Boundary

### Lakefront

- Pedestrian Streets
- Buildings
- Parcels
- Streets
- Water
- Cemetery
- Municipalities

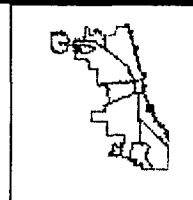

Information provided on the City of Chicago web site should not be used as a substitute for legal, accounting, real estate, business, tax, or other professional advice. The City of Chicago assumes no liability for any damages or loss of any kind that might arise from the use of, misuse of, or the inability to use the City web site and/or the materials contained on the web site. The City of Chicago also assumes no liability for improper or incorrect use of materials or information contained on its web site. All materials that appear on the City of Chicago web site are distributed and transmitted as is, without warranties of any kind, either express or implied, and subject to the terms and conditions stated in this disclaimer.

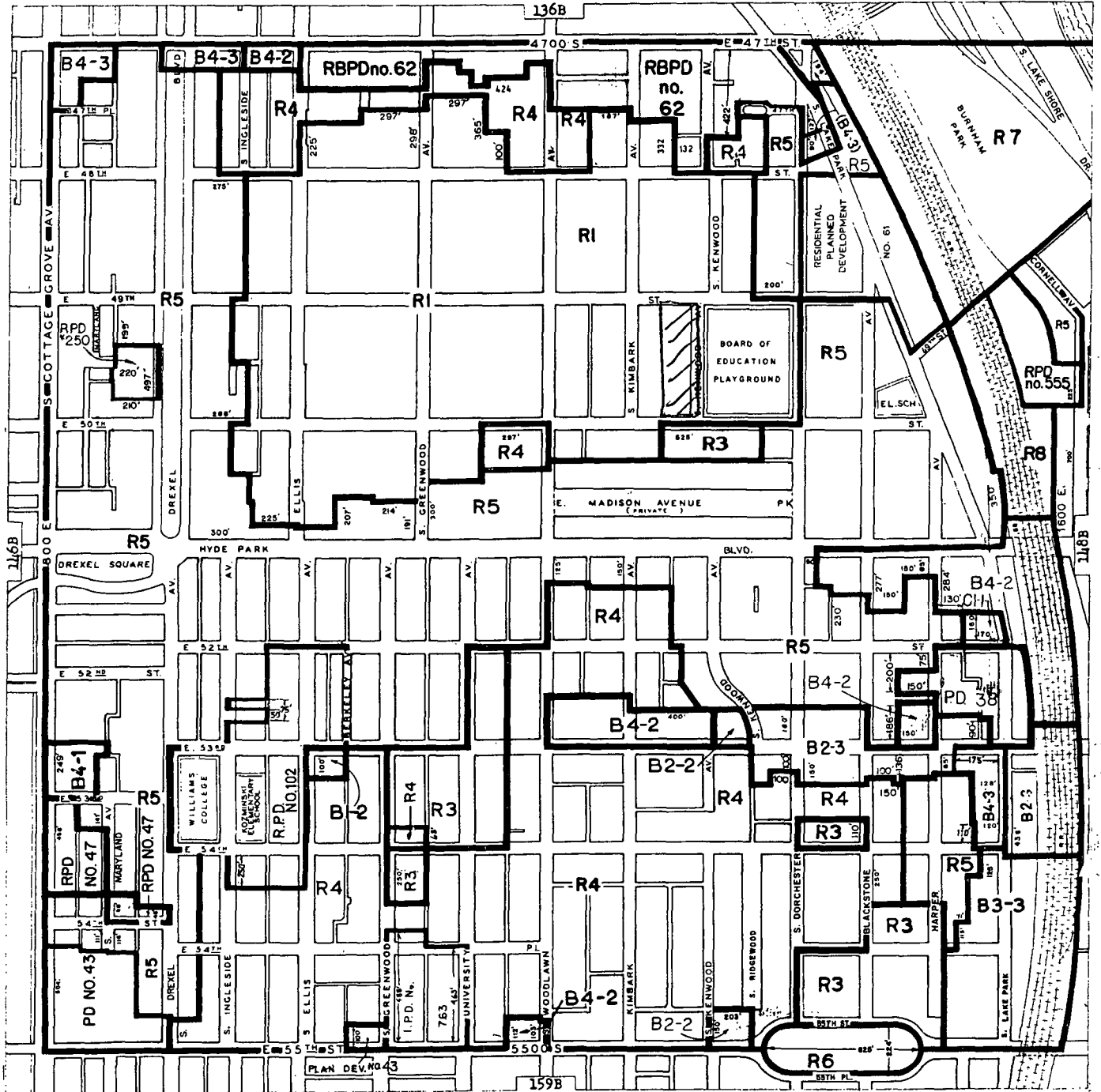

**RESIDENCE DISTRICTS**

- R1 SINGLE-FAMILY RESIDENCE DISTRICT
- R2 SINGLE-FAMILY RESIDENCE DISTRICT
- R3 GENERAL RESIDENCE DISTRICT
- R4 GENERAL RESIDENCE DISTRICT
- R5 GENERAL RESIDENCE DISTRICT
- R6 GENERAL RESIDENCE DISTRICT
- R7 GENERAL RESIDENCE DISTRICT
- R8 GENERAL RESIDENCE DISTRICT

**BUSINESS DISTRICTS**

- B1-1 TO B1-5 LOCAL RETAIL DISTRICTS
- B2-1 TO B2-5 RESTRICTED RETAIL DISTRICTS
- B3-1 TO B3-5 GENERAL RETAIL DISTRICTS
- B4-1 TO B4-5 RESTRICTED SERVICE DISTRICTS
- B5-1 TO B5-5 GENERAL SERVICE DISTRICTS
- B6-6 AND B6-7 RESTRICTED CENTRAL BUSINESS DISTRICTS
- B7-5 TO B7-7 GENERAL CENTRAL BUSINESS DISTRICTS

**COMMERCIAL DISTRICTS**

- C1-1 TO C1-5 RESTRICTED COMMERCIAL DISTRICTS
- C2-1 TO C2-5 GENERAL COMMERCIAL DISTRICTS
- C3-5 TO C3-7 COMMERCIAL-MANUFACTURING DISTRICTS
- C4 MOTOR FREIGHT TERMINAL DISTRICT

**MANUFACTURING DISTRICTS**

- M1-1 TO M1-5 RESTRICTED MANUFACTURING DISTRICTS
- M2-1 TO M2-5 GENERAL MANUFACTURING DISTRICTS
- M3-1 TO M3-5 HEAVY MANUFACTURING DISTRICT

FOR USE AND BULK REGULATIONS, RESIDENCE DISTRICTS, SEE ARTICLE 7.  
 FOR USE AND BULK REGULATIONS, BUSINESS DISTRICTS, SEE ARTICLE 8.  
 FOR USE AND BULK REGULATIONS, COMMERCIAL DISTRICTS, SEE ARTICLE 9.  
 FOR USE AND BULK REGULATIONS, MANUFACTURING DISTRICTS, SEE ARTICLE 10



PLAT OF DAWKIN  
CITY OF DENVER

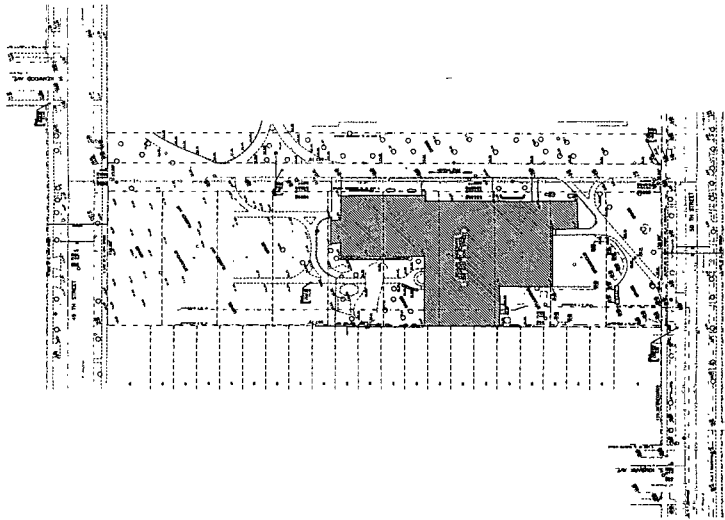

PLAT OF DAWKIN  
CITY OF DENVER

PLAT OF DAWKIN  
CITY OF DENVER

PLAT OF DAWKIN  
CITY OF DENVER

PLAT OF DAWKIN  
CITY OF DENVER

