



City of Chicago



Or2022-135

Office of the City Clerk

Document Tracking Sheet

Meeting Date:	5/23/2022
Sponsor(s):	Villegas (36)
Type:	Order
Title:	Issuance of permits for sign(s)/signboard(s) at 2150 N Cicero Ave - 126 sq. ft.
Committee(s) Assignment:	Committee on Zoning, Landmarks and Building Standards

CITY COUNCIL
COMMITTEE ON ZONING, LANDMARKS AND BUILDING STANDARDS

COUNCIL ORDER

RE: Approval of sign over 100 square feet in area or over 24 feet above grade

ORDERED, that the City Council hereby approves the following sign application submitted by:

Applicant*: Paisans Pizzeria

(* The Applicant is the owner of the real property or the business tenant of the real property. Do not list the sign contractor, sign erector, sign company or advertising entity in the above space.)

This Order approves the following sign in accordance with Municipal Code of Chicago Section 13-20-680:

Address of Sign: 2150 N Cicero Ave Chicago, IL 60639

Zoning District: B3-1

DOB Sign Permit Application #: 100965947

Sign Details:

1. On-premise OR Off-premise
2. Static sign OR Dynamic-image display sign
3. Number of sign faces 1
4. Projecting over the public way Yes (Yes or No) If yes, Public Way Use #: BACP1675683
5. Dimensions: Length 15 feet 0 inches Height 8 feet 5 inches
Total square feet in area: 126 feet 0 inches
6. Height above grade: 12 feet 0 inches
7. Elevation (side of building or lot where the sign will be erected): South East Lot
8. Name of Sign Contractor/Erector: Olympik Signs

To be legal, such sign shall comply with all provisions of Title 17 of the Chicago Municipal Code ("Zoning Ordinance") and all other provisions of the Municipal Code governing the permitting, construction and maintenance and removal of signs and sign structures. Failure of the applicant and the applicant's successors to comply shall be grounds for invalidation or revocation of the sign permit.

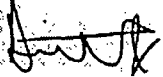

Alderman

36

Ward



CITY OF CHICAGO

DEPARTMENT OF BUILDINGS

Sign Permit Application

APPROVAL NUMBER	APPLICATION NUMBER 100965947	ANNUAL FEE	WORK CODE	DRAWINGS ATTACHED <input type="checkbox"/> YES <input type="checkbox"/> NO			
DATE OF APPLICATION 04/06/2022		TYPE OF SIGN FLAT OR BOX					
ADDRESS OF SIGN 2150 N CICERO AVE, 60639-		LENGTH	FT. 15	IN. 0	HEIGHT	FT. 8	IN. 5
BUILDING	ORIGINAL PERMIT NUMBER	AREA	SQ. FT. 126	WEIGHT	LBS. 450		
TYPE OF PERMIT NEW CONSTRUCTION (SIGN)		SIGN HEIGHT ABOVE GRADE/ROOF			FT. 12		
PAYER OF ANNUAL INSPECTION DOUVRIS, SPIRO 2150 N CICERO AVE CHICAGO, IL 60639 (630)380-4444		SHAPE OF SIGN REGULAR					
SIGN MANUFACTURER OLYMPIK SIGNS		SIGN WILL READ PAISANS PIZZERIA					
ADDRESS WHERE SIGN CAN BE SEEN PRIOR TO ERECTION		NO. OF LAMPS 1,000		TOTAL WATTAGE 240			
TICKET NUMBER 0		REINSPECTION CONTROL NUMBER		TYPE OF LAMP OTHER			
TYPE OF SUPPORT FOR SIGN GROUND STRUCTURE		NO. OF BALLAST/TRANSFORMERS 4		INPUT OF TRANSFORMERS 110V.			
SIGN BOARD SUPPORT MEMBERS OTHER		CONTRACTOR WILL INSTALL		<input checked="" type="checkbox"/> FEEDERS <input checked="" type="checkbox"/> CUSTOMER LEADS			
ANNUAL FEE		TYPE OF SWITCH					
CONSTRUCTION FEE 600.00		LOCATION OF SWITCH OUTSIDE SIGN					
1017 B FEE		SIGN LOCATION INSTALL LED ILLUMINATED SIGN CABINET ONTO FREESTANDING SIGN BASE PROVIDED BY OTHERS & LOCATED AT SOUTH EAST END OF LOT.					
TOTAL FEE 600.00		Check # for Zoning					
AMOUNT PAID 200.00		Check # for DCAP					
BALANCE DUE \$ 400.00							

The undersigned certify that the statements in this application are true and correct and that all work done under the proposed permit, will conform to the requirements of the Chicago Municipal Code

LICENSE #	E69270
ELECT CONTR*	OLYMPIK SIGNS, INC.
ADDRESS	1130 N. GARFIELD LOMBARD, IL 60148-
SUPERVISOR SIGNATURE	<i>Bill Pyter</i>

#	TGC101361
CONTRACTOR*	OLYMPIK SIGNS INC
ADDRESS	1130 NORTH GARFIELD STREET LOMBARD IL, 60148-
SIGNATURE	<i>[Signature]</i>

*IF APPLICABLE

The permit issued on this application will authorize only signs here applied for. If other signs are to be erected they must be covered by additional permits

City of Chicago
Lori E Lightfoot, Mayor



Department of Buildings
Matthew Beaudet, Commissioner

TYPE OF BUSINESS
COM DINING Other: _____
 Name: _____
 LIC #: _____
 Renewal Date: _____

SIGN BOND REQUIRED? YES
 COUNCIL ORDER REQUIRED YES
 IS SPECIAL PERMISSION REQUIRED FROM CHIEF ELECTRICAL
 YES

Projects Over:
 Private Property
 Public Way Grant Permit #: _____
 Planned Development/Manufacturing PMD/PD#: _____
 Zoning District: **C2** Other: **C2-1**

IF YES, ATTACH LETTER OF REQUEST
 TIME STAMP

TYPE OF SIGN:
 ADVERTISING ILLUMINATE MOVEABLE
 BUSINESS FLASHING

TOTAL STREET FRONTAGE OF LOT (IN FEET) 270
 TOTAL AREA OF NEW SIGN (SQ.FT.) 126
 TOTAL AREA OF ALL SIGNS ON LOT (SQ.FT.) 100
 HEIGHT OF SIGN ABOVE GRADE (TO TOP) 20ft 5in

DISTANCE OF CURB LINE OUTER EDGE (ft) 10
 DISTANCE OF STRUCTURE INNER EDGE (ft) 10

SIGN CLERK _____ APPROVED FOR PERMIT _____

DISTANCE FROM (ft):
 A. PUBLIC PARK (OVER 10 ACRES) 1,000
 B. EXPRESSWAY (IF LESS THAN 1,000 FT.) 1,000
 C. RESIDENCE DISTRICT (ADVERTISING SIGNS ONLY) 130

REMARKS

IF REPLACEMENT SIGN OR CHANGE OF FACE, WHAT DOES THE EXISTING SIGN READ?
 Original Payee: _____

Landmark Hold: Status: _____

ZONING (OFFICE USE ONLY)

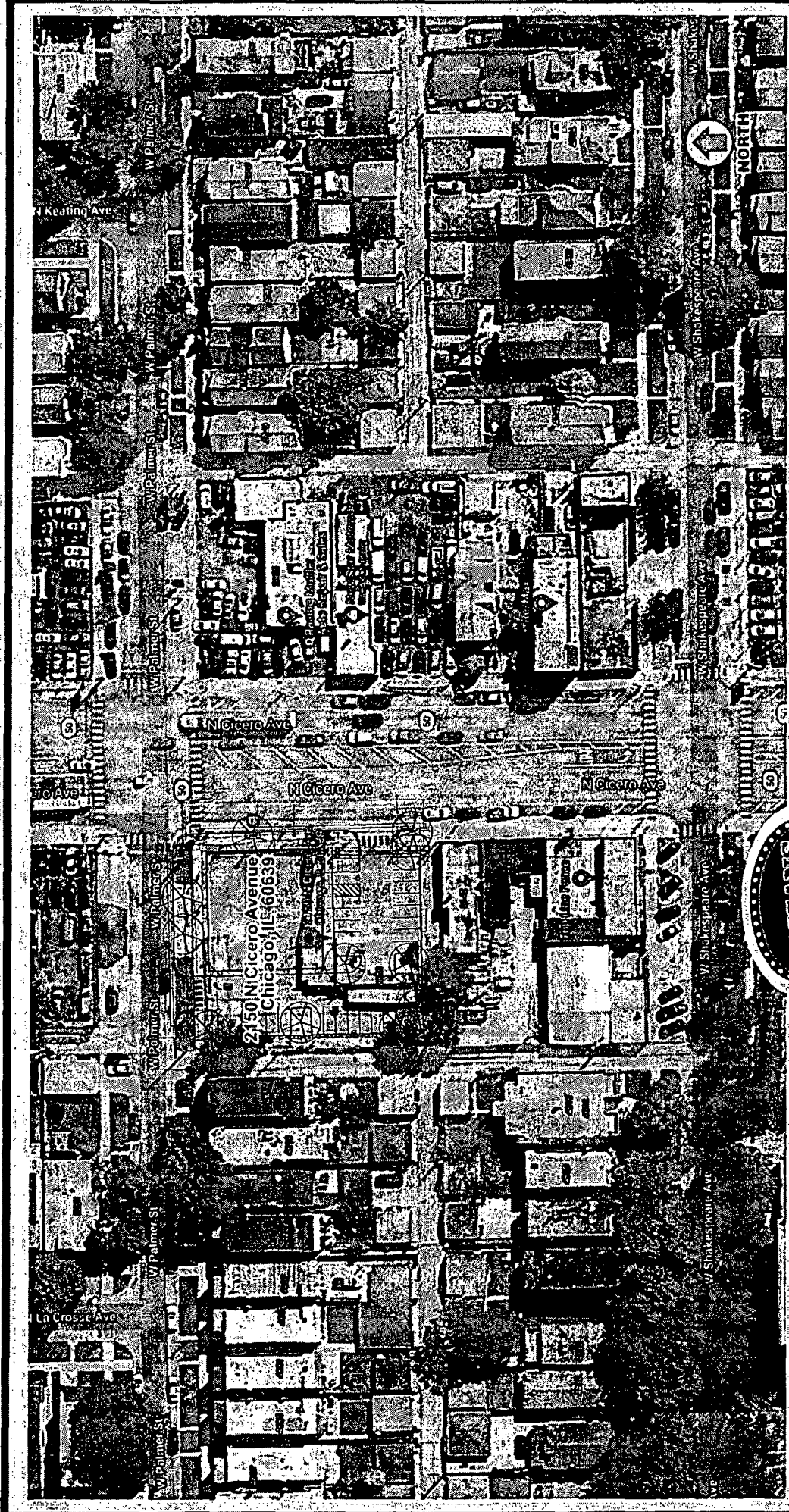

Site Plan -

OLYMPIK SIGNS

account representative
ROBBY WHITEHEAD
 1180 N. Gary Rd
 Lombard, IL 60148
 Ph: # 630.424.6100

PAISANS PIZZERIA
 2150 N Cicero Avenue
 Chicago, IL 60639

job#: 21-8945
 12-01-21
 rev.# 02-16-22

Comments:

WWW.OLYPIKSIGNS.COM

page 1 of 11

THIS SITE PLAN IS UNAPPROVED UNTIL IT IS SUBMITTED TO THE CITY OF CHICAGO WITH A PROPER PERMIT. THE CITY OF CHICAGO IS NOT RESPONSIBLE FOR ANY DAMAGE TO PROPERTY OR PERSONS THAT MAY OCCUR AS A RESULT OF THE USE OF THIS SITE PLAN. THE CITY OF CHICAGO IS NOT RESPONSIBLE FOR ANY DAMAGE TO PROPERTY OR PERSONS THAT MAY OCCUR AS A RESULT OF THE USE OF THIS SITE PLAN.

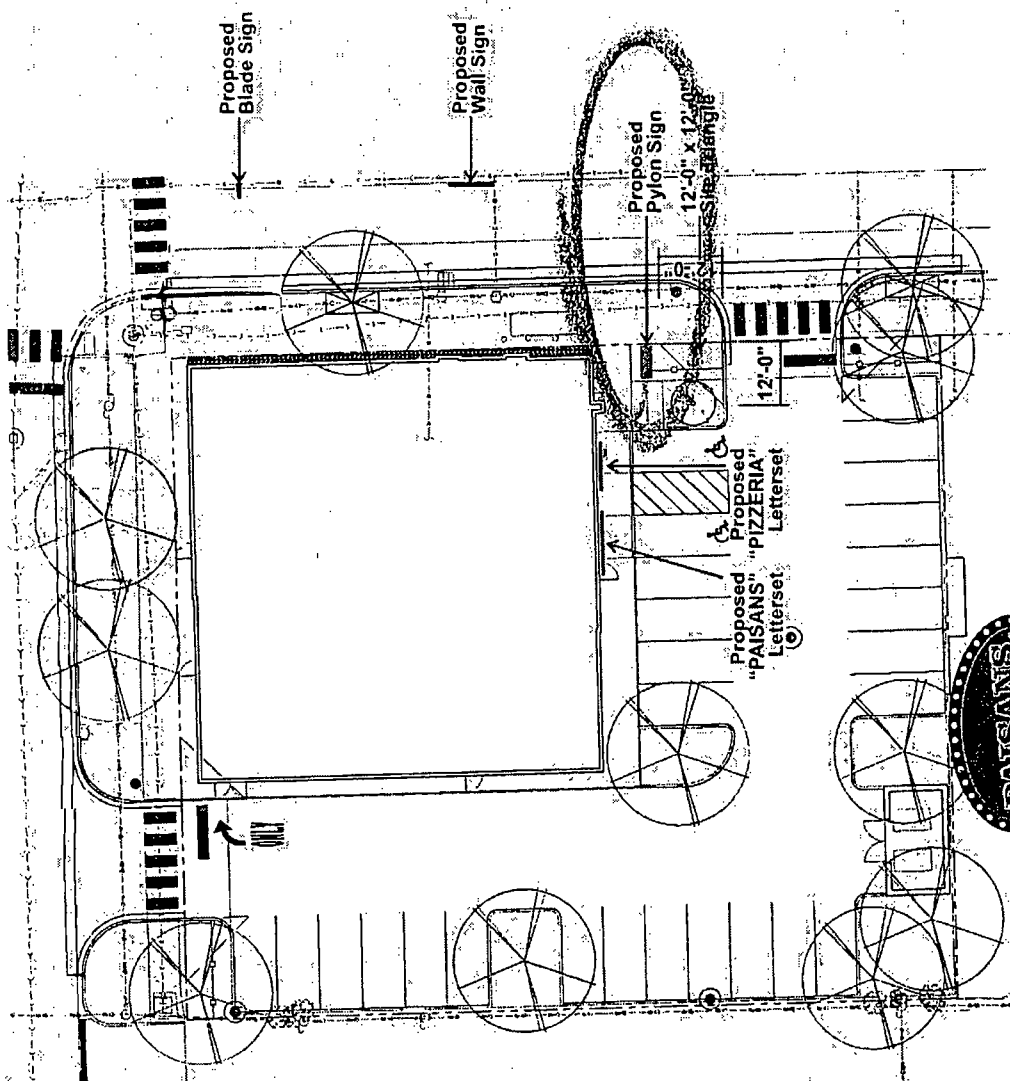

Preliminary Site Plan -
Scale N.T.S.

Comments:
job# 21-8945
12-01-21
rev.# 02-16-22

drawn by
PAMELA F

WWW.OLYMPIKSIGNS.COM

client
ROBBY WHITEHEAD

2150 N Cicero Avenue
Chicago, IL 60639

TEL: 630.424.6100
FAX: 630.424.6120

PAISANS PIZZERIA

PAISANS PIZZERIA

OLYMPIK SIGNS

SITE PLAN

THIS IS AN PRELIMINARY UNAPPROVED DRAWING. COMMENCED IN CONNECTION WITH A PROJECT AND NOT FOR CONSTRUCTION. THIS DRAWING IS THE PROPERTY OF OLYMPIK SIGNS, INC. AND IS NOT TO BE REPRODUCED, COPIED, OR TRANSMITTED IN ANY FORM OR BY ANY MEANS, WITHOUT THE WRITTEN PERMISSION OF OLYMPIK SIGNS, INC.

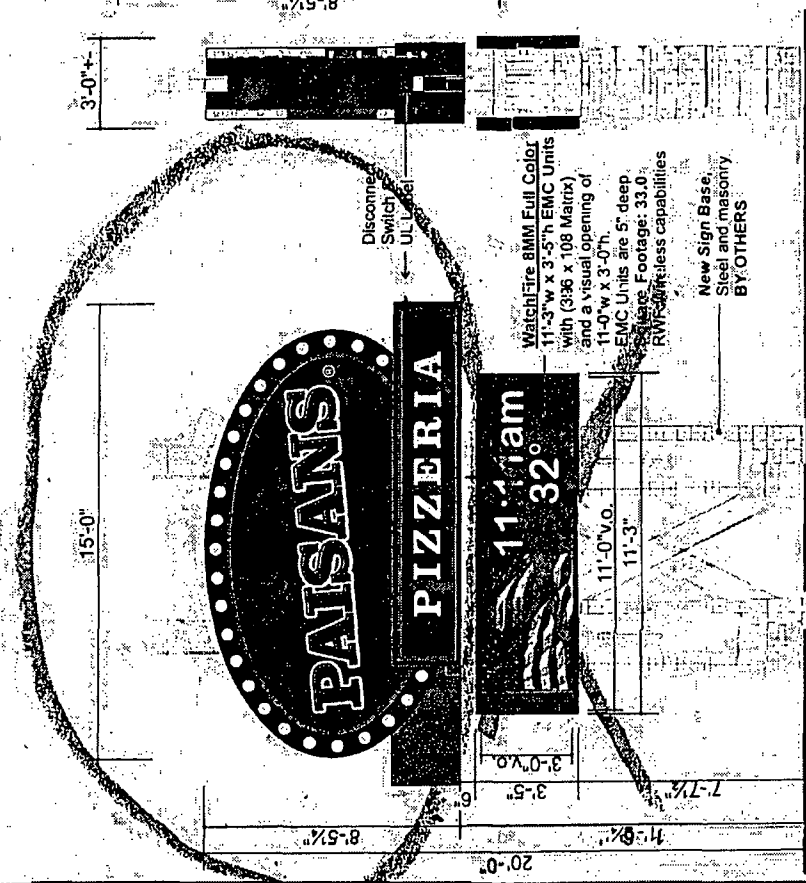
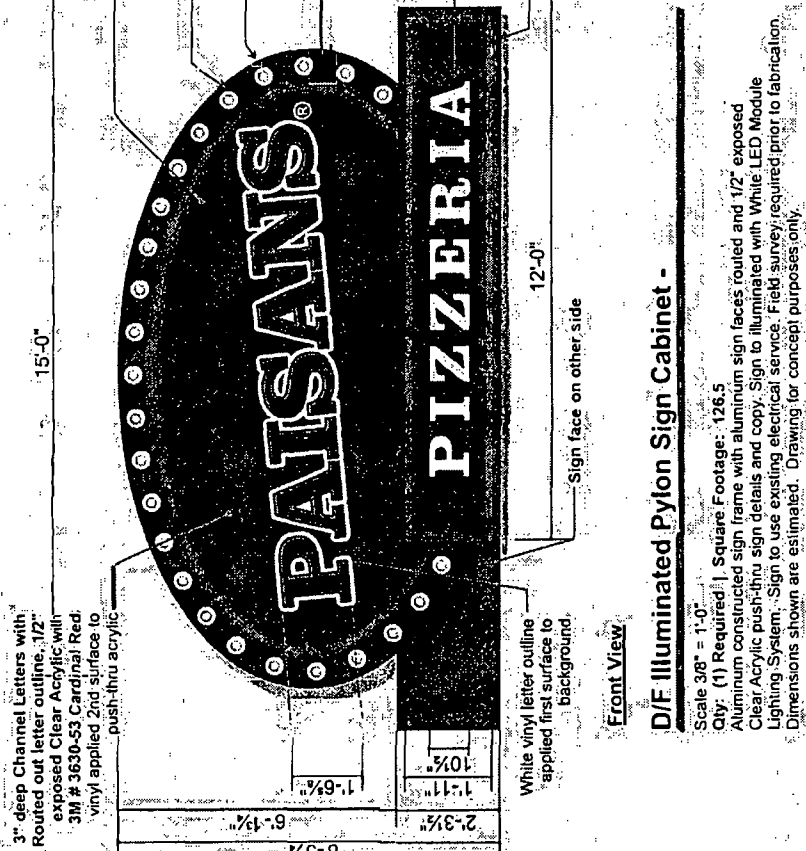

Front View

Scale 3/8" = 1'-0"

Qty: (1) Required | Square Footage: 126.5

Aluminum constructed sign frame with aluminum sign faces routed and 1/2" exposed Clear Acrylic push-thru sign details and copy. Sign to be illuminated with White LED Module Lighting System. Sign to use existing electrical service. Field survey required prior to fabrication. Dimensions shown are estimated. Drawing for concept purposes only.

Side View

Scale 1/4" = 1'-0"

Field survey required prior to fabrication. Dimensions shown are estimated. Drawing for concept purposes only.

D/F Illuminated Pylon Sign Cabinet -

3" deep Channel Letters with Routed out letter outline, 1/2" exposed Clear Acrylic with 3M # 3630-53 Cardinal Red vinyl applied 2nd surface to push-thru acrylic

3 1/2" Recessed Face, painted Black background, sides and returns

Clear S14 LED Bulbs (25 + Bulbs Total each side)

White vinyl circle applied first surface to background

Routed out sign band, 1/2" exposed Clear Acrylic with 3M # 3630-53 Cardinal Red vinyl applied 2nd surface to push-thru acrylic

Routed out "PIZZERIA" copy, backed with White polycarb

5" deep aluminum framed sign cabinet with routed out sign band, 1/2" exposed Clear Acrylic push-thru with 3M # 3630-53 Cardinal Red vinyl applied 2nd surface to push-thru acrylic

White vinyl letter outline applied first surface to background.

Sign face on other side

12'-0"

10%

1'-11"

1'-6"

6'-1 1/2"

8'-5 1/2"

2'-3 1/2"

15'-0"

Watch for 8mm Full Color 11'-3" w x 3'-3" h EMC Units with (386 x 108 Matrix) and a visual opening of 11'-0" w x 3'-0" h.

EMC Units are 5" deep. Height: 33.0". RFI/EMI/RFI capabilities

New Sign Base Steel and masonry BY OTHERS

Discontinue Switch UL Label

11'-0" v.o.

11'-3"

7'-7 1/2"

3'-5"

3'-0" v.o.

20'-0"

15'-0"

3'-0"

Comments:

Job#: 21-8945
12-01-21
rev.# 02-16-22

drawn by PAMELA F

WWW.HOLLSIGNS.COM

page 9 of 11

PAYSANS PIZZERIA

2150 N Cicero Avenue
Chicago, IL 60639

TEL: 630.424.6100 FAX: 630.424.6120

OLYMPIK SIGNS

1150 N. Garfield
Lombard, IL 60148 Ph: 630.424.6100

THIS IS AN ESTIMATED UNILLUMINATED DRAWING. SUBMITTED IN CONNECTION WITH A PROJECT WE ARE PLANNING FOR YOU. THIS IS NOT TO BE CONSIDERED A CONTRACT. THE CLIENT'S RESPONSIBILITY IS TO OBTAIN ALL NECESSARY PERMITS AND APPROVALS PRIOR TO FABRICATION. DIMENSIONS SHOWN TO ANYONE OUTSIDE OF YOUR ORGANIZATION WITHOUT THE WRITTEN PERMISSION OF HOLLSIGNS, INC. ARE VOID.

client: KORBAY WHITEHEAD

account representative: TED N. Garfield

Scale 3/8" = 1'-0"

Scale 1/4" = 1'-0"

PMS 187

3M Cardinal Red

#3630-53

PIZZERIA

PIZZERIA

PIZZERIA