



City of Chicago



Or2010-1224

Office of the City Clerk

Tracking Sheet

Meeting Date:	12/8/2010
Status:	Introduced
Sponsor(s):	Thomas, Latasha
Type:	Order
Title:	Install Sign(s)/Signboard(s) at 148 W. 49th
Committee(s) Assignment:	Committee on Buildings

(signs)

ORDERED, That the Commissioner of Buildings is hereby directed to issue a sign permit to: KGD Enterprises, Inc. d/b/a: Chicago Signs, 26W535 Saint Charles Road, Carol Stream, Illinois 60188.

for the erection of a sign / signboard over 24 feet in height and / or over 100 square feet (in area of one face) at: Save a Lot Food Stores, 148 West 79th Street (South Elevation).

Dimensions: Length 37' Height 4'

Height above grade / roof to top of sign: 16

TOTAL SQUARE FOOT AREA: 148 SQ. FT.

Such sign(s) shall comply with all applicable provisions of TITLE 17 of the Chicago Zoning Ordinance and all other applicable provisions of the Municipal Code of the City of Chicago governing the construction and maintenance of outdoor signs, signboards and structures.

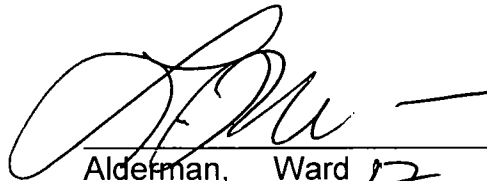

Alderman, Ward 17

**ZONING SIGN PERMIT APPLICATION
DEPARTMENT OF ZONING
CITY OF CHICAGO
OFFICE OF THE ZONING ADMINISTRATOR**

Application For KGD Enterprises, Inc (dba) **CHICAGO SIGN** John Doyle
(Name of Sign Company)

Location - Street Address: Save A Lot, 148 W. 79th St

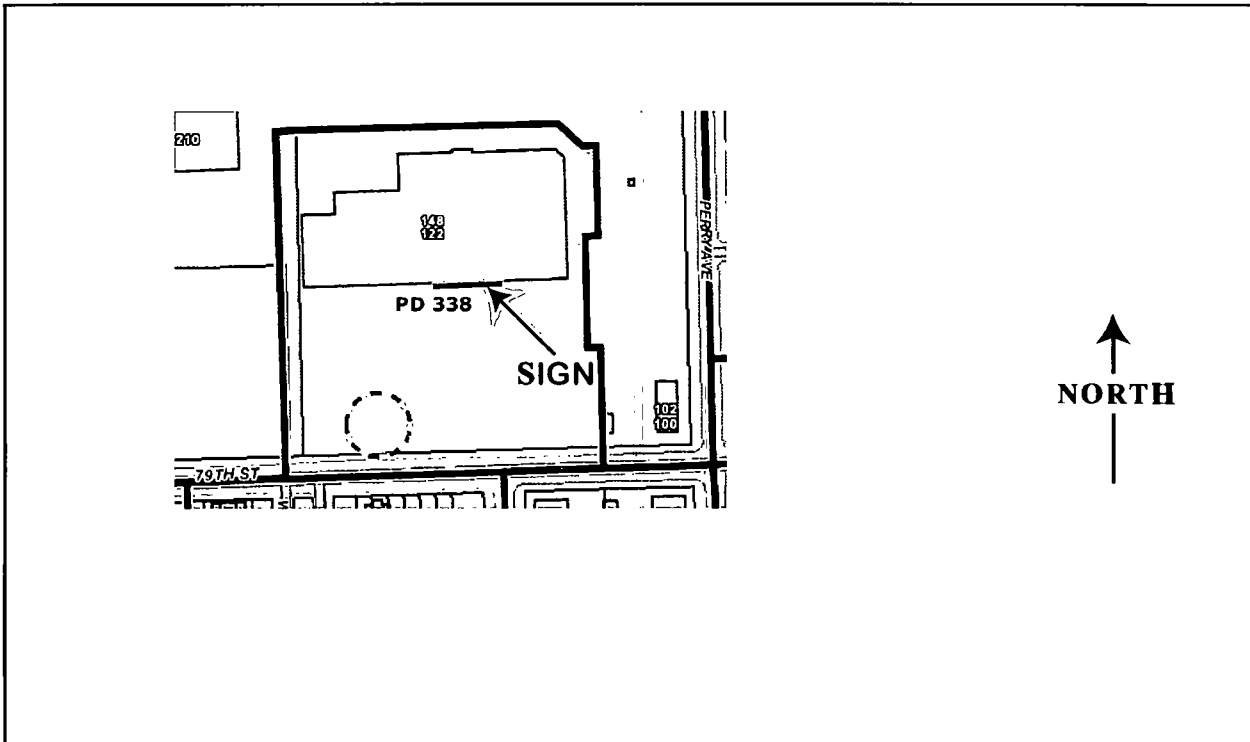
Zoning District: PD 338



1. Type of Sign (check one for each section)
 - a.) Signboard, Flat, Projecting, or Awning
 - b.) Business ID. or Advertising
2. Non-illuminated, Illuminated, Flashing, and/or Moving
3. Height above curb level 12 ft, _____ in.
4. Gross Area of sign 148 sq. ft.
5. Total area of all signs on the lot 189 sq. ft.
6. Project over public way; yes or (no) If yes _____ ft, _____ in.
Distance from curb line dna in.
7. Distance from expressway or major route (within 1000 ft.) dna ft.
Is sign visible from expressway or major routes yes or (no) (circle one)
8. Distance from park (over 10 Acres) dna ft.
9. Distance from residential zone dna ft.

ALL OF THE ABOVE QUESTIONS MUST BE ANSWERED FULLY

SIGNATURE

NOTE: IN B6-6 and B6-7 Districts, exact sign copy must be indicated
For roof signs, indicate height above grade _____ ft.

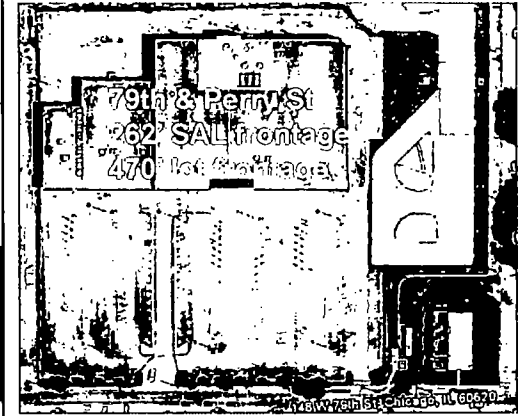
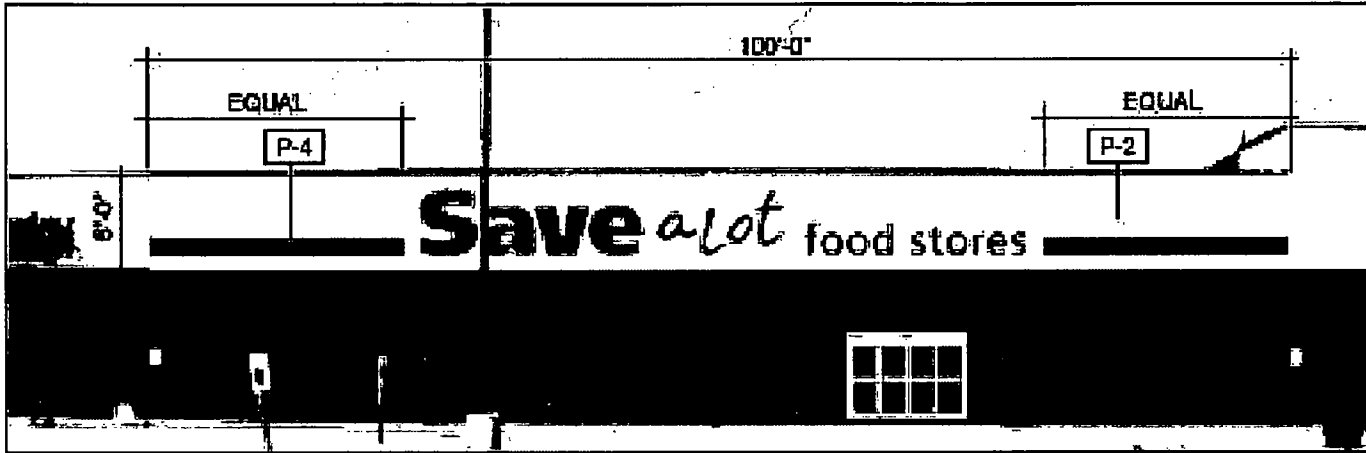

37'

4' **Save a lot** food stores

1' scale

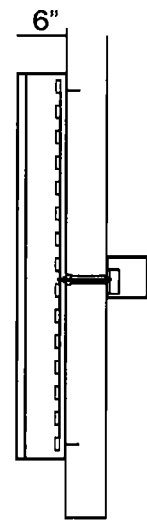

Section Thru:
 "Save a lot"
 letters.
 LED illumination.
 Aluminum wrap and sides
 Acrylic facing.
 5 transformers
 420 watts
 120v
 Wt: 200#
 UL Label
 Listed flush toggle switch.



Section Thru:
 "food stores"
 letters.
 Non-illuminated.
 Acrylic pin mount letters.

Sign Permit Application

APPROVAL NUMBER	APPLICATION NUMBER 100374693	ANNUAL FEE	WORK CODE	DRAWINGS ATTACHED <input type="checkbox"/> YES <input type="checkbox"/> NO
DATE OF APPLICATION 12/01/2010			TYPE OF SIGN FLAT OR BOX	
ADDRESS OF SIGN 148 W 79TH ST, 60620-			LENGTH	FT. IN. HEIGHT FT. IN.
BUILDING	ORIGINAL PERMIT NUMBER		AREA	SQ FT. WEIGHT LBS.
TYPE OF PERMIT NEW CONSTRUCTION (SIGN)			148	300
PAYER OF ANNUAL INSPECTION SAV A LOT FOOD STORES, STORE MANAGER 148 WEST 79TH STREET CHICAGO, IL 60620 (000)000-0000			SIGN HEIGHT ABOVE GRADE/ROOF FT 12	
SIGN MANUFACTURER KGD ENTERPRISES			SHAPE OF SIGN REGULAR	
ADDRESS WHERE SIGN CAN BE SEEN PRIOR TO ERECTION			SIGN WILL READ SAVE A LOT FOOD STORES	
TICKET NUMBER 0	REINSPECTION CONTROL NUMBER		NO OF LAMPS 7	TOTAL WATTAGE 420
TYPE OF SUPPORT FOR SIGN BUILDING			TYPE OF LAMP OTHER	
SIGN BOARD SUPPORT MEMBERS OTHER			NO. OF BALLAST/TRANSFORMERS 5	INPUT OF TRANSFORMERS 120
ANNUAL FEE _____			CONTRACTOR WILL INSTALL <input checked="" type="checkbox"/> FEEDERS <input checked="" type="checkbox"/> CUSTOMER LEADS	
CONSTRUCTION FEE _____ 200.00			TYPE OF SWITCH SPECIAL	
1017 B FEE _____			LOCATION OF SWITCH LISTED FLUSH TOGGLE	
TOTAL FEE _____ 200.00			SIGN LOCATION INDIVIDUAL ILLUMINATED LETTERS READING, SAV-A-LOT FOOD STORES, SOUTH ELEVATION.	
AMOUNT PAID _____ 200.00				
BALANCE DUE _____				

The undersigned certify that the statements in this application are true and correct and that all work done under the proposed permit will conform to the requirements of the Chicago Municipal Code

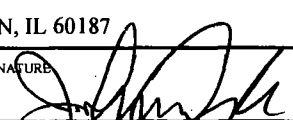
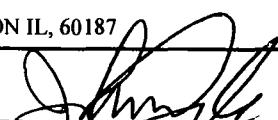
	REG. NO. E92687	BOND NO. 0482722	REG. NO. N93120
ELECT CONTR KGD ENTERPRISES, INC.	ELECTR	SIGN ERECTOR KGD ENTERPRISES	SIGNER
ADDRESS 204 N GARY AVE WHEATON, IL 60187		ADDRESS 204 N GARY WHEATON IL, 60187	
SUPERVISOR SIGNATURE 		SIGNATURE 	

The permit issued on this application will authorize only signs here applied for. If other signs are to be erected they must be covered by additional permits

City of Chicago
 Richard M. Daley, Mayor



Department of Buildings
 Richard Monocchio, Commissioner

TYPE OF BUSINESS <u>COMMERCIAL</u> Other: <u>GROCERY STORE</u> Name: <u>SAVE A LOTFOODS</u> LIC #: Renewal Date:	SIGN BOND REQUIRED? <input type="checkbox"/> YES COUNCIL ORDER REQUIRED <input checked="" type="checkbox"/> YES IS SPECIAL PERMISSION REQUIRED FROM CHIEF ELECTRICAL <input type="checkbox"/> YES IF YES, ATTACH LETTER OF REQUEST TIME STAMP
Projects Over: <input checked="" type="checkbox"/> Private Property <input checked="" type="checkbox"/> Public Way Grant Permit #: <input checked="" type="checkbox"/> Planned Development/Manufacturing PMD/PD#: <u>338</u> Zoning District: <u>OTHER</u> Other: <u>PD</u>	TIME STAMP
TYPE OF SIGN: <input type="checkbox"/> ADVERTISING <input checked="" type="checkbox"/> ILLUMINATE <input type="checkbox"/> MOVEABLE <input checked="" type="checkbox"/> BUSINESS <input type="checkbox"/> FLASHING	TIME STAMP
TOTAL STREET FRONTAGE OF LOT (IN FEET) <u>262</u> TOTAL AREA OF NEW SIGN (SQ.FT.) <u>148</u> TOTAL AREA OF ALL SIGNS ON LOT (SQ.FT.) <u>189</u> HEIGHT OF SIGN ABOVE GRADE (TO TOP) <u>16ft</u> in	TIME STAMP
DISTANCE OF CURB LINE OUTER EDGE (ft) <u>267</u> DISTANCE OF STRUCTURE INNER EDGE (ft) <u>1</u>	SIGN CLERK APPROVED FOR PERMIT
DISTANCE FROM (ft): A. PUBLIC PARK (OVER 10 ACRES) _____ B. EXPRESSWAY (IF LESS THAN 1,000 FT.) _____ C. RESIDENCE DISTRICT (ADVERTISING SIGNS ONLY) _____ IF REPLACEMENT SIGN OR CHANGE OF FACE, WHAT DOES THE EXISTING SIGN READ? Original Payee: _____ Landmark Hold: <input type="checkbox"/> Status: _____	REMARKS
ZONING (OFFICE USE ONLY)	REMARKS