



City of Chicago



Or2023-8

Office of the City Clerk

Document Tracking Sheet

Meeting Date:	1/18/2023
Sponsor(s):	Waguespack (32)
Type:	Order
Title:	Issuance of permits for sign(s)/signboard(s) at 2131 N Elston Ave - Permit No. 100997462
Committee(s) Assignment:	Committee on Zoning, Landmarks and Building Standards

CITY COUNCIL
COMMITTEE ON ZONING, LANDMARKS AND BUILDING STANDARDS

COUNCIL ORDER

RE: Approval of sign over 100 square feet in area or over 24 feet above grade

ORDERED, that the City Council hereby approves the following sign application submitted by:

Applicant*: The Green

(* The Applicant is the owner of the real property or the business tenant of the real property. Do not list the sign contractor, sign erector, sign company or advertising entity in the above space.)

This Order approves the following sign in accordance with Municipal Code of Chicago Section 13-20-680:

Address of Sign: 2131 N. Elston Ave. Chicago, IL 606 14

Zoning District: PD1420

DOB Sign Permit Application #: 100997462

Sign Details:

1. On-premise OR Off-premise

2. Static sign OR Dynamic-image display sign

3. Number of sign faces 1

4. Projecting over the public way No (Yes or No) If yes, Public Way Use #: _____

5. Dimensions: Length 15 feet 4 inches Height 9 feet 4 inches

Total square feet in area: 143 feet _____ inches

6. Height above grade: 1 feet _____ inches

7. Elevation (side of building or lot where the sign will be erected): West

8. Name of Sign Contractor/Erector: Olympik Signs

To be legal, such sign shall comply with all provisions of Title 17 of the Chicago Municipal Code ("Zoning Ordinance") and all other provisions of the Municipal Code governing the permitting, construction and maintenance and removal of signs and sign structures. Failure of the applicant and the applicant's successors to comply shall be grounds for invalidation or revocation of the sign permit.

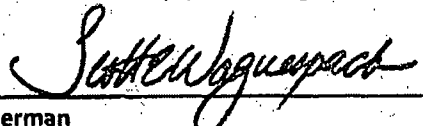
Alderman

Ward



CITY OF CHICAGO

DEPARTMENT OF BUILDINGS

Sign Permit Application

APPROVAL NUMBER	APPLICATION NUMBER 100997462	ANNUAL FEE	WORK CODE	DRAWINGS ATTACHED <input type="checkbox"/> YES <input type="checkbox"/> NO
DATE OF APPLICATION 11/23/2022			TYPE OF SIGN FLAT OR BOX	
ADDRESS OF SIGN 2131 N ELSTON AVE, 60614-			LENGTH	FT. IN. HEIGHT FT. IN.
BUILDING	ORIGINAL PERMIT NUMBER		AREA	SQ. FT. WEIGHT LBS.
TYPE OF PERMIT NEW CONSTRUCTION (SIGN)			SIGN HEIGHT ABOVE GRADE/ROOF FT.	
PAYER OF ANNUAL INSPECTION FEE PTACIN, CONNOR 3742 W DIVERSEY AVE, APT 2 CHICAGO, IL 60647 (847)826-6456			SHAPE OF SIGN REGULAR	
SIGN MANUFACTURER OLYMPIK SIGNS			SIGN WILL READ VIRTUAL + REALITY	
ADDRESS WHERE SIGN CAN BE SEEN PRIOR TO ERECTION			NO. OF LAMPS TOTAL WATTAGE	
TICKET NUMBER 0			TYPE OF LAMP	
REINSPECTION CONTROL NUMBER			NO. OF BALLAST/TRANSFORMERS INPUT OF TRANSFORMERS	
TYPE OF SUPPORT FOR SIGN BUILDING			CONTRACTOR WILL INSTALL <input checked="" type="checkbox"/> FEEDERS <input checked="" type="checkbox"/> CUSTOMER LEADS	
SIGN BOARD SUPPORT MEMBERS OTHER			TYPE OF SWITCH	
ANNUAL FEE			LOCATION OF SWITCH	
CONSTRUCTION FEE	400.00	Check # for Zoning	SIGN LOCATION	
1017 B FEE			INSTALL VINYL ON WEST ELEVATION WINDOW.	
TOTAL FEE	400.00	Check # for DCAP		
AMOUNT PAID	200.00			
BALANCE DUE	\$ 200.00			

The undersigned certifies that the statements in this application are true and correct and that all work done under the proposed permit will conform to the requirements of the Chicago Municipal Code.

LICENSE #	TGC101361
ELECT CONTR*	CONTRACTOR* OLYMPIK SIGNS INC
ADDRESS	ADDRESS 1130 NORTH GARFIELD STREET LOMBARD IL, 60148
SUPERVISOR SIGNATURE	SIGNATURE

*IF APPLICABLE
The permit issued on this application will authorize only signs here applied for. If other signs are to be erected they must be covered by additional permits.

City of Chicago
Lori E Lightfoot, Mayor



Department of Buildings
Matthew Beaudet, Commissioner

TYPE OF BUSINESS COM ENTERTAIN Other: <u>GOLF SIMULATOR</u>		SIGN BOND REQUIRED? <input type="checkbox"/> YES	
Name: _____ LIC #: _____ Renewal Date: _____		COUNCIL ORDER REQUIRED <input checked="" type="checkbox"/> YES	
Projects Over: <input checked="" type="checkbox"/> Private Property <input checked="" type="checkbox"/> Public Way Grant Permit		IS SPECIAL PERMISSION REQUIRED FROM CHIEF ELECTRICAL INSPECTOR <input type="checkbox"/> YES	
<input checked="" type="checkbox"/> Planned Development/Manufactur PMD/PD# <u>PD1420</u> Zoning District <u>OTHER</u> Other: <u>PD</u>		IF YES, ATTACH LETTER OF REQUEST	
TYPE OF SIGN: <input type="checkbox"/> ADVERTISING <input type="checkbox"/> ILLUMINATED <input type="checkbox"/> MOVEABLE <input checked="" type="checkbox"/> BUSINESS <input type="checkbox"/> FLASHING		TIME STAMP	
TOTAL STREET FRONTAGE OF LOT (IN FEET) <u>1,550</u>			
TOTAL AREA OF NEW SIGN (SQ.FT.) <u>143</u>			
TOTAL AREA OF ALL SIGNS ON LOT (SQ.FT.) <u>1,814</u>			
HEIGHT OF SIGN ABOVE GRADE (TO TOP) <u>10ft 4in</u>			
DISTANCE OF CURB LINE OUTER EDGE (ft) <u>10</u>		SIGN CLERK	APPROVED FOR PERMIT
DISTANCE OF STRUCTURE INNER EDGE (ft) <u>10</u>			
DISTANCE FROM (ft): A. PUBLIC PARK (OVER 10 ACRES) <u>1,000</u> B. EXPRESSWAY (IF LESS THAN 1,000 FT.) <u>1,000</u> C. RESIDENCE DISTRICT (ADVERTISING SIGNS ONLY) <u>580</u>		REMARKS	
IF REPLACEMENT SIGN OR CHANGE OF FACE, WHAT DOES THE EXISTING SIGN READ?			
Original Payee: _____			
Landmark Hold: <input type="checkbox"/> Status: _____			
ZONING (OFFICE USE ONLY)			

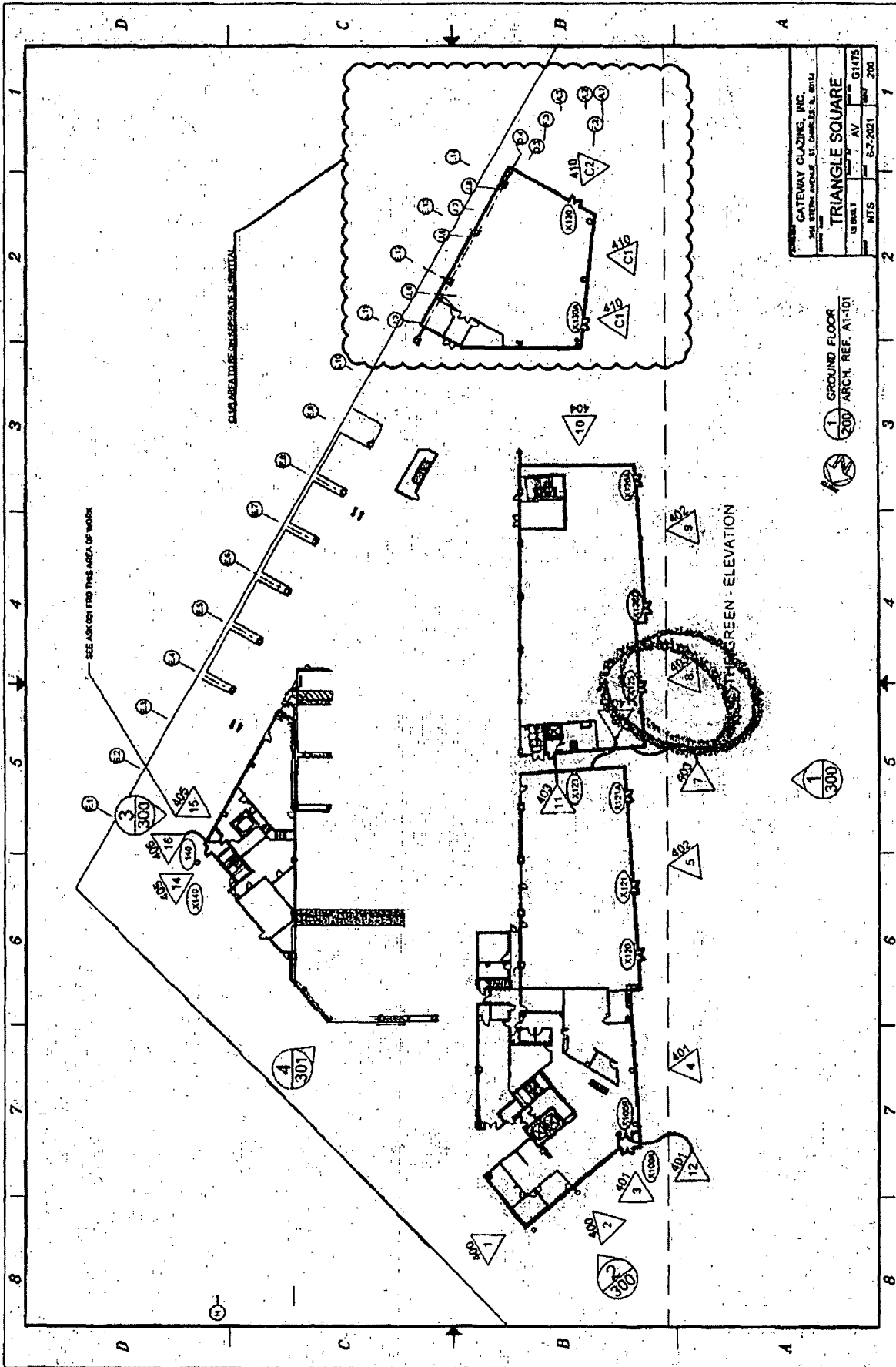

GATEWAY GLAZING, INC.
 200 WESTERN AVENUE, ST. CHARLES, N. CAROLINA
TRIANGLE SQUARE
 LIBERTY AVENUE
 NTS 6-7-2021
 G1475
 200

1 GROUND FLOOR
 200 ARCH. REF. A1-101

1 300

GREEN - ELEVATION

SEE ASK ORT FROM THIS AREA OF WORK

CLIO AREA TO BE REPEATED SUBMITTA

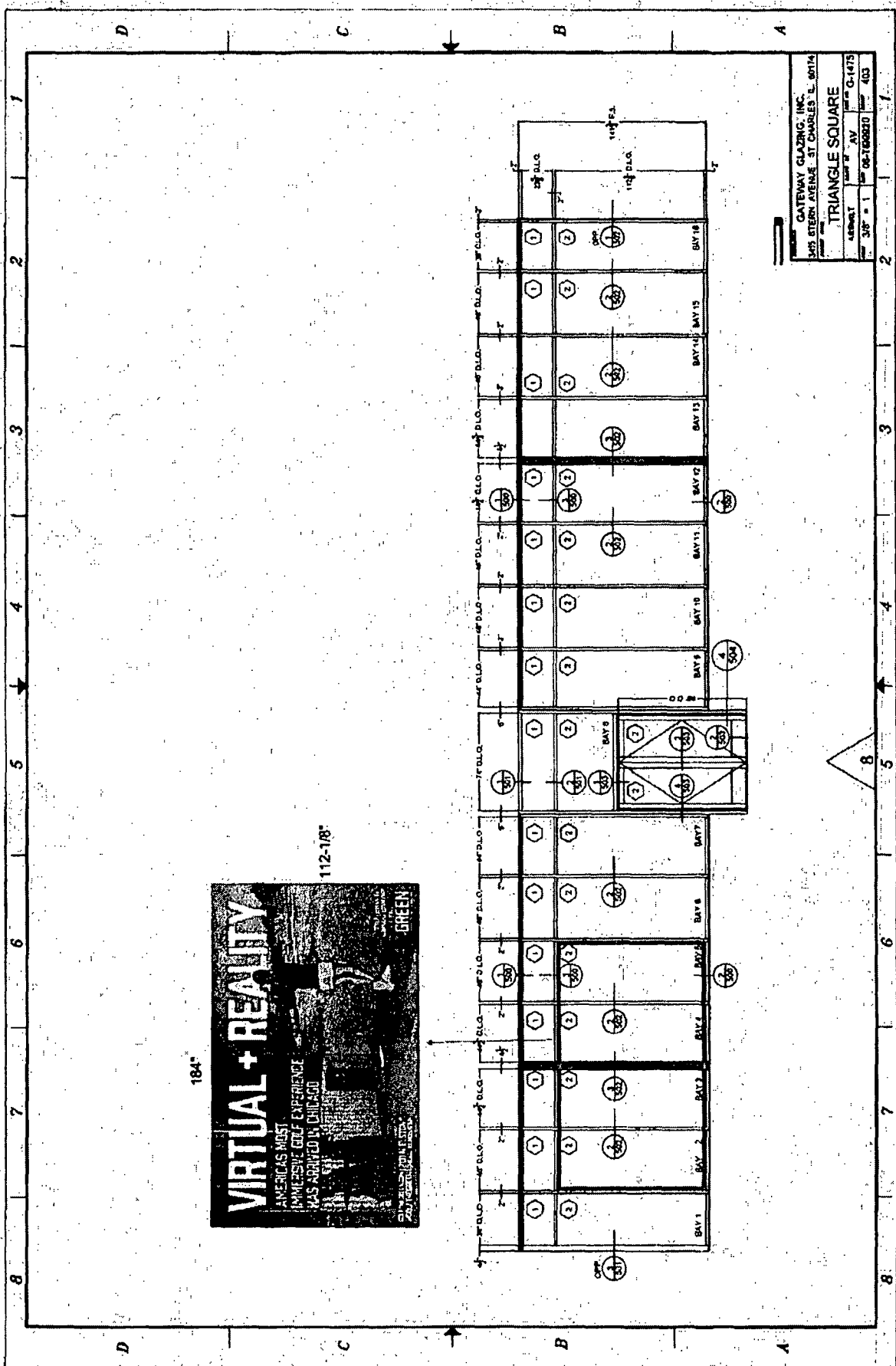

GATEWAY GLAZING, INC.
 3405 STERN AVENUE - ST CHARLES, IL 60114
TRIANGLE SQUARE
 PROJECT NO. AV 1000
 SHEET NO. 403



184'

112-1/8'