



Office of Chicago City Clerk



O2011-735

Office of the City Clerk

City Council Document Tracking Sheet

Meeting Date:	2/9/2011
Status:	Introduced
Sponsor(s):	Fioretti, Bob (2)
Type:	Ordinance
Title:	Vacation of portions of W 14th St and S Paulina St
Committee(s) Assignment:	Committee on Transportation and Public Way



City of Chicago
Richard M. Daley, Mayor

Department of Transportation

30 North LaSalle Street
Suite 1100
Chicago, Illinois 60602-2570
(312) 744-3600
(312) 744-7215 (TTY)
www.cityofchicago.org/transportation

January 26, 2011

Ms. Mara S. Georges
Corporation Counsel
Room 600 - City Hall
Chicago, IL. 60602-1289

Attention: Mr. Steven Holler
Deputy Corporation Counsel

Re: Proposed **Street and Alley Vacation**
File No.: **19-02-09-3150**

Dear Ms. Georges:

Pursuant to a request from the Illinois Medical District, we are transmitting herewith for your review and approval as to form and legality an original and three (3) copies of a proposed vacation of a portion of W. 14th Street, W. 14th Place, S. Paulina Avenue and the 16 foot public alleys in the blocks bounded by W. Hastings Avenue, S. Ashland Avenue, W. 15th Street and the CTA right-of-way. This property is located in the 2nd Ward.

The person to contact in connection with this proposed ordinance is Mr. Kenneth E. Scheiwe, Technical Counsel, Illinois Medical District, Phone No. 312-633-3434.

Section 2 of the ordinance reserves an easement for Commonwealth Edison, AT & T-Illinois/SBC and Comcast. Section 3 of the ordinance reserves an easement for the Chicago Transit Authority. Section 4 of the ordinance reserves an easement for Peoples Gas Light and Coke Company. Section 5 of the ordinance provides for compensation for that part of the public alley to be vacated and for a deposit to be made to the Department of Transportation to ensure that the required construction of curb and walk across the entrance of that part of the alley vacated, will be completed. Section 6 of the ordinance provides for the recording of a certified copy of the ordinance. Section 7 is the take effect clause.

Sincerely,

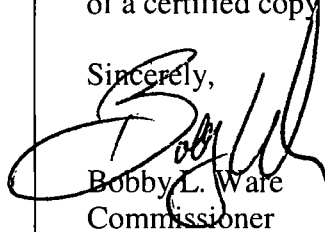

Bobby L. Ware
Commissioner

Originated by:



Luann Hamilton
Deputy Commissioner

BLW: LH: mw

cc: Alderman Robert Fioretti
Alderman Anthony Beale
Saundra Foreman/w Attach. Dwg.



VACATION ORDINANCE

WHEREAS, the City of Chicago ("City") is a home rule unit of local government pursuant to Article VII, Section 6 (a) of the 1970 constitution of the State of Illinois and, as such, may exercise any power and perform any function pertaining to its government and affairs; and

WHEREAS, the properties bounded by W. Hastings Street, the Chicago Transit Authority elevated tracks immediately west of S. Paulina Avenue, W. 15th Street and S. Ashland Avenue are owned by the Illinois Medical District (the "Property"); and

WHEREAS, the Illinois Medical District proposes to assemble properties including the portion of the streets and alleys to be vacated herein; and

WHEREAS, the City Council of the City of Chicago, after due investigation and consideration, has determined that the nature and extent of the public use and the public interest to be subserved is such as to warrant the vacation of parts of public streets and alleys described in the following ordinance; now therefore,

BE IT ORDAINED BY THE CITY COUNCIL OF THE CITY OF CHICAGO:

SECTION 1. ALL THOSE PARTS OF WEST 14TH STREET, WEST 14TH PLACE AND SOUTH PAULINA STREET, LYING ADJACENT TO STINSON'S SUBDIVISION OF BLOCKS 15, 16, 17 AND 18 IN THE DIVISION OF SECTION 19, TOWNSHIP 39 NORTH, RANGE 14 EAST OF THE THIRD PRINCIPAL MERIDIAN, TOGETHER WITH THE 16 FOOT PUBLIC ALLEYS LYING WITHIN SAID SUBDIVISION OF BLOCKS, AND CONTAINED WITHIN THE FOLLOWING BOUNDED AND DESCRIBED PARCEL OF LAND:

BEGINNING AT THE INTERSECTION OF THE SOUTH LINE OF WEST HASTINGS STREET WITH THE WEST LINE OF SOUTH ASHLAND AVENUE;

THENCE SOUTH ALONG SAID WEST LINE, 924.90 FEET TO THE NORTH LINE OF WEST 15TH STREET;

THENCE WEST ALONG SAID NORTH LINE, 144.00 FEET TO THE WEST LINE OF THE FIRST PUBLIC ALLEY WEST OF SOUTH ASHLAND AVENUE;

THENCE NORTH ALONG SAID WEST LINE AND THE NORTH AND SOUTH EXTENSION THEREOF, 594.60 FEET TO THE SOUTH LINE OF WEST 14TH STREET;

THENCE WEST ALONG SAID SOUTH LINE, 456.00 FEET TO THE EAST LINE OF SOUTH PAULINA STREET;

THENCE SOUTH ALONG THE SAID EAST LINE, 594.60 FEET TO THE NORTH LINE OF WEST 15TH STREET;

THENCE WEST ALONG SAID NORTH LINE 162.00 FEET TO WEST LINE OF LOT 97 IN STINSON'S SUBDIVISION OF BLOCK 18, AFORESAID;

THENCE NORTH ALONG SAID WEST LINE 124.15 FEET TO THE SOUTH LINE OF A 16 FOOT PUBLIC ALLEY ADJACENT TO LOT 97 IN STINSON'S SUBDIVISION OF BLOCK 18, AFORESAID;

THENCE EAST ALONG SAID SOUTH LINE, 24.00 FEET TO THE SOUTHERLY EXTENSION OF THE WEST LINE OF LOT 53 IN STINSON'S SUBDIVISION OF BLOCK 18, AFORESAID;

THENCE NORTH ALONG SAID WEST LINE OF LOT 53 AND ITS SOUTHERLY AND NORTHERLY EXTENSION, 206.15 FEET TO THE NORTH LINE OF WEST 14TH PLACE;

THENCE WEST ALONG SAID NORTH LINE, 18.30 FEET TO A LINE 18.30 FEET WEST OF AND PARALLEL WITH THE EAST LINE OF LOT 47 IN STINSON'S SUBDIVISION OF BLOCK 18, AFORESAID;

THENCE NORTH ALONG THE LAST MENTIONED PARALLEL LINE 145.15 FEET TO A LINE 8.00 NORTH OF AND PARALLEL WITH THE SOUTH LINE OF LOT 4 IN STINSON'S SUBDIVISION OF BLOCK 18, AFORESAID;

THENCE WEST ALONG SAID PARALLEL LINE 5.70 FEET TO THE WEST LINE OF LOT 4 IN STINSON'S SUBDIVISION OF BLOCK 18, AFORESAID;

THENCE NORTH 446.45 ALONG THE WEST LINE OF LOTS 54 AND 97 IN STINSON'S SUBDIVISION OF BLOCK 15, AFORESAID, BEING ALSO THE WEST LINE OF LOT 4 IN STINSON'S SUBDIVISION OF BLOCK 18, AFORESAID TO THE SOUTH LINE OF WEST HASTINGS STREET;

THENCE EAST ALONG SAID SOUTH LINE OF WEST HASTINGS STREET, 762.00 FEET TO SAID WEST LINE OF SOUTH ASHLAND AVENUE AND THE POINT OF BEGINNING, IN COOK COUNTY, ILLINOIS as indicated by the words "TO BE VACATED" on the drawing hereto attached, which drawing for greater certainty, is hereby made a part of this ordinance, be and the same are hereby vacated and closed, inasmuch as the same are no longer required for public use and the public interest will be subserved by such vacation.

SECTION 2. The City of Chicago hereby reserves for the benefit of Commonwealth Edison, AT&T-Illinois/SBC and Comcast, their successors or assigns, an easement to operate, maintain, construct, replace, and renew overhead poles, wires, and associated equipment and underground conduit, cables, and associated equipment for the transmission and distribution of electrical energy, telephonic, cable television and associated services under, over, and along the streets and alleys as herein vacated, with the right of ingress and egress.

SECTION 3. The City of Chicago hereby reserves for the benefit of the Chicago Transit Authority the West 16 feet, more or less, of those portions, as herein vacated, of W. 14th Street and W. 14th Place, located between W. Hastings Street on the north and W. 15th Street on the south, lying between the Eastern property line of the Chicago Transit Authority elevated right-of-way and S. Paulina Street; and the West 16 feet, more or less, of those portions, as herein vacated, of the three east/west 16 foot alleys located between W. Hastings Street on the north and W. 15th Street on the south, lying between the Eastern property line of the Chicago Transit Authority elevated right-of-way and S. Paulina Street (collectively referred to as "property that is subject to CTA reservation of rights") for the operation, maintenance, repair, renewal or replacement of the elevated structure, support columns, platforms and related facilities with the right of ingress and egress in said area at all times for the above-stated purposes. It is further provided that no buildings or other structures shall be erected on the property that is subject to CTA reservation of rights or other use made of the property that is subject to CTA reservation of rights which would interfere with the operation, maintenance, repair, renewal or replacement of said facilities.

SECTION 4. The City of Chicago hereby reserves for the benefit of The Peoples Gas Light and Coke Company an easement to operate, maintain, repair, renew and replace existing underground facilities in all of the "to be vacated" public streets and alleys,

with the right of ingress and egress at all times for any and all such purposes. It is further provided that no buildings or other structures shall be erected on said easement herein reserved for The Peoples Gas Light and Coke Company or other use made of the said area which would interfere with the construction, operation, maintenance, repair, removal, or replacement of said facilities.

SECTION 5. The vacation herein provided for is made upon the express condition that within 365 days after the passage of this ordinance, the Illinois Medical District shall deposit in the City Treasury of the City of Chicago a sum sufficient to defray the costs of removing paving and curb returns and constructing sidewalk and curb across the entrance to that part of public streets and alleys hereby vacated. The precise amount of the sum so deposited shall be ascertained by the Commissioner of Transportation after such investigation as is requisite.

SECTION 6. The vacations herein provided for are made upon the express condition that within 365 days after the passage of this ordinance, the Illinois Medical District shall file or cause to be filed for the record in the office of the Recorder of Deeds of Cook County, Illinois a certified copy of this ordinance, together with an attached drawing approved by authorized staff of the Maps and Plats Unit of the Chicago Department of Transportation.

SECTION 7. This ordinance shall take effect and be in force from and after its passage.

Vacation Approved:

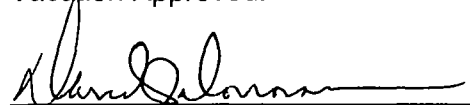
for Bobby L. Ware
Commissioner of Transportation

Approved as to Form and Legality

Deputy Corporation Counsel

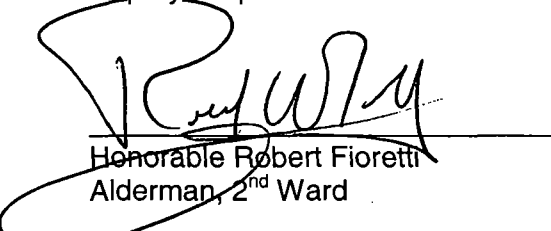

Honorable Robert Fioretti
Alderman, 2nd Ward

GREMLEY & BIEDERMANN

A Division of
PLCS Corporation
LICENS. NO. 04-005132

PROFESSIONAL LAND SURVEYORS
4508 SOUTH PLATINUM AVENUE, CANTON, N.Y. 14050
TELEPHONE (716) 445-9322 FAX (716) 724-4444 EMAIL INFO@PLCS-CORP.COM

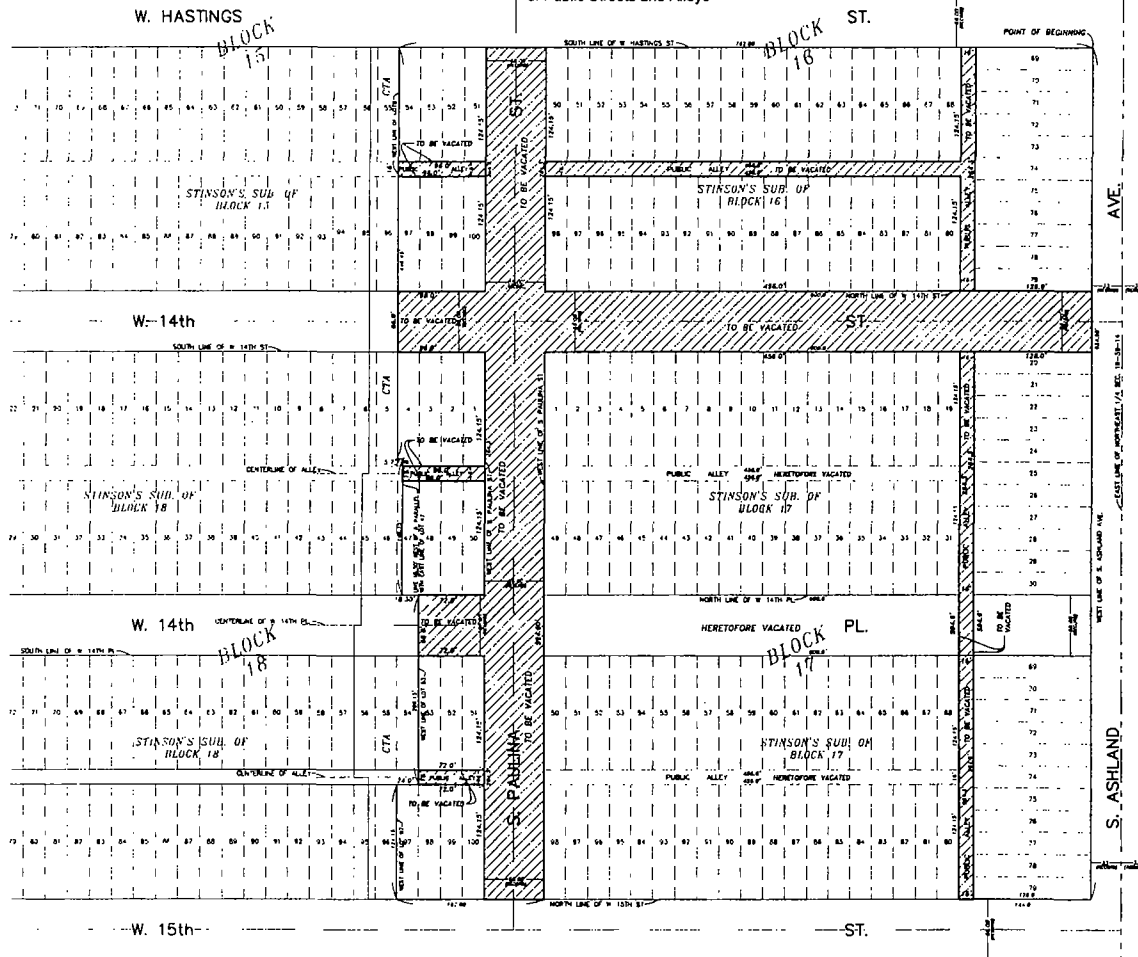
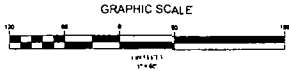
Plat of Vacation of Public Streets and Alleys



ALL THOSE PARTS OF WEST 14TH STREET, WEST 14TH PLACE AND SOUTH ASHLAND STREET, 1/2 THRU AND ADJACENT TO STINSON'S SUBDIVISION OF BLOCKS 15, 16, 17 AND 18 IN THE CONVEYANCE BY SECTION 18, 18TH JUNE 1876 AS NOTED HEREIN AS EAST OF THE SAID INTERSECTION TOGETHER WITH THE 14 FOOT PUBLIC ALLEY LATER SET OUT IN THE SUBDIVISION OF BLOCKS 15 AND 16 CONTAINED WITHIN THE WELLSBORO BOUNDARY AND DESCRIBED HEREIN OF LAND

BEGINNING AT THE INTERSECTION OF THE SOUTH LINE OF WEST HASTINGS STREET WITH THE WEST LINE OF SOUTH ASHLAND AVENUE;

THENCE NORTH ALONG SAID WEST LINE 8.48 FEET TO THE NORTH LINE OF WEST 14TH STREET;

THENCE WEST ALONG SAID NORTH LINE 1.86 FEET TO THE WEST LINE OF THE FIRST PUBLIC ALLEY WEST OF SOUTH ASHLAND AVENUE;

THENCE NORTH ALONG SAID WEST LINE 86 FEET AND NORTH AND SOUTH EXTENSION THEREOF, 33.84 FEET TO THE SOUTH LINE OF WEST 14TH STREET;

THENCE WEST ALONG SAID SOUTH LINE, 4.82 FEET TO THE EAST LINE OF SOUTH ASHLAND STREET;

THENCE NORTH ALONG THE 14 FOOT EAST LINE, 3.82 FEET TO THE NORTH LINE OF WEST 14TH STREET;

THENCE WEST ALONG SAID NORTH LINE 1.86 FEET TO THE WEST LINE OF LOT 27 IN STINSON'S SUBDIVISION OF BLOCK 15, APPROXIMATE;

THENCE NORTH ALONG SAID WEST LINE 124.19 FEET TO THE SOUTH LINE OF A 16 FOOT PUBLIC ALLEY ADJACENT TO LOT 27 IN STINSON'S SUBDIVISION OF BLOCK 15, APPROXIMATE;

THENCE EAST ALONG SAID SOUTH LINE, 3.40 FEET TO THE WEST LINE OF THE SOUTHERLY EXTENSION OF THE WEST LINE OF LOT 23 IN STINSON'S SUBDIVISION OF BLOCK 15, APPROXIMATE;

THENCE NORTH ALONG THE WEST LINE OF LOT 17 AND ITS SOUTHERLY AND WINDINGLY EXTENSION, 10.11 FEET TO THE NORTH LINE OF WEST 14TH STREET;

THENCE WEST ALONG SAID NORTH LINE, 4.8 FEET TO A LINE 1.25 FEET WEST OF AND PARALLEL WITH THE EAST LINE OF LOT 17 IN STINSON'S SUBDIVISION OF BLOCK 15, APPROXIMATE;

THENCE NORTH ALONG THE LAST MENTIONED PARALLEL LINE 10.11 FEET TO A LINE 1.25 FEET WEST OF AND PARALLEL WITH THE WEST LINE OF LOT 4 IN STINSON'S SUBDIVISION OF BLOCK 15, APPROXIMATE;

THENCE WEST ALONG SAID PARALLEL LINE 1.25 FEET TO THE WEST LINE OF LOT 4 IN STINSON'S SUBDIVISION OF BLOCK 15, APPROXIMATE;

THENCE NORTH AND SOUTH ALONG THE WEST LINE OF LOTS 4 AND 5 IN STINSON'S SUBDIVISION OF BLOCK 15, APPROXIMATE, 1.25 FEET WEST OF THE WEST LINE OF WEST 14TH STREET;

THENCE WEST ALONG THE SOUTH LINE OF WEST 14TH STREET, 1.25 FEET TO SAID WEST LINE OF SOUTH ASHLAND AVENUE AND THE POINT OF BEGINNING IN COCK COURT, SENeca.

REVISED 12-7-10 EAST BNDY PFR ORDER NO. 2010-14828 [E5]
REVISED 12-3-10 PLR ORDER NO. 2010-14809 [E5]
REVISED 8-17-2009 REV. ORDER NO. 2009-13064 [A17]

DESIGNED BY: **GREMLEY & BIEDERMANN**
CHECKED BY: **GREMLEY & BIEDERMANN**

GREMLEY & BIEDERMANN
PLCS Corporation
4508 SOUTH PLATINUM AVENUE
CANTON, NY 14050
PHONE (716) 445-9322 FAX (716) 724-4444 EMAIL INFO@PLCS-CORP.COM

ORDER NO. **2009-12687-001**
DATE: **JUNE 4, 2009**
SCALE: **AS SHOWN**
SHEET: **1 of 1**

NOTES
DIMENSIONS AND NUMBER IN PLAT AND ORIGINAL PLATS THEREOF COMPARE ALL POINTS BEFORE BLOCKS BY NAME AND IN ORDER REPORT ANY DISCREPANCIES
NO DIMENSIONS SHALL BE ASSUMED BY SCALE MEASUREMENT UPON THIS PLAT
UNLESS OTHERWISE NOTED HEREON THE BEARING DATA, ELEVATION DATA AND COORDINATE DATA P LINED IN ARE SHOWN
COPYRIGHT GREMLEY & BIEDERMANN, INC. 2009. ALL RIGHTS RESERVED.

STATE OF ALABAMA
COUNTY OF COCAHULE
I, David S. Jett, A PROFESSIONAL ALABAMA LAND SURVEYOR, DO HEREBY CERTIFY THAT I HAVE PREPARED THE PLAT HEREON DRAWN FROM PREVIOUS PLATS AND RECORDS FOR VACATION PURPOSES AS SHOWN ON THE PLAT HEREON DRAWN. DIMENSIONS ARE SHOWN IN FEET AND DECIMAL PARTS THEREOF.

DRAWN BY: David S. Jett
BY: David S. Jett
PROFESSIONAL ALABAMA LAND SURVEYOR NO. 3726
MY LICENSE EXPIRES November 30, 2012

