



Office of the Chicago City  
Clerk



O2011-9764

Office of the City Clerk

City Council Document Tracking Sheet

<b>Meeting Date:</b>	12/14/2011
<b>Sponsor(s):</b>	Dowell, Pat (3)
<b>Type:</b>	Ordinance
<b>Title:</b>	Issuance permits for sign(s)/signboard(s) at 3658 S Wentworth Ave
<b>Committee(s) Assignment:</b>	Committee on Zoning, Landmarks and Building Standards

## ORDINANCE

**Be it ordained by the City of Chicago:**

**Section 1.** That the Commissioner of Buildings is hereby authorized and directed to issue a sign permit to M-K Signs, Inc., 4900 N. Elston Avenue, Chicago, IL 60630, for the election of a sign/signboard over 24 feet in height and / or 100 square feet (in area of one face) at Progressive Baptist Church 3658 S. Wentworth, Chicago, IL 60640, (East Elevation), with the dimensions, height and square foot area:

**Dimensions:** length: 58'7" height: 5'0"

**Height above grade to top of sign:** 17'0"

**Total Square foot area:** 293 square feet

Notwithstanding any provisions of Title 17 of the Municipal Code, of the City of Chicago (the Chicago Zoning Ordinance) to the contrary, the Commissioner of Buildings is hereby directed and authorized to issue a sign permit to the address referenced within this ordinance.

**Section 2.** This ordinance shall be in force and effect from and after its passage and due publication.

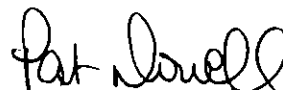

---

Pat Dowell  
Alderman, 3rd Ward



CITY OF CHICAGO

## DEPARTMENT OF BUILDINGS

## Sign Permit Application

APPROVAL NUMBER	APPLICATION NUMBER 100420808	ANNUAL FEE	WORK CODE	DRAWINGS ATTACHED <input type="checkbox"/> YES <input type="checkbox"/> NO
DATE OF APPLICATION 12/03/2011			TYPE OF SIGN FLAT OR BOX	
ADDRESS OF SIGN 3658 S WENTWORTH AVE, 60609-			LENGTH	FT 58
BUILDING			IN	7
ORIGINAL PERMIT NUMBER			HEIGHT	FT 5
TYPE OF PERMIT NEW CONSTRUCTION (SIGN)			AREA	SQ FT 293
PAYER OF ANNUAL INSPECTION COLLINS, REV. W 3658 S. WENTWORTH AVE CHICAGO, IL 60609 (773)545-4444			WEIGHT	LBS 400
SIGN MANUFACTURER M-K SIGNS, INC			SIGN HEIGHT ABOVE GRADE/ROOF FT 12	
ADDRESS WHERE SIGN CAN BE SEEN PRIOR TO ERECTION			SHAPE OF SIGN REGULAR	
TICKET NUMBER 0			SIGN WILL READ PROGRESSIVE BAPTIST CHURCH	
REINSPECTION CONTROL NUMBER			NO OF LAMPS 16	
TYPE OF SUPPORT FOR SIGN BUILDING			TOTAL WATTAGE 1760	
SIGN BOARD SUPPORT MEMBERS STEEL			TYPE OF LAMP FLUORESCENT	
ANNUAL FEE CONSTRUCTION FEE 1017 B FEE TOTAL FEE AMOUNT PAID BALANCE DUE			NO OF BALLAST/TRANSFORMERS 4	
			INPUT OF TRANSFORMERS 120	
			CONTRACTOR WILL INSTALL	
			<input checked="" type="checkbox"/> FEEDERS <input checked="" type="checkbox"/> CUSTOMER LEADS	
			TYPE OF SWITCH KNIFE	
			LOCATION OF SWITCH OUTSIDE SIGN	
			SIGN LOCATION PROGRESSIVE BAPTIST CHURCH WALL DISPLAY, OPAGUE BACKGROUND /W ILLUMINATED LETTERS	

The undersigned certify that the statements in this application are true and correct and that all work done under the proposed permit will conform to the requirements of the Chicago Municipal Code

ELECT CONTR M-K SIGNS, INC.	REG. NO E05834	BOND NO	REG NO E05834
ADDRESS 4900 N. ELSTON AVE. CHICAGO, IL 60630	ELECTR	SIGN ERECTOR M-K SIGNS, INC.	SIGNER
SUPERVISOR SIGNATURE		ADDRESS 4900 N. ELSTON AVE. CHICAGO IL 60630	
		SIGNATURE	

The permit issued on this application will authorize only signs here applied for If other signs are to be erected they must be covered by additional permits

City of Chicago  
Rahm Emanuel, MayorDepartment of Buildings  
Michael Merchant, Commissioner

TYPE OF BUSINESS <input checked="" type="checkbox"/> COMMERCIAL      Other _____ Name: <u>PROGRESSIVE BAPTIST CHURCH</u> LIC # _____ Renewal Date: _____	SIGN BOND REQUIRED? <input type="checkbox"/> YES COUNCIL ORDER REQUIRED <input checked="" type="checkbox"/> YES IS SPECIAL PERMISSION REQUIRED FROM CHIEF ELECTRICAL <input type="checkbox"/> YES IF YES, ATTACH LETTER OF REQUEST
Projects Over: <input checked="" type="checkbox"/> Private Property <input checked="" type="checkbox"/> Public Way      Grant Permit # _____ <input checked="" type="checkbox"/> Planned Development/Manufacturing      PMD/PD# <u>PD-183</u> Zoning District: <u>M1</u> Other: _____	TIME STAMP
TYPE OF SIGN: <input type="checkbox"/> ADVERTISING <input checked="" type="checkbox"/> ILLUMINATE <input type="checkbox"/> MOVEABLE <input checked="" type="checkbox"/> BUSINESS <input type="checkbox"/> FLASHING	
TOTAL STREET FRONTAGE OF LOT (IN FEET) <u>550</u>	
TOTAL AREA OF NEW SIGN (SQ.FT.) <u>293</u>	
TOTAL AREA OF ALL SIGNS ON LOT (SQ.FT.) <u>12</u>	
HEIGHT OF SIGN ABOVE GRADE (TO TOP) <u>17ft 0in</u>	
DISTANCE OF CURB LINE OUTER EDGE (ft) <u>15</u> DISTANCE OF STRUCTURE INNER EDGE (ft) <u>17</u>	SIGN CLERK _____ APPROVED FOR PERMIT _____
DISTANCE FROM (ft) A. PUBLIC PARK (OVER 10 ACRES) <u>0</u> B. EXPRESSWAY (IF LESS THAN 1,000 FT.) <u>150</u> C. RESIDENCE DISTRICT (ADVERTISING SIGNS ONLY) <u>0</u>	REMARKS
IF REPLACEMENT SIGN OR CHANGE OF FACE, WHAT DOES THE EXISTING SIGN READ?  Original Payee: _____	
Landmark Hold: <input type="checkbox"/> Status: _____	
ZONING (OFFICE USE ONLY)	

**CITY OF CHICAGO**  
**DEPARTMENT OF ZONING AND LAND USE PLANNING**  
**SIGN SITE PLAN**  
(ALL INFORMATION MUST BE COMPLETED AND LEGIBLE)

Site Address: 3658 S WENTWORTH 1 of 1 applications

Sign Company: M-K SIGNS, INC Rep Name: ANTHONY CILIA

Phone (773) 545-4444 EXT        (Below: Building, streets and location of sign on lot or structure)  
North

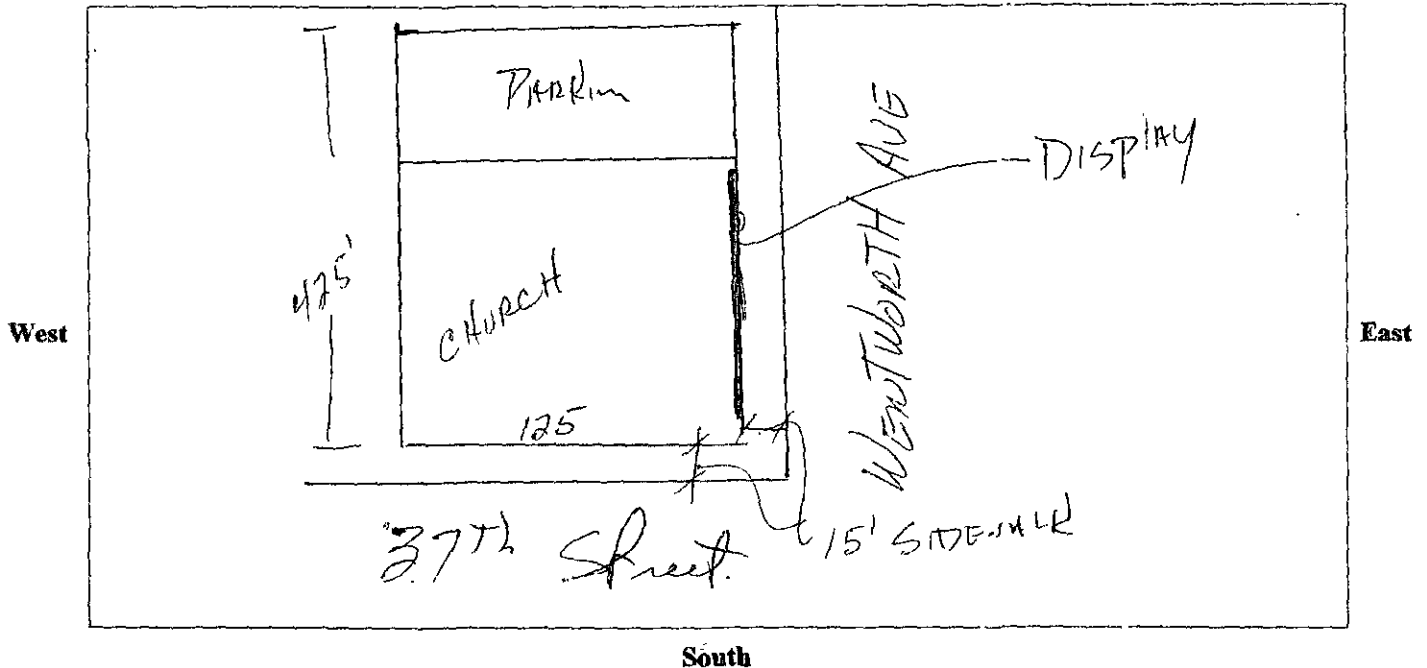

**SIGN USE:**

Bus. ID (On-premise) ☒  
Business Lice. # ☐

Advertising (Off-premise) ☐

**PERMIT TYPE:**

New Construction ☒  
Change of Face ☐  
Previous Permit # ☐

**TYPE OF SIGN:**

Flat Wall ☒  
Freestanding ☐  
Awning ☐  
Marquee ☐  
High Rise Building ☐  
Projecting Private ☒  
Projecting Public Way ☐  
Public Way Use -Permit # ☐

**SIGN CHARACTERISTICS:**

Non- Illuminated ☐  
Illuminated ☒  
Changing Image ☐  
Video Display ☐  
Flashing ☐

**DISTANCE FROM:**

Curb Line: 15  
Expressway, Toll Roads  
or Major Route  
(n/a if over 1000 ft) 150  
Park (over 10 acres) —  
Residential Zone —  
Existing Off-premise on  
same side of street: —

**TOTAL SQUARE FOOTAGE:**

Square footage of this proposed sign 293  
Gross area of all proposed signs 293  
Area of all existing signs  
(not including proposed) on Zoning Lot 12

Signature: Anthony Cilia

(Revised 4/10)

Date: 12-5-11

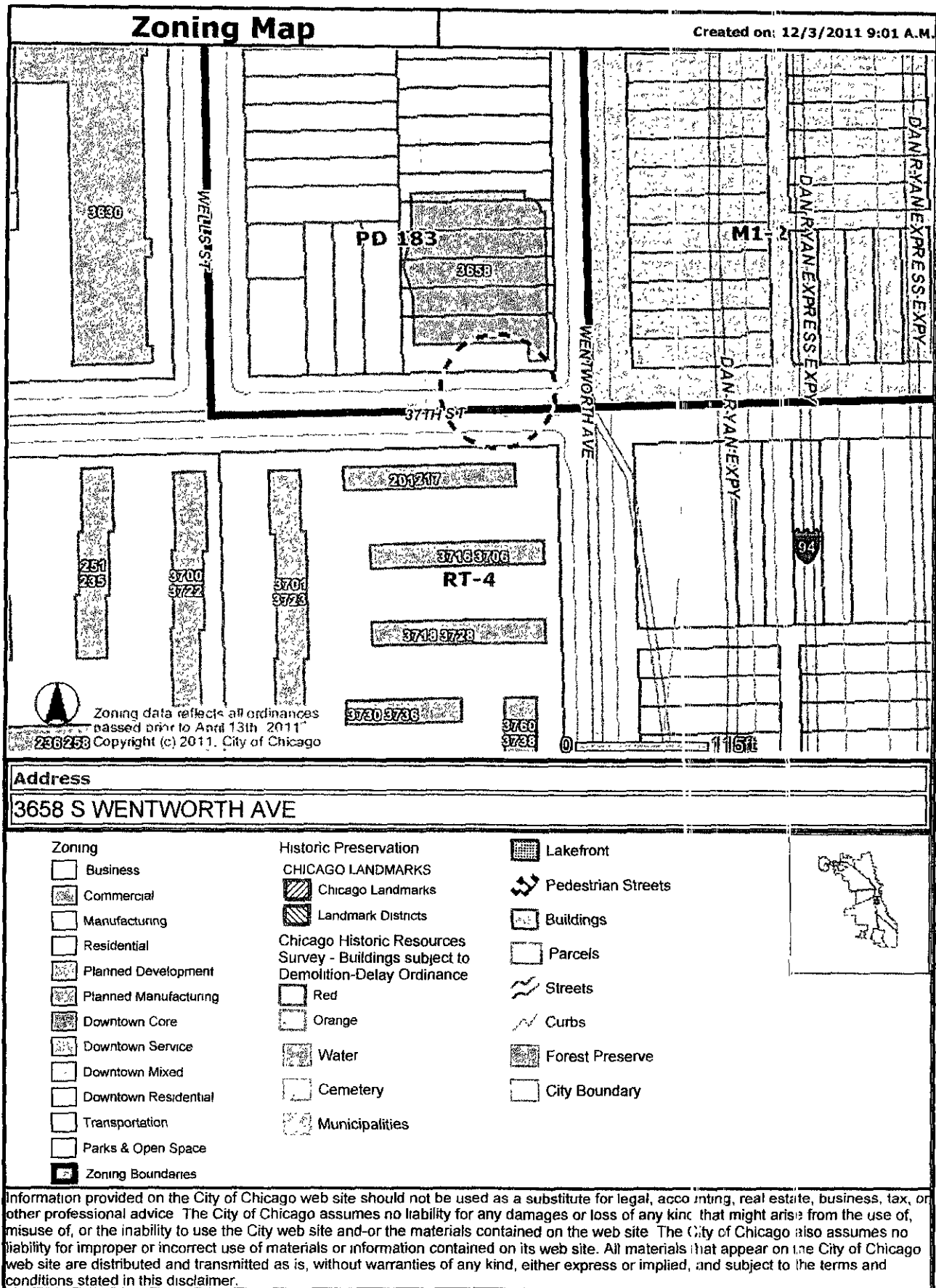

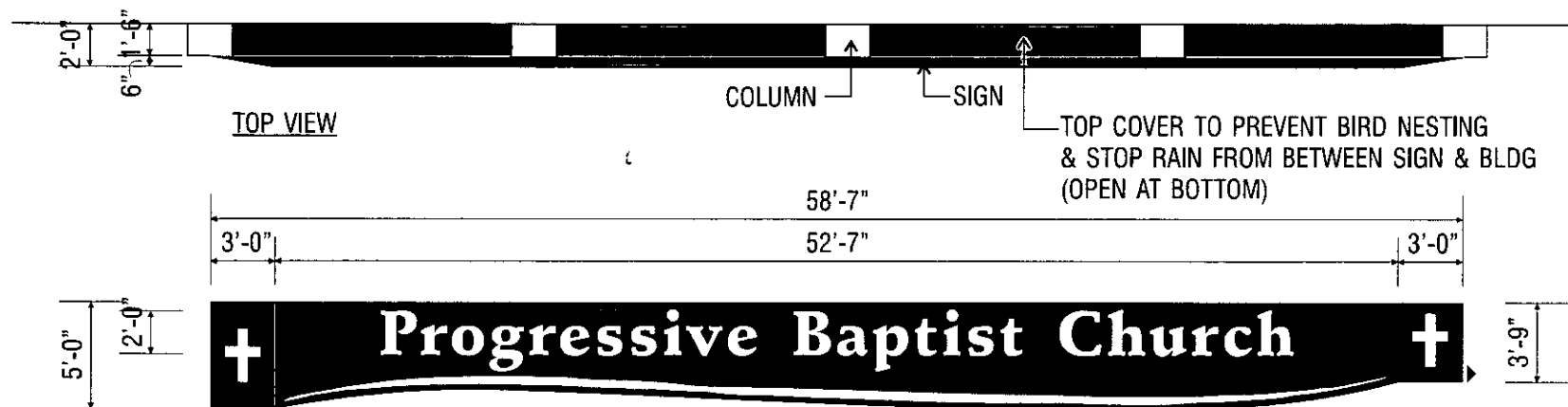

**OPTION #1** (1) S/F ILLUMINATED SIGN

ALUM. SIGN CABINET - BLACK  
 COPY ROUTED OUT W/ WHITE PLEX PUSH-THRU LETTERS  
 UNDERSCORE ROUTED OUT W/ LT. BLUE PLEX PUSH-THRU  
 WHITE VINYL CROSSES ON END PANELS  
 ILLUMINATION - T8 H.O. LAMPS

SERVICE DOORS AT BACK OF SIGN  
 ► SAFETY SWITCH



APPROVED: \_\_\_\_\_ DATE: \_\_\_\_\_

**M-K SIGNS**  
 CHICAGO  
 4900 N. ELSTON AVE  
 CHICAGO, IL 60630  
 773/545-4444  
 FAX 773/545-0042  
 E-MAIL: artdept@mksigns.net

PROGRESSIVE BAPTIST CHURCH CHICAGO, IL		SCALE	DATE
Colors represented in this drawing are for presentation purposes only. They will not match your finished product exactly. Actual color samples can be obtained from your sales representative. This design is the original and unpublished work of MK SIGNS and may not be reproduced, copied or exhibited in any fashion without the expressed written consent of MK SIGNS. The rights to this design may be purchased.	DATE	1/8" = 1'-0"	7-12-11
	REVISION	DESIGNER	SALES
	7-14-11	LM	RC
	7-18-11	FILE	DRAWING NUMBER
	8-12-11	Progressive	2000-5