



Office of the Chicago City  
Clerk



SO2011-9764

Office of the City Clerk

City Council Document Tracking Sheet

<b>Meeting Date:</b>	12/14/2011
<b>Sponsor(s):</b>	Dowell, Pat (3)
<b>Type:</b>	Ordinance
<b>Title:</b>	Issuance permits for sign(s)/signboard(s) at 3658 S Wentworth Ave
<b>Committee(s) Assignment:</b>	Committee on Zoning, Landmarks and Building Standards

From:Alderman Solis

312 744 6572

01/22/2012 19:40

#147 P.003/003

**SUBSTITUTE ORDER****BE IT ORDAINED BY THE CITY COUNCIL OF THE CITY OF CHICAGO:**

**SECTION 1.** That the Commissioner of Buildings is hereby authorized and directed to issue a sign permit to M-K Signs, Inc., 4900 N Elston Avenue Chicago IL 60630, for the erection of a sign/signboard over 24 feet in height and/ or over 24 feet in height and/or over 100 sq.ft. (in area of one face) at Progressive Baptist Church, 3658 S Wentworth, Chicago IL 60640 (East Elevation) with the dimensions, height and sq.ft. area:

Dimensions: length 58'7 feet; height, 5 feet  
Height Above Grade / Roof to top of Sign: 17 feet  
Total Square Foot Area: 293 Square Feet

Such a sign will comply with all applicable provisions of TITLE 17 of the Chicago Zoning Ordinance and all other applicable provisions of the Municipal Code of the City of Chicago governing the construction and maintenance of outdoor signs, signboards and structures

3658 S Wentworth



Pat Dowell  
Alderman, 3<sup>rd</sup> Ward



CITY OF CHICAGO

**DEPARTMENT OF BUILDINGS****Sign Permit Application**

APPROVAL NUMBER	APPLICATION NUMBER 100420808	ANNUAL FEE	WORK CODE	DRAWINGS ATTACHED <input type="checkbox"/> YES <input type="checkbox"/> NO
-----------------	---------------------------------	------------	-----------	--

DATE OF APPLICATION 12/03/2011		TYPE OF SIGN FLAT OR BOX			
ADDRESS OF SIGN 3658 S WENTWORTH AVE, 60609-		LENGTH 58	FT 58	IN 7	HEIGHT 5
BUILDING	ORIGINAL PERMIT NUMBER	AREA 293	SQ FT 293	WEIGHT 400	LBS 400
TYPE OF PERMIT NEW CONSTRUCTION (SIGN)		SIGN HEIGHT ABOVE GRADE/ROOF 12			
PAYER OF ANNUAL INSPECTION COLLINS, REV. W. 3658 S. WENTWORTH AVE CHICAGO, IL 60609 (773)545-4444		SHAPE OF SIGN REGULAR			
SIGN MANUFACTURER M-K SIGNS, INC.		SIGN WILL READ PROGRESSIVE BAPTIST CHURCH			
ADDRESS WHERE SIGN CAN BE SEEN PRIOR TO ERECTION		NO OF LAMPS 16		TOTAL WATTAGE 1760	
		TYPE OF LAMP FLUORESCENT			
		NO OF BALLAST/TRANSFORMERS 4		INPUT OF TRANSFORMERS 120	
TICKET NUMBER 0		REINSPECTION CONTROL NUMBER		CONTRACTOR WILL INSTALL <input checked="" type="checkbox"/> N FEEDERS <input checked="" type="checkbox"/> Y CUSTOMER LEADS	
TYPE OF SUPPORT FOR SIGN BUILDING		TYPE OF SWITCH KNIFE			
SIGN BOARD SUPPORT MEMBERS STEEL		LOCATION OF SWITCH OUTSIDE SIGN			
ANNUAL FEE		SIGN LOCATION PROGRESSIVE BAPTIST CHURCH WALL DISPLAY, OPAQUE BACKGROUND /W ILLUMINATED LETTERS			
CONSTRUCTION FEE 200.00					
1017 B FEE					
TOTAL FEE 200.00					
AMOUNT PAID 200.00					
BALANCE DUE					

The undersigned certify that the statements in this application are true and correct and that all work done under the proposed permit will conform to the requirements of the Chicago Municipal Code

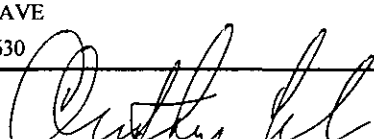
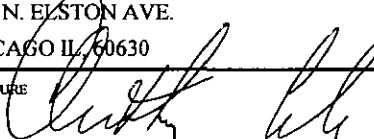
ELECT CONTR M-K SIGNS, INC.	REG NO E05834
ADDRESS 4900 N. ELSTON AVE CHICAGO, IL 60630	SIGN ERECTOR M-K SIGNS, INC.
SUPERVISOR SIGNATURE 	SIGNER 

The permit issued on this application will authorize only signs here applied for. If other signs are to be erected they must be covered by additional permits.

City of Chicago  
Rahm Emanuel, MayorDepartment of Buildings  
Michael Merchant, Commissioner

TYPE OF BUSINESS <u>COMMERCIAL</u> Other: _____ Name: <u>PROGRESSIVE BAPTIST CHURCH</u> LIC #: _____ Renewal Date: _____	SIGN BOND REQUIRED? <input type="checkbox"/> YES COUNCIL ORDER REQUIRED <input checked="" type="checkbox"/> YES IS SPECIAL PERMISSION REQUIRED FROM CHIEF ELECTRICAL <input type="checkbox"/> YES IF YES, ATTACH LETTER OF REQUEST
Projects Over: <input checked="" type="checkbox"/> Private Property <input checked="" type="checkbox"/> Public Way Grant Permit #: _____ <input checked="" type="checkbox"/> Planned Development/Manufacturing PMD/PD# <u>PD-183</u> Zoning District <u>M1</u> Other: _____	TIME STAMP
TYPE OF SIGN: <input type="checkbox"/> ADVERTISING <input checked="" type="checkbox"/> ILLUMINATE <input type="checkbox"/> MOVEABLE <input checked="" type="checkbox"/> BUSINESS <input type="checkbox"/> FLASHING	
TOTAL STREET FRONTAGE OF LOT (IN FEET) _____ 550	
TOTAL AREA OF NEW SIGN (SQ FT) _____ 293	
TOTAL AREA OF ALL SIGNS ON LOT (SQ FT) _____ 12	
HEIGHT OF SIGN ABOVE GRADE (TO TOP) _____ 17ft 0in	SIGN CLERK _____ APPROVED FOR PERMIT _____
DISTANCE OF CURB LINE OUTER EDGE (ft) _____ 15	
DISTANCE OF STRUCTURE INNER EDGE (ft) _____ 17	
DISTANCE FROM (ft)  A. PUBLIC PARK (OVER 10 ACRES) _____ 0 B. EXPRESSWAY (IF LESS THAN 1,000 FT.) _____ 150 C. RESIDENCE DISTRICT (ADVERTISING SIGNS ONLY) _____ 0	REMARKS
IF REPLACEMENT SIGN OR CHANGE OF FACE, WHAT DOES THE EXISTING SIGN READ?  _____ _____ _____	
Original Payee: _____ _____ _____	
Landmark Hold: <input type="checkbox"/> Status: _____ ZONING (OFFICE USE ONLY)	

**CITY OF CHICAGO**  
**DEPARTMENT OF ZONING AND LAND USE PLANNING**  
**SIGN SITE PLAN**  
(ALL INFORMATION MUST BE COMPLETED AND LEGIBLE)

Site Address: 3658 S WENTWORTH 1 of 1 applications

Sign Company: M-K SIGNS, INC Rep Name: ANTHONY CILIA

Phone (773) 545-4444 EXT        (Below: Building, streets and location of sign on lot or structure)  
North

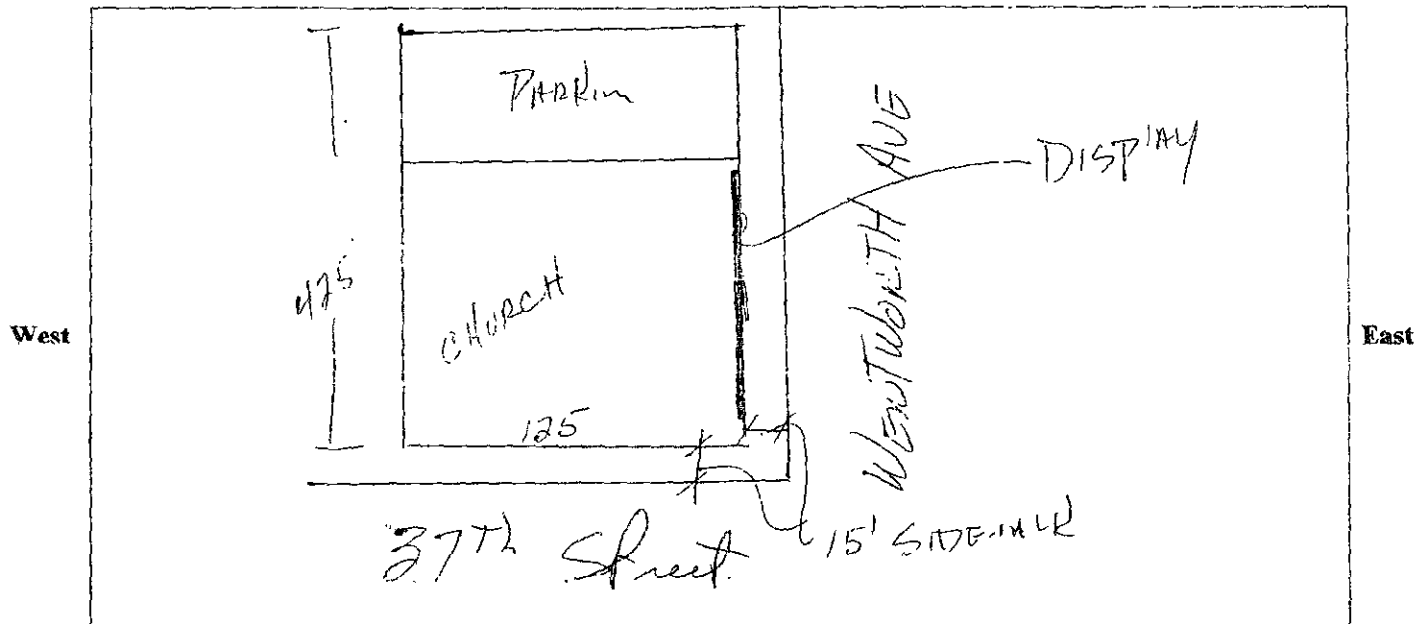

**SIGN USE:**

Bus. ID (On-premise) ☒

Business Lice. #       

Advertising (Off-premise) ☐

**PERMIT TYPE:**

New Construction ☒

Change of Face ☐

Previous Permit #       

**TYPE OF SIGN:**

Flat Wall ☒

Freestanding ☐

Awning ☐

Marquee ☐

High Rise Building ☐

Projecting Private ☒

Projecting Public Way ☐

Public Way Use -Permit #       

**SIGN CHARACTERISTICS:**

Non-Illuminated ☐

Illuminated ☒

Changing Image ☐

Video Display ☐

Flashing ☐

**DISTANCE FROM:**

Curb Line: 15

Expressway, Toll Roads

or Major Route

(n/a if over 1000 ft) 150

Park (over 10 acres) —

Residential Zone —

Existing Off-premise on

same side of street: —

**TOTAL SQUARE FOOTAGE:**

Square footage of this proposed sign 293

Gross area of all proposed signs 293

Area of all existing signs

(not including proposed) on Zoning Lot 12

Signature: Anthony Cilia

(Revised 4/10)

Date: 12-5-11

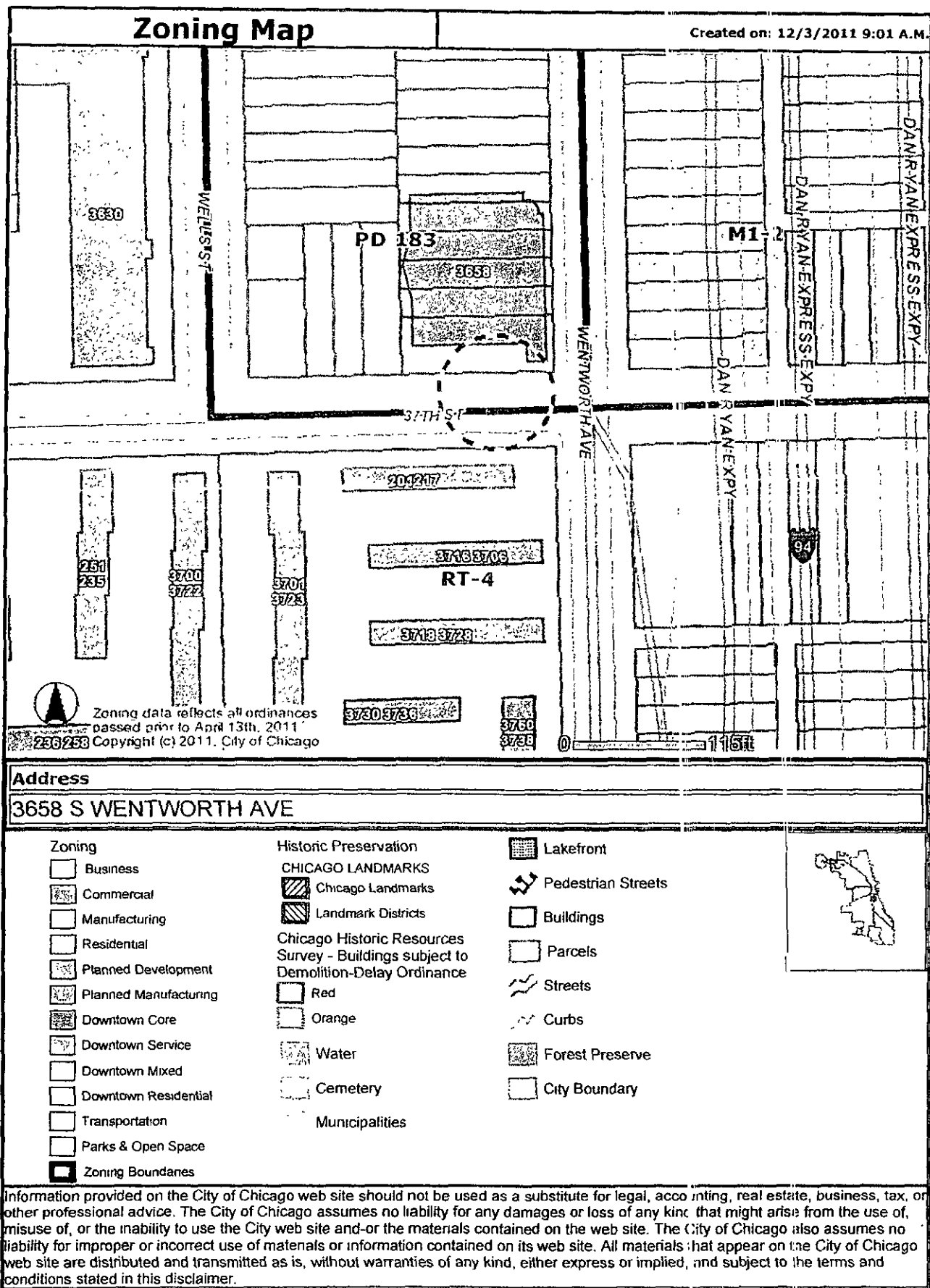

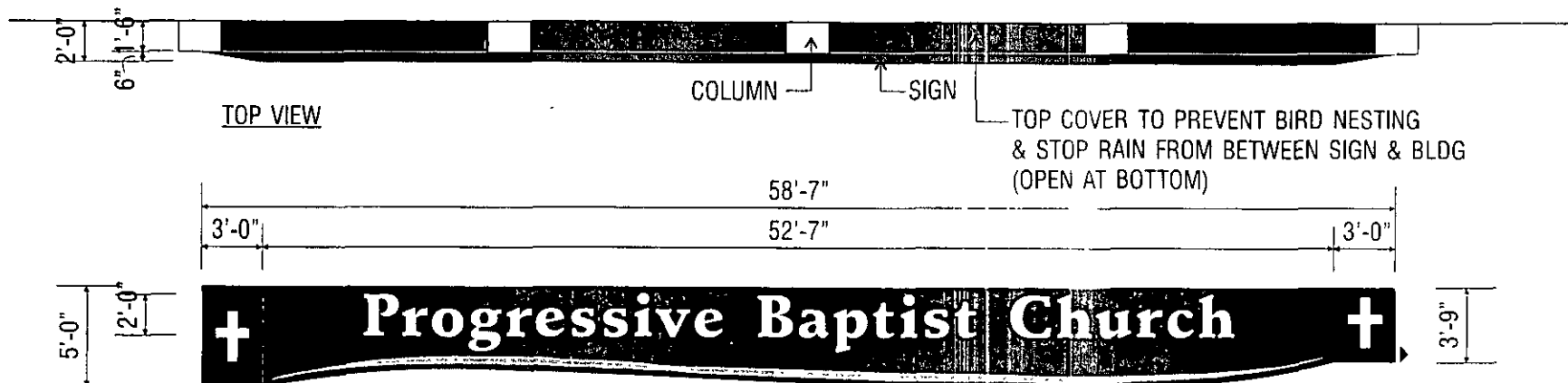

**OPTION #1 (1) S/F ILLUMINATED SIGN**

ALUM. SIGN CABINET - BLACK  
COPY ROUTED OUT W/ WHITE PLEX PUSH-THRU LETTERS  
UNDERScore ROUTED OUT W/ LT. BLUE PLEX PUSH-THRU  
WHITE VINYL CROSSES ON END PANELS  
ILLUMINATION - T8 H.O. LAMPS

SERVICE DOORS AT BACK OF SIGN  
▶ SAFETY SWITCH



APPROVED: \_\_\_\_\_ DATE: \_\_\_\_\_

**M-K SIGNS**  
CHICAGO

4900 N. ELSTON AVE.  
CHICAGO, IL 60630

773/545-4444  
FAX 773/545-0042  
E-MAIL: artdept@mksigns.net

**PROGRESSIVE BAPTIST CHURCH**  
CHICAGO, IL

Colors represented in this drawing are for presentation purposes only  
They will not match your finished product exactly  
Actual color samples can be obtained from your sales representative

This design is the original and unpublished work of MK SIGNS and may not be reproduced, copied or exhibited in any fashion without the expressed written consent of MK SIGNS. The rights to this design may be purchased

DATE	REVISION	SCALE	DATE
7-14-11		1/8" = 1'-0"	7-12-11
7-18-11		DESIGNER	SALES
8-12-11		LM	RC
		FILE	DRAWING NUMBER
		Progressive	2000-5