



City of Chicago



Or2014-7

Office of the City Clerk

Document Tracking Sheet

Meeting Date:	1/15/2014
Sponsor(s):	Waguespack (32)
Type:	Order
Title:	Issuance of permits for sign(s)/signboard(s) at 1030 W North Ave - Kingsbury St elevation
Committee(s) Assignment:	Committee on Zoning, Landmarks and Building Standards

Committee on Buildings

(signs)

ORDERED: That the Commissioner of Buildings is hereby directed to issue a sign permit to: (Contractor's name and address)

Landmark Sign Group
7424 Industrial Ave.
Chesterton, IN 46304

for the erection of a sign/signboard over 24 feet in height and/or over 100 square feet (in area of one face) at: (Business NAME & ADDRESS)

Life Storage - Permit # 100520214 (Kingsbury)
1030 W. North Ave.
Chicago IL 60642

Dimensions: length 10' height 22'

height above grade/roof to top of sign 40'

TOTAL SQUARE FOOT AREA 220

Such sign(s) shall comply with all applicable provisions of TITLE 17 of the Chicago Zoning Ordinance and all other applicable provisions of the Municipal Code of the City of Chicago governing the construction and maintenance of outdoor signs, signboards and structures.

Scott Waguespack
Alderman, Ward 32
Waguespack

12255 West 187th Street
Mokena, Illinois 60448
(708) 479-8385

File : LandmrkSgn039c.mod

Site : Life Storage
1030 West North Avenue
Chicago, Illinois

Sign Type : 22'-0" x 10'-0" two piece single face sign for installation on 18" thick brick wall using thru bolts and back-up plates. The upper ID section is 10'-0" x 10" x 12" deep with a 12'-0" x 10'-0" lower multi tenant section that is 8" deep.
Drawing No. 1311126 rev. A

Design Wind Load : (PSF) $WL := 30.0$ Based on the Chicago Building Code 16 (13-52-310) (f) 1a.

Design Snow Load : (PSF) $SL := 25.0$ Based on the Chicago Building Code 16 (13-52-280) (a) for flat roofs.

Reference : Manual of Steel Construction, AISC 13th Edition.

Mounting Bolts : ASTM A-307 $F_u = 60.0 \text{ ksi.}$; $F_t = 20.00 \text{ ksi.}$; $F_v = 10.00 \text{ ksi.}$

Design Loads for the Upper ID Section :

Dead Load :

Based on 4.5 lbs. per Square Foot : $\text{ShrUpDL} := (10.0 \cdot 10.0) \cdot 4.5$ $\text{ShrUpDL} = 450 \text{ lbs.}$

Wind Load :

Suction : $\text{ShrUpWL} := (10.0 \cdot 10.0) \cdot WL$ $\text{ShrUpWL} = 3000 \text{ lbs.}$

Snow Load :

All Exposed Surfaces : $\text{ShrUpSL} := \left[10.0 \cdot \left(\frac{12.0}{12} \right) \right] \cdot SL$ $\text{ShrUpSL} = 250 \text{ lbs.}$

Combined Shear :

Summation : (lbs.) $\text{ShrUpSgn} := \sqrt{(\text{ShrUpDL} + \text{ShrUpWL})^2 + (\text{ShrUpSL} + \text{ShrUpWL})^2}$
 $\text{ShrUpSgn} = 4739.726$

Design of Mounting Bolts for the Upper ID Section :

Mounting Bolt Diameter : (in.) $\text{MntBltDia} := 0.75$

Stress Area : (in.²) $\text{MntBltArea} := \frac{\pi \cdot \text{MntBltDia}^2}{4}$ $\text{MntBltArea} = 0.442$
(Based on nominal diameter per AISC 4-3)

Allowable Tension : (lbs.) $\text{AllwTen} := 20000 \cdot \text{MntBltArea}$ $\text{AllwTen} = 8836$

Allowable Shear : (lbs.) $\text{AllwShr} := 10000 \cdot \text{MntBltArea}$ $\text{AllwShr} = 4418$

Number of Mounting Bolts : $\text{NoBlts} := 8$

Shear per Mounting Bolt : (lbs.) $\text{ShrMntBlt} := \frac{\text{ShrUpSgn}}{\text{NoBlts}}$ $\text{ShrMntBlt} = 592.466$



$$\text{Tension Load per Mounting Bolt : (lbs.)} \quad \text{TenMntBlt} := \frac{\text{ShrUpWL}}{\text{NoBlts}} \quad \text{TenMntBlt} = 375$$

$$\text{Unity Check :} \quad \text{UCMntBlt} := \frac{\text{ShrMntBlt}}{\text{AllwShr}} + \frac{\text{TenMntBlt}}{\text{AllwTen}} \quad \text{UCMntBlt} = 0.177 < 1.00 \quad \text{OK}$$

Mounting Bolts

Note : Use 3/4" diameter ASTM A-307 all thread rod, nuts and washers with 1/4" thick x 4" x 4" steel plate washers on the inside of the building.

Design Loads for the Lower Tenant Section :

Dead Load :

$$\text{Based on 4.5 lbs. per Square Foot :} \quad \text{ShrLwrDL} := (12.0 \cdot 10.0) \cdot 4.5 \quad \text{ShrLwrDL} = 540 \quad \text{lbs.}$$

Wind Load :

$$\text{Suction :} \quad \text{ShrLwrWL} := (12.0 \cdot 10.0) \cdot \text{WL} \quad \text{ShrLwrWL} = 3600 \quad \text{lbs.}$$

Combined Shear :

$$\text{Summation : (lbs.)} \quad \text{ShrLwrSgn} := \sqrt{(\text{ShrLwrDL} + \text{ShrLwrWL})^2 + (\text{ShrLwrWL})^2}$$

$$\text{ShrLwrSgn} = 5486.31$$

Design of Mounting Bolts for the Lower Tenant Section :

$$\text{Mounting Bolt Diameter : (in.)} \quad \text{MntBltDia} := 0.75$$

$$\text{Stress Area : (in.}^2\text{)} \quad \text{MntBltArea} := \frac{\pi \cdot \text{MntBltDia}^2}{4} \quad \text{MntBltArea} = 0.442$$

(Based on nominal diameter per AISC 4-3)

$$\text{Allowable Tension : (lbs.)} \quad \text{AllwTen} := 20000 \cdot \text{MntBltArea} \quad \text{AllwTen} = 8836$$

$$\text{Allowable Shear : (lbs.)} \quad \text{AllwShr} := 10000 \cdot \text{MntBltArea} \quad \text{AllwShr} = 4418$$

$$\text{Number of Mounting Bolts :} \quad \text{NoBlts} := 12$$

$$\text{Shear per Mounting Bolt : (lbs.)} \quad \text{ShrMntBlt} := \frac{\text{ShrLwrSgn}}{\text{NoBlts}} \quad \text{ShrMntBlt} = 457.193$$

$$\text{Tension Load per Mounting Bolt : (lbs.)} \quad \text{TenMntBlt} := \frac{\text{ShrLwrWL}}{\text{NoBlts}} \quad \text{TenMntBlt} = 300$$

$$\text{Unity Check :} \quad \text{UCMntBlt} := \frac{\text{ShrMntBlt}}{\text{AllwShr}} + \frac{\text{TenMntBlt}}{\text{AllwTen}} \quad \text{UCMntBlt} = 0.137 < 1.00 \quad \text{OK}$$

Mounting Bolts

Note : Use 3/4" diameter ASTM A-307 all thread rod, nuts and washers with 1/4" thick x 4" x 4" steel plate washers on the inside of the building.



Mrs. Frank Campbell

Ald. Copy



CITY OF CHICAGO

DEPARTMENT OF BUILDINGS

Sign Permit Application

APPROVAL NUMBER	APPLICATION NUMBER 100520214	ANNUAL FEE	WORK CODE	DRAWINGS ATTACHED <input type="checkbox"/> YES <input type="checkbox"/> NO
-----------------	---------------------------------	------------	-----------	--

DATE OF APPLICATION 12/05/2013		TYPE OF SIGN FLAT OR BOX															
ADDRESS OF SIGN 1030 W NORTH AVE, 60642-		LENGTH	FT. 10	IN 0	HEIGHT	FT. 22	IN. 0										
BUILDING	ORIGINAL PERMIT NUMBER	AREA		SQ FT 220	WEIGHT		LBS. 1,000										
TYPE OF PERMIT NEW CONSTRUCTION (SIGN)		SIGN HEIGHT ABOVE GRADE/ROOF					FT. 40										
PAYER OF ANNUAL INSPECTION LIFESTORAGE, . 1030 W NORTH AVE CHICAGO, IL 60642 (312)397-0001																	
SIGN MANUFACTURER LANDMARK SIGN																	
ADDRESS WHERE SIGN CAN BE SEEN PRIOR TO ERECTION																	
TICKET NUMBER 0		REINSPECTION CONTROL NUMBER															
TYPE OF SUPPORT FOR SIGN BUILDING																	
SIGN BOARD SUPPORT MEMBERS STEEL																	
ANNUAL FEE		<table border="1" style="width:100%; border-collapse: collapse;"> <tr> <td style="width:50%;">CONSTRUCTION FEE</td> <td style="width:50%;">200.00</td> </tr> <tr> <td>1017 B FEE</td> <td></td> </tr> <tr> <td>TOTAL FEE</td> <td>200.00</td> </tr> <tr> <td>AMOUNT PAID</td> <td>200.00</td> </tr> <tr> <td>BALANCE DUE</td> <td></td> </tr> </table>						CONSTRUCTION FEE	200.00	1017 B FEE		TOTAL FEE	200.00	AMOUNT PAID	200.00	BALANCE DUE	
CONSTRUCTION FEE	200.00																
1017 B FEE																	
TOTAL FEE	200.00																
AMOUNT PAID	200.00																
BALANCE DUE																	
		<div style="border: 1px solid black; padding: 2px; display: inline-block;">Check # for Zoning</div>															
		<div style="border: 1px solid black; padding: 2px; display: inline-block;">Check # for DCAP</div>															

SHAPE OF SIGN REGULAR		SIGN WILL READ LIFESTORAGE & THREE TENANT PANELS			
NO. OF LAMPS 20		TOTAL WATTAGE 1200			
TYPE OF LAMP FLUORESCENT					
NO. OF BALLAST/TRANSFORMERS 3		INPUT OF TRANSFORMERS 120			
CONTRACTOR WILL INSTALL		<input checked="" type="checkbox"/> FEEDERS <input checked="" type="checkbox"/> CUSTOMER LEADS			
TYPE OF SWITCH SPECIAL					
LOCATION OF SWITCH OUTSIDE SIGN					
SIGN LOCATION KINGSBURY STREET ELEVATION: ILLUMINATED WALL SIGN - "LIFESTORAGE" & (3) TENANT PANELS.					

The undersigned certify that the statements in this application are true and correct and that all work done under the proposed permit will conform to the requirements of the Chicago Municipal Code

ELECT CONTR VIP TECH ELECTRIC, INC.	REG. NO E94065
ADDRESS 10225 W. PACIFIC FRANKLIN PARK, IL 60131-	
SUPERVISOR SIGNATURE	

BOND. NO.	REG. NO N90730
SIGN ERECTOR LANDMARK OUTD'R ADVERTIS'	SIGNER
ADDRESS 7424 INDUSTRIAL AVE CHESTERTON XXX IN, 46304	
SIGNATURE	

The permit issued on this application will authorize only signs here applied for. If other signs are to be erected they must be covered by additional permits.

City of Chicago
Rahm Emanuel, Mayor



Department of Buildings
Michael Merchant, Commissioner

Page 2 of 2

Ald. Copy

CITY OF CHICAGO • BACP-PWU • BUNDLE PERMIT APPLICATION • V.12.21.12

APPLICATION TO USE THE PUBLIC RIGHT OF WAY



APPLICANT INFORMATION

LEGAL NAME OF ENTITY: Life Storage Centers of Lincoln Park, LLC

PERMIT MAILING ADDRESS: 777 Lake Zurich Rd - #200

CITY: Barrington

STATE: IL

ZIP CODE: 60010

CONTACT PERSON: Iwona Lach

TITLE: Marketing Coordinator

PHONE: 847.382.0567

FAX: 847.852.1399

E-MAIL: iwona@lifestorage.net

BUILDING OWNER INFORMATION

NAME: Jean L Jodoin

ADDRESS: 777 Lake Zurich Rd - #200

CITY: Barrington

STATE: IL

ZIP CODE: 60010

PHONE: 847.382.0560

FAX: 847.852.1399

E-MAIL: jean@lifestorage.net

USE OF THE PUBLIC WAY

1. List the proposed or existing use below and complete the worksheet on page 3.
Use only one application for all public way use type.

TYPE	HOW MANY?	BUILDING ADDRESS
Signs	4	1030 W North Ave
Awnings	2	1030 W North Ave
Banners	7	1030 W North Ave

2. Please enclose one sketch of each proposed use of the public way, which maps to scale the proposed use(s) and its relationship to surrounding right-of-way. All measurements must be indicated. The prints should also accurately depict the location of the property line and public facilities (meters, light poles, sidewalks).

APPLICANT CERTIFICATION

I hereby certify that all statements made as part of the application, and the attachments herein, are true to the best of my knowledge and belief.

BY: [Signature]
F.E.I.N. or SOCIAL SECURITY NUMBER:

TITLE: MANAGING PARTNER

ALDERMAN'S APPROVAL

As part of this application process, you are required to notify/seek approval from the Alderman in whose ward your proposed use of the public way is located.

ALDERMAN'S SIGNATURE: [Signature]

DATE: 11/8/2013

WARD: 32

Approval shall not be withheld for any reason relating to the language, content or message contained in or implied by the sign, canopy, awning, banner or marquee for which the permit is sought. If alderman's signature indicating approval is not received by BACP within 60 days of submission of the application to the alderman then, provided the application is complete and accurate and the applicant is not in violation of any pertinent provision of the Municipal Code, the application shall be deemed approved by the BACP and processed for submission to the City Council as a Mayoral Introduction.

☐ Approve Reason(s):

☐ Do Not Approve Reason(s):



Department of Business Affairs and Consumer Protection (BACP) Business Assistance Center (BAC)
Public Way Use Unit (PWU) • City Hall, Room 800 • 121 North LaSalle Street, Chicago, Illinois 60602
www.cityofchicago.org/bacp • 312.74.GOBIZ (744.6249) • 312.742.1974 (TTY)

APPLICATION TO USE THE PUBLIC RIGHT OF WAY



APPLICATION WORKSHEET

- For use by **NEW APPLICANTS ONLY**.
- For renewals obtain form from City Hall, 121 N LaSalle St., Rm 800 or call (312) 74 - GOBIZ (744-6249)

Complete the worksheet for each use of the public way and indicate all applicable measurements

Exact Street (i.e. S. State St.)	Quantity	Length of structure along public way	Height of structure	Depth of structure	Height above grade	Total depth over public way	Is this sign(s) illuminated? (Y/N)	Is this an Existing Public Way Use (Y/N)
W. North Ave.	1	5'2"	7'6"	24"	12'	6'	Y	Y
N. Kingsbury St.	1	5'2"	7'6"	24"	12'	6'	Y	Y
N. Kingsbury St.	1	10'	22'	10"	40'	10"	Y	Y
N. Kingsbury St.	1	5'	12'	18"	14'	5'	Y	Y
N. Kingsbury St.	1	13'8"	4'6"	1'8"	11'	1'8"	N	Y
N. Kingsbury St.	1	12'5"	4'6"	1'8"	11'	1'8"	N	Y
Banners								
W. North Ave.	7	2'	8'	1/32"	12'	2'	N	Y

Blade Sign ①

Blade Sign ②

Wall Sign ③

Blade Sign ④

Awning ①

Awning ②

See example of required plans beginning on page 4.

NOTE: Pursuant to section 2-154-030 of the Municipal Code of the City of Chicago the Corporation Counsel of the City of Chicago may require any such additional information from any applicant to achieve full disclosure relevant to the request for action by the City Council or other city agency. Pursuant to section 2-154-020 of the Municipal code of the City of Chicago any material change in the information required above must be provided by supplementing this statement at any time up to the time the City Council or any city agency takes action on the application.



City of Chicago | Department of Business Affairs and Consumer Protection | Public Way Use Unit
Business Assistance Center | City Hall Room 800 | 121 North LaSalle Street | Chicago, Illinois 60602
www.cityofchicago.org/bacp | 312 74 GOBIZ (744 6249) | 312 742 1974 (TTY)



APPLICATION CHECKLIST (continued)

☐ Acceptance Letter

ACCEPTANCE OF GRANT OF PRIVILEGE PERMIT TERMS

I hereby understand and accept the terms and conditions relative to the issuance of the permit, and by signing below, I acknowledge the receipt of a copy of the Municipal Code of Chicago's 10-28 and 13-20 regulations, as well as all the additional requirements promulgated herein:

I understand it shall be my duty as the permit holder, and as a condition of the permit, to:

1. Comply with all the requirements defined within Chicago's Municipal Code, the Rules and Regulations, as well as the requirements promulgated herein;
 2. Upon the passage of the permit ordinance at City Council, pay the non-refundable applicable Grant of Privilege annual permit fee.
 3. Upon the submission of the permit application the applicant shall furnish the certificate of insurance; and,
 4. Resolve all Account Holds since failure to do so will prevent the processing of this permit application;
 5. Install or maintain the grant of privilege after the issuance of the permit by the Commissioner of Business Affairs and Consumer Protection;
- I hereby agree to accept the terms and conditions relative to issuance of the permit.
 - I agree to renew the Certificate of Insurance at least 10 days prior to expiration of the policy.
 - I understand that if the item or items are not constructed/maintained the permit fees will not be refunded.

I understand that failure to adhere to all conditions imposed in the permit may result in revocation of the permit.

SIGNATURE: <u>[Signature]</u>	DATE: _____
PRINT NAME: <u>JEAN L. JODON</u>	TITLE: <u>MANAGING PARTNER</u>

ACCOUNT #: <u>2184126</u>	SITE #: _____
LEGAL NAME OF ENTITY: <u>Life Storage Centers of Lincoln Park, LLC</u>	
BUSINESS NAME (DBA): _____	
BUSINESS LOCATION ADDRESS: <u>1030 W North Ave</u>	
CITY: <u>Chicago</u>	STATE: <u>Illinois</u> ZIP CODE: <u>60642</u>
BUSINESS PHONE: <u>847.341.1811</u>	
E-MAIL: <u>lwona@lifestorage.net</u>	PERMIT TYPE: _____



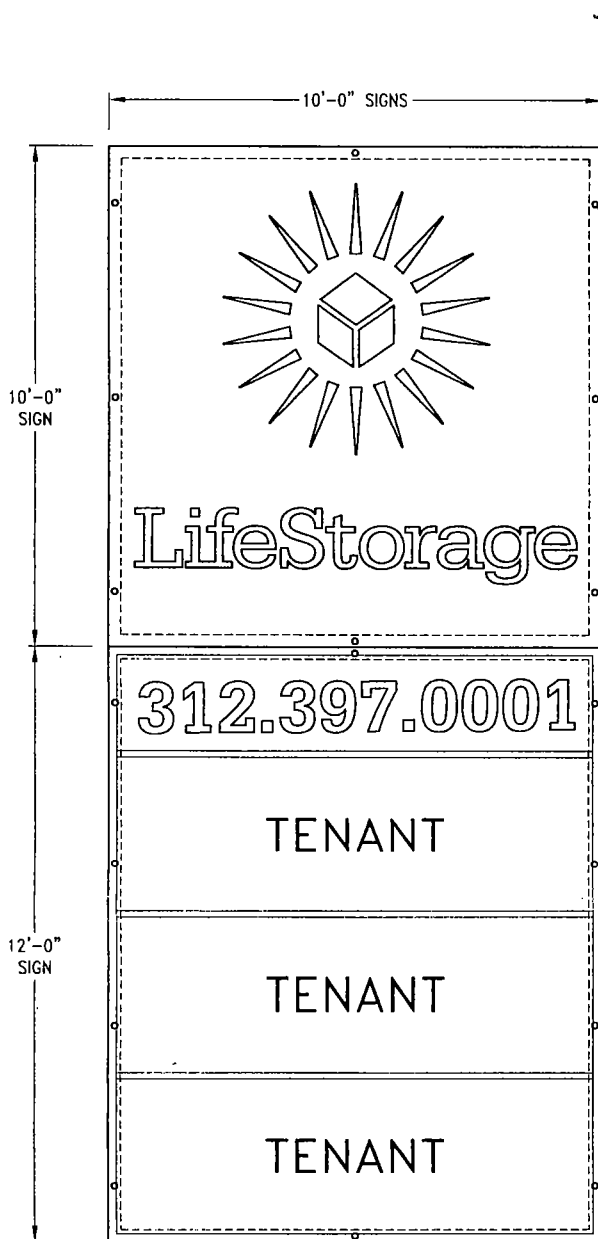

ELEVATION VIEW

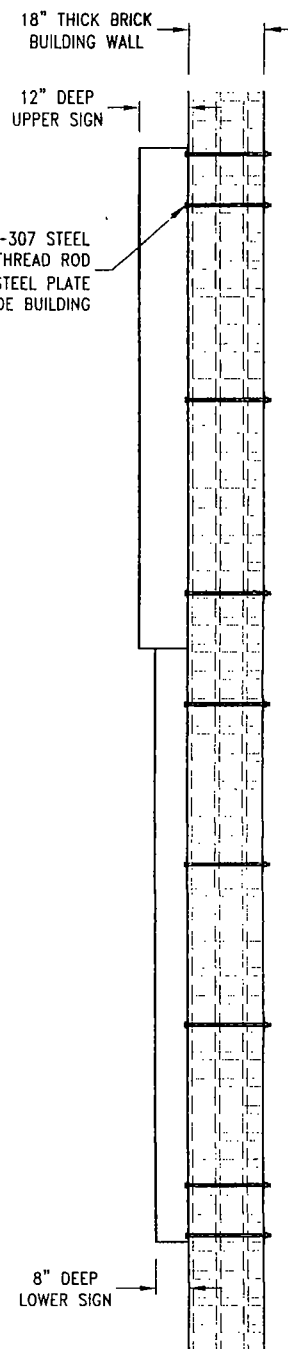

SIDE VIEW

DESIGN WIND LOAD: 30.0 PSF
Based on the Chicago Building Code
16 (13-52-310) (f) 1a.

DESIGN SNOW LOAD: 25.0 PSF
Based on the Chicago Building Code
16 (13-52-280) (a) for flat roofs.

NOTE:

All electrical to be in accordance
with U.L., the NEC and local code.

RLZ
11-29-17

SITE:

Life Storage
1030 West North Avenue
Chicago, Illinois

A	26 Nov 13	RELEASED FOR PERMITTING	J HOGAN
REV	DATE	DESCRIPTION	APPROVED
Robert-James & Associates, Inc. 12255 West 187th Street, Mokena Illinois 60448-9737 phone: 708-479-8385 fax: 708-479-8395 email: rja37@comcast.net			
TITLE 22'-0" x 10'-0" SINGLE FACE SIGN MOUNTED TO BUILDING WALL			
DRAWN BY	D. MUNNS	DATE	26 Nov 13
CHECKED BY	J. HOGAN	DATE	26 Nov 13
SCALE	NONE	DRAWING NUMBER	1311125
SHEET	1 OF 2	REV.	A