

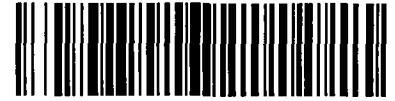

City of Chicago



Or2014-225

Office of the City Clerk

Document Tracking Sheet

Meeting Date:	5/28/2014
Sponsor(s):	Lane (18)
Type:	Order
Title:	Issuance of permits for sign(s)/signboard(s) at 7601 S Cicero Ave - 502 sq. ft.
Committee(s) Assignment:	Committee on Zoning, Landmarks and Building Standards

Committee on Zoning, Landmarks, and Building Standards

(Signs)

ORDERED, That the Commissioner of Buildings is hereby directed to issue a sign permit to: (Contractor's name and address)

Sure Light Sign Company

260 Knox Park Road

Lake Zurich, IL 60047

for the erection of a sign/signboard over 24 feet in height and/or over 100 square feet (in area of one face) at: (Business Name & Address)

American Multi-Cinema, Inc. (AMC)

Permit # 100538203

7601 S. Cicero Ave.

Chicago, IL 60652

Dimensions: Length 27'-6" **Height** 18'-3"
Height above grade/roof to top of sign 21'-3"
TOTAL SQUARE FOOT AREA: 502

Such sign(s) shall comply with all applicable provisions of TITLE 17 of the Chicago Zoning Ordinance and all other applicable provisions of the Municipal Code of the City of Chicago governing the construction and maintenance of outdoor signs, signboards and structures.

Lona Lane, 18th Ward
Alderman Lane Ward 18

amc

13-1554 R3	
Sheet 3 of 4	
AMC Ford City 14	
7801 S. Cleaves Ave Chicago, IL 60622	
Art. No. 7801 S. Cleaves Ave	Shen Macrum
Designer Justin Barabino	
Date 12/19/13	
Client AMC	
Location Chicago, IL	
Project AMC	
Engineer AMC	
Checker AMC	
Reviser AMC	
Estimator AMC	
Manufacturer AMC	
Notes 1. See sheet 13-1554 R1 for details of other signs. 2. See sheet 13-1554 R2 for details of other signs. 3. See sheet 13-1554 R3 for details of other signs.	

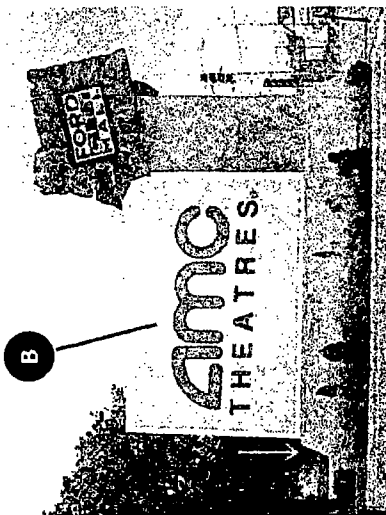
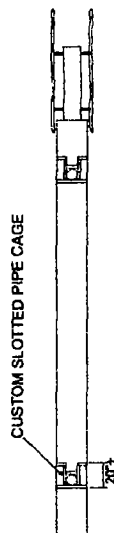

PHOTO SURVEY - BEFORE
NTS

B

PHOTO SURVEY - AFTER
NTS



CUSTOM SLOTTED PIPE CAGE

100.0000

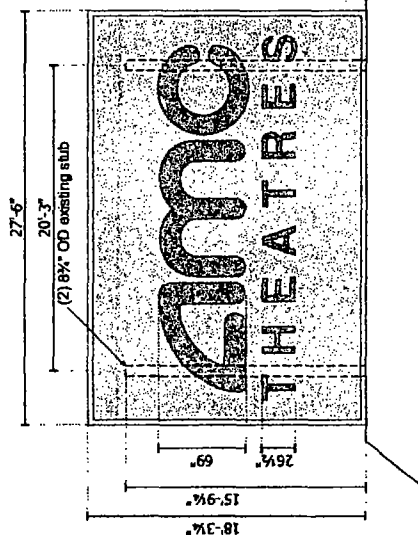

D/F Sign Detail

(1) REQUIRED - MANUFACTURE AND INSTALL.

SCALE: 1/8" = 1'-0"

50. FT. 502.45

REMOVE EXISTING CABINET.
REPLACE WITH NEW D/F CABINET.
4" RETAINERS, FILLER ALL PTD. WHITE
WHITE FLEX FACES WITH PRINTED GRAPHICS.
INTERNALLY ILLUMINATED WITH WHITE LEDS.
SIGN INSTALLS OVER EXISTING SUPPORT STEEL PIPES
AND IS DROPPED IN AND SLID TOWARDS "FORD CITY MALL" ID ELEMENT.

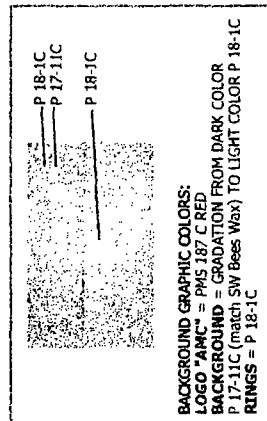

END VIEW

BACKGROUND GRAPHIC COLORS:
LOGO "AMC" = PMS 187 C RED
BACKGROUND = GRADATION FROM DARK COLOR
P 17-11C (match SW Bees Wax) TO LIGHT COLOR P 18-1C
RINGS = P 18-1C

P 18-1C
P 17-11C
P 18-1C

B

FINAL ELECTRICAL
CONNECTION BY
CUSTOMER



CITY OF CHICAGO

DEPARTMENT OF BUILDINGS

Sign Permit Application

APPROVAL NUMBER	APPLICATION NUMBER 100538203	ANNUAL FEE	WORK CODE	DRAWINGS ATTACHED <input type="checkbox"/> YES <input type="checkbox"/> NO
DATE OF APPLICATION 04/29/2014			TYPE OF SIGN FLAT OR BOX	
ADDRESS OF SIGN 7601 S CICERO AVE, 60652-			LENGTH 27	FT 6
BUILDING			HEIGHT 18	IN 3
ORIGINAL PERMIT NUMBER			AREA 502	SQ FT 900
TYPE OF PERMIT NEW CONSTRUCTION (SIGN)			WEIGHT LBS.	
PAYER OF ANNUAL INSPECTION AMERICAN MULTI-CINEMA, INC., 4440 W. 77TH ST., FLOOR 1 CHICAGO, IL 60652 (773)555-5555			SIGN HEIGHT ABOVE GRADE/ROOF FT. 3	
SIGN MANUFACTURER CHANDLER SIGNS			SHAPE OF SIGN REGULAR	
ADDRESS WHERE SIGN CAN BE SEEN PRIOR TO ERECTION			SIGN WILL READ AMC THEATRES	
TICKET NUMBER 0			NO. OF LAMPS 540	
REINSPECTION CONTROL NUMBER			TOTAL WATTAGE 1020	
TYPE OF SUPPORT FOR SIGN GROUND STRUCTURE			TYPE OF LAMP OTHER	
SIGN BOARD SUPPORT MEMBERS STEEL			NO. OF BALLAST/TRANSFORMERS 8	
ANNUAL FEE CONSTRUCTION FEE 1017 B FEE TOTAL FEE AMOUNT PAID BALANCE DUE			INPUT OF TRANSFORMERS 120	
			CONTRACTOR WILL INSTALL	
			<input checked="" type="checkbox"/> FEEDERS <input checked="" type="checkbox"/> CUSTOMER LEADS	
			TYPE OF SWITCH SPECIAL	
			LOCATION OF SWITCH OUTSIDE SIGN	
			SIGN LOCATION SIGN ON THE CORNER OF 76TH & CICERO AVE.: 18'-3" X 27'-6" LED ILLUMINATED MONUMENT SIGN CABINET "AMC THEATRES"	

The undersigned certify that the statements in this application are true and correct and that all work done under the proposed permit will conform to the requirements of the Chicago Municipal Code

REG. NO.	E94598
ELECT CONTR	MARTIN G. SCHANER
ADDRESS	260 KNOX PARK ROAD LAKE ZURICH, IL 60047-
SUPERVISOR SIGNATURE	

BOND. NO.	REG. NO.
SIGN ERECTOR	SURE LIGHT SERVICE CO
ADDRESS	1225 BOWES RD ELGIN IL, 60123-
SIGNATURE	

The permit issued on this application will authorize only signs here applied for. If other signs are to be erected they must be covered by additional permits.

City of Chicago
Rahm Emanuel, MayorDepartment of Buildings
Felicia Davis, Commissioner

TYPE OF BUSINESS <u>COMMERCIAL</u> Other: <u>THEATRE</u> Name: <u>AMC</u> LIC #: <u>1799064</u> Renewal Date: <u>11/15/2015</u>	SIGN BOND REQUIRED? <input type="checkbox"/> YES COUNCIL ORDER REQUIRED <input checked="" type="checkbox"/> YES IS SPECIAL PERMISSION REQUIRED FROM CHIEF ELECTRICAL <input type="checkbox"/> YES IF YES, ATTACH LETTER OF REQUEST
Projects Over: <input checked="" type="checkbox"/> Private Property <input checked="" type="checkbox"/> Public Way Grant Permit #: _____ <input type="checkbox"/> Planned Development/Manufacturing PMD/PD#: _____ Zoning District: <u>B3</u> Other: _____	TIME STAMP
TYPE OF SIGN: <input type="checkbox"/> ADVERTISING <input checked="" type="checkbox"/> ILLUMINATE <input type="checkbox"/> MOVEABLE <input checked="" type="checkbox"/> BUSINESS <input type="checkbox"/> FLASHING	
TOTAL STREET FRONTAGE OF LOT (IN FEET) <u>600</u>	
TOTAL AREA OF NEW SIGN (SQ.FT.) <u>502</u>	
TOTAL AREA OF ALL SIGNS ON LOT (SQ.FT.) <u>1,300</u>	
HEIGHT OF SIGN ABOVE GRADE (TO TOP) <u>21 ft 3in</u>	
DISTANCE OF CURB LINE OUTER EDGE (ft) <u>18</u> DISTANCE OF STRUCTURE INNER EDGE (ft) <u>45</u>	SIGN CLERK APPROVED FOR PERMIT
DISTANCE FROM (ft): A. PUBLIC PARK (OVER 10 ACRES) <u>1,000</u> B. EXPRESSWAY (IF LESS THAN 1,000 FT.) <u>1,000</u> C. RESIDENCE DISTRICT (ADVERTISING SIGNS ONLY) <u>1,000</u>	REMARKS
IF REPLACEMENT SIGN OR CHANGE OF FACE, WHAT DOES THE EXISTING SIGN READ? Original Payee: _____	
Landmark Hold: <input type="checkbox"/> Status: _____	
ZONING (OFFICE USE ONLY)	

CITY OF CHICAGO
DEPARTMENT OF ZONING AND LAND USE PLANNING
SIGN SITE PLAN
(ALL INFORMATION MUST BE COMPLETED AND LEGIBLE)

Site Address: 7601 S. Cicero Ave. 2 of 2 applications

Sign Company: Sure Light Sign Company Rep Name: Gayle Miller #2172670

Phone (815) 355 - 9841 EXT N/A (Below: Building, streets and location of sign on lot or structure)
North

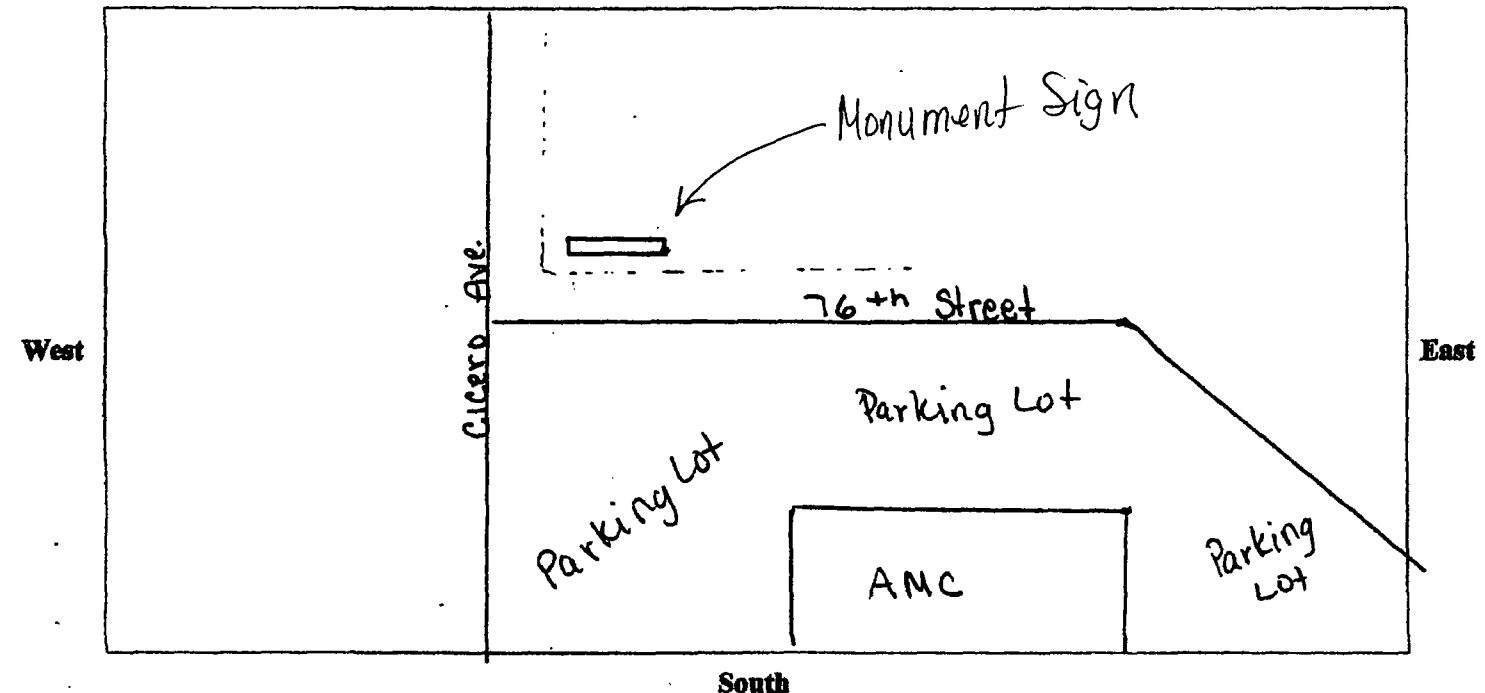

SIGN USE:

Bus. ID (On-premise) ☒

Business Lice. #
1799064

Advertising (Off-premise) ☐

PERMIT TYPE:

New Construction ☒

Change of Face

Previous Permit # ☐

TYPE OF SIGN:

Flat Wall ☐

Freestanding ☐

Awning ☐

Marquee ☐

High Rise Building ☐

Projecting Private ☒

Projecting Public Way ☐

Public Way Use -Permit #

SIGN CHARACTERISTICS:

Non- Illuminated ☐

Illuminated ☒

Changing Image ☐

Video Display ☐

Flashing ☐

DISTANCE FROM:

Curb Line: _____

Expressway, Toll Roads
or Major Route

(n/a if over 1000 ft) >1000

Park (over 10 acres) >1000

Residential Zone >1000

Existing Off-premise on
same side of street: N/A

TOTAL SQUARE FOOTAGE:

Square footage of this proposed sign 502

Gross area of all proposed signs 780

Area of all existing signs
(not including proposed) on Zoning Lot 1300

Signature : _____ #2172670

Date: 4/29/14